

MIDI MATE

2.4G MIDI IN/OUT Wireless Virtual Cable

Ver 1.2

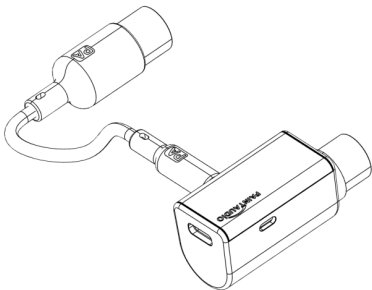

PAINTAUDIO

1 Connections and applications

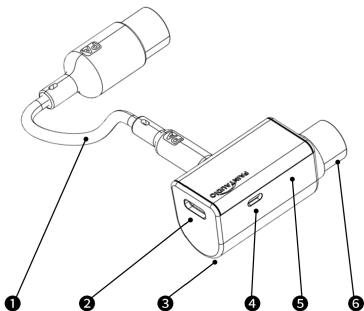

1. **MIDI IN** adapter. Converts MIDI IN plug into 2.5mm jack
2. **USB** data and **5V power** input
3. Charging (RED) and Power ON (BLUE) LED
4. **Power switch**: only for internal battery on / off
5. **Main Part**: Includes the circuits and the internal Li-battery
6. **MIDI OUT**: Standard MIDI OUT plug

Application examples 1:

One ways transmit

- Two MIDI MATEs are grouped in a pair by being set to the same wireless ID number
- MIDI signals are transmitted from one device to another device, covering a distance of 10-100 meters depending on the transmission conditions.
- The latency is less than 5ms.

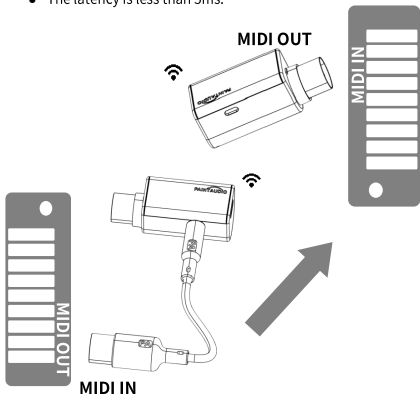

Application examples 2:

Double way transmit

- Two MIDI MATEs are grouped in a pair by being set to the same wireless ID number
- MIDI Signal transmits from one device to another device in both the way and return
- 10-100m distance based on the transmit condition. Latency $\leq 5\text{ms}$

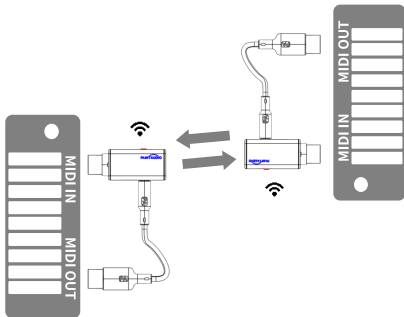

Application examples 3:

1:N Pairing with one sender and N receivers

Set all MIDI MATEs with the same wireless ID

It is not recommended to have multisenders but one receiver

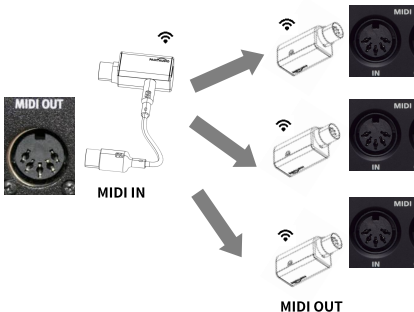

Application examples 4:

Work with MIDI CAPTAIN



Set MIDI MATE and
MIDI CAPTAIN with
the same wireless ID

1:1 mode



1:N mode

Set all devices with
the same wireless ID

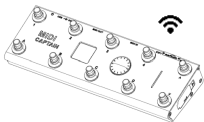

Application examples 5:

Hardware - Air - Software

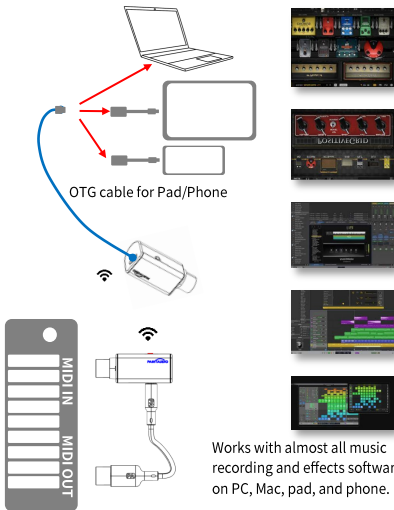

2 USB setup items

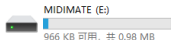

lib

Code libraries

license

Unique device license data ⚠️ Need backup to your PC in safe condi-

boot.py

boot_out.txt

code.py

Readme.txt

Setup.txt

Settings

```
WIRELESS_ID = [8] # 1-100 This ID should be  
MIDI_CHANNEL = [1] # 1-16 Match the MIDI CHAN  
WIRELESS_dB = [6] # Wireless power 0:12dBm 1  
9: -10dBm 10: -15dBm 11: -20dBm 12: -25dBm 13: -30d
```

There are 3 items to be set. Change the number in [] based on the application.

WIRELESS_ID: Set all devices need to be paired with the same ID

MIDI_CHANNEL: Set the MIDI CHANNEL

WIRELESS_dB: Set the wireless transmit power, number 14 to 0, stands for -25dBm to 12dBm

3 Backup and restore

It is recommended to back up the entire MIDIMATE disk on your PC, specially the **license** folder.

In case the flash based USB disk crashes or the setup file gets corrupted, a copy back can restore the device into its initial state.

You can download the latest Firmware package at **www.paintaudio.com**

Updating process:

Firmware update steps:

1. Connect your computer, whether it's a Windows PC or a Mac, using a USB Type-C cable.
2. Once connected, you should see the MIDIMATE drive on your computer. Open the drive and delete all files, except for the "license" directory and its contents.
3. Unzip the downloaded firmware package and copy all files to the empty MIDIMATE drive on your computer.
4. After copying all the files, unplug the USB cable and reconnect it.
5. Wait for about half a minute, and the firmware will enter the working state.
6. You can now use the updated device normally.

4 Specification

Power Voltage	5V USB Type C
Power Current	30mA / 80mA (USB-MIDI)
Power	0.4W
USB	USB-MIDI
Battery	230mAh Li-battery; 6-8 Hours
Battery charging	100mA auto-charging
Wireless ID	1-100
Wireless Frequency	2.4G
MIDI	OUT in main part, IN with cable
CPU	120MHz dual core
Weight	30g
Dimension	56mm x 25mm x 22mm (Main)

5 Safety information

Always follow the basic precautions listed below to avoid the possibility of serious injury or even death from electrical shock, damages, fire or other hazards. These precautions include, but are not limited to, the following:

- Do not connect the instrument during a thunder.
- Do not set up the cord or outlet to a humid place, unless the outlet is specially designed for humid places.
- If the instrument needs to be powered by AC, do not touch the bare part of the cord or the connector, when the power cord is connected to the AC outlet.
- Always follow the instructions carefully when setting up the instrument.
- Do not expose the instrument to rain or moisture, to avoid fire and/or electrical shock.
- Keep the instrument away from electrical interface sources, such as fluorescent light and electrical motors.
- Keep the instrument away from dust, heat and vibration.
- Do not expose the instrument to sunlight.
- Do not place heavy objects on the instrument; do not place containers with liquid on the instrument.
- Do not touch the connectors with wet hands.
- Leave the device out of the reach of kids and children when no guardian.
- Remove the USB cable or adapter powering source when not using the device.

6 Contact Us

Email: contact@paintaudio.com

Web: www.paintaudio.com

7 Other Statements

This User Guide is only used as a reference of the product. Any use not specified in the User Guide is considered to be the wrong use of the product. PaintAudio assumes no responsibility for any loss resulting from the irregular use. This User Guide may contain name and pattern information of other products, and the reference is used as auxiliary instructions. The owner of the registered trademark or patent can apply to change or delete the use of the trademark or patent . PaintAudio owns the right to modify this User Guide on account of product upgrade.

保修卡 Warranty

型号 Model	
用户签名 Signature	
日期 Date of Sales	
地址 Address	
序列号 SN	
经销商 Distributor	
发票号 Invoice No.	
其它备注 Others	

本产品自购买之日12个月内享受免费维保服务。以下情形除外：不可抗力损坏；人为损坏；私自拆修；法规规定的其它情形。

This product enjoys free maintenance service within 12 months from the date of purchase. Except for the following situations: force majeure damage; man-made damage; unauthorized dismantling and repair; other circumstances stipulated by laws and regulations.

PAINTAUDIO



合 格 证
QUALIFICATION

型号 MODEL	
检验 CHECKER	
日期 DATE	

PAINTAUDIO

THANK YOU