

Coventry Daimler Fleetline Bus

Kit contents

- Upper shell
- Lower shell
- Upper floor
- Lower floor
- Back wheel (x2)
- Front wheel (x2)
- Steering wheel
- Mirror (x2) (OO only)

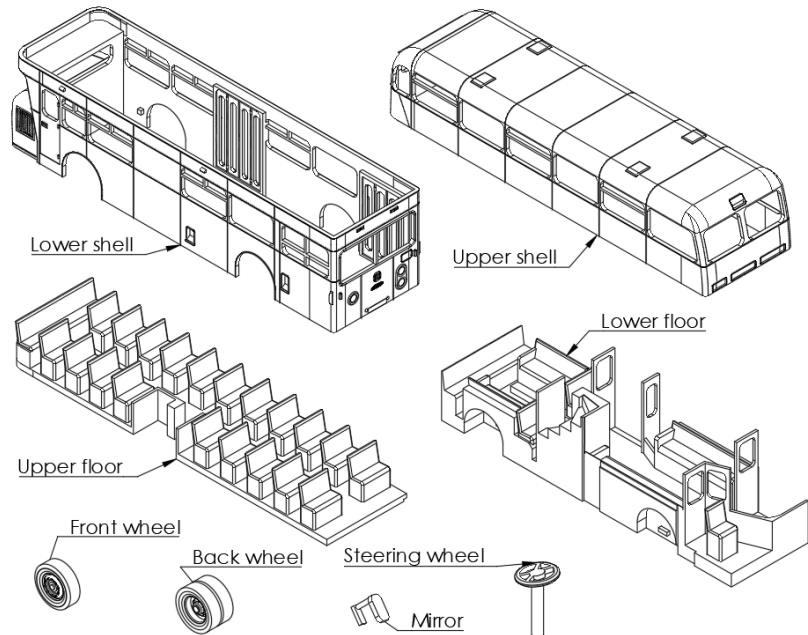

General Notes

Keep the parts of the model out of direct sunlight while unpainted. The resin used for the shell in particular is susceptible to UV degradation and will become brittle. The other parts are made from a plastic called PLA. It is less susceptible to UV degradation (although is still affected) it can start deforming at temperatures of 50°C and above.

Cyanoacrylate superglue is the best type of glue to use on all parts.

Instructions

1. Neaten shells if required

The production process for the shell can leave a number of small lumps or spots on the model. While we do our best to neaten the model before packaging, some may be missed. As such the model may need some gentle sanding with fine sand paper or a fine file to remove the lumps. A craft knife can also be used to trim parts. Be mindful of some the delicate details on the front of the bus.

2. Dry run fitting items together

We recommend doing a test run of fitting parts together so you get a feel for it before paint is applied to the model.

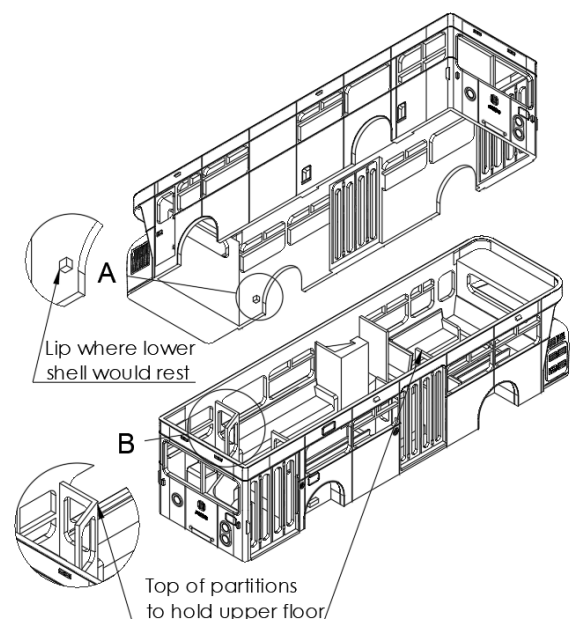



The lower floor should slide into the lower shell from below. It will rest against the lips that are on the inside of the shell to stop the floor moving too far.

The upper floor should rest inside the top of the lower shell and sit on the interior partitions, stairs and tops of the doors. The upper shell should then slide over the upper floor. Please don't force the upper floor into the upper shell, it may damage the shell.

The wheels have a slot on the back of them, to help align them in the wheel arches on the lower floor. The wheels will probably be loose at this point.

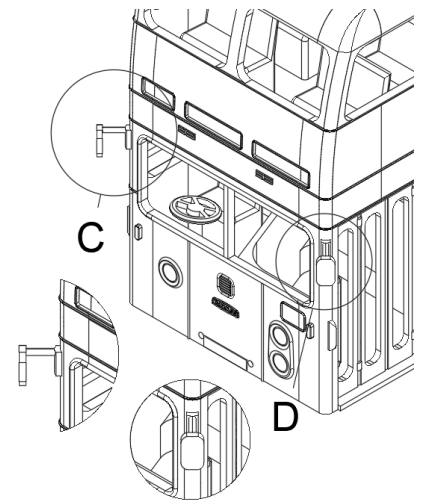

3. Add the wing mirrors and steering wheel

The wing mirrors (OO only) and steering wheel will need to be glued in place before painting the model. Make sure the steering wheel is placed far enough from the edge of the lower floor that the lower shell can still fit.

The diagrams opposite indicate where on the model they should be glued. A small spot of a cyanoacrylate superglue should keep them in place.

3. Decorate

Once you are happy with the fit of the parts you can take the bus apart and decorate it as you wish.

The model can be painted with standard modelling acrylics. We recommend spraying the model parts with a primer before painting.

If you wish to add glazing to the bus, this should be done at this point as well (after painting).

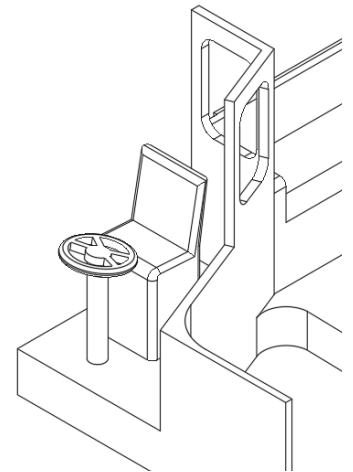

4. Reassemble and glue

Once you are happy the model can be reassembled following the same instructions as in step 2. To keep the parts in place, use a cyanoacrylate superglue. A small spot of glue in the slot of the wheels will be sufficient for them, and glue on the slot and lip should be sufficient for the floor. Note that the glue can set very quickly on the resin shell.

Suggestion for livery colours:

The following describes the colours for the Coventry Transport livery. A set of coloured drawings are also included.

The majority of the bus will be painted cream, with several horizontal bands in red. A very thin red band runs around the bus below the lower deck windows that drops down at the front corners to go underneath the front windscreen. There is a red band that round all around the bus above the lower deck windows (extending to where the shell splits) and at the very bottom of the bus. Another red band runs below the upper deck windows. The roof down to the top of the upper

deck windows is also red, and this curved round the last window on the upper deck so that all around the upper deck rear window is red. The mirrors should also be red.

Several details should be highlighted in a shiny metal colour: the window bars, the surround of the front lights, the surround of the windscreen, the handrails on the front door entrance, the handle on the upper deck rear window and the door handle on the back door. The Daimler logo and detailing above should also be highlighted.

