

oneisall®

Pet Clippers for Home Grooming

Model: X2

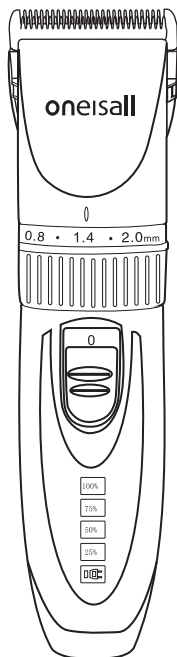

Any problems you have, please contact us:
support@oneisall.com

ON-D120

Each Part Name

UK

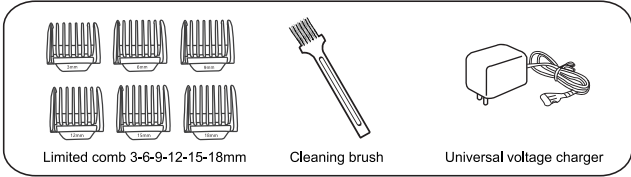
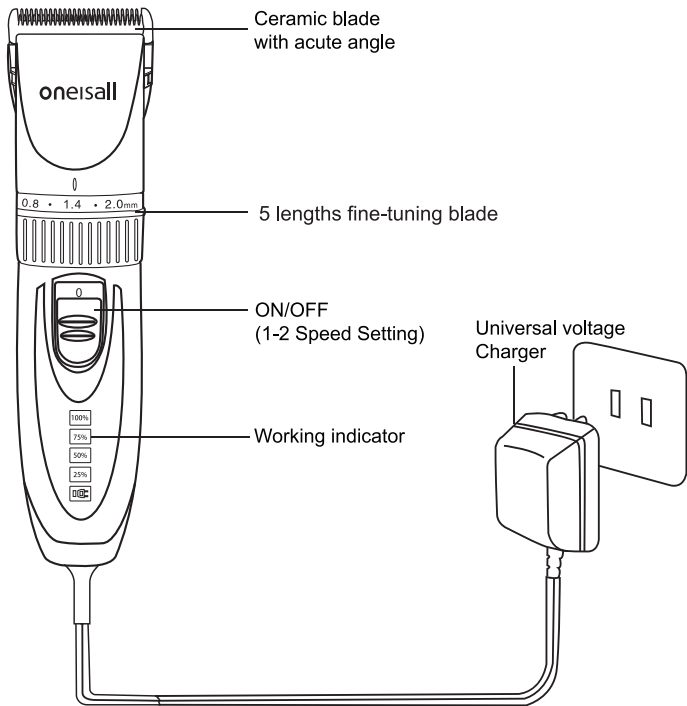

Professional Hair Clipper	Motor	Operating voltage:3.7V
		Centering material:anti-wear brass
	Battery	high-performance environment-friendly battery
		Charging time:about 3H
		Operating time with full charge:about 240 min

Specific Adapter	Input: 110V - 240V50/60Hz
	Output:DC 5V == 1A

LED

1>Charging status indicator

Remaining Battery performance \ Battery indicator		20%	40%	60%	80%	100%
< 20%	✓	Flashing light	X	X	X	X
< 40%	✓	✓	Flashing light	X	X	X
< 65%	✓	✓	✓	Flashing light	X	X
< 80%	✓	✓	✓	✓	Flashing light	X
< 100%	✓	✓	✓	✓	✓	✓

2>Operating status display

Remaining Battery performance \ Battery indicator		20%	40%	60%	80%	100%
<100%	X	✓	✓	✓	✓	Flashing light
< 80%	X	✓	✓	✓	Flashing light	X
< 60%	X	✓	✓	Flashing light	X	X
< 40%	X	✓	Flashing light	X	X	X
< 20%	X	Flashing light	X	X	X	X
< 5%	Flashing light	X	X	X	X	X

A:Limited comb function trim for crew cut or the side hair Special long (3,6,9,12,15,18 mm) 6 Kinds of length adjustment to control the length of hair.

B:Blade limit redulator:5 kinds of length adjustment from 0.8mm-2.0mm.

- 1.Determine the need hair length.
- 2.Select the appropriate limit comb.

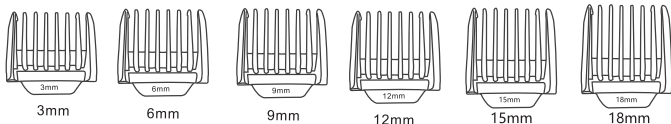

- 3.Fine tune the blade.

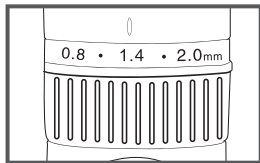

Moving the button left and right to adjust the blade(0.8mm-2.0mm)

Limit Comb installation:

Like the picture,hold both sides and push when butting the button positions.(Notes: the comb should not be loose or easy to fall off after being butted.)

Limit Comb dismantle:

Remove the butted positions with hands on its both sides and then remove the comb.

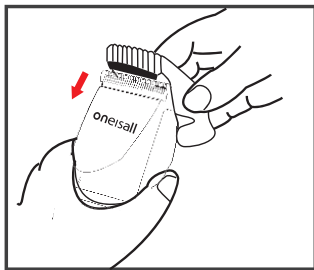

Blade Removal



- Like the picture, press down the moving blade with the thumb and then remove the blade.

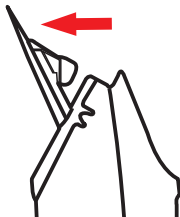

- Please hold with the other hand to avoid the blade falling off.

Blade Installation

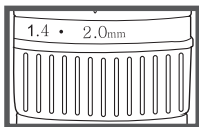

- Adjust the adjusting ring to 2.0mm before installing the blade

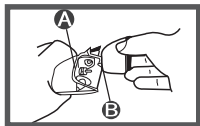

- Direct the blade (B) at the hair clipper's slot (A) and plug in



- Push the blade down until it clicks

Taper Blade Cleaning



1. Clear up the blade with cleaning brush.

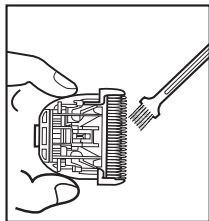

2. The blade can be removed out for cleaning.

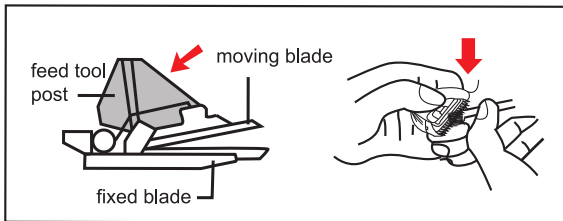

The moving blade can be turned back, and then cleaning the hair between the moving blade and the fixed blade.

Taper Blade Maintenance

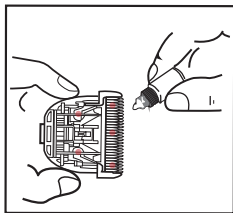

Before or after use, maintain the blade by dripping some oil on the red point places like the left picture. (oil included)

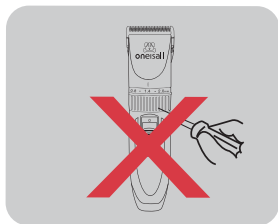

1. Please do not disassemble the product.
2. The hair clipper can not be washed.
Please keep it away from wet conditions.

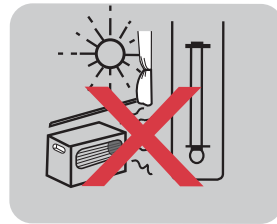

3. The product can only be cleaned by cloth with little water or mild soap solution.
4. Do not charge the product under environment above 104°F or below 32°F.
 - ※ The product can produce little heat during using or charging, which is normal.
 - ※ Please remove the battery safely and return it to the specified places when the battery runs out. Never discard it casually.

Q1. Any suggestions before using the clipper?

A1. Firstly, you should wash and dry the pet.

Secondly, if your pet's hair is too long, you should trim your pet's hair with scissors first, comb the hair smoothly, then use clippers to trim your pet.

Thirdly, before and after using the clipper, a little oil should be dripped on the blade for lubrication and maintenance.

Q2. What does the guide comb 3mm, 6mm, 9mm, 12mm mean? How to use it?

A2. The size of the blade and the guide combs means the length of the hair that can be left on your cat after a grooming.

For example, if you use the blade with 1.0(mm) and the 12mm guide comb together, that it will leave $1.0\text{mm} + 12\text{mm} = 13\text{mm}$ long hair on your cat.

If you use the blade with 1.0 (mm) and don't use a guide comb that the hair will be shortened to 1.0mm only.

Q3. What should I do if the battery cannot be recharged or turned on?

A3. The battery life depends on the frequency of use and the time of use. If it is not used for a long time, it is recommended to charge the hair clipper at least once every three months to ensure battery life.

WE ARE READY TO HELP

oneisall offers a standard **2-year** warranty. If you have any issues with your oneisall product, please do not hesitate to contact us. Be sure to include your proof of purchase, model number, and any relevant photos or videos in your message to expedite the process. Our oneisall support team is available 7 days a week and will respond to your inquiry within **24 hours**. Thank you for choosing oneisall.

Please note that the oneisall warranty does not apply to used products or purchases made from unauthorized sellers. It's important to be aware that the warranty also does not cover consumable parts such as blades, guards, filters, brushes, and similar items. These parts may require regular replacement or maintenance.

✉ support@oneisall.com

☎ +1 877-522-8578 (US) **Mon-Fri** 8am-5pm(PST)

🌐 Web: www.oneisall.com



Guide video



@Oneisall Official

oneisall[®]

Any problems you have, please contact us :
support@oneisall.com



ON-D120