

oneisall®

# Pet Clippers for Home Grooming

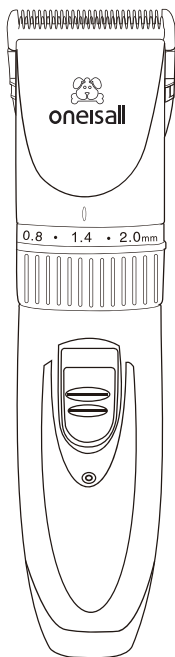

ON-D113

# Each Part Name

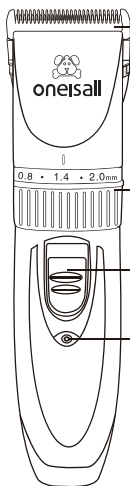

Sharp ceramic blade

5-position  
blade length adjustment

Switch

Charging Indicator

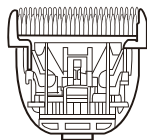

Charger



Type-c



Guide comb 3-6-9-12-15-18 mm



Brush



Oil

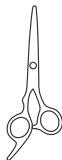

Scissors



Comb

## High performance lithium battery

---

Pet Grooming Clipper	Motor	Operating voltage: 5V
		Centering material: anti-wear brass
	Battery	Battery type: 2000mAh
		Charge time: 3h
		Operating time: 3h
Specific Adapter	Input: 100V-240V~50/60Hz	
	USB connect with adapter 5V=1A	

## Plug-in Using Method

---

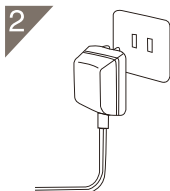
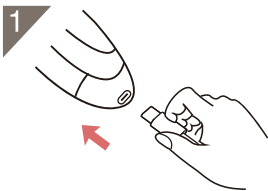

- 1.Putting the rechargeable batteries into the clipper and plugging the charging cable to start charge.
- 2.Red Charge light means start charge.
- 3.The red charge light will be changed into green color when it is fully charged.

# Adjusting Length Function

---

- A:** Limited comb function trim for crew cut or the side hair  
Special long(3,6,9,12,15,18mm)6 kinds of length adjustment to control the length of hair
- B:** Blade limit regulator: 5 kinds of length adjustment from 0.8mm-2.0mm

1. Determine the need hair length
2. Select the appropriate guide comb

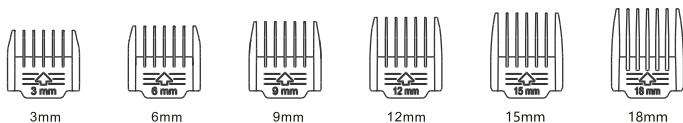

## 3. Fine tune the blade

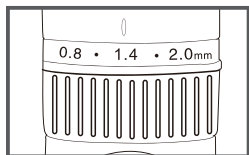

Moving the button left and right to adjust the blade (0.8mm-2.0mm)

### Guide Comb installation:

Like the picture, hold both sides and push when butting the button positions. (Notes: the comb should not be close or easy to fall off after being butted.)

### Guide Comb dismantle

Remove the butted positions with hands on its both sides and then remove the comb.

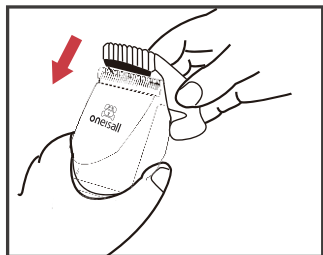

# Blade Removal & Installation

---

## Blade Removal



- Like the picture, press down the moving blade with the thumb and then remove the blade.
- Please hold with the other hand to avoid the blade falling off.

## Blade Installation

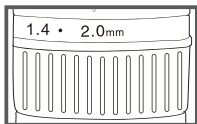

- Adjust the adjusting ring to 2.0mm before installing the blade

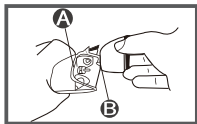

- Direct the blade(B) at the hair clipper's slot(A) and plug in



- Push the blade down until it clicks

# Cleaning & Maintenance

---

## Blade Cleaning

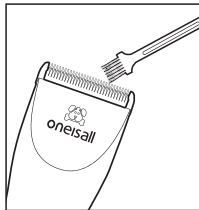

1. Clear up the blade with cleaning brush.

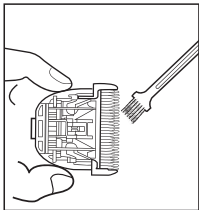

2. The blade can be removed out for cleaning.

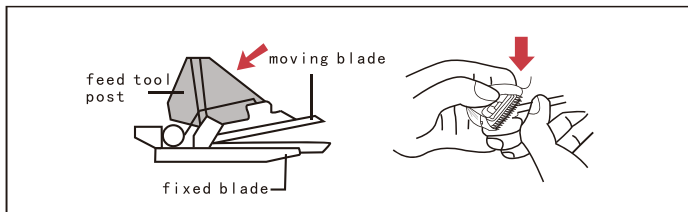

The moving blade can be turned back on, and then cleaning the hair between the moving blade and the fixed blade.

## Blade Maintenance

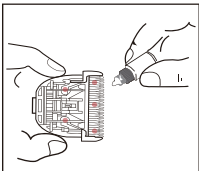

Before or after use, maintain the blade by dripping some oil on the red point places like the left picture.

## Precautions For Use

---



1. Please do not disassemble the product.



2. The hair clipper can not be washed. Please keep it away from wet conditions.

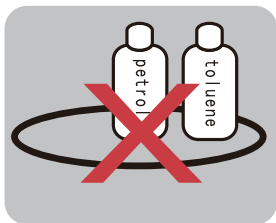

3. The product can only be cleaned by cloth with little water or mild soap solution.

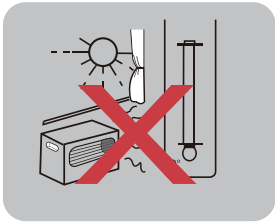

4. Do not charge the product under environment above 40°C or 0 °C

- The product can produce little heat during using or charging, which is normal.
- Please remove the battery safely and return it to the specified places when the battery runs out. Never discard it casually.

## Contact Us

---

### WE ARE READY TO HELP

Oneisall offers a standard **2 years** warranty. If you have any issues with your Oneisall product, please do not hesitate to contact us. Be sure to include your proof of purchase, model number, and any relevant photos or videos in your message to expedite the process. Our Oneisall support team is available 7 days a week and will respond to your inquiry within **24 hours**. Thank you for choosing Oneisall.

Please note that the Oneisall warranty does not apply to used products or purchases made from unauthorized sellers. It's important to be aware that the warranty also does not cover consumable parts such as blades, guards, filters, brushes, and similar items. These parts may require regular replacement or maintenance.

✉ support@oneisall.com

🕒 +1 877-522-8578 (US) **Mon-Fri** 8am-5pm(PST)

🌐 www.oneisall.com



Guide video



@Oneisall Official