

Dining Table #J040213 Installation

INSTALLATION MANUAL Tools You Will Need:

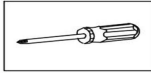

Philips Screwdriver

Before the Installation

1. Do not throw away packing materials until assembly is complete for small parts may come loose inside the carton during shipment. If parts are missing, please contact us.
2. Assemble this item on a soft surface, such as carpet to protect the finish.
3. Proper assembly of this item requires 2 people.
4. Periodically check to ensure that all connections are tight.
7. It is recommended that installation of the product be done by a qualified licensed plumber.

Care and Cleaning

1. To protect the finish, avoid use chemicals and household cleaners.
2. All hot serving dishes should be placed on a pad.
3. Any liquid spilled onto the top should be cleaned up immediately with a damp cloth.

Parts List

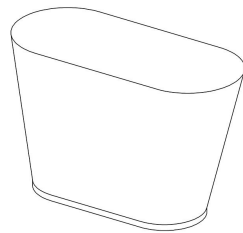

base (A x 1)

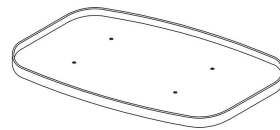

metal plate (B x 1)

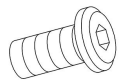

screw (AA x 4)

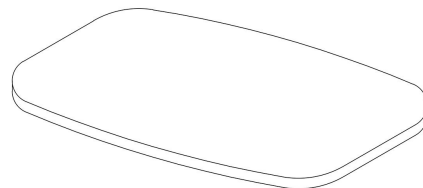
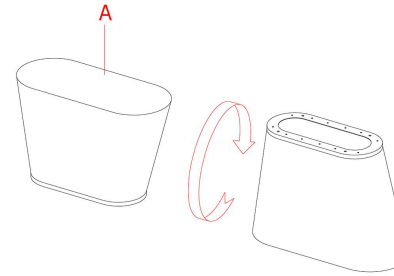

table top (C x 1)

Note: Do not fully tighten all bolts until all parts are in place. Failure to follow these instructions may cause the bolt to misalign during assembly.

Installation Guide



1. Place the base (A) upside down on a clean surface.

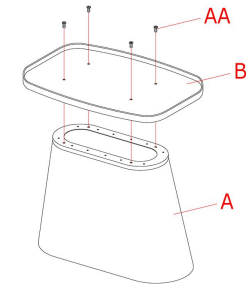

2. Match the holes of metal plate (B) with holes given on the bottom of the base (A) with screws (AA).

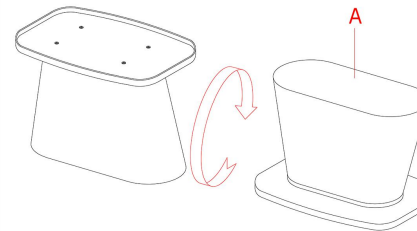

3. Place the base (A) in the right way (as picture shown).

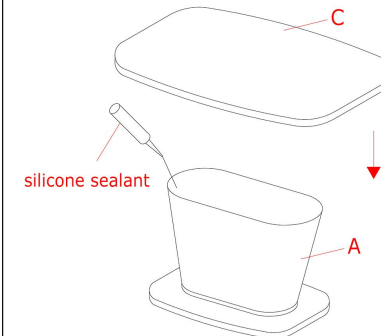

4. Attach silicone sealant over the edge of the base (A). Then, put the table top (C) to the base (A) lightly and correctly.