

# ShelfTalkers™ & Sign Holders

## IN-STORE MESSAGING WITH AISLE SIGNS & SHELF TALKERS™

Promote your message at the shelf edge using kostklip's in-store signage solutions. Combine a right angle aisle sign with Signature Series ShelfTalkers™ to deliver a cohesive message.



Gluten-Free Section



Combine large signs with smaller ShelfTalkers™



### Gluten Free ShelfTalker™

Use bold, colorful and reusable ShelfTalkers™ to highlight specific products on the shelf. Help shoppers identify gluten free options in your store with kostklip's Pre-Printed ShelfTalkers™. Available for ClearVision™ and ClearGrip™ shelf edge ticket moldings. Contact us for C-channel or other shelf applications.

### Gluten Free Aisle Sign

Use way-finding signs, like kostklip's Gluten Free Aisle Sign, to help customers identify specialty sections in your store. Printed on 0.0600" Styrene, the aisle sign is more durable than typical paper or Sintra® aisle markers.

### Top Mount Right Angle Sign Holder

Kostklip's Top Mount Right Angle Sign Holder is a sleek and light alternative to sharp, bulky metal sign fasteners. Attach to the shelf with included pushpins and use with interchangeable T-style sign grips to hold materials of different thicknesses.

**kostklip®**  
LIFE AT THE SHELF EDGE

**Toll-Free North America 1.800.661.5547**

Kost Klip Manufacturing Ltd. | [www.kostklip.com](http://www.kostklip.com) | [sales@kostklip.com](mailto:sales@kostklip.com)

ShelfTalkers\_SignHolders\_092514 | Printed in Canada

# ShelfTalkers™ & Sign Holders

## IN-STORE MESSAGING WITH AISLE SIGNS & SHELF TALKERS™

Promote your message at the shelf edge using kostklip's in-store signage solutions. Combine a right angle aisle sign with Signature Series ShelfTalkers™ to deliver a cohesive message.

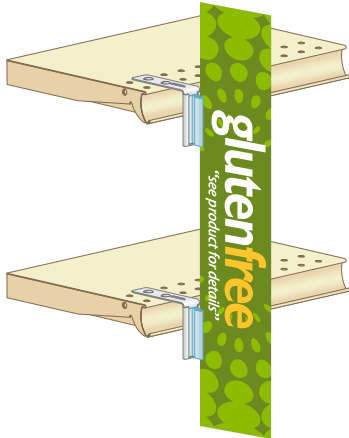

### Gluten Free Aisle Sign

- Custom print
- Durable 0.0600" Styrene
- Contact us for other shapes and sizes

Code	Description	Color	Pack
GFAS-106369	36"H x 6"W	Green/Yellow	1

\*Matching color pushpins included

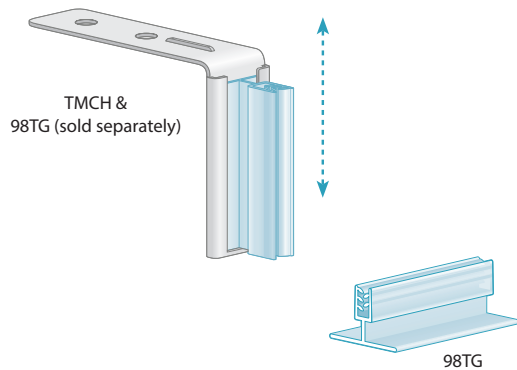

### Top Mount Right Angle Sign Holder

- Low profile top mount attaches with pushpins (included)
- Use varying sized grips (sold separately) to hold signs
- Hinged to swing away and return to position
- Available in black or white

Code	Description	Color	Pack
TMCH-106208	2"H x 3"L	AW	10
TMCH-106207	2"H x 3"L	BL	10
98TG-106391	grip holds up to 0.1" thickness	CL	10
99TG-106392	grip holds up to 0.187" thickness	CL	10
100G-106393	grip holds up to 0.25" thickness	CL	10

\*Matching color pushpins included with TMCH



### Gluten-Free Bib ShelfTalker™

- Clips into any 1.25"H ClearVision® ticket molding
- Reusable
- Clear PVC
- Contact us for custom sizes and colors

Code	Description	Pack
SSHA-105216	'Gluten Free', 2.5"W x 1.25"H	100



Toll-Free North America 1.800.661.5547

Kost Klip Manufacturing Ltd. | [www.kostklip.com](http://www.kostklip.com) | [sales@kostklip.com](mailto:sales@kostklip.com)

ShelfTalkers\_SignHolders\_092514 | Printed in Canada