

Channel Clip-In, Flush, Adhesive Front

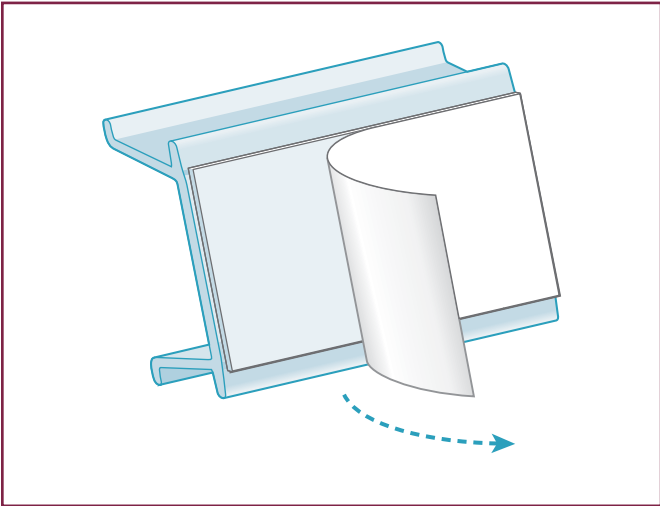

FEATURES:

- Includes foam tape
- » Can be used with SPRO and 260F sign protectors

Code	Description	Color	Pack
CHCL-103982	2"L, with foam tape	CL	50



Toll-Free North America 1.800.661.5547

Kost Klip Manufacturing Ltd. | www.kostklip.com | sales@kostklip.com

CHCL_Product_Sheet_VSN 1 | Printed in Canada