

124E TWISTKLIP™ SIGN HOLDERS

Colorful TwistKlips™ all-plastic, rust proof sign holders



Shown paired with SPRO sign protector

Kostklip's TwistKlips™ are versatile sign holders for endless number of applications. We've improved our original TwistKlip™ by creating an all-plastic sign holder, ideal for wet areas like Floral, Produce, Deli and Outdoor departments. Our all-plastic TwistKlips™ are rust-proof and wash down so it can be used for open food applications. The large clip has a firm grip and attaches almost anywhere for your in-store signage needs.

We've added some **new colors** to coordinate with seasonal displays, promotions, CPG programs or corporate branding. The **clear top creates maximum readability** to inform your customers about your merchandise. Combine the TwistKlip™ with one of our sign protectors to protect your paper signs from damage.



Clear with dark pink, lime green & blue



All black & all clear



Clear with white & black



Shown with CVTM sign protector by clipping onto the back leg of the sign holder. The TwistKlip™ discreetly displays pricing and signage.

Compatible with:

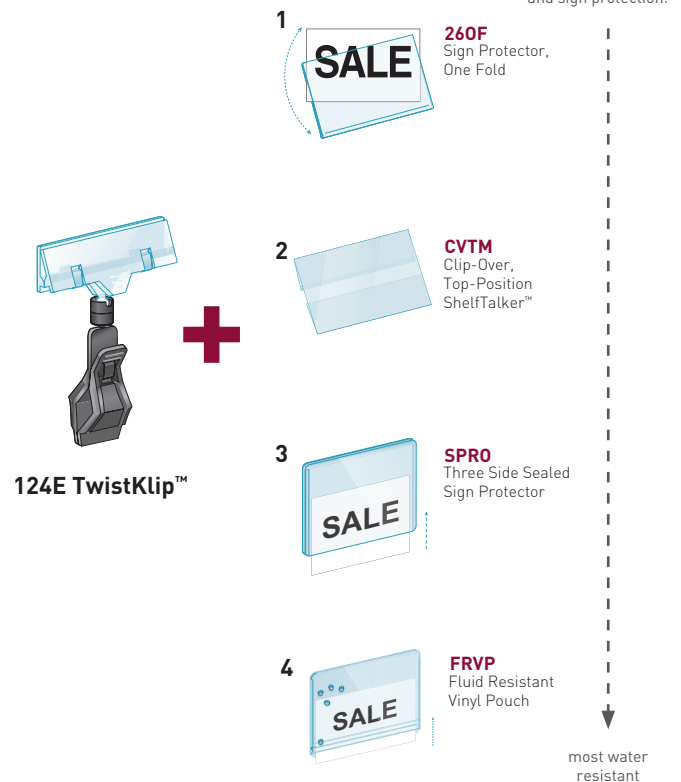

kostklip®
LIFE AT THE SHELF EDGE

Toll-Free North America 1.800.661.5547

Kost Klip Manufacturing Ltd. | www.kostklip.com | sales@kostklip.com

Colorful-TwistKlips_053018 | Printed in Canada

124E TWISTKLIP™ SIGN HOLDERS

Versatile, flexible, sign clips

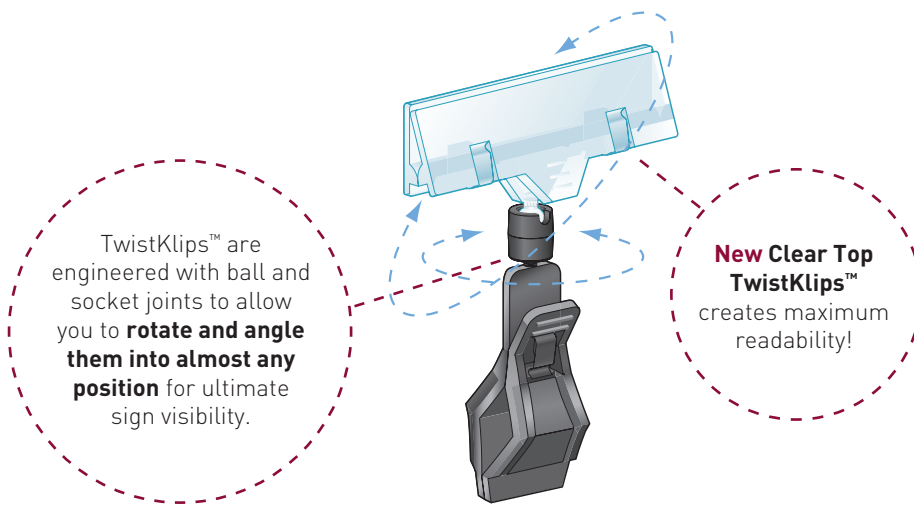

Custom colors available!

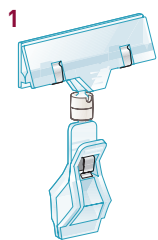

1
Original TwistKlip™
Metal hinges
124E-101271

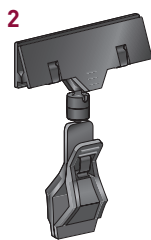

2
Black TwistKlip™
All plastic
124E-106155

NEW!

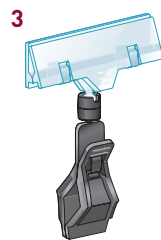

3
Clear Top TwistKlip™
All plastic
124E-107258

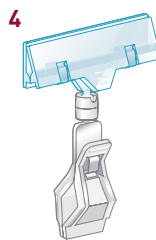

4
Clear Top TwistKlip™
All plastic
124E-107257



5
Clear Top TwistKlip™
All plastic
124E-107256

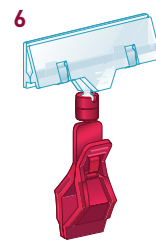

6
Clear Top TwistKlip™
All plastic
124E-107254



7
Clear Top TwistKlip™
All plastic
124E-107255

Code	Description	Color	Pack
1 124E-101271	4"H x 3.125"W	CLEAR	25
2 124E-106155	4"H x 3.125"W	BLACK	25
3 124E-107258	4"H x 3.125"W	CLEAR/BLACK	25
4 124E-107257	4"H x 3.125"W	CLEAR/WHITE	25
5 124E-107256	4"H x 3.125"W	CLEAR/LIMEGREEN	25
6 124E-107254	4"H x 3.125"W	CLEAR/DARKPINK	25
7 124E-107255	4"H x 3.125"W	CLEAR/BLUE	25

*Contact us to request for samples

FEATURES

- Sign clip holds material up to 0.187" thick
- Large sign clip fastens to material up to 1" thick
- Universal joint swivels in almost any direction
- Polycarbonate plastic—durable and rust proof
- Safe to use in food areas with proper cleaning
- Contact kostklip's customer service for additional colors

kostklip®
LIFE AT THE SHELF EDGE

Toll-Free North America 1.800.661.5547

Kost Klip Manufacturing Ltd. | www.kostklip.com | sales@kostklip.com

Colorful-TwistKlips_053018 | Printed in Canada