

Graco Supply Systems

Lubrication Bulk Packages with Advanced NXT[®] Technology



PROVEN QUALITY. LEADING TECHNOLOGY.

Check-Mate® Grease Systems

Check-Mate Grease Pump Floor Stand Packages

		14:1	26:1	29:1	55:1	63:1	68:1	
CHECK-MATE FLOOR STAND PUMPS	PUMP SPECIFICATIONS	Package Number with DataTrak	247973	247976	247974	247977	247975	247978
		Package Number w/o DataTrak	24E006	24E007	24E008	24E009	24E010	24E011
		Mounting	Floor Stand (223952)					
		Pump with DataTrak	P14MCS	P26MCS	P29MCS	P55MCS	P63MCS	P68MCS
		Pump w/o DataTrak	P14DCS	P26DCS	P29DCS	P55DCS	P63DCS	P68DCS
		Output per Cycle	500cc		250cc		100cc	200cc
		Motor Size	NXT 3400	NXT 6500	NXT 3400	NXT 6500	NXT 3400	NXT 6500
		Maximum Fluid Pressure psi (bar, Mpa)	1400 (96.5, 9.7)	2600 (179.3, 17.9)	2900 (200.0, 20.0)	5500 (379.2, 37.9)	4500 (310.3, 31.0)	5300 (356.5, 36.5)
		Maximum Air Input Pressure psi (bar, Mpa)	100 (6.9, 0.7)				72 (5.0, 0.5)	78 (5.4, 0.53)
		Output at 60 CPM lbs/min (kg/min)*	57.0 (26.0)		28.0 (13.0)		11.4 (5.2)	22.8 (10.4)
	MANUALS	System Manual	312863					
		Pump Manual	312376					
		Pump Lower Manual	312375					
Motor Manual		311238						
OUTLET	Pump Outlet Size	1 1/2 in npt (m)		1 in npt (f)		3/4 in npt (m)	1 in npt (f)	
	HOSES	3/4 in x 6 ft Air Hose	208610					
1 in x 6 ft Fluid Hose		115042	244657					

*Graco recommends 20 CPM or less for supply applications



Check-Mate Grease Ram Packages

		14:1	63:1	68:1	
CHECK-MATE RAM PUMPS	PUMP SPECIFICATIONS	Package Number	247979	247980	247981
		Mounting	RAM System		
		Output per Cycle	500cc	100cc	200cc
		Motor Size	NXT 3400		NXT 6500
		Maximum Fluid Pressure psi (bar, Mpa)	1400 (96.5, 9.7)	4500 (310.3, 31.0)	5300 (365.5, 36.5)
		Maximum Air Input Pressure psi (bar, Mpa)	100 (6.9, 0.7)	72 (5.0, 0.5)	78 (5.4, 0.53)
		Output at 60 CPM lbs/min (kg/min)*	57.0 (26.0)	11.4 (5.2)	22.8 (10.4)
	MANUALS	System Manual	312863		
		Supply Systems Operation	312371		
		Supply Systems Repair & Parts	312373		
	OUTLET	Pump Outlet Size	1 1/2 in npt (m)	3/4 in npt (m)	1 in npt (f)
		HOSES	3/4 in x 6 ft Air Hose	208610	
	1 in x 6 ft Fluid Hose		115042	244657	

*Graco recommends 20 CPM or less for supply applications



Move Large Amounts of Oil and Grease Fast!

Dispenses up to 31 gallons of oil or 57 pounds of grease a minute

- Tested to outperform and outlast all other pumps on the market with its long-life packing design
- Intuitive, easy-to-use controls
- Best value for the money—fewer parts, faster repairs and long-lasting durability

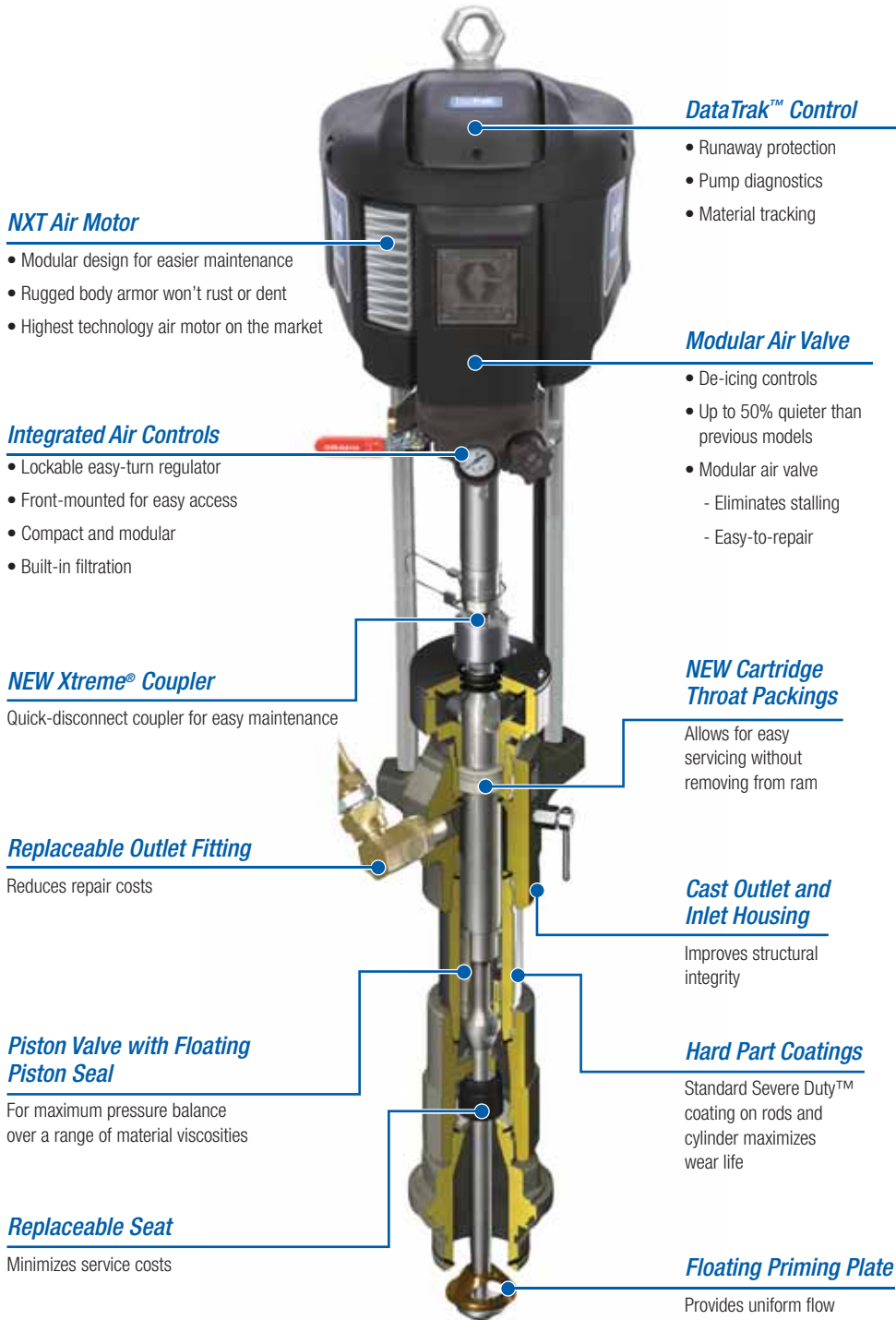

NXT Air Motor

- Modular design for easier maintenance
- Rugged body armor won't rust or dent
- Highest technology air motor on the market

Integrated Air Controls

- Lockable easy-turn regulator
- Front-mounted for easy access
- Compact and modular
- Built-in filtration

NEW Xtreme® Coupler

Quick-disconnect coupler for easy maintenance

Replaceable Outlet Fitting

Reduces repair costs

Piston Valve with Floating Piston Seal

For maximum pressure balance over a range of material viscosities

Replaceable Seat

Minimizes service costs

DataTrak™ Control

- Runaway protection
- Pump diagnostics
- Material tracking

Modular Air Valve

- De-icing controls
- Up to 50% quieter than previous models
- Modular air valve
 - Eliminates stalling
 - Easy-to-repair

NEW Cartridge Throat Packings

Allows for easy servicing without removing from ram

Cast Outlet and Inlet Housing

Improves structural integrity

Hard Part Coatings

Standard Severe Duty™ coating on rods and cylinder maximizes wear life

Floating Priming Plate

Provides uniform flow



Markets/Applications

In-Plant

- Supply long-pipe runs or large volume header systems with multiple dispense locations
- Fill remote reservoirs or feed an automated lubrication system
- Transfer and dispense large amounts of lubricant to supply a production process

Mines/Construction

- Rapid fill of lube trucks
- Service off-road equipment needing high volume transfers of oil or transmission fluids
- Feed lubricant to a mine or construction process

Fleets (municipal, military, aviation)

- Rapid transfer or dispense of lubricants to service fleet equipment
- Supply large volume header systems with multiple dispense locations

What's NXT?

Innovation that boosts your productivity.

Graco NXT. It's what's next.

DataTrak...More Control Than Ever Before

Advanced Graco Control Architecture

The Rules Have Changed

- Provides pump runaway protection by monitoring pump speed. DataTrak automatically shuts the pump off when material runs out or if a hose breaks.
- Tracks and displays material usage and volumetric flow, and tells you how much material is left in the drum. With an accurate, unbiased measurement of flow, DataTrak helps ensure quality control and eliminates material waste.
- Provides pump diagnostics for better maintenance. DataTrak tracks material throughput, which indicates when it's time for routine maintenance. It also provides pump lower diagnostics and lets you know whether the pump is diving in the up or down stroke—a good indication that packings or balls are starting to wear, or the pump needs to be cleaned.



Remote Control for Maximum Convenience

- Integrated ram and pump control is easy to use and easy to see
- Intuitive electronic user interface gives the operator immediate and important operating data at the touch of a button

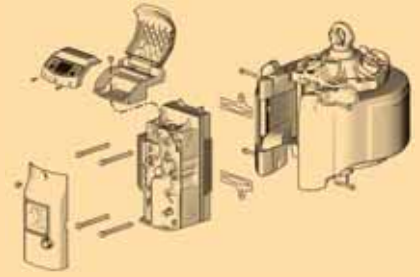

Modular—No Special Tools Required

Graco air motors are designed with modular components so that no special tools are needed for assembly and repair.

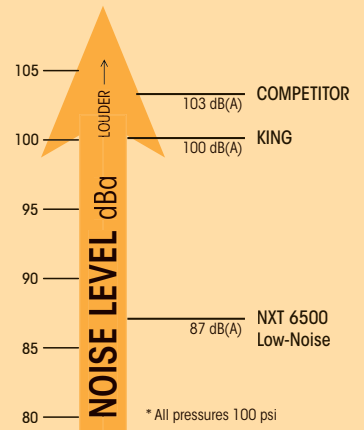

Quiet Operation

The quiet, low-noise NXT Air Motor operates around 87 decibels, while other comparable motors operate up to 103 dB(A).

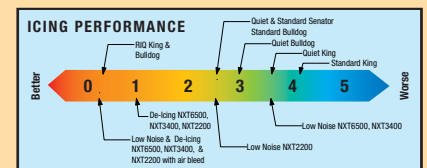

Reduced Icing Keeps You Pumping

Frost or ice can freeze-up the pump when you're moving large volumes of oil or grease.

Graco's all new de-icing technology adds warmer ambient air to the air motor to melt any build-up.

Dura-Flo™ and High-Flo® Oil Systems

Dura-Flo Oil Pump Packages

		6:1	10:1	12:1	23:1	
DURA-FLO PUMPS	PUMP SPECIFICATIONS	Package Number with DataTrak	247890	247894	247891	247895
		Package Number w/o DataTrak	24D604	24D608	24D605	-
		Mounting	Wall (255143)			
		Pump with DataTrak and thermal relief kit	24D592	24D595	24D593	-
		Pump w/o DataTrak and thermal relief kit	24D598	24D601	24D599	-
		Output per Cycle	1000cc		580cc	
		Output at 60 CPM gpm (lpm)*	17.4 (65.9)		9.2 (34.8)	
		Motor Size	NXT 3400	NXT 6500	NXT 3400	NXT 6500
		Maximum Fluid Pressure psi (bar, Mpa)	620 (42.7, 4.3)	1180 (81.3, 8.1)	1190 (82.1, 8.2)	1725 (118.9, 11.9)
		Maximum Air Input Pressure psi (bar, Mpa)	100 (6.9, 0.7)			75 (5.2, 0.5)
	MANUALS	System Manual				312862
	INLET/ OUTLET SIZE	Pump Inlet Size	2 in npt (f)			
		Pump Outlet Size	1 1/2 in npt (f)			
	HOSES	3/4 in x 4 ft Air Hose	110048			
1 in x 6 ft Fluid Hose		115042				

*Graco recommends 20 CPM or less for supply applications



High-Flo Oil Pump Packages

		3.5:1	4.5:1	6:1	6:1	
HIGH-FLO PUMPS	PUMP SPECIFICATIONS	Package Number with DataTrak	247888	247889	247892	247893
		Package Number Pump w/o DataTrak	24D602	24D603	24D606	24D607
		Mounting	Wall (255143)			Stand (218742)
		Pump with DataTrak and thermal relief kit	24D590	24D591	24D594	24D594
		Pump w/o DataTrak and thermal relief kit	24D596	24D597	24D600	24D600
		Output per Cycle	2000cc	1500cc	2000cc	
		Output at 60 CPM gpm (lpm)*	31.5 (119.2)	23.2 (87.8)	31.5 (119.2)	
		Motor Size	NXT 3400		NXT 6500	
		Maximum Fluid Pressure psi (bar, Mpa)	350 (24.1, 2.4)	450 (31.0, 3.1)	500 (35.2, 3.4)	
		Maximum Air Input Pressure psi (bar, Mpa)	100 (6.9, 0.7)		75 (5.2, 0.5)	
	MANUALS	System Manual				312862
	INLET/ OUTLET SIZE	Pump Inlet Size	1 1/2 in npt (f)		2 in npt (f)	
		Pump Outlet Size	1 in npt (f)		2 in npt (f)	
	HOSES	3/4 in x 4 ft Air Hose	110048			
1 in x 6 ft Fluid Hose		115042		247969		

*Graco recommends 20 CPM or less for supply applications



AMERICAS

MINNESOTA

Worldwide Headquarters
Graco Inc.
88 -11th Avenue N.E.
Minneapolis, MN 55413

MAILING ADDRESS

P.O. Box 1441
Minneapolis, MN 55440-1441
Tel: 612-623-6000 Fax: 612-623-6777

EUROPE

BELGIUM

European Headquarters
Graco N.V.
Industrieterrein -Oude Bunders
Slakweidestraat 31
3630 Maasmechelen,
Belgium
Tel: 32 89 770 700 Fax: 32 89 770 777

ASIA PACIFIC

AUSTRALIA

Graco Australia Pty Ltd.
Suite 17, 2 Enterprise Drive
Bundoora, Victoria 3083
Australia
Tel: 61 3 9468 8500 Fax: 61 3 9468 8599

CHINA

Graco Hong Kong Ltd.
Shanghai Representative Office
Building 7
1029 Zhongshan Road South,
Huangpu District
Shanghai, 200011
The People's Republic of China
Tel: 86 21 649 50088 Fax: 86 21 649 50077

INDIA

Graco Hong Kong Ltd.
India Liaison Office
Room 443, Augusta Point
Regus Business Centre 53
Golf Course Road
Gurgaon, Haryana
India 122001
Tel: 91 124 435 4208 Fax: 91 124 435 4001

JAPAN

Graco K.K.
1-27-12 Hayabuchi
Tsuzuki-ku
Yokohama City, Japan 2240025
Tel: 81 45 593 7300 Fax: 81 45 593 7301

KOREA

Graco Korea Inc.
Shinhan Bank Building
4th Floor #1599
Gwanyang-Dong, Dongan-Ku,
Anyang-si, Korea 431-060
Tel: 82 31 476 9400 Fax: 82 31 476 9801



Graco's got you covered

Facilities Worldwide for Global Support



Quality First

At Graco we pride ourselves on providing best-in-class products. Engineered solutions are manufactured in our own facilities, with the highest standards in the industry. We provide you with world-class customer support and expertise to help solve your lubrication challenges.



Global Reach

Graco has facilities across the globe to provide you with the products and service *you* need, where *you* live. Plus, Graco has dedicated field experts in all areas of the world to support the products we sell.



Product Capabilities

Graco has a broad range of products to provide solutions that meet your needs. Our products are engineered and tested to perform in the harshest environments so you can be certain your equipment is protected and working at peak performance.

Contact us today!

Call **800-533-9655** to speak with a Graco representative,
or visit www.graco.com for more information.

