

# User Manual

AirWave Pro

**LANGSDOM**

Open-ended Sports Headphone

We appreciate you for purchasing the Langsdom AirWave Pro Open-ended Sports Headphone, the following instructions will guide you to use it easily.

## Wearing

Hang the headphone on the auricle, align the sound holes with the ear canal and adjust to wearing comfort angle.

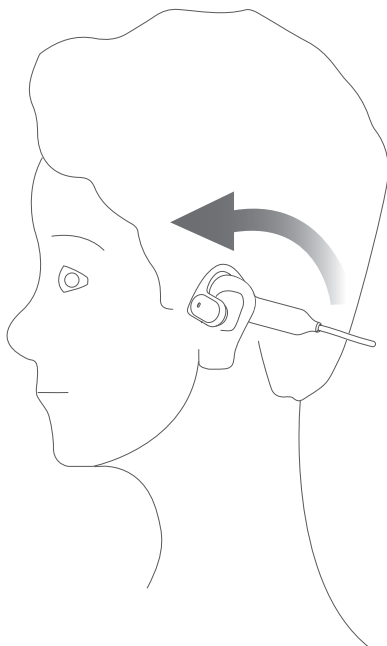

## Accessories



User Manual

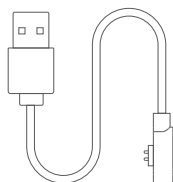

Charging Cable



Qualified Certificate

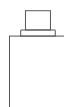

OTG Port

# Diagram

## Headphone

- ① Charging port
- ② Indicator light
- ③ Multifunction button
- ④ Volume down button
- ⑤ Volume up button
- ⑥ Microphone

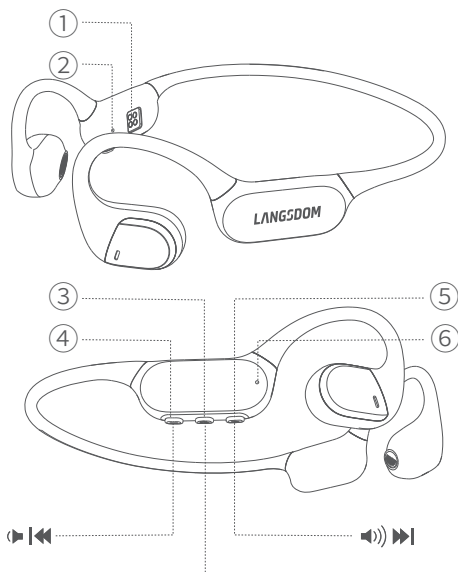

## Multifunction button

Play/Pause Music x1

Answer/Hang Up x1

Switch Bluetooth/Mp3 X2

In MP3 mode, switch sequential play or random play (boot default is sequential play)

Long press about one second to wake up voice assistant

Long press about 2 seconds to reject call

X1 ►|| ◀▶  
2X [Bluetooth icon] / MP3 X3 [Sequential play icon] [Random play icon] 1S [Voice assistant icon] 2S [Reject call icon]

## Volume down button

Volume down x 1

Long press 2S: Previous song

## Volume up button

Volume up x 1

Long press 2S: Next song

## Manually On/Off

1. When the headphone is off, long press the multifunction button about 2 seconds to power on.
2. When the headphone is on, long press the multifunction button about 5 seconds to power off.

## Pairing

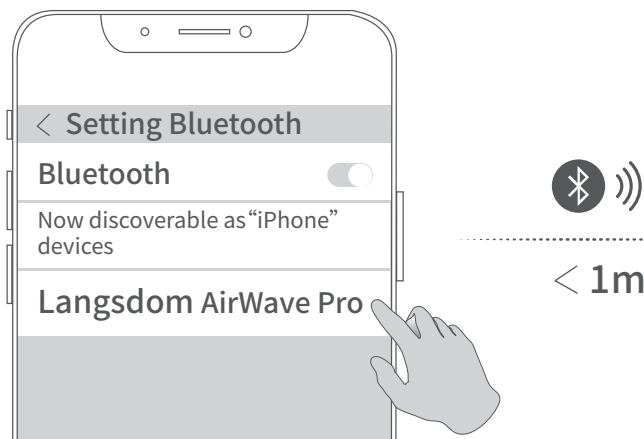

## How to pair

When the Bluetooth is paired for the first time, long press the multifunction button about 2 seconds, the headphone will automatically turn on the Bluetooth function after the blue light is on for about 1 second and the red and blue lights flash alternately. Then search for Bluetooth devices, select the "Langsdom AirWave Pro" to pair.

## Auto Pairing

1. After power on, the headphone will automatically connect back to the last Bluetooth device within about 5 minutes, otherwise power off automatically.
2. When being disconnected from the device beyond the effective distance, the headphone will automatically reconnect after returning to the effective distance within 5 minutes.

## Reset the pairing

When the headphone is off, press and hold for 10 seconds to power on. After the voice prompt, the headphone clears the pairing information and power up. Then, the headphone is powered on again and enters the pairing state again.

## Extended Link

1. Disconnect the headphone from device A after it connected.
2. Turn on the Bluetooth of device B, search for "Langsdom AirWave Pro" and select to connect.
3. Turn on the Bluetooth of device A and select "Langsdom AirWave Pro" to connect.

## Charging the headphone:

The headphone's red light is on———— charging

The headphone's blue light is on———— fully charged

The headphone is fully charged about 1 hour

※ The headphone is off while charging.

## Warning

1. Do not listen for a long time at a high volume level, preventing injury to hearing.
  2. The headphone only can be charged with 5V charger, using a fast charger that more than 5V or charger with 5V more than 1.5A will cause overheat or fire.
  3. Do not expose the headphone to high temperature or expose it to sunlight for a long time.
  4. The storage temperature of the headphone is from 10°C to 30°C.
  5. The operating ambient temperature for earphone is from -20°C to 60°C.
  6. Please fully charge the headphone after a long-term placement, and ensure to charge every 3 months.
- ※ It is recommended that new headphone be fully charged before use.

# Product Parameters

## EN

Model: AirWave Pro

BT Version: V5.4

Charging Voltage: DC5V

Battery Capacity: 170mAh

BT Frequency Range: 2.402-2.480GHz

Audio Frequency : 20Hz-20KHz

Speakers Size:  $\Phi 18 \times 11\text{mm}$

Impedance:  $16\Omega \pm 15\%$

Transmission Range: 10m

Sensitivity:  $95\text{dB} \pm 3\text{dB}$

Play Time: About 17.5 hours

Headphone's Charging Time: About 1 hour

## PT

Modelo: AirWave Pro

Versão Bluetooth: V5.4

Tensão de Entrada: DC5V

Capacidade da Bateria: 170mAh

Frequência de Transmissão: 2.402-2.480GHz

Frequência de Áudio: 20Hz-20KHz

Alto-falante:  $\Phi 18 \times 11\text{mm}$

Impedância:  $16\Omega \pm 15\%$

Alcance de Transmissão: 10m

Sensibilidade:  $95\text{dB} \pm 3\text{dB}$

Tempo de Jogo: Cerca de 17.5 horas

Tempo de Carregamento do Fone de Ouvido:

Cerca de 1 hora

**FR**

Modèle: AirWave Pro

BT version: V5.4

Tension D'entrée: DC5V

Capacité de La Batterie: 170mAh

Fréquence de Transmission: 2.402-2.480GHz

Fréquence Audio: 20Hz-20KHz

Haut-parleur:  $\Phi 18 \times 11\text{mm}$

Impédance:  $16\Omega \pm 15\%$

Portée de Transmission: 10m

Sensibilité:  $95\text{dB} \pm 3\text{dB}$

Temps de Jeu: Environ 17.5 heures

Temps de Charge du Casque: Environ 1 heure

The magnetic charging cable is the data cable, you can directly access the computer, or use the OTG adapter to transfer the desired music. Acceptable music formats: MP3, WMA, WAV, APE, FLAC.

It is not recommended to import excessively large audio files.





# FCC

## FCC ID: 2AZDD-AirWave Pro

### FCC Statement

This equipment has been tested and found to comply with the limits for a Class B digital device, pursuant to part 15 of the FCC Rules. These limits are designed to provide reasonable protection against harmful interference in a residential installation. This equipment generates, uses and can radiate radio frequency energy and, if not installed and used in accordance with the instructions, may cause harmful interference to radio communications. However, there is no guarantee that interference will not occur in a particular installation. If this equipment does cause harmful interference to radio or television reception, which can be determined by turning the equipment off and on, the users are encouraged to try to correct the interference by one or more of the following measures.

- Reorient or separation the receiving antenna.
- Increase the separation between the equipment and receiver.
- Connect the equipment into an outlet on a circuit different from that to which the receiver is connected.
- Consult the dealer or an experienced radio/TV technician for help.

Any change or modifications not expressly approved by the party responsible for compliance could void the user's authority to operate the equipment. This device complies with Part 15 of the FCC Rules. Operation is subject to the following two conditions:

- (1) This device may not cause harmful interference, and
- (2) This device must accept any interference received, including interference that may cause undesired operation.

The device has been evaluated to meet general RF exposure requirement. The device can be used in portable exposure condition without restriction.