

Pallet Truck Steer Wheel Replacement Guide

Our instructions will guide you through all the steps required when it comes to pallet truck front wheel replacement:

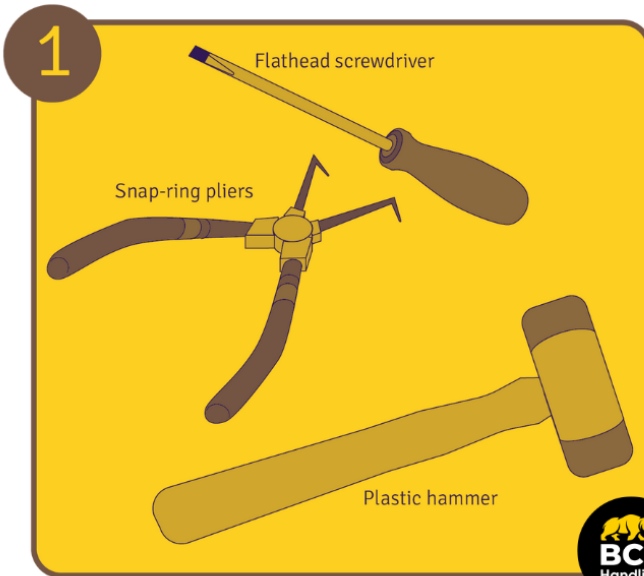

The right accessories

You will need a small flathead screwdriver, snap-ring pliers and a plastic hammer.

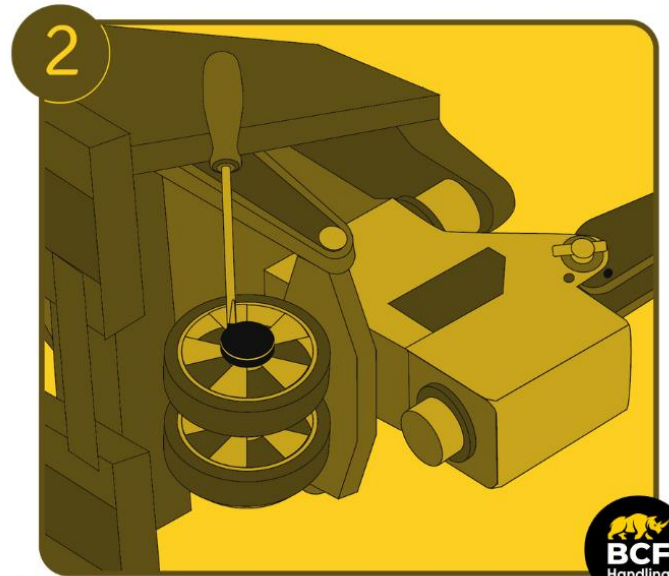

The right position

Carefully lay the pallet truck on its side. Remove the cap on the steering wheel using the flathead screwdriver.

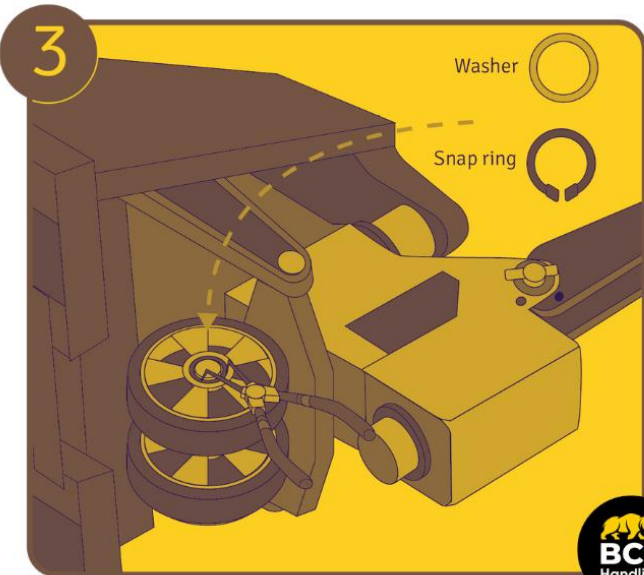

Remove the snap ring

Remove the snap ring with the pliers and remove the washer.

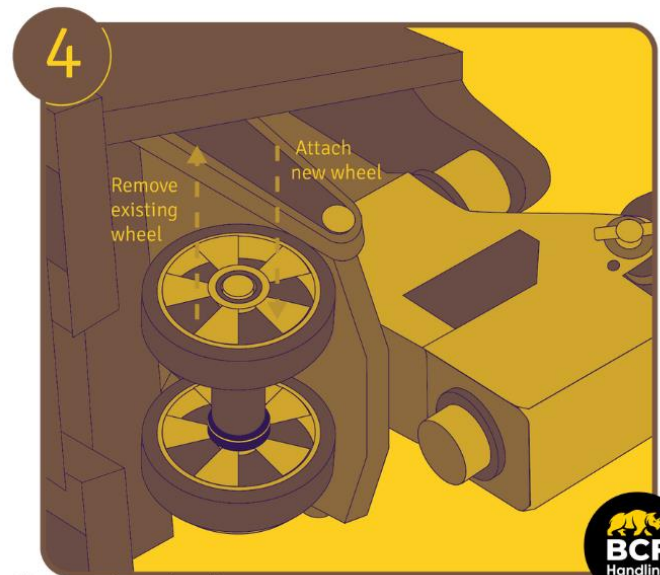

Change the wheel

Remove the wheel from its axle and replace it with the new steering wheel. Don't forget to put the washer (spacer) back in place.



+44 (0)28 9344 0526

info@bcfhandling.com

bcfhandling.com



Visit Our Online
Webshop Now!

www.bcfhandling.com

Pallet Truck Steer Wheel Replacement Guide

5

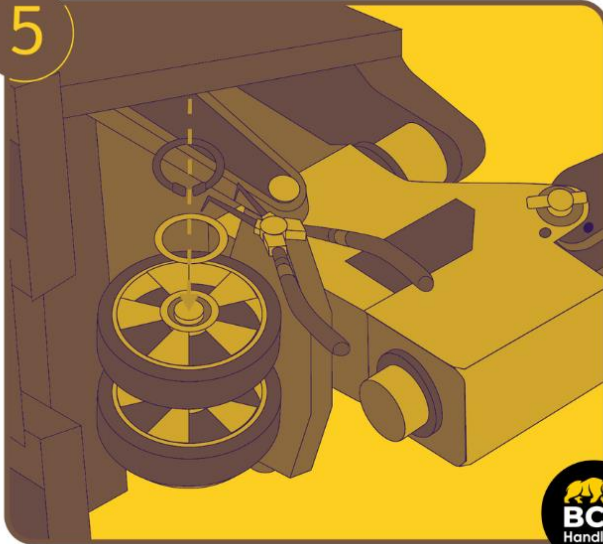

Secure the wheel

Use pliers to secure the wheel with the snap ring. Make sure that the snap ring is seated correctly in the groove of the axle.

6

Plastic hammer

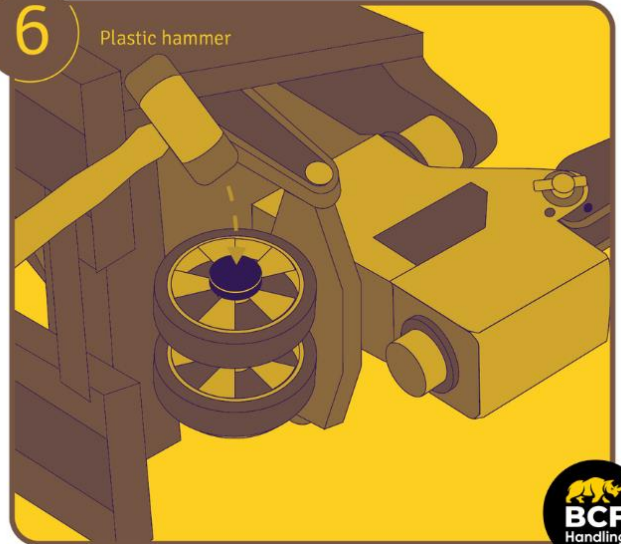

Attach the cap

Place the cap back on the steering wheel. Carefully secure the cap by hitting it with the plastic hammer.

7

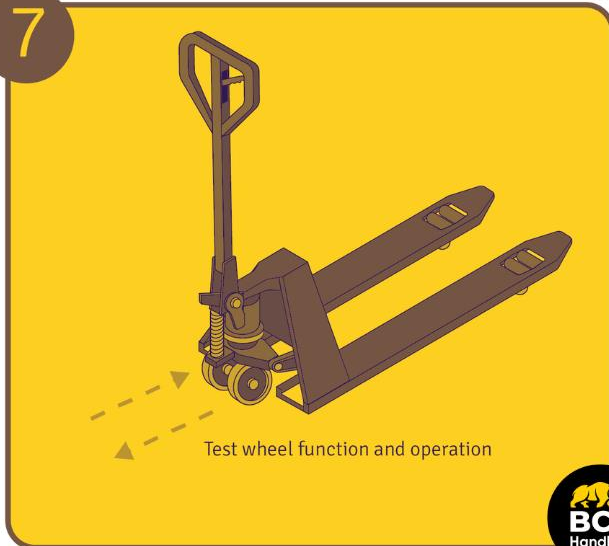

Check all functions

Ensure the steering wheel works properly: does it run smoothly without catching or dragging? Then you have done everything correctly.



+44 (0)28 9344 0526



info@bcfhandling.com



bcfhandling.com



Visit Our Online
Webshop Now!

www.bcfhandling.com

