

DTK-KEY

DTK-KEY is a flush-mounting detector in **KEYSTONE module**, dual technology in **24.125GHz k band**. DTK-KEY sensor to be installed on any residential/commercial series Keystone adapter (to be purchased separately).

It has an **INFRARED** range of about 6-8mt. adjustable with trimmer and a coverage of 120°. It has a **MICROWAVE** range of about 10-12mt. adjustable with trimmer and a coverage of 90°.

Main functions :

AND: the alarm is activated if the microwave and infrared detect movement.

OR: the alarm is activated only if one of them detects it.

INTELLIGENT OR: if one of the two sensors (microwave-infrared) provides 10 detections in 30", it generates an alarm even if configured in AND. Activate only in stable environmental conditions!

Technical features:

12VDC power supply

Absorption in idle status: about 27mA

Absorption in alarm status: max 36mA.

Operating temperature: -20°C +50°C.

Movement alarm discrimination controlled by integrated microprocessor.

High immunity to microphone effect and transients.

MW-PORT TRIMMER : to adjust the microwave range.

TRIMMER MW-DLY : to adjust the microwave delay.

IR-PORT TRIMMER : to adjust the infrared range

Microwave EIRP = 15dBm output power

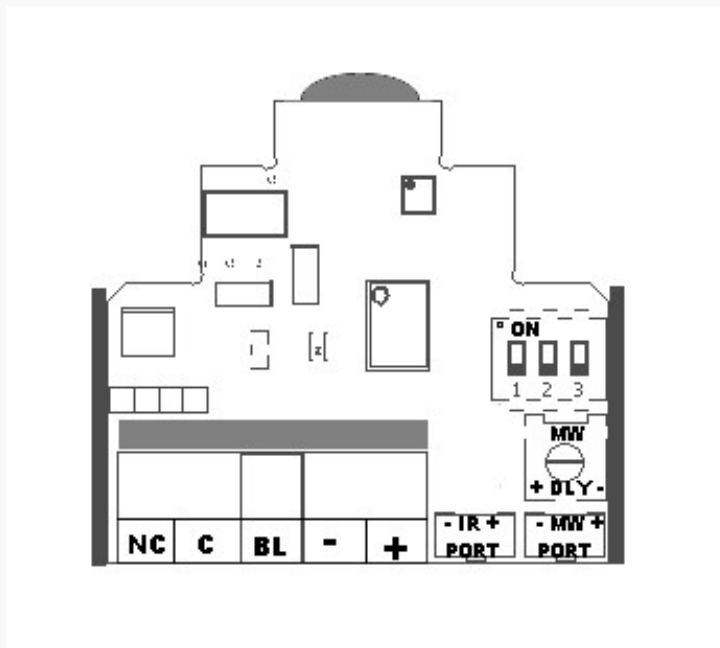

CONNECTIONS:

NC C= Alarm contact NC

BL = Microwave emission block input. A positive 12v at the BL input activates the GREEN LINE function (no microwave emission)

- = Negative 12 V power supply

+ = Positive 12 V power supply

INFRARED COVERAGE DIAGRAM:

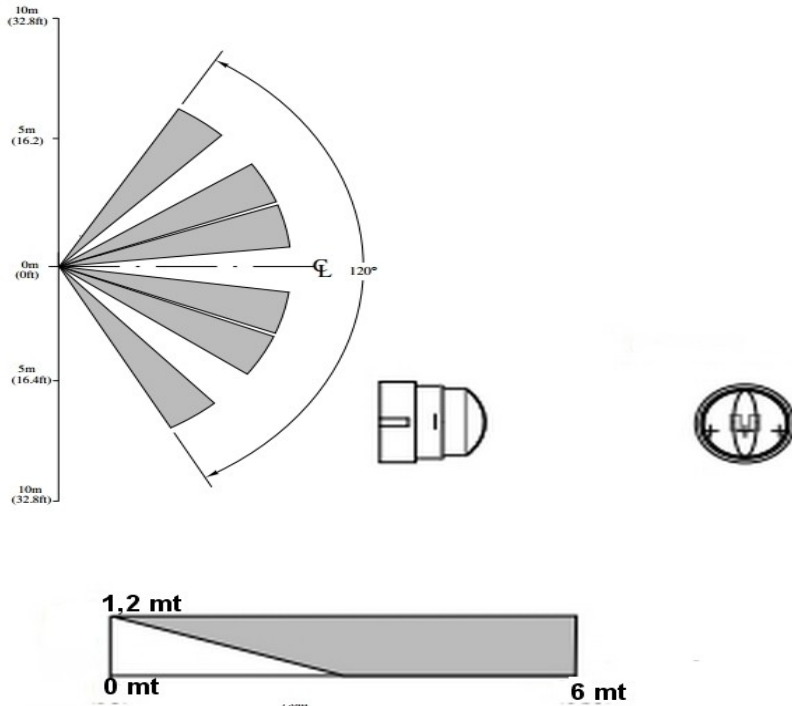

MICROWAVE COVERAGE DIAGRAM:



system pattern (-10dB)	azimuth	system_az	43	°
	elevation	system_el	116	°

SETTINGS:

TRIMMER IR-PORT	INFRARED GAIN SETTING (red led)	
TRIMMER MW-PORT	MICROWAVE RANGE SETTING (blue led)	
TRIMMER MW-DLY	MICROWAVE HALTING DELAY SETTING	
DIP-SWITCH 1	ON = LED ON (DEFAULT)	OFF = LED OFF
DIP-SWITCH 2	ON = OR OPERATION	OFF = AND OPERATION (DEFAULT)
DIP-SWITCH 3	ON = AUTOMATIC OR FUNCTION DISABLED (DEFAULT)	OFF = AUTOMATIC OR FUNCTION ENABLED

SIMA ELETTRONICA
 VIA A. PIO 1 POZZUOLI (NA) ITALY
 TEL. 081 866 24 50 SALES OFFICE FAX 081 804 10 49
 TOLL FREE NUMBER 800 68 86 70 TECHNICAL SUPPORT
info@simaelettronica.com
<http://www.simaelettronica.com>

