

ENGLISH

iCare PATIENT2
iCare EXPORT



Quick Guide

iCare PATIENT2 & EXPORT
Quick Guide for
mobile phones and PC

Rx Only (U.S.)

icare



Read this Quick Guide before using iCare PATIENT2. Follow the instructions step by step.

If you need help in using the PATIENT2 app, contact your healthcare professional or iCare distributor.

PATIENT2 Quick Guide for Android

Step

Page

1	Start using the iCare PATIENT2 app	4
2	Pair the tonometer via Bluetooth and transfer measurements	5
3	Pair the tonometer via USB and transfer measurements	7
4	Log in	8
5	Graph and table functionality	9

PATIENT2 Quick Guide for iOS

Step

Page

1	Start using the iCare PATIENT2 app	12
2	Pair the tonometer with your mobile device	13
3	Transfer measurements and Log in	15
4	Graph and table functionality	17
5	Turn on Bluetooth on the Tonometer	19

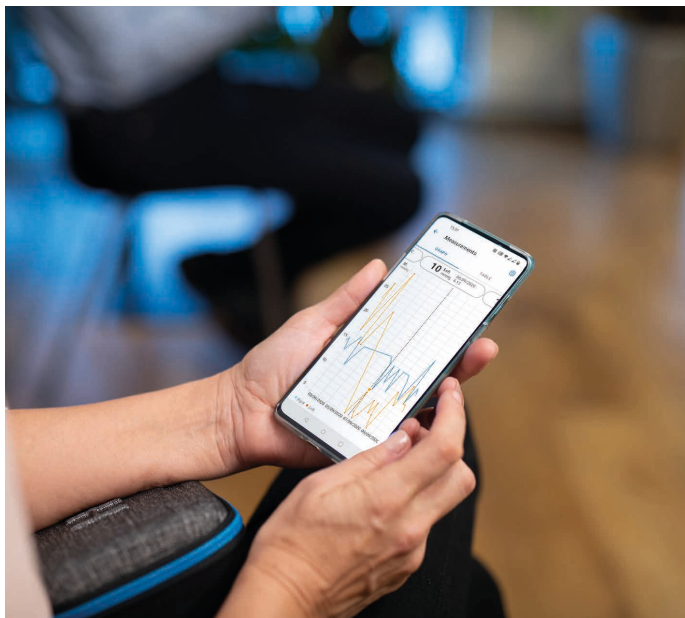

PATIENT2 Quick Guide for Android

Patients can use iCare PATIENT2 for viewing their IOP measurement results and for transferring results to iCare CLINIC or iCare CLOUD. Healthcare professionals can only use the iCare PATIENT2 app for transferring IOP measurement results to iCare CLINIC.



Make sure that the mobile device with the iCare PATIENT2 app installed is set to the correct time and date.



Before taking measurements, update the tonometer's time to your local time, manually from the tonometer's settings or automatically by connecting the tonometer to the iCare PATIENT2 application or to the iCare EXPORT software.

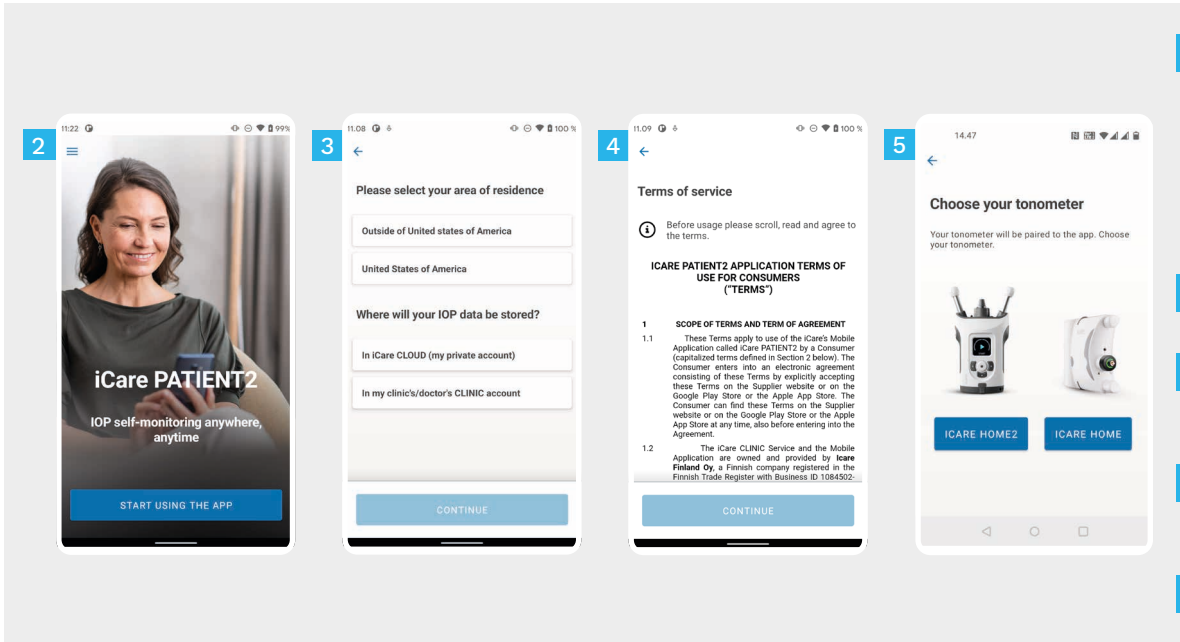

1 Download the iCare PATIENT2 app from Google Play Store.



2 Press **START USING THE APP** button.

3 Select your area of residence. Select where your IOP data will be stored.

4 Scroll down and read through the Terms of service and agree to them.

5 Choose your tonometer model.

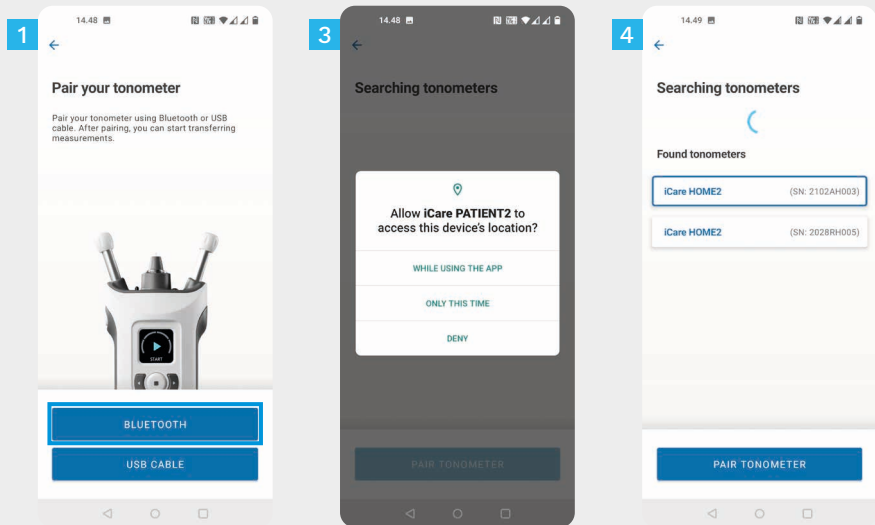

- 1 Select the pairing method.
- 2 Go to your smart phone's settings and switch Bluetooth on.
- 3 Tonometer's bluetooth is on by default. If it's not, see Chapter "Switch on Bluetooth on the Tonometer" for instruction. Allow the prompted requests on your mobile device to continue pairing.
- 4 Tap on the tonometer with the serial number of your tonometer. Tap **PAIR TONOMETER**.

NOTE! If you have previously paired your tonometer via USB cable and want to use Bluetooth, you will need to pair it again.

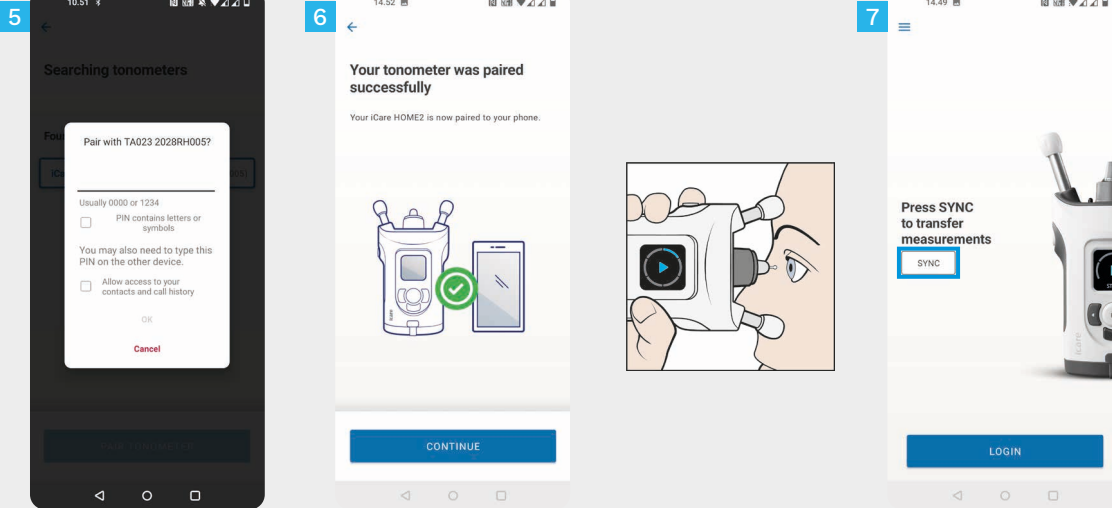

- 5 Enter the PIN code shown on the tonometer. Tap **OK**.
- 6 The tonometer is now paired successfully. Tap **CONTINUE**.
- 7 You are now ready to start using the app. After measuring your IOP, tap **SYNC** to transfer the measurement results to the cloud.

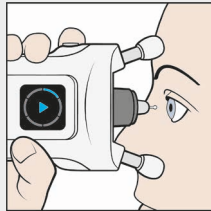

- 1 Tap **USB CABLE**.
- 2 After taking measurements, connect your tonometer to your phone using the USB cable provided. Use the provided adapter if needed.
- 3 The measurement data is transferred automatically.
- 4 Disconnect the USB cable after the measurement transfer is complete.

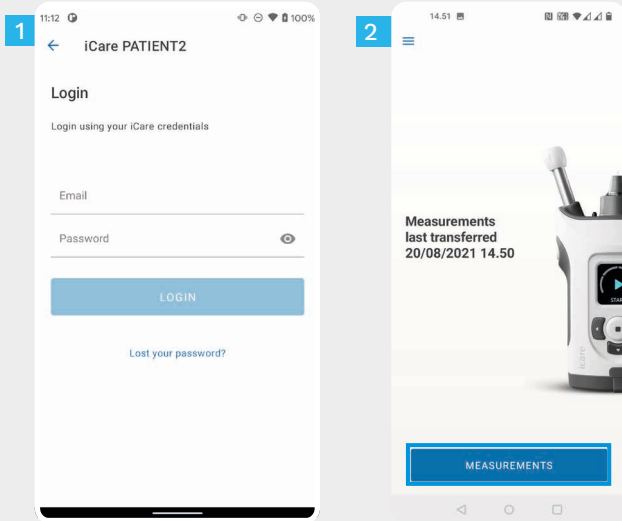

- 1 Log in with your iCare credentials.
- 2 Tap **MEASUREMENTS** to see your IOP measurement results.

NOTE! For information on how to obtain iCare credentials, read the Getting Started Guide in the tonometer's carrying case.

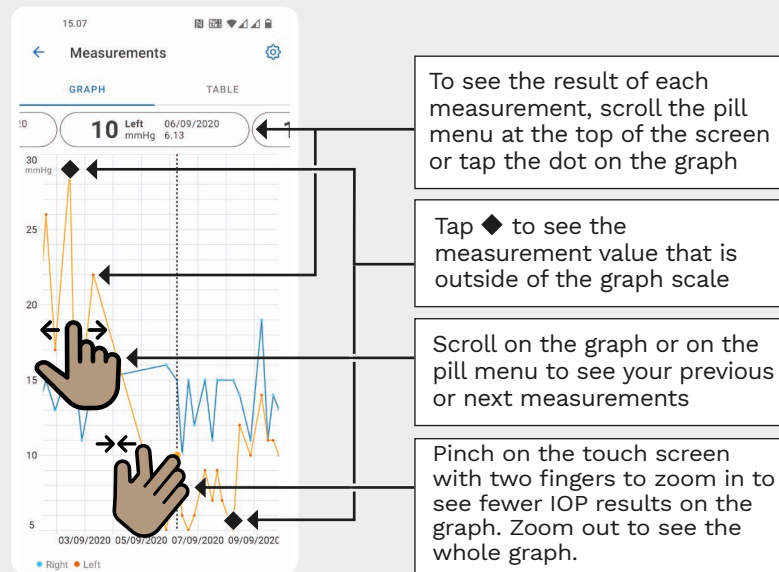
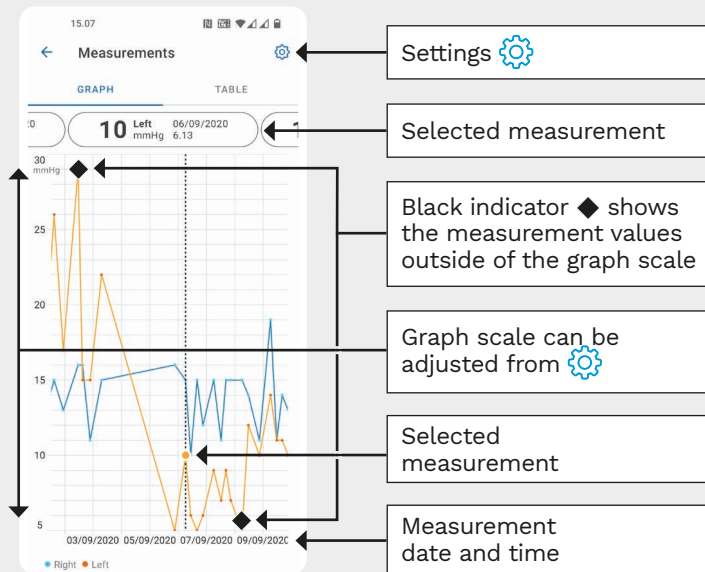

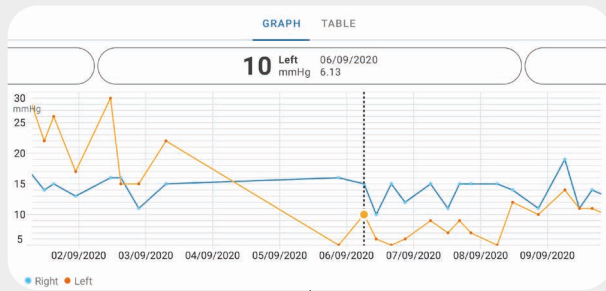

Rotate to view the graph in landscape orientation

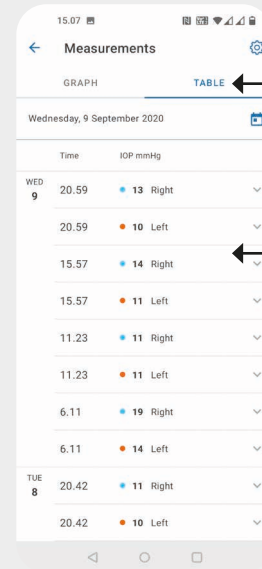

Tap **TABLE** to view measurements in list format

Select date from

Scroll the list

Tap to view measurement quality

PATIENT2 Quick Guide for iOS

Patients can use iCare PATIENT2 for viewing their IOP measurement results and for transferring results to iCare CLINIC or iCare CLOUD. Healthcare professionals can only use the iCare PATIENT2 app for transferring IOP measurement results to iCare CLINIC.



Make sure that the mobile device with the iCare PATIENT2 app installed is set to the correct time and date.



Before taking measurements, update the tonometer's time to your local time, manually from the tonometer's settings or automatically by connecting the tonometer to the iCare PATIENT2 application or to the iCare EXPORT software.

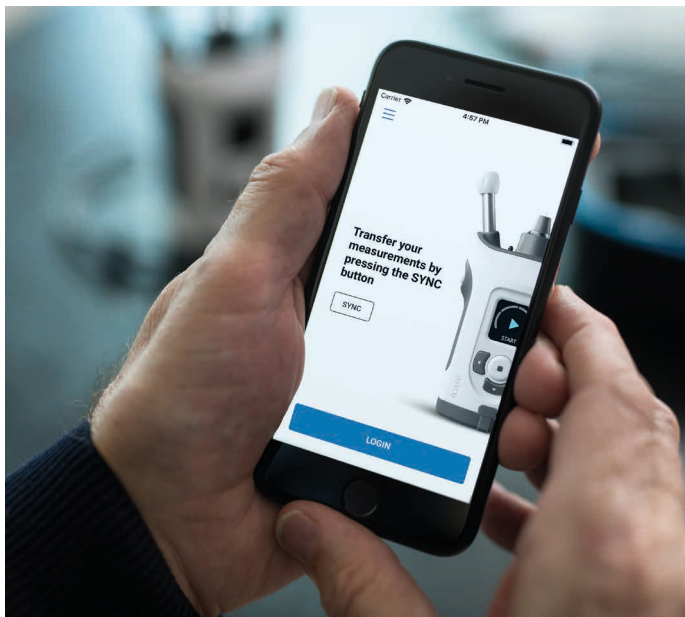

2

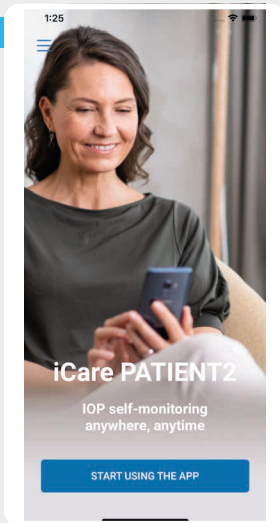

3

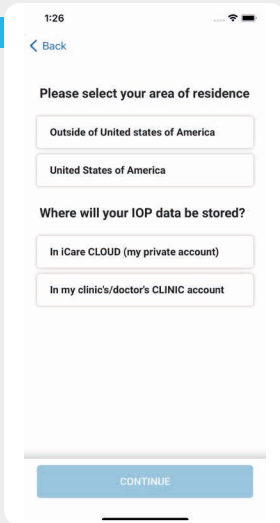

4

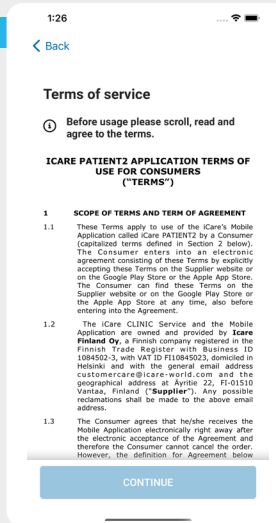

1

Download the iCare PATIENT2 app from App Store.



2

Press “START USING THE APP” button.

3

Select your area of residence. Select where your IOP data will be stored.

4

Scroll down and read through the Terms of service and agree to them.

3a

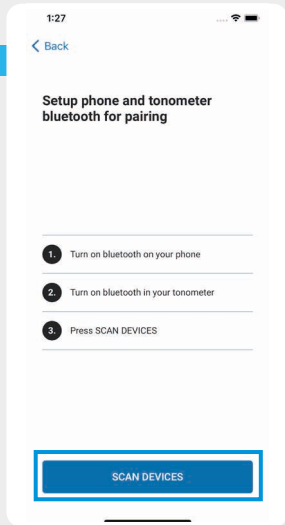

3b

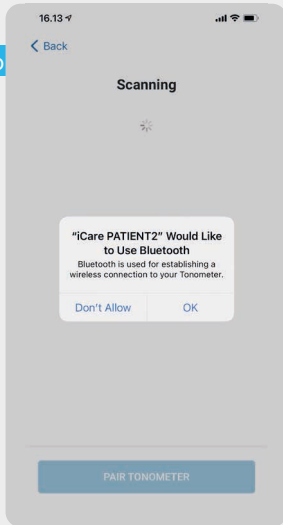

4

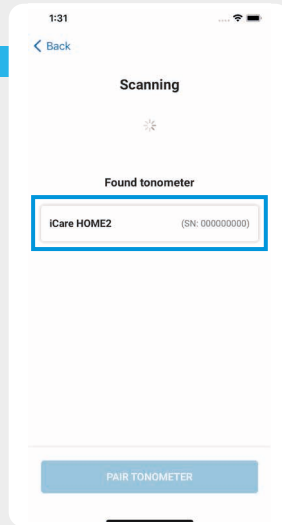

1

Tonometer's Bluetooth is on by default. If it's not, see Chapter "Switch on Bluetooth on the Tonometer" for instructions.

2

Go to your mobile device's settings and switch Bluetooth on.

3

Tap **SCAN DEVICES**. If the app asks for a permission to use Bluetooth, tap OK.

4

Tap on the tonometer with the serial number.

5

Tap **PAIR TONOMETER**.

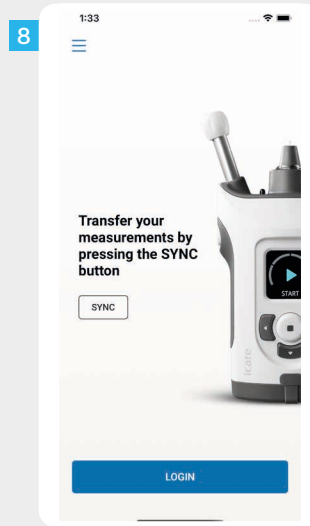
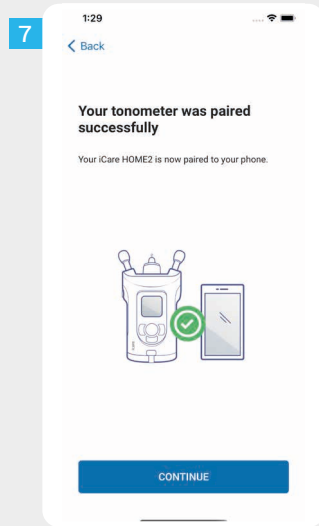
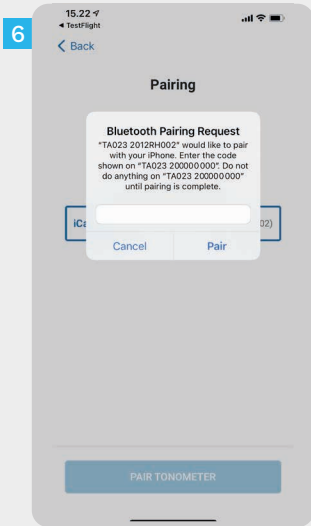

6 Enter the PIN code shown on the tonometer. Tap **Pair**.

7 The tonometer is now paired successfully. Tap **CONTINUE**.

8 You are now ready to start using the app.

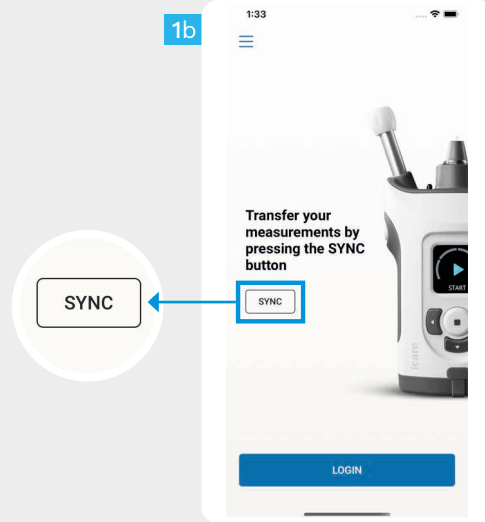
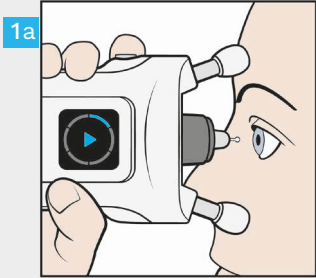

- 1 After measuring your IOP, tap **SYNC** to transfer the measurement results to the cloud.

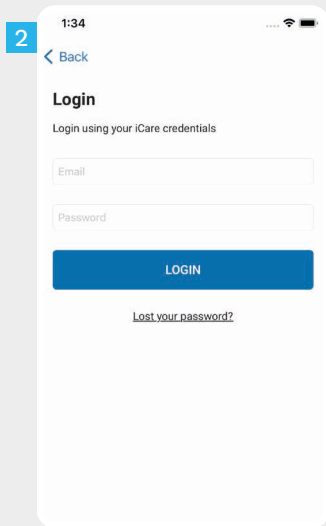

2 Log in with your iCare credentials.

3 Tap **MEASUREMENTS** to see your IOP measurement history.

NOTE! For information on how to obtain iCare credentials, read the Getting Started Guide in the tonometer's carrying case.

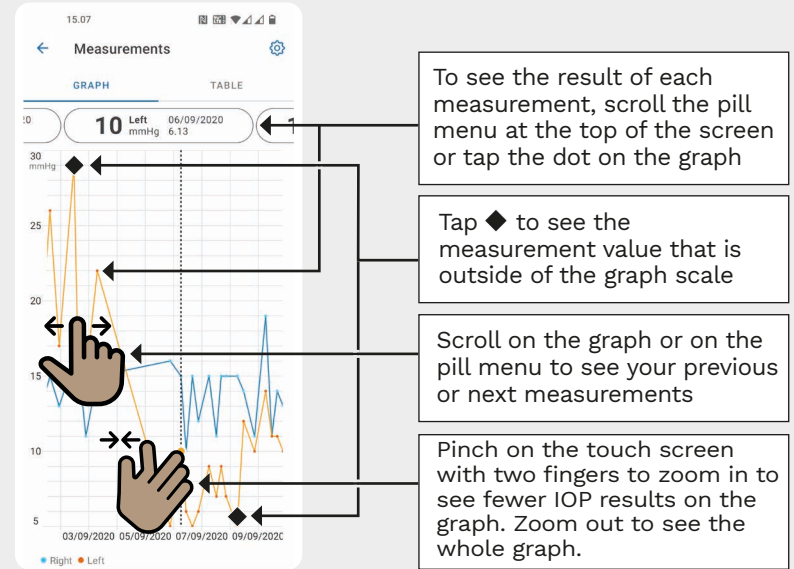
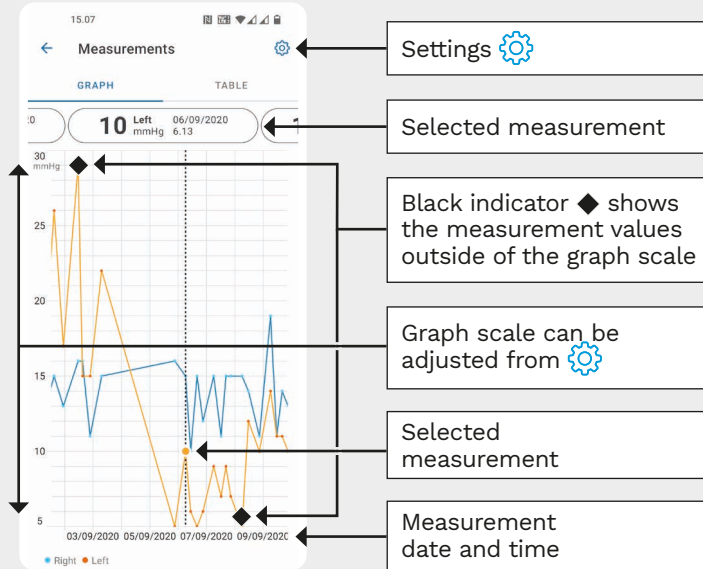

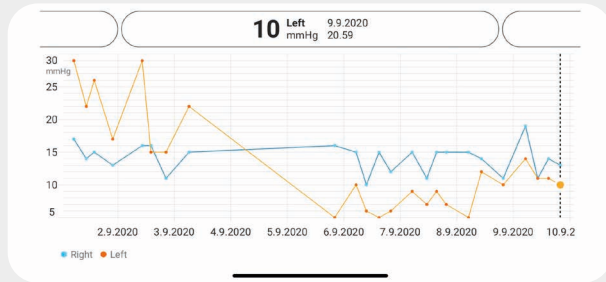

Rotate to view the graph in landscape orientation

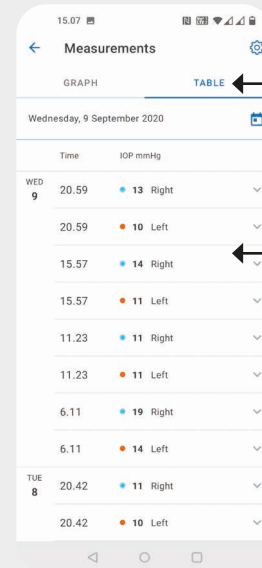

Tap **TABLE** to view measurements in list format

Select date from







Scroll the list

Tap to view measurement quality



Hold the tonometer vertically for these instructions.

The Bluetooth on your tonometer is activated by default, as a factory setting. To check if the Bluetooth is activated on the tonometer or to turn it on, follow the instructions below.

- 1 Press  to switch the tonometer on.
- 2 Press  until you see **SETTINGS** on the tonometer screen, and press .
- 3 If Bluetooth is off, Press  to enter the **BLUETOOTH** menu.
- 4 Press  until you see **TURN ON**, and press .



iCare EXPORT

Quick Guide

icare

icare EXPORT

Quick Guide (For Windows only)

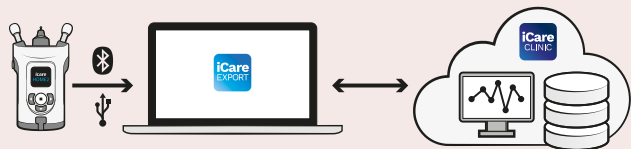

Read this Quick Guide before using iCare EXPORT. Follow the instructions step by step.

If you need help in using the EXPORT software, contact your healthcare professional or iCare distributor.

EXPORT Quick Guide

Step

Page

- | | | |
|----------|---|----|
| 1 | Download and Set up iCare EXPORT | 20 |
| 2 | Connect and send measurements using USB cable | 22 |
| 3 | Connect and send measurements via Bluetooth | 23 |

Patients can store their IOP measurement data to a private account in the iCare CLOUD, if their tonometer is not registered to a healthcare professional's iCare CLINIC account. For information on how to set up a private account, read the Getting Started Guide in the tonometer's carrying case.



Make sure that the computer time and date is correct when using with iCare EXPORT.



Before taking measurements, update the tonometer's time to your local time manually from the tonometer's settings, or automatically by connecting the tonometer to the iCare PATIENT2 application or to the iCare EXPORT software.

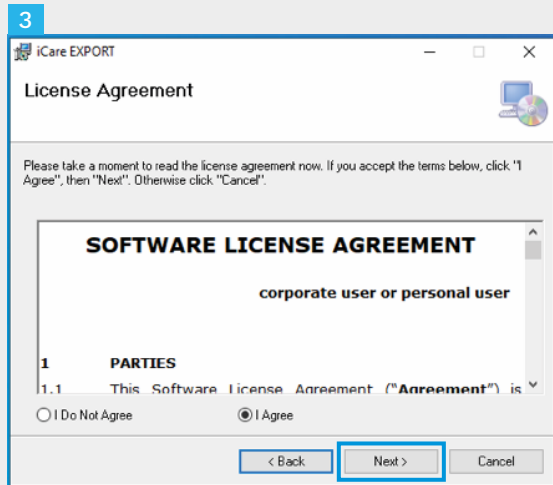
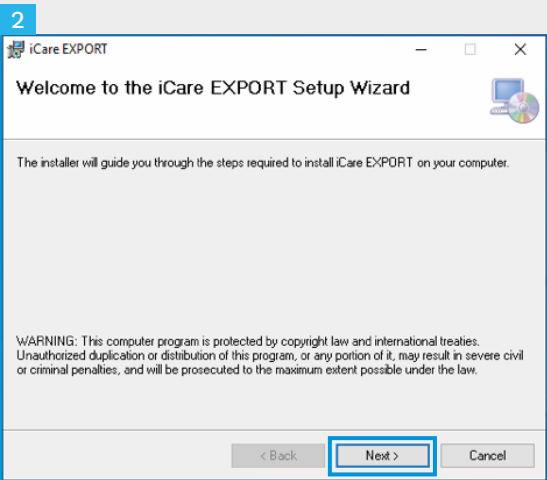

1 Download iCare EXPORT from iCare CLOUD.

Double click on the iCare EXPORT Setup.exe file.

2 Read the instructions on the Setup Wizard and click **Next**.

3 Accept the software license agreement by selecting **I Agree**. To continue, click **Next** until the installation is completed.

4

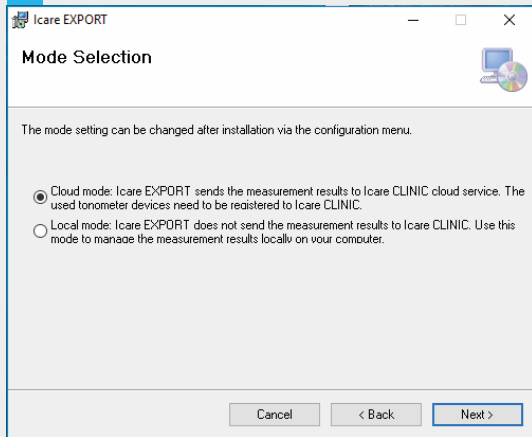

6



7

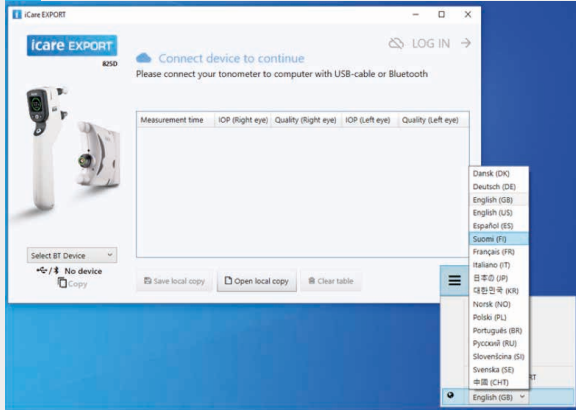

4

Choose **Cloud mode** to store measurement results in iCare CLINIC or CLOUD. Choose **Local mode** to store measurements on your PC.

5

When installation is complete, click **Close**.

6

Double click the **iCare EXPORT** icon on the desktop or find the program under **Windows Start** menu, under **icare** folder and start the program.

7

You can select the language from the right bottom menu.

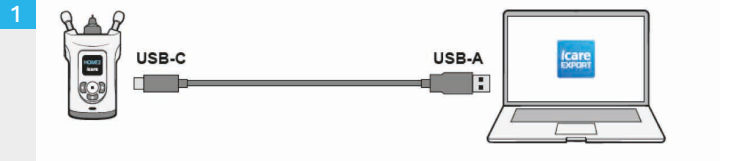

2

icare EXPORT

Measurements saved!

All measurements were successfully posted (Organization 1 in London Demo). The measurements were cleared from the device.

Measurement time	IOP (Right eye)	Quality (Right eye)	IOP (Left eye)	Quality (Left eye)
1/7/2021 10:04:17 AM			16	GOOD
1/7/2021 10:04:06 AM	14	EXCELLENT		
1/7/2021 10:03:59 AM			14	GOOD
1/7/2021 10:03:52 AM	14	GOOD		

Select BT Device

2028RH005 S/N

Copy

Save local copy Open local copy Clear table

1 Connect your tonometer to your PC using the USB cable provided.

2 The tonometer sends the measurement results to the server automatically.

NOTE! that once you have transferred the data, the measurement results are automatically removed from the tonometer's memory.

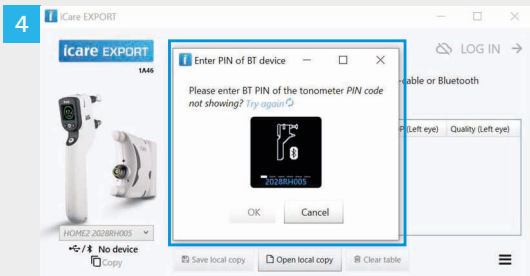
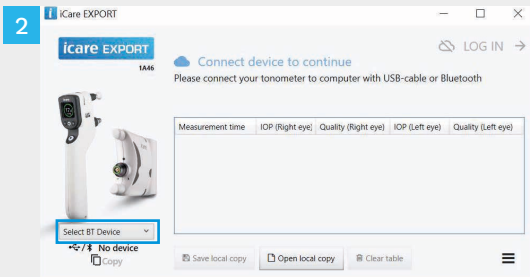

In iCare EXPORT application

For these instructions, make sure that the tonometer's and the PC's Bluetooth is on. For instructions, see chapter 5 How to switch on Bluetooth on the Tonometer.

- 1 Make sure that the tonometer is on before you connect the tonometer to iCare EXPORT.
- 2 Click **Select BT Device** on the left bottom.
- 3 Select your tonometer's serial number from the drop-down menu. You can find the serial number (SN) on the label on the back of your tonometer.
- 4 Enter the PIN code that will appear on your tonometer's screen and press **OK**

1 **icare EXPORT**

icare EXPORT 1A46 LOG IN →

 **Measurements saved!**
All measurements were successfully posted (Organization 1 in London Demo) The measurements were cleared from the device.

Measurement time	IOP (Right eye)	Quality (Right eye)	IOP (Left eye)	Quality (Left eye)
1/7/2021 10:04:17 AM			16	GOOD
1/7/2021 10:04:06 AM	14	EXCELLENT		
1/7/2021 10:03:59 AM			14	GOOD
1/7/2021 10:03:52 AM	14	GOOD		

Select BT Device
2028RH005 S/N Copy

Save local copy Open local copy Clear table ☰

1 The tonometer connects to the iCare EXPORT application and sends the measurement results to the iCare CLOUD or your healthcare professional's iCare CLINIC account automatically.

NOTE! *that once you have transferred the data, the measurement results are automatically removed from the tonometer's memory.*



Icare Finland Oy

Äyritie 22
01510 Vantaa, Finland
Ph. +358 9 8775 1150
info@icare-world.com

Icare USA, Inc.

4700 Falls of Neuse Rd. Ste 245
Raleigh, NC. 27609
Ph. +1 888.422.7313 | Fax +1 877.477.5485
infoUSA@icare-world.com



For further information,
read the instruction manual.



www.icare-world.com

icare

iCare is a registered trademark of Icare Finland Oy, Centervue S.p.A., Icare Finland Oy, and Icare USA Inc. are parts of Revenio Group and represent the brand iCare. Not all products, services or offers referenced in this brochure are approved or offered in every market and approved labeling and instructions may vary from one country to another. Product specifications are subject to change in design and scope of delivery and as a result of ongoing technical developments.