

WARING COMMERCIAL

Pasta Cooker / Rethermalizer

WPC100

Unit Information

208volts – 60Hz – 2700watts
240volts – 60Hz – 3600watts

13.9 Quarts MAX Capacity

Reaches a rolling boil in under
25 minutes.

Cook up to 4 pounds of fresh
or frozen pasta in minutes.

036363
Round Basket
(4 come with unit)

036364
Rectangle Basket
(2 come with unit)

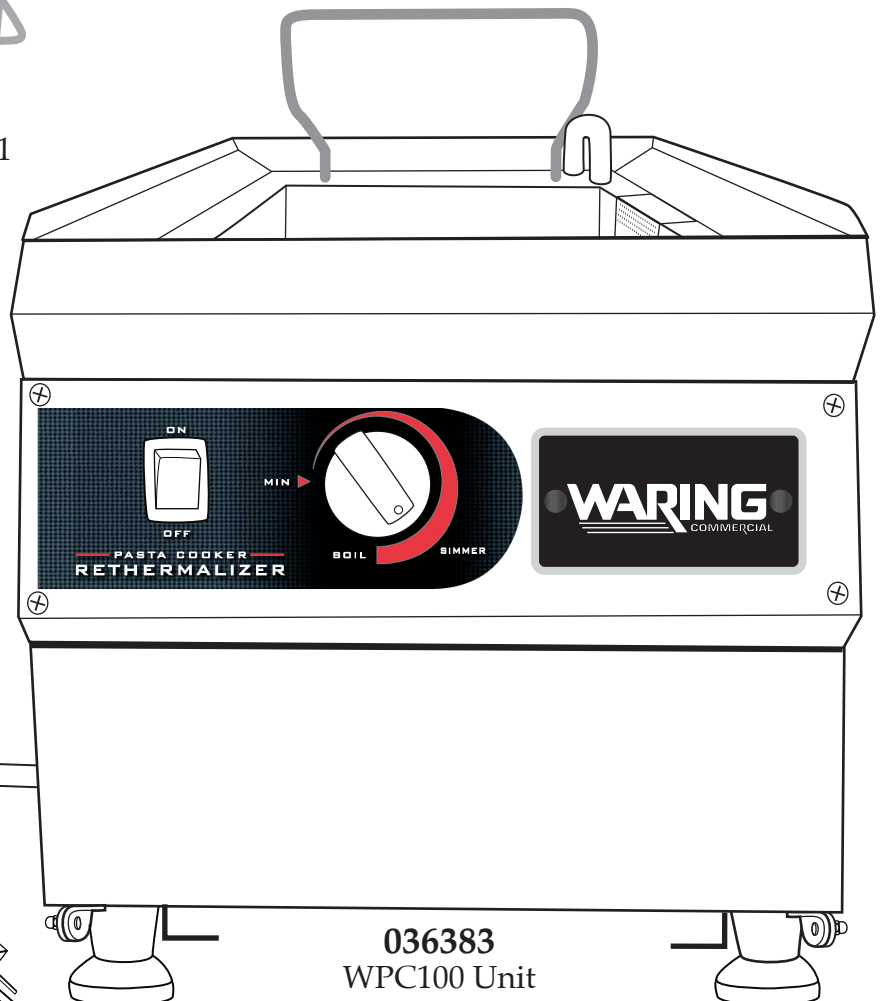
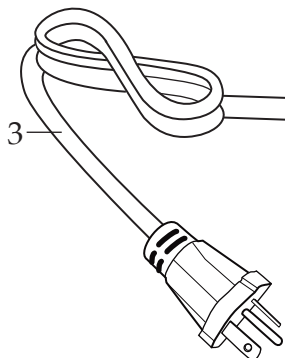
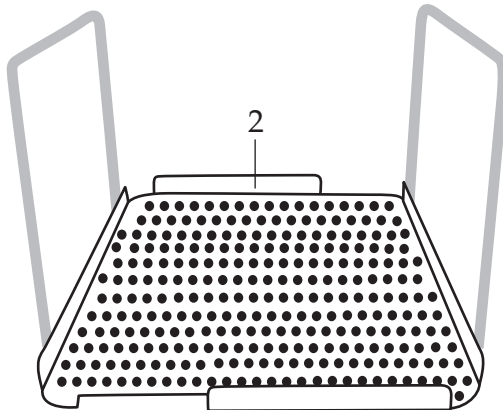
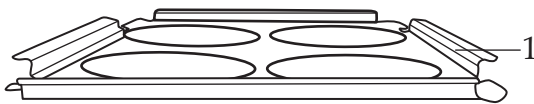
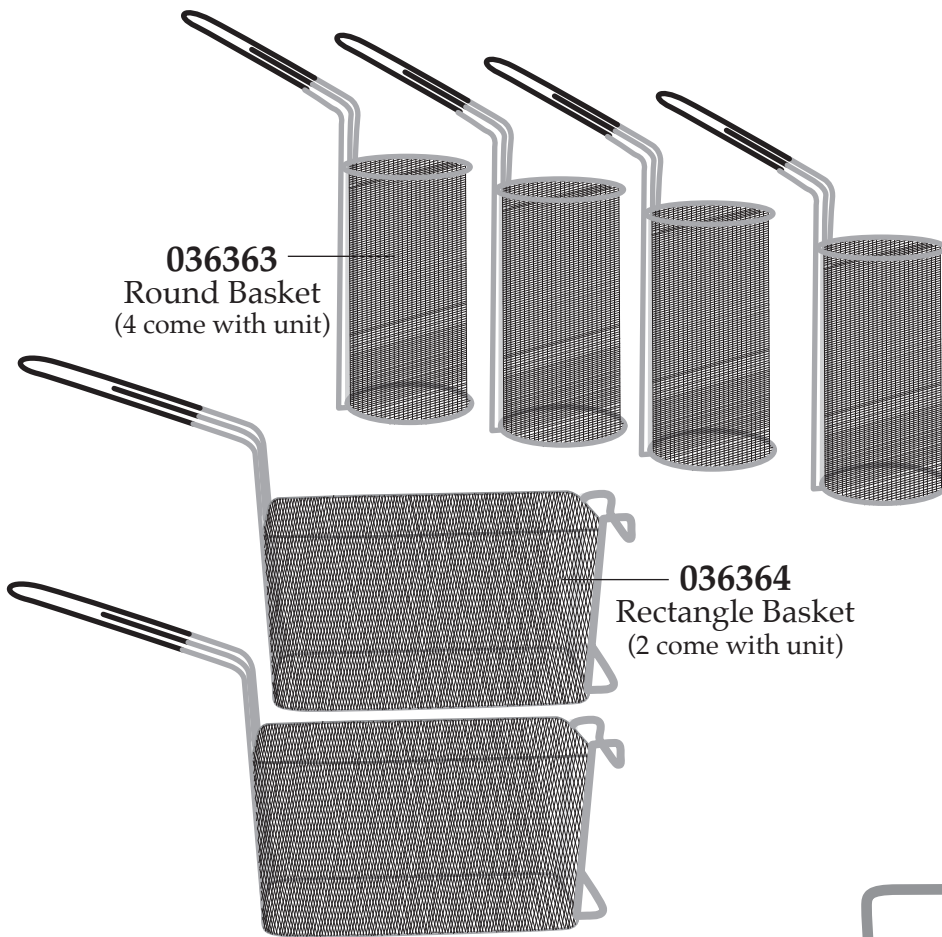

WARING COMMERCIAL cUL US LISTED 4H03
TORRINGTON, CT 06790
PASTA COOKER / RETHERMALIZER
CUSEUR À PÂTES ELECTRIQUE / RECHAUFFEUR
MODEL / MODELE: WPC100
208V 60Hz 2700W
240V 60Hz 3600W
MADE IN CHINA / FABRIQUÉ EN CHINE
APPROVED FOR COMMERCIAL USE
USAGE COMMERCIAL AUTORISÉ
DATE CODE: WVVVY

week week | year year



Base Unit Components

WPC100

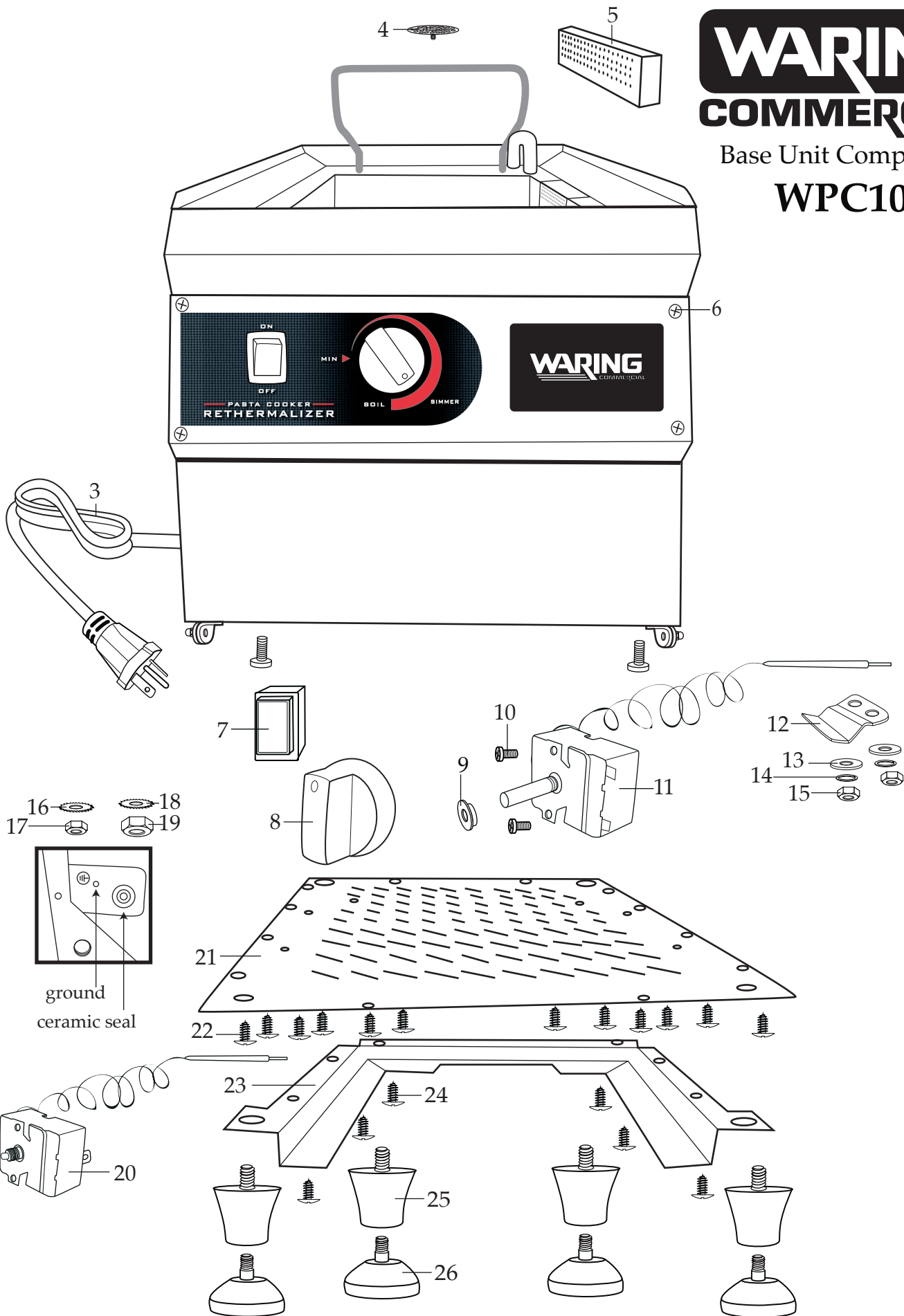

Illustration#	Part#	Description
1	036365	Round Basket Resting Support
2	036366	Basket Support
3	036367	Cord (6-20 plug type)
4	036368	Bottom Drain with Screw
5	036369	Overflow Drain
6	036370	Screw (6 required)
7	036371	Rocker Switch
8	036372	Thermostat Knob
9	036373	Seal
10	036374	Screw (2 required)
11	036384	Thermostat
12	036375	Bracket
13	029986	Washer (2 required)
14	032360	Spring Washer (2 required)
15	030534	Hex Nut (2 required)
16	029959	Lock Washer (2 required ground)
17	030534	Hex Nut (2 required ground)
18	036376	Lock Washer (ceramic seal)
19	036377	Hex Nut (ceramic seal)
20	037671	Reset Switch
21	036378	Bottom Plate
22	036379	Screw (12 required)
23	036380	Small Basket Support Storage
24	036379	Screw (6 required)
25	036381	Leg (4 required)
26	036382	Foot (4 required)

