

# WARING COMMERCIAL

## Automatic Thermal Coffee Brewer WCM60PT

### Unit Information

Warranty 2 Yr. Parts & 1 Yr. Labor  
60Hz - 1800 Watts - 120 Volts  
2 Separately Controlled PTC Warmers  
& Hot Water Faucet

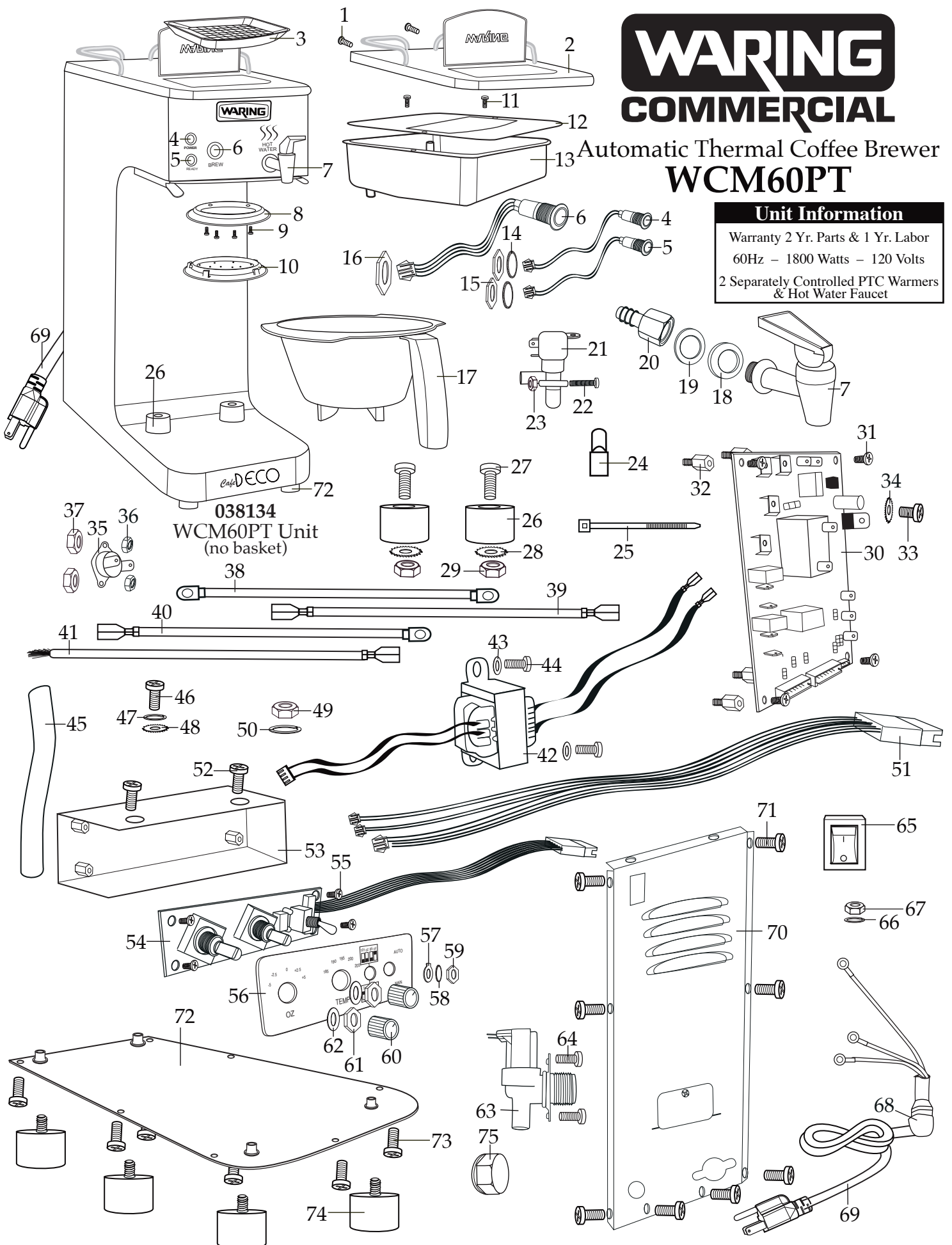

<b>Illustration#</b>	<b>Part#</b>	<b>Description</b>
1	037166	Screw (2 required)
2	038120	Top Plate
3	038073	Plastic Net
4	038112	Power On Red Light
5	038007	Ready Green Light
6	038110	Brew Light
7	037988	Tap (spigot)
8	038072	Spreader Holder
9	038076	Screw (4 required)
10	038044	Spreader
11	038076	Screw (2 required)
12	038090	Basin Cover
13	038089	Basin
14	038084	Lock Washer (power light & ready light)
15	016236	Hex Nut (power light & ready light)
16	038008	Hex Nut (brew light)
17	038018	Brew Basket
18	037990	Metal Washer
19	037989	Rubber Washer
20	037991	Tap Hose Adapter
21	037996	Brew Solenoid
22	037997	Screw (2 required)
23	037171	Hex Nut (2 required)
24	019123	Crimp Connector (2 required)
25	013731	Wire Nut (10 required)
26	038003	Rubber Stopper (2 required)
27	038004	Screw (1 for each stopper)
28	037175	Lock Washer (1 for each stopper)
29	037174	Hex Nut (1 for each stopper)
30	037987	PCB Board
31	038010	Plastic Screw (4 required)
32	038011	Plastic Connector (4 required)
33	037161	Screw (for PCB Board)

<b>Illustration#</b>	<b>Part#</b>	<b>Description</b>
34	037158	Lock Washer (for PCB Board)
35	037153	Thermal Cut Off
36	037154	Hex Nut (2 required)
37	037171	Hex Nut (2 required)
38	Leads with 2 Ring Terminals	
	038083	8.5" Yellow/Green Lead
	037973	6.75" Burgundy Lead
	037974	6.75" Blue Lead
39	Leads with 2 Regular Terminals	
	037984	12.25" Burgundy Lead
	038098	12.5" Burgundy Lead
	038097	12.5" Blue Lead
	037980	28.5" Burgundy Lead
	037981	28.5" Blue Lead
40	Leads with 1 Ring and 1 Regular Terminals	
	038077	4.75" Burgundy Lead
	037976	8.5" Yellow/Green Lead
	037979	8.75" Black Lead (2 required)
	037977	12.75" Blue Lead
41	Leads with 1 Regular Terminal ONLY	
	038099	12" Blue Lead
	038100	12" Burgundy Lead
42	037708	Transformer
43	038104	Washer (2 required)
44	037166	Screw (2 required)
45	Hoses	
	037999	2" Hose
	038106	3.75" Hose
	038000	5.25" Hose
	037771	7" Hose
	038107	9" Hose
	038108	10.25" Hose
	038070	12.5" Hose
46	037166	Screw (for ground top of unit)
47	038065	Spring Washer (for ground top of unit)
48	037158	Lock Washer (for ground top of unit)
49	038102	Hex Nut (black lead to pcb board)
50	038103	Spring Washer black lead to pcb board)
51	037992	Lead Tape with Black Sleeve
52	037166	Screw (2 required)
53	038094	Temperature Board Holder with Connectors

Illustration#	Part#	Description
54	038016	Temperature Board
55	038010	Plastic Screw (4 required)
56	038012	Temperature Board Cover
57	038093	Washer (auto - man shaft)
58	038092	Lock Washer (auto - man shaft)
59	038091	Hex Nut (auto - man shaft)
60	038013	Knob (2 required)
61	038015	Hex Nut (1 under each knob)
62	038014	Washer (1 under each knob)
63	037165	Water Fill Solenoid
64	037166	Screw (2 required)
65	038017	Rocker Switch
66	038085	Spring Washer (for ground bottom of unit)
67	037171	Hex Nut (for ground bottom of unit)
68	038101	Back Plate
69	037166	Screw (8 required)
70	037172	Strain Relief
71	037173	Cord
72	037995	Bottom Plate
73	037166	Screw (7 required)
74	037705	Yellow Valve Cover

**038020**

Package of Filters

**038019**

Adapter Kit



Date Code Location → D/C: WWYY  
D/C: WWYY  
(week week year year)