

# HF-12M series, 2/3"-1" \*3, 2.1μm, 12MP

Maximum sensor size: 8mm/12mm=2/3", 16mm/25mm=1/1.2", 35mm=1"



- Low distortion
- Compact design



	Anti Shock & Vibration HF818-12M	Anti Shock & Vibration HF1218-12M	Anti Shock & Vibration HF1618-12M	Anti Shock & Vibration HF2518-12M	Anti Shock & Vibration HF3520-12M
Focal length [mm]	8	12	16	25	35
Iris range [F. no]	F1.8-F22	F1.8-F22	F1.8-F22	F1.8-F22	F2.0-F22
Angle of view : 2/3"	56.9°×43.9°	39.3°×30.0°	30.8°×23.3°	20.0°×15.1°	14.7°×11.0°
Working Distance*1 [mm]	∞-100	∞-100	∞-100	∞-100	∞-200
Operation of focus	Manual	Manual	Manual	Manual	Manual
Operation of iris	Manual	Manual	Manual	Manual	Manual
Filter thread [mm]	M30.5×0.5	M30.5×0.5	M30.5×0.5	M30.5×0.5	M30.5×0.5
Mount	C-mount	C-mount	C-mount	C-mount	C-mount
Weight (approx.) [g]	95	85	90	85	85
Sensor size (std.)*2	2/3"(2.1μm)	2/3"(2.1μm)	2/3"(2.1μm)	2/3"(2.1μm)	2/3"(2.1μm)
Sensor size (max.)*3	2/3"(2.1μm)	1/1.2"(4.5μm)	1/1.2"(4.5μm)	1/1.2"(4.5μm)	1"(4.5μm)
TV distortion [%]	-1.03	0.18	-0.03	0.02	0.01
Dimension [mm]	ø33×48.5	ø33×52.5	ø33×52.5	ø33×53.1	ø33×53.1

HF818-12M

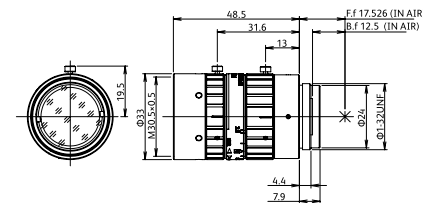

HF1218-12M

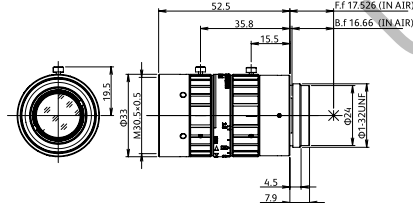

HF1618-12M

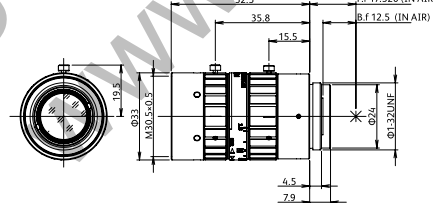

HF2518-12M

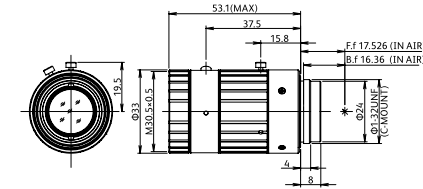

HF3520-12M

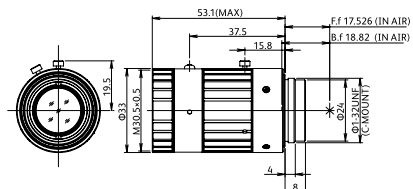

# HF-XA-5M series, 2/3"-1.1" \*3, 3.45μm, 5MP

Maximum sensor size: 6mm/8mm=2/3", 12mm/16mm/25mm/35mm=1/1.2", 50mm=1.1"



- Compact design



	Anti Shock & Vibration HF6XA-5M	Anti Shock & Vibration HF8XA-5M	Anti Shock & Vibration HF12XA-5M	Anti Shock & Vibration HF16XA-5M	Anti Shock & Vibration HF25XA-5M	Anti Shock & Vibration HF35XA-5M	Anti Shock & Vibration HF50XA-5M
Focal length [mm]	6	8	12	16	25	35	50
Iris range [F. no]	F1.9-F16	F1.6-F16	F1.6-F16	F1.6-F16	F1.6-F16	F1.9-F16	F2.4-F16
Angle of view : 2/3"	74.7°×58.1°	58.4°×44.6°	40.1°×30.3°	31.4°×23.7°	20.0°×15.0°	14.2°×10.7°	10.4°×7.8°
Working Distance*1 [mm]	∞-100	∞-100	∞-100	∞-100	∞-100	∞-200	∞-200
Operation of focus	Manual	Manual	Manual	Manual	Manual	Manual	Manual
Operation of iris	Manual	Manual	Manual	Manual	Manual	Manual	Manual
Filter thread [mm]	M37.5×0.5	M25.5×0.5	M25.5×0.5	M25.5×0.5	M25.5×0.5	M25.5×0.5	M30.5×0.5
Mount	C-mount	C-mount	C-mount	C-mount	C-mount	C-mount	C-mount
Weight (approx.) [g]	100	79	79	71	72	60	95
Sensor size (std.)*2	2/3"(3.45μm)	2/3"(3.45μm)	2/3"(3.45μm)	2/3"(3.45μm)	2/3"(3.45μm)	2/3"(3.45μm)	2/3"(3.45μm)
Sensor size (max.)*3	2/3"(3.45μm)	2/3"(3.45μm)	1/1.2"(4.5μm)	1/1.2"(4.5μm)	1/1.2"(4.5μm)	1/1.2"(4.5μm)	1.1"(4.5μm)
TV distortion [%]	-2.88	-1.99	-1.26	-0.60	-0.07	0.10	0.01
Dimension [mm]	ø39×51	ø29.5×51.5	ø29.5×51.5	ø29.5×46	ø29.5×46.5	ø29.5×41.5	ø33×66.5

HF6XA-5M

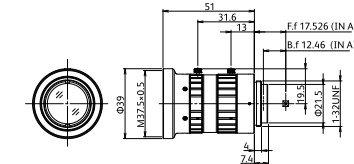

HF8XA-5M

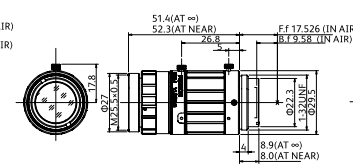

HF12XA-5M

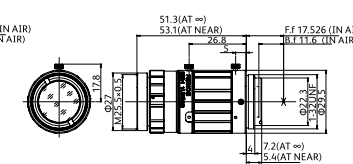

HF16XA-5M

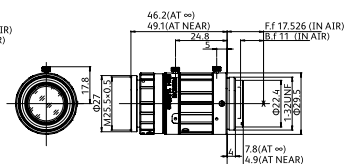

HF25XA-5M

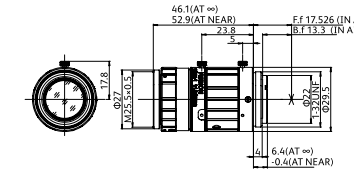

HF35XA-5M

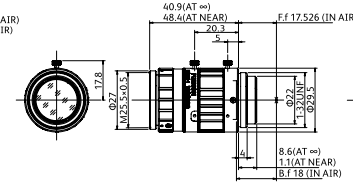

HF50XA-5M

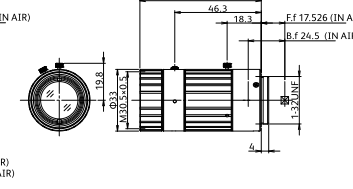

\*1 From front of lens barrel. \*2 Sensor size(std.): Ideal size to maximize the target resolution.

\*3 Sensor size(max.): Adaptable sensor size varies depending on the model. Please check the amount of light and resolution on the edges pertaining to your particular application.

\*1 From front of lens barrel. \*2 Sensor size(std.): Ideal size to maximize the target resolution.

\*3 Sensor size(max.): Adaptable sensor size varies depending on the model. Please check the amount of light and resolution on the edges pertaining to your particular application.