

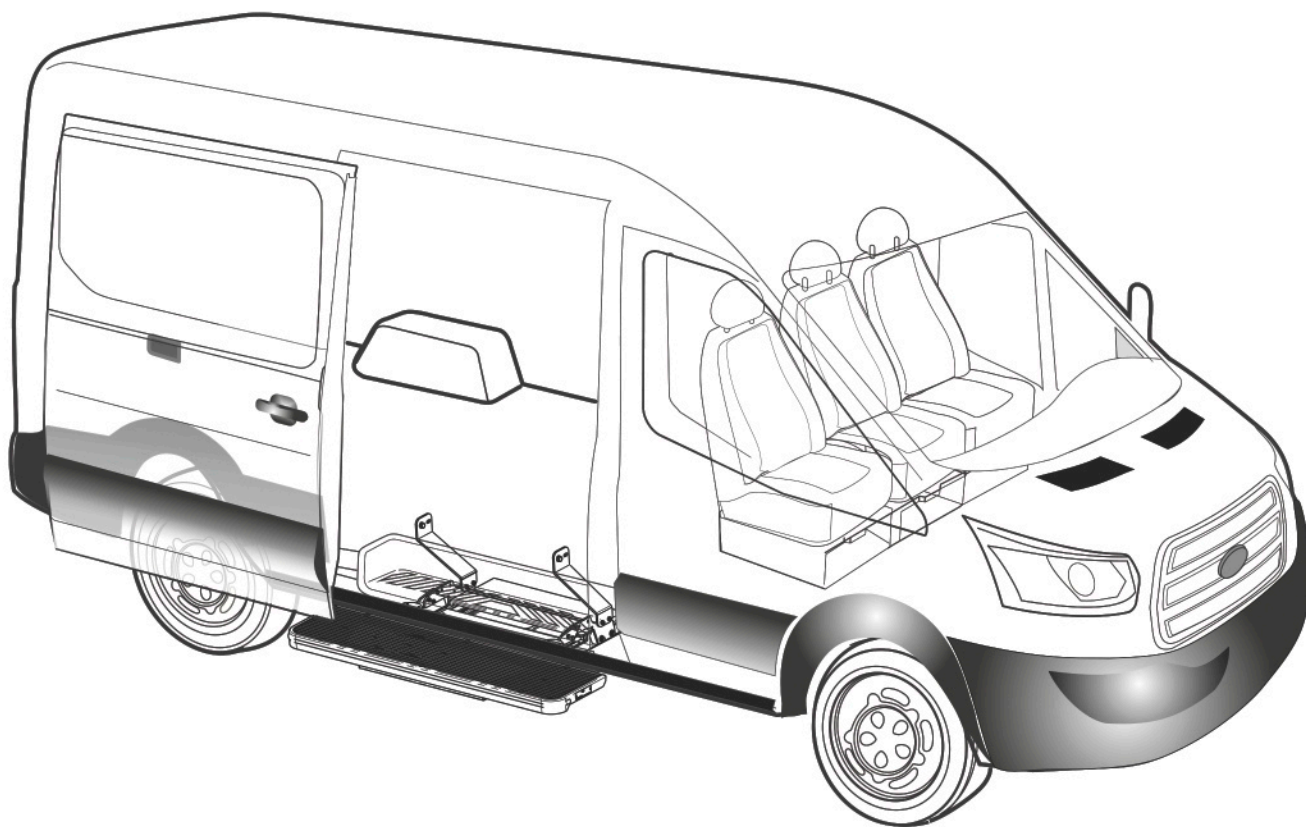

www.PowerDoorAndStep.com

(888) 928-8000

FORD TRANSIT 2014



Automatic Power Step

016-006-TRN Step Kit for Transit

Includes:

016-006-A Power Step Assembly
160-16-361 Bracket Kit - Ford Transit

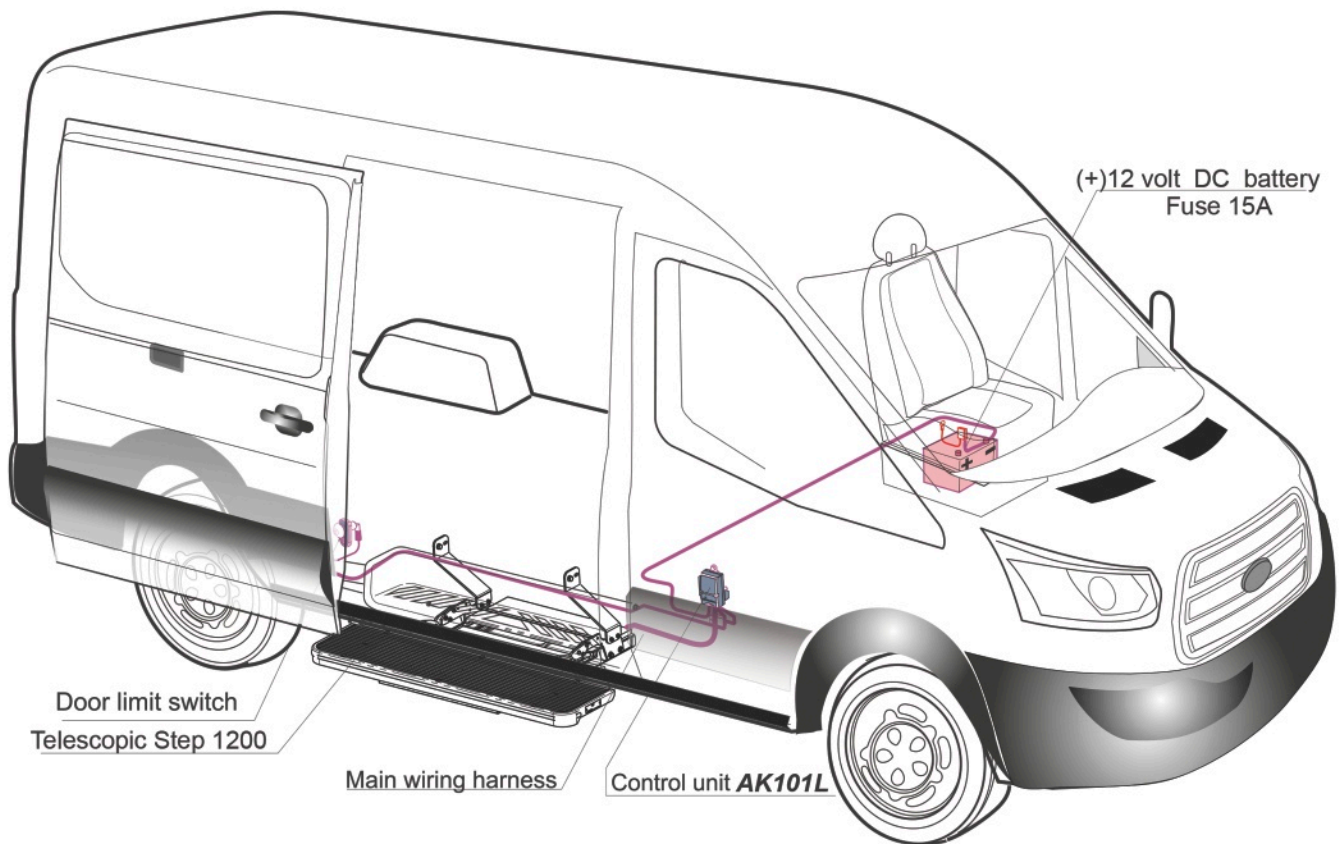

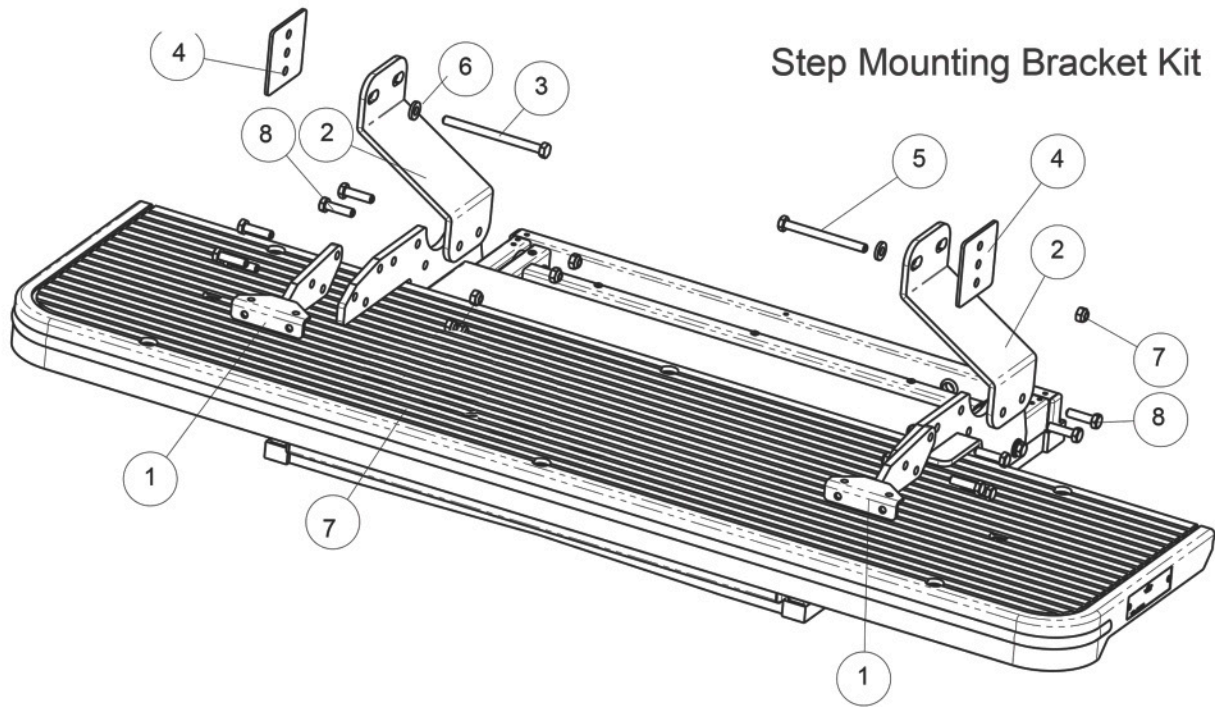

Step Mounting Bracket Kit

Step Mounting Bracket Kit *RWD* PN: 160-16-361

ITEM NO.	DESCRIPTION	PART NUMBER	QTY.
1	Step Front bracket	111-99-006	2
2	Support	128-99-001A	2
3	Hex bolt M8x120 DIN933,8.8	632-08-120	2
4	Support Plate (70X70)	128-97-15K	4
5	Bolt M8x90	632-08-090	2
6	Flat washer 8, thick, S 2mm BN 737	600-32-081	2
7	Hex lock nut M8 DIN 985	602-02-008	12
8	Hex bolt M8X30 DIN933, 8.8	632-08-030	10
9	Flat washer 6, 2.5mm BN 737	600-32-061	4
10	Hex lock nut M6 DIN 985	602-02-006	4
11	Hex bolt M6X20 DIN933, 8.8	632-06-020	4

PN: 016-00060 (Step Without Brackets)

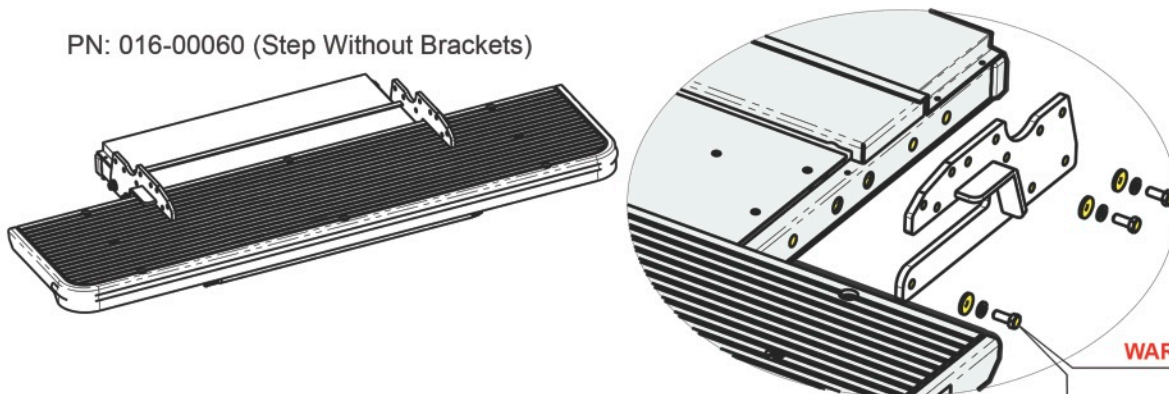

WARNING

HEX HEAD BOLT M8x20
THICK WASHER 8
SPRING WASHER 8

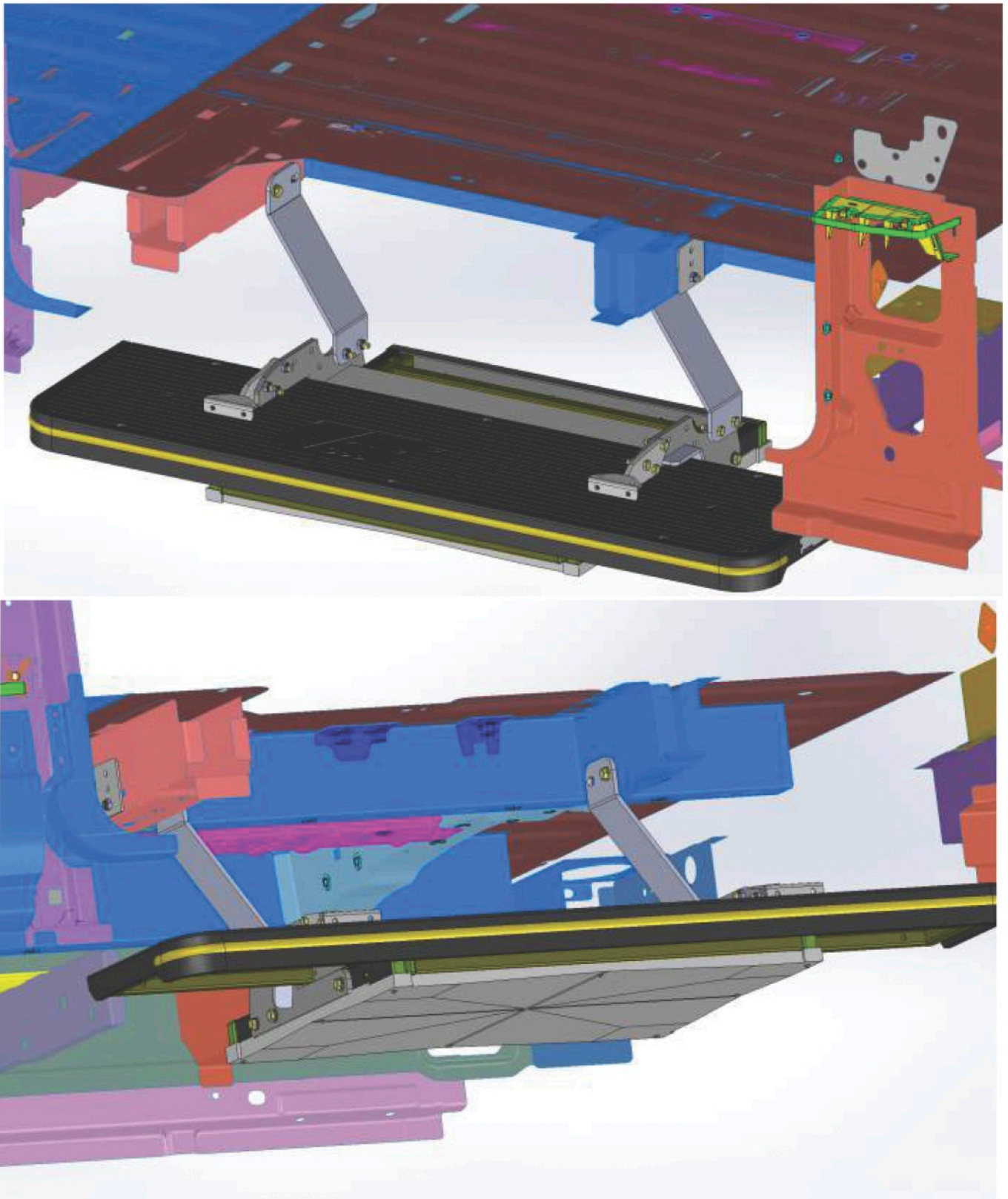

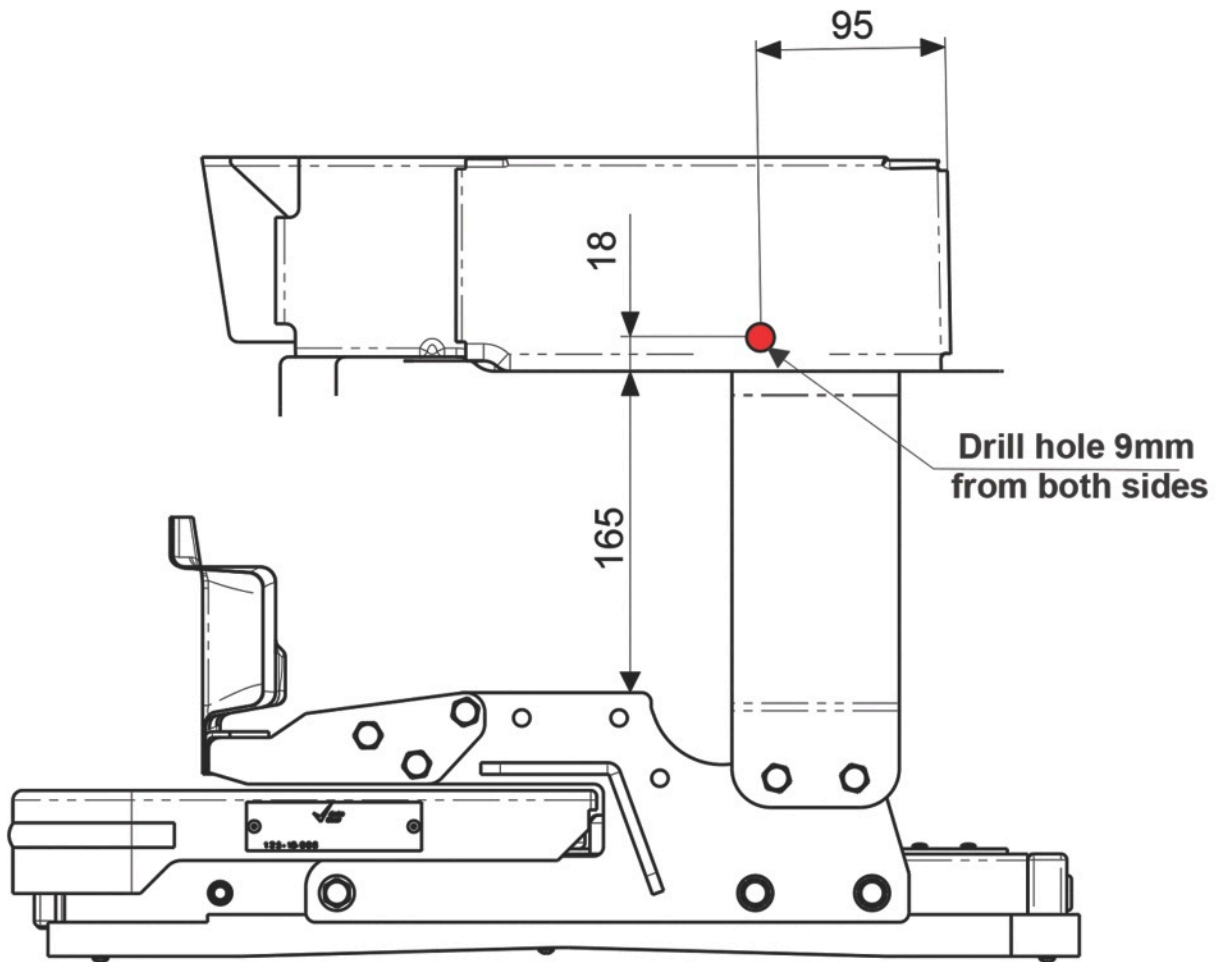

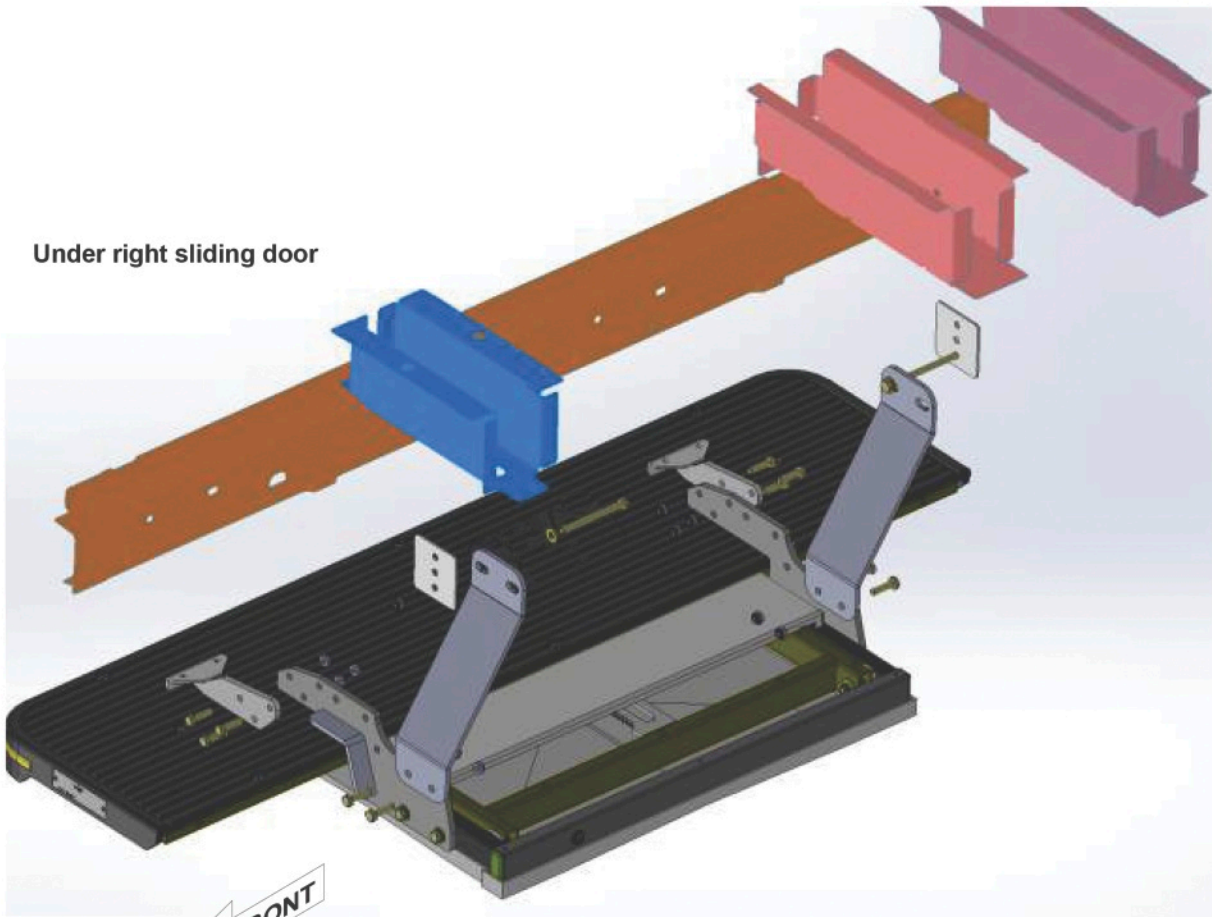

FRONT

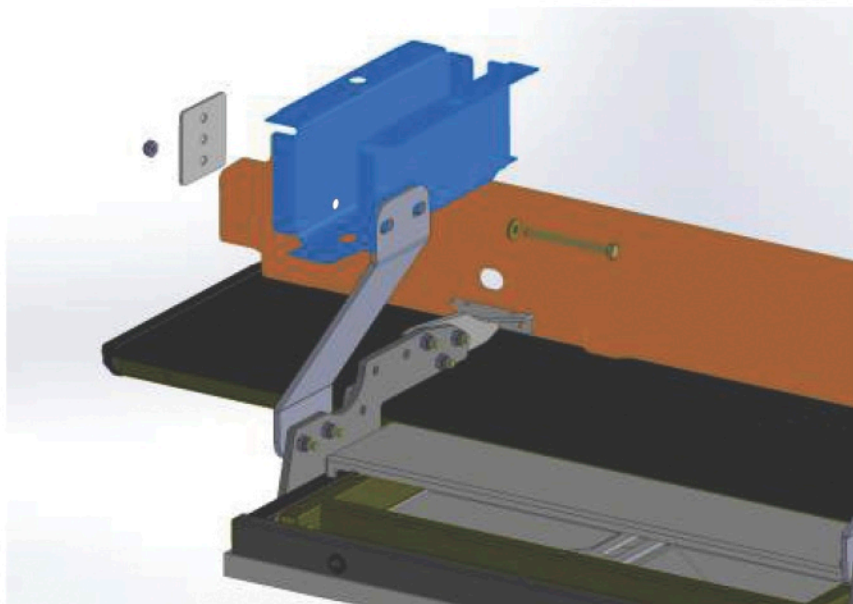

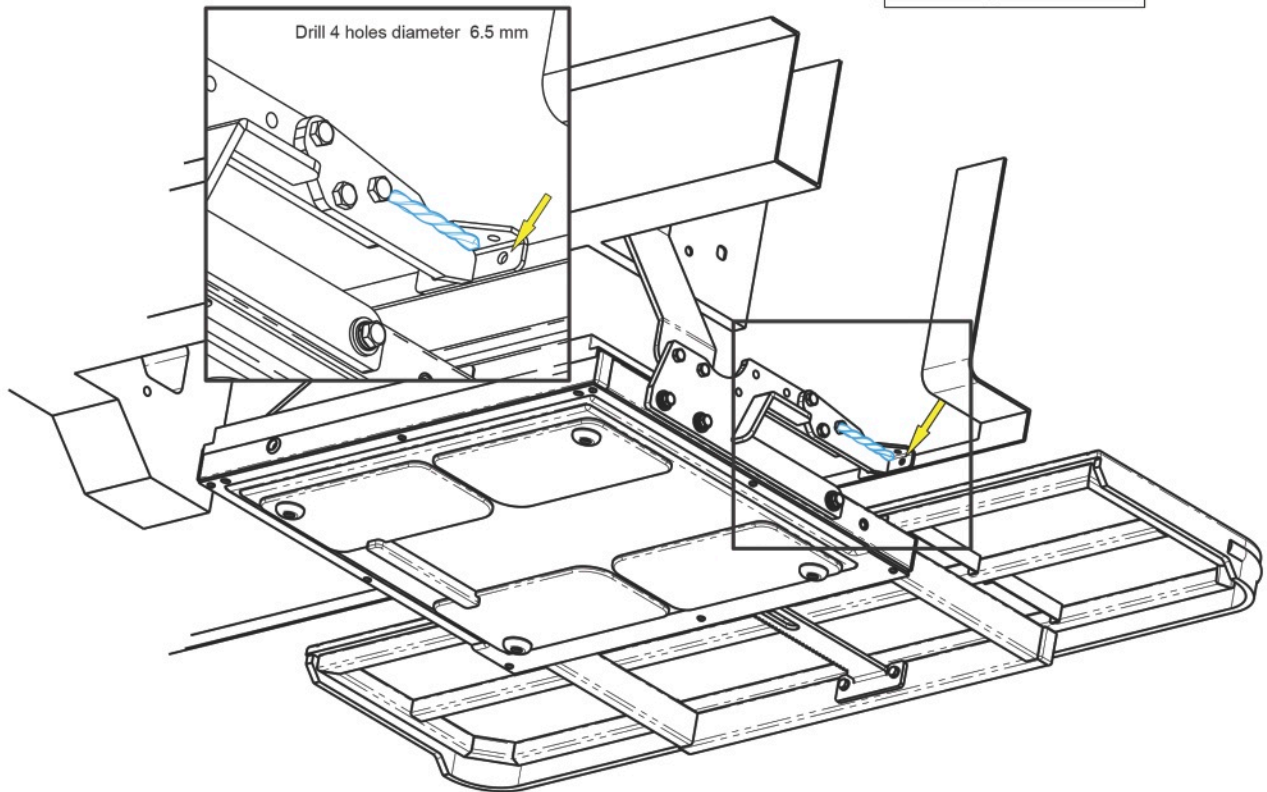
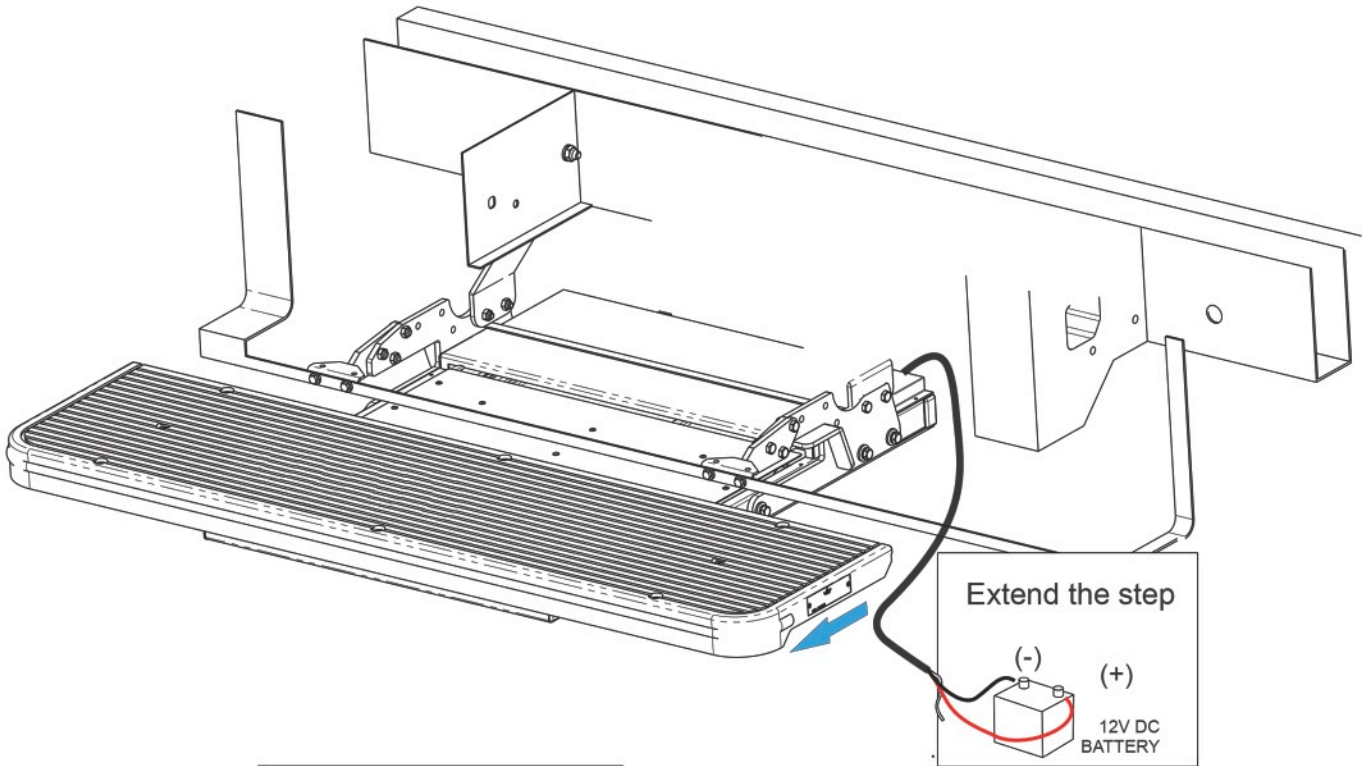

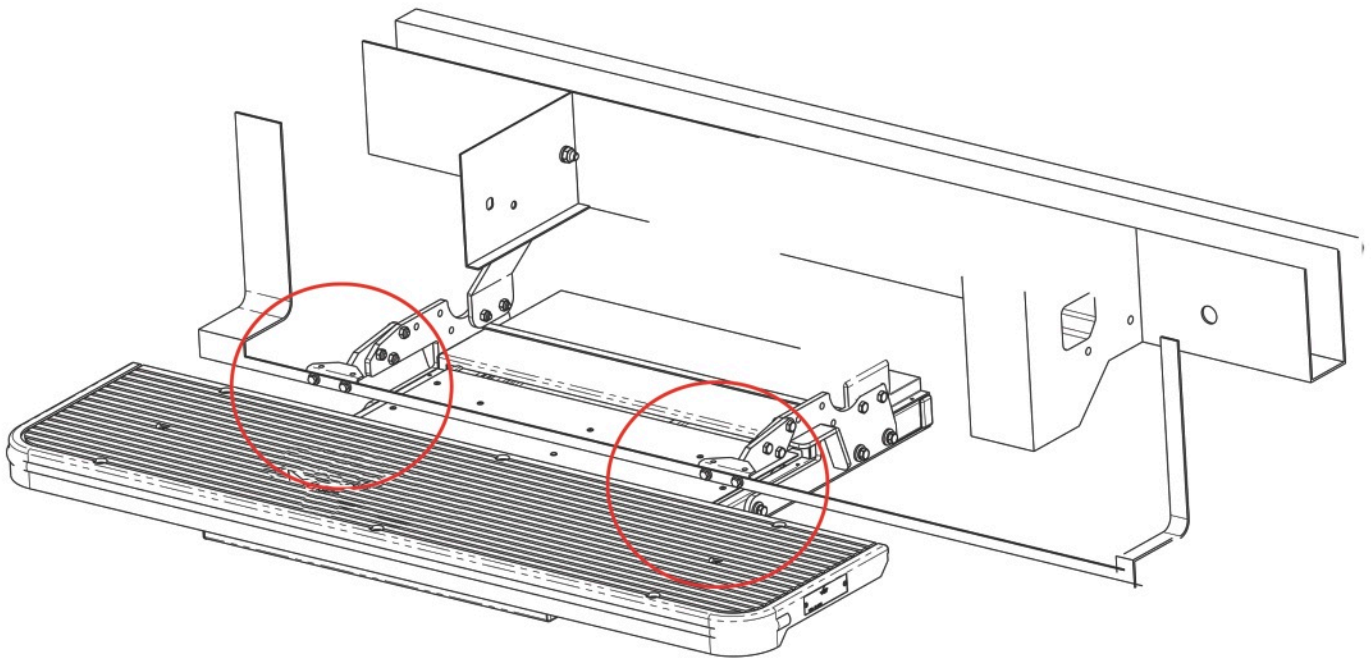

- 11 Hex Bolt M6X20
- 10 Lock nut M6
- 9 Washer 6

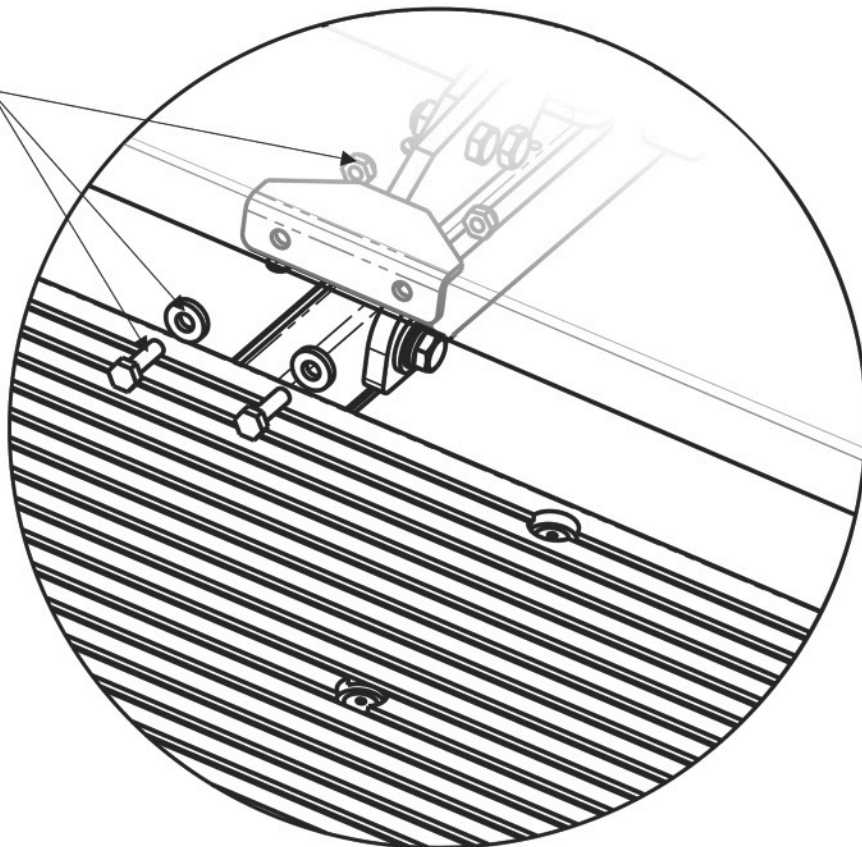

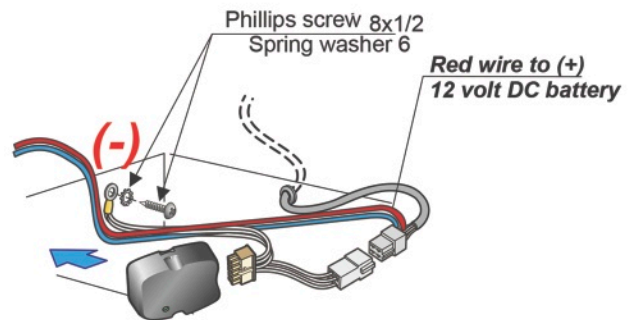
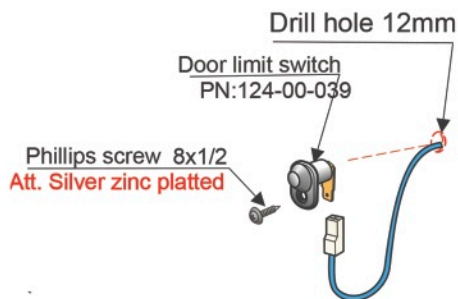
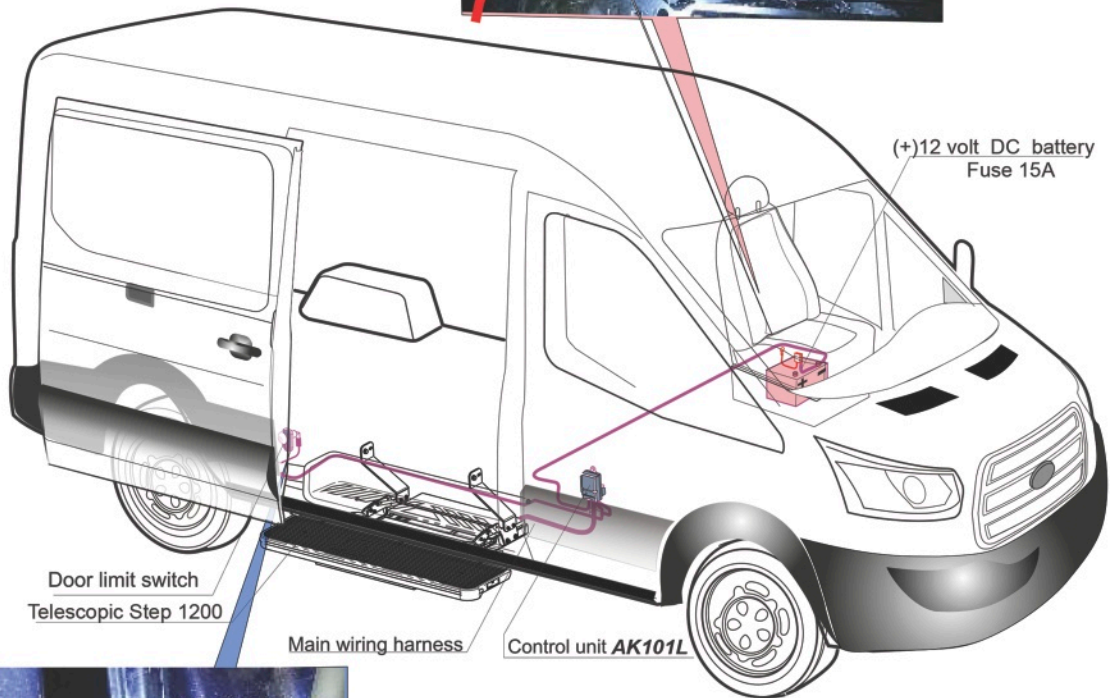
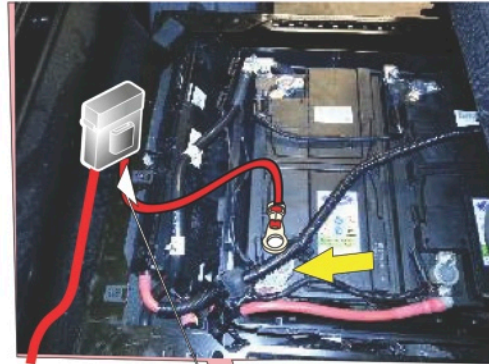

WIRING DIAGRAM

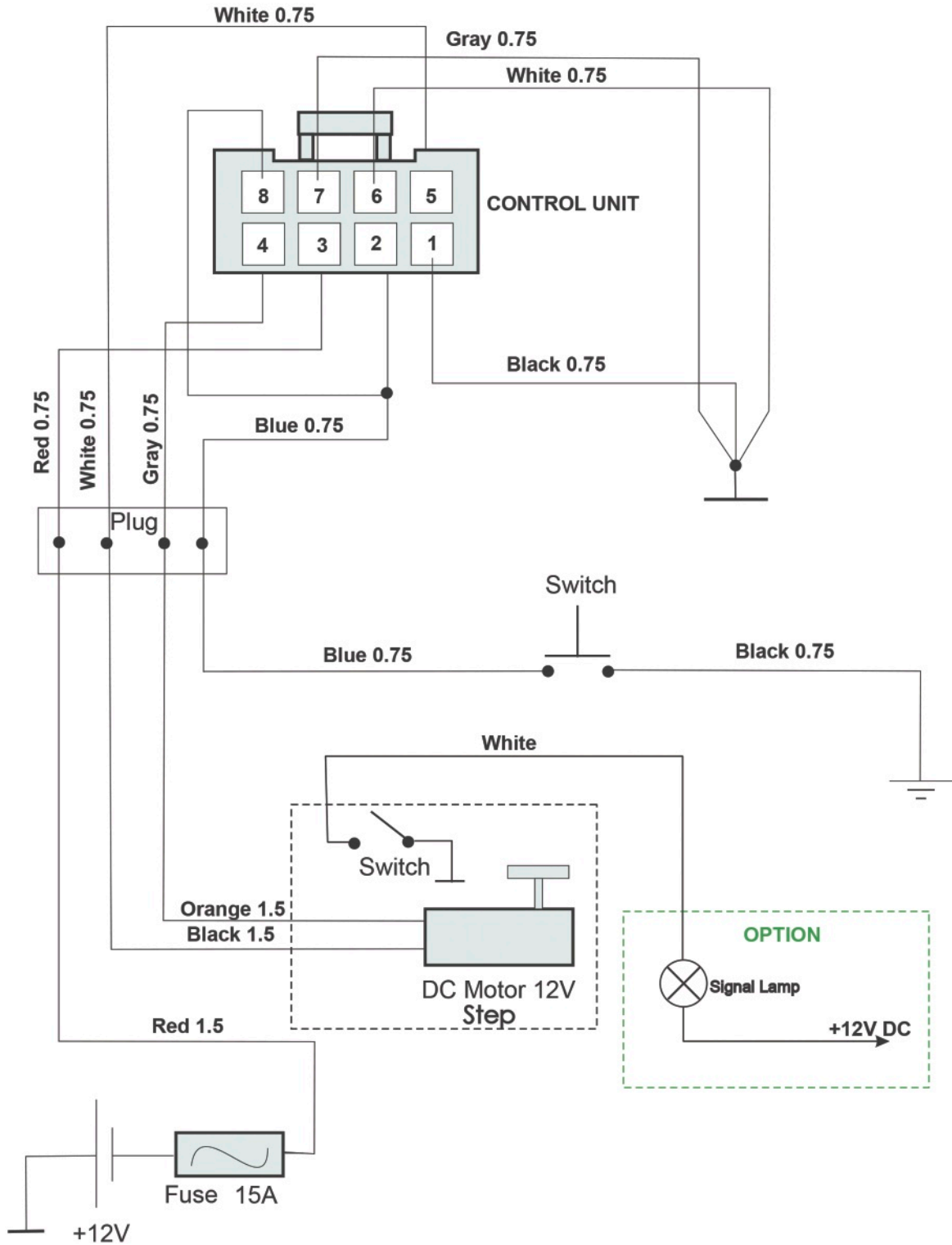



EFS system Basic Troubleshooting

1. Step does not function in opening or closing modes.
 - Check main fuse
 - Check connections of power terminals to the control units, motor and operation knob.
 - Check connection of the ground terminal (-)
 - Check control unit

Important information

To commence regular operation after the EFS has been disconnected from power (Battery change, Faulty fuse etc.) reset the system by pressing the switch a few times.



Power Door & Step Company
6855 Hayvenhurst Ave | Van Nuys | CA 91406
(888) 928-8000
www.PowerDoorAndStep.com