

V363 *Ford* **TRANSIT**

RWD/FWD

Long Wheel Base ,Jumbo



Automatic Sliding Door Set

PN: 015-3632-DL

Ford Transit Van

PN: 015-3632-VDL

Ford Transit Seats Interior (Wagon)

Original Door latch mechanism
& operation with handles

Update 23.05.17

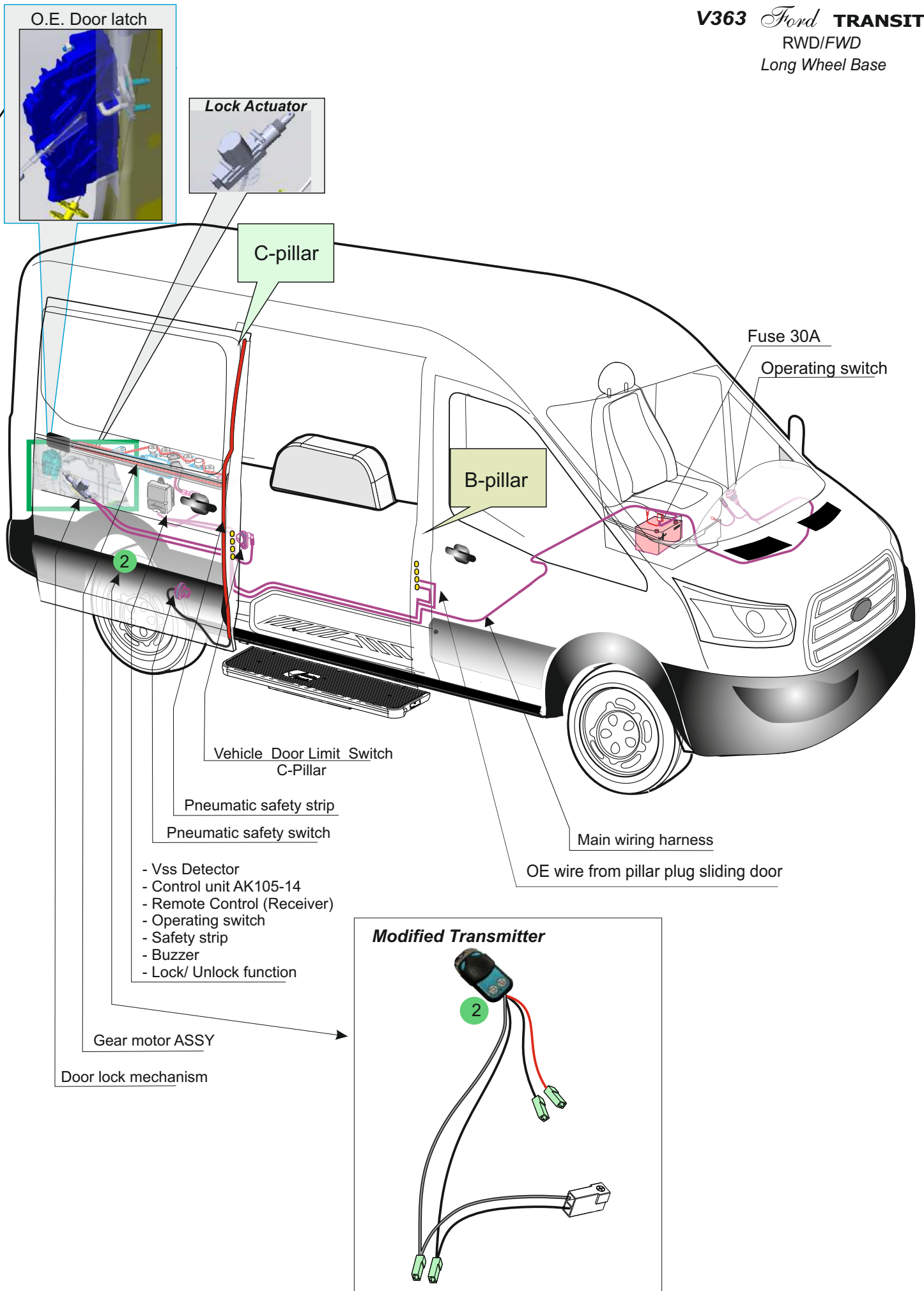

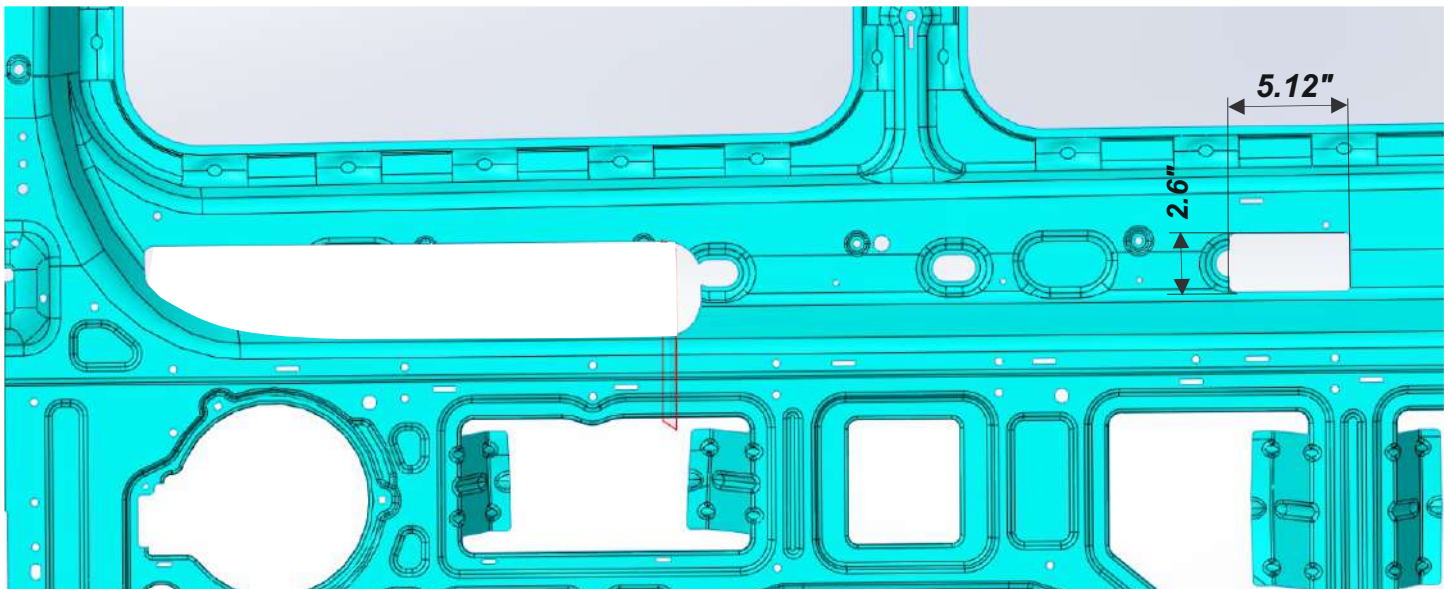
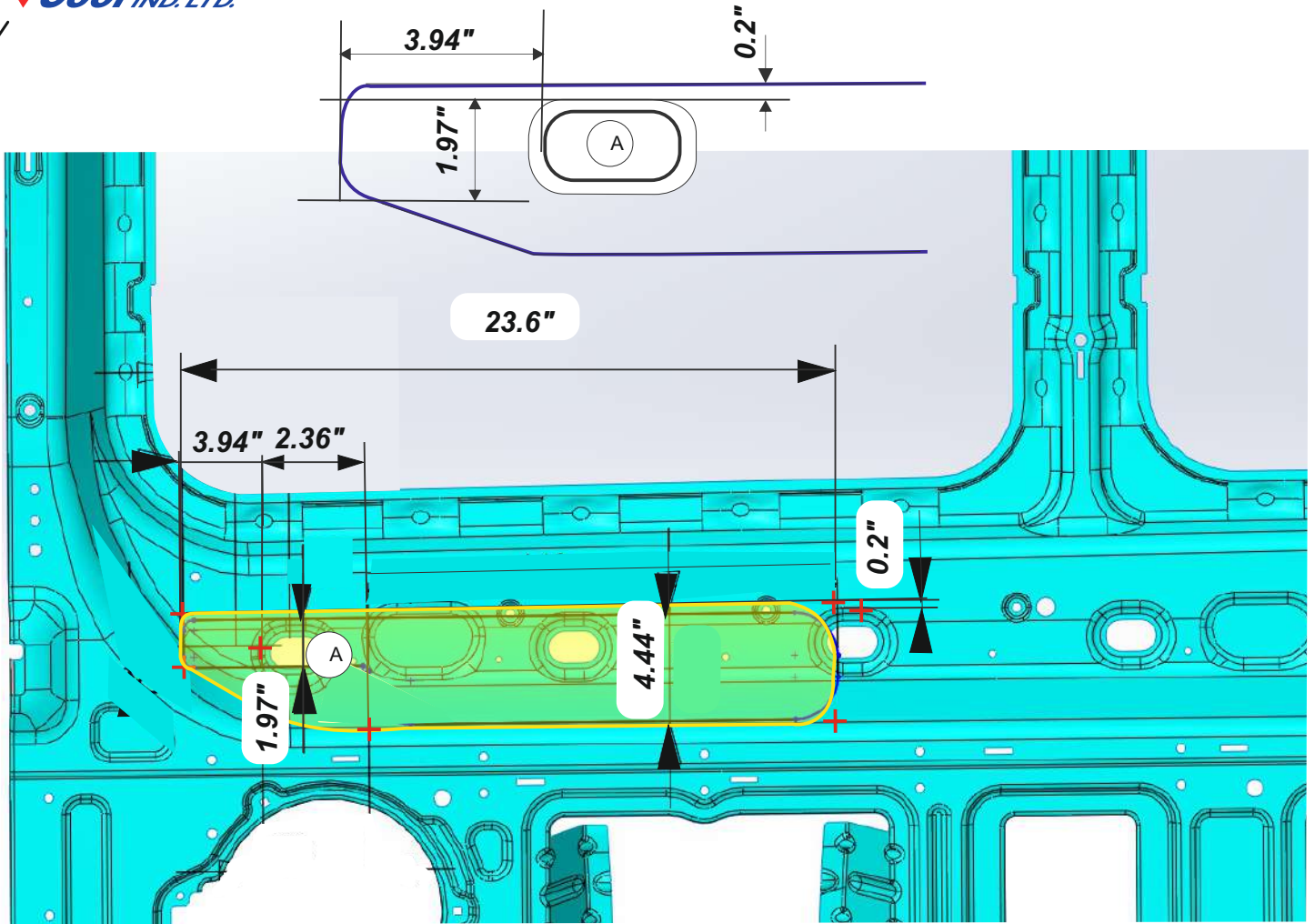

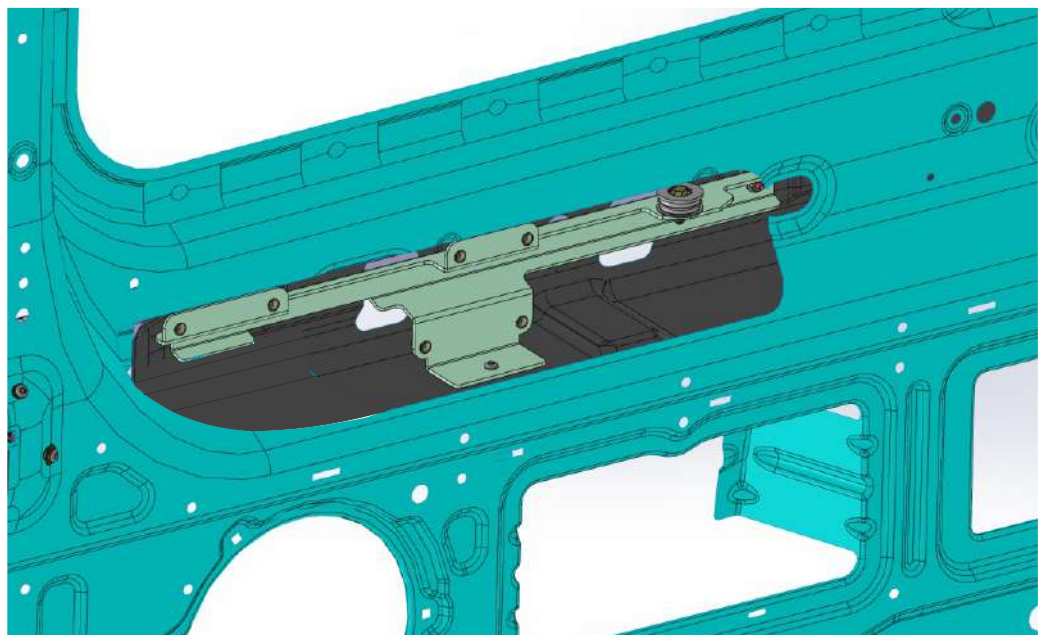
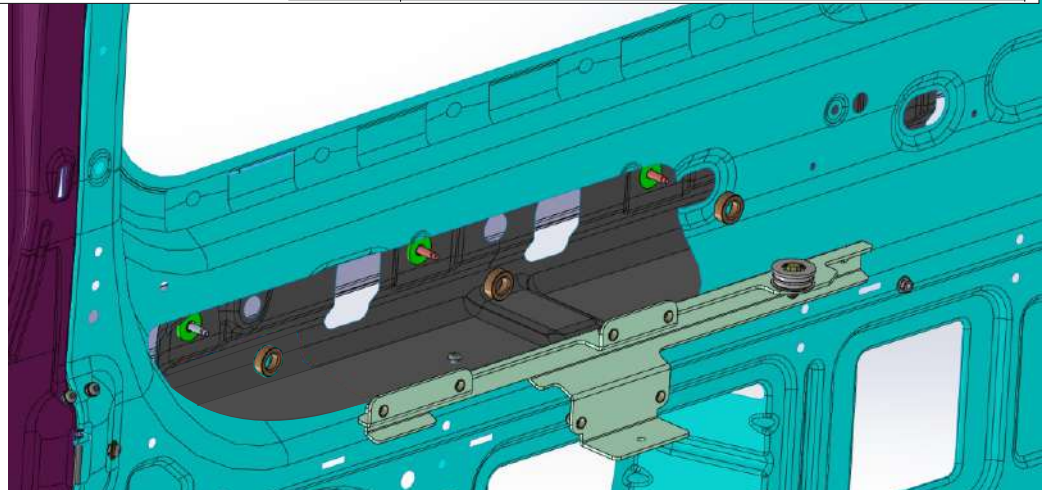
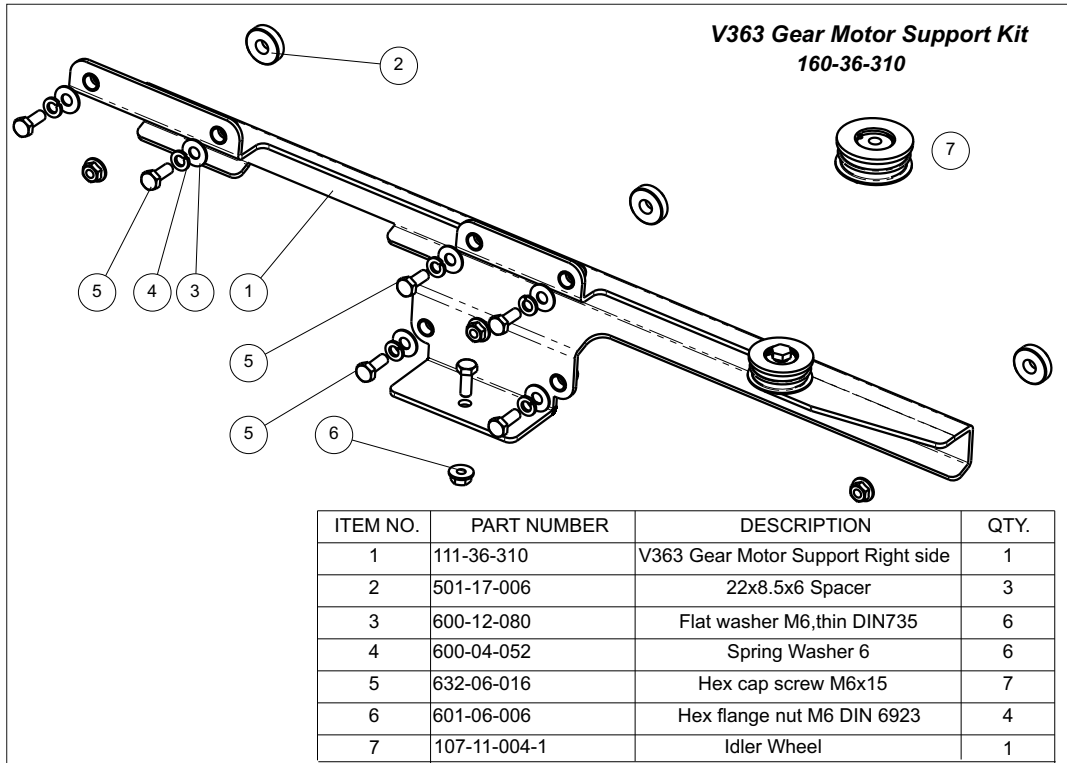

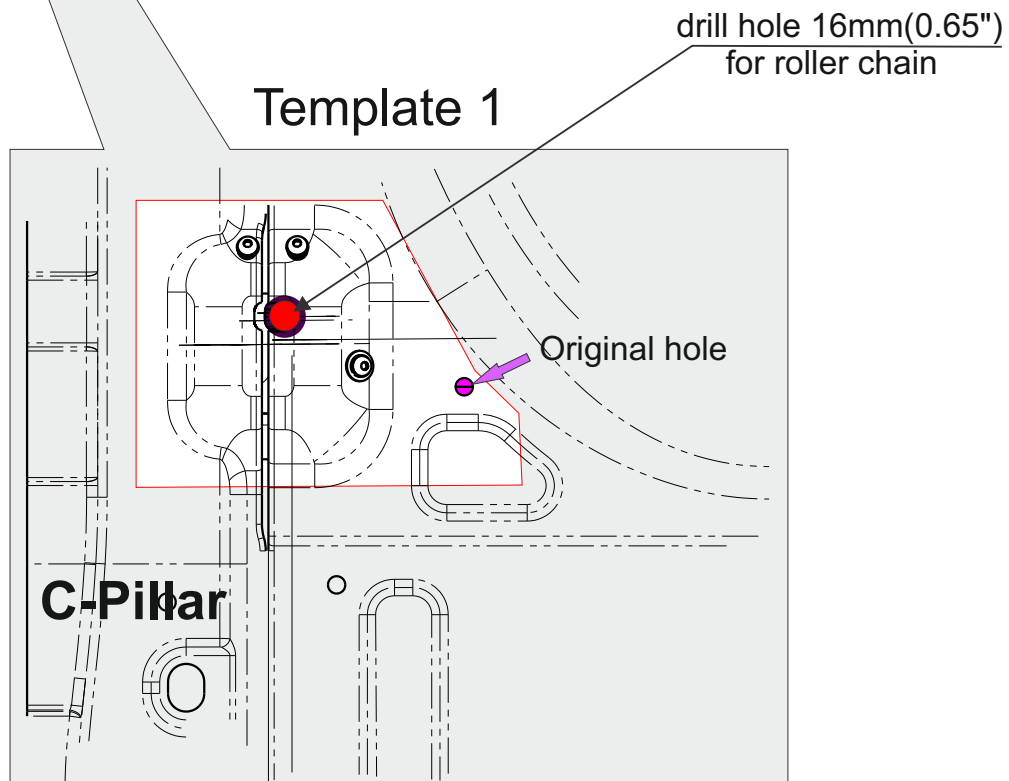
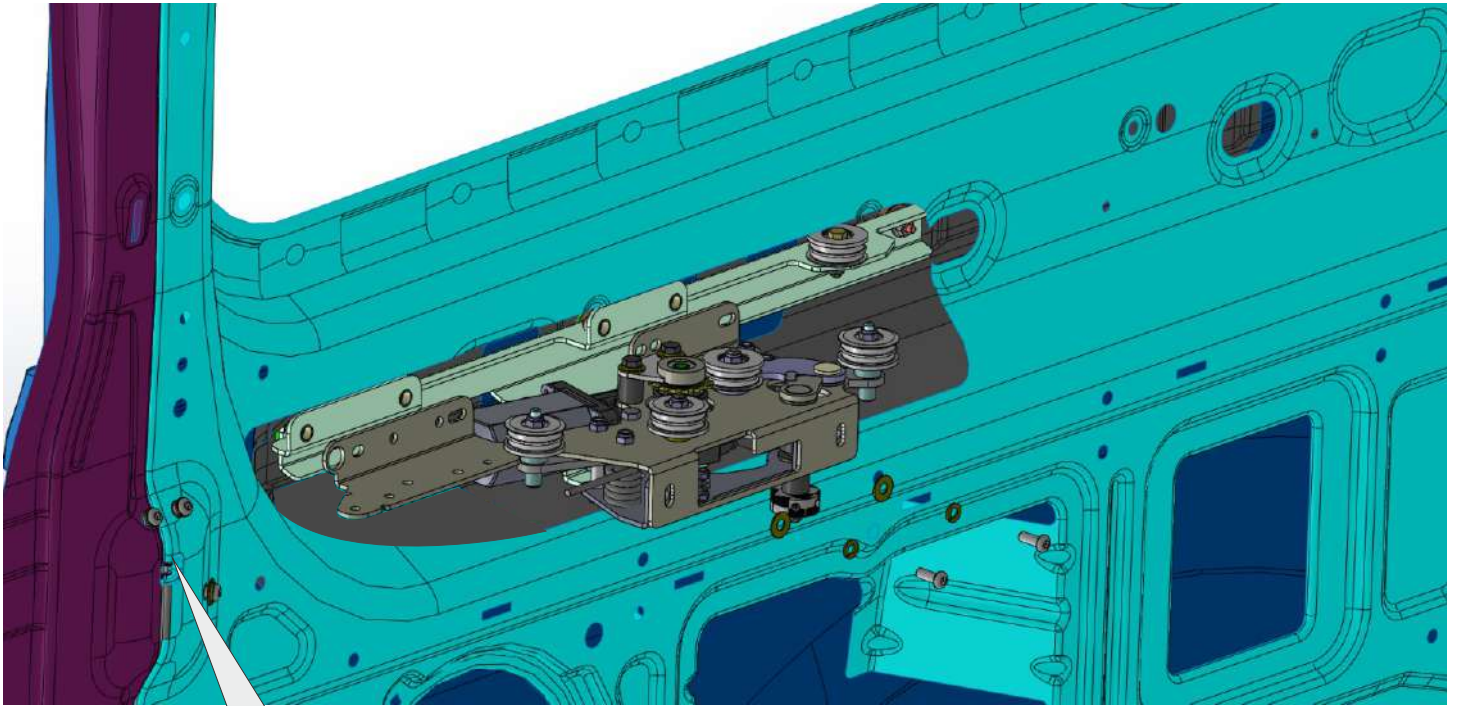

V363 Front Idler Kit
160-36-320

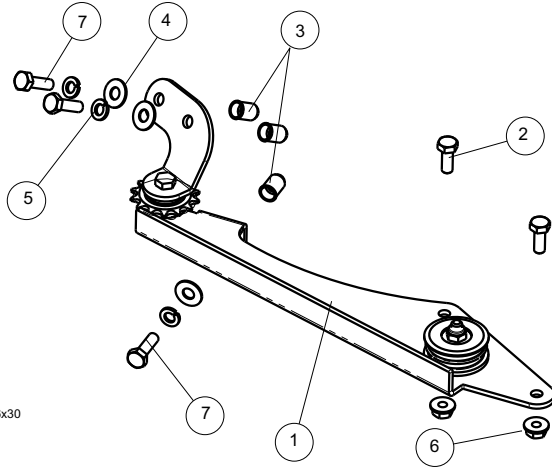

ITEM NO.	PART NUMBER	DESCRIPTION	QTY.
1	111-36-330	V363 Front Idler Kit	1
2	632-06-016	Hex cap screw M6x15	2
3	603-02-006	Rivet nut M6	3
4	600-12-080	Flat washer M6,thin DIN735	3
5	600-04-052	Spring Washer 6	3
6	601-06-006	Hex flange nut M6 DIN 6923	2
7	632-06-020	Hex bolt M6x20 DIN933, 8.8	3

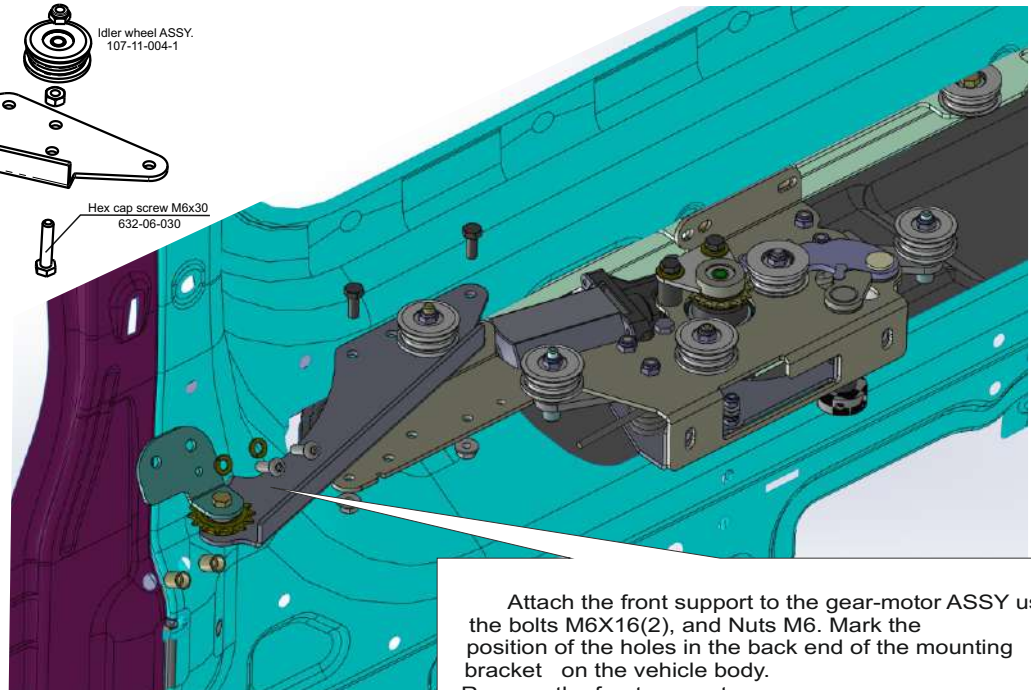
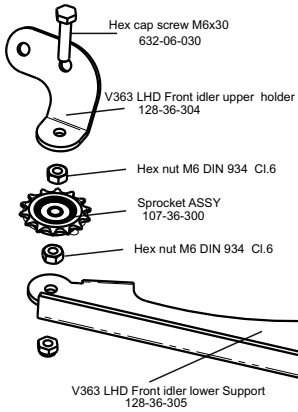

Attach the front support to the gear-motor ASSY using the bolts M6X16(2), and Nuts M6. Mark the position of the holes in the back end of the mounting bracket on the vehicle body. Remove the front support.



Drill 3 holes 9.5mm and install the threaded inserts (QTY. 3)

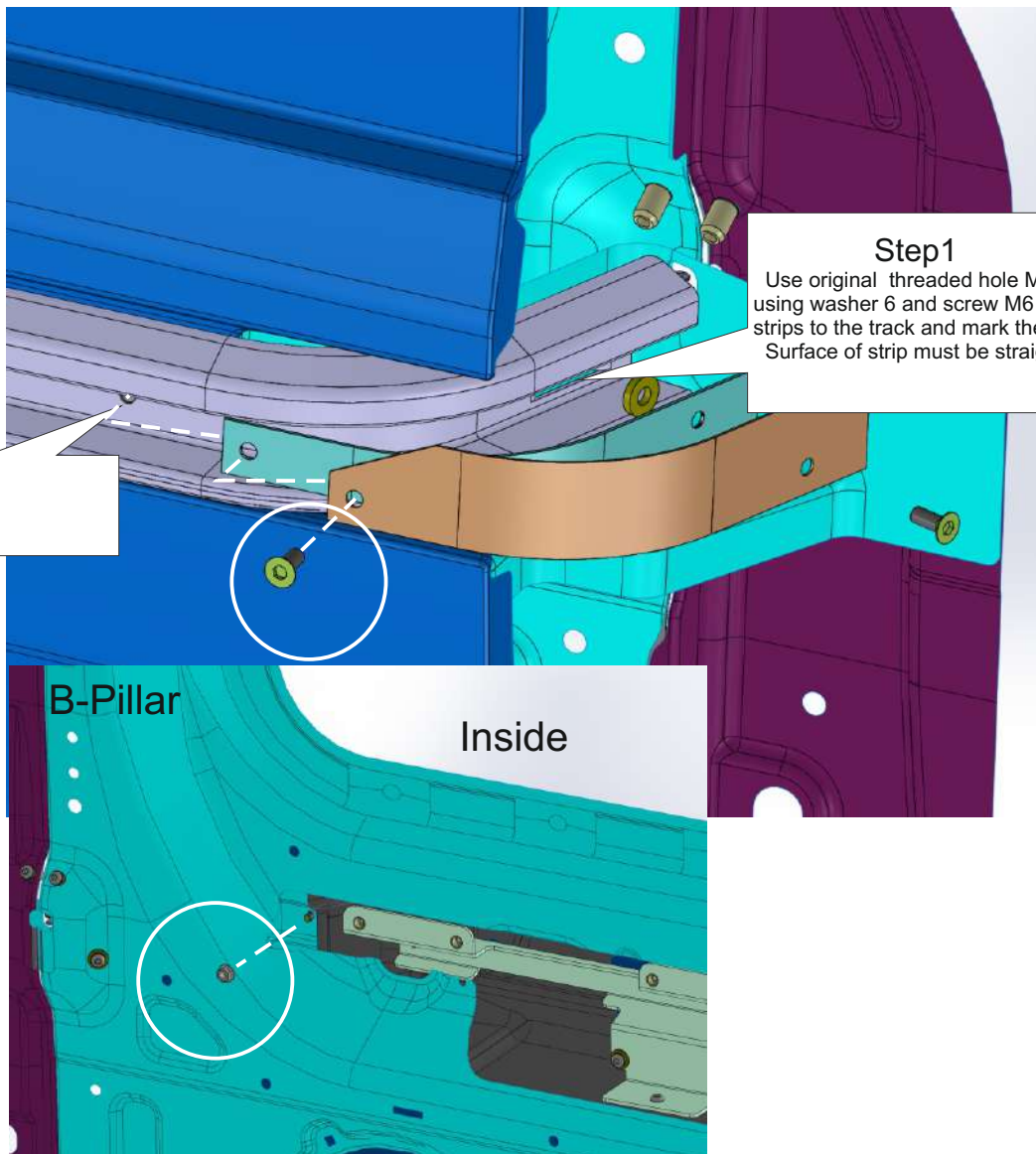
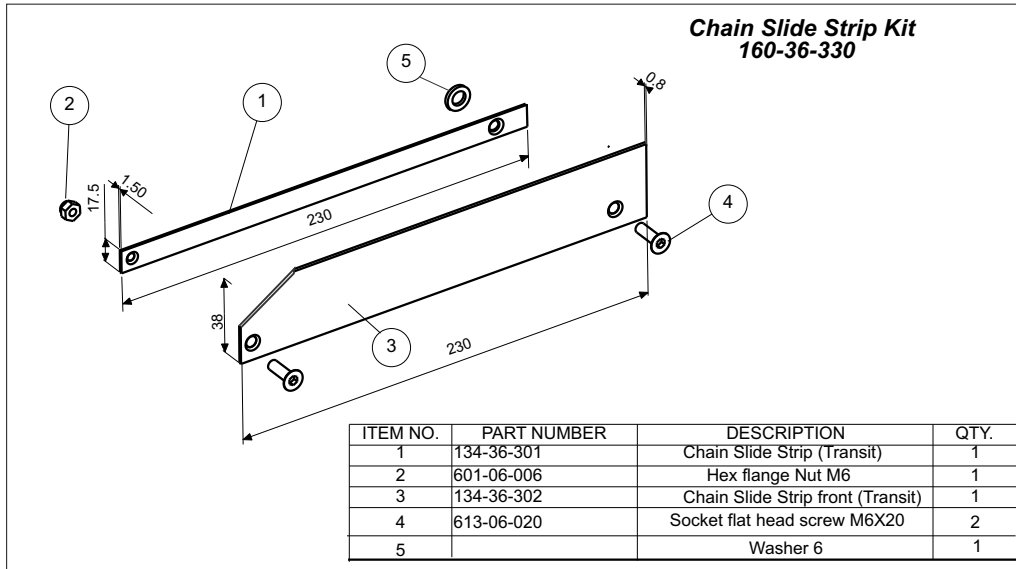

**Rear Idler Kit
 160-36-340**

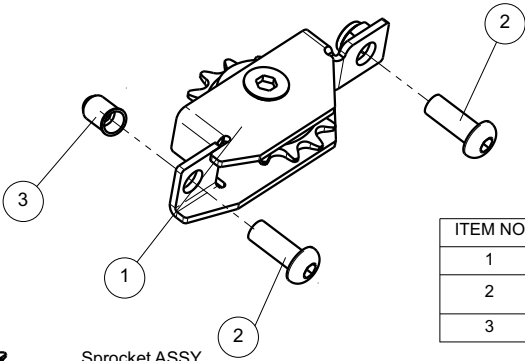

ITEM NO.	PART NUMBER	DESCRIPTION	Exploded/QTY.
1	111-36-340	Rear idler	1
2	614-06-016	Socket button head cap screw M6X16	2
3	603-02-006	Rivet nut M6	1

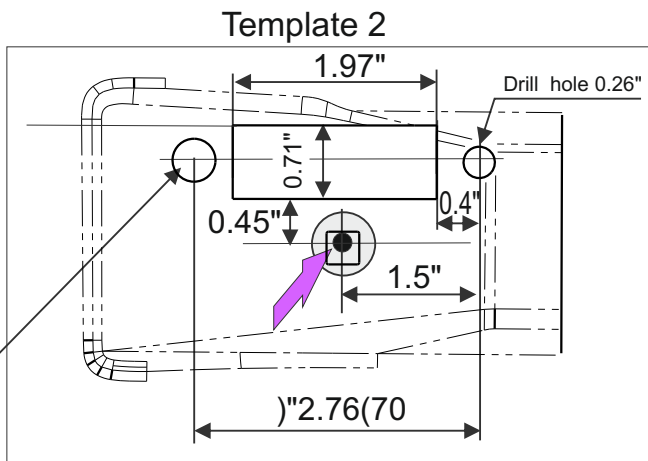
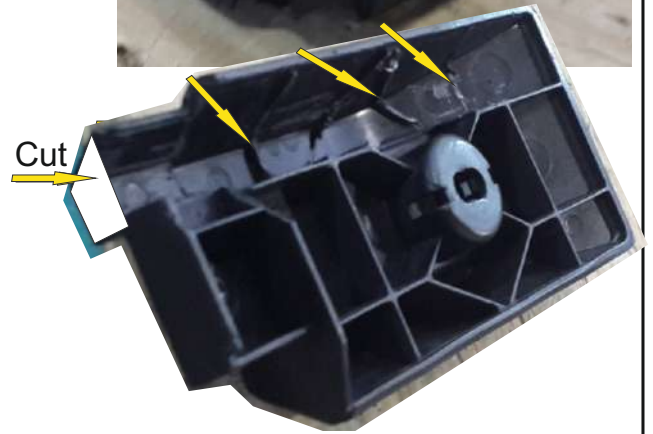
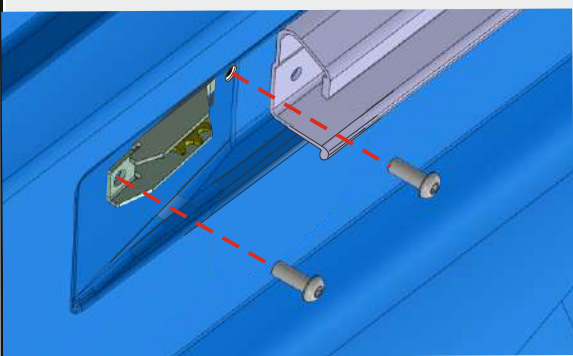
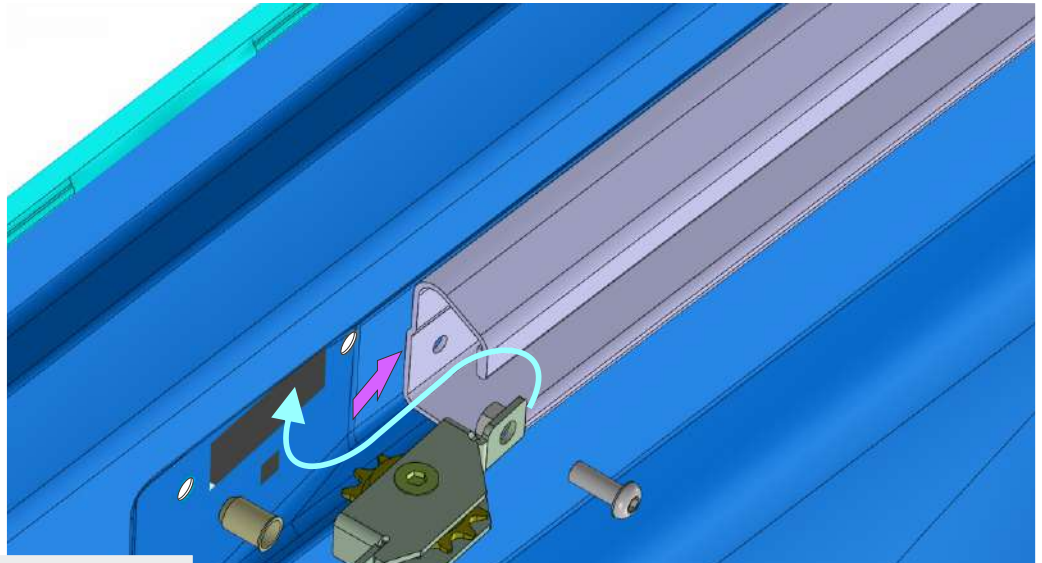
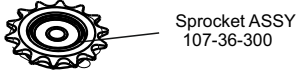

Drill hole 0,374" (9.5mm) and install the threaded insert

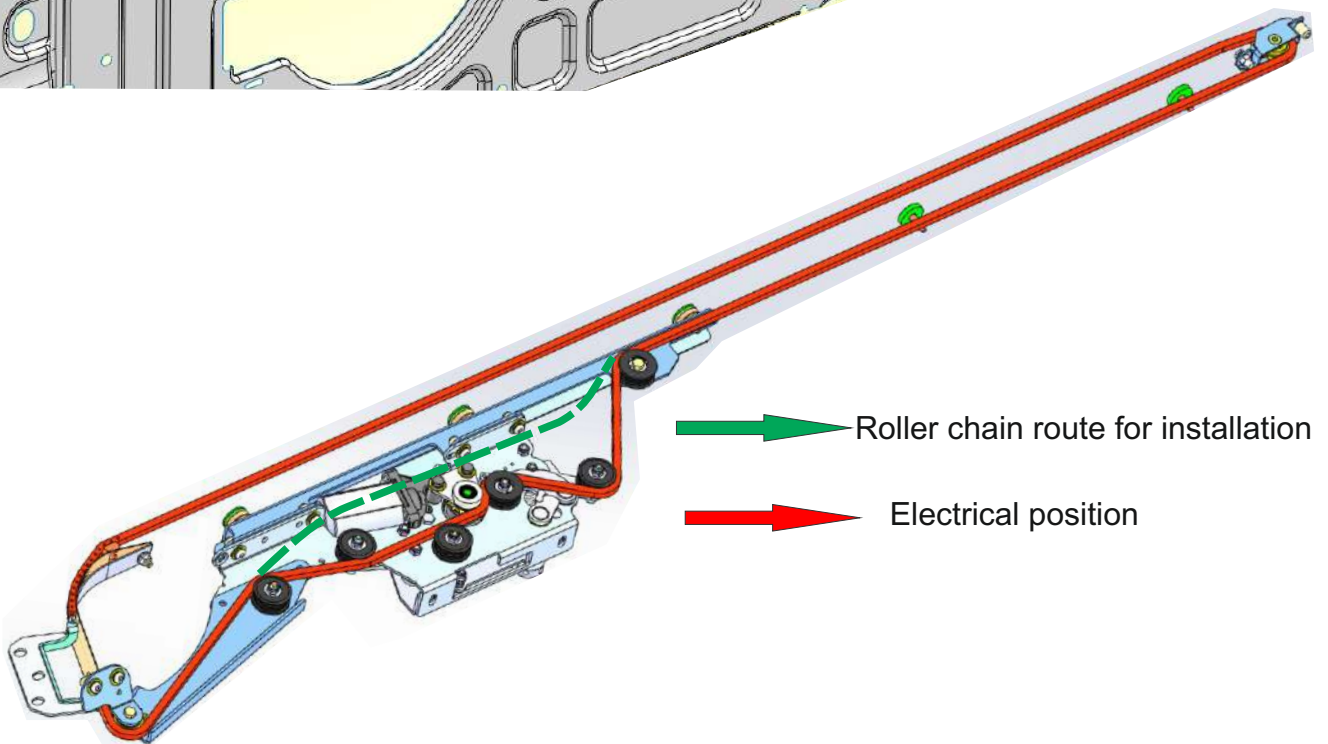
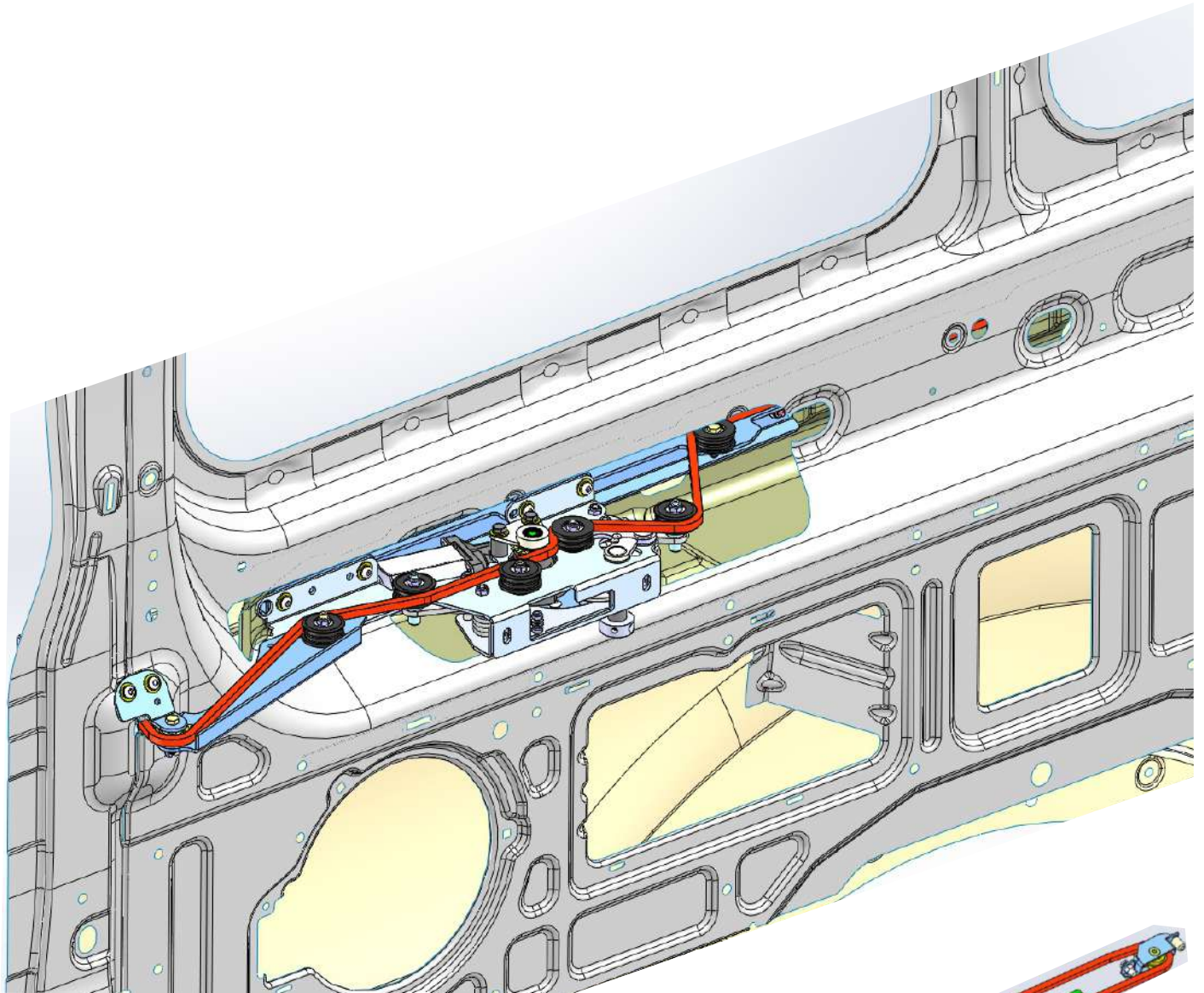

Driven Chain Kit
 160-36-350

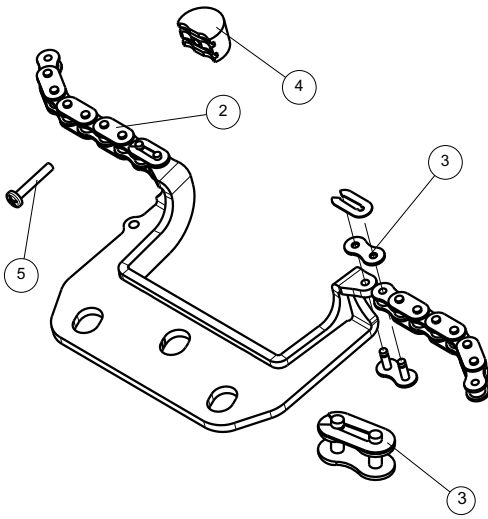

ITEM NO.	PART NUMBER	DESCRIPTION	Exploded/QT.Y.
1	111-36-320	Chain bracket	1
2	178-36-300	Roller chain B05 L=3088 mm(192 Links)	2
3	900-01-072	Chain connecting link B05	2
4	134-36-303	V363 Slider	1
5	647-03-012	Screw M3x12	1

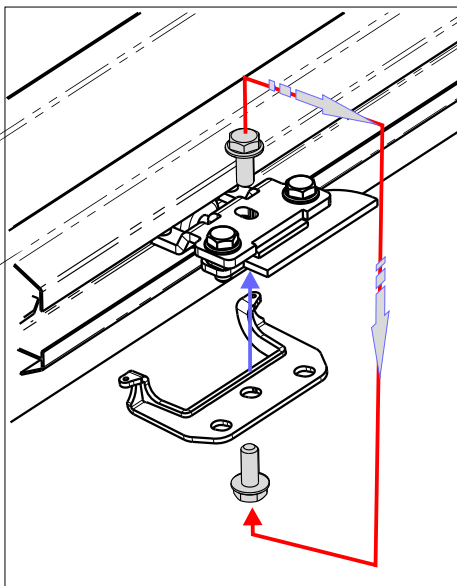
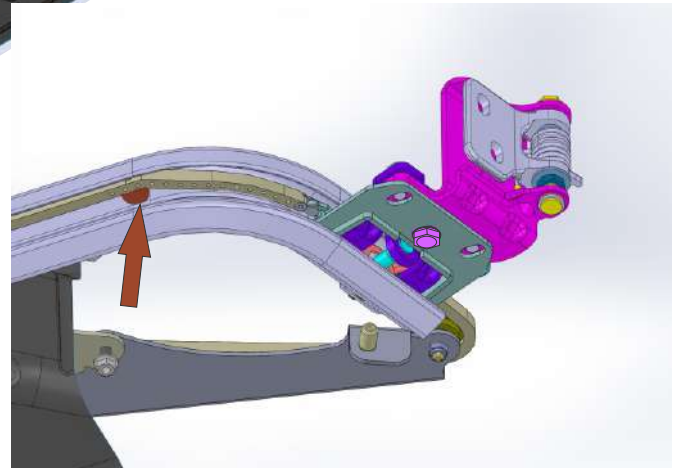
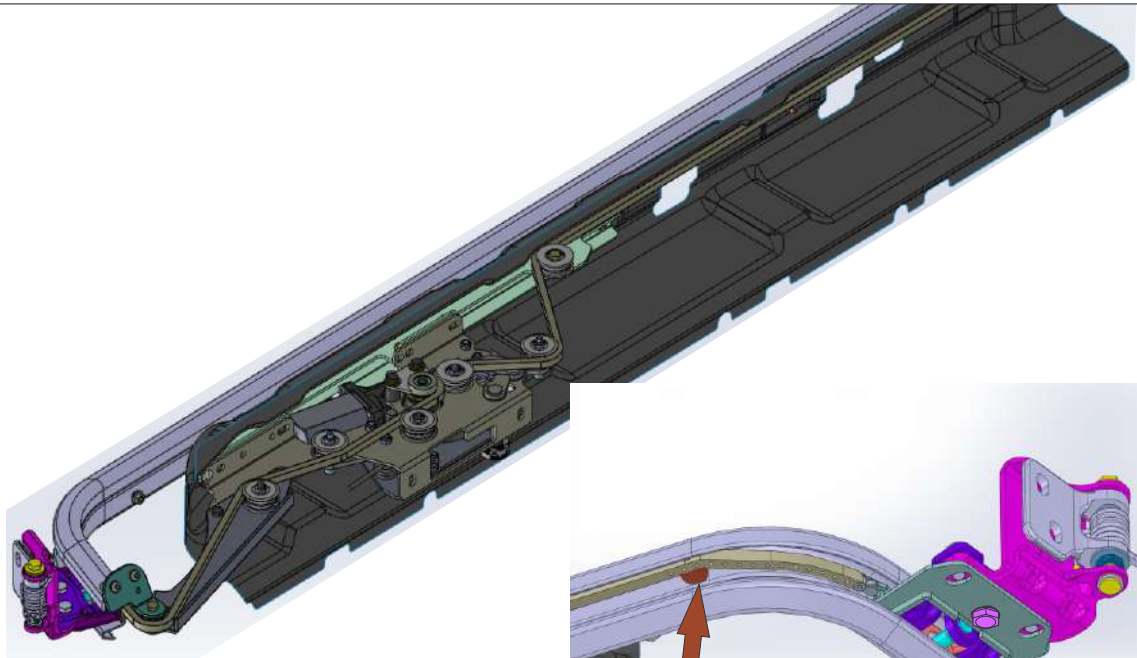

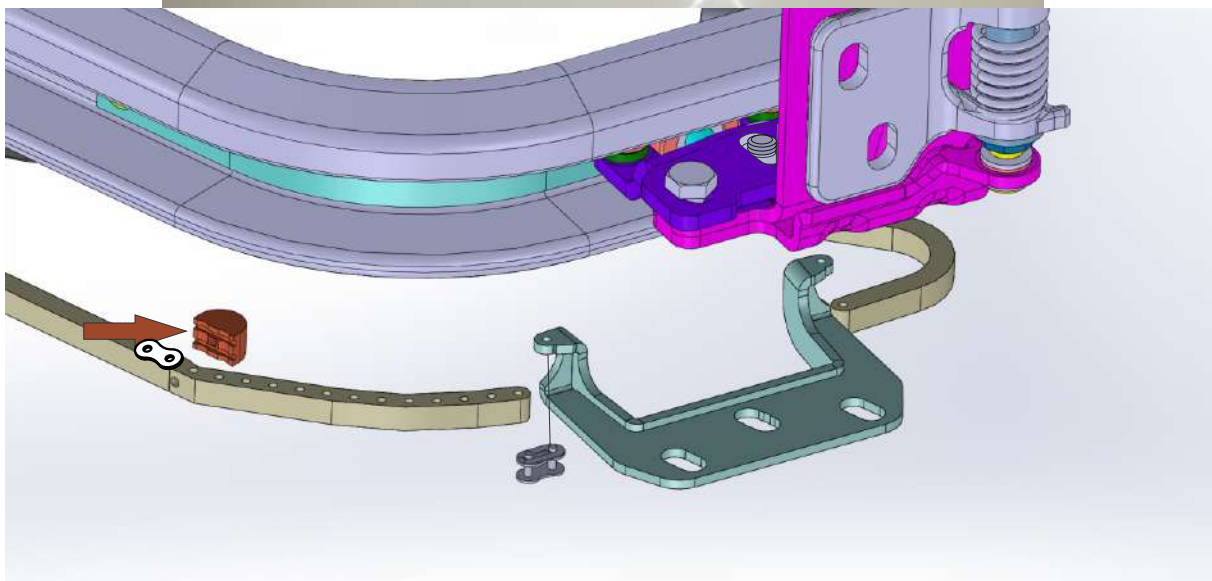
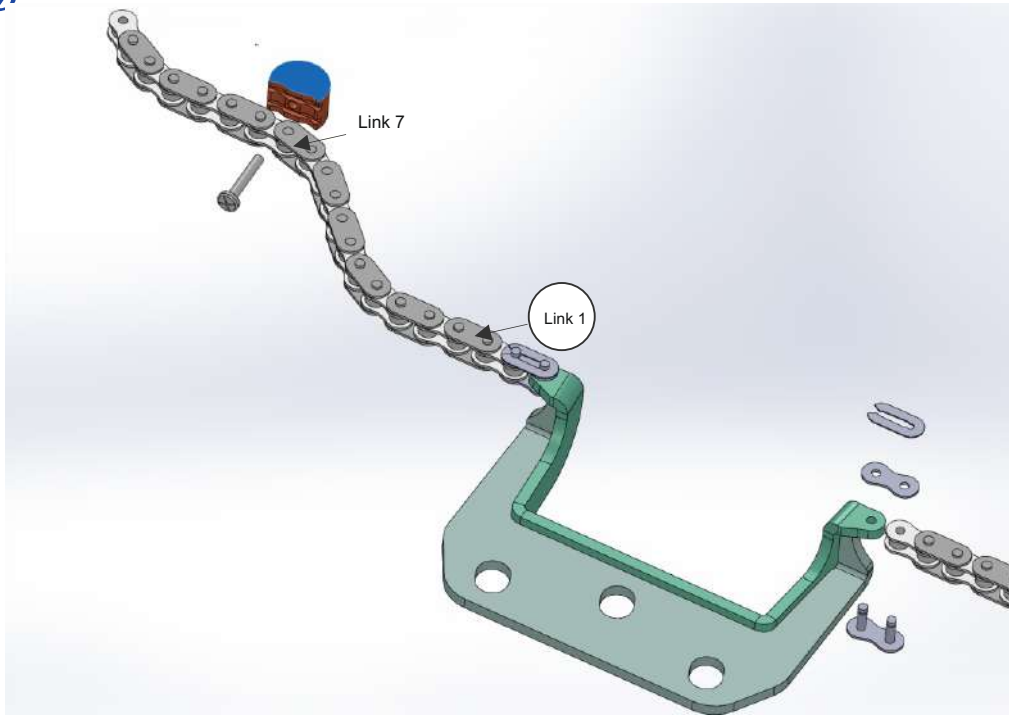

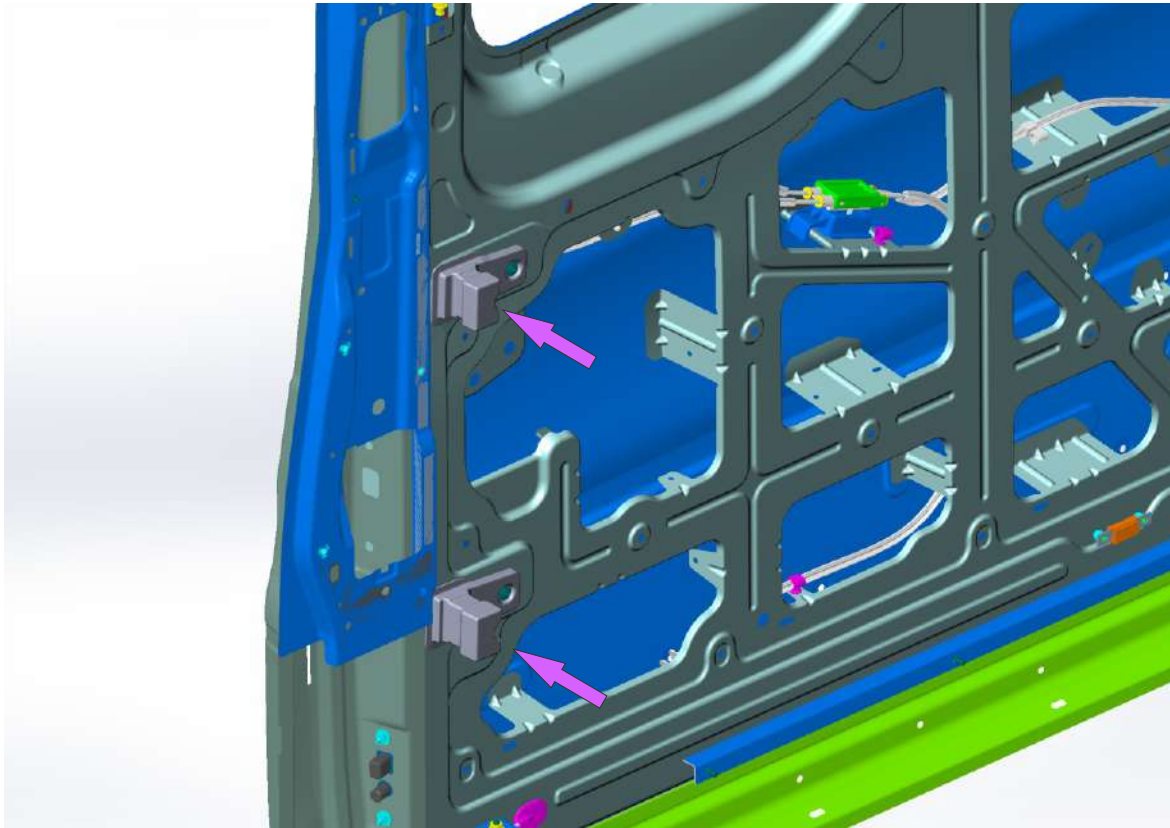

Two stoppers rotate 180 degrees

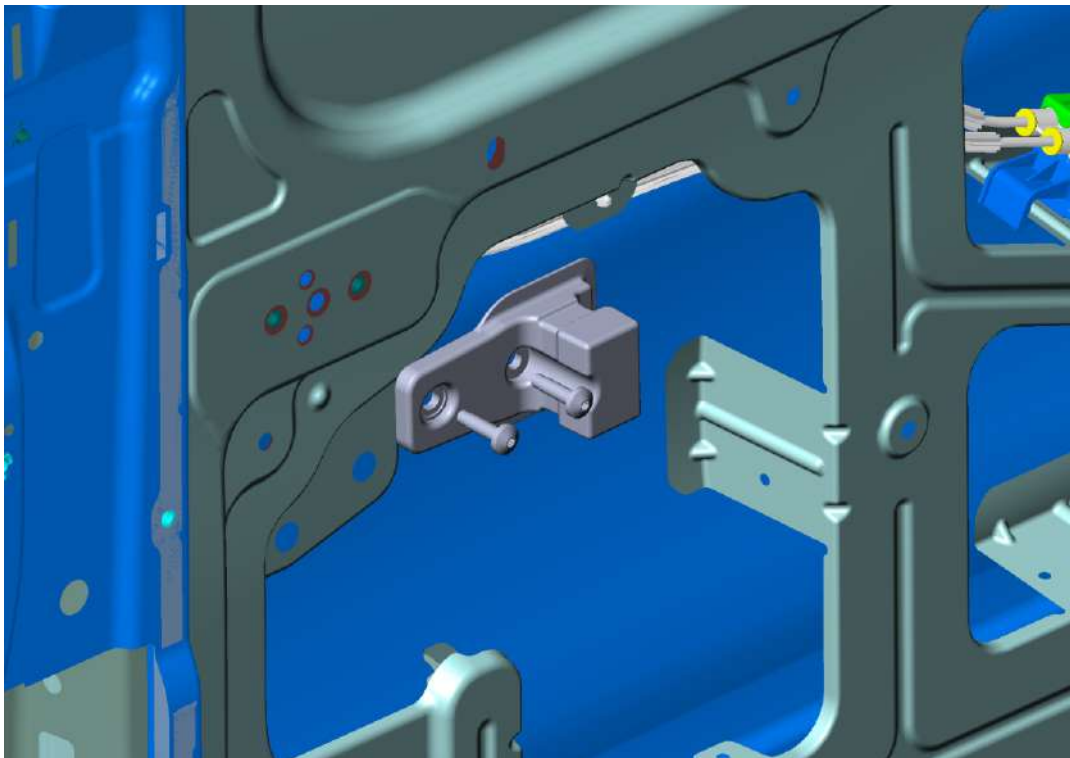

Plus wire installation

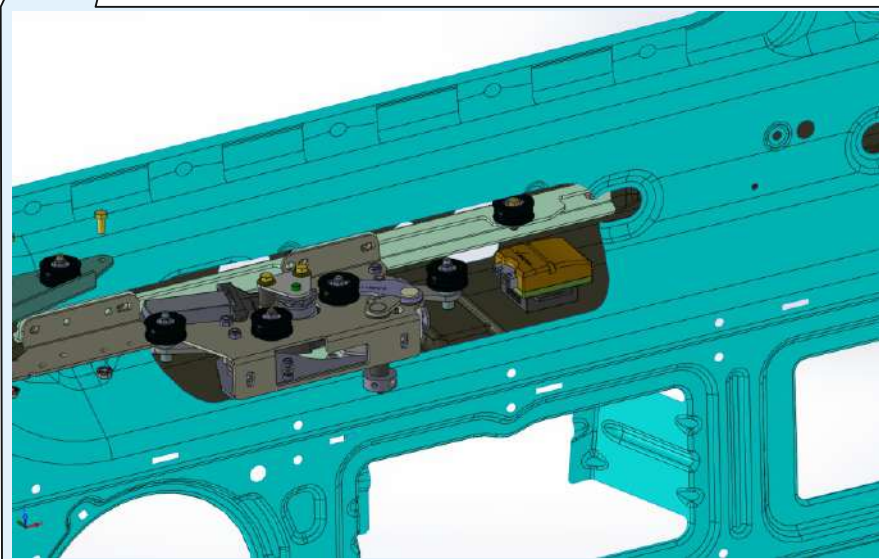
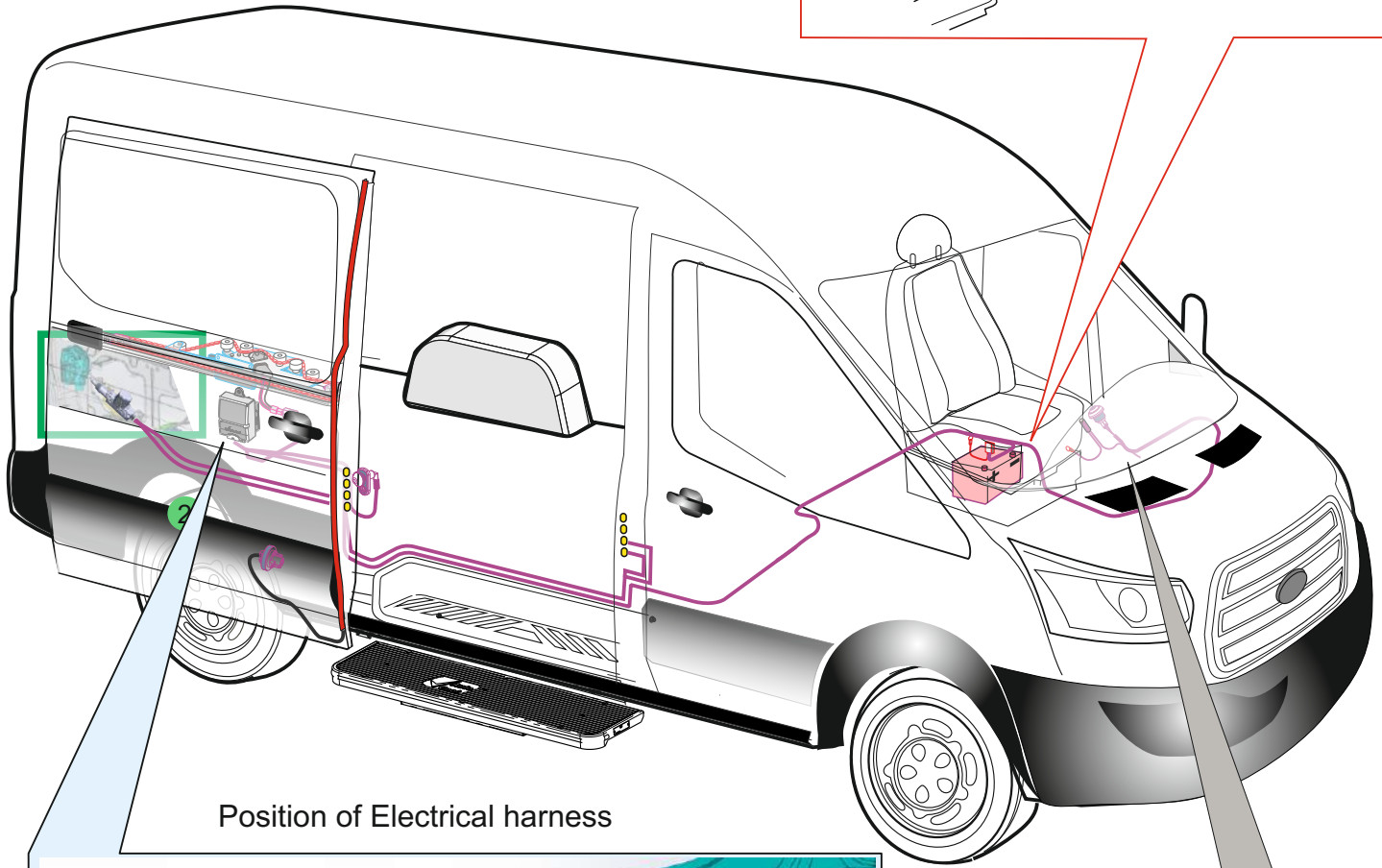
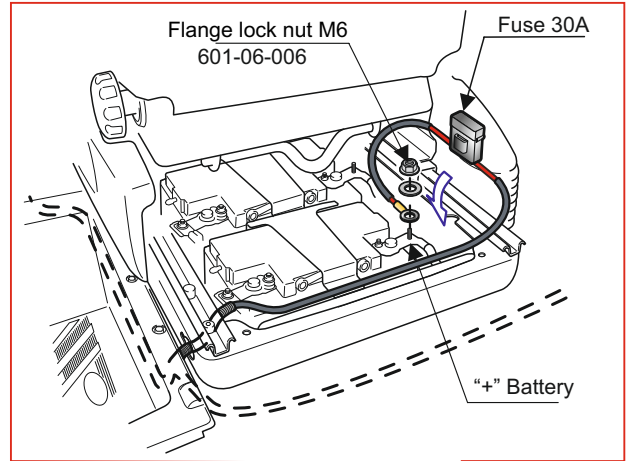

ASD controller install inside the vehicle close as possible to the mechanism/motor

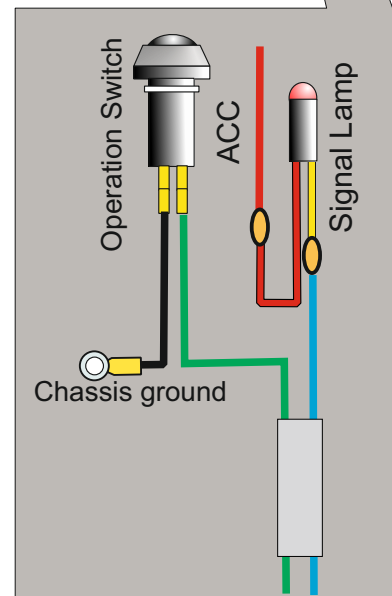

Electrical Accessories Kit

PN: 160-36-300



Operating Switch
 PN:124-02-012-1

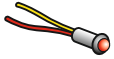

Signal Light
 PN:124-10-069



Decal
 PN:125-00-018

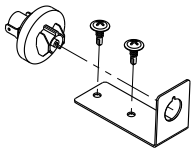

Pneumatic Safety Switch Assy
 PN:160-10-042

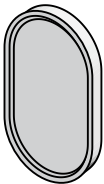

Cap (Spacer)
 PN:151-15-428



Screw 8x5/8
 PN:646-08-020

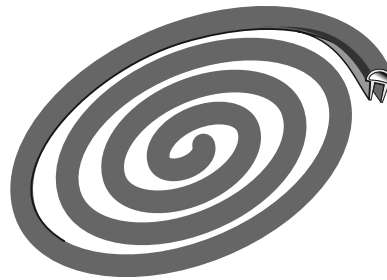

Pneumatic safety strip
 PN:113-65067



Pneumatic Plastic Tube
 PN:113-26063



Rubber Tube
 PN:113-06-067



Single barb connector 1/4"
 PN:113-15-047



Fast Glue
 PN:144-30-007

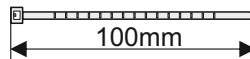

Cable strap
 PN:125-10-016

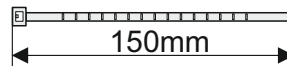

Cable strap
 PN:125-10-014



Door Limit Switch
 PN:124-00-039

Do not connect to the original limit switch, Install limit switch which comes in the kit

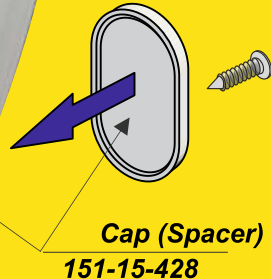
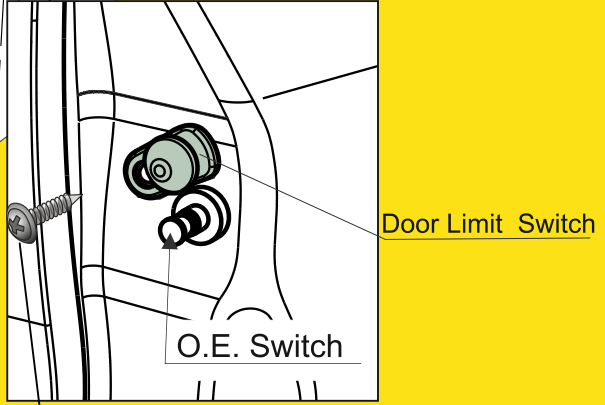
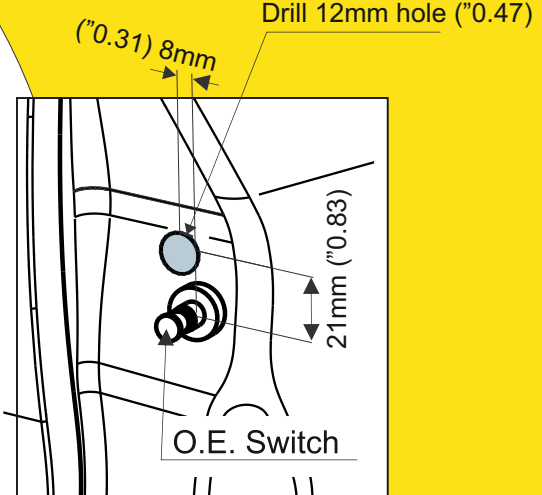
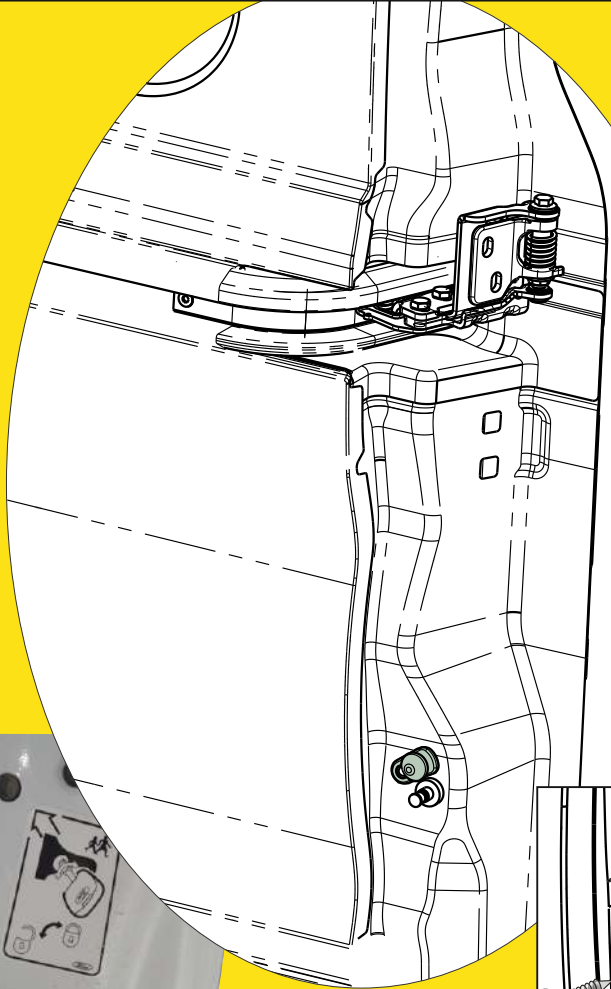

Self drilling screw 8x1/2"

Apply grease on surface of switch



Glue and press for 60sec to dry
 Be sure no leak

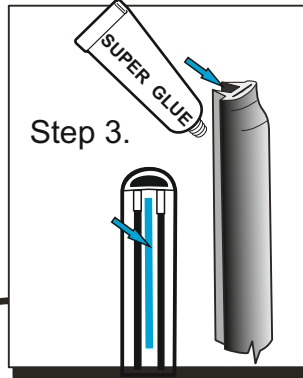
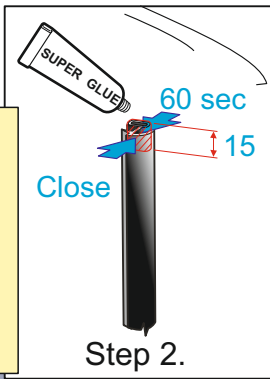

Clean surface carefully with alcohol to insure good contact of the pneumatic safety strip.
 ← Step 1.

Pneumatic Safety Strip
 PN: 112-06-109

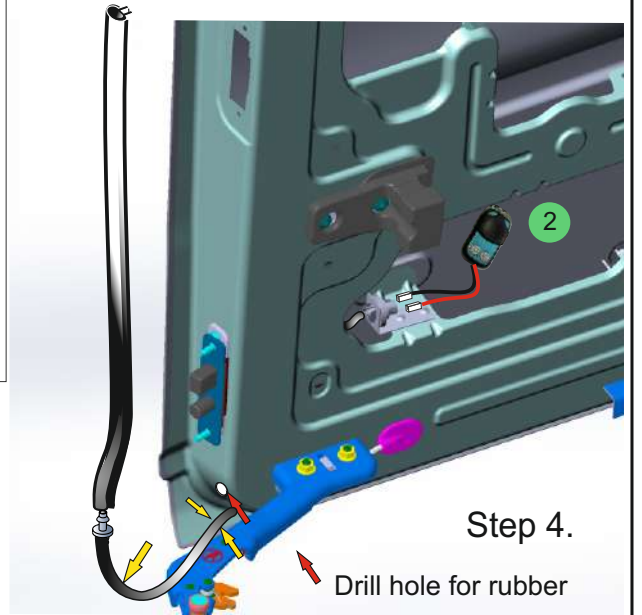
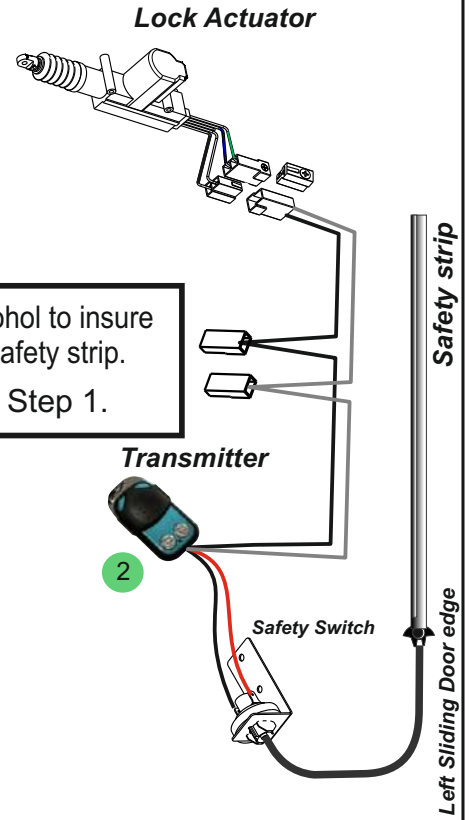
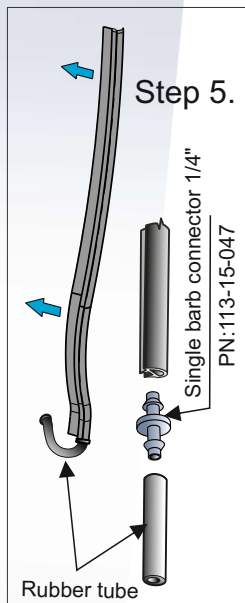

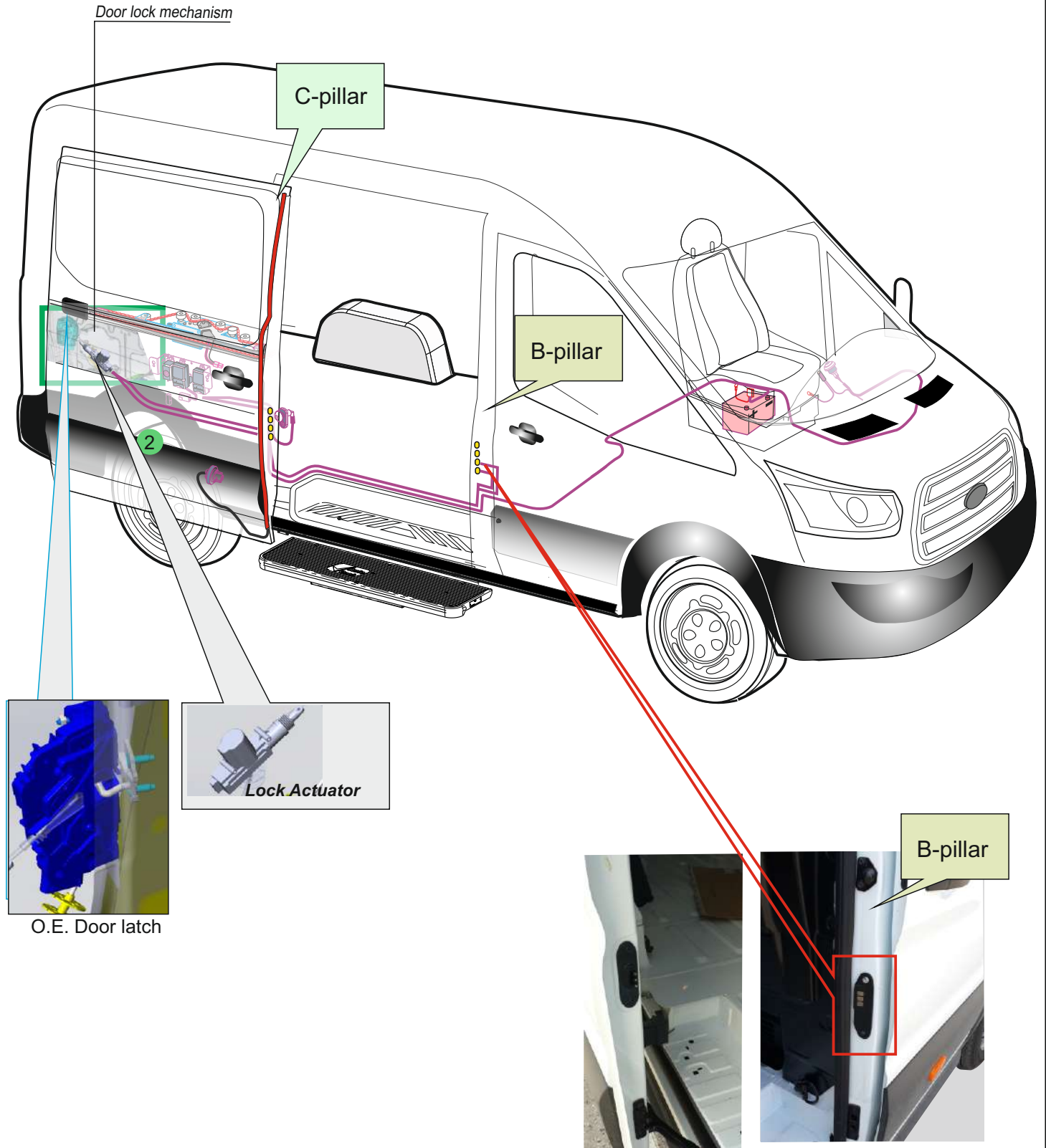

ASD V363 Ford _Original Door Latch ASSY

160-36-302

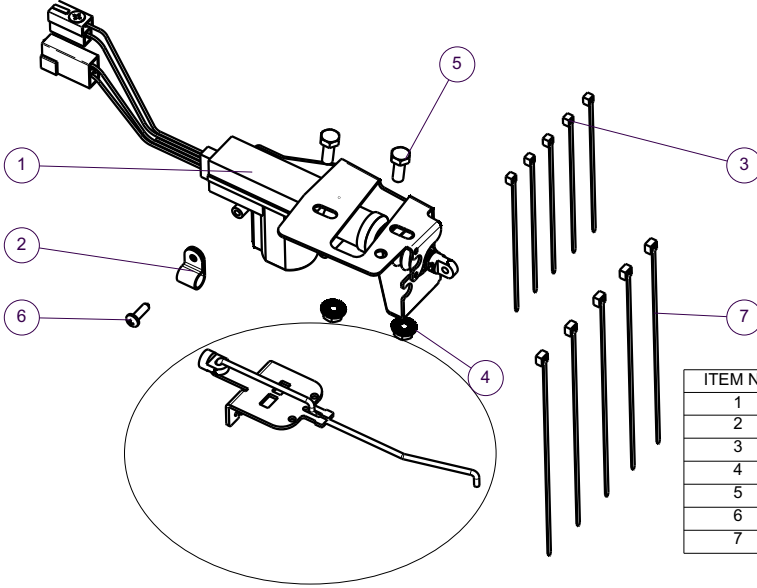

ITEM NO.	PART NUMBER	DESCRIPTION	QTY.
1	111-36-355	Actuator bracket ASSY.	1
2	125-10-005	Plastic clamp UC-2 3/8"	1
3	125-10-016	Cable strap 100mm	5
4	601-06-006	Hex flange nut M6	2
5	632-06-016	Hex cap screw M6x15	2
6	646-08-020	Phillips screw 8x5/8"	1
7	125-10-014	Cable strap 150mm	5

Lock Actuator ASSY.

111-36-355

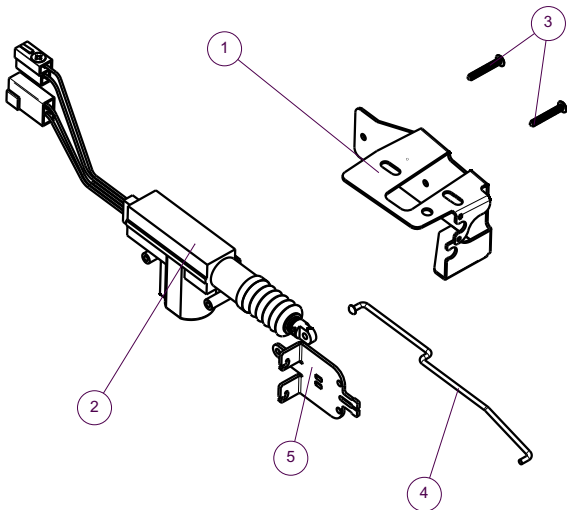

ITEM NO.	PART NUMBER	DESCRIPTION	QTY.
1	128-36-359-1	V363 Actuator bracket	1
2	110-01-006-10	Lock actuator ASSY	1
3	110-01-006-Screw#4		2
4	128-36-310	V363: Lock Actuator arm	1
5	128-36-360-1	Cables adapter	1

Internal door handle cables

External door handle cable

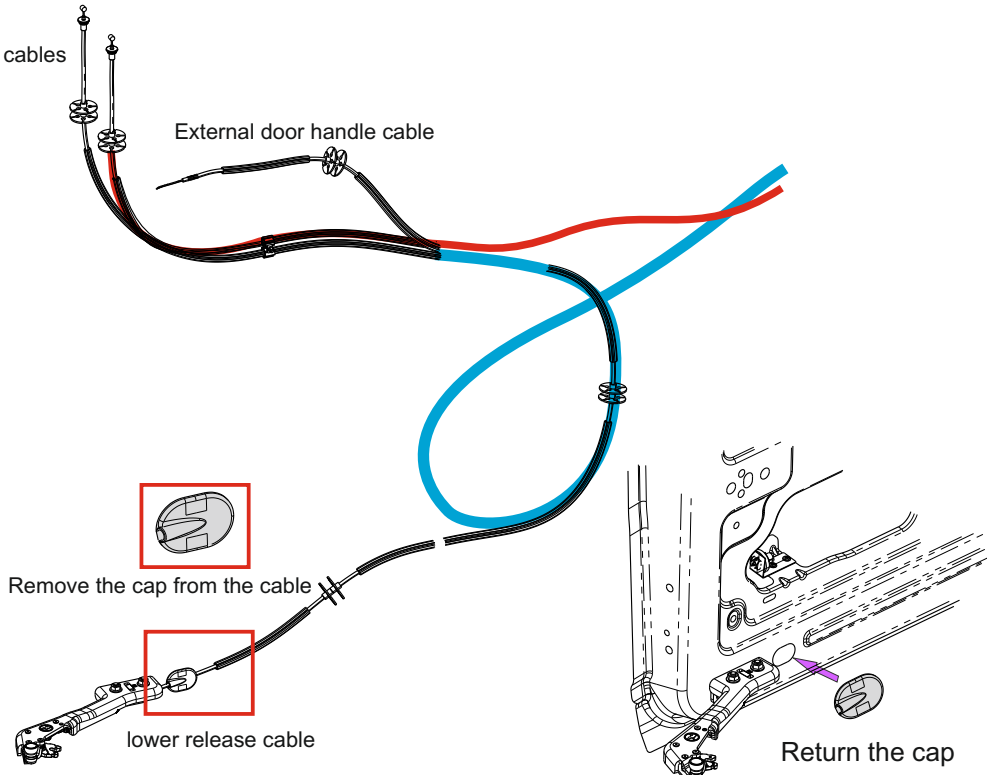

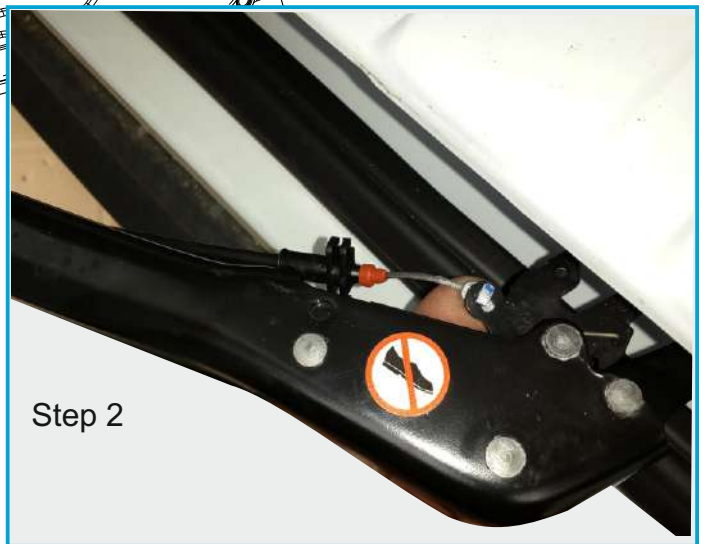
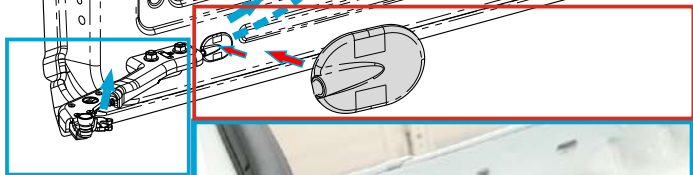
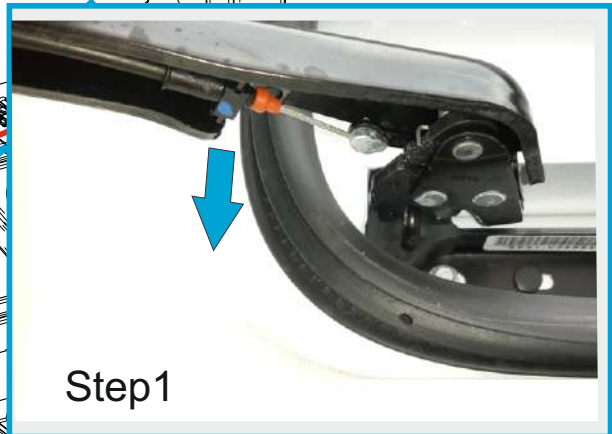
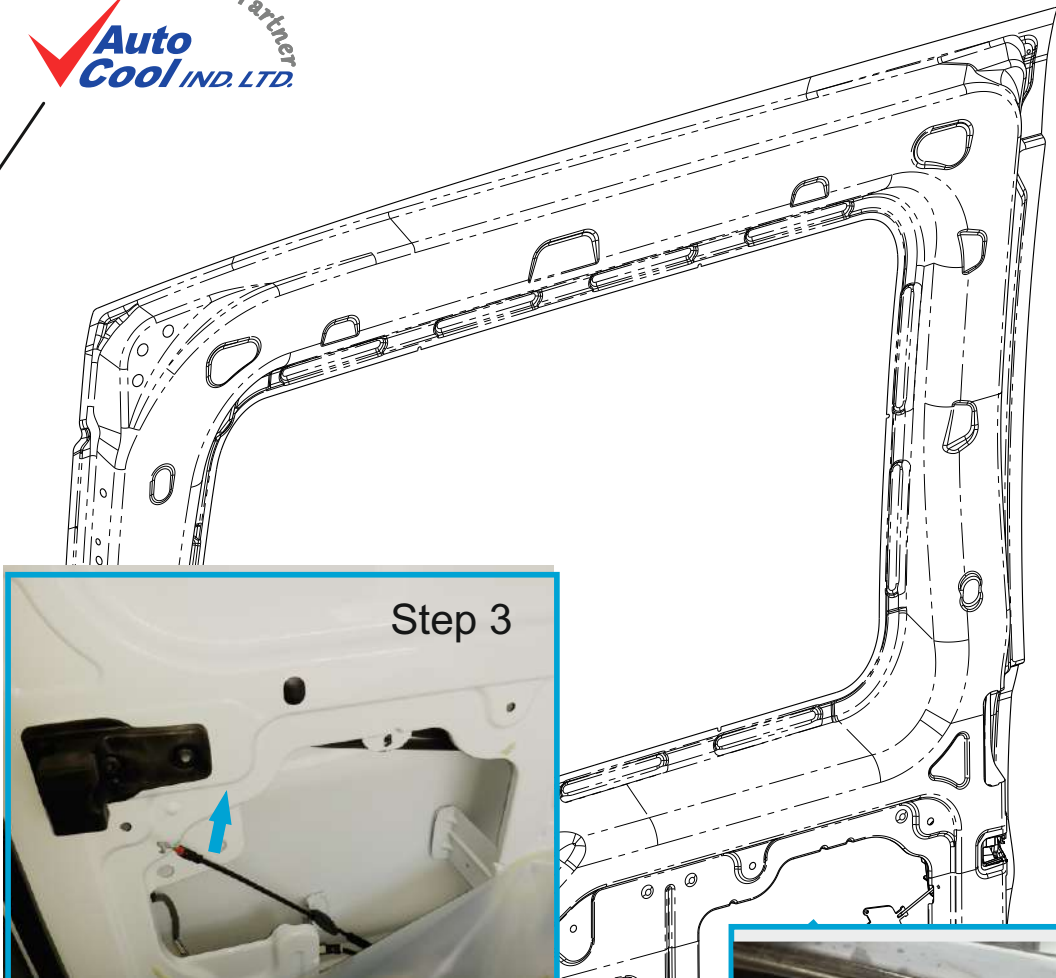

Disconnect

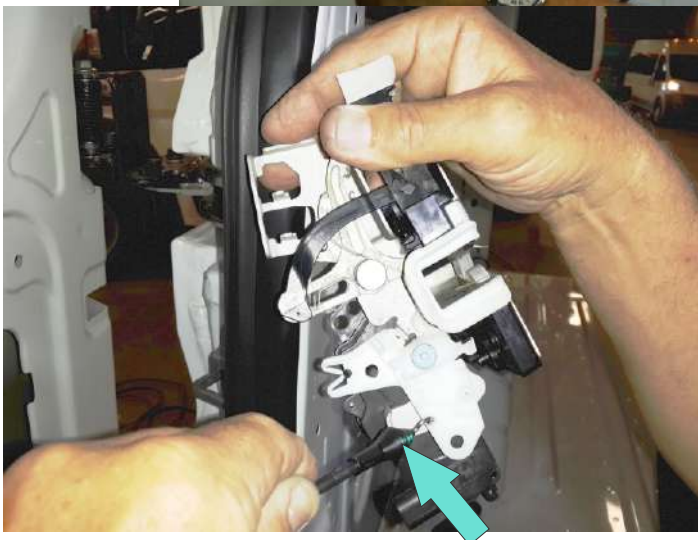

Disconnect

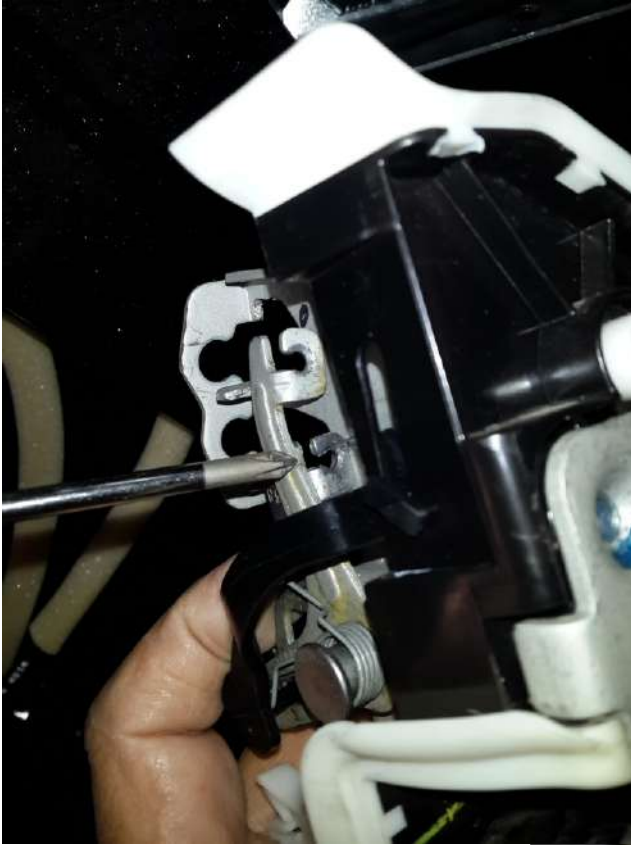

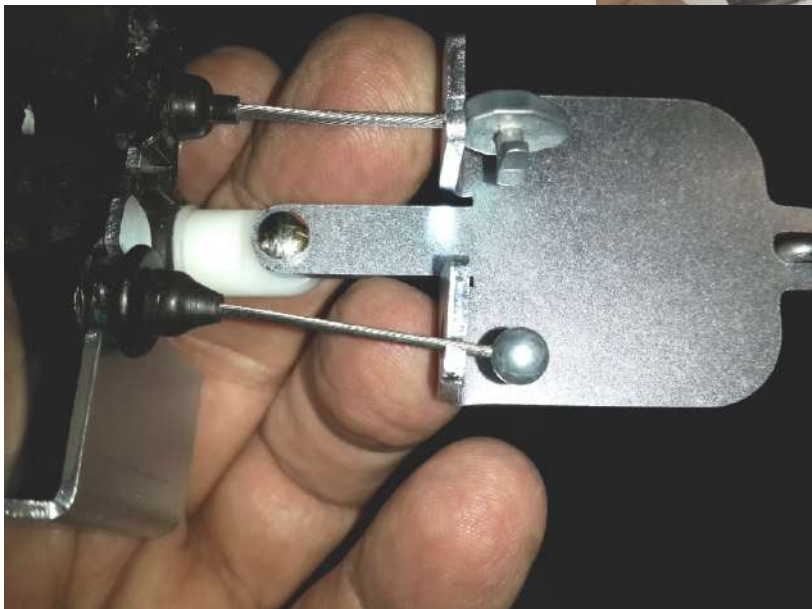
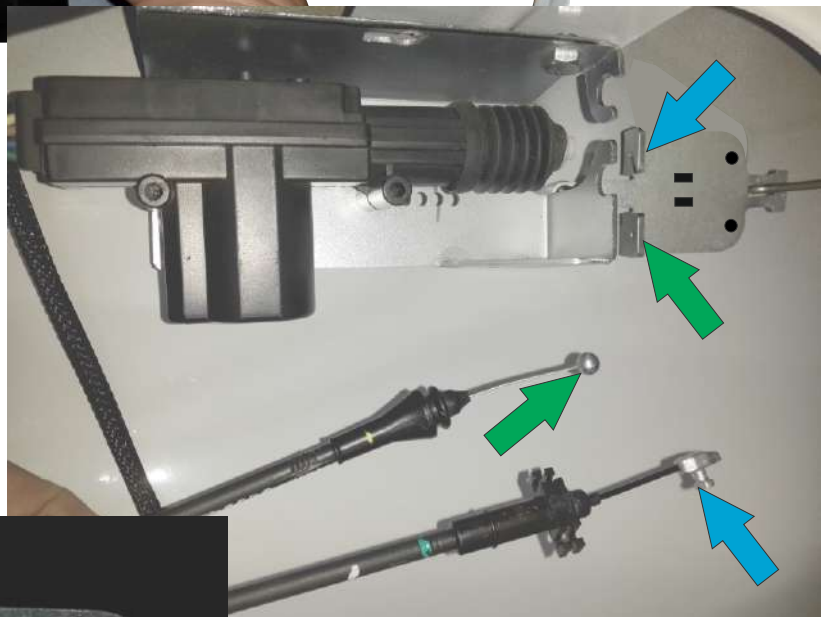
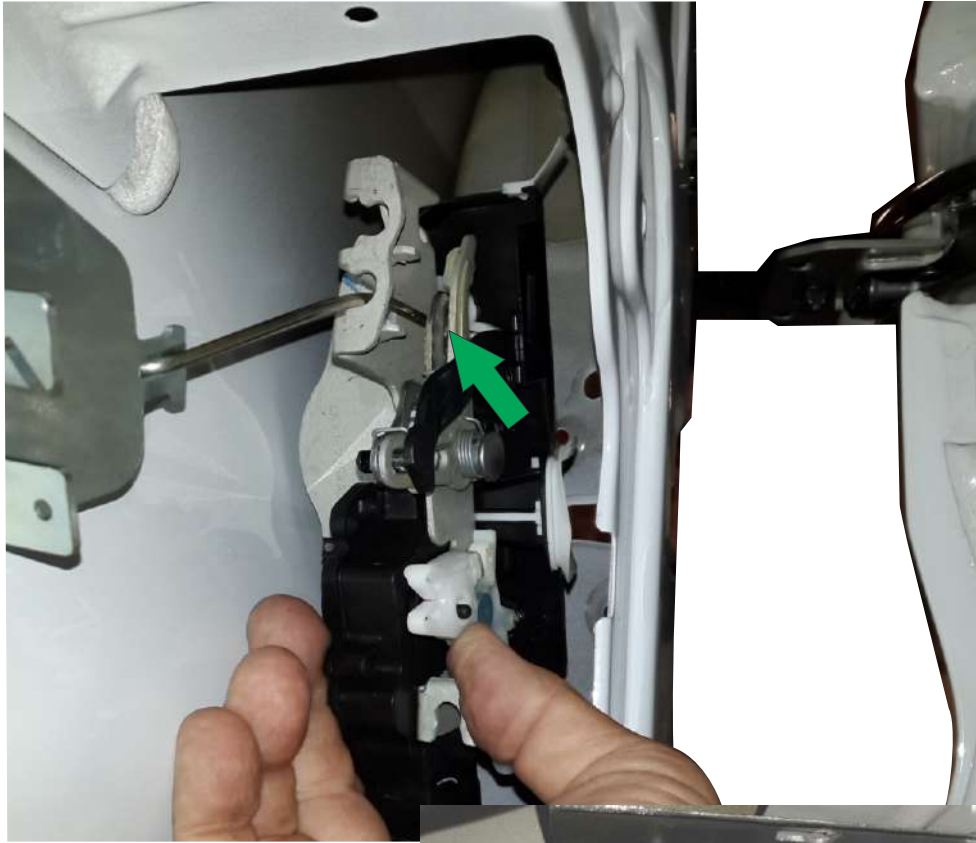

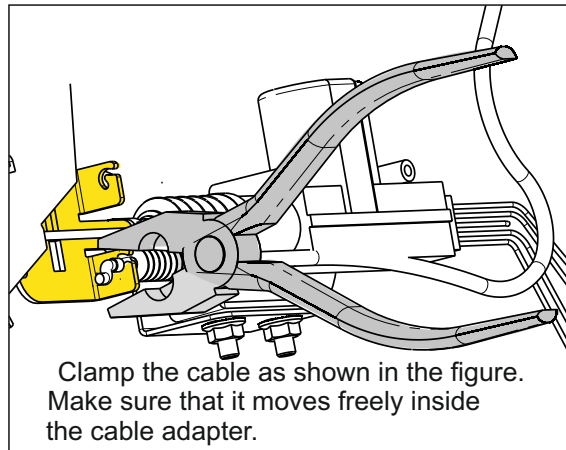
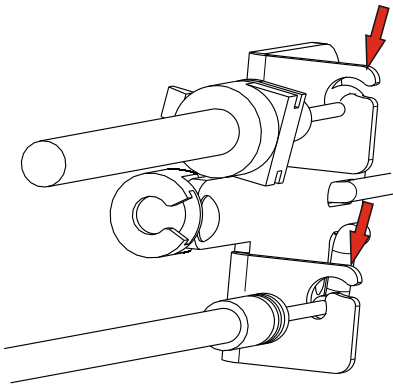
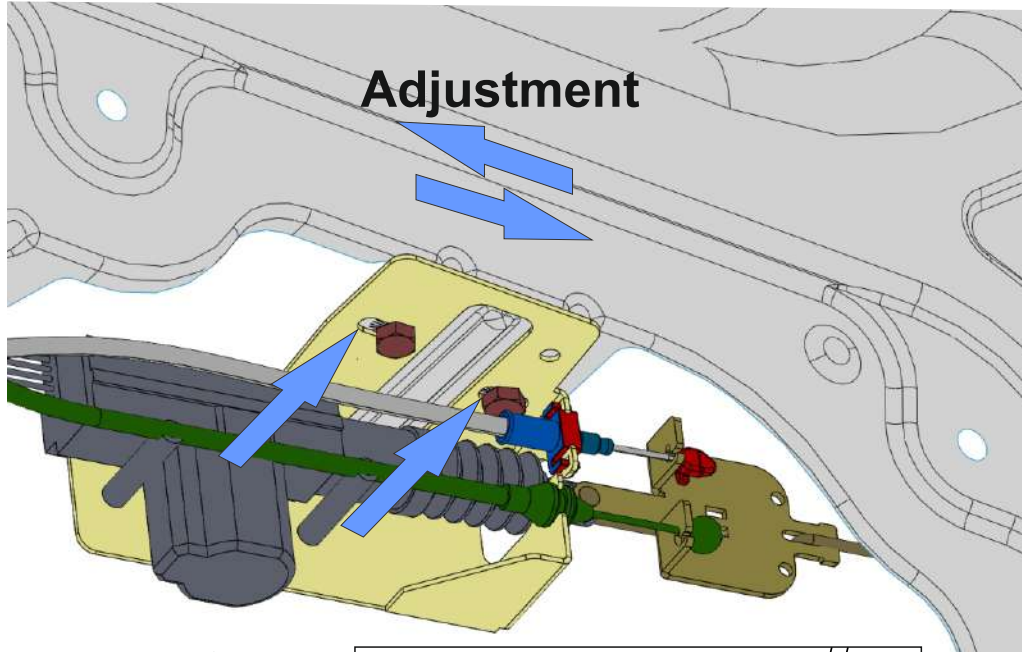

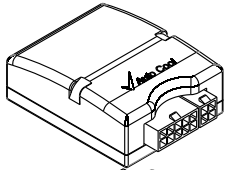

ASD controller AK-105-14pin
 PN: 124-14-105

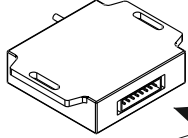

REMOTE CONTROL UNIT
 PN: 124-02-006-1



Modified transmitter
 PN: 124-02-007-DL

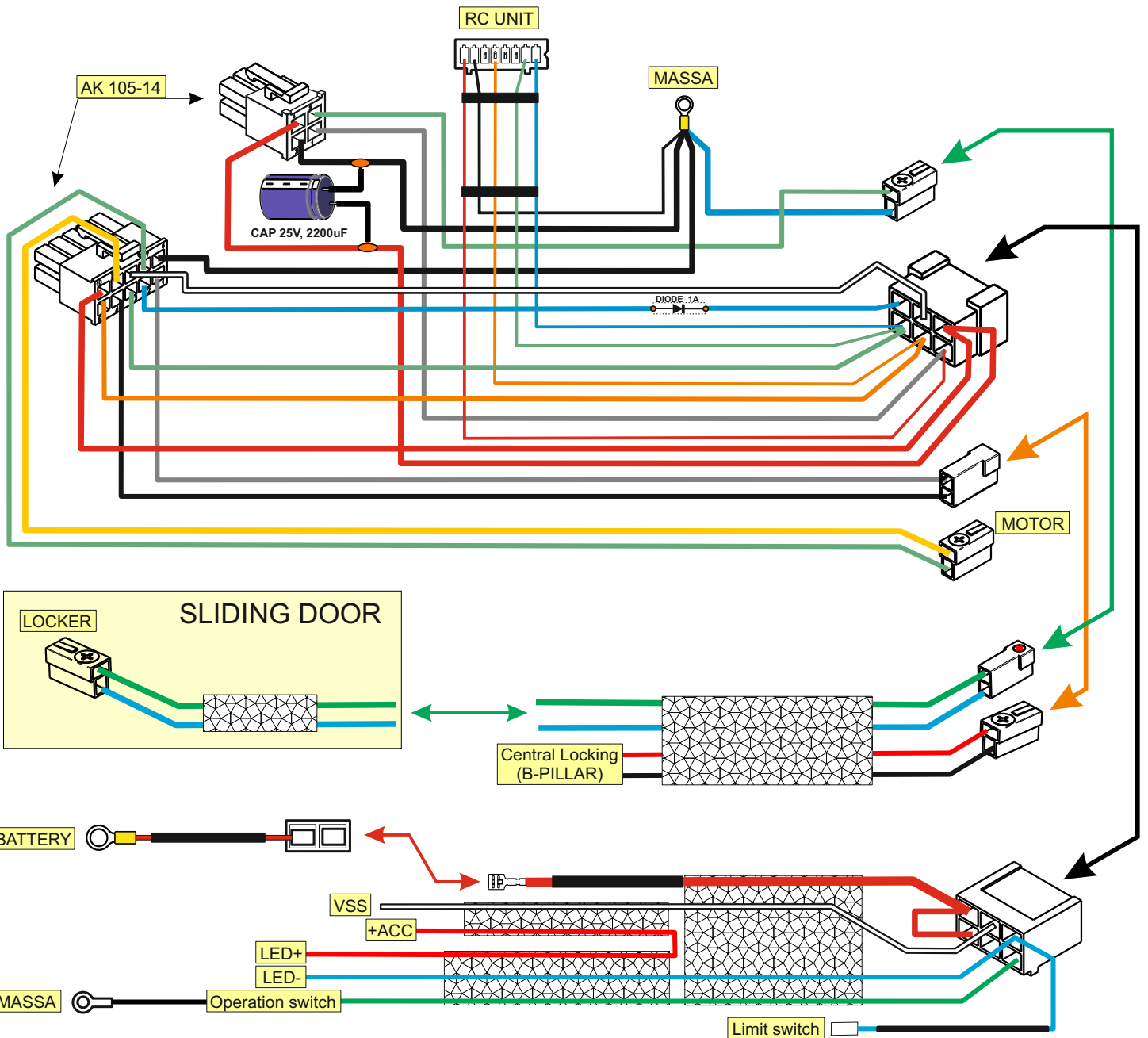
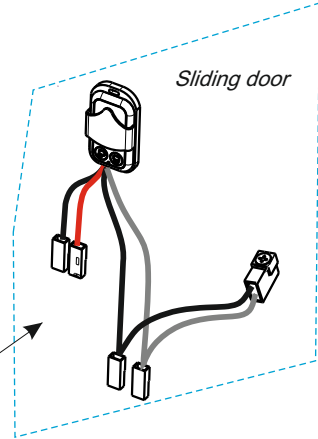

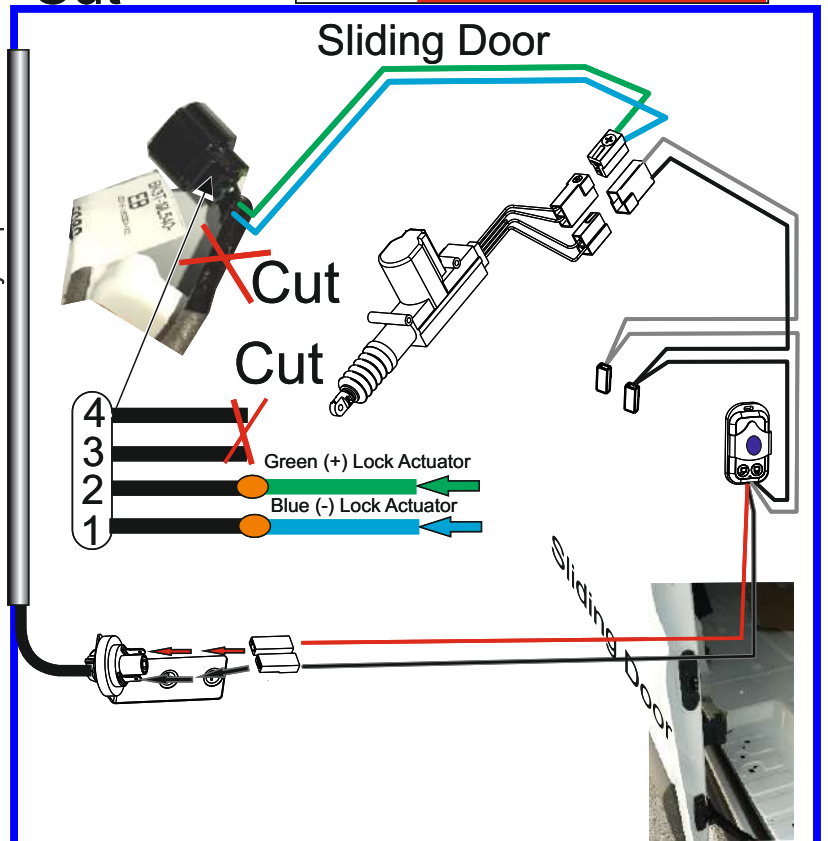
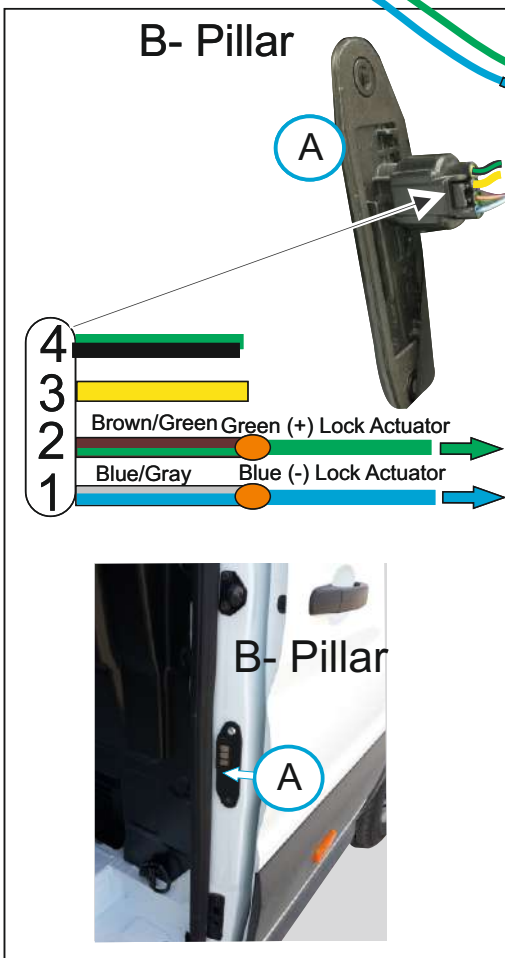
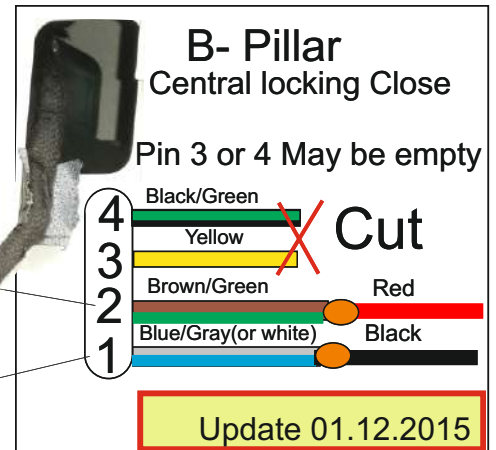
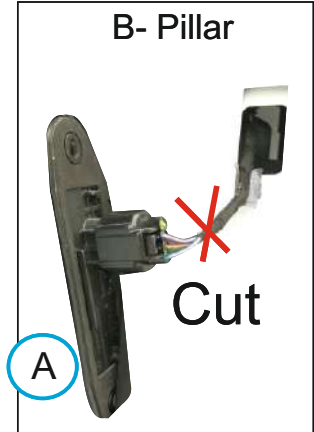
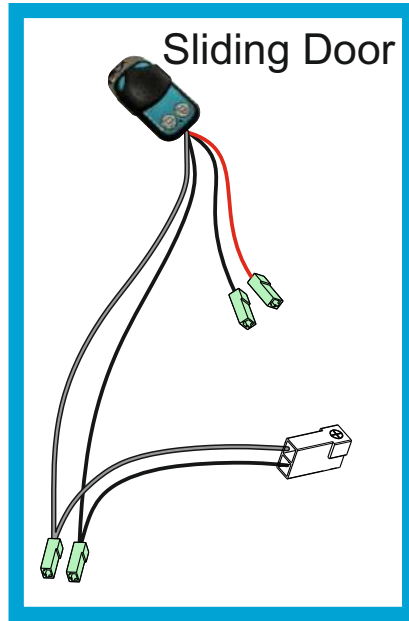
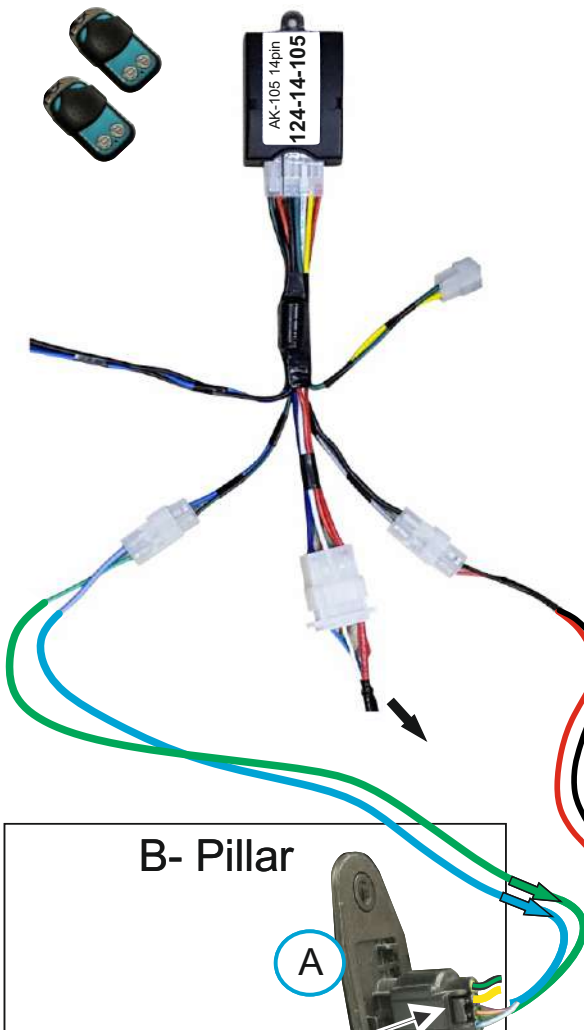

● - Solder and isolate

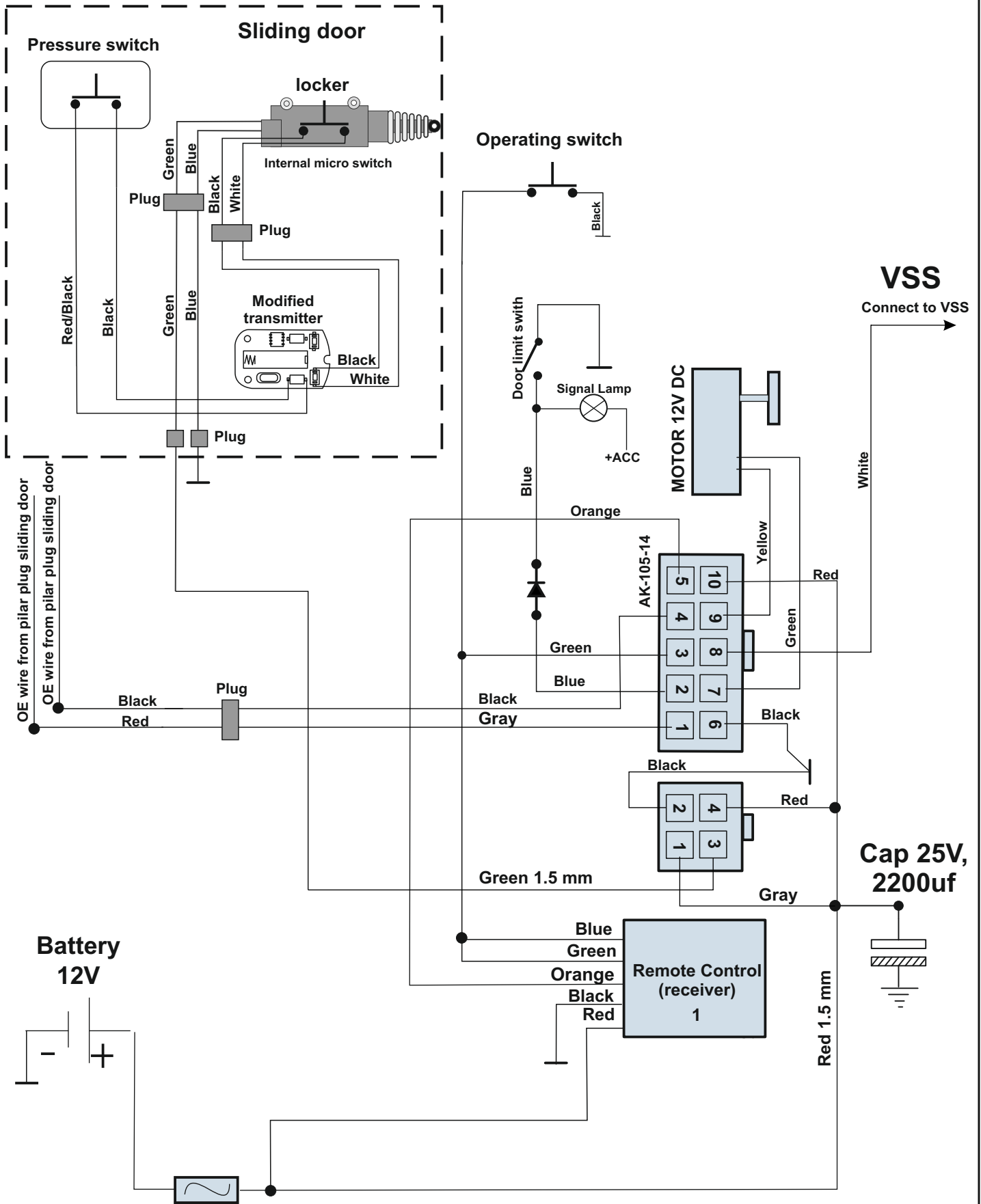

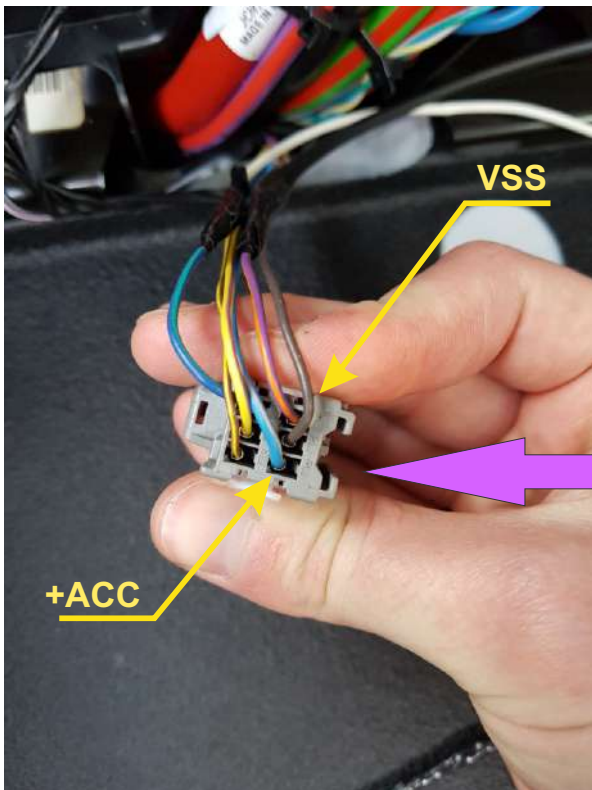
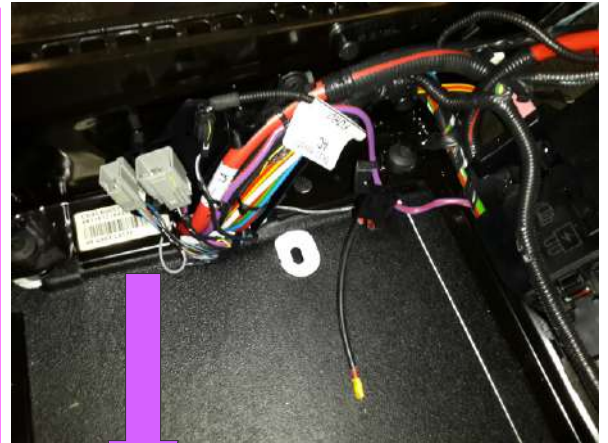
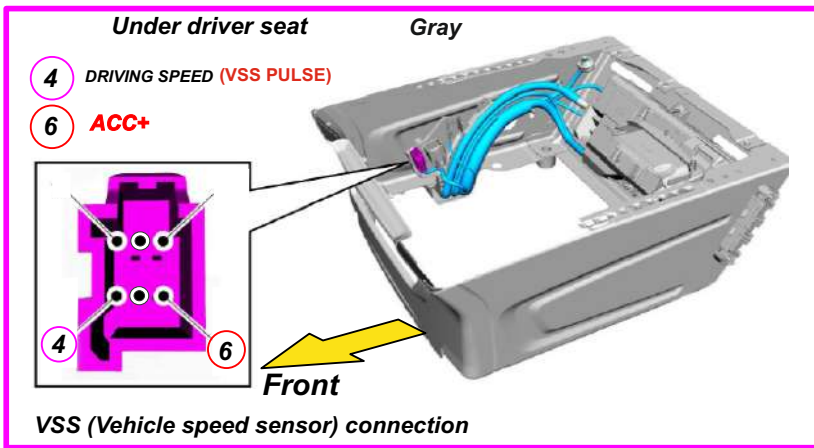

PN: 015-3632-DL
Ford Transit Van

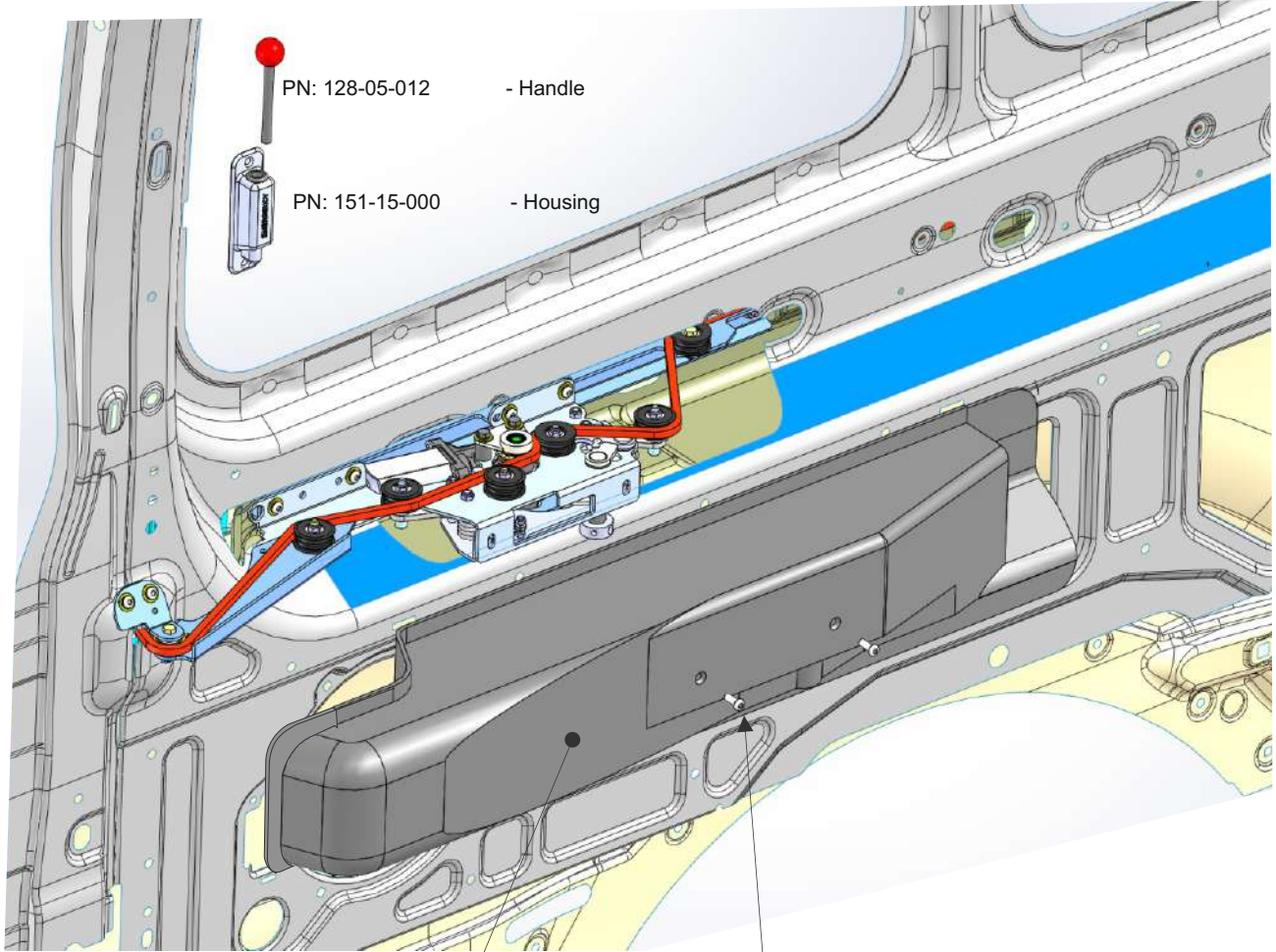

PN: 151-36-301-Cover

Phillips screw M6



PN: 015-3632-VDL

Ford Transit Seats Interior (Wagon)

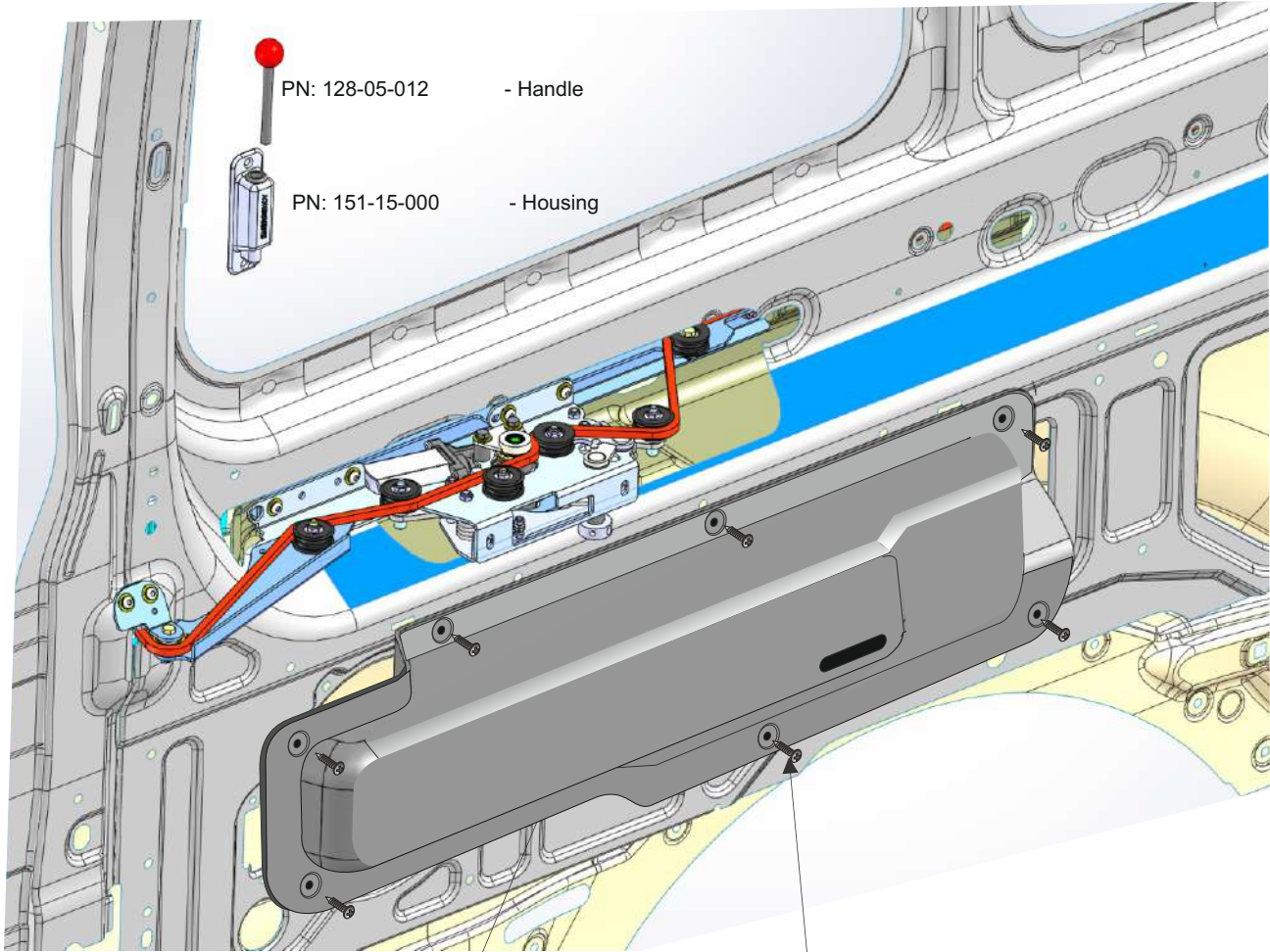

PN: 151-36-301VG
Cover

Phillips screw





ASD
Automatic Sliding Door
External emergency
door opening kit
PN: 111-03-013

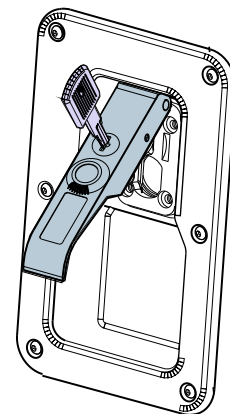

Option

Gear-motor ASSY.

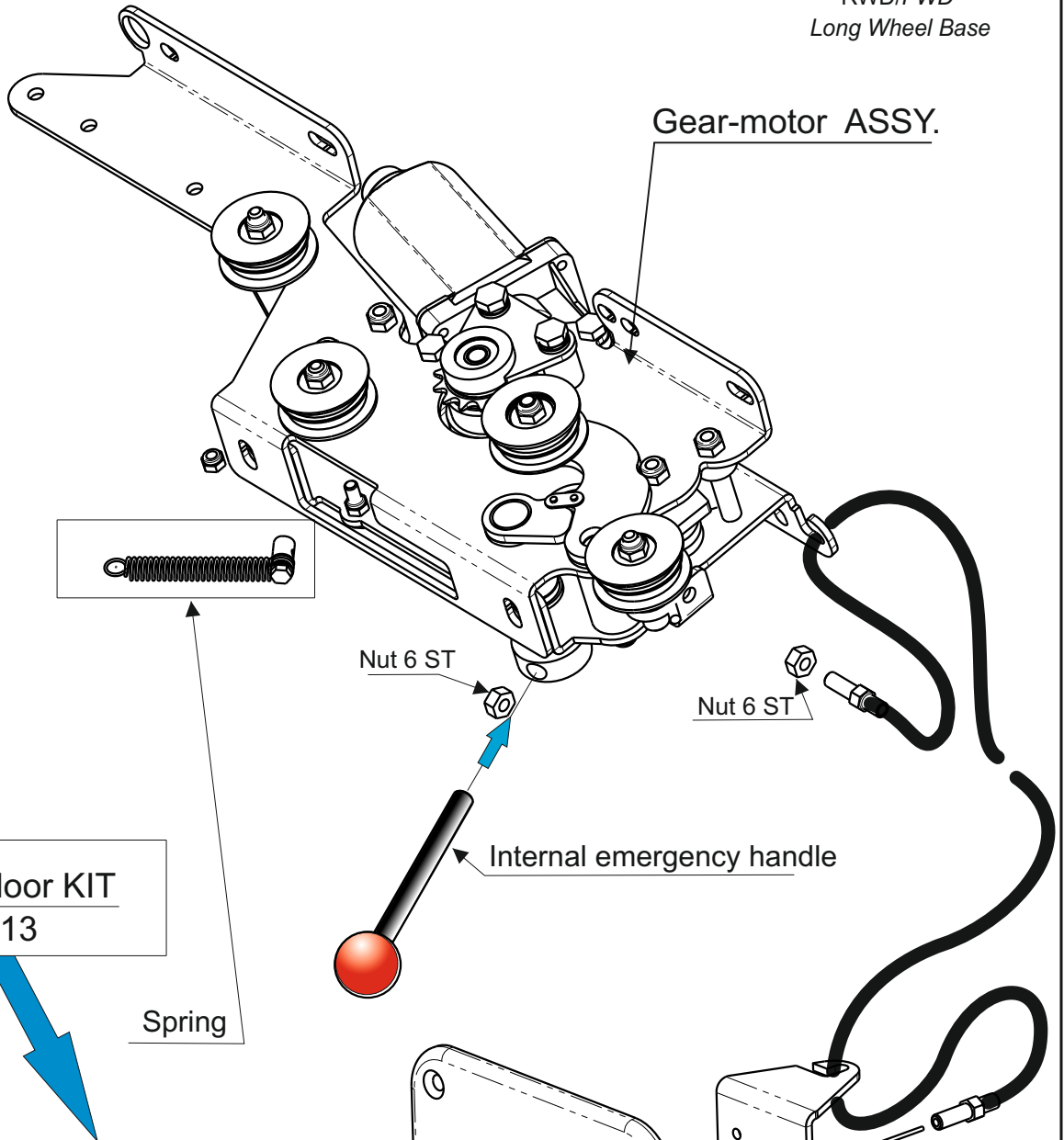

Emergency door KIT
PN: 111-03-013

Spring

Nut 6 ST

Nut 6 ST

Internal emergency handle

Bracket
PN: 128-03-013A

Emergency door handle
PN: 111-03-0131

Socket head M5X16

Emergency handle cover
PN: 151-03-131

Figure1

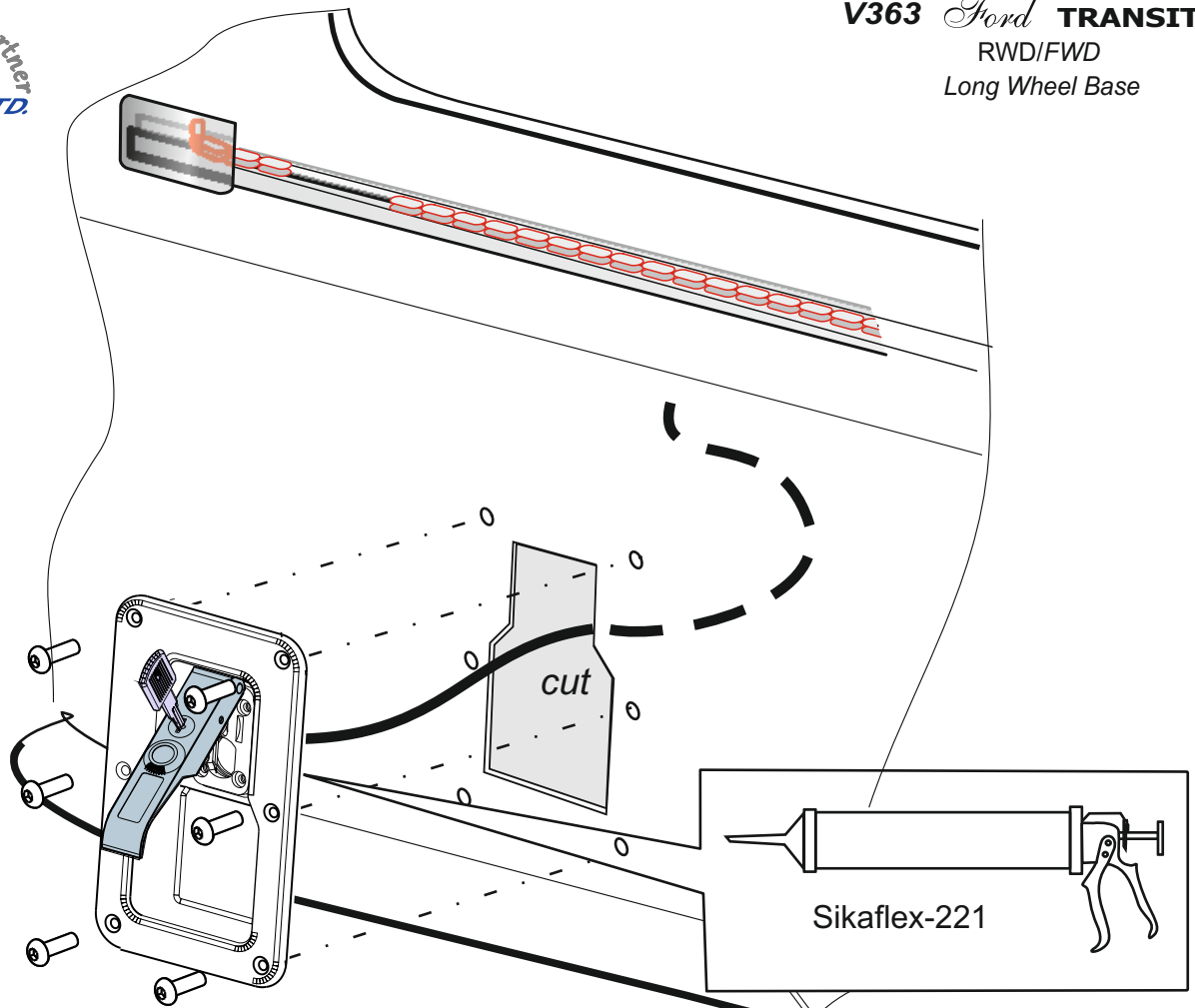

Install the external handle for emergency opening door

Figure2

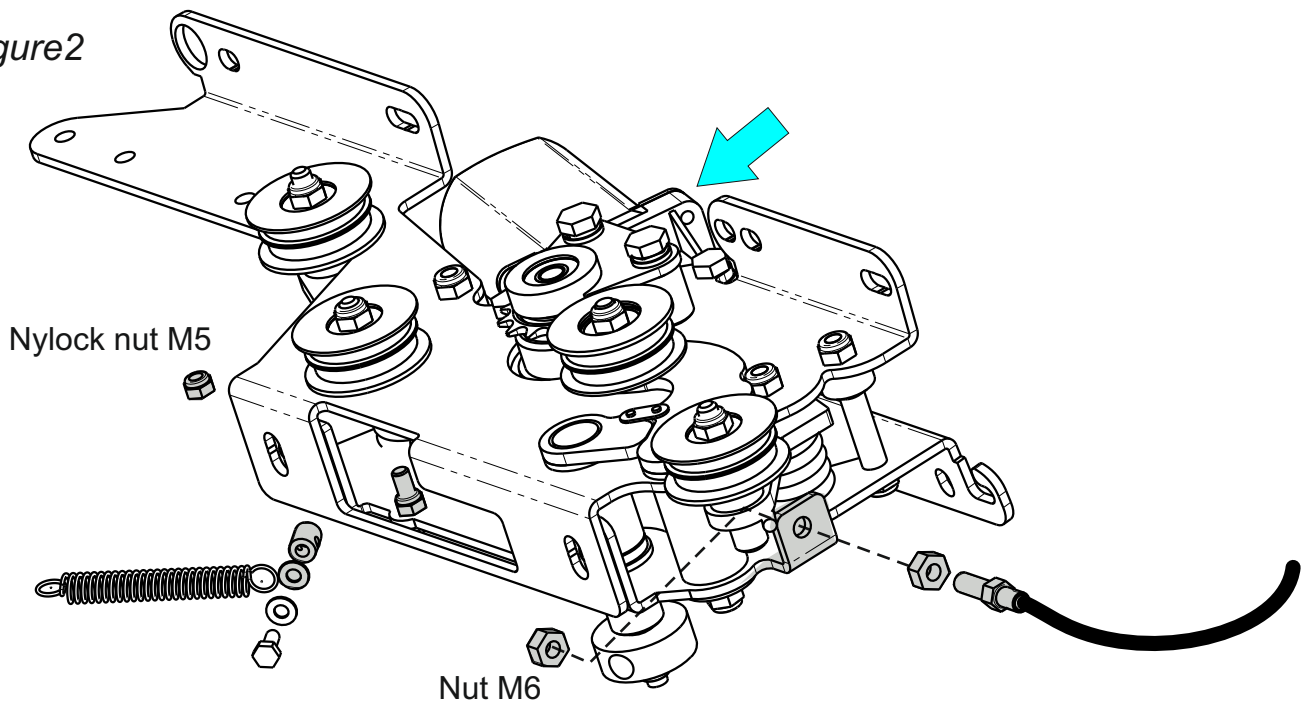

To install the cable:
Verify that the Internal emergency handle is on closed position.
Insert the cable into the hole (see figure 2) fasten nuts M6

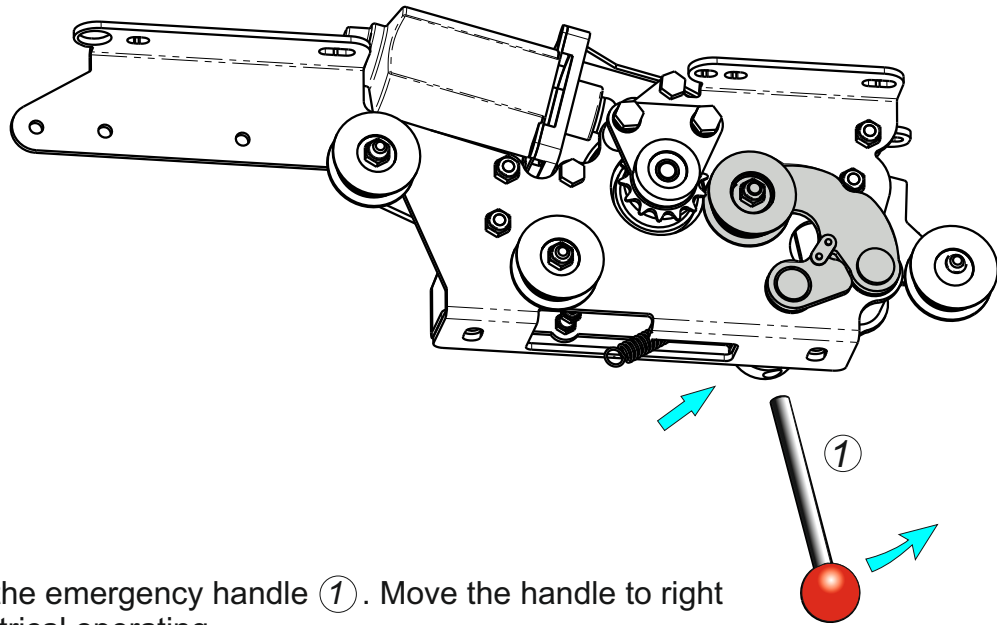

Insert the emergency handle ①. Move the handle to right for electrical operating

Install the cable

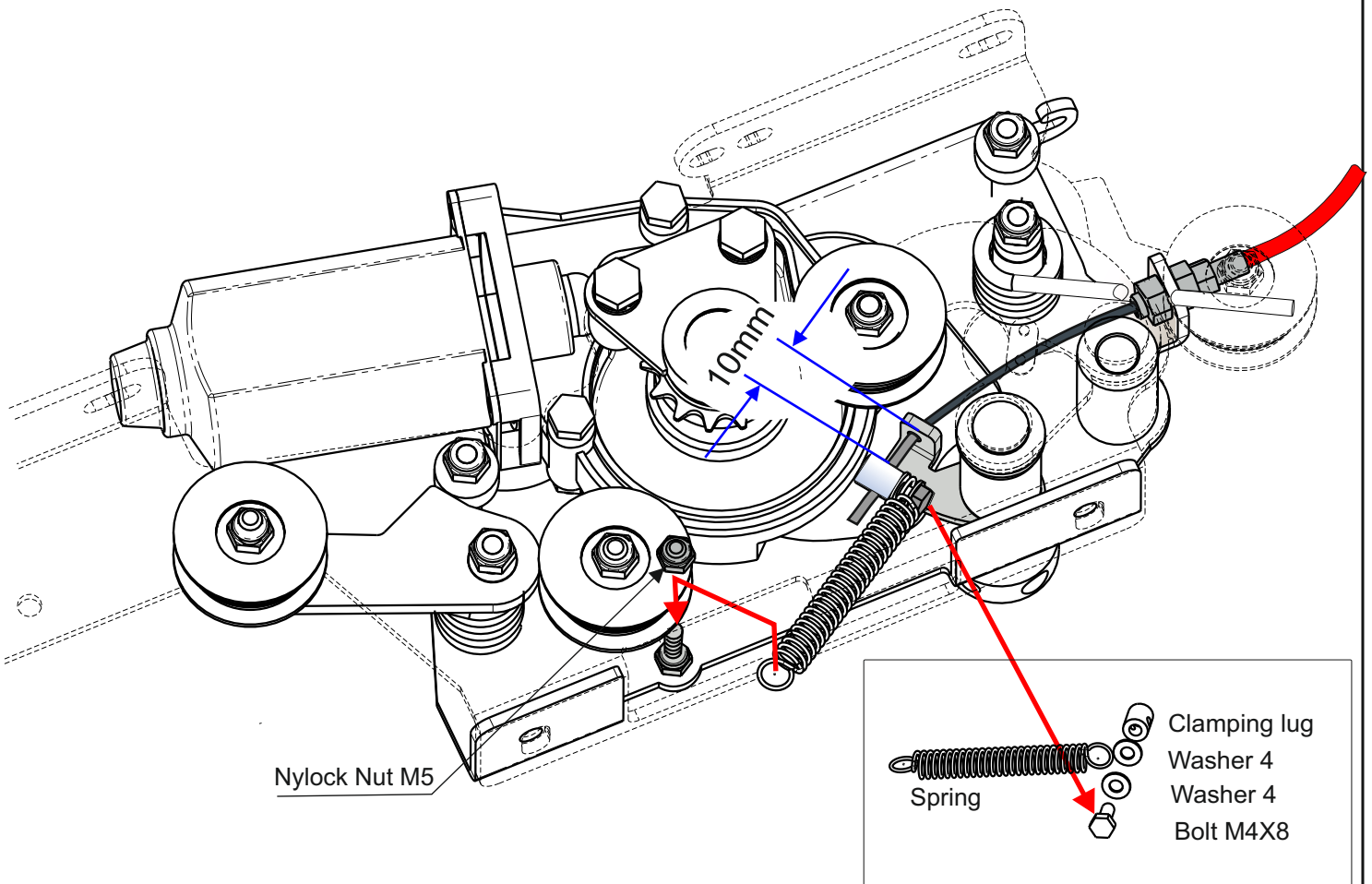

Pneumatic safety Switch

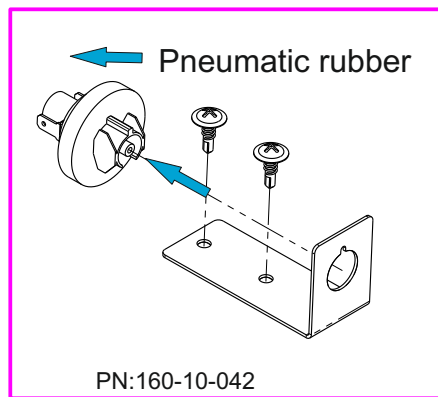

Pneumatic Switch
PN:122-10-047

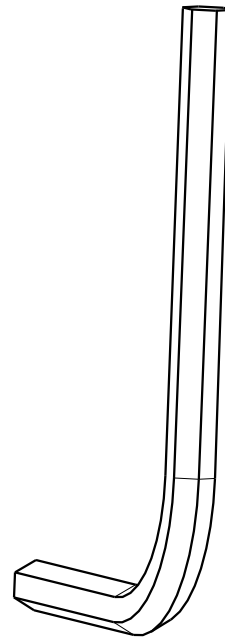
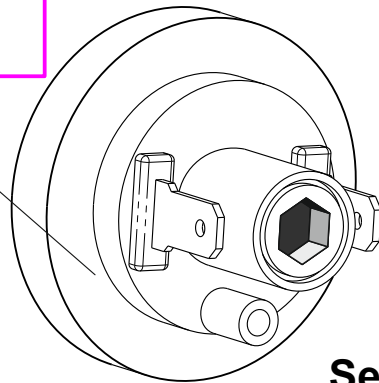

Hex key
N 4mm

Sensitivity adjustment



Increase Sens



Decrease Sens

PN:160-10-042

Replace or add new Transmitter (key) to the Remote Control Unit

1. Press and hold lock button (left knob).
2. Press the receiver programming button one time and release.

Delete: press and hold programming button about 10-20 seconds.

Lock Button

Programming Button



Automatic Sliding Door user's Manuel

The Automatic Sliding Door system (ASD) manufactured by Auto Cool Ltd conforms with the requirements of the European regulations. The ASD is approved by the German TUV in Munich it complies with the **EEC DIRECTIVE 72/245EC and obtained the certificate of compliance No 2004/104/EC.**

Operation Instructions

- The door is operated by a switch located on the dashboard:
- To open**—press the switch shortly, door opens to end of its range.
- To close** - press the switch shortly, door closes and locks.
- To change its direction while in motion** - press the switch shortly - the door will stop; press the switch shortly again - the door will change direction.
- To control opening range** – Continuous pressure on the control switch will set the door in motion upon its release, the door will stop.
- Visual status indications** – When the vehicle's main ignition switch is on the indication light is visible in the ASD control switch:
 - Dim light – the door is closed.
 - Bright light – the door is open.
- Audio status indicators** – **Independently of the vehicle's main switch** – the vehicle's buzzer is always functioning whenever the door is in closing motion.

Safety measures

The system includes **safety features** to protect the passengers.

- Closing** – When encountering an obstruction, the controller automatically reverses the door direction to open full way .
- In addition, a pneumatic switch is attached to the front side of door pillar, which upon sensing pressure performs the same function and retracts immediately.
- Opening** - When encountering an obstruction, the controller stops the door.
- ASD system connects to OE VSS device and operates only at speeds of less than 5 km/h.

Emergency facility

The system has inside and outside (optional) emergency releasing handle. Pulling one of them will result in disconnecting the ASD mechanism device and the door will function normally immediately.

Please note:

The system performs automatic reset after the ASD has been disconnected from the power either when replacing the fuse or by disconnecting the Battery. The system resets itself within two minutes; Please be patient.

ASD: Basic Troubleshooting

1. Door does not function.
 - Check main fuse.
 - Check connections of power terminals to the control unit, motor and operating switch.
 - Check Control units AK-105L
 - Check motor.
2. Door does not operate upon commencing the closing mode or when reaching the fully closed position it reverses.
 - Check the safety pneumatic pressure tube; disconnect the plugs of pressure switch and close the door.
 - If the issue is not solved, try to regulate the sensitivity of the pressure switch.
 - Check safety switch.
 - Reset the system by extracting the fuse and returning it to its place.
 - Check control unit – AK105.
3. Door does not close completely.
 - Check voltage of battery, if low, start the engine.
4. Door does not open, although the electrical motor is engaged.
 - Check position of the locker unit, which annuls the OEM locking system of the door.
5. Door does not automatically reverse when encountering an obstruction during the closing mode.
 - Check safety pneumatic switch.
 - Check pressure tube & switch.
 - Check control unit.
6. Noise from the door's chain during opening and or closing modes.
 - Check installation and alignment of all wheel supports, front and rear, as well as the gear motor support.
 - Very loose chain may also jump over and cause damage to the sprocket's main motor.
 - Check chain tension and if needed shorten it by removing one or two "links".
7. Remote control unit does not function.
 - Check connection of power terminals.
 - Check battery of the key unit transmitter.If issue still persists, replace the remote control receiver and the two transmitters
8. If equipped with VSS, the door operates although the vehicle is in motion over 5Km/h.
 - Check connections to the VSS unit.
 - Check VSS unit.
9. Buzzer does not operate during the closing mode.
 - Check buzzer or replace it.

Please note:

The system performs automatic reset after the ASD has been disconnected from the power either when replacing the fuse or by disconnecting the Battery.
The system resets itself within two minutes. Please be patient.

Tools required for installation
 ASD. AAD. STEP. ATG



Air Reciprocating Saw



Saw BLades



13mm Pneumatic Drill



Air Die Grinder



Hand holding battery-powered electric drill

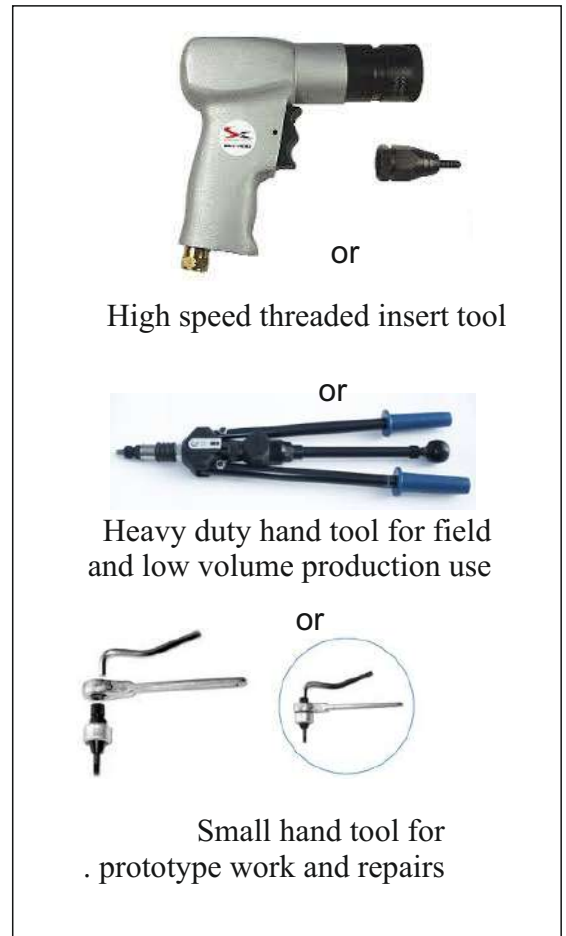

or

High speed threaded insert tool

or

Heavy duty hand tool for field and low volume production use

or

Small hand tool for . prototype work and repairs



Soldering-iron



Masking Tape 50MM

Flashlight or drop light

Pencil or marker

Safety Glasses



Straight Flute HSS Step Drill
 diameter 4-30mm

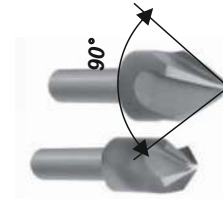

Drill Point Countersinks



Straight Shank Twist Drill

diameter 4mm / 5mm / 6mm / 6.5mm / 7mm / 9.5mm 12mm



T-Handle Set



Hand Files



Heavy Duty Snap Blade Knives



Wire Stripper/Crimper



Locking plier



Combination Wrench Set Metric



Plier Set



1/4" Drive Socket Set metric



Screwdriver Set