

# INSTRUCTIONS FOR ACR AISLink MOB

## How to Fit an ACR AISLink MOB to the Atlas 190 UML Life Jacket

These instructions will guide you through fitting your device into an Atlas lifejacket. Follow each step carefully to ensure it functions safely and correctly. Handle the lifejacket and all device components with care to avoid damage during installation.

### Before You Begin

Make sure you're familiar with how your Personal Locator Beacon (PLB) works—especially how to disable and re-enable it. You'll need to do this during the fitting process. If unsure, please refer to your Original Equipment Manufacturer's (OEM) manual.

You will need a flat surface to work on.

### Step 1: Open the Lifejacket

Open your Atlas lifejacket via the burst point and peel the cover apart to expose the inflatable bladder. Spread the bladder out flat, being careful not to catch or snag the manual inflation cord.

*(For more details on unpacking, refer to your user manual.)*

*(Fig. 1)*

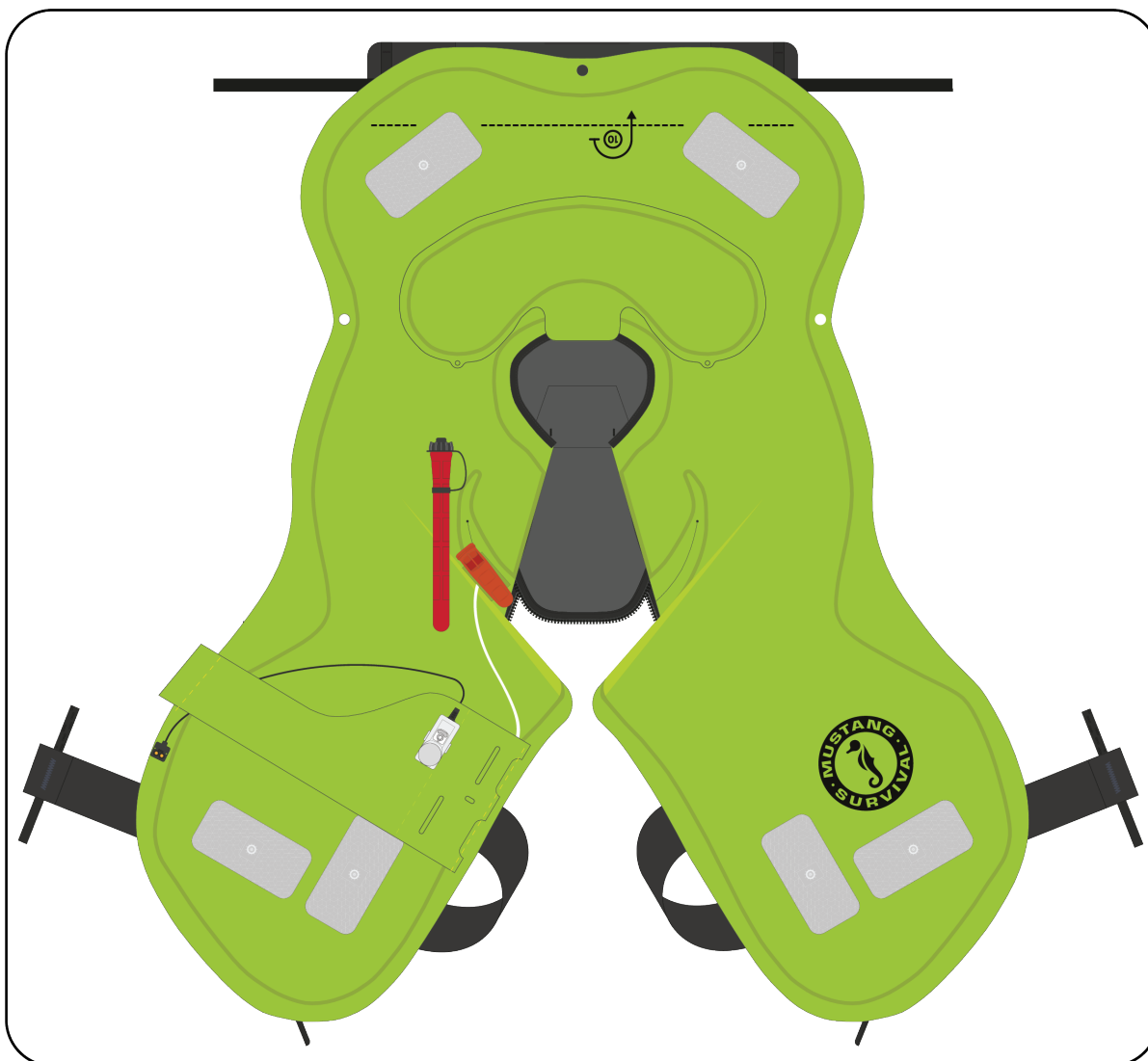

*Fig 1.*

## Step 2: Deactivate the Device

Refer to the OEM User Manual for your PLB and follow the steps to deactivate the device before continuing.

### Step 3: Attach the Fitting Clip

Slide the fitting clip into the upper slot of the PLB (Fig. 2a). Then, secure the device by using the upper mounting slot (Fig. 2b).

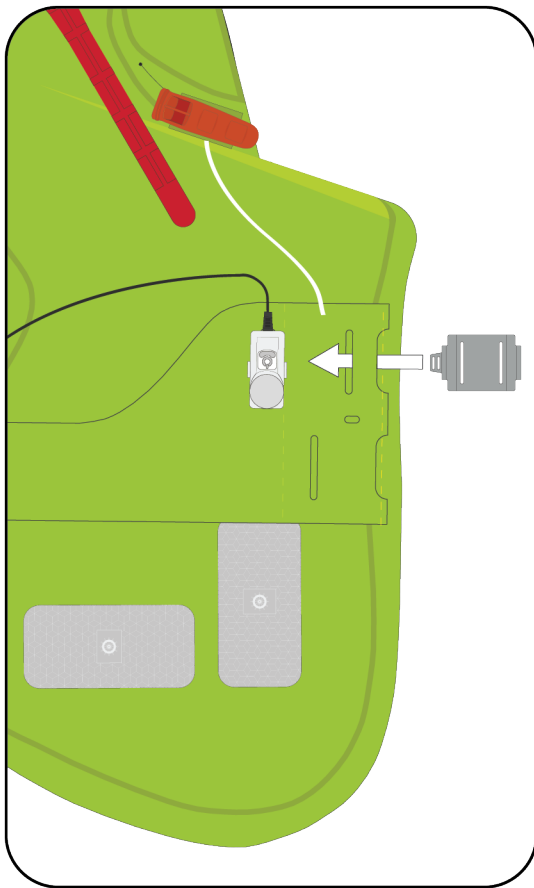

Fig 2a.

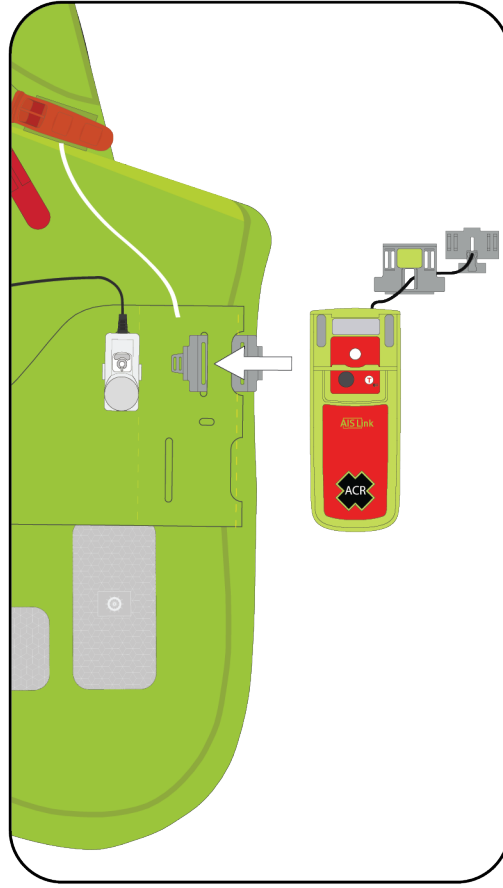
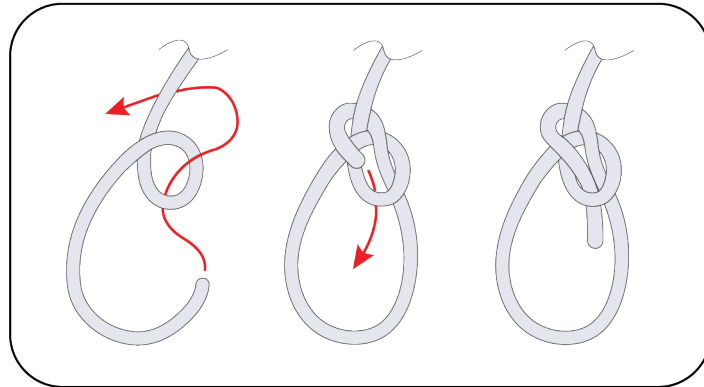

Fig 2b.

### Step 4: Tie the Tether

Using a bowline knot, attach the device to the loose end of the cord on the bladder—this cord is located next to the whistle. Thread the cord through the back tether slot on the device to secure it.

(Fig. 3)

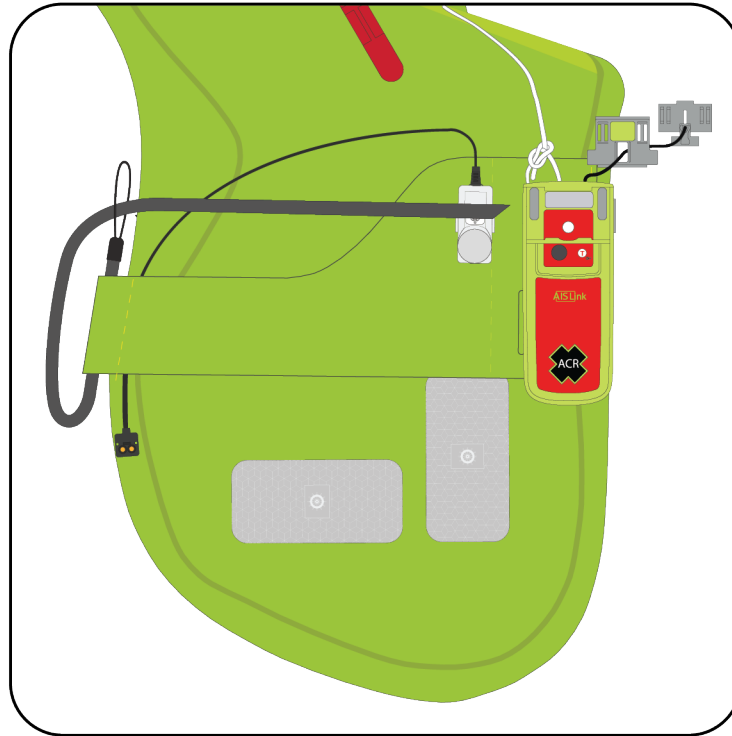

*Fig 3.*

#### Step 5: Secure the Ribbon

Thread the ribbon (provided with the device) through the far end of the bladder panel. Create a hitch by looping the ribbon through itself to hold it in place.

(Fig. 4)



*Fig 4.*

### Step 6: Position and Secure the Ribbon

Thread the ribbon behind the rear activation slide, then pass it through the middle slot of the device (*Fig. 5*).

Next, press the front and rear activation slides tightly together to hold the ribbon firmly in place (*Fig. 6*).

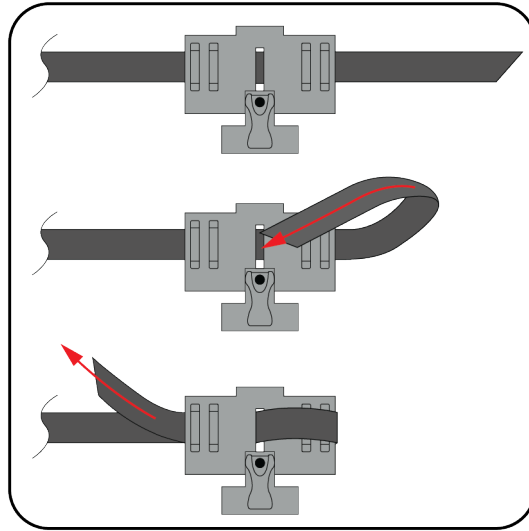

Fig 5.

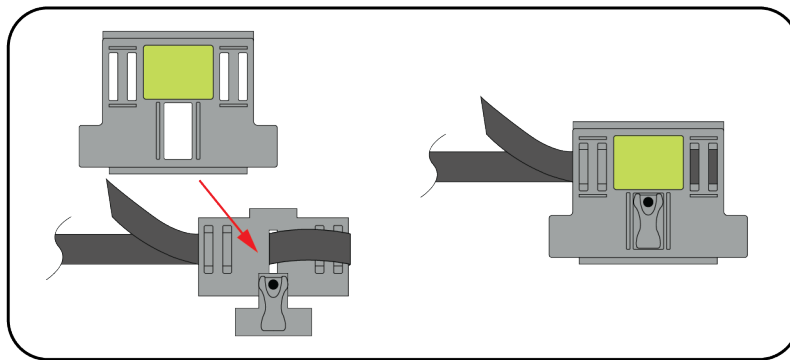
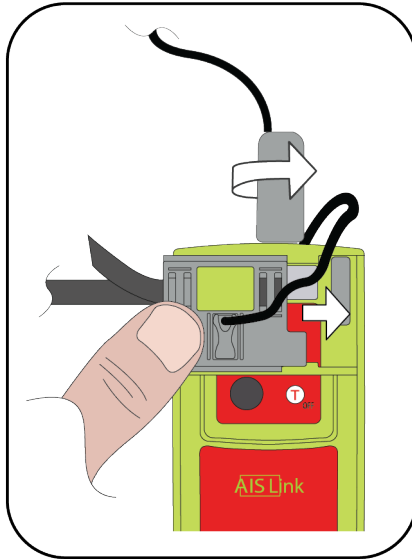

Fig 6.

### Step 7: Pack the Antenna and Arm the Device

Follow the steps in the OEM User Manual to properly stow the antenna and (re-)arm the device. Once armed, slide the clip into place and apply the securing tape to hold everything firmly.

(Fig. 7)

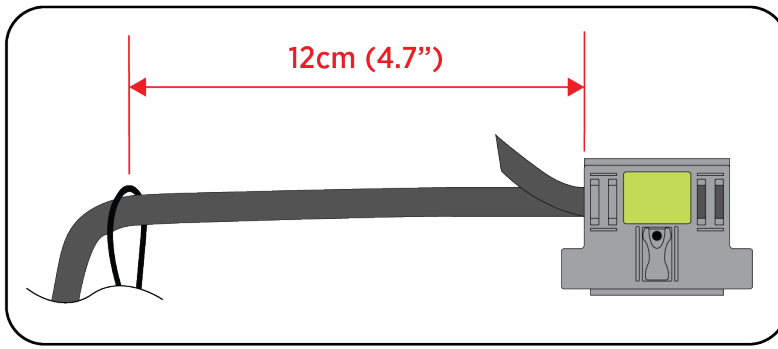

*Fig 7.*

### Step 8: Check Ribbon Length

Make sure the ribbon is secured so that there is 12 cm (4.7") of space between the activation slider and the point where the ribbon is hitched.

*(Fig. 8a, 8b)*



*Fig 8a.*

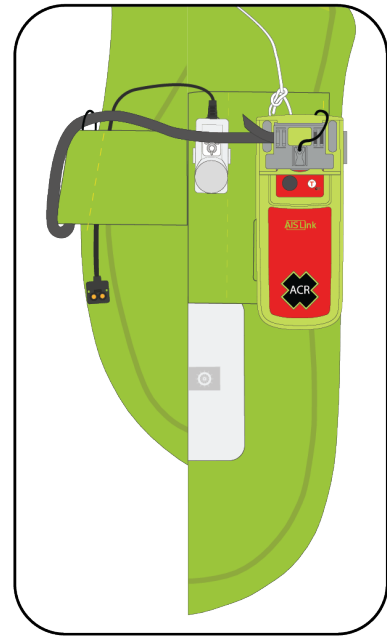

*Fig 8b.*

### Step 9: Repack the Lifejacket

Repack the lifejacket as outlined in the Atlas manual—except make sure the device is folded on top, facing outward, and positioned as the uppermost layer above the bladder.

*(Fig. 9)*



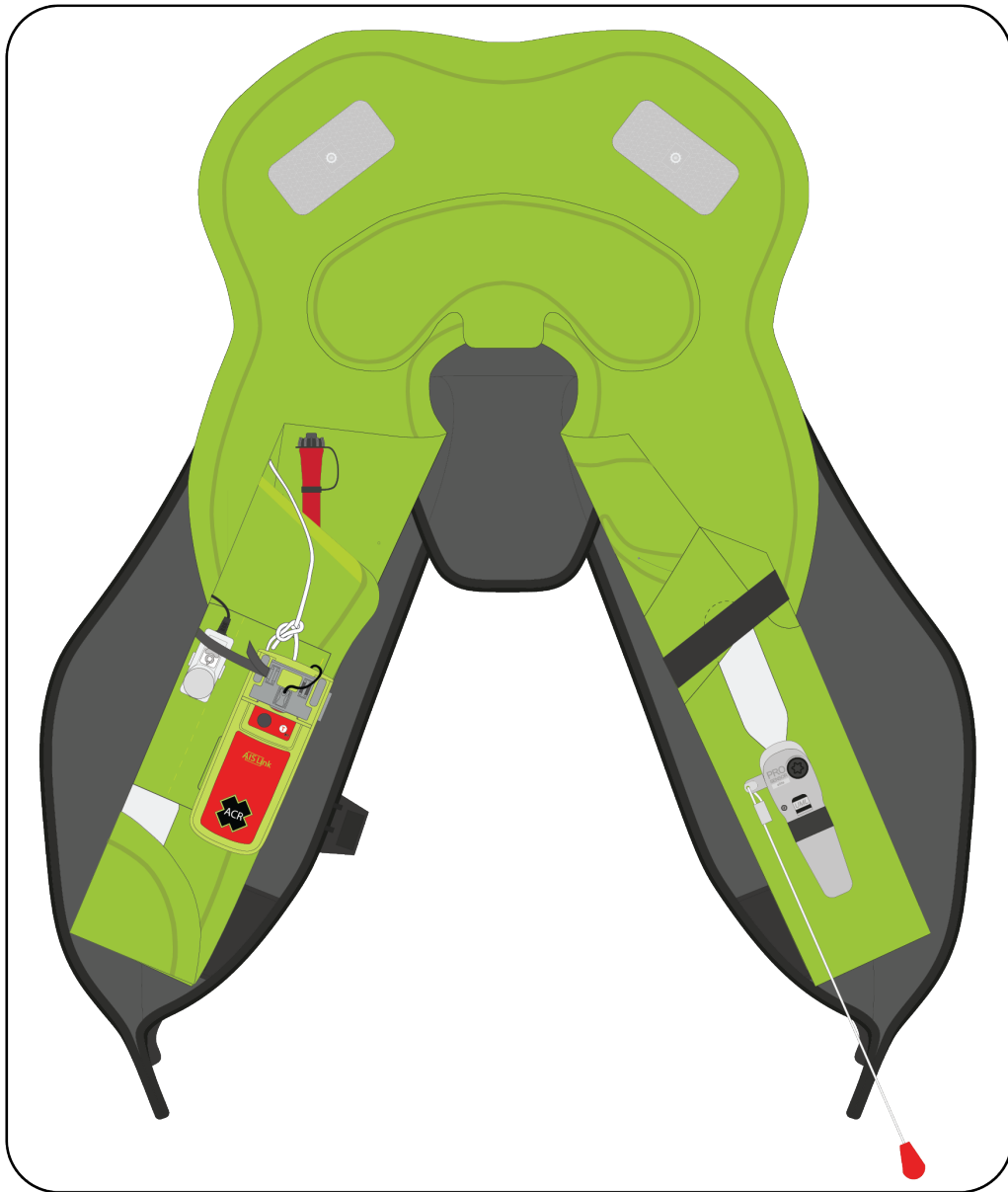

*Fig 9.*

#### Step 10: Mark the Label

As a final step, locate the label tucked into the centre back panel of the lifejacket and mark it to indicate *"PLB fitted."*

(Fig. 10)

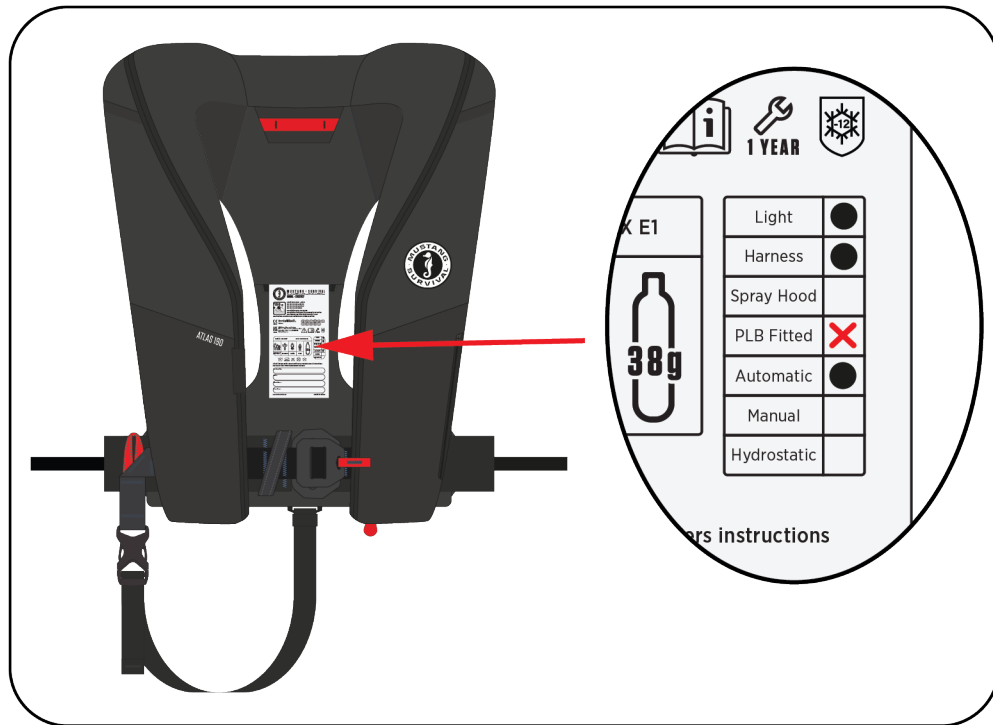

Fig. 10