

**Read all instructions BEFORE assembly and USE of product.
KEEP INSTRUCTIONS FOR FUTURE USE.**



gowithme®
by BABY DELIGHT®

VILLA

portable tent/playard

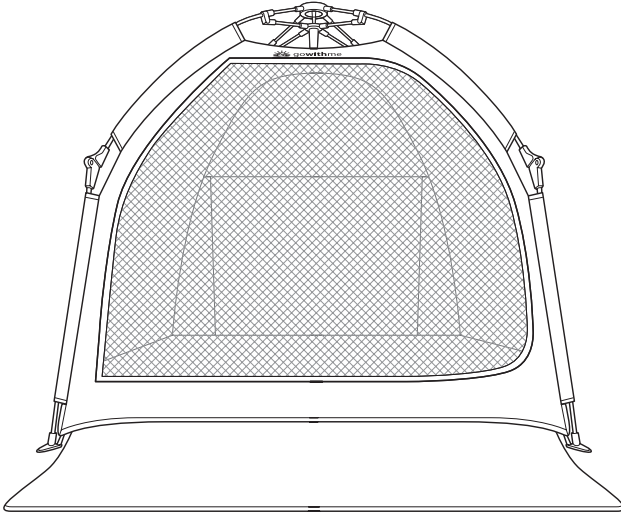

Care & Instructions

Contents



Tent

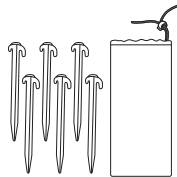

**Stakes (6)
with storage bag**



Travel Bag

WARNING:

FAILURE TO FOLLOW THESE WARNINGS AND THE INSTRUCTIONS COULD RESULT IN SERIOUS INJURY OR DEATH. PLEASE READ INSTRUCTION MANUAL BEFORE SET-UP. IF YOU MISPLACE YOUR INSTRUCTION MANUAL, NEVER USE THIS PRODUCT. CONTACT BABY DELIGHT, INC. FOR A REPLACEMENT INSTRUCTION MANUAL.

- The playard, including all supporting structure, must be fully erected prior to use.
- Make sure all latches and straps are secure.
- Discontinue use of the product when child is able to climb out or reaches the height of 35 inches (890 mm).
- Child can become entrapped and die when improvised netting or covers are placed on top of playard. Never add such items to confine child in playard.
- When child is able to pull to standing position, remove bumper pads, large toys, and other objects that could serve as steps for climbing out.
- Never place playard near a window where cords from blinds or drapes can strangle a child.
- Always provide the supervision necessary for the continued safety of your child.
- When used for playing, never leave child unattended.
- To reduce the risk of SIDS, pediatricians recommend healthy infants be placed on their back to sleep, unless otherwise advised by your physician.
- Never use this product if there are any loose or missing fasteners, loose joints, broken parts, or torn mesh/fabric. Check before assembly and periodically during use. Contact Baby Delight, Inc. for replacement parts. Never substitute parts.
- Never use plastic shipping bags or plastic film as mattress covers. They can cause suffocation.
- Never use a water mattress with this product.
- NEVER leave child in product unless it is fully erected and secured.
- NEVER use product outdoors in high winds.
- If using tent stakes to anchor the product, assure that the stakes are firmly secured in the ground and are at or below ground level as not to cause an impaction hazard.

SUFFOCATION HAZARD:

INFANTS CAN SUFFOCATE:

- In the gaps between an extra pad and side of the playard.
- In gaps between a mattress too small or too thick and product sides.
- On soft bedding.
- NEVER add a mattress, pillow, comforter or pad/padding.

⚠ STRANGULATION HAZARD:

STRINGS AND CORDS CAN CAUSE STRANGULATION! KEEP STRINGS AND CORDS AWAY FROM CHILD:

- **NEVER** place the playard near a window where cords from blinds or drapes can strangle a child.
- **NEVER** hang strings on or over the playard.
- **NEVER** place items with a string around a child's neck, such as hood strings, pacifier cords, etc.
- **NEVER** attach strings to toys.

⚠ PLAYARD SET-UP:

- **Keep fingers clear of folding mechanism during folding and unfolding.**
- **Keep all children away from the playard during assembly and take down (sides not fully expanded).**
- **ALWAYS** set up playard on a flat, level surface. Check floor/ground surface underneath playard floor to assure that it is clear of any objects that may injure your child. Insure surface is suitable for your child to play on.

Conforms to ASTM F 406 Standard Consumer Safety Specification for Playards.

⚠ CAUTION: KEEP SMALL PARTS OUT OF CHILD'S REACH.

IMPORTANT - READ THE INSTRUCTIONS CAREFULLY BEFORE USE AND KEEP THEM FOR FUTURE REFERENCE.

Assembly/Operating Instructions

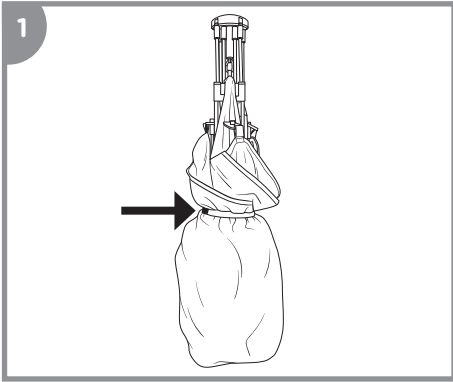

Remove tent from bag and unbuckle strap.

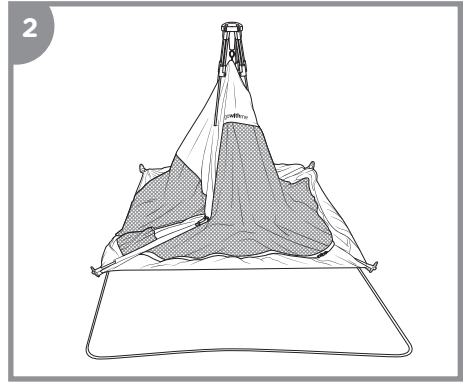

Tent will unfold.

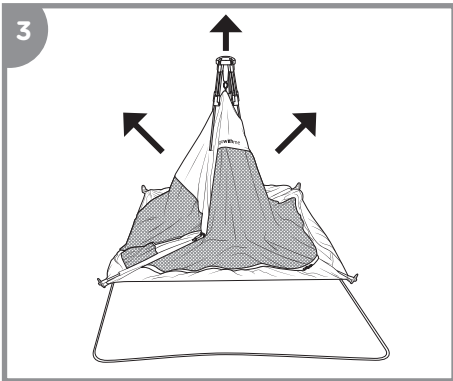

Lift tent up from center hub until all sides pop up.

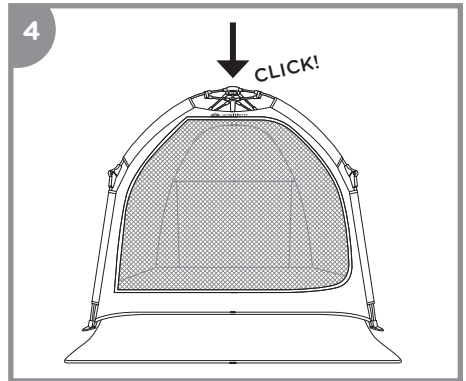

Press hub down to lock in place. You should hear an audible "click".

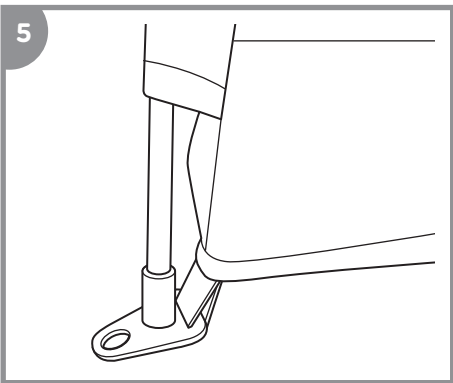

Make sure each of the bottom four corners of the tent are connected to the plastic anchor plates.

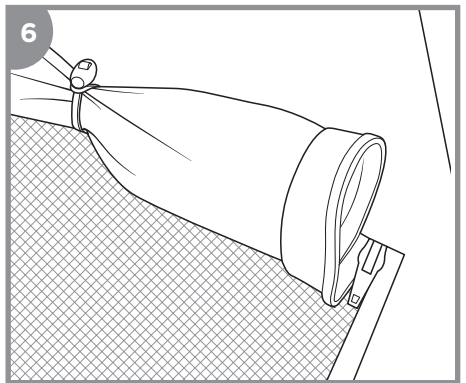

The front, sides and back panels can be unzipped and rolled up and secured using the plastic tabs and the elastic loops.

To Use Stakes

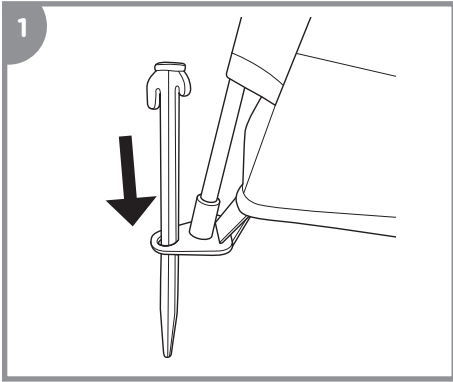

The tent comes with 6 plastic stakes. Insert the stakes in the 4 corners of the tent in the round hole of the anchor plates and press them into the ground until secure.

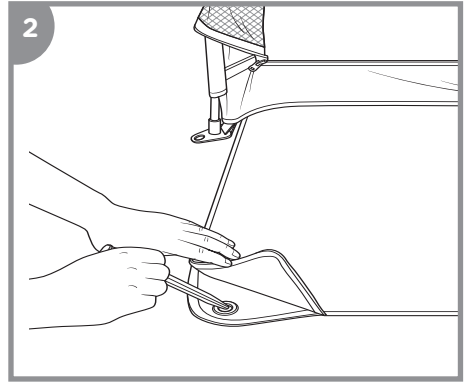

The additional two stakes can be inserted in the front corners of the fabric threshold by lifting corners up and inserting stakes into the metal grommets.

To Use Side Pockets

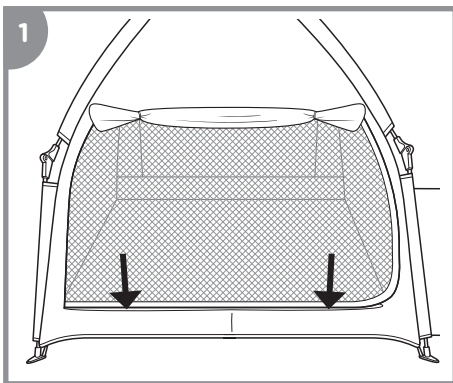

The tent features long pockets on the left, right and back side. These pockets can be filled with sand or rocks for further weight in windy conditions in addition to using the stakes.

To Fold

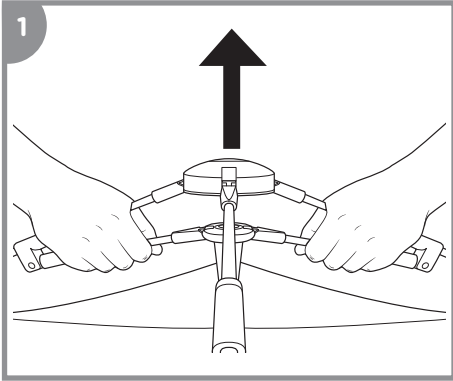

Grab the two white and grey opposing tubes and squeeze in the upward direction until the tent starts to collapse and continue lifting up and pressing inward.

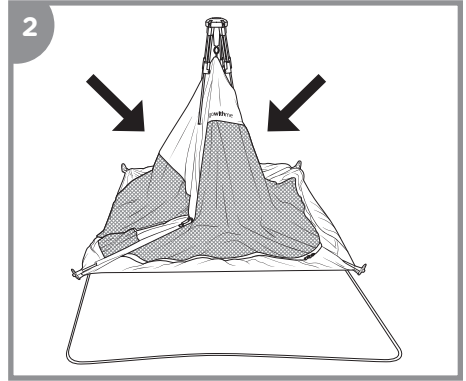

The tent should fold with each of the lower tubes laying flat of the ground.

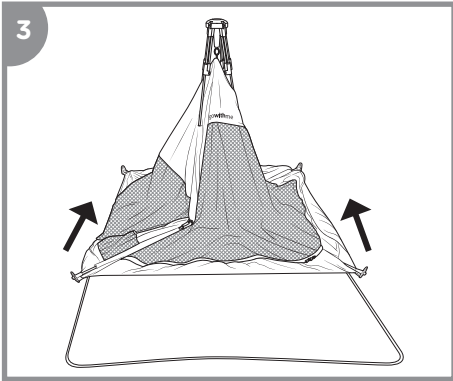

Lift the four lower tubes together toward the center hub, wrap tent fabric and buckle strap.

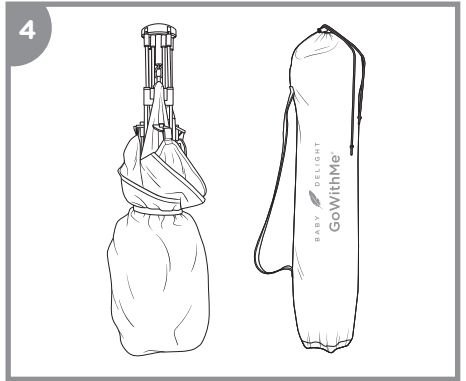

Place tent in bag for storing.

Care & Cleaning

Caring for your new GoWithMe® Villa tent/playard is very easy.

Wipe surface with a damp cloth using mild detergents and warm water to clean. Wipe with a towel or air dry.

Limited Warranty

At Baby Delight, Inc. we make innovative and high quality products for babies, children and their parents. We warrant this product to be free from defects in material and workmanship existing at the time of manufacture for a period of 90-days from the date of initial purchase (sales receipt is required for proof of purchase). If such a defect is discovered during the limited warranty period, we will, at our sole option, repair or replace your product at no cost to you.

This limited warranty does not cover claims resulting from misuse, failure to follow the instructions on installation, maintenance and use, abuse, alteration, involvement in an accident, and normal wear and tear.

For warranty service or replacement part information:

Please call 1-401-333-6800, email consumercare@babydelight.com, or write to Baby Delight Consumer Services: 30 Martin Street, Suite 3C, Cumberland, RI 02864.

Some replacement parts may be available for purchase after this limited warranty expires. Please visit us at www.babydelight.com or call us at 1-401-333-6800 for details.



www.babydelight.com

© 2022 Baby Delight, Inc. | 30 Martin Street, Suite 3C, Cumberland, RI, 02864, USA
1-401-333-6800 | consumercare@babydelight.com
BD05610, BD05620, BD05630, BD05640, BD05650