Operating Manual



Please must read the Operating Instruction before using Wheelchair

Contents

I	Introduction.....	1
II	Specifications.....	2
III	Unfolding &Folding	3
IV	Installing the Joystick Controller.....	5
V	Adjusting the Armrest and Backrest.....	6
VI	Manual Model Operation.....	7
VII	Splitting Wheelchair.....	8
VIII	Joystick Operation.....	9
IX	Charging Instructions.....	10
X	Transport& Storage.....	12
XI	Safety Guide.....	12
XII	Appendix.....	19

PRECAUTIONS

Please read the instructions before using the chair in order to operate and maintain it properly.



**PLEASE PAY ATTENTION TO THE FOLLOWINGS
CONTENT WITH THESE WARNING SYMBOLS.**



**FAILURE TO TAKE PRECAUTIONS COULD RESULT IN
SERIOUS INJURIES.**



**IT CAN ALSO DAMAGE OR DECREASE THE LIFE
EXPECTANCY OF THE CHAIR.**

I Introduction

Thank you for choosing **Culver Mobility** for your portable wheelchair transportation needs. Congratulations on your choice of **Culver Mobility CHAIR**, which will provide you with years of dependable service with proper use and care.

It is important to read through this manual before operating your chair to become familiar with its features as well as its limitations and safety information. You will find the operation and care of your chair very simple and easy, but should you have any questions please contact us at hotline 949-501-5183 or by email culvermobility@gmail.com.

Get to know your CHAIR:



II Specifications

Model	337
Unfold size (L*W*H)	35.4"x23.9"x38.6"
Fold size (L*W*H)	29.8"x23.9"x14.4"
Turning Radius	33.5"
Backrest	Adjustable height
Motor	2 x 250W Brushless DC Motor
Battery	1 x 24V10Ah Li-ion battery or 2 x 24V10Ah Li-ion battery or 3 x 24V10Ah Li-ion battery
Max Load	400 lbs
Tires	8" solid PU tires (Front) 12" solid Rubber tires (Rear)
Suspension	6 spring suspensions
Max Speed	4.7 MPH
Frame material	6061 Aluminum alloy
Charge	24V/2A

III Unfolding & Folding

Your CHAIR will arrive carefully packaged in a cardboard box. We suggest that two people are available to remove the packaging and set up the CHAIR for the first time.

1. The WHEELCHAIR ships upright; carefully open the top of the box then turn the box on the side for easier removal of the contents.

2. Unfolding Process

A) Unfolding-Step 1

Hold the backrest with one hand, and press and hold the seat cushion with the other hand to push it away, as shown in Figure. 1.



Figure. 1

B) Unfolding-Step 2

After fully unfolding, the buckle plate under the backrest should be fastened, as shown in Figure. 2. **(Before using the wheelchair, make sure that the gusset plate is pressed in place, otherwise there is danger of folding during use!)**

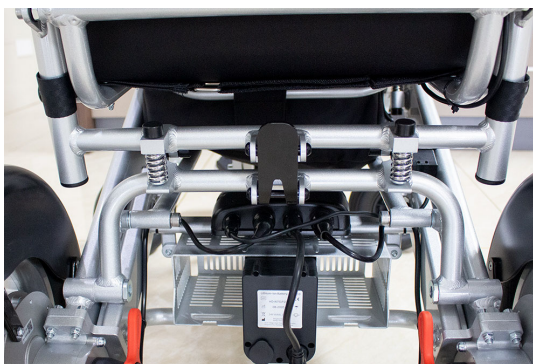

Figure. 2

3. Folding Process

A) Folding-Step 1

Open the buckle plate, check the images below to see how it should appear open. As show in Figure.3



Figure. 3

B) Folding-Step 2

First pull the buckle plate under the backrest apart, as shown in Figure. 4, hold the backrest with one hand and pull up the seat cushion with the other hand to close it, as shown in Figure. 5.



Figure. 4

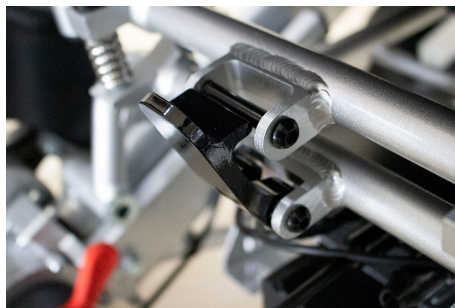

Figure. 5

IV Installing the Joystick Controller

Step 1

Insert the controller joystick into the armrest tube and tighten the knob to fix it in position. as shown in Figure. 6.



Figure. 6

Step 2

Connect the controller wire harness to the CPU wire harness that runs from the chair itself, taking care to line up the pins properly so that they do not get bent, broken or damaged. as shown in Figure. 7



Figure. 7

NOTE: Make sure connector pins in wire harness are lined up properly; do NOT force the wire harness connections together or you will bend or break the pins.

Step 3

Insert the power plug into the battery and tighten it, as shown in Figure. 8. If the battery needs to be replaced, loosen and pull out the plug. As shown in Figure. 9, pull open the fixed switch under the battery by hand and pull out the battery.



Figure. 8



Figure. 9

Step 4

If the battery capacity needs to be increased, batteries with the same capacity can be connected in parallel. As shown in Figure. 10, there are two socket holes on the battery that can be inserted into either of them in parallel to increase the capacity.



Figure 10

V Adjusting the Armrest and Backrest

Turn the armrest locking knob upward, as shown in Figure. 11, and then lift the armrest upward, as shown in Figure. 12. To fix the armrest, press the armrest downward and turn the knob downward, as shown in Figure. 13.



Figure 11



Figure 12



Figure 13

Release the fixing knob behind the backrest, as shown in Figure. 14, and adjust the backrest up and down to a suitable height, as shown in Figure. 15. Finally, tighten the knob to fix the backrest.



Figure 14

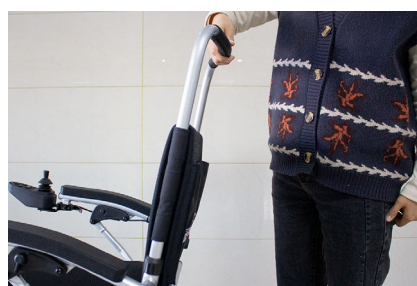

Figure 15

VI Manual Model Operation

Press down inside on the clutch handle to keep the electromagnetic brake at the separation position. This will allow the wheels to move freely so caregiver can push the chair. as shown in Figure.16

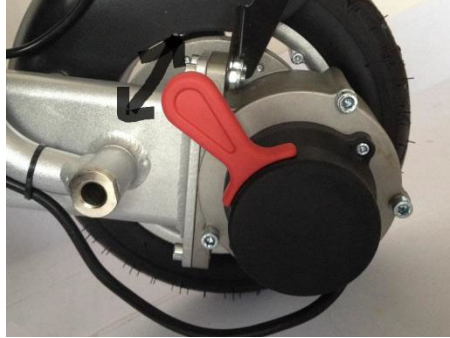
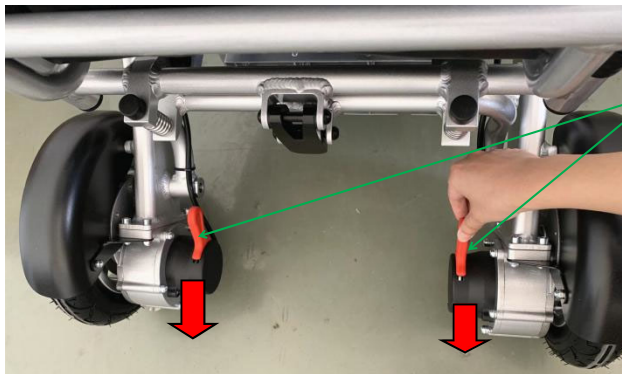

Figure 16

If the user operates the chair without assistance, the electromagnetic brake must be at the engaged position. Otherwise, the user will not have control over the chair. as shown in Figure.17



Press the both clutch handle outside, the chair is on electric model.

Figure 17

VII Splitting Wheelchair

Fold the wheelchair and make it stand straight, as shown in Figure 18.

Press the cross-bar with one hand, and pull up the top frame with the other hand, as shown in Figure 19.

Then the two parts are separated, as shown in Figure 20.



Figure. 18



Figure. 19



Figure. 20

Lift the top frame onto the down frame, as shown in Figure 21.

Let the top frame slide into the chute of the down frame, then the two parts are joint. as shown in Figure 22.

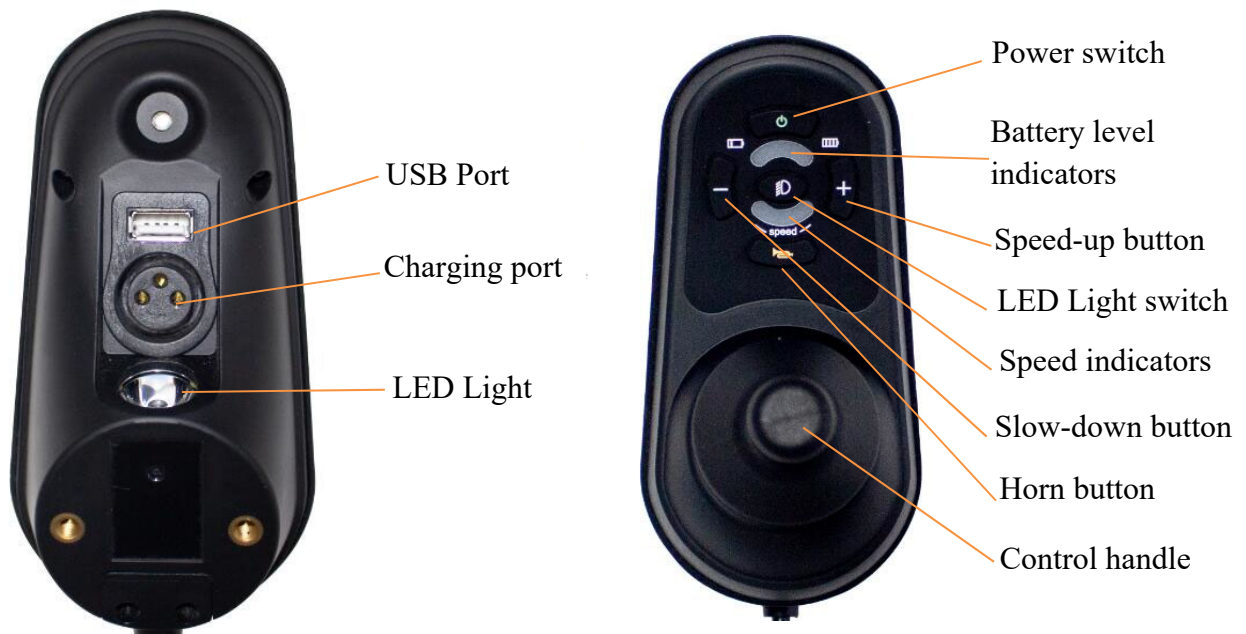

Figure. 21



Figure. 22

VIII Joystick Operation



- Joystick: controls the chair's direction and speed.
- Power on: press to turn on the power
- Power off: press to turn off the power
- Power display: there are three colors of the LED lights. Green. Indicates power left in the batteries.
- Speaker: Horn, that sounds when the user presses the button.
- Accelerate Max. Speed: press to adjust to higher speed.
- Decelerate Max. Speed: press to adjust to slower speed.
- Speed display: All lights on means it is set to max speed.

Charging Method (off-board charging cable):

1. Turn the power OFF using the button on the controller.



2. Take this off-board charging cable from the bag under the seat. The plastic side is used to connect the battery, and the metal side is used to connect the charger.



3. Connect the battery and off-board charging cable.



4. Press this metal button to connect this cable with charger.



5. Now you can plug the charger into the power supply and charge your batteries.



X Transport& Storage

- To pick up the chair, stand it up when it is folded.
- Folded chair can be stored in the car trunk.
- The battery should be fully charged and the chair should be placed in cool, dry, and ventilated place in case of the chair will long-term placement.
- **Please, the battery needs to be charged once every three months, otherwise it could lead to over-discharge damage.**

XI Safety Guide



- The user must be of sound mind and judgment.
- The user must read this user's guide before operating the chair and get familiar with its components and features.



- The user should practice driving skills with assistance on open, flat, and safe grounds before normal use.
- To move forward and Parking.

To move forward, push the joystick forward lightly ;
To stop, release the joystick.



- Moving backwards

The user must be aware of what is behind them before maneuvering backwards to avoid collisions.,
push the joystick backwards lightly.



- Turning

To turn, push the joystick to the left or right. and be aware of what is to the left or right to avoid collisions.



- Driving on bends

Lightly push the joystick in the direction of the bend. Practice speed control.



- Practice avoiding obstacles

Lightly push the joystick in either directions to avoid and maneuver around the obstacles, practice speed control.



- Driving Fast

Push the joystick all the way in the direction you want to go. Pull the joystick back to the middle if you do not feel you are not 100% in control.



- Driving Uphill

Keep your body tilted forward to keep the center of gravity stable. Drive slowly. We recommend the slope be less than 9 degrees for optimal performance.



- Entering & Exiting elevator

The user should pay attention to the opening and closing intervals of the elevator door to avoid collisions while entering or exiting the elevator.



- Driving on sidewalks

The user should stay on the sidewalk and avoid entering the motor vehicle lane unless to cross the street. Pay attention to obstacles and avoid contact with them.



- Crossing the street

Pay attention to avoid cars and only cross when you are allowed to. Must drive slowly over the curb, to get back on the sidewalk, which should not be more than 3cm high.

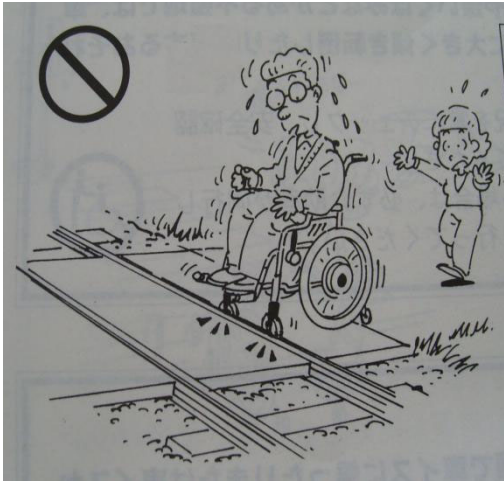

- Driving over train/railroad tracks
Don't cross railroad/train tracks alone, we highly recommend you should be accompanied by an assistant, friend, or loved one.

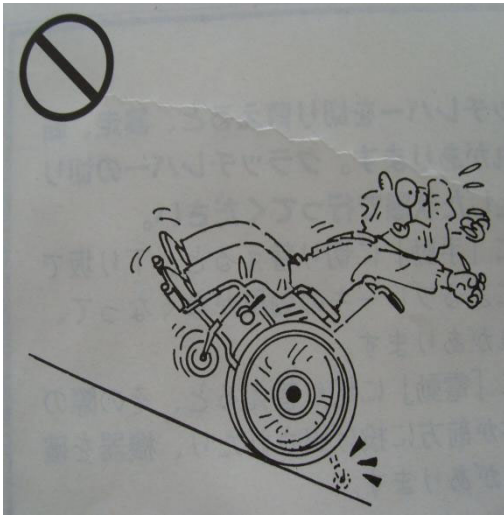

- Driving on too steep of an incline could result in a rollover or an accident.



- Driving over too high of a curb/step (more than 3cm) could result in rollover.





- We recommend that the user has assistance getting out and into the chair. Move the armrests and footrest out of the way before entering and exiting the chair.



- Do not attempt to repair the product on your own. It may cause permanent damage to the chair and could put yourself at risk of injury or death. It should be repaired by professional personnel.



- Do not allow children access to the chair.



- Do not hose down the chair with water or any liquids. It will cause damage to the chair and could also harm or endanger your personal safety. So, wipe down with a damp cloth.



- Do not leave the battery or electrical components of the chair in a car that is baking in the sun. It will cause permanent damage. So, keep it away from fire and heat sources.



- Do not allow children access to the battery or electrical components to the chair. It should be stored in a cool, dry area that children do not have access to.



- Do not store the battery in direct sunlight. Please, it should be stored in a dry, cool, and ventilated area that children don't have access to. Also, do not store in a severe cold environment. It will damage and decrease the life of the battery.

XII Appendix

1. Warranty

Part	Coverage	Remarks
Frame	2 Years	Non-deliberate damage
Motor	2 Years	Non-deliberate damage
CPU	1 Year	Non-deliberate damage
Battery	1 Year	Non-deliberate damage
Joystick	1 Year	Non-deliberate damage
Wearing Parts	3Months	Non-deliberate damage

2. Contact US

Showroom & Office

1403 E Edinger Ave
Santa Ana, CA 92705

Email:

culvermobility@gmail.com

Toll-free: 1-949-501-5183