

INSTRUCTION MANUAL

HUANUO

Rev02(A)

HNSS7

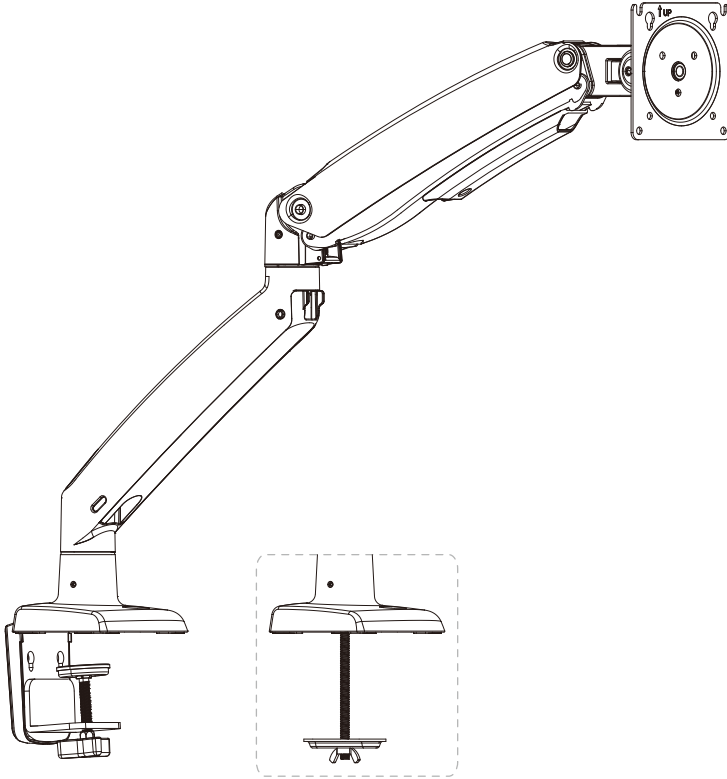

Desk Monitor Arm

1-800-556-0533 (US/CA)
44-808-196-3874 (UK)

support@huanuo.com

www.huanuo.com

Before getting started, let's make sure this mount is compatible.

1 Is the VESA pattern of your monitor 75 x 75mm (3 x 3") or 100 x 100mm (3.9 x 3.9")?

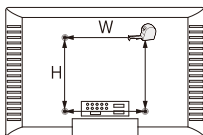

- Yes — Perfect!
- No — This mount is NOT compatible.

2 Does your monitor (including accessories) weigh less than 26.4 lbs (12kg)?



- Yes — Perfect!
- No — This mount is NOT compatible.

3 Tools Needed (not included)

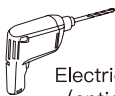

Electric Drill (optional)



3/8–1 1/16" (10–27mm) Drill Bit (optional)

NOTE

- Please carefully read all instructions before attempting installation. If you DO NOT understand the instructions or have any questions or concerns, please call technical support or email customer service.
- Not all hardware included in this package will be used.

CAUTION

Avoid personal injuries and property damage!

- DO NOT use this product for any purpose that is NOT explicitly specified in this manual. DO NOT exceed weight capacity. We are NOT liable for damage or injury caused by improper mounting, incorrect assembly or inappropriate use.
- Before starting assembly, verify all parts are included and undamaged. DO NOT use damaged or defective parts. If you require replacement parts, please call technical support or email customer service.

⚠ WARNING

- This product contains small items that may pose a choking hazard.
- This product contains gas spring arms which are under high pressure. Do not puncture these arms or expose the arms to fire or flame. If this product is defective, please call technical support or email customer service.
- Do not use this product on desks made of particle board or other soft woods.
- The information contained in this manual does not cover all possible conditions or variables in relation to the installation of this product.

4 Important Safety Information

Product Features

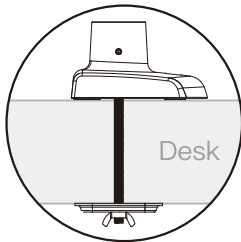
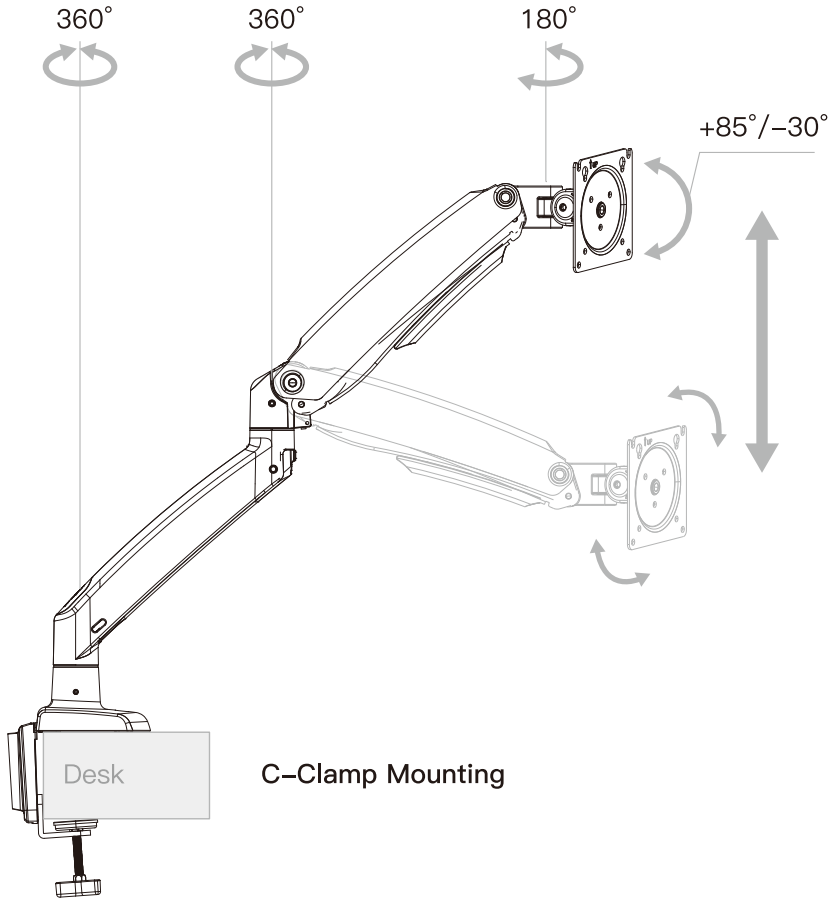

TENSION ADJUSTMENT SHOULD BE DONE ONLY AFTER MONITOR INSTALLATION



Attention

DO NOT adjust tension without monitor attached.

1. Verify the weight of your monitor (including accessories) is between 4.4–26.4 lbs (2–12kg). Monitor weight information can be found in the monitor instruction manual or by contacting the manufacturer.
2. Ensure monitor has been securely attached to the mount.

WARNING:

- Gas spring arm is under pressure and should be handled with care.
- Failure to follow the instructions may result in damage to the mount and/or personal injury.

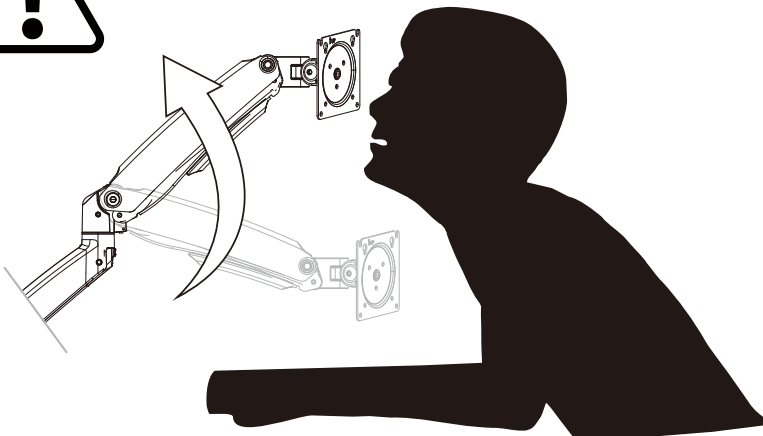

Supplied Parts and Hardware for Step 1

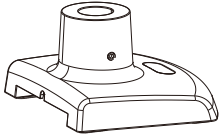

Base
01 x 1

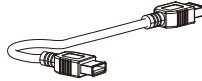

USB Cable
02 x 1

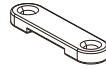

USB Pressure Plate
[A2] x 1



Bolt
M4 x 10mm
[A1] x 2

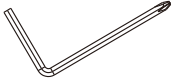

Large Allen Key
3/16" (5mm)
[L3] x 1

Supplied Parts and Hardware for Step 2

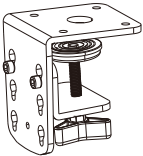

C-Clamp
03 x 1



Clamp Cover
04 x 1



Bolt
M6 x 12mm
[B1] x 4



Grommet Bolt
[C1] x 1



Locking Plate
[C2] x 1



Butterfly Nut
[C3] x 1



Medium Allen Key
5/32" (4mm)
[L2] x 1



Large Allen Key
3/16" (5mm)
[L3] x 1

Supplied Parts and Hardware for Step 3

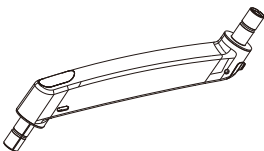

Lower Arm Section
05 x 1

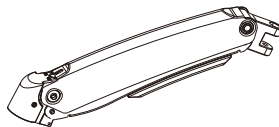

Upper Arm Section
06 x 1



Small Allen Key
1/8" (3mm)
[L1] x 1

Supplied Parts and Hardware for Step 4

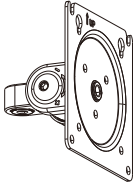

Monitor Plate

07 x 1

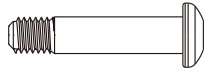

Bolt
M8 x 38mm
[D1] x 1



Washer
16 x 8.2 x 1.5mm
[D2] x 1

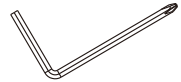

Large Allen Key
3/16" (5mm)
[L3] x 1

Supplied Hardware for Step 5



Washer
10 x 4.5 x 1.0mm
[E1] x 4

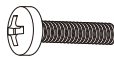

Bolt
M4 x 12mm
[F1] x 4



Bolt
M4 x 30mm
[G1] x 4



Spacer
L13mm
[H1] x 4

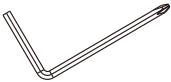

Large Allen Key
3/16" (5mm)
[L3] x 1

Supplied Hardware for Step 6, 8 and 10

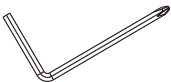

Large Allen Key
3/16" (5mm)
[L3] x 1

Step 1 Attach the USB Cable

Option A: No USB Cable

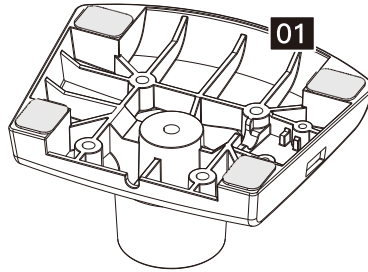

Option B: Route USB Cable

Route USB cable under base as demonstrated in the following diagram. Attach the USB pressure plate [A2] to hold the USB cable [02] in the base [01] with bolts [A1].

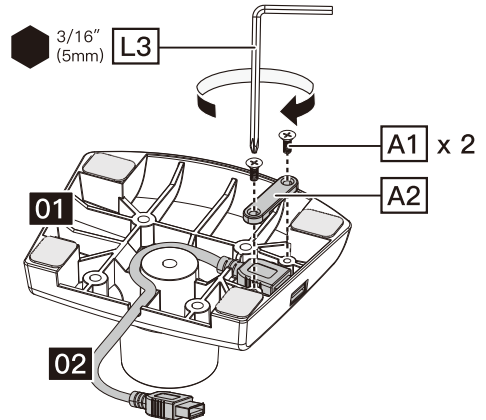

Step 2 Install the Base

For C-Clamp Mounting

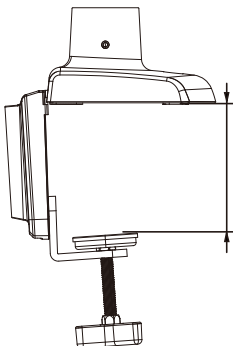

For desk thickness:
0.4–3.5"
(10–90mm)

For Grommet Mounting Skip to Page 08

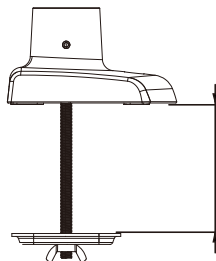

For desk thickness:
0.4–3.5"
(10–90mm)

OR

Option A: For C-Clamp Mounting

①

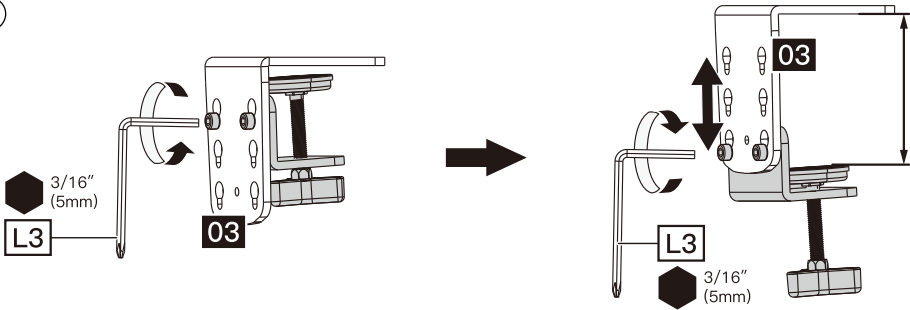

②

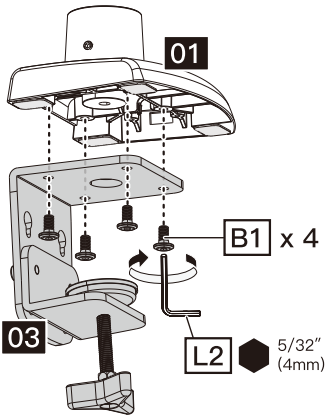

③

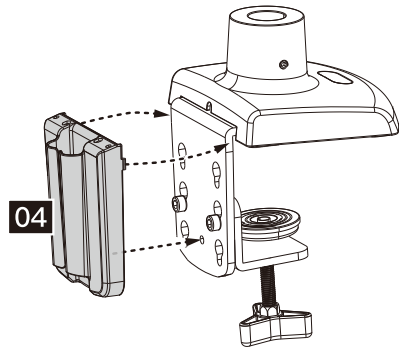

WARNING:
Ensure bolts are secured firmly.

④

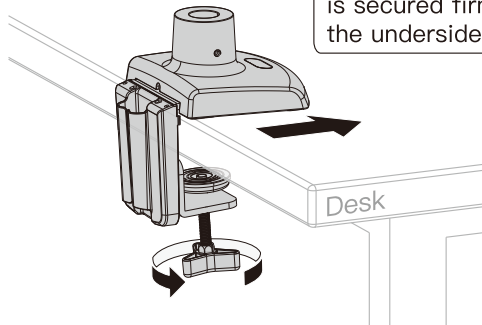
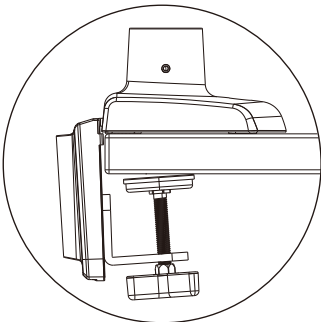

WARNING:
Ensure the C-Clamp
is secured firmly to
the underside of desk.

Option B: For Grommet Mounting

①

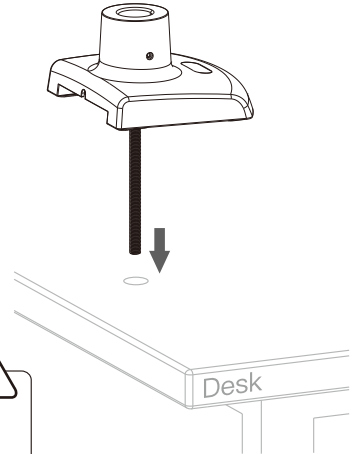
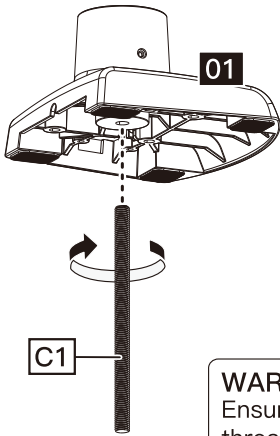

WARNING:
Ensure the grommet bolt is threaded securely to the base.

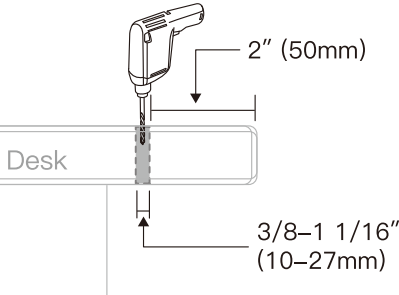
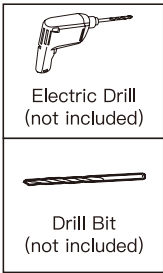

NOTE: If there is no grommet hole on the desk, you will need to drill one. Mark the desired location at least 2" (50mm) from the desk edge. Drill the hole using a 3/8-1 1/16" (10-27mm) drill bit.

②

WARNING:
Tighten the butterfly nut to firmly secure the locking plate to the underside of desk.

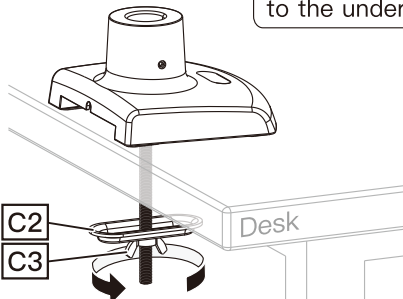

Step 3 Attach the Lower and Upper Arm Sections

Attach the lower and upper arm sections [05] and [06], then tighten the set screws. Do not overtighten them, as this may affect the rotation of the arm.

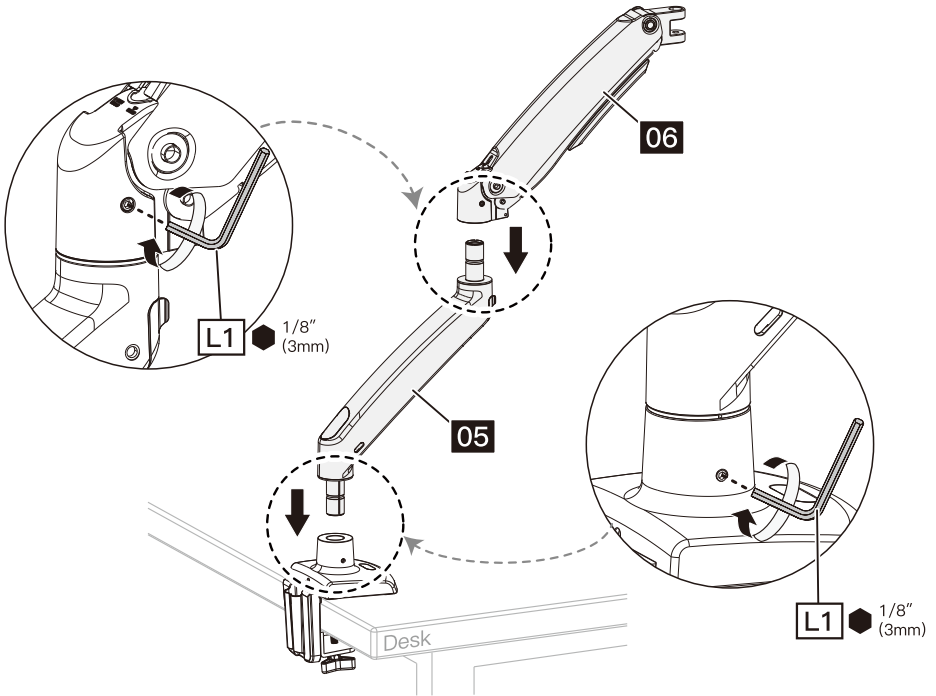

Step 4 Attach the Monitor Plate to the Upper Arm Section

Slide the monitor plate [07] sideways into the slot at the end of the upper arm section [06]. Fasten with bolt [D1] and washer [D2].

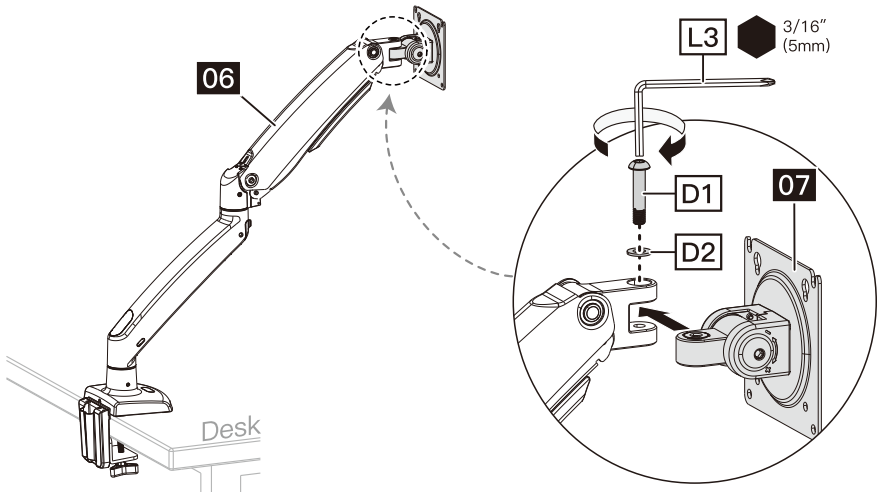

Step 5 Hang the Monitor on the Mount

Hand thread bolts into the threaded inserts on the back of your monitor to determine which bolt (M4 x 12mm or M4 x 30mm) to use. A minimum of 4–5 turns into the threading is required. Do not turn past the bottom of the hole.

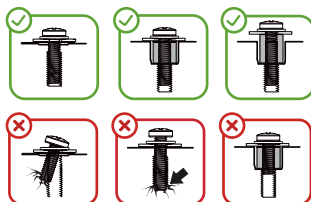
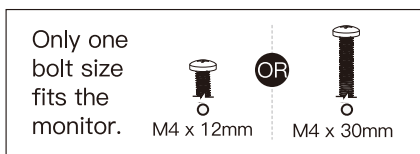

Choose the bolt and spacer configuration that fits your monitor type. Thread in the top bolts, but do not tighten all the way yet.

For Flat Back Monitor

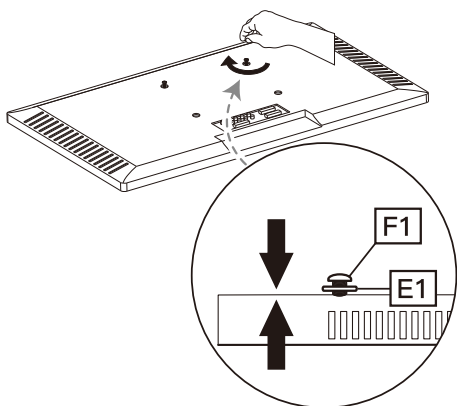

For Curved Back Monitor

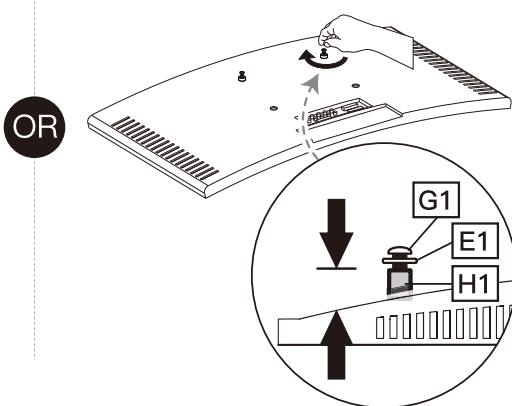

OR

With the top bolts attached, hang the monitor onto the VESA plate using the top 100mm slots or 75mm holes. Thread in the bottom bolts, then firmly tighten all bolts to secure the monitor to the mount arm.

NOTE: Gas spring tension is preset at 8.8–11 lbs (4–5kg).

After hanging the monitor on the mount, release the monitor slowly so that it doesn't suddenly fall.

For VESA hole pattern:

- 75 x 75mm (3 x 3")
- 100 x 100mm (3.9 x 3.9")

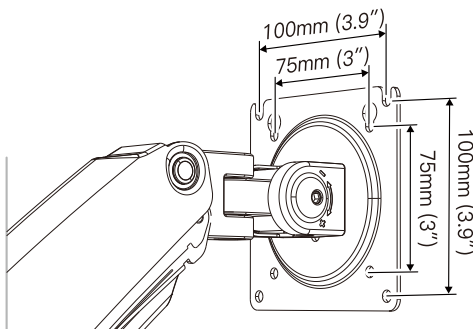



HEAVY! You may need assistance with this step.

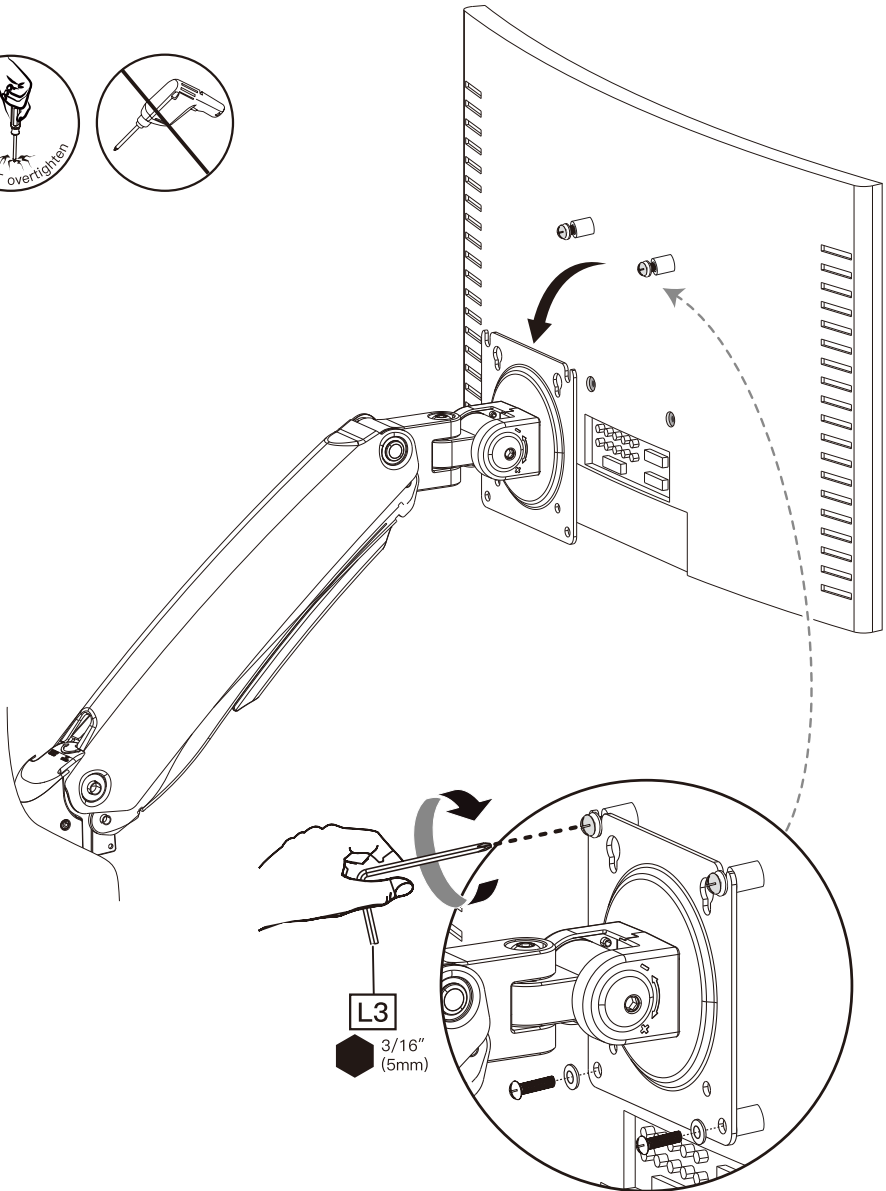

Step 6 Adjust Gas Spring Tension

- 1 Hold the upper arm in a horizontal position. In this position, you can access the gas spring tension bolt to increase or decrease tension so the arm stays in position by itself.



CAUTION:

To avoid damage to monitor or mount, always keep the arm in a horizontal position while making adjustments. You may need assistance with this step.

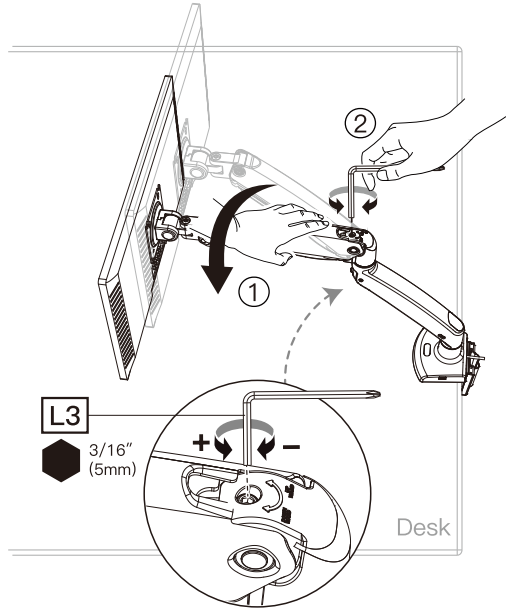

- 2 Use the large Allen key to adjust gas spring tension until the arm stays in position by itself. Once correctly adjusted, you can raise and lower your monitor and it will stay in position.

Scan the QR code to watch the arm adjustment video.

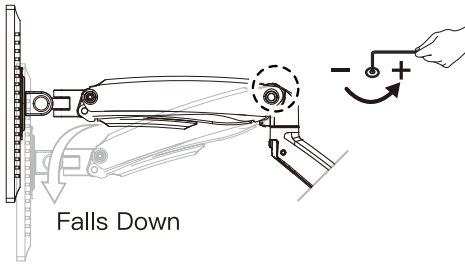

If the monitor falls down and fails to stay at the desired height:

Turn counter-clockwise (+) to increase gas spring tension until the monitor can stay at the desired height by itself.

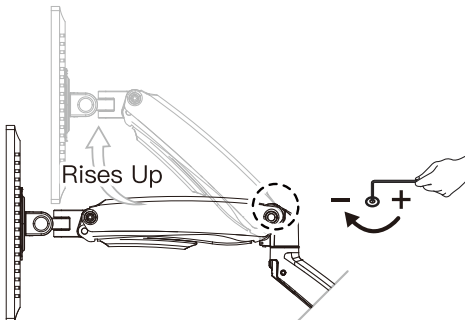

If the monitor rises up and fails to stay at the desired height:

Turn clockwise (-) to reduce gas spring tension until the monitor can stay at the desired height by itself.

Step 7 Adjust the Swivel Position of the Monitor

Swivel the monitor to your desired position.

Incorrect

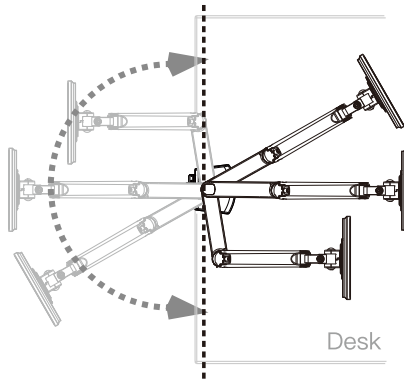
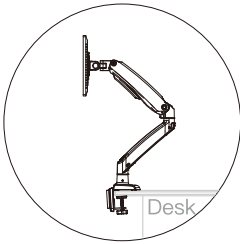
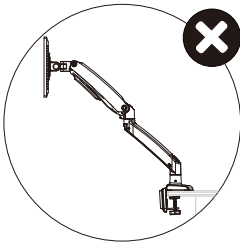

Correct

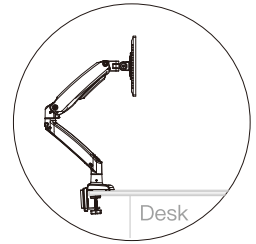
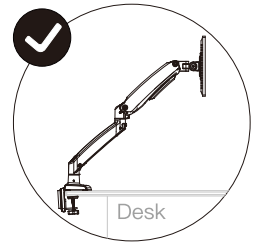

WARNING:

Avoid the risk of tipping and falling.
Do not position or swivel the monitor
beyond the edge of the desktop.



Step 8 Adjust the Tilt Angle of the Monitor



Adjust your monitor by gripping the monitor edges (do not press on the screen itself). If it's difficult to adjust, loosen the tilt-lock bolt on the monitor plate connector. Adjust the monitor to the desired angle, and then fully tighten the bolt again to lock the tilt angle.

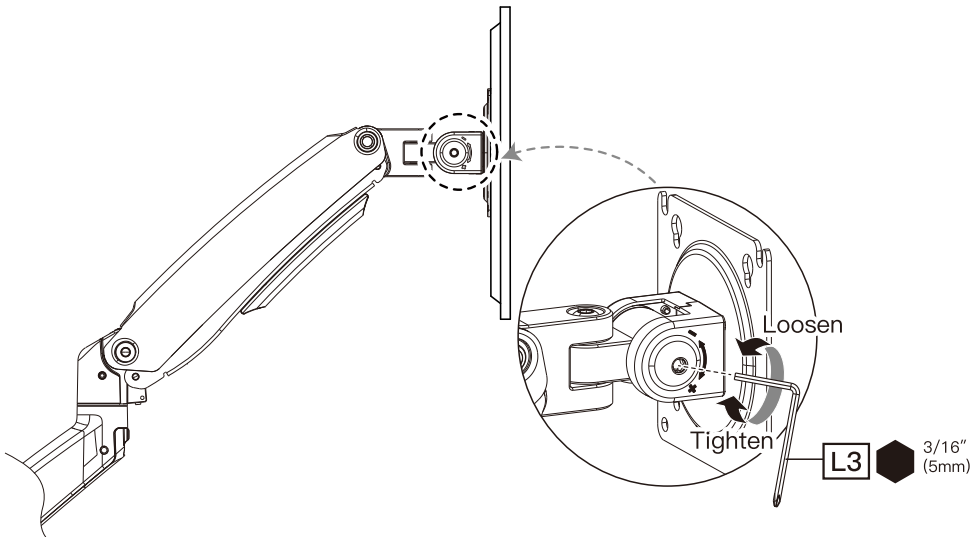

Step 9 Adjust the Rotation of the Monitor

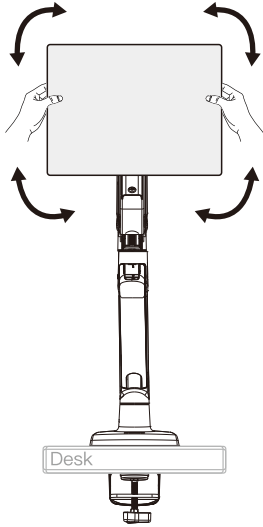

360°
Rotation

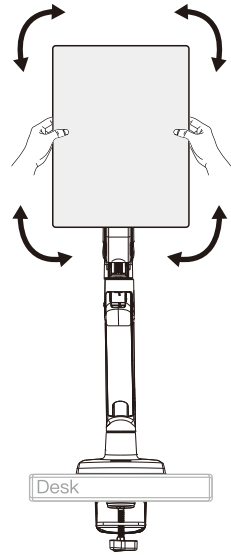

Step 10 Route Cables Down the Arm

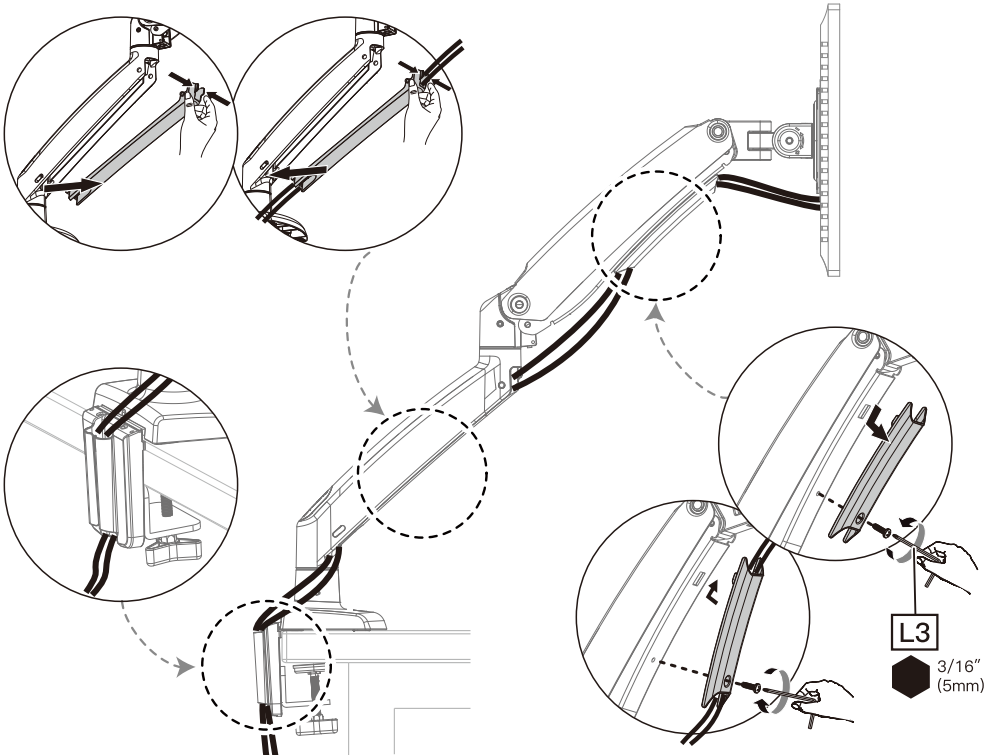

HUANUO



1-800-556-0533 (US/CA)
44-808-196-3874 (UK)



support@huanuo.com



www.huanuo.com