



---

QUICK START GUIDE

---

# Assembling Frames & Fabrics

Scrim Jim Cine frame tubes, corner connectors, straight connectors, and fabrics can be assembled in sizes 1' x 1' to 8' x 8'.

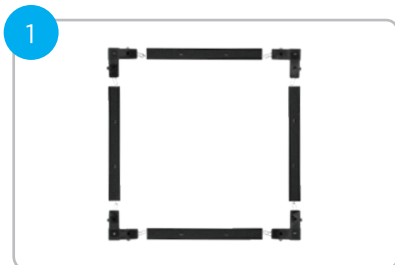

## Arrange Components

On a flat surface, position frame tubes and connectors next to each other in your desired order. Align the connectors' positive-locking buttons with the button receptacles on the frame tubes.



## Connect Frame Tubes

When included, connect straight connectors with their corresponding frame tubes first. Press and hold the positive-locking button and slide the frame tube into place. The button will 'click' when connected properly. Next, connect each end to corner connectors.



## Frame Creation

Connect all sections together to complete your frame. Ensure positive-locking buttons are properly secured.



## Attach Fabric

Place the fabric's loop tape edge onto the frame's hook tape. Press to secure.



## Secure Fabric Corners

Place the fabric's loop tape tabs around the frame and attach to the rear of the frame (for sizes 4' x 4' and larger).



## Additional Fabrics

Scrim Jim Cine fabrics are available in a wide variety of materials and sizes to control virtually any lighting you encounter.

Visit [fjwestcott.com/scrimjimcine](http://fjwestcott.com/scrimjimcine) to view the entire line of fabric options.

# Small Frame Mounting

Frame sizes 1' x 1' and 1' x 2' can be mounted on a light stand with the Dual-Joint Tilter Bracket (#2198).

## Mounting with a Dual-Joint Tilter Bracket



### Attach Bracket to Frame

Screw the bracket's 3/8"-16 stud into the frame's 3/8"-16 receptacle.



### Secure Bracket to Stand

Place the bracket's light stand receptacle onto your stand. Tighten the knob to secure.

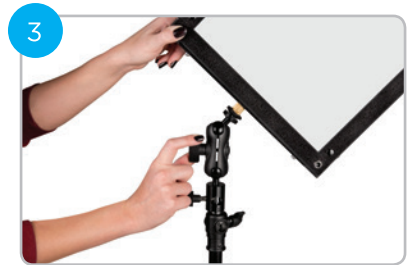

### Position Frame

Place your frame in the desired position by utilizing the dual ball-head joint. Ensure knob is securely tightened after each adjustment.

## Mounting with a Flex™ Yoke

Frame sizes 1' x 1' up to 2' x 2' can be mounted on a light stand or c-stand with the Flex Yoke (#7458, #7459) and Grip Head (#1881). This is an ideal mounting solution for frames used in conjunction with Flex LED mats. Visit [fjwestcott.com/flex](http://fjwestcott.com/flex) to learn more about Flex LED mats.



### Attach Grip Head to Stand

Place the grip head's light stand receptacle onto your stand. To secure, tighten the knob in the lower screw receptacle when using a light stand or in the upper screw receptacles when using a c-stand.



### Attach Yoke to Frame

Place the yoke arms around the frame. Align the yoke screws with the frame's 3/8"-16 receptacles. Ensure the rubber washer is located between the frames and the yoke. Tighten the knobs to secure.



### Secure Yoke in Grip Head

Place the long receptacle on the yoke into the appropriate sized receptacle on the grip head. Tighten the head's large knob to secure.

Note: Original Flex softboxes are not compatible with Flex Yokes.

# Medium & Large Frame Mounting

## Mounting with a Vise Grip or Scrim Jim Cine Bracket



### Medium Frames

Frame sizes 1' x 1' to 4' x 4' can be mounted with a single Center Jaw Vise Grip (#1980) or Scrim Jim Cine Clamp (#2080) and Grip Head (#1881) on a heavy-duty light stand. Affix the grip or clamp centered along the longest side and avoid using horizontally without a second grip or clamp.



### Large Frames

Frame sizes 4' x 6' to 8' x 8' can be mounted with two Center Jaw Vise Grips (#1980) or Scrim Jim Cine Clamps (#2080) and two Grip Heads (#1881) to heavy-duty light stands (#9913) or c-stands. For easiest assembly, we recommend 2 people. Perform the following steps twice for larger frame sizes.

1



#### Attach Grip Head to Stand

Place the grip head's light stand receptacle onto your preferred stand. To secure, tighten the knob in the lower screw receptacle when using a light stand or in the upper screw receptacles when using a c-stand.

2



*Vise Grip shown*

#### Secure Vise Grip or Scrim Jim Cine Bracket in Grip Head

Place the long end of the vise grip or Scrim Jim Cine Bracket into the appropriate sized receptacle on the grip head. Tighten the head's large knob to secure.

3



*Vise Grip shown*

#### Secure Frame in Vise Grip or Scrim Jim Cine Bracket

Loosen the wing nut on the Vise Grip or Scrim Jim Cine Bracket. Align the center of the frame inside of the jaws. Then, tighten the wing nut to secure the frame.

# Warranty

Westcott's warranty obligations for this product are limited to the following terms.

The F.J. Westcott Co. ("Westcott") warrants this Westcott branded product against defects in materials and workmanship under normal use for a period of TWO (2) YEARS from the date of retail purchase from Westcott or an authorized retailer by the original end-user purchaser ("Warranty Period"). If a defect arises and a valid claim is received within the Warranty Period, at its option and to the extent permitted by law, Westcott will either (1) repair the defect at no charge, using new or refurbished replacement parts, or (2) exchange the product with a product that is new or which has been manufactured from new or serviceable used parts and is at least functionally equivalent to the original product. This Limited Warranty applies only to products manufactured by or for Westcott that can be identified by the Westcott trademark, trade name, or logo affixed to them.

This warranty does not apply to: (a) damage caused by accident, abuse, misuse, flood, fire, earthquake, mold, or other external causes; (b) damage caused by operating the product outside the permitted or intended uses described by Westcott; (c) a product or part that has been modified to alter functionality or capability without the written permission of Westcott; or (d) cosmetic damage, including but not limited to scratches, dents and broken plastic.

Disclaimer: By purchasing, borrowing and/or using this product for any event, both public or private, you, the customer, accepts all responsibility and releases Westcott, and its associates, of any and all liability in the event of manufacturer's defect, malfunction or misuse of the product which may lead to further injuries or complications unforeseen by the user. Westcott is not responsible for any potential or incurred damage caused by failure to properly mount, hang, or store the product, which includes, but is not limited to damage to cameras, electronics, electrical equipment, buildings, building materials, personal injury, death, or disability, fire damage, or any and all other damage not mentioned previously.

Please contact Westcott's Repair Department for a Return Authorization Number "RMA" prior to requesting warranty service. This RMA must be clearly written on the outside of the box to the left of the shipping label. Items sent in without pre-authorization or that do not fall under the limited warranty will be returned at the expense of the sender.

Repair Department: 800-886-1689 / 419-243-7311 (International)

Email: [service@fjwestcott.com](mailto:service@fjwestcott.com)

Shipping: F.J. Westcott Co, 1425-B Holland Rd. Maumee, OH 43537

**Register your new gear online at [FJWESTCOTT.COM/REGISTER](http://FJWESTCOTT.COM/REGISTER)**





©Jem Schofield

## Free Lighting Tips! Featuring Top Professionals

- Photo and film lighting techniques
- Behind-the-scenes videos
- Gear guides and how-to articles
- Inspirational photo galleries
- Live events and workshops

Visit [westcottu.com](https://westcottu.com)



In an effort to provide the best quality products possible, we periodically make product modifications. Actual products or features listed may vary from items shown. Westcott does not claim responsibility for any typographical errors. ©F.J. Westcott Co. All rights reserved. EA1219



©Joel Grimes