



LTS-02

ADJUSTABLE LAPTOP STAND WITH DESK CLAMPS



STANDARD TABLETOP

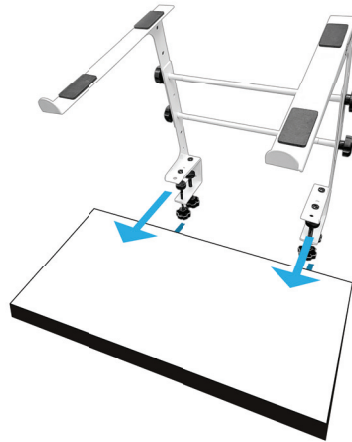
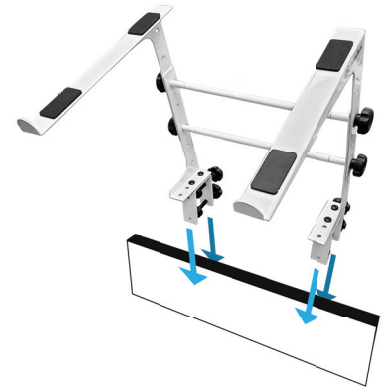

TABLE / SHELF EDGE MOUNT



PARTITION / LEDGE MOUNT

PARTS



Scan QR Code to view product details, videos and reviews.

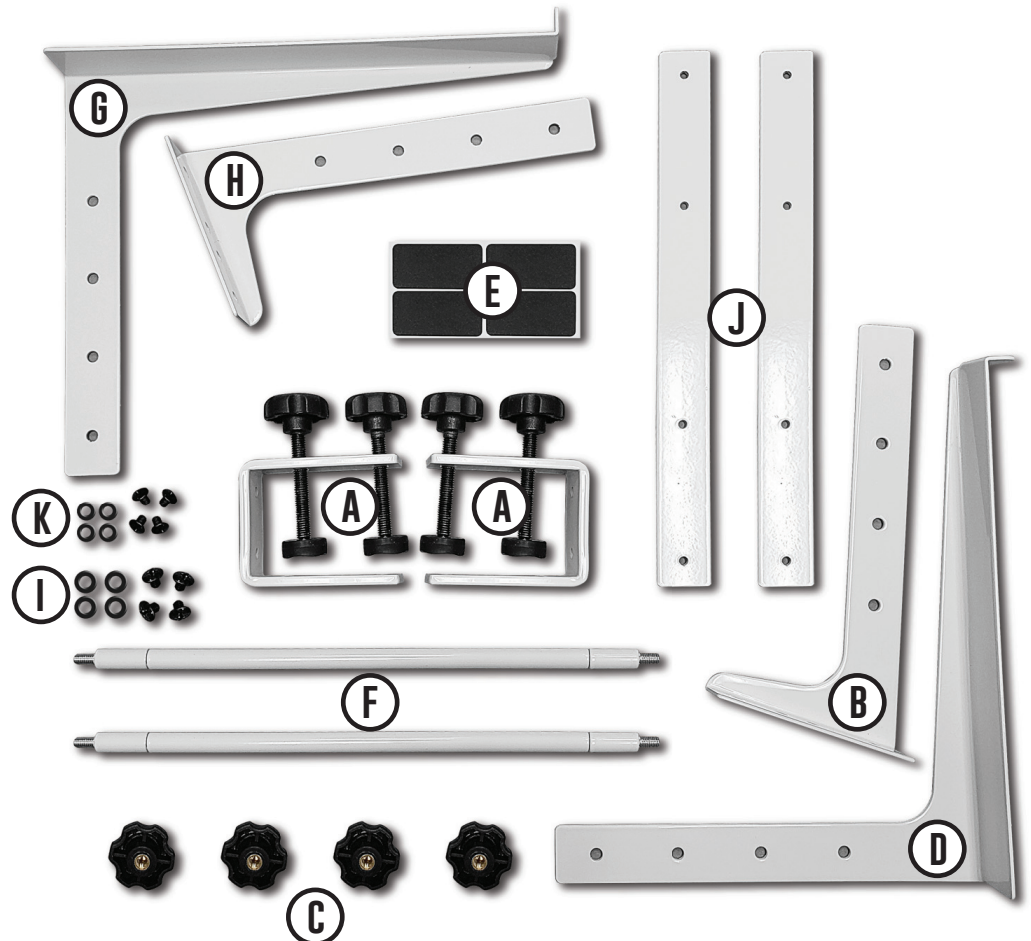

| PART # | PART NAME | # OF PIECES |
|--------|---------------------|-------------|
| A | EDGE BASE CLAMPS | 2 |
| B | RIGHT L - FOOT | 1 |
| C | PLASTIC SCREW KNOBS | 4 |
| D | RIGHT TOP ARM | 1 |
| E | EVA NON-SLIP PADS | 4 |
| F | WIDTH ADJUST RODS | 2 |
| G | LEFT TOP ARM | 1 |
| H | LEFT L - FOOT | 1 |
| I | M6 SCREWS & WASHERS | 4 |
| J | TABLETOP BARS | 2 |
| K | M5 SCREWS & WASHERS | 4 |

ASSEMBLY INSTRUCTIONS

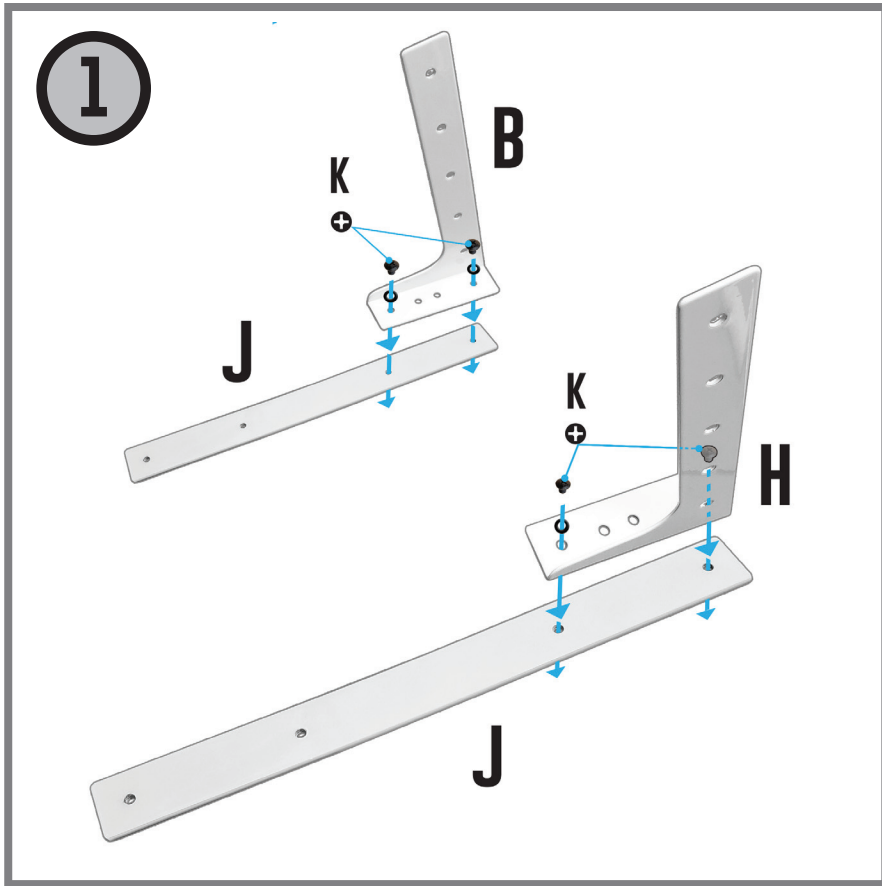

- Position **Right L-Foot (B)** and **Left L- Foot (H)** over the two **Tabletop Bars (J)**.
- Align the holes and screw in the smaller **M5 Screws and Washers (K)**.

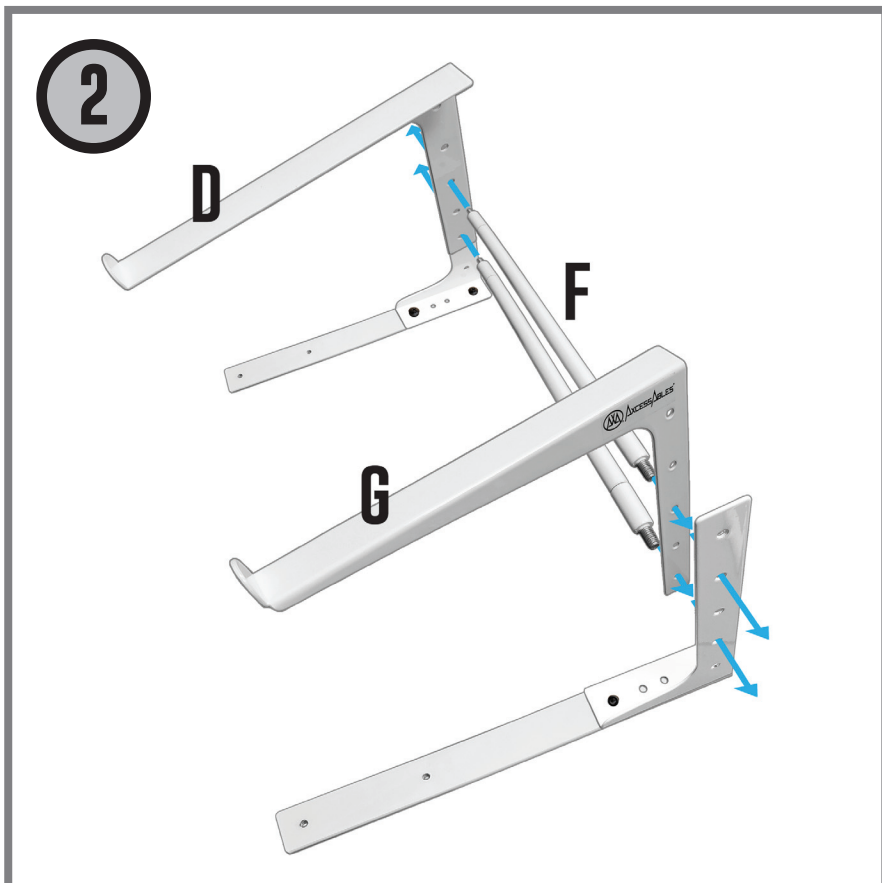

- Align the screw holes of the **Right Top Arm (D)** and **Left Top Arm (G)** over the now completed footers.
- Position the two **Width Adjust Rods (F)** to align with the screw holes of the **Right Top Arm (D)** and **Left Top Arm (G)** the footers and insert.

Side Feature



- The **Width Adjust Rods (F)** is comprised of 3 separate parts that can be unscrewed or screwed on depending on the width of your laptop.

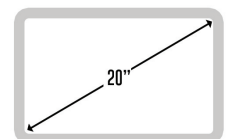
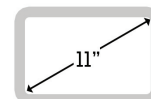

ASSEMBLY INSTRUCTIONS CONTINUE

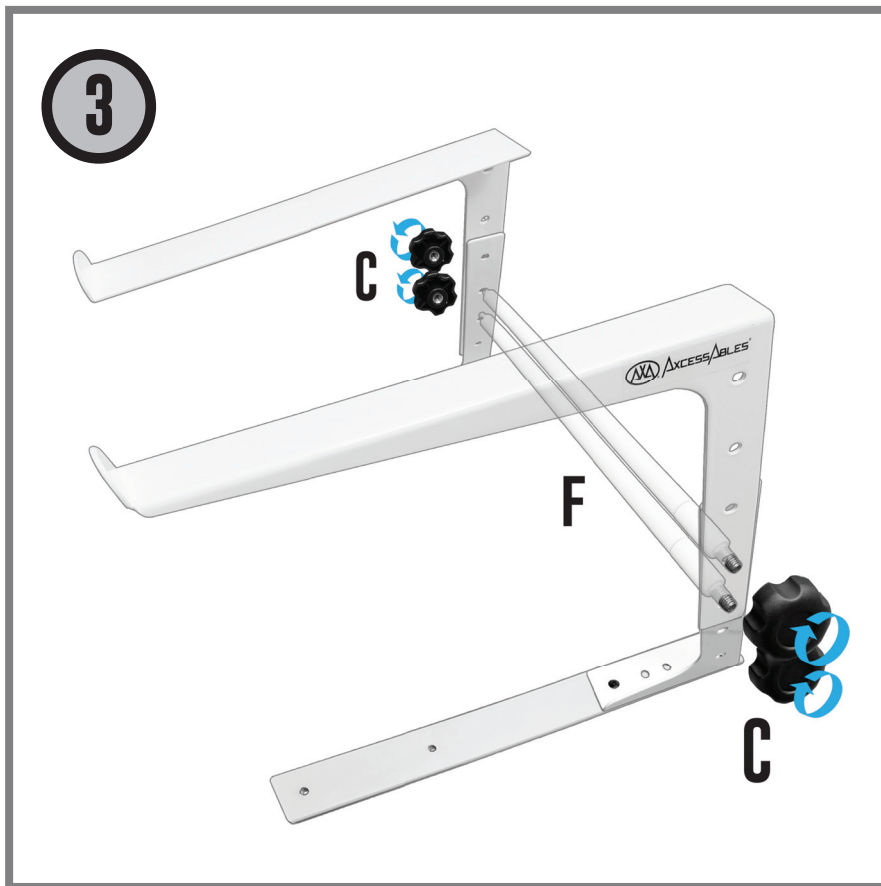

- Secure the **Width Adjust Rods (F)** by screwing in the **Plastic Screw Knobs (C)**.

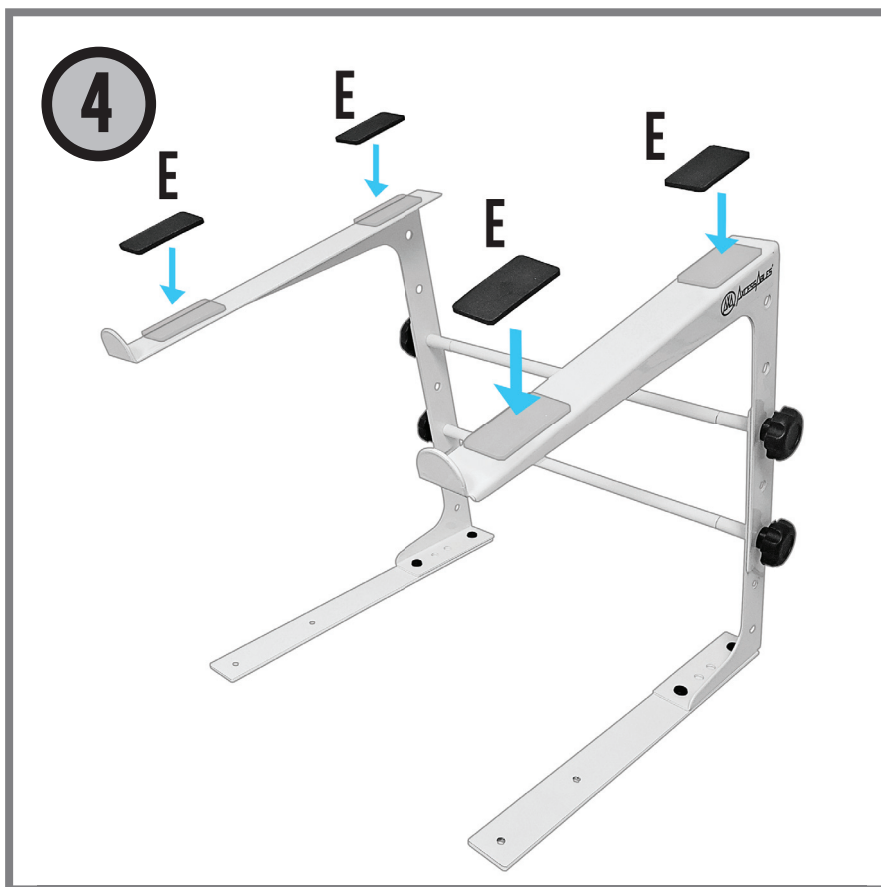

- Stick the **EVA - Non-Slip Pads (E)** strategically on the **Right and Left Top Arms**.

ASSEMBLY INSTRUCTIONS FOR TABLE EDGE AND LEDGE MOUNTING

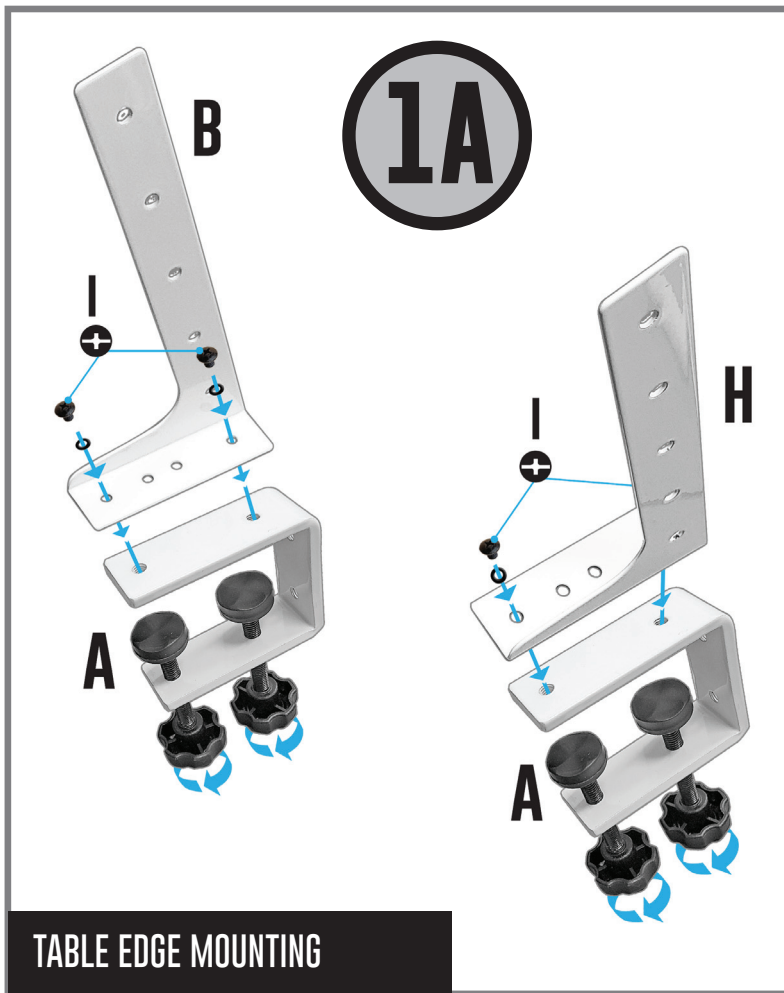

- For **Table Edge Mounting** position the **Edge Base Clamps (A)** with the **plastic knobs** pointed downward.
- Align the screw holes to the **Left L - Foot (H)** and **Right L - Foot (B)** bottom screw holes and screw in the **M6 Screws with Washers (I)**.

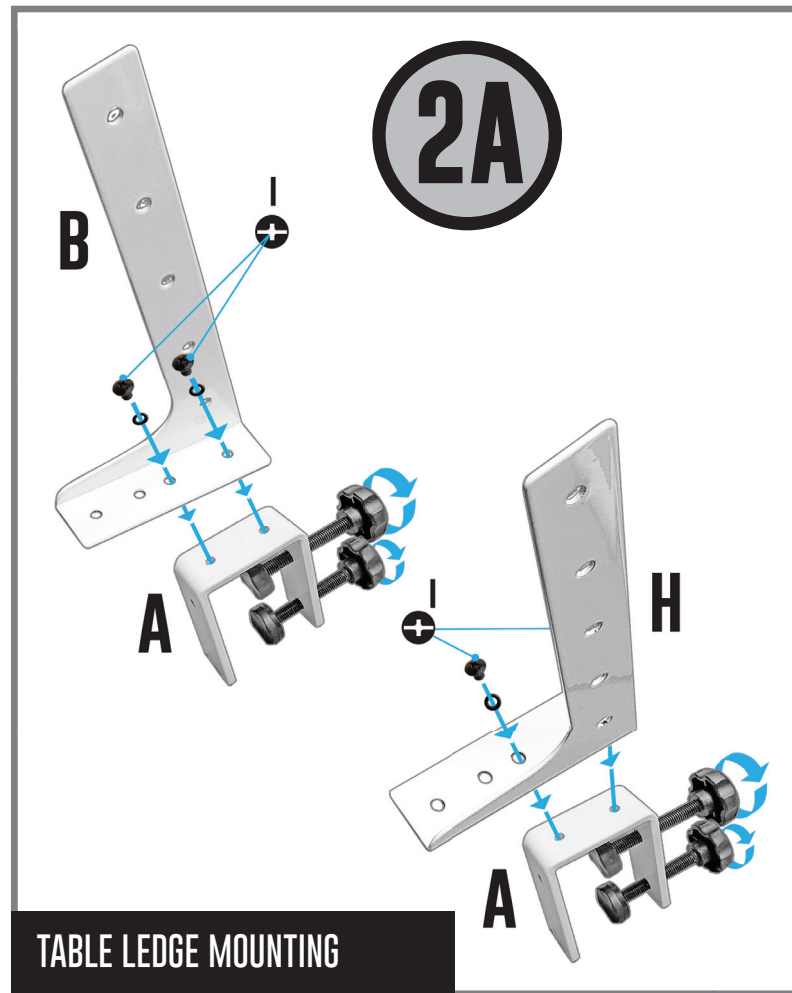

- For **Table Ledge Mounting** position the **Edge Base Clamps (A)** with the **plastic knobs** pointed to the sides.
- Align the screw holes to the **Left L - Foot (H)** and **Right L - Foot (B)** bottom screw holes and screw in the **M6 Screws with Washers (I)**.

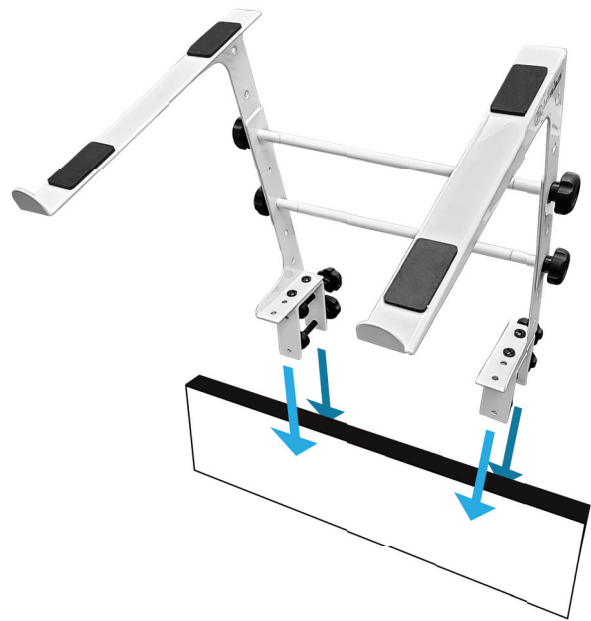
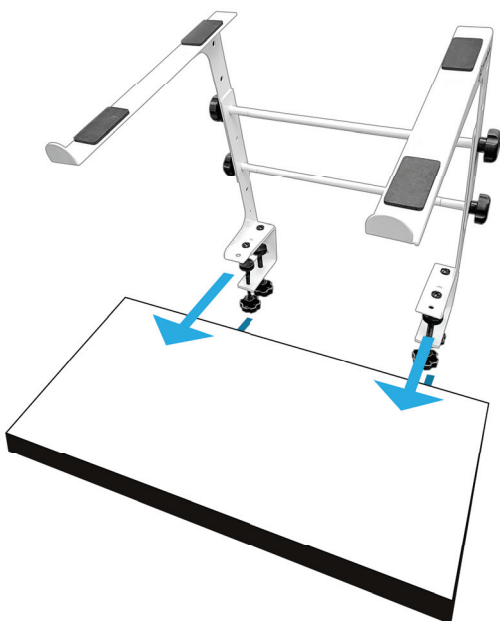

ADJUSTING THE STAND'S HEIGHT

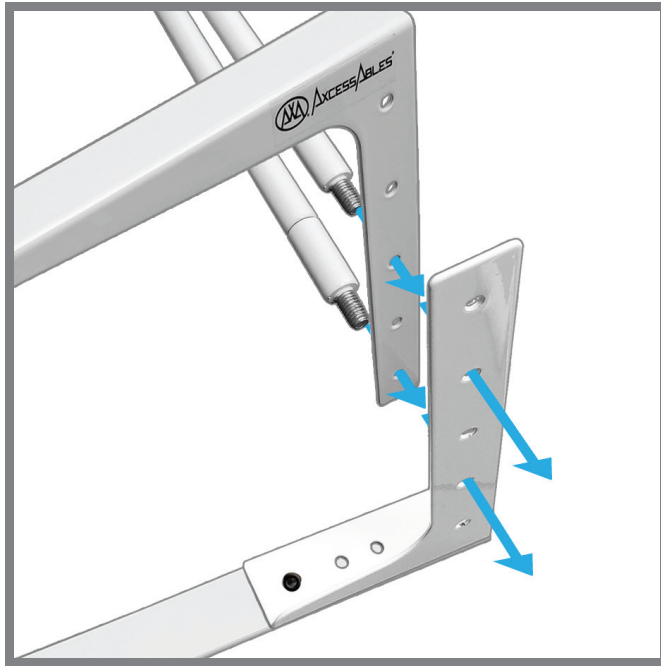

- Pick a preferred working height for your *LTS-02* Laptop Stand.
- Align the holes of the **Left and Right Top Arms** to the corresponding holes of the **Left and Right L-Footers**.
- Insert the **Width Adjust Rods**.
- Screw in the **Plastic Screw Knobs**.

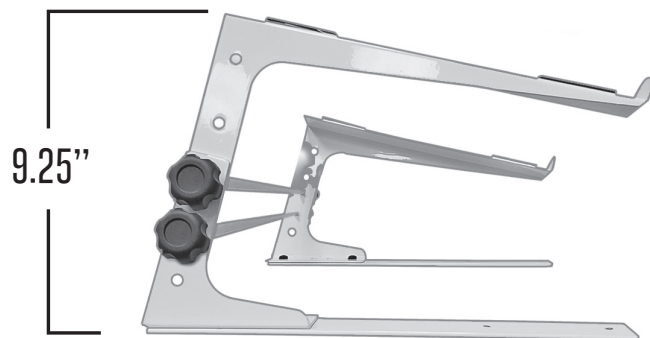
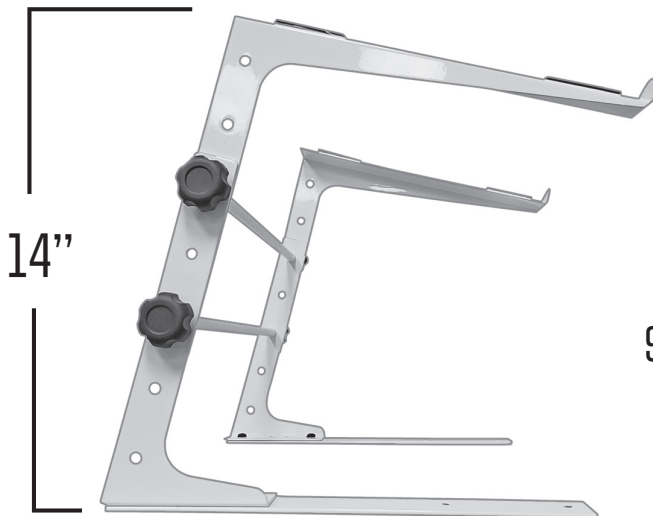

FOR
LAPTOPS



FOR
MIXERS



ANY QUESTIONS? VISIT US AT AXCESSABLES.COM