

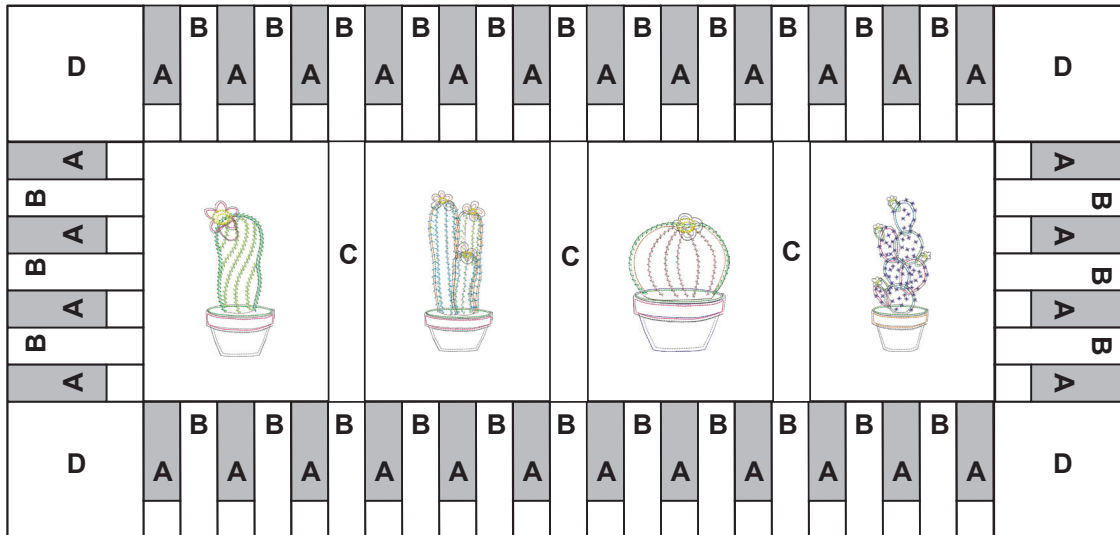

Sprinkle a little fun on your applique!

Cactus Table Runner

Finished size: 45" x 21½"



Materials: (WOF = 42")

- Four finished *Confetti Cactus* designs. Cut each to 8" x 11"
- **A strips:** 3 light fabrics: 2" x 42" (WOF) each; 3 dark fabrics: 4½" x 42" each (**OR** 6 fat quarters)
- **B and C strips:** 9 assorted fabrics: 2" x 42" each **OR** 9 fat quarters
- **D squares:** 1 fat quarter
- 1½ yards fabric for backing and ¼ yard for binding

Instructions:

A strips

Step 1: Cut one, 2" x WOF strip from each of the light fabrics and one, 4½" x WOF from each of the dark fabrics.

Step 2: Stitch one light strip and one dark strip together along the long edge with a ¼" seam to form a strip that is 6" x WOF. Repeat for other two sets.

Step 3: Subcut each of the three resulting strips into 11, 2" x 6" strips. **You will need 32 of these A strips.** You will have some fabric left over.

B and C strips

Step 1: Cut one, 2" x WOF strip from each 9 fabrics **OR** two, 2" x 21" strips from each fat quarter

Step 2: For C strips, choose three of the 9 assorted fabric strips and cut one 2" x 11" strip from each for a total of **three C strips**. With the remaining strips, subcut each strip into 2" x 6" pieces. **You will need 28 of these B strips** for the table runner. You may have some strips left over.

D squares

Step 1: Cut four, 6" x 6" corner squares.

A Strips

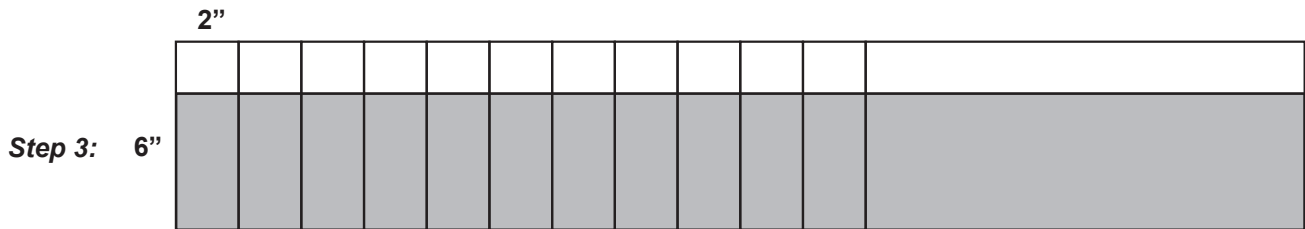
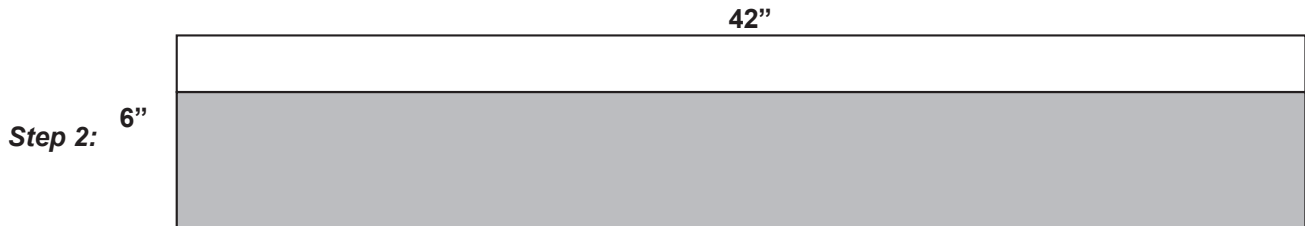
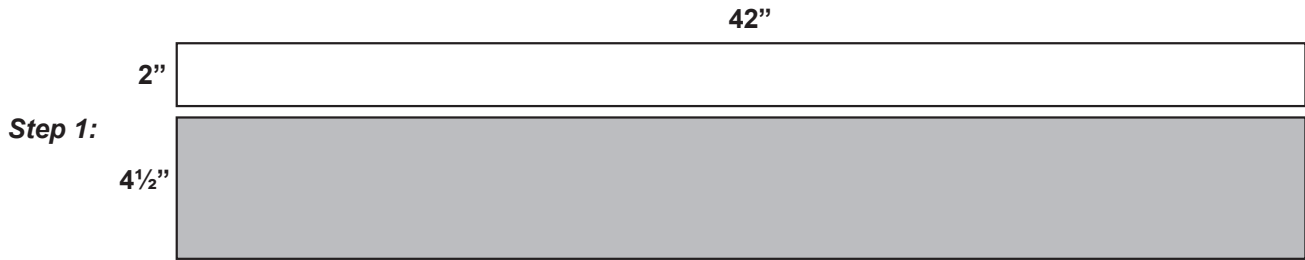

Cut 11 strips from each of the three sets. You need 32, 2" x 6" A strips.
You will have extra fabric.

B and C Strips

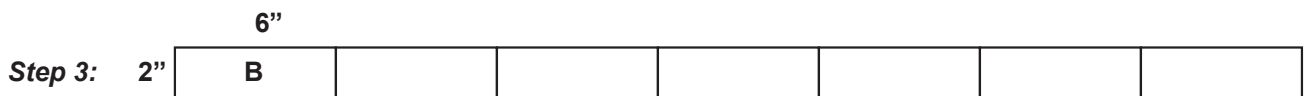
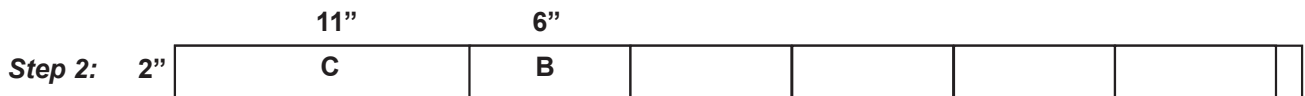
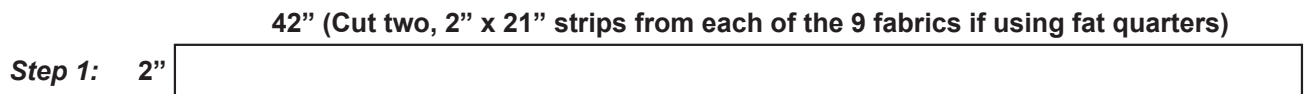

You will need 3, 2" x 11" C strips and 28, 2" x 6" B strips for border.



- Using the diagram below, join the A and B strips together using a ¼" seam. The top and bottom panels use 12, A strips and 11, B strips. The side panels use 4, A strips and 3, B strips.
- Add the D corners to the top and bottom strips.
- Join the 8" x 11" cactus blocks with the C strips using a ¼" seam.
- Join the side panels to the cactus panel.
- Add the top and bottom panels.
- Adding batting, quilt, and bind! You can also use this as a wall hanging, but remember to put a sleeve on the back.
- If this is a gift, be sure to add a label to the back!

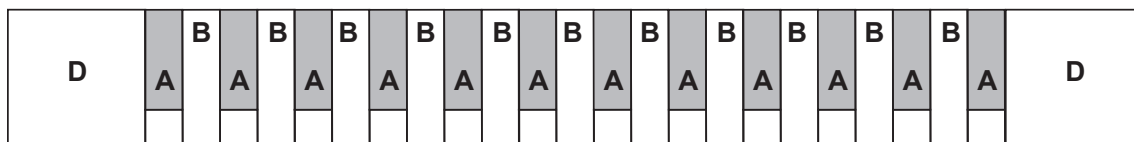
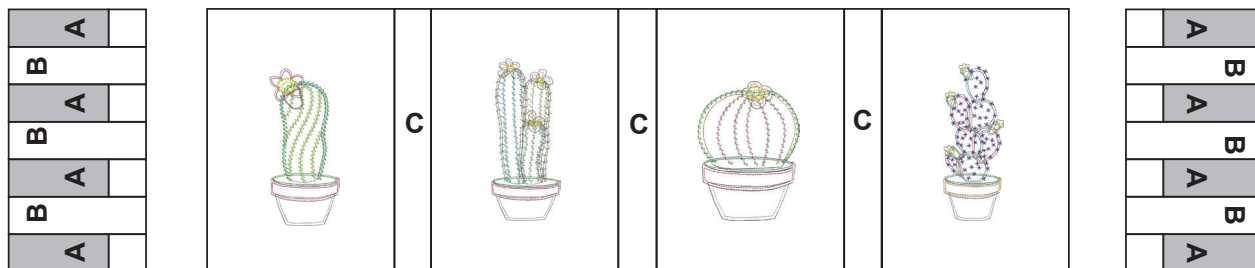
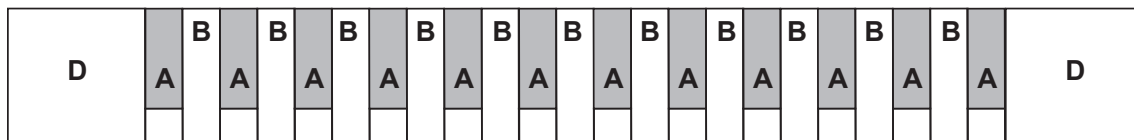

Finished Table Runner

