

zuster

Interlace 36 Inch Vanity Unit

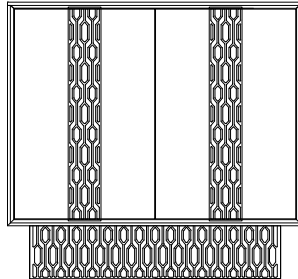

Vanity Fitting Instructions

- Prior to installation it is important to inspect the vanity to ensure no damage has occurred in transit. If damage has occurred, or a visible defect exists, do not proceed with the installation and advise supplier immediately. No warranty claim for damage will be accepted if the vanity is installed.
- Prior to installation check wall/tile surface where unit will be fitted is flat and even. Installing on uneven wall will result in the unit twisting – DO NOT PROCEED.
- It is recommended that the Corian top is protected during installation.

PLEASE NOTE: MANUFACTURER WILL NOT BE LIABLE FOR THE COST OF INSTALLATION OR REMOVAL OF THE VANITY & THE WARRANTY WILL BE VOIDED IF DAMAGE OCCURRED DURING INSTALLATION.

1. Check that the unit will fit into the location. On timber studded walls, mark the positions of the studs, so to be able to fix the unit to these later.

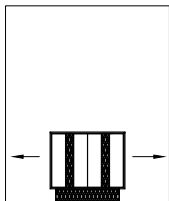

2. To aid Installation; first remove the doors by unclipping the hinges from the mounting plate. Place doors in a secure location in the meantime.

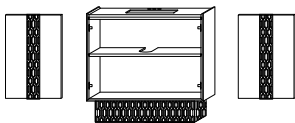

3. Line up the unit so that the units waste chamber aligns with the corresponding plumbing. Holes for waste outlet through the back are not pre-drilled. Cutting the waste outlet is left to the discretion of the plumber. Mark where unit is to be installed.

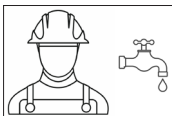

4. Mount unit by pre-drilling through any part of the back of the unit into the wall. Drill into the timber wall studs and attach using cabinet screws. These will need to be at both the top and bottom of the vanity unit to ensure its secure.

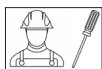
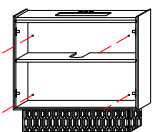

Vanity should be installed by a qualified, licensed trade person.

Plumbers, please ensure a copy of the Installation Instructions are left with the end user for future reference



Interlace 36 Inch Vanity Unit

5. Ensure the vanity is installed level; as this will affect the alignment of the doors. The unit **MUST ALSO SIT FLUSH** with wall when in contact with the ground.

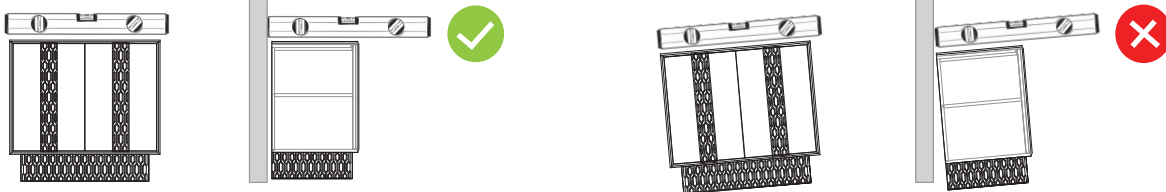

6. Ensure the corian is right way up to align with the waste cutout, as well as edge detail. Silicone needs to be applied to secure and mount onto the vanity permanently. Silicone all the way around the top edge of the cabinet where the unit meets any wall surface to ensure a proper protective seal.

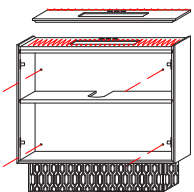

7. Attach the doors back on by sliding the hinges on the bracket and adjust accordingly using the hinge adjustment screws.

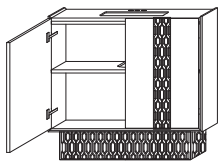

****Recommendation for Plumbing**

Waste should not be over tightened to avoid stress on basin and top.

TO MAKE ADJUSTMENT



Start by removing the Zuster tag off the hinge plate to reveal the phillips head screws.

SIDE TO SIDE ADJUSTMENT

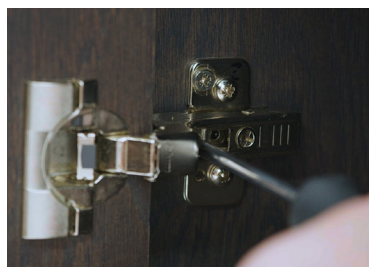

Turn front screw found closest to the door. This can be turned left or right.

DEPTH ADJUSTMENT

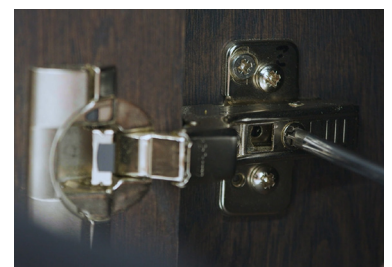

Turn back screw found at the back of the hinge. This can be turned left or right.

HEIGHT ADJUSTMENT

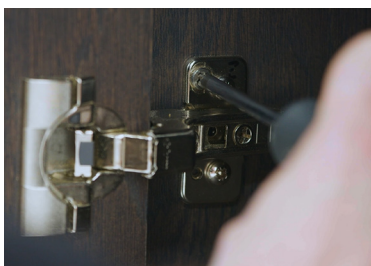

Turn screw found on the hinge mount. This can be turned left or right.

SCAN ME FOR A DETAILED ADJUSTMENT VIDEO:



Plumbers, please ensure a copy of the Installation Instructions are left with the end user for future reference