

4

3

2

1

REVISIONS				
ZONE	REV	DESCRIPTION	DATE	APPROVED
--	1	INITIAL RELEASE	02017-MMM-DD	- -
	2	CLAMP RINGS VISUALLY CHANGED	02022-MAR-04	MZ

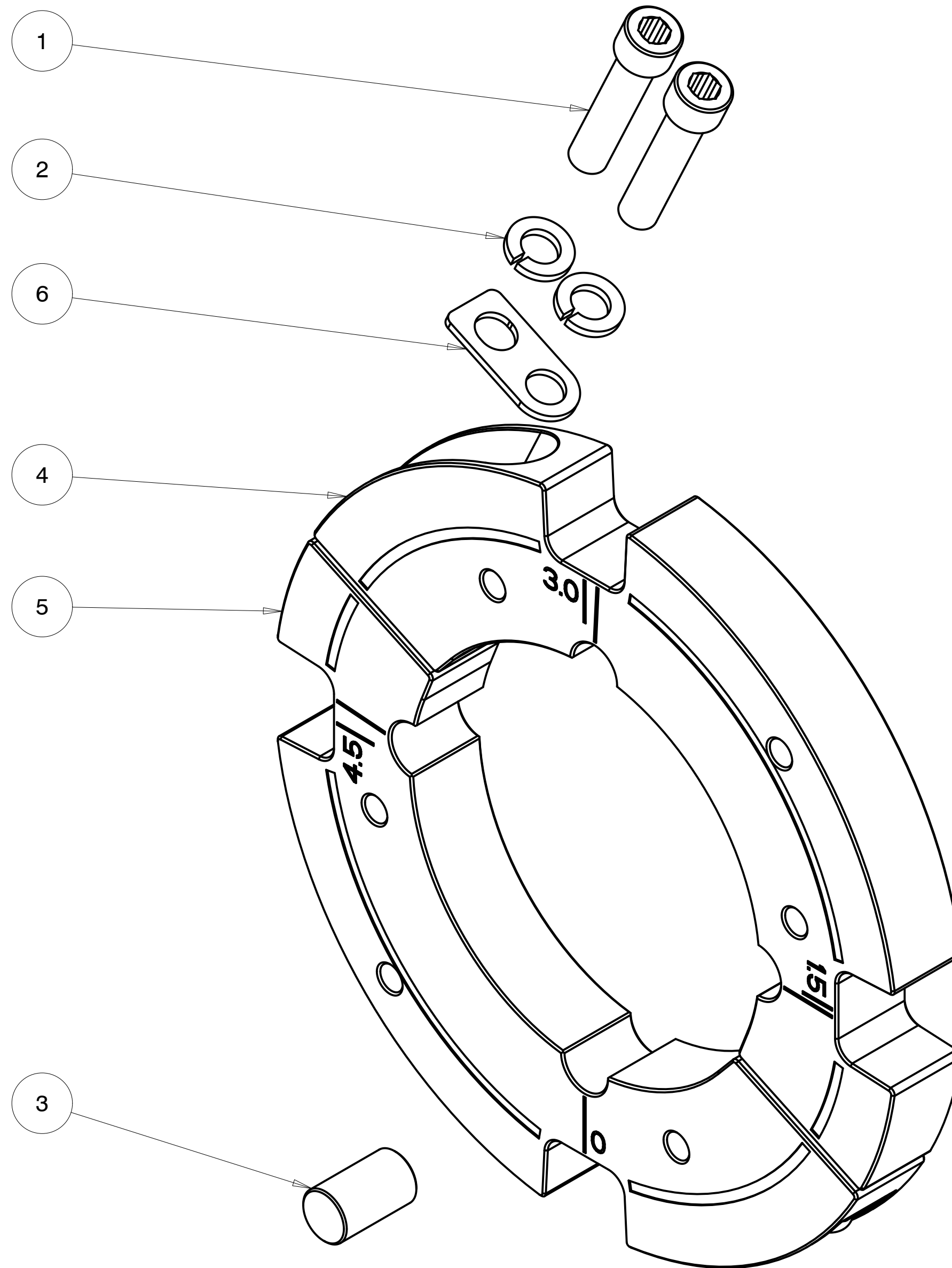

ITEM NO.	QTY REQD.	PART NO.	DRAWING TITLE OR DESCRIPTION	MANUFACTURER	MFG PART NO.
6	2	560-001-1442	WASHER PLATE, NOTCH RING, MT	FAB	---
5	1	560-001-1440-02	NOTCH RING 0 AND 4.5 DEGREE, MT	FAB	---
4	1	560-001-1440-01	NOTCH RING 1.5 AND 3.0 DEGREE, MT	FAB	---
3	1	90-400-750-1250-20	DOWEL PIN, .750 DIA X 1.250 L 18-8	MCMASTER	90145A992
2	4	90-310-510-870-120-20	WASHER, SPLIT LOCK .510 ID X .87 X .120TK, SST	MCMASTER	92146A033
1	4	90-100-500C-2250-20	SCREW, 1/2-13 X 2.25 SCH, SST 18-8	MCMASTER	92196A721

UNLESS OTHERWISE SPECIFIED DIMENSIONS ARE IN INCHES.

TOLERANCES ARE:

.X +/- 0.1

.XX +/- 0.01

.XXX +/- 0.001

ANGLES +/- 0.5

INTERPRET DIMENSIONS PER ASME Y14.5M 1994 (R2004)

PRO/E REPORTED PARAMETERS	DESIGNER
PRO/E MATERIAL: N/A	N UEBEL
PRO/E MASS: 6.624	ENGINEER: N UEBEL
PRO/E VOLUME: N/A	02017-MMM-DD
PRO/E DRAWING FILE NAME: 560-001-9440	DRAFTER: ---
	02017-MMM-DD
	CHECKED: ---
	02017-MMM-DD

DO NOT SCALE DRAWING

UNIVERSAL SONAR MOUNT		
ASSEMBLY, NOTCH RING, 6" POLE W/ NOTCH		
SIZE	CUSTOMER DRAWING/PART NO.	REV
C	---	2
DRAWING/PART NO.		
560-001-9440		
SCALE	0.800	SHEET 1 OF 2

4

3

2

1

CUSTOMER DRAWING/PART NO. ---

DRAWING/PART NO. 560-001-9440

REV 2

SHT 1

D

D

C

B

A

A

4

3

2

1

REVISIONS
SEE SHEET 1

D

CUSTOMER DRAWING/PART NO.

DRAWING/PART NO.

560-001-9440

REV

2

SHT

2

A



UNIVERSAL SONAR MOUNT		
ASSEMBLY, NOTCH RING, 6" POLE W/ NOTCH		
SIZE	CUSTOMER DRAWING/PART NO.	REV
C	---	2
	DRAWING/PART NO. 560-001-9440	
SCALE	1.000	SHEET 2 OF 2

4

3

2

1

D

CUSTOMER DRAWING/PART NO.

DRAWING/PART NO.

560-001-9440

REV

2

SHT

2

A

D

CUSTOMER DRAWING/PART NO.

DRAWING/PART NO.

560-001-9440

REV

2

SHT

2

A