

4

3

2

1

REVISIONS				
ZONE	REV	DESCRIPTION	DATE	APPROVED
--	1	INITIAL RELEASE	2022-FEB-23	MZ

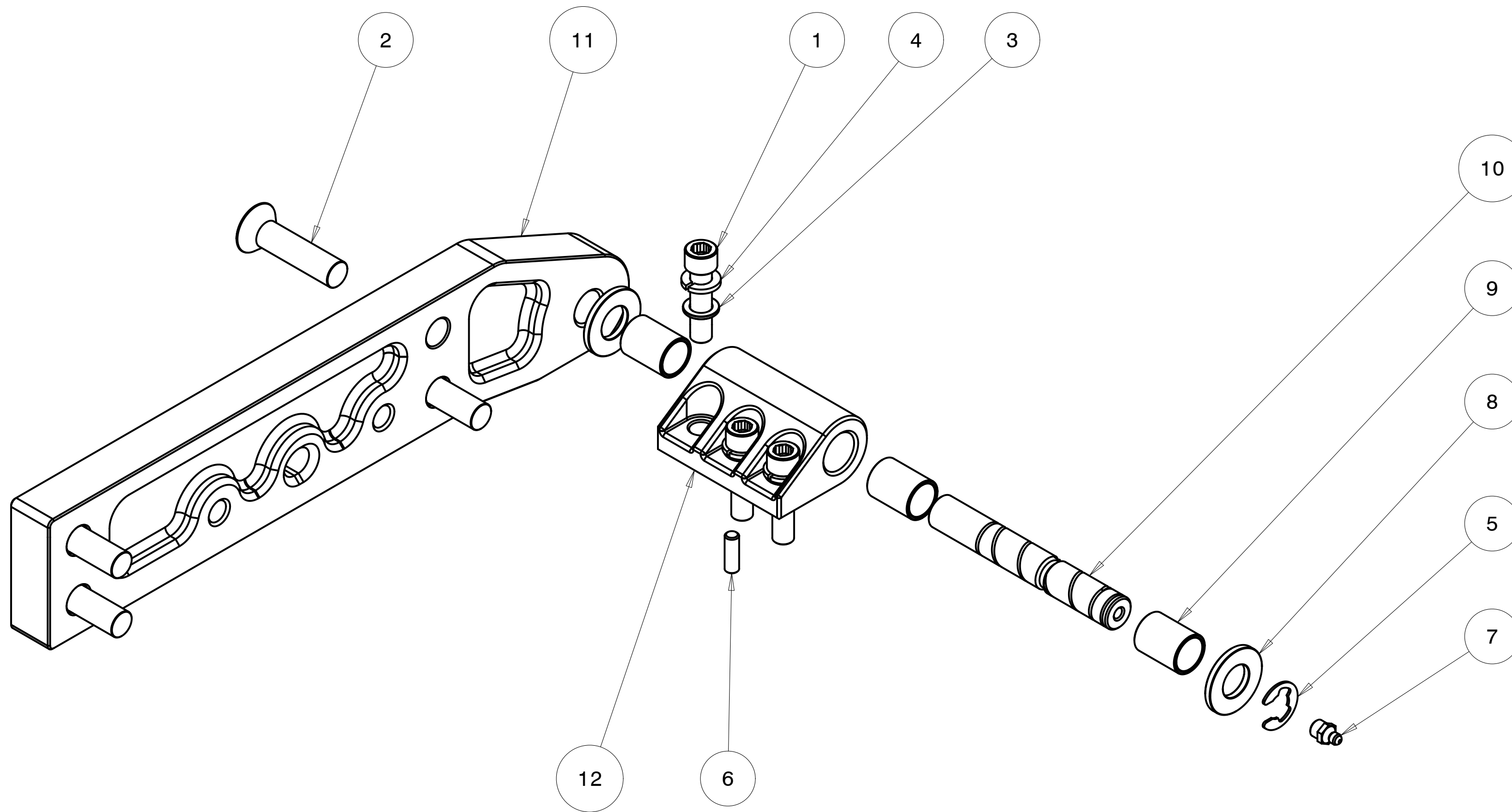

ITEM NO.	QTY REQD.	PART NO.	DRAWING TITLE OR DESCRIPTION	MANUFACTURER	MFG PART NO.
12	1	560-1036-01	USM, HINGE, CLEAR HOLE	FAB	---
11	1	560-001-1025-02	HINGE STRAP, RIGHT, MT	FAB	---
10	1	560-001-1024	USM, HINGE SHAFT, MT	FAB	---
9	3	500-1042	BUSHING, HINGE KNUCKLE	FAB	---
8	2	500-1038	HINGE WASHER, 1.275 OD X .630 ID X .125 TH	FAB	---
7	1	94-350-313F-344-01-23	GREASE FITTING, 5/16-24-UNF STRAIGHT 303 SST	MCMaster	1293K44
6	2	90-400-250-750-21	DOWEL PIN, .250 DIA X .750 L 316	MCMaster	97395A485
5	1	90-355-485-042-20	E-CLIP, .625 SHAFT, .485 GROOVE, .042 W, SST	MCMaster	98408A140
4	3	90-310-380-680-090-20	WASHER, SPLIT LOCK .380 ID X 68 OD X .090TK, 18-8 SST	MCMaster	92146A031
3	3	90-300-390-625-06-20	WASHER, .390 X .63 X .060 18-8 SST	MCMaster	98017A200
2	4	90-110-500C-2000-20	SCREW, 1/2-13 UNC X 2.0 FHC 18-8	MCMaster	92210A720
1	3	90-100-375C-1500-20	SCREW, 3/8-16 X 1.500 SHC 18-8 SST	MCMaster	92196A628

UNLESS OTHERWISE SPECIFIED DIMENSIONS ARE IN INCHES.		CREO REPORTED PARAMETERS		DESIGNER	
TOLERANCES ARE:		DANNY HILLIS		DANNY HILLIS	
.X +/-	0.1	CREO MATERIAL	G STAPLES	2022-MMM-DD	
.XX +/-	0.01	CREO MASS	M ZASSO	2022-MMM-DD	
.XXX +/-	0.001	CREO VOLUME	---	2022-MMM-DD	
ANGLES +/-	0.5	CREO DRAWING FILE NAME:	DO NOT SCALE DRAWING		
INTERPRET DIMENSIONS PER ASME Y14.5M 1994 (R2004)		560-001-9025-02			

UNIVERSAL SONAR MOUNT		
ASSEMBLY, HINGE, RIGHT, MT		
SIZE	CUSTOMER DRAWING/PART NO.	REV
C	---	2
DRAWING/PART NO.		
560-001-9025-02		
SCALE	0.625	SHEET 1 OF 2

4

3

2

1

CUSTOMER DRAWING/PART NO. ---  
 DRAWING/PART NO. 560-001-9025-02  
 REV 2  
 SHT 1

A

4

3

2

1

REVISIONS  
SEE SHEET 1

CUSTOMER DRAWING/PART NO.

---

DRAWING/PART NO.

560-001-9025-02

REV

2

SHT

2

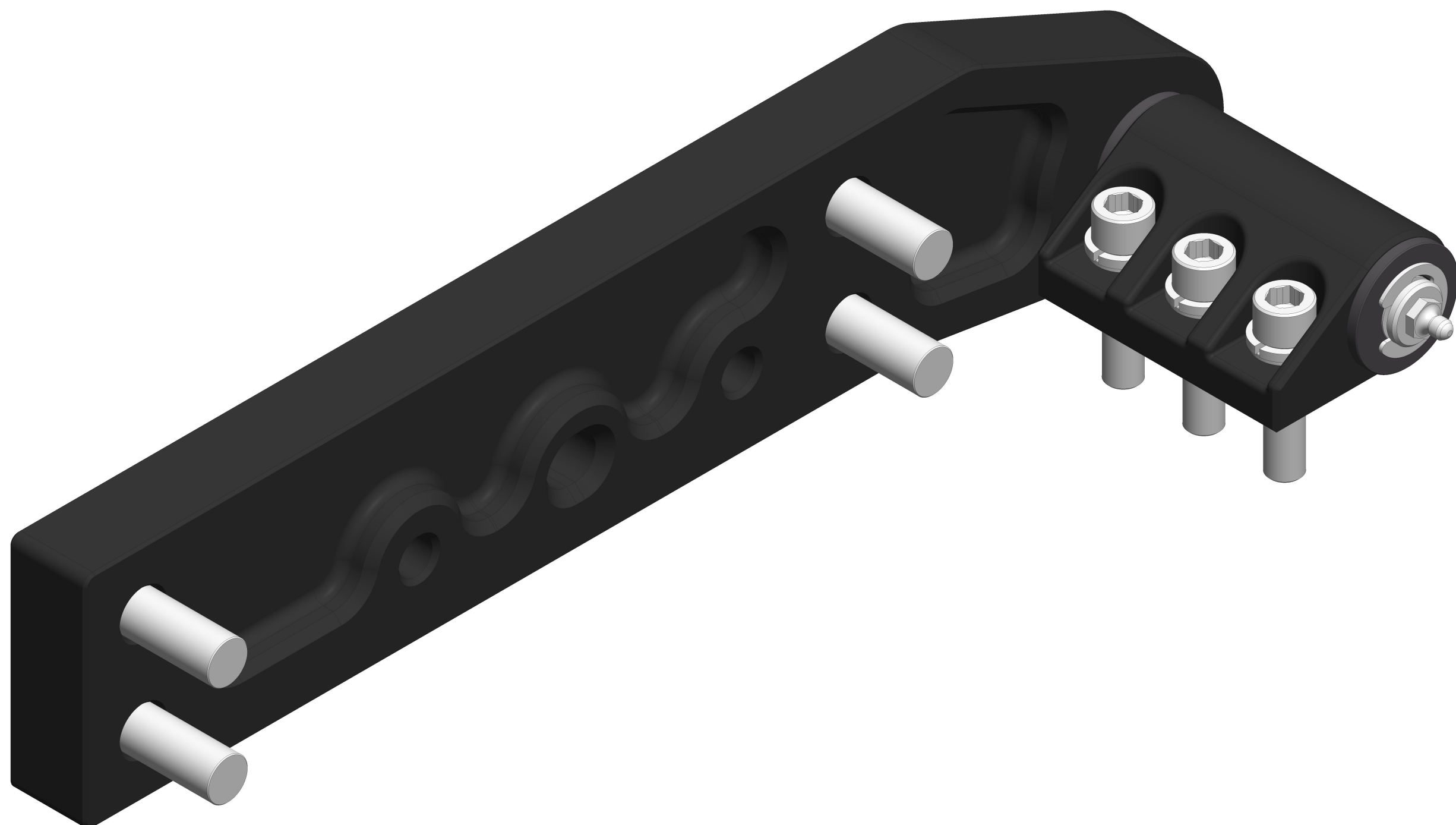

UNIVERSAL SONAR MOUNT		
ASSEMBLY, HINGE, RIGHT, MT		
SIZE	CUSTOMER DRAWING/PART NO.	REV
<b>C</b>	---	2
	DRAWING/PART NO. 560-001-9025-02	
SCALE	1.000	SHEET 2 OF 2

4

3

2

1

A

D

C

B

A

D

C

B

A