

4

3

2

1

REVISIONS				
ZONE	REV	DESCRIPTION	DATE	APPROVED
--	1	INITIAL RELEASE	02022-JAN-19	MZ

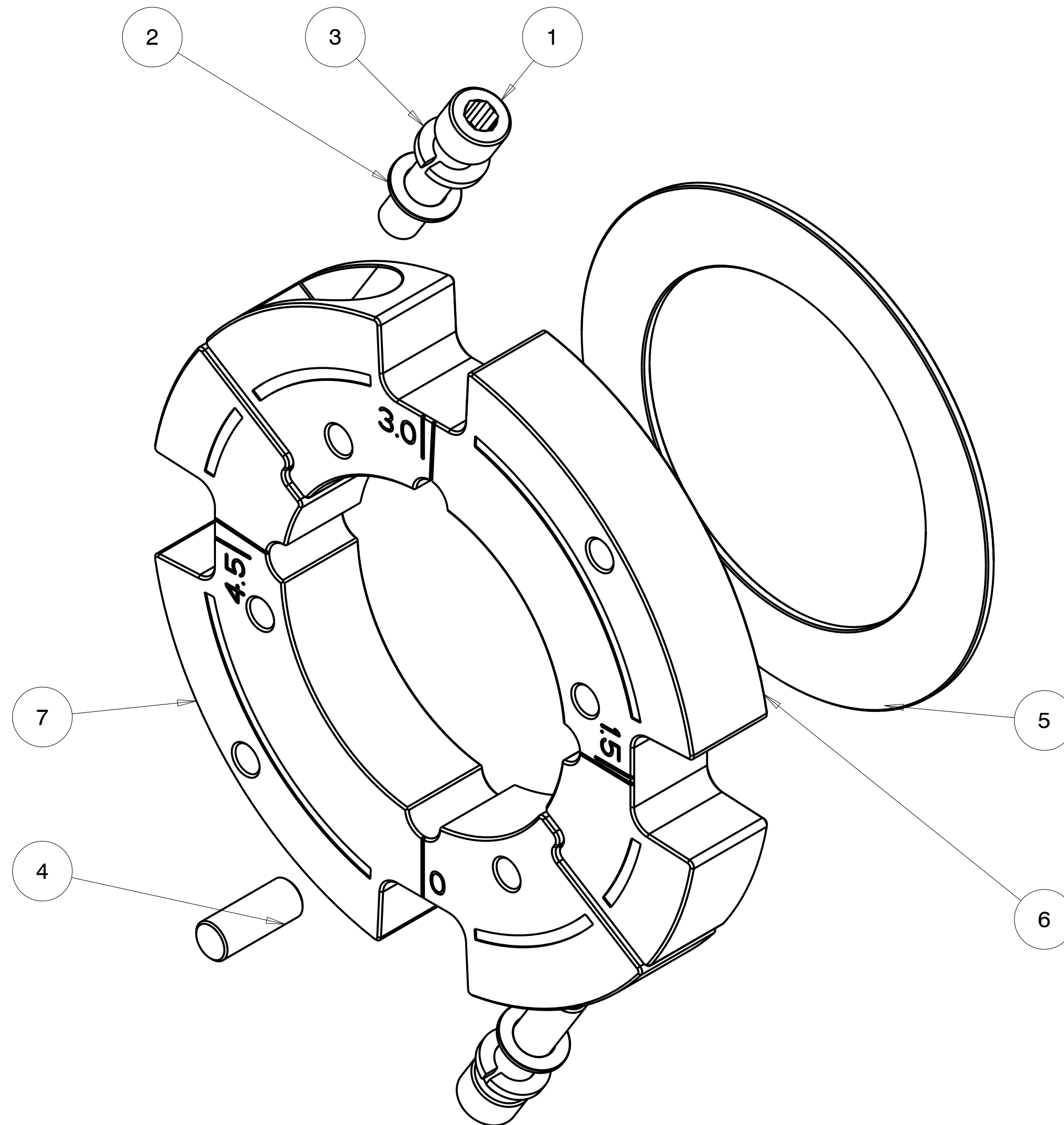

ITEM NO.	QTY REQD.	PART NO.	DRAWING TITLE OR DESCRIPTION	MANUFACTURER	MFG PART NO.
7	1	500-001-1440-02	NOTCH RING, 0 AND 4.5 DEGREES, HT	FAB	---
6	1	500-001-1440-01	NOTCH RING, 1.5 AND 3.0 DEGREE, HT	FAB	---
5	1	500-001-1005	THRUST WASHER, X POLE, HT	FAB	---
4	1	90-400-500-1250-20	DOWEL PIN, .500 ID X 1.250 L 18-8	MCMMASTER	90145A714
3	2	90-310-510-870-120-20	WASHER, SPLIT LOCK .510 ID X .87 X .120TK, SST	MCMMASTER	92146A033
2	2	90-300-515-875-060-20	WASHER, .515 ID X .875 OD X .060 18-8	MCMMASTER	98017A210
1	2	90-100-500C-2000-20	SCREW, 1/2-13 X 2 SCH, SST 18-8	MCMMASTER	92196A720

UNLESS OTHERWISE SPECIFIED DIMENSIONS ARE IN INCHES. TOLERANCES ARE: .X +/- 0.1 .XX +/- 0.01 .XXX +/- 0.001 ANGLES +/- 0.5 INTERPRET DIMENSIONS PER ASME Y14.5M 1994 (R2004)	PRO/E REPORTED PARAMETERS	DESIGNER G STAPLES	
	PRO/E MATERIAL N/A	ENGINEER G STAPLES	02019-AUG-15
	PRO/E MASS 4.719	DRAFTER G STAPLES	02019-AUG-15
	PRO/E VOLUME N/A	CHECKED ---	02019-AUG-15
PRO/E DRAWING FILE NAME: 540-001-9440	DO NOT SCALE DRAWING		

UNIVERSAL SONAR MOUNT		
ASSEMBLY, NOTCH RING, 4.5" POLE W/ NOTCH		
SIZE	CUSTOMER DRAWING/PART NO.	REV
C	---	1
DRAWING/PART NO. 540-001-9440		
SCALE	0.875	SHEET 1 OF 2

4

3

2

1

CUSTOMER DRAWING/PART NO. ---
 DRAWING/PART NO. 540-001-9440
 REV 1
 SH1 1

A

D

D

C

B

A

4

3

2

1

REVISIONS
SEE SHEET 1

D

CUSTOMER DRAWING/PART NO.

DRAWING/PART NO.
540-001-9440

REV
1

SHT
2

A

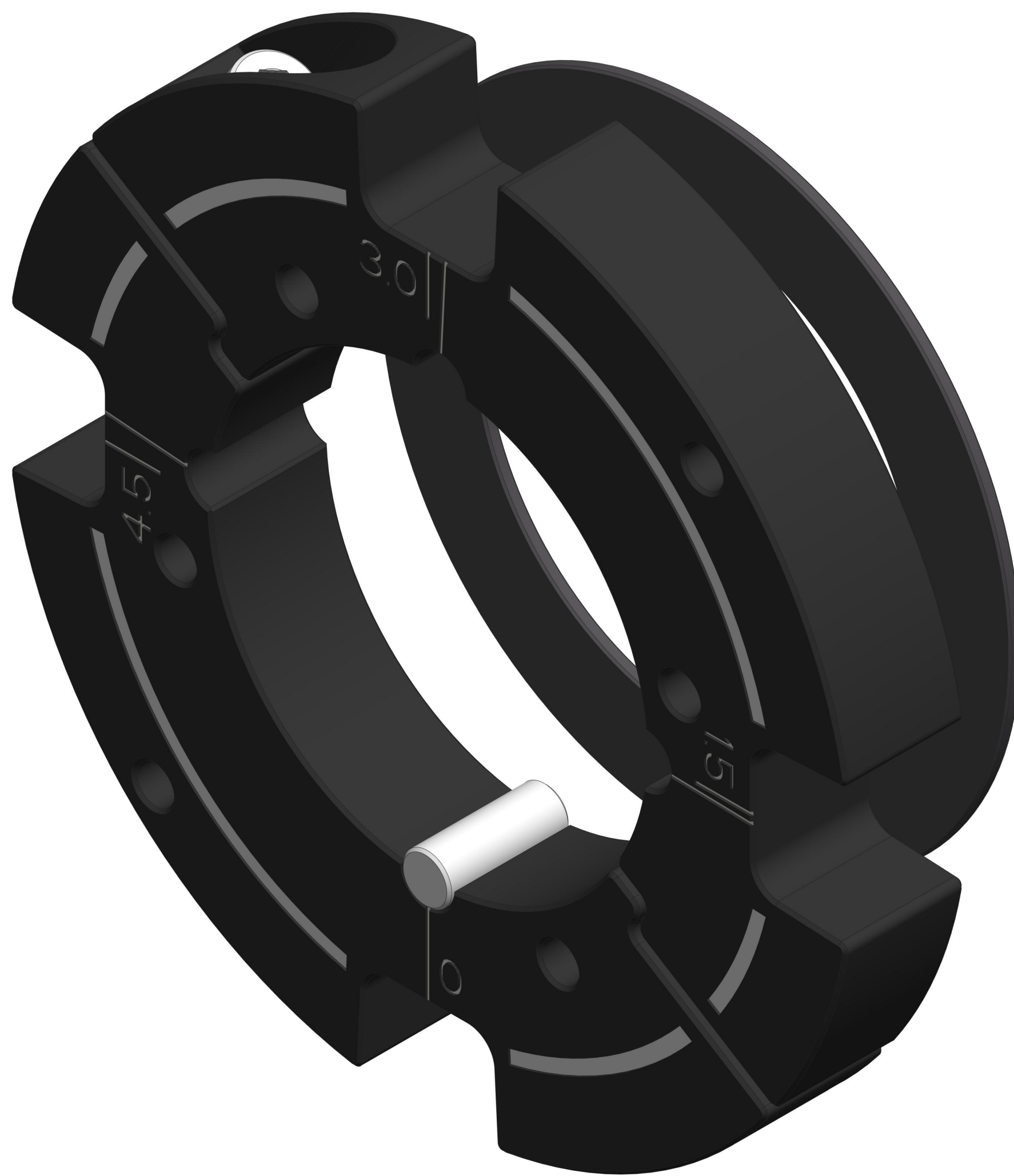

UNIVERSAL SONAR MOUNT		
ASSEMBLY, NOTCH RING, 4.5" POLE W/ NOTCH		
SIZE	CUSTOMER DRAWING/PART NO.	REV
C	---	1
	DRAWING/PART NO. 540-001-9440	
SCALE	1.250	SHEET 2 OF 2

4

3

2

1

D

CUSTOMER DRAWING/PART NO.

DRAWING/PART NO.
540-001-9440

REV
1

SHT
2

A

A