

NOTES: UNLESS OTHERWISE SPECIFIED.

- 1. FOR DIMENSIONS NOT SHOWN SEE COMPUTER GENERATED FILE: 501-1790 REV: 3
- 2. MATERIAL: AL 6061
- 3. FINISH: 125RMS
- 4. PLATING: ANODIZE TYPE III CLASS 2 (DYED HARD COAT, BLACK) W/ TEFLON SEAL
- 5. PAINT: NONE
- 6. ONE HALF OF A FEATURE DIMENSIONED ACROSS A CENTER LINE AND/OR A SYMMETRIC CALLOUT IS EQUAL TO THE DIMENSION SHOWN DIVIDED BY TWO AND ITS TOLERANCE DIVIDED BY TWO.
- 7. BREAK AND DEBURR ALL SHARP EDGES.
- 8. PART TO BE FREE FROM DIRT AND OILS.

REVISIONS				
ZONE	REV	DESCRIPTION	DATE	APPROVED
--	1	INITIAL RELEASE	02011-FEB-15	--
	2	INITIAL RELEASE	02011-JUN-02	
	3	WRENCH SIZE WAS 3.52, PLATING	02012-MAY-01	

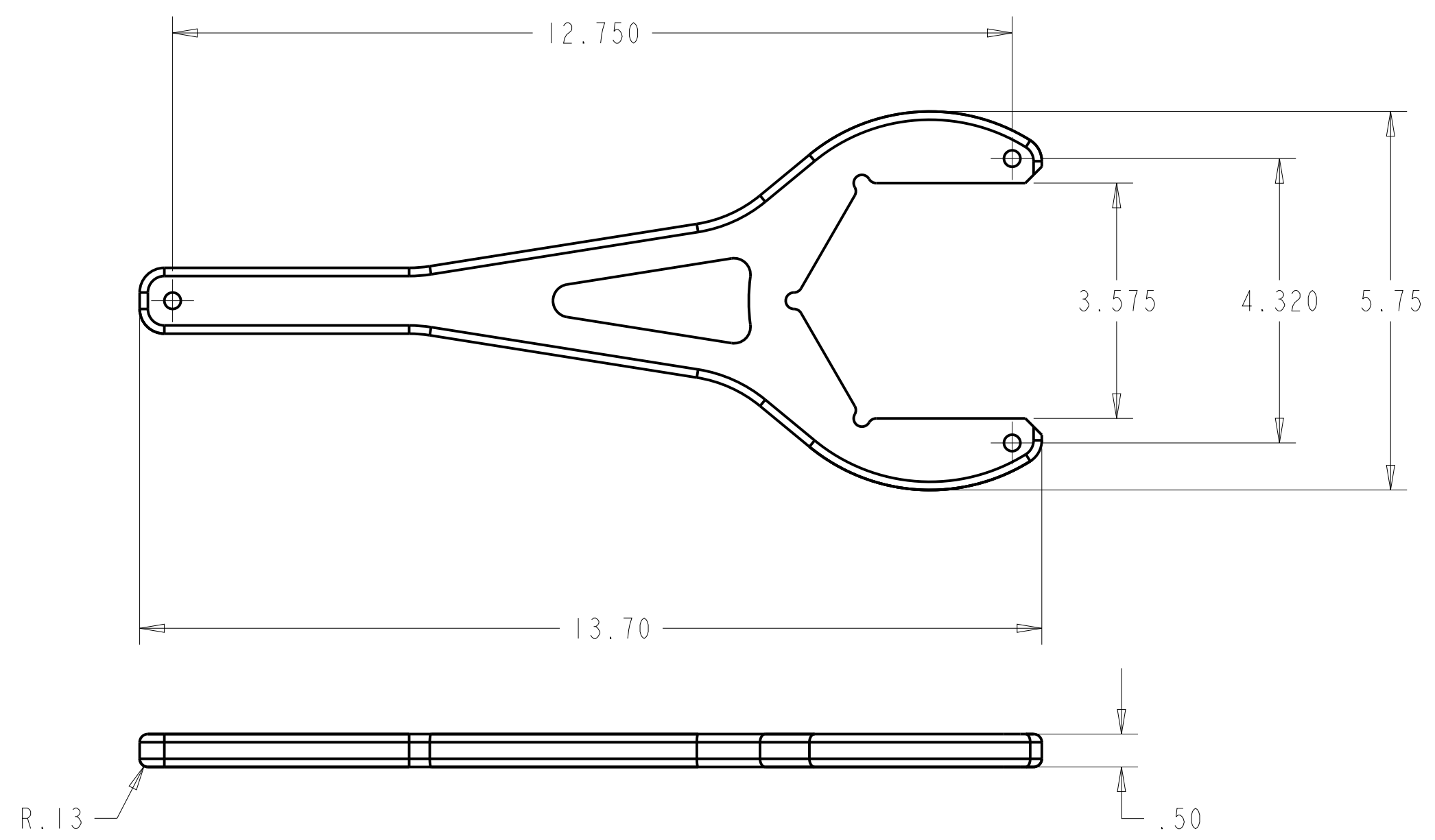
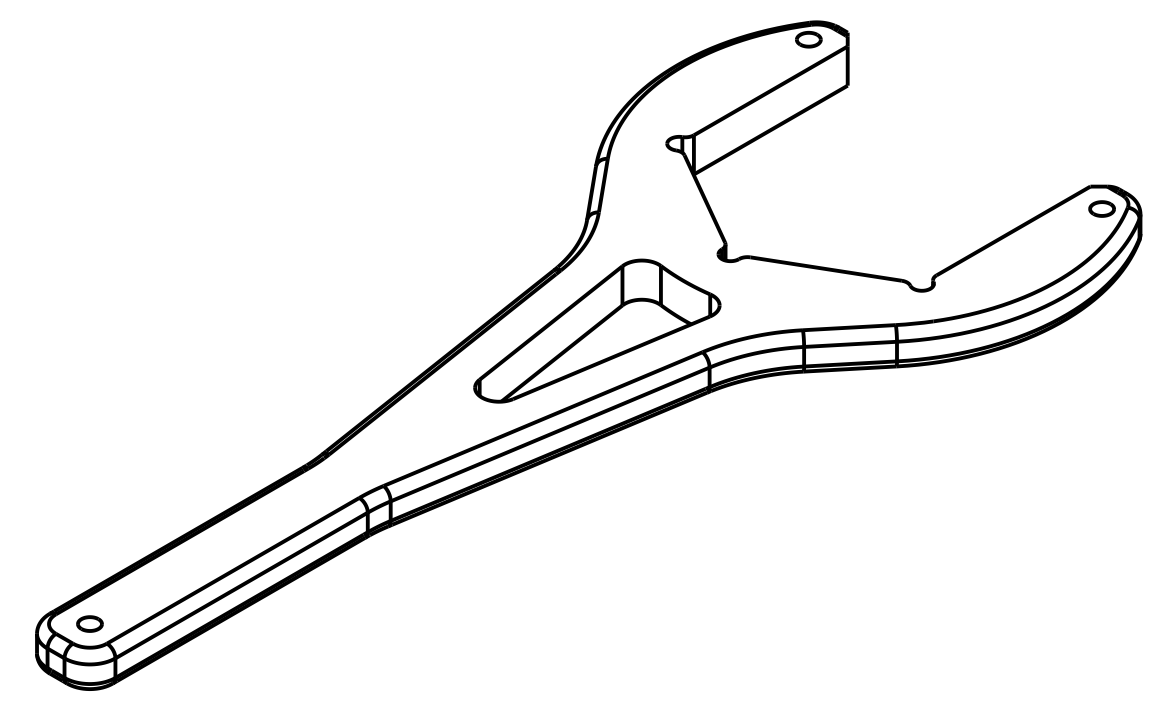

UNIVERSAL SONAR MOUNT

WRENCH, QC ADAPTOR, USM

UNLESS OTHERWISE SPECIFIED DIMENSIONS ARE IN INCHES. TOLERANCES ARE: .X +/- 0.1 .XX +/- 0.01 .XXX +/- 0.005 ANGLES +/- 0.5 INTERPRET DIMENSIONS PER ASME Y14.5M 1994 (R2004)	PRO/E REPORTED PARAMETERS		DESIGNER	
	PRO/E MATERIAL	AL6061	G STAPLES	
	PRO/E MASS	1.008	ENGINEER	G STAPLES 02011-FEB-15
	PRO/E VOLUME	10.292	DRAFTER	--- 02011-FEB-15
	PRO/E DRAWING FILE NAME:	501-1790	CHECKED	--- 02011-FEB-15
			DO NOT SCALE DRAWING	

SIZE	CUSTOMER DRAWING/PART NO.	REV
C	---	3
	DRAWING/PART NO.	
	501-1790	
SCALE	0.500	SHEET 1 OF 1

CUSTOMER DRAWING/PART NO. ---
 DRAWING/PART NO. 501-1790
 REV 3
 SH 1