

# JET TECH TECHNICAL MANUAL



**737E**  
HIGH-TEMP UNDERCOUNTER  
DELUXE DISHWASHER  
**ELECTRONIC SERIES**





# Contacts

## Technical Support 1-888-275-4538

Robert Marsolais	Service Manager	225	robert@mvpgroupcorp.com
Alan Gallagher	Service Consultant	214	alan@mvpgroupcorp.com
Jonathan Menard	Service Consultant	230	jonathan@mvpgroupcorp.com
Richard M. Hiller	Special Projects Manager	211	richard@mvpgroupcorp.com

service@mvpgroupcorp.com

# Tools

Some of the tools you will need to repair and service the 737e.

- Volt Meter
- Temperature meter
- Allen Keys (Metric)
- Phillips screw driver
- Nut drivers (Metric)
- Wrenchs (Metric)



US (inches)	Metric (mm)
1/8	3.18
5/32	3.97
	4
3/16	4.76
	5
13/64	5.16
7/32	5.56
15/64	6.05
	6
1/4	6.35
17/64	6.75
	7
9/32	7.14
5/16	7.94
	8
11/32	8.73
	9
3/8	9.53
	10
	11
7/16	11.11
15/32	11.91
	12
1/2	12.7
	13
17/32	13.49
	14

# Top of 737e

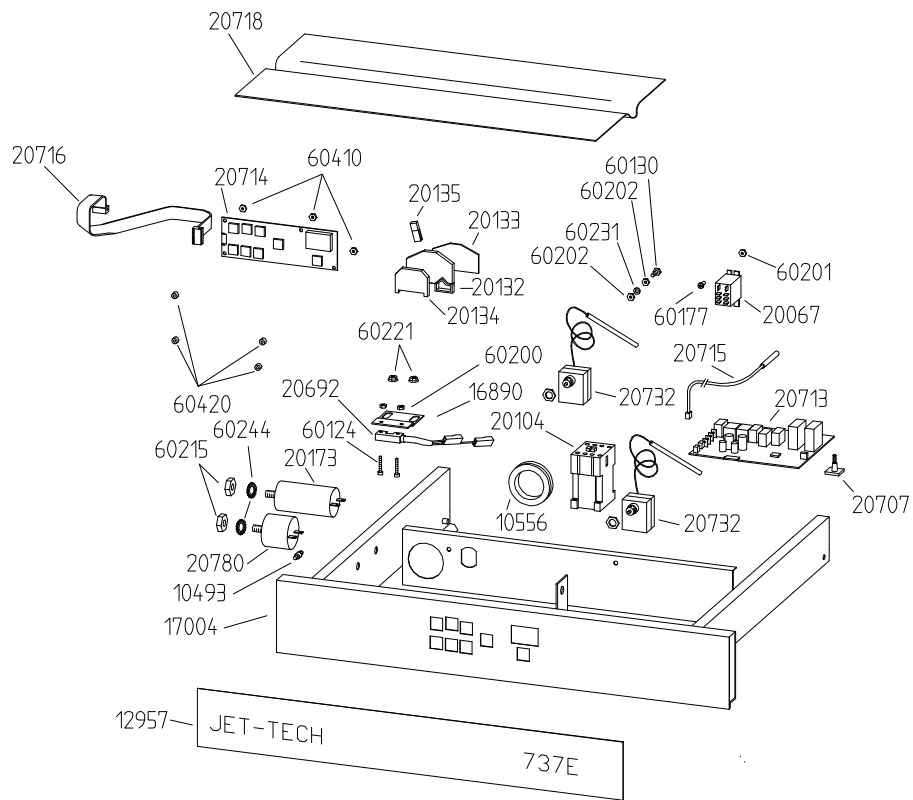
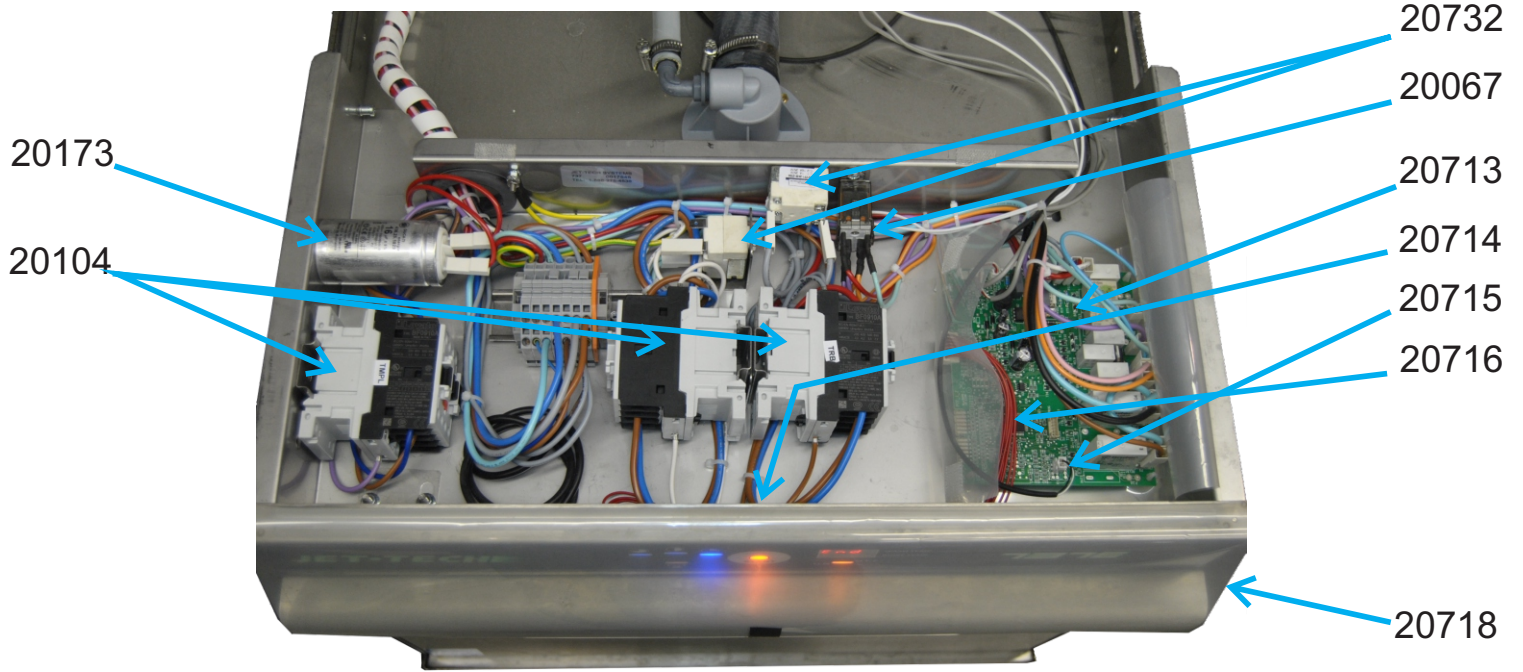

20714

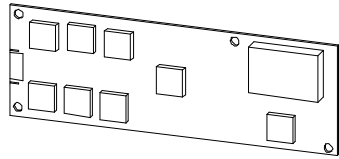

20713

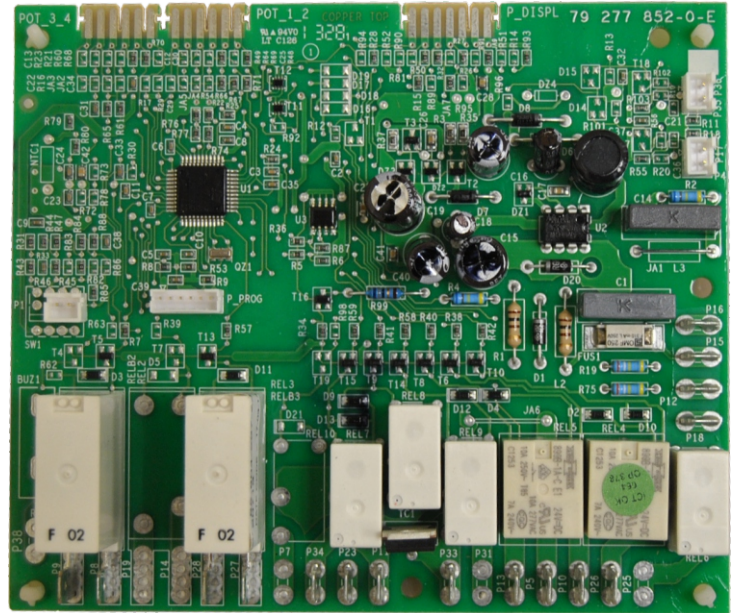
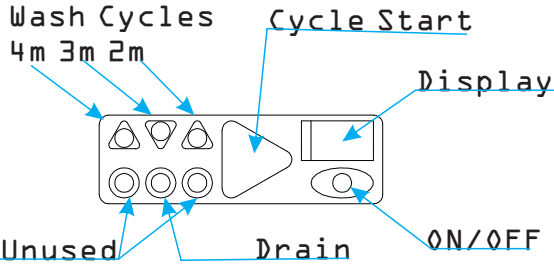
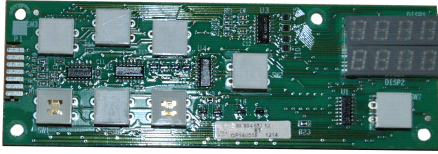
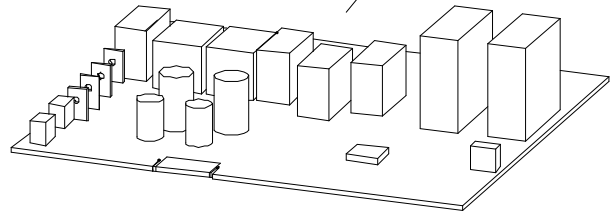

Touch-Pad

Final Rinse Probe

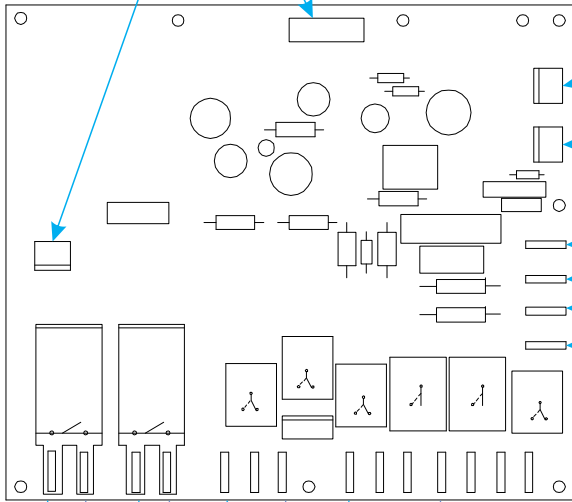

- P36 temperature probe Wash Tank
- P35
- P17 Temperature probe rinse booster
- P4
- P16 Power line L1
- P15 Power line L2
- P12 Door switch signal
- P18 Water level signal

- Booster Heat
- Wash Heat
- Incoming Water (chemicals)
- Power Line L2
- Wash
- Drainage

# ELECTRONIC BOARD PROGRAMMING

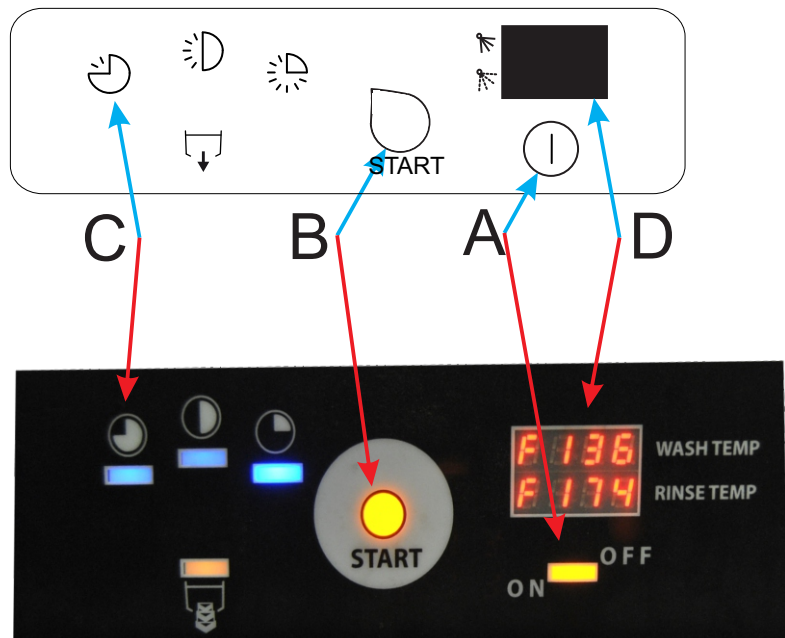

## MENU ACCESS





### Level 1

Level 1 access will allow you to change the first 4 settings.

- 1 TURN THE MACHINE ON AND OFF BY PRESSING BUTTON **A**.  
(IF THE MACHINE IS ALREADY ON, TURN IT OFF BY PRESSING BUTTON **A**)
- 2 PRESS BUTTON **B** SEVEN (7) TIMES WITHIN (10) SECONDS FROM TURNING OFF MACHINE.
- 3 PRESS AND KEEP PRESSING BUTTON **C** ONCE QUICKLY.  
"P-00 STOP" WILL BE ON THE DISPLAY.

### MODIFY PARAMETERS

- 1 SELECT A PARAMETER BY SCROLLING THROUGH THE MENU WITH BUTTON **B**.
  - 2 PRESS BUTTON **C** TO ENTER INTO THE PARAMETER MODIFICATION.
  - 3 PRESS BUTTON **B** TO MODIFY THE PARAMETER WITH AVAILABLE OPTIONS AND BUTTON **C** TO CONFIRM THE MODIFICATION.
- ONCE YOU CONFIRM THE MODIFICATION, YOU RETURN TO POINT 1 WITH THE OPTION TO SELECT ANOTHER PARAMETER BY SCROLLING THROUGH THE MENU WITH BUTTON **B**.

P-00 STOP	P-01 T-BL	P-02 T-VA	P-03 SOFT
Thermostop 0= not active 1=active default:0	Temperature boiler Min 60C 140F Max 95C 200F Default 85C 185F	Temperature Tank Set to 70C 160F Default 60C 140F	Soft start 0= not active 1= active default: 1 ,set to 0
			

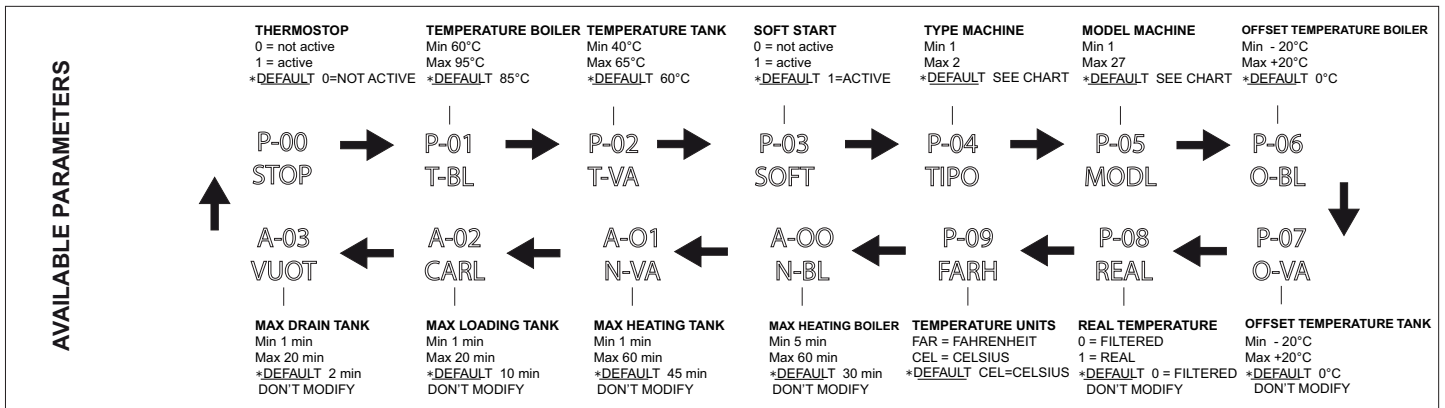







P04 (DISPLAY)	P05 (DISPLAY)	MODEL	CYCLE		DRAIN PUMP
2	8	727E / 737E	120 + 180 + 240 sec		YES
4	31	757E	70 + 120 + 180 + 240 sec		

# Level 2

Level 2 access will allow you to change all 14 settings.

- 1 TURN THE MACHINE ON AND OFF BY PRESSING BUTTON **A**.  
(IF THE MACHINE IS ALREADY ON, TURN IT OFF BY PRESSING BUTTON **A**)
- 2 PRESS BUTTON **B** SEVEN (7) TIMES WITHIN (10) SECONDS  
FROM TURNING OFF MACHINE.
- 3 PRESS AND KEEP PRESSING BUTTON **C** FOR THREE (3) SECONDS  
UNTIL *P-00 STOP* IS ON THE DISPLAY.

PP-0	P-01	P-02	P-03
<b>P-04</b> <b>TIPO</b>	<b>P-05</b> <b>MODL</b>	<b>P-06</b> <b>O-BL</b>	<b>P-07</b> <b>O-VA</b>
TYPE OF MACHINE SET AT 2	MODEL OF MACHINE SET AT 8	OFFSET TEMPERATURE BOILER ! DO NOT CHANGE SET AT 0	OFFSET TEMPERATURE TANK ! DO NOT CHANGE SET AT 0
			
<b>P-08</b> <b>REAL</b>	<b>P-09</b> <b>FARH</b>	<b>A-00</b> <b>N-BL</b>	<b>A-01</b> <b>N-VA</b>
REAL TEMPERATURE 0= FILTERED 1= ACTUAL DEFAULT=0	TEMPERATURE UNIT 0=CELSIUS 1= FAHRENHEIT SET TO 1	MAX HEATING TIME FOR BOILER MIN 5 MIN MAX 60 MIN DEFAULT 30 MIN	MAX HEATING TIME FOR TANK MIN 1 MIN MAX 60 MIN DEFAULT 45MIN
			

A-02 CARL	A-03 VUOT
MAX FILL TIME MIN 1 MIN MAX 20 MIN DEFAULT 10 MIN	MAX DRAIN TIME MIN 1 MIN MAX 20 MIN DEFAULT 2 MIN
	

## Error Codes

ntcb E-01	Booster temperature probe faulty or not connected properly
ntcu E-02	Tank temperature probe faulty or not connected properly
FILL E-03	Water fill not completed within allocated time (10 min) Obstruction in water line, or faulty solenoid valve.
t bo E-04	Booster temperature limit setpoint reached (+14C/ 57F)
t UA E-05	Tank temperature limit setpoint reached (+14C/57F)
drA E-06	Drain problem; Drainage not completed on maximum set time. Bad drain pump, obstruction in drain line or pump.
bnot E-07	Maximum booster heating time reached (15min)
unot E-08	maximum tank heating time reached (30 min)
SErUlCE E-09	Memory error or electronic board damaged





# Level 3

Level 3 access will allow you test different components.

- 1 TURN THE MACHINE ON AND OFF BY PRESSING BUTTON **A**.  
(IF THE MACHINE IS ALREADY ON, TURN IT OFF BY PRESSING BUTTON **A**)
- 2 PRESS BUTTON **C** SEVEN (7) TIMES WITHIN (10) SECONDS  
FROM TURNING OFF MACHINE.

-PS- d--1	-PL- d--1	88:88 empty	-r r- 0143
Drain pump test door closed d--0 = door open	Wash pump test door closed		N/A

SALT OPEN	-rb- 0078	empty 88:88	-rL- 0046
N/A	Booster heater test temperature in Celsius		Wash Tank Heater test Temperature in Celsius

-EC- d--1	-ER- d--1	-Er- d--1	-Eb- d--1
P-10 door closed	P-13 door closed	P-25 door closed	Solenoid valve (chemical pumps) test door closed

# TAV. No 515 MOD. 737E

LUGLIO 2015

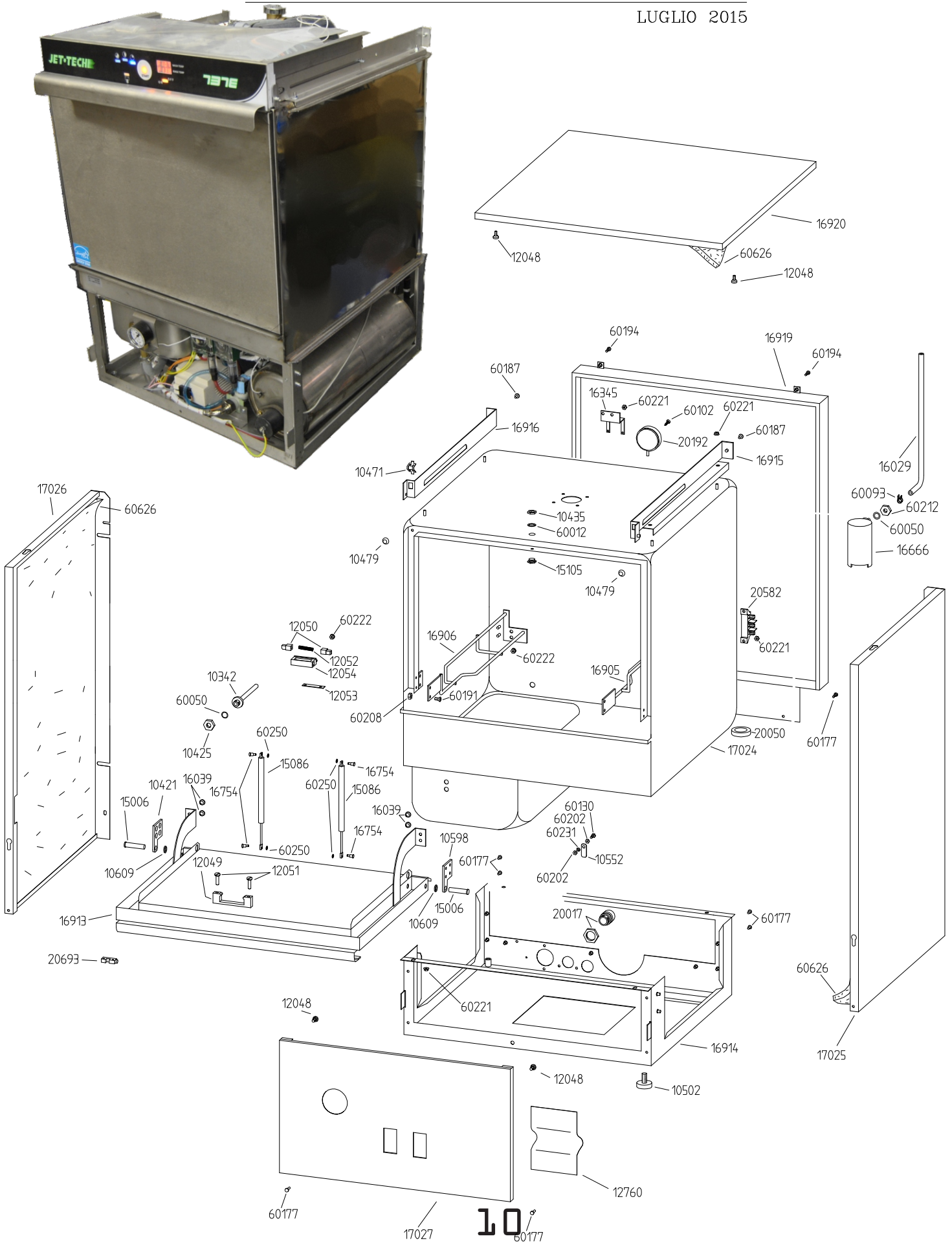

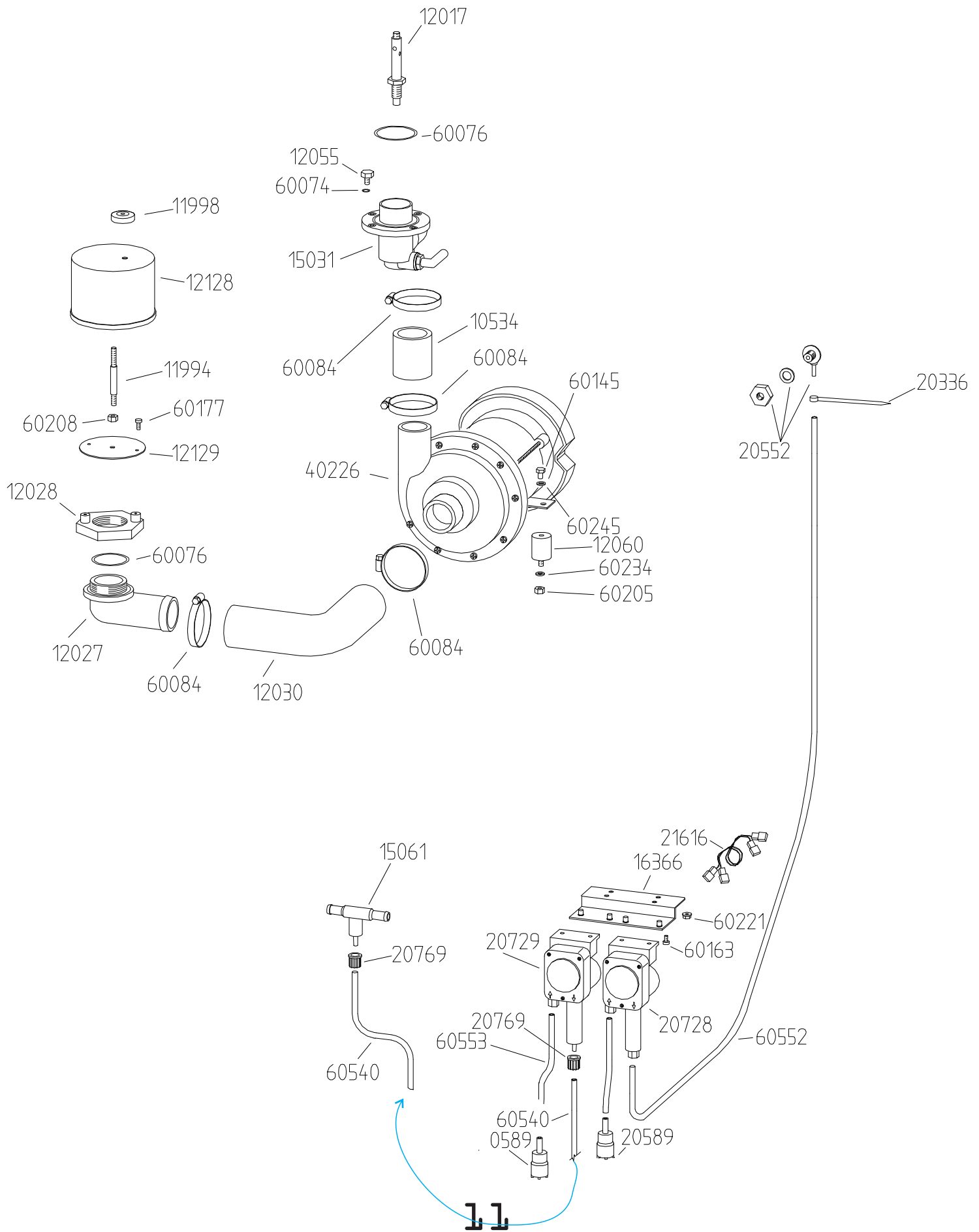

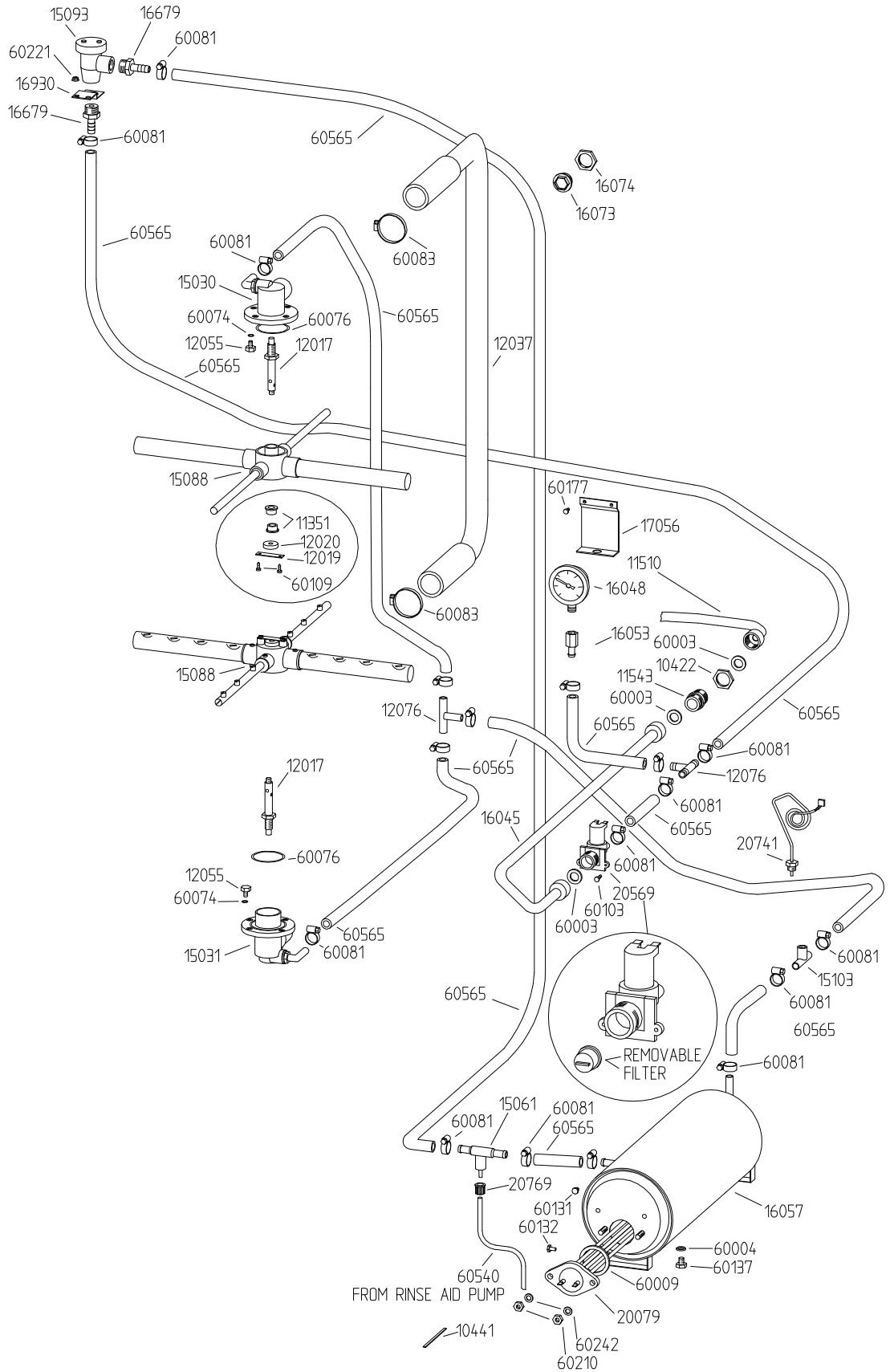

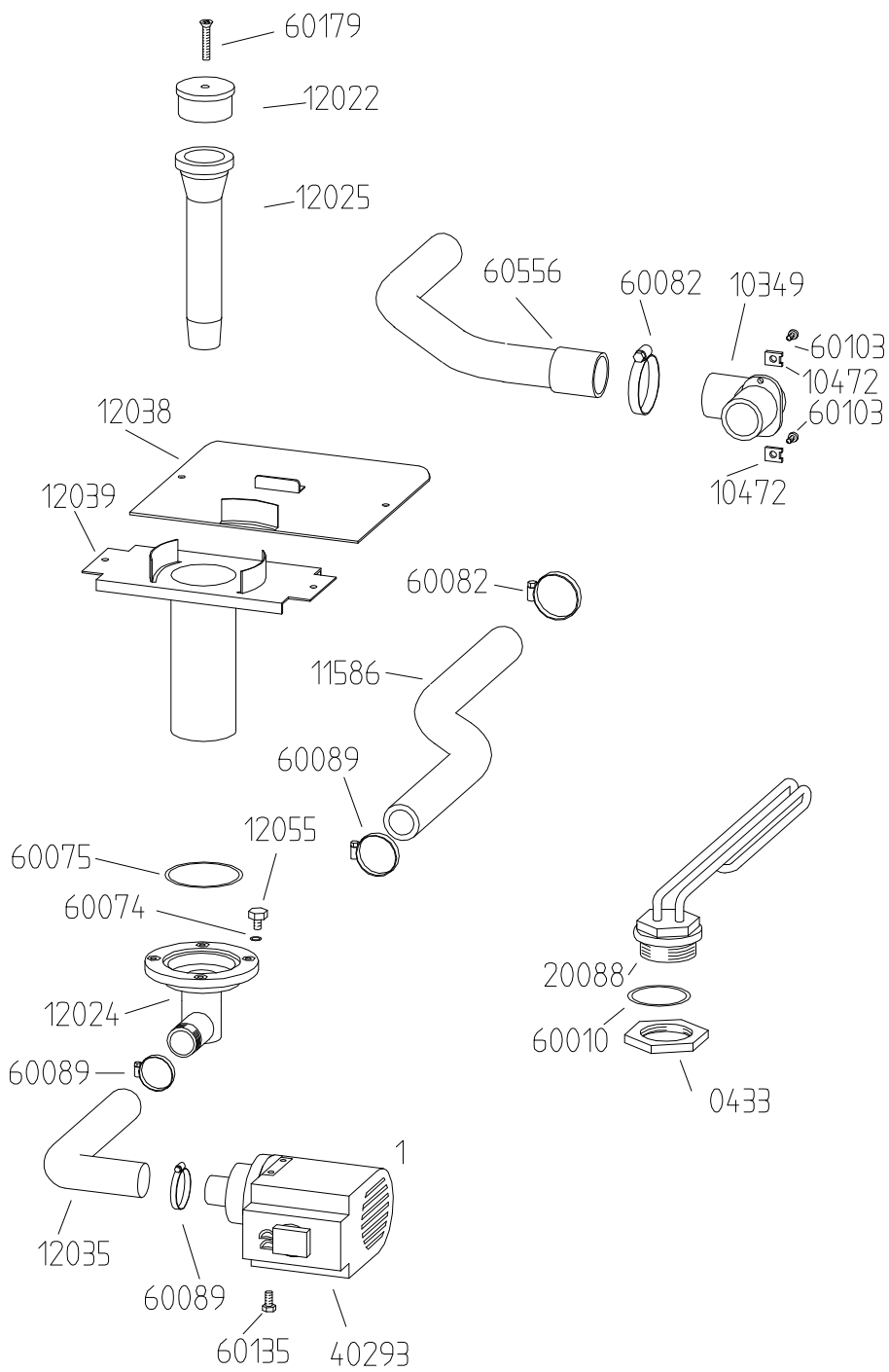

# PARTS LIST

Part Number	Description		
		15030	KIT SUPERIOR SUPPORT ARM
10342	CONNECTOR DIAMETER 6,5	15031	KIT INFERIOR SUPPORT ARM
10349	CONNECTOR	15061	CONNECTOR
10421	SMALL SQUARE	15086	GAS SPRING
10422	NUT	15088	WASH/RINSE ARM 50-1200
10425	NUT	15089	WASH/RINSE ARM
10433	NUT	15093	ANTI REFLUX DEVICE X-33
10435	NUT	15103	CONNECTOR PROBE TEMPERAT.NSF
10441	SPRING F.BULB PROBE THERMOSTAT	15105	PLUG DOOR MICROSWITCH
10471	SPRING	16029	TUBE F.PRES.SWITCH CF 50 2001
10472	SPRING	16039	BUFFER FOR FLASK EPDM
10479	BUFFER	16045	TUBE 3/4-3/4 TRAY 600X400
10493	PIVOT	16048	MANOMETER
10502	ADJUSTABLE FOOT	16053	RUBBER-CARRIER 1/4 GAS
10534	TUBE	16057	BOYLER 737 BULKHEAD NSF
10552	PLATE	16073	PLUG NYLON TFT 26X1,5
10556	FAIR LEAD	16074	NUT NYLON 3/4 BLACK RO/3-4 N
10598	SQUARE	16345	SQUARE F.PRESSURE SWITCH 2001
10609	SPACER	16366	FLASK DET.PUMP DS 400
11351	BUSH	16666	AIR TRAP STAINLESS STEEL
11510	TUBE	16679	RUBBER-CARRIER PG13 1/2-18/1"
11543	CONNECTOR	16754	PIVOT FOR GAS SPRING
11586	TUBE POMPE VIDANGE 1000-1201	16890	SQUARE MAGNET.SWITCH AT 50
11994	ROD FILTER	16905	RIGHT BASKET GUIDE AT 50
11998	NUT	16906	LEFT BASKET GUIDE AT 50
12007	SUPPORT	16913	DOOR AT 50
12008	SUPPORT	16914	BASEMENT AT 50
12017	PIVOT	16915	RIGHT GUIDE AT 50
12019	PLATE	16916	LEFT GUIDE AT 50
12020	NUT	16919	REAR PANEL AT 50
12021	CONNECTOR	16920	TOP AT 50
12022	LID WITH FILTER	16930	FLASK FOR VALVE NSF
12024	CONNECTOR	17004	PANEL TS 58 OMEGA ELECTRONICS
12025	TUBE	17024	TANK AT 50
12027	CONNECTOR	17025	RIGHT LAT.PANEL AT 50
12028	NUT	17026	LEFT LAT.PANEL AT 50
12030	TUBE	17027	PANEL JET-TECH 737 NSF
12035	TUBE	17056	FLASK MANOMETER 737 NSF
12037	TUBE	20017	FIXING CABLE ST 16
12038	FILTER	20050	FAIR LEAD WITH DIAPHRAGM DG 29
12039	FILTER	20067	RELAY 12A 230V
12048	PIVOT	20079	BOYLER HEATING ELEM.230V 4000W
12049	DOOR HOOK	20088	TANK HEATING ELEM.230V 2800W
12050	DOOR CATCH	20104	CONTACTOR 220/230V 50/60HZ
12051	BUSH	20132	TERMINAL
12052	SPRING	20133	PLATE 249-116
12053	PLATE	20134	TERMINAL 281-313
12054	DOOR CATCH BODY	20135	STAPLE
12055	SCREW	20173	CAPACITOR 16
12060	ANTI-VIBRATION	20192	PRESSURE SWITCH
12074	HUB	20332	SPIRAL
12076	MANIFOLD	20336	CLIP
12128	FILTER	20337	CLIP NYLON
12129	DISK	20532	TERMINAL BLOCK CF 50 400V
12760	TRANSPARENT FILM 110X150	20552	CONNECTOR AUT.D.DOS.(5X7)
12957	FILM 737 E JET-TECH	20569	SOLENOID VALVE 1A 240V 60HZ UL
15006	PIVOT	20582	TERMINAL FV110

20589	FILTER FOR AUT.DET.DOSE 5X7	60200	NUT
20692	MAGNETIC SWITCH E5121VDA0196	60201	NUT
20693	MAGNET M302NCBCNC42	60202	NUT
20707	SUPPORT FOR ELECTRONIC CARD	60208	NUT
20713	ELECTRONIC CARD POWER	60210	NUT 8VA
20714	ELECTR.CARD CONTROL AND VIEW	60212	NUT
20715	PROBE TEMPERATURE 2 MT ELECTR.	60215	NUT
20716	CONNECT.CABLE EL.CARD 7+7 40CM	60221	NUT DIN6923 5VA
20718	MYLARD PROTECTION THICKN.0,10	60222	NUT DIN6923 5VA INOX
20728	AUTOMATIC DET.DOSE GN202 NSF	60231	WASHER
20729	AUTOMATIC DET.DOSE GN82B NSF	60234	WASHER
20732	SAFETY THERMOSTAT 124° WYF 2MT	60242	WASHER
20741	PROBE NTC 1/4 2MT CONNECTOR	60244	WASHER
20769	NUT SEKO F.6MM 0000061001	60250	RING
20779	SHRINK TUBING D.6,4	60410	PLASTIC NUT MB
20780	FILTER UL	60420	SPACER NYLON 7X4X6
21616	U BOLT AUT.PERIST.DOSE JET-T.	60540	HOSE POLYAMIDE 5X7 MM
21700	LOOM 737 E NSF	60552	RED HOSE 5X7 X-32/X-33
30049	DISH BASKET 50X50	60553	BLUE HOSE 5X7 X-32/X-33
30105	UNIVERSAL BASKET 50X50	60556	TUBE FOR DRAIN PUMP
40226	MOTOR PUMP	60565	HOSE
40293	DRAIN PUMP 60HZ	60596	BAG
60003	GASKET	60626	PANEL
60004	WASHER TEFLON 15X10X3	60655	PACKAGE F 18/737 JET-TECH
60007	WASHER TEFLON 15X10X9	60657	PEDESTAL F 18/737 JET-TECH
60009	GASKET 52X42X6	60659	EXPANDED 85X10X10X3
60010	ORING	60675	EXPANDED 87X42X3 K20
60012	GASKET		
60050	ORING		
60074	ORING		
60075	ORING		
60076	ORING		
60081	CLIP		
60082	CLIP		
60083	CLIP		
60084	CLIP		
60089	CLIP		
60093	CLAMP		
60102	SCREW		
60103	SCREW		
60109	SCREW		
60124	SCREW 3MAX30		
60130	SCREW		
60131	SCREW 5MAX10		
60132	SCREW		
60135	SCREW		
60137	SCREW		
60145	SCREW 6MA X 8		
60163	SCREW		
60166	SCREW		
60177	SCREW 4MAX10		
60179	SCREW		
60187	SCREW 4MAX10		
60191	SCREW 6MAX12		
60194	SCREW 4MAX30		

## MANUFACTURERS LIMITED WARRANTY

Jet Tech Systems Corporation (Jet Tech) hereby warrants all new warewashers bearing the name JET TECH and installed within the continental United States of America or Canada to be free from defects in material or workmanship, under normal and regular usage and operation, for a period of one (1) year following the date of original installation, (unless specified otherwise) but in no event can exceed eighteen (18) months from the date of shipment from the factory.

If a defect in material(s) or workmanship is detected; or found to exist within the stated period above, Jet Tech, at its sole discretion, shall either repair or replace any original equipment manufacturers part which has proven to fail within the machine; providing that the equipment has not been altered or tampered with in any manner, has been installed correctly as per the owners manual, and maintained and operated in complete accordance with this manual.

The labor cost to repair or replace any part proven to be defective, as per above clause(s), shall be covered by Jet Tech Systems, within the continental United States of America or Canada; provided that: prior authorization for this labor was approved by Jet-Tech Systems, the service work was performed by an authorized Jet Tech service agency; and that this agency installed an original and genuine Jet Tech part in the machine. Any repair work performed by a non-authorized service depot remains the sole responsibility of the user, and Jet Tech Systems will not be held responsible. The installation of any generic part will not be valid; and therefore voids this warranty. All authorized labor coverage shall be limited to regular hourly rates only. Any supplemental hourly rates or charges, such as weekends or emergency premiums remain the responsibility of the user.

Jet Tech Systems Corp. (Jet Tech) hereby states that: warranty travel time shall be limited to, and without exception, a round-trip total of two (2) hours OR mileage up to a maximum of one hundred (100) miles round-trip. Any charges exceeding those stated herein must have prior authorization by the factory.

Exceptions to above warranty are: (A) Damages resulting from shipping, handling or abuse. (B) Incorrect installation and/or connections. (C) Adjustments or calibration of any parts. (D) Faults due to lack of regular maintenance or cleaning of any internal part(s). (E) Replacement of any wearable items such as: glasswasher curtains, or peristaltic squeeze tubing or gaskets. (F) Excessive lime, mineral, alkali or hard water conditions and (G) Poor results due to: use of an incorrect type of detergent (for non-commercial type applications), and excessive or inadequate water temperature(s) or pressure conditions.

JET TECH SYSTEMS CORPORATION STATES THAT THERE ARE NO OTHER WARRANTIES, EXPRESSED OR IMPLIED, THAT ARE NOT SET FORTH HEREIN, JET TECH SYSTEMS CORPORATION SHALL ASSUME NO OTHER RESPONSIBILITY, EITHER DIRECT OR NON-DIRECT, OR BE LIABLE FOR ANY OTHER OR ADDITIONAL LOSS OR DAMAGE WHETHER BEING DIRECT OR CONSEQUENTIAL, AS A RESULT OF ITS EQUIPMENT.



## SERVICE CALL REGULATIONS

JET TECH ware washers are warranted as specified in the MANUFACTURERS LIMITED WARRANTY.

Upon receiving the demand for repairs on a unit, we will create a work order or Warranty Authorization which will have all the pertinent information. We will send this form to you as a purchase order for service. We ask that you respect the times allocated on the form. Should more time is required to complete a service call, call us and ask for more time. Without proper authorization, your claim for payment will be delayed.

We will pay for:

1. Labor to replace a defective part, as per the attached Allocated Times Schedule.
2. Travel time, as specified in the MANUFACTURERS LIMITED WARRANTY.
3. JET TECH original replacement parts supplied from service company inventory

We will NOT pay for:

- Unauthorized labor charges.
- Unauthorized travel charges.
- Waiting time. Call for an appointment, if required.
- More than one man on a service call.
- Travel time exceeding the MANUFACTURERS LIMITED WARRANTY.
- More than one service call for the same problem.
- Adjustment or calibrations, as specified in the MANUFACTURERS LIMITED WARRANTY.
- Replacement of small items (pilot light, screens, jets).
- Cleaning or regular maintenance.
- Overtime or weekends charges (time and a half, or more)
- Problems due to improper installation.
- Problems due inadequate or improper use of the equipment.
- Problems due to improper water supply temperature or inadequate/excessive water pressure.
- Problems due to inadequate/excessive electric supply.
- Disconnecting of hard plumbing or removal of counter tops, etc.

We are here to help you with diagnostic or service problems.

Call us toll free at 1-888-275-4538, extension 611 for assistance. After office hours assistance is also available by dialing the extension 411 or \*411. Our email is [service@mvpgroupcorp.com](mailto:service@mvpgroupcorp.com). All paperwork related to warranty work can be sent by email to [warranty@mvpgroupcorp.com](mailto:warranty@mvpgroupcorp.com). Other contact information is available at [www.mvpgroupcorp.com](http://www.mvpgroupcorp.com).

Our standard procedure is to invoice all parts shipped at \$0 for WARRANTY REPAIRS regardless what the amount shows on the work order. All defective parts should be kept for 90 days. After this period, the parts can be discarded.

YOUR INVOICE MUST INCLUDE THE FOLLOWING INFORMATION:

1. Warranty Repair Authorization Number.
2. Model and serial numbers.
3. Problem reported.
4. Detailed description all charges including dates, hours worked and work done.
5. Reason for part failure.
6. Indicate the general state of the equipment, cleanliness and if abuse is apparent.

We expect that your work is warranted by your company for at least 90 days.



COVER PAGE  
2 CONTACT  
3 TOP OF DISHWASHER  
4 ELECTRONICS  
5 PROGRAMMING  
6 PROGRAMMING (CONT)  
7 PROGRAMMING (CONT)  
8 PROGRAMMING (CONT)  
8 ERROR CODES  
9 LEVEL 3, TESTING  
10 EXPLODED VIEW  
11 EXPLODED VIEW (CONT)  
12 EXPLODED VIEW (CONT)  
13 EXPLODED VIEW (CONT)  
14 PARTS LIST  
15 PARTS LIST (CONT)  
16 WARRANTY  
17 WARRANTY REGULATION  
18 LAST PAGE



5659 ROYALMOUNT  
MONTREAL QUEBEC  
CANADA H4P 2P9  
514 737 9701 888-275-4538  
514 342 3854  
WWW.MVPGROUPCORP.COM