



Wireless Electric Breast Pump



Instructions
for use

TABLE OF CONTENTS

Congratulations	2
Contents	3
Preparing The Parts & Cleaning	4
Product Assembly	5
Display Information	6
Pump Operation	7
Instructions For Use	8
Troubleshooting	9
Important Safety Information & Warnings	10
Technical Information	11

1

CONGRATULATIONS

Our **Wireless Electric Breast Pump** is a must-have for any mum embarking on their breastfeeding journey. This super stylish breast pump is great for expressing your milk, in any sit-down setting. Thanks to the compact, wireless design, you can simply charge and go. Featuring 3 expression settings, this nifty pump will have your liquid gold flowing in no time! We know that no boob is the same, so we've included two different-sized nipple inserts for the soft silicone cushion so you can select the one that fits your breast best – After all, comfort is key! The wireless design means cleaning is super easy; Simply dismantle the pump parts, wash with warm soapy water, and pop in the steriliser. Expressing couldn't be simpler.

Key Features

- Comfortable, soft silicone horn simulates baby's natural feeding patterns.
- Compact design that's easy to clean and assemble.
- Built-in rechargeable battery enables on-the-go expression.
- 2-phase operation with stimulation and expression suction patterns.
- 3 modes: stimulation, expression, and combined stimulation & expression.
- Vacuum strength control for all three modes, with 9 levels in each mode.
- Advanced touch-screen technology.
- Closed system prevents backflow.

2

CONTENTS

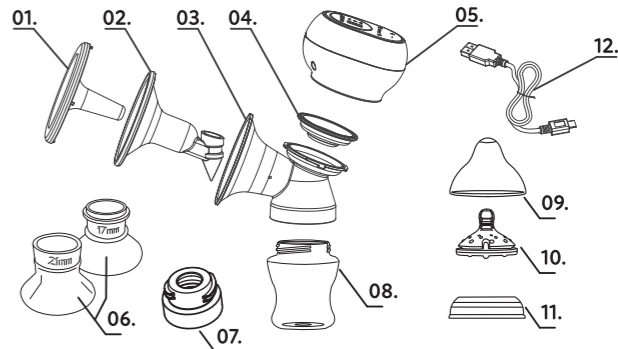

01. Protective Dust Cover
02. Silicone Breast Cushion
03. Breast Shield Body
04. Diaphragm
05. Pump Unit
06. 17mm & 21 mm Silicone Breast Shield Inserts

07. Bottle Adapter
08. Nuby™ Bottle
09. Bottle Lid
10. Slow Flow Feeding Teat
11. Bottle Screw Ring
12. USB Cable

3

PREPARING THE PARTS & CLEANING

Cleaning:

- DO NOT sterilise the pump unit.
- Before each use, sterilise all parts that have direct contact with breastmilk. This includes the following: Silicone breast cushion, protective dust cover, bottle parts, bottle adapter, breast shield body, diaphragm.
- Please ensure all parts are completely dry before assembly and use.
- DO NOT allow pump motor to come into contact with water.
- Wash your hands thoroughly with soap and water before handling the breast pump and attachments.
- DO NOT use solvents or abrasives.
- Suitable for steam sterilisation, cold water sterilisation, and UV sterilisation.
- DO NOT accelerate the drying process by the use of heat.
- Wipe pump unit with a damp cloth or baby wipe to clean.

4

PRODUCT ASSEMBLY

1. Assembling the breast pump.

Insert the silicone breast cushion into the breast shield body, ensuring the silicone has sealed around the plastic horn. To protect the silicone breast cushion, insert the dust cover. The dust cover must be removed before starting a pumping session.

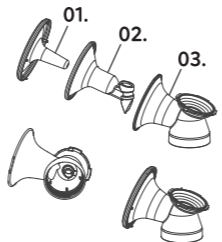

2. Attaching the bottle.

Screw the adapter onto the breast shield body. Screw the bottle to the adapter ring.



NOTE: Ensure silicone breast cushion is connected securely to plastic attachment connected to the motor unit.

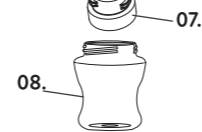

3. Attaching the pump unit.

Ensure diaphragm is inserted into the top of the breast shield body correctly. Screw the pump unit clockwise until it is fully secured to the breast shield body.

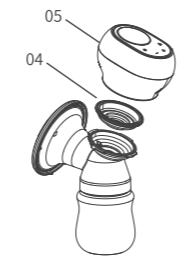

5

DISPLAY INFORMATION

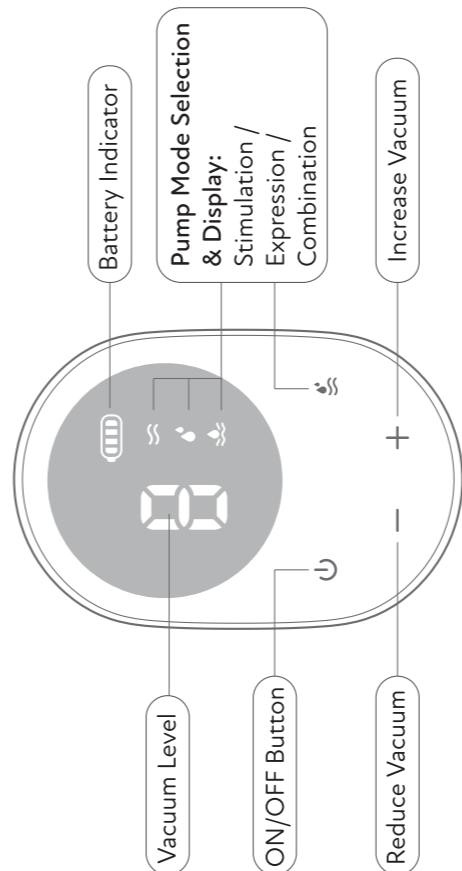

6

PUMP OPERATION

1. The LED screen has a battery indicator to show remaining charge. The battery can work for up to 2 hours on a full charge. When the battery is too low, the battery indicator (🔋) will flash. After 10 seconds, the machine will automatically turn off. Please fully charge the battery before first use and when it is low.
2. Press and hold (⏻) to turn on. The default setting is stimulation mode (🌀). On first use, this will be set to level 1 vacuum strength. On subsequent uses, the level will be set to the last selected vacuum strength. There are 9 vacuum levels to choose from, with level 9 being the strongest. Always start with the lowest vacuum level, increasing strength carefully and to your preference.
3. Pressing (🌀) will select the expression mode (👤). There are 9 vacuum levels to choose from in this mode.
4. Pressing (👤) again will switch to the combination mode (🌀👤). This mode alternates between stimulation pumping for 5 cycles and expression pumping for 5 cycles. This mode alternates between performing 5 cycles in stimulation mode and 5 cycles in expression mode.
5. To pause the pumping session, short press (⏻). To restart the pumping session, simply short press (⏻) again. If the pause time exceeds 5 minutes, the machine will automatically enter standby mode.
6. To turn the motor unit off, press and hold (⏻).

7

INSTRUCTIONS FOR USE

- Please take care to set a low vacuum strength before placing on your breast, slowly increasing vacuum strength to suit your expression needs while maintaining comfort.
- Before using the pump, measure your nipple size using the included chart. A good fit is important for the pump to work effectively. The silicone shield has a diameter of 25mm, but if this is not the best fit you can use the 17mm or 21mm silicone inserts included in the box.
- Place your breast into the silicone shield, ensuring your nipple is placed in the centre. Stimulation mode is recommended for the beginning of the pumping session. This mode works by mimicking the sucking pattern of a breastfeeding infant, which triggers milk flow.
- Once milk flow begins, you can switch to the expression mode. This mode works by mimicking an infants' stronger suck when beginning to feed.
- The combination mode cycles between the above two modes. This mode is helpful if milk flow begins to slow during the expression phase and another let-down phase is required.

8

TROUBLESHOOTING

Low or No Suction

- Check all parts are dry and have been assembled correctly.
- Check the silicone cushion is attached securely to the pump unit.
- Ensure the silicone cushion forms a complete seal around the breast.

Pump Won't Switch On

- Check that the battery has been charged.
- Make sure to press and hold the power button.

Weak Vacuum or No Vacuum

- Ensure the inner silicone part dispensing milk into the bottle is correctly attached to the plastic tube leading to the motor unit.
- All parts must be completely dry before use.
- Frequent use or improper sterilisation can cause the silicone to degrade. If the silicone breast shield is showing signs of wear or damage then replace immediately.
- Ensure the silicone breast shield is fitted correctly with the edges overlapping the plastic horn.
- Ensure the silicone diaphragm is properly placed between plastic body and the motor unit.
- Check to make sure complete seal is made between breast and silicone breast shield for best performance.

9

IMPORTANT SAFETY INFORMATION

Failure to follow these instructions/safety information can lead to danger from the device.

- Unplug the AC adapter from the wall socket outlet when the pump is not in use.
- Do not leave the Nuby™ Wireless Electric Breast Pump unattended when plugged into a power source.
- Keep the device dry and do not immerse in water.
- Do not reach for an electrical device if it has fallen into water. Unplug immediately.
- Repairs must be conducted by authorised service agencies.

WARNINGS

- The rechargeable battery is built-in. DO NOT remove the battery.
- Do not use any adapters or batteries that don't come with the pump.
- Turn the product off when product is not in use and charge the battery once a month or when necessary.
- Do not charge battery for longer than 6 hours.
- Always unplug the power adapter from the breast pump after each use and when cleaning the breast pump.
- This is a single user product. Use by more than one person may present a health risk.
- Do not leave in the vicinity of unsupervised children.
- Use only for its intended use as described in this manual.
- Do not use when sleeping or overly tired.
- Do not use the unit if damaged.
- Do not place near any appliances that generate a strong magnetic field.
- Do not place in direct sunlight.

10

TECHNICAL INFORMATION

Power Adapter Input: 100-240V ~ 50/60Hz
Power Output: 5V 2A
Power Rating: 10W
Lithium Battery: 3.7V 1500mAh
Timer: 30mins
Stimulation Speed: 95-105T/min
Expression Speed: 21-65T/min
Stimulation Vacuum (9 levels): -0.002~-0.019Mpa
Expression Vacuum (9 levels): -0.013~-0.036Mpa
Overall Noise: <52dB
Operating Conditions: 5-40 °C, RH ≤90%
Electric Shock Protection: AC Adapter Class II, Host Machine Class III



Form CWY_UK
89165

Nuby UK LLP
13 Burford Way
Baldon Business Park
Baldon Colliery
Newcastle upon Tyne
NE35 9PZ
Freephone number: 0800 334 5844
enquiries@nuby-uk.com
www.nuby-uk.com
www.nuby.com



EC REP
DC PHARM
Calle Filadelfos,
S/N - NAVE 3
Olesa de Montserrat,
08640 Barcelona, SPAIN

© 2022 Luv n' care
Nuby TM and Nuby logo licensed to
Luv n' care by Admar International