

USER MANUAL

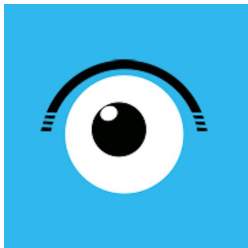

HDlivecam

This manual describes how to use this WIFI camera and install the supplied software. Be sure that you have read and understood its contents before using the camera.

To get started, you need:

1. A wireless network (only support 2.4G)
***Use numbers and letters in creating network name and password.**
2. A smart device, such as an Android Smart Phone or Tablet (Android version 6.0 or latest) or an iPhone, iPad, or iPod Touch (IOS version 8.0 or latest).

APP Download:

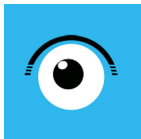

HDlivecam



QR Code

Download the App “HDlivecam Pro” from Google Play Store (for Android) or Apple Store (for iOS). Or scan the QR code to download the APP.

Quick Start Guide

①

Power on Camera

②

**Connect to AP
mode**

③

**Change AP mode
to IP mode**

④

Live Videos

***AP mode for point to point , the camera can not be view remotely . the phone need to be close to the camera to be able to view the live videos. **

Step ① Power on the camera

*****Camera configured****

Before setting, connecting the device with power supply and turn it on.

Step ② Connect to AP mode

Open the “HDlivecam” App , Sign Up(Register a new account) if it is your first time to use this APP . Then Sign in(Login in).

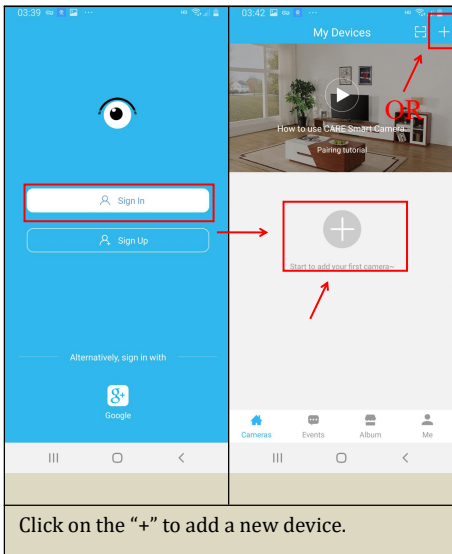

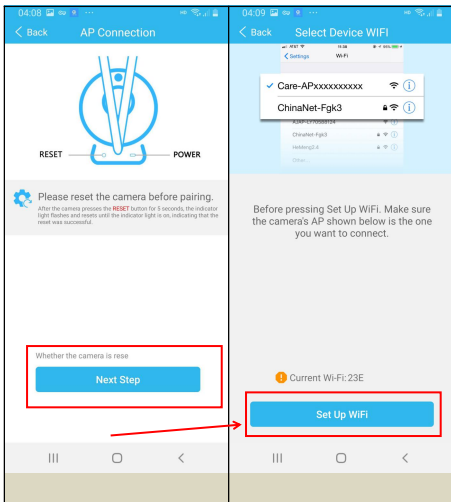

Click “Next Step” and then click “Setup WI-FI” will enter into your phone “WI-FI Setting”. Connect the network same as camera’s UID(which is unique to each unit)

***If there is no hotspot WIFI please reset the camera and wait the camera reboot**

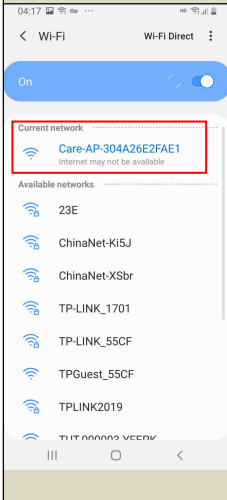
	<p>Android system</p> <p>Internet may not be available Connect to another network or turn on Switch to mobile data.</p> <p>Switch to mobile data Another network</p> <p><u>***If your Android system phone show you that "the current WLAN network cannot access the internet, Switch to another network ?" Just ignore it.**</u></p>
---	--

Back to HDlivecam APP after connection is successful.

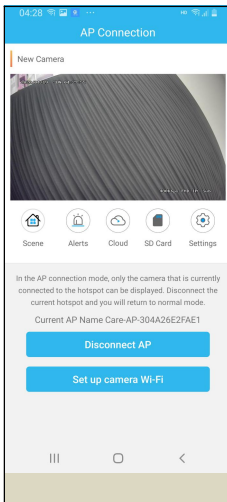

Now you are in AP mode .

***AP mode for point to point , the camera can not be view remotely . the phone need to be close to the camera to be able to view the live videos. **

Step ③ Change AP to IP mode

Click the “ Set up camera WI-Fi ” to connect the camera to IP Mode

04:28

AP Connection

New Camera



Scene

Alerts

Cloud

SD Card

Settings

In the AP connection mode, only the camera that is currently connected to the hotspot can be displayed. Disconnect the current hotspot and you will return to normal mode.

Current AP Name Care-AP-304A26E2FAE1

Disconnect AP

Set up camera Wi-Fi

1 Set up WI-FI

04:28

Cancel Choose a Network

Please select the WIFI to connect for your IP camera

TUT-000003-YFEPK

23E

TP-LINK_1701

ChinaNet-XSbr

TPGuest_55CF

23E_ext

TP-LINK_55CF

ChinaNet-Ki5J

Xiaomi_呆呆

ChinaNet-5124

ChinaNet-JMTJ

TP-LINK_55CF-kz

2 Select WI-FI

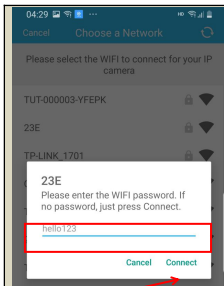

3 Enter Password

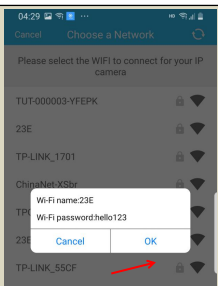

4 Confirm PWD

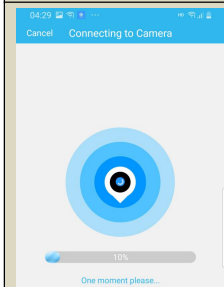

5 Waiting Setting

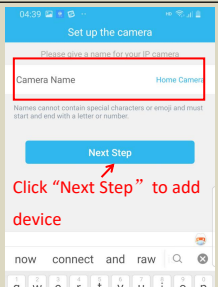





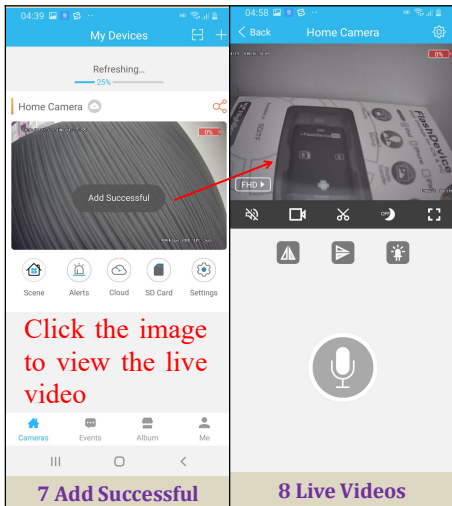

















6 Enter a name

Step ④ Live Videos

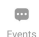

Icon Details:

	scan + device		Me
	+ device		speaker
	share device		video record
	scene switch		Snapshot
	alarm events		night vision
	cloud storage		full screen
	SD card storage		left/right
	setting menu		upside/down
 Cameras	device lists		indicator light ON/OFF
 Events	Alarm events		voice intercom
 Album	Images/videos		resolution rate

FREQUENTLY ASKED QUESTIONS

[What Micro SD Card is required for recording?](#) The camera supports up to 128 GB Micro SD card. Please use High Speed Class 10 FAT formatted memory card. You must format the Micro SD before using.

[Why can't the camera go online?](#)

1. Powerless; 2. Check if your router is working properly or not; 3. Weak Wi-Fi signal; 4. Wrong password wrong while Wi-Fi setting

[Why is remote monitoring not smooth?](#) You should choose a suitable resolution to watch according to your internet speed.

[How could i save in SD card?](#) Open the setting menu to set the SD card video recording.

[Why i can't save to my SD card?](#) SD Card must be formatted if this is your first time to use it .

[How do I when I forgot my password?](#) Press reset key for 10 seconds and restore the factory setting.

Disclaimer:

Our company would not be responsible to any consequences cause by improper use, please use it in appoint environment and comply with the relevant laws and regulations!