

7B-000-007

Island Straight Stone Platform

Read Before Building

This is a very complex kit, we strongly recommend taking your time building it. It is also very important to keep a clean work area as the card is permeable and can stain very easily.

We recommend using a standard PVA glue slightly diluted with water. We do not recommend any fast drying glues, as they can dry too quickly, making any small position adjustments difficult. It's best to apply the glue using a small paintbrush or cardboard offcut.

Parts cannot be bought individually. Spare or replacement frets can be bought £10 each for large frets and £7 each for small frets by contacting sales@dapol.co.uk

Instructions are available online in pdf form if you need a closer look.

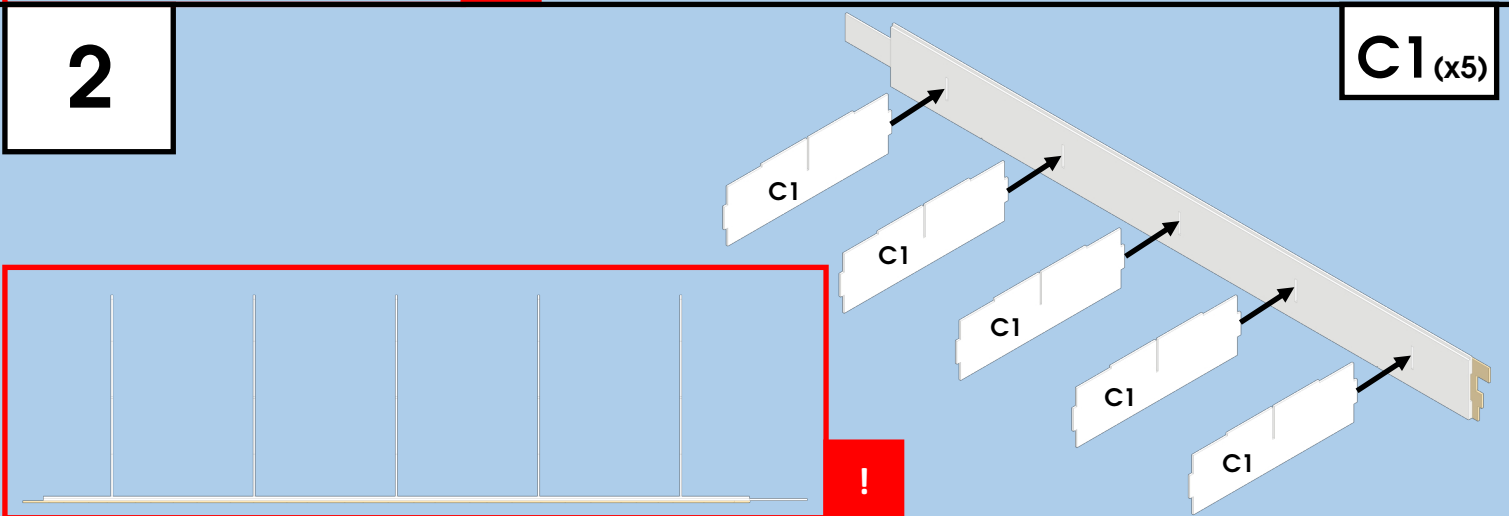
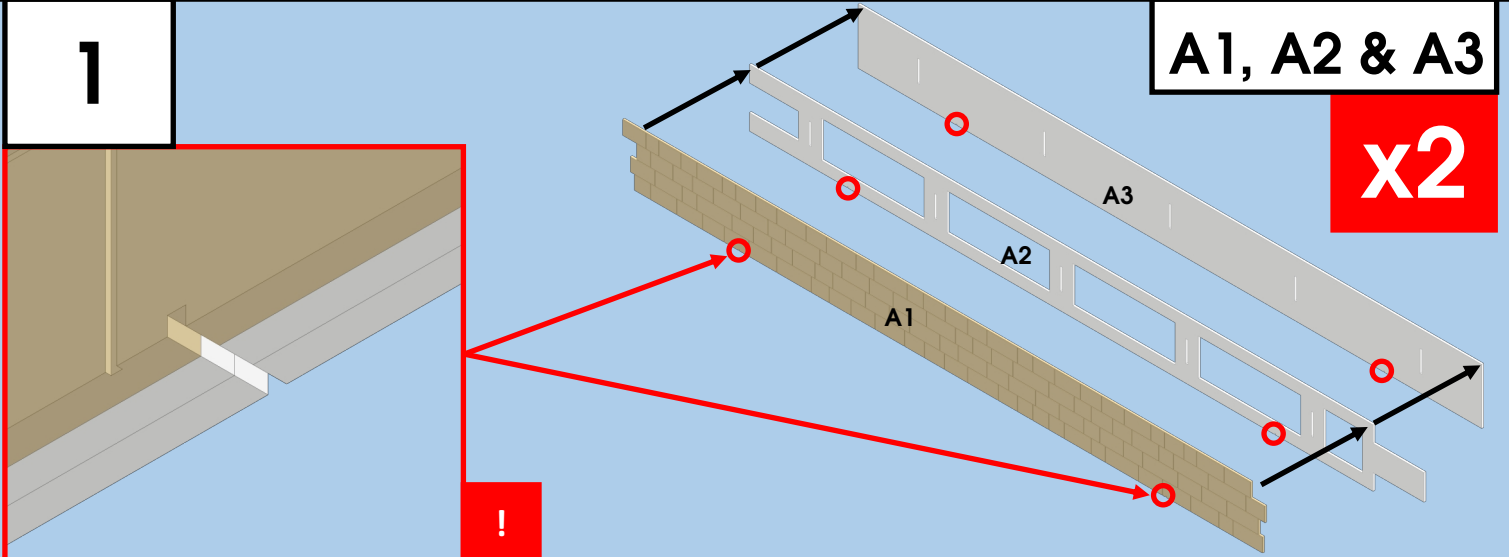

3

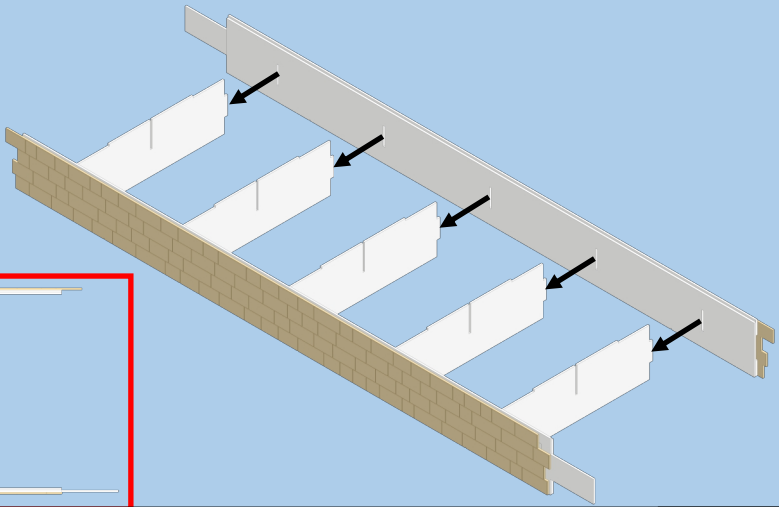

!

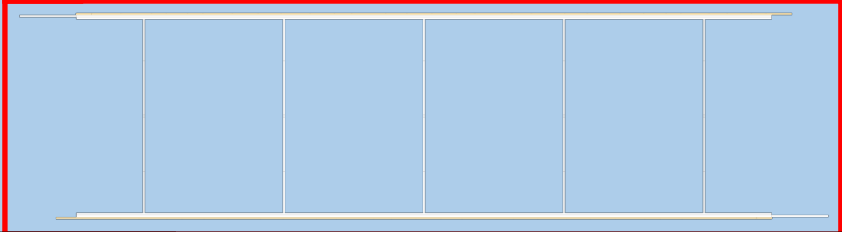

4

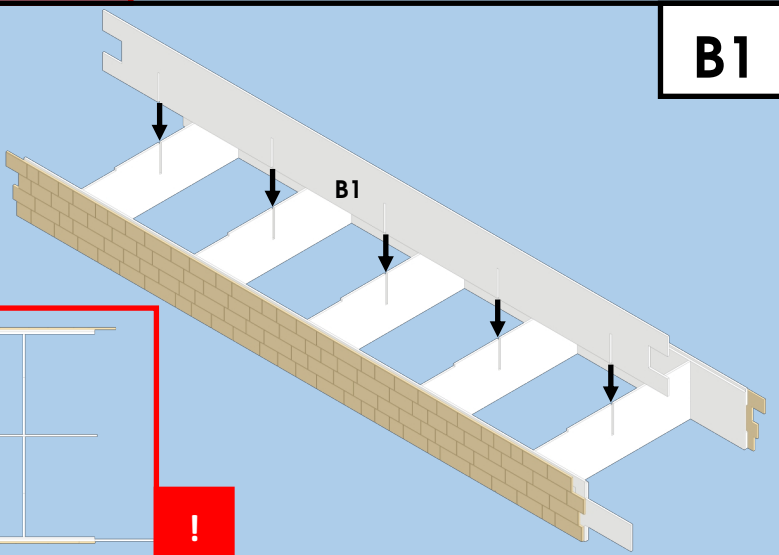

B1

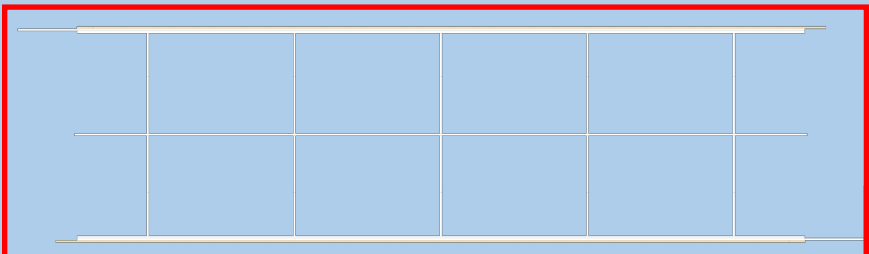

!

5

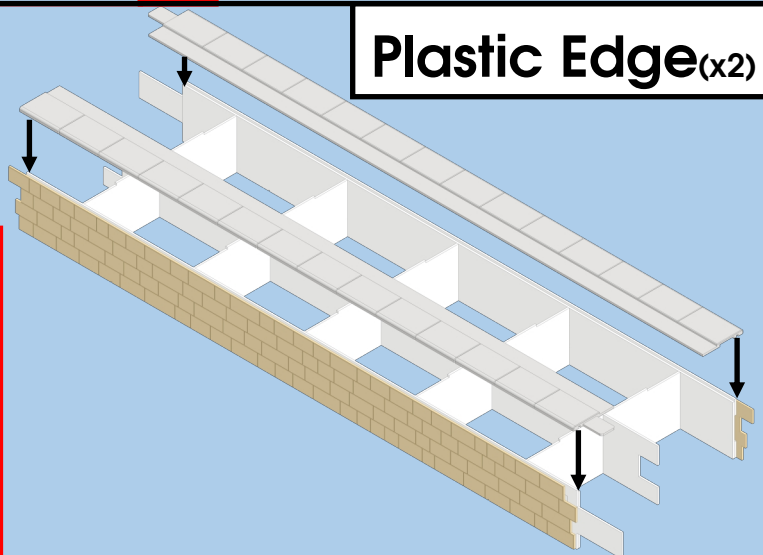

Plastic Edge (x2)

!

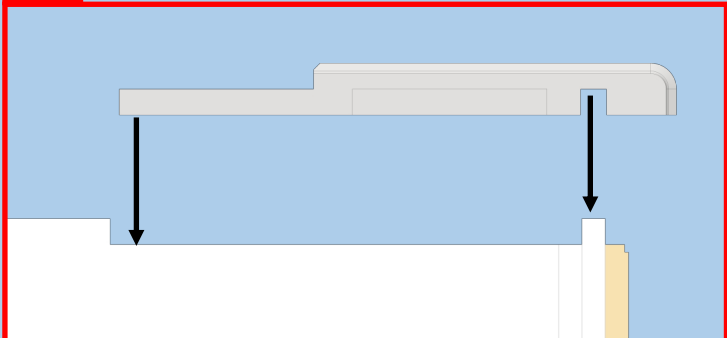

6

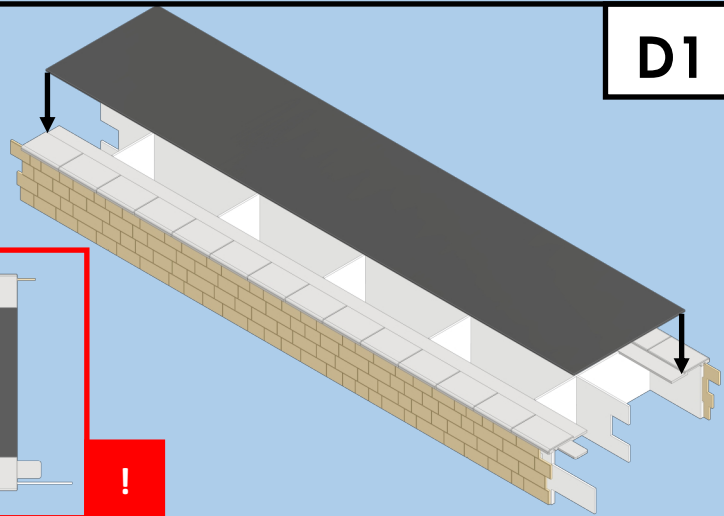

D1

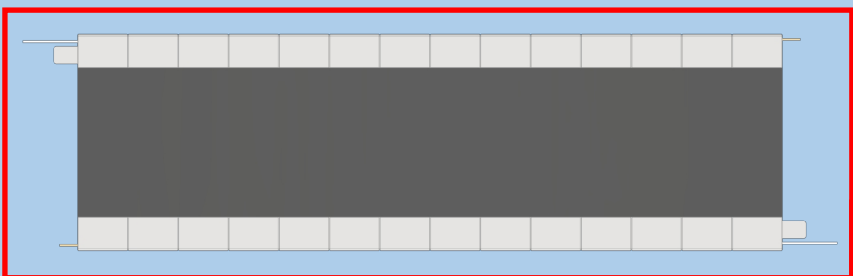

!