

dapol 00/H0 TRACKSIDE MODEL C061: CITY OF TRURO

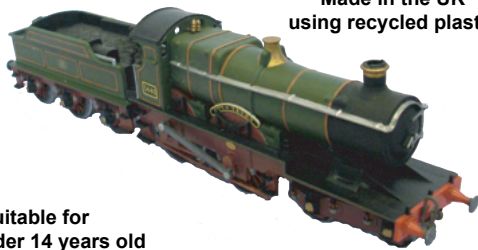

Made in the UK
using recycled plastic



Not suitable for
children under 14 years old

Please Note - The tools used to produce this model were made over 50 years ago. Over the period, changes have been made and it may be that reference numbers moulded into the plastic parts do not match the numbers used in these instructions. Therefore we advise you to FOLLOW the exploded diagram and instructions.

ASSEMBLY INSTRUCTIONS:

It is recommended that the instructions and exploded view are studied and that the assembly is practiced before cementing together. Certain parts may need to be trimmed and may best be painted before cementing.

WARRANTY:

Parts can get bent during transit or by prolonged storage. However misshapen parts can be straightened by placing them in hot water to soften the plastic and then carefully manipulating them back into shape by finger pressure. Please be careful that the water does not cause harm to skin or fingers. In the event of parts being broken or missing, then you **MUST** return to the place of purchase (the seller). The seller will replace your kit and return the original kit to Dapol under their agreed contractual terms. Do **NOT** return to Dapol. Finally please note that Dapol does not keep individual parts for any kit.

APPLYING TRANSFERS:

First, cut the sheet into the six separate subjects. Dip each into warm water for a few minutes and then carefully slide off the backing sheet. Using either a small artist brush or point of craft knife, carefully remove the loose transfers from the water and apply to the painted model. Allow transfers to settle into position under their own weight and then, carefully apply pressure to face to transfer with smooth cloth to remove any excess water and air. Allow at least 6 hours for the transfer to thoroughly dry and full adhesion to occur.

PAINTING INSTRUCTIONS:

Please refer to photograph of model on left.

Mainframe Assembly

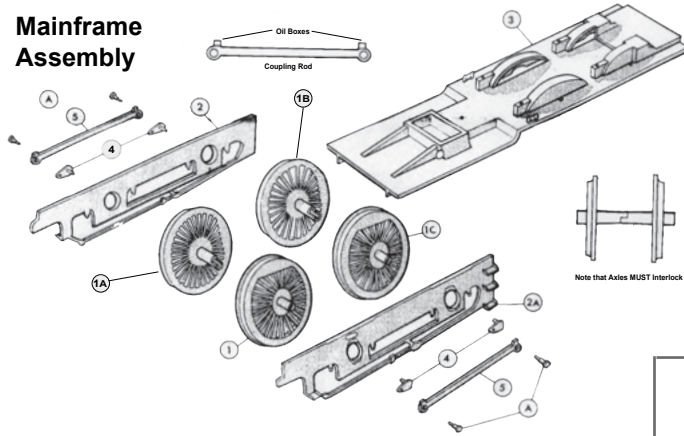

1. Cement leading driving wheels (1 - 1A) together. Note that the shaped axles interlock; check that the wheels run true.
2. Repeat procedure with rear driving wheels (1B - 1C).
3. Push stub axles of driving wheels through axles holes in mainframes (2 - 2A). **DO NOT CEMENT.**
4. Apply cement to entire top and front edges of mainframes and locate mainframe and wheel assembly beneath underside of footplate (3).
5. Apply cement to "D" shaped holes in ends of protruding axles and press the two fly cranks (4) into place.
6. Carefully place a drop of cement into holes of fly cranks.
7. Place coupling rod (5) over cemented hole in fly crank with the oil boxes on top. Insert pin (A) through holes in coupling rods and press into holes in fly cranks. Keep cement clear of coupling rods. Repeat instructions 5, 6 and 7 for opposite side.

Boiler Assembly etc.

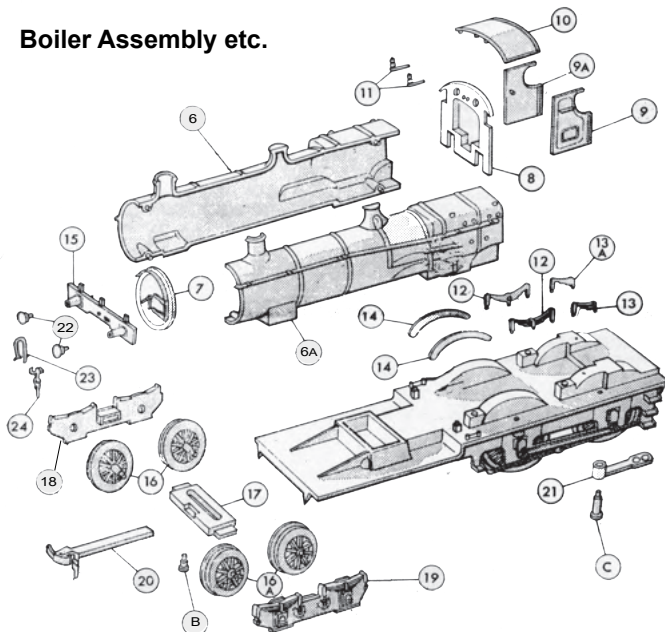

8. Apply cement to edges of one of the combined firebox halves (6) and locate and cement to other boiler half (6A).
9. Locate and cement boiler front (7) into position on front of boiler.
10. Locate and cement boiler to footplate.
11. Apply cement to rear edges of firebox and to bottom edges of cab front (8) then position cab front onto footplate and rear of firebox.
12. Locate and cement cab sides (9 - 9A) to cab front and footplate.
13. Locate and cement cab roof (10) to cab front and sides.
14. Locate and cement whistles (11) into locating holes on top of firebox.
15. Cement locating pins on springs (12) and half-springs (13 - 13a) into locating holes on either side of footplate.
16. Apply cement to bottom edge of nameplates (14) and fit onto front driving wheel splashes.
17. Locate and cement front buffer beam (15) to front edge of footplate.
18. Apply cement to bogie wheel pin half (16) and press corresponding bogie wheel socket half (16A) into position. Check that wheels run true.
19. Locate and cement tongue on side of bogie stretcher (17) into slot in bogie side frame (18). **NOTE:** Top face of bogie stretcher is marked TOP & the locating recess is to front.
20. Insert stub axles of bogie wheels (**DO NOT CEMENT**) into axle holes on inner face of bogie side frame.

21. Cement tongue on other side of bogie stretcher into locating slot in remaining bogie side frame (19) and at same time locating **BUT DO NOT CEMENT**, ends of stub axles into axle holes on inner face of bogie side frame.

22. If working coupling is required, cement buckeye coupling (20) into recess in front of bogie stretcher; if working buckeye is not required then omit this part of the process.
23. Mount bogie assembly to locomotive by means of pivot pin (B). Place a drop of cement into pivot pin housing beneath front of footplate then push pivot pin through slot in bogie stretcher and into housing, taking care top of stretcher is free from cement and swivels easily.
24. Carefully place a drop of cement into tender coupling housing at rear and underside of footplate. Press pivot pin (C) through hole in large boss on tender coupling (21) and press into coupling housing. Check that coupling is free to move.
25. Locate and cement buffers (23) into locating holes on front buffer beam.
26. Locate and cement vacuum pipe (23) into locating hole on front buffer beam.
27. If **NON** working coupling (24) has been selected, locate and cement into central hole in front buffer beam.

Tender Assembly

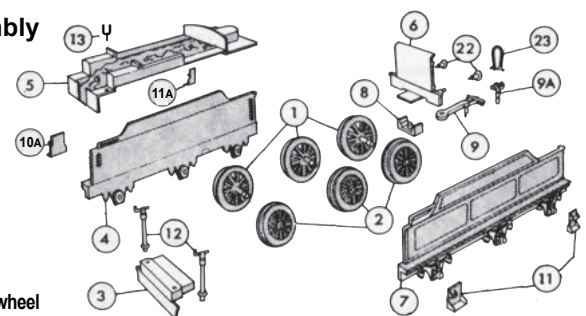

28. Cement tender pin wheel halves (1) to tender wheel socket halves (2).
NOTE - pin half fits into socket half. Check that wheels run true.
29. Locate and cement tender footplate (3) to locating rib on front of right tender side (4)
30. Locate and cement tender top (5) to locating rib on right tender side
31. Locate and cement tender back (6) to rear of tender top and side
32. Push stub axles of tender wheels into holes in axle boxes in right tender side. **DO NOT CEMENT.**
33. Locate and cement left hand edge of footplate, tender top and tender back to left hand side (7), at same time locating stub axles of tender wheels into holes in axle boxes.
34. If working coupling has been selected, locate the hole in the coupling (9) over the pin in the coupling housing (8). Apply cement to the edges of the housing and cement into position under the tender back (check that coupling is free to move). If **NON** working coupling (9A) has been selected, locate and cement into central hole in buffer beam.
35. Locate and cement steps (10 - 10A - 11 - 11A) to tender sides.
36. Locate and cement handbrakes (12) into locating holes in tender footplate.
37. Locate and cement Yoke (13) into locating hole on left hand side of tender top.
38. Cement buffers (22) into locating holes in buffer beams.
39. Locate and cement vacuum pipe (23) into locating hole in buffer beam.