

# dapol 00/H0 TRACKSIDE MODEL C057: SEMI-DETACHED HOUSE

Made in the UK  
using recycled plastic



Not suitable for  
children under 14 years old



**Please Note** - The tools used to produce this model were made over 50 years ago. Over the period, changes have been made and it may be that reference numbers moulded into the plastic parts do not match the numbers used in these instructions. Therefore we advise you to FOLLOW the exploded diagram and instructions.

**ASSEMBLY INSTRUCTIONS:** It is recommended that the instructions and exploded view are studied and that the assembly is practiced before cementing together. Certain parts may need to be trimmed and may best be painted before cementing.

**WARRANTY:** Parts can get bent during transit or by prolonged storage. However misshapen parts can be straightened by placing them in hot water to soften the plastic and then carefully manipulating them back into shape by finger pressure. Please be careful that the water does not cause harm to skin or fingers.

In the event of parts being broken or missing, then you **MUST** return to the place of purchase (the seller). The seller will replace your kit and return the original kit to Dapol under their agreed contractual terms. Do **NOT** return to Dapol.

Finally please note that Dapol does not keep individual parts for any kit.

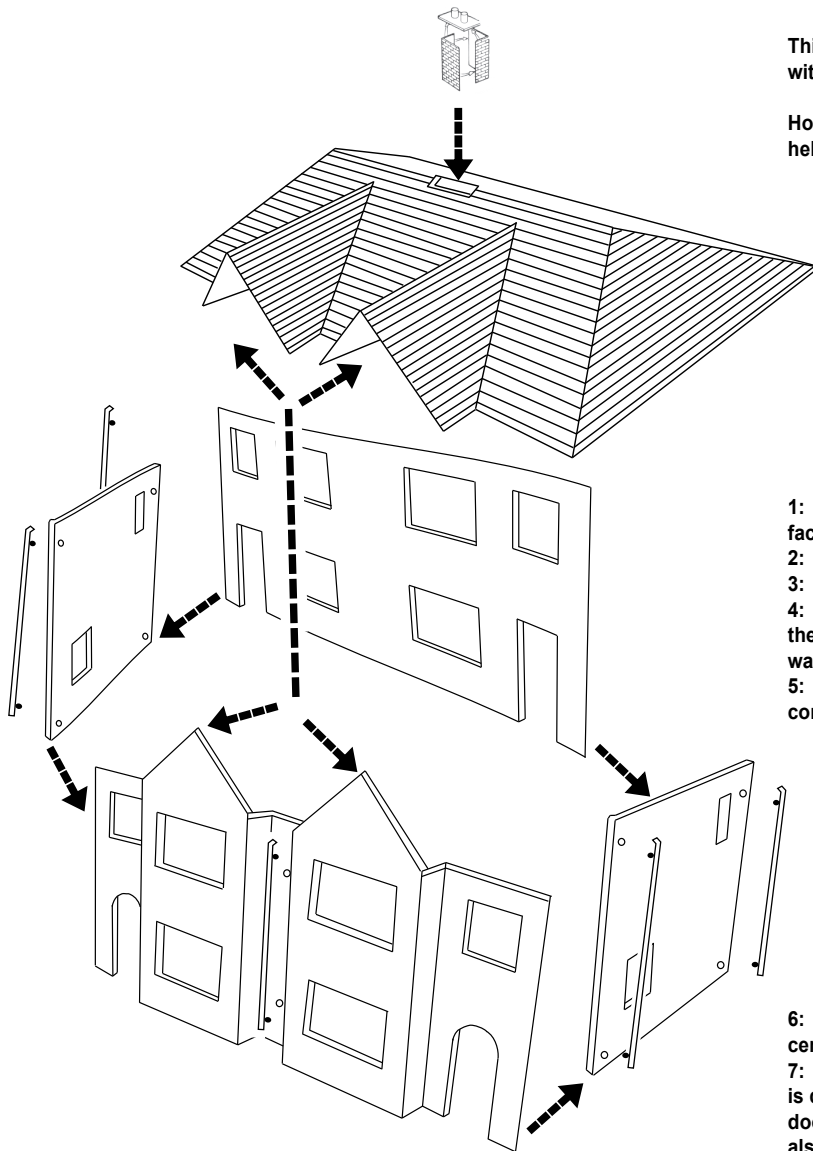

This semi-detached house is one of the most simple kits to assemble and with the use of a small number of obvious parts.

However, for ease of assembly, please note the following points which will help in the work.

- 1: The two side walls should be positioned with the larger window opening facing the front of the building.
- 2: Cement the various windows into place from the **INSIDE** of the walls.
- 3: Cement the clear acetate glazing onto the inside of the windows.
- 4: Assemble the walls and windows and allow to dry before cementing the four walls together to form the basic framework of the structure.
- 5: Cement the five drain pipes into place using the two small lugs and corresponding holes in the walls.

- 6: Cement the chimney assembly and cement to the roof before finally cementing the roof to the structure.
- 7: Whilst there are three different sizes of windows, each window size is different and can only fit into the obvious position. Likewise for the doors; their shapes make it clear where they fit. The clear acetate should also be used for the door glazing.