

# dapol 00/H0 TRACKSIDE MODEL C031: SHOP & FLAT

Made in the  
UK using recycled plastic



Not suitable for  
children under 14 years old

**Please Note** - The tools used to produce this model were made over 50 years ago. Over the period, changes have been made and it may be that reference numbers moulded into the plastic parts do not match the numbers used in these instructions. Therefore we advise you to FOLLOW the exploded diagram and instructions.

**ASSEMBLY INSTRUCTIONS:** It is recommended that the instructions and exploded view are studied and that the assembly is practiced before cementing together. Certain parts may need to be trimmed and may best be painted before cementing.

**WARRANTY:**

Parts can get bent during transit or by prolonged storage. However misshapen parts can be straightened by placing them in hot water to soften the plastic and then carefully manipulating them back into shape by finger pressure. Please be careful that the water does not cause harm to skin or fingers.

In the event of parts being broken or missing, then you **MUST** return to the place of purchase (the seller). The seller will replace your kit and return the original kit to Dapol under their agreed contractual terms. Do **NOT** return to Dapol.

Finally please note that Dapol does not keep individual parts for any kit.



= CEMENT



= ASSEMBLED SECTION

Start by assembling the shop front (part A).

Cut a piece of clear plastic to size and glue behind the door and windows of the shop front and then glue your chosen window display onto the clear plastic ensuring that the glue is applied behind the window frames where it can't be seen.

Fit and glue all the remaining windows and doors into their appropriate positions on the remaining walls.

Glue completed shop front (part A) to sides of the building and glue back of shop onto the sides. Then glue the floor of the balcony into place.

Glue upper part of shop front (part B) into place and then fit the coping to the top edges of the balcony walls.

Finally, glue the chimney and water tank onto the shop roof and glue roof into position, ensuring that the fittings are in the positions shown in the illustration of the finished model.

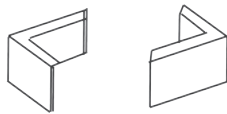
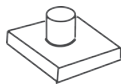

Chimney Assembly  
(water tank similar)

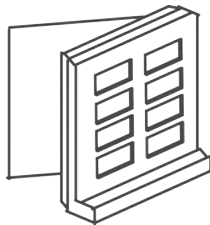

Window Fitting

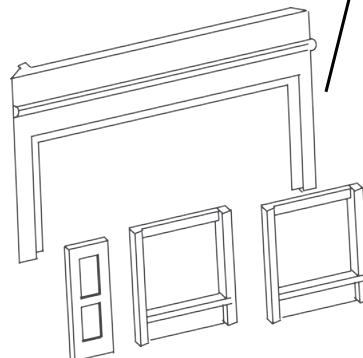
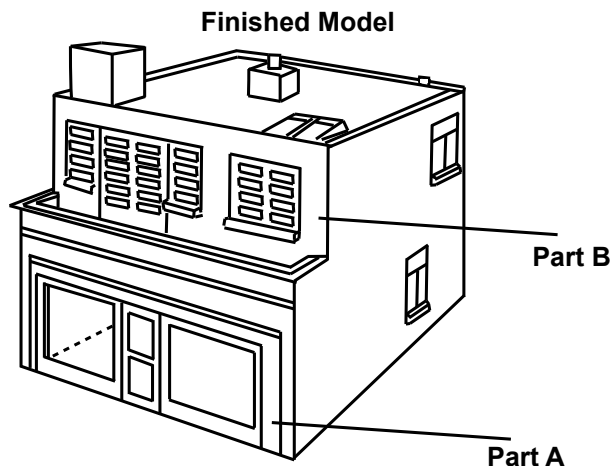

Assembly of Shop Front  
(Position of Door can be Central or  
either side of Window)