

dapol

00/H0 TRACKSIDE MODEL C030: DOCKSIDE CRANE

Made in the UK using recycled plastic



Not suitable for children under 14 years old

Please Note - The tools used to produce this model were made over 50 years ago. Over the period, changes have been made and it may be that reference numbers moulded into the plastic parts do not match the numbers used in these instructions. Therefore we advise you to FOLLOW the exploded diagram and instructions.

ASSEMBLY INSTRUCTIONS: It is recommended that the instructions and exploded view are studied and that the assembly is practiced before cementing together. Certain parts may need to be trimmed and may best be painted before cementing.

WARRANTY: Parts can get bent during transit or by prolonged storage. However misshapen parts can be straightened by placing them in hot water to soften the plastic and then carefully manipulating them back into shape by finger pressure. Please be careful that the water does not cause harm to skin or fingers. In the event of parts being broken or missing, then you **MUST** return to the place of purchase (the seller). The seller will replace your kit and return the original kit to Dapol under their agreed contractual terms. Do **NOT** return to Dapol. Finally please note that Dapol does not keep individual parts for any kit.

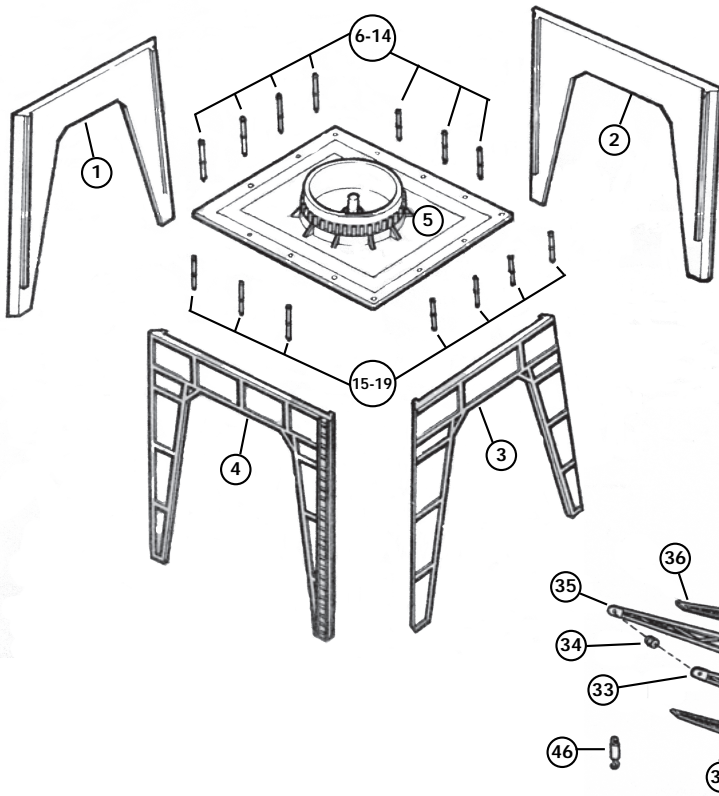

- 1: Cement the four legs (1 - 4) to the central base (5) and then cement the fourteen stanchions (15-19) into place on the central base as shown. Allow to dry.
- 2: Locate the two rear boom arms (20 & 22) and the small pulley (21). Clip the pulley into the corresponding holes in the boom arms and then cement the complete assembly to the rear wall (23) ensuring that the pulley revolves. Then cement the rear panel (24) to the back of the boom arms.
- 3: Cement one side wall (25) to the rear wall assembly. Then clip both main pulleys (26 & 27) into the corresponding holes in the side wall, before locating opposite side wall (28) and cementing it to the opposite side of the rear wall, ensuring that both main pulleys revolve.
- 4: Cement the front wall (29) into place. Then cement small lamp (30) into the front of this wall before finally cementing complete assembly to the base (32). Do not yet fit roof.
- 5: Locate the five main parts of the central arm (33-37) and the two arm-to-base brackets (38 & 39). Clip the small end pulley (34) into the corresponding holes at the end of the two side arms (33 & 35) and then cement the top and bottom pieces (36 & 37) to hold the complete assembly in place. Then clip the two base brackets to either side of the completed arm assembly, before finally cementing the brackets into place on the front of the base as shown.
- 6: Cement the small ladder (40) into place on the side of the base. Then cement the four remaining small stanchions (42-45) into the base and finally cementing the door (41) into the side wall as shown.

7: Now consider the fitting of the 'Cable' which connects the small rear pulley (21) to the small front pulley (34) and onwards to the hook (46).

It is recommended that you use cotton thread and keep it as one continual piece.

Commence by fastening around the rear pulley, then pass through the window opening in the rear wall, then over large pulley (27) and under the next pulley (26) before exiting via the upper window opening in the front wall. Now thread inside of the central arm until reaching the small front pulley (34) and from there to the hole in the end of the hook (46). Now take the thread in the opposite direction before again reaching the rear pulley and tying the two ends together.

You can obviously choose the precise length of thread to suit to particular needs.

8: Now cement the roof (31) into place over the completed cabin assembly.

9: Locate bogie side pieces (47 & 52) and clip each of the four wheels (48-51) into place.

DO NOT CEMENT WHEELS. Position completed assembly and cement in place to the bottom of the legs on one side, using the fastening lugs on the bogie assembly as the cementing points. Repeat procedure for other bogie assembly (53-58) & (54-57).

