

dapol

Gauge

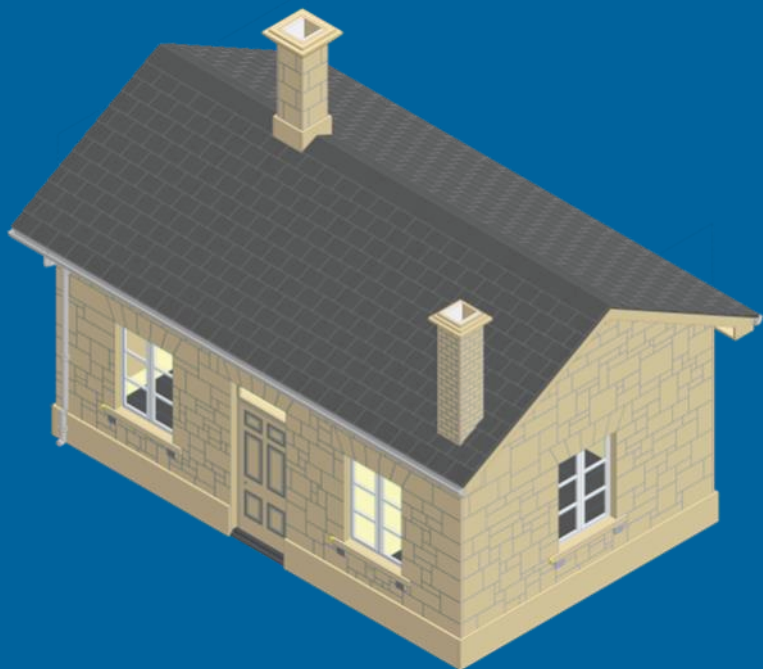

7B-002-005

Great Western Railway Small Station Building

Based on Stogumber



Read Before Building

Estimated Build Time:
6-8 hours

This is a very complex kit, we strongly recommend taking your time building it. It is also very important to keep a clean work area as the card is permeable and can stain very easily.

We recommend using a standard PVA glue slightly diluted with water. We do not recommend any fast drying glues, as they can dry too quickly, making any small positional adjustments difficult. It's best to apply the glue using a small paintbrush or cardboard offcut.

Parts cannot be bought individually. Spare or replacement frets can be bought £10 each for large frets and £7 each for small frets by contacting sales@dapol.co.uk

Printed instructions are available free of charge by contacting sales@dapol.co.uk

But most of all. Enjoy.

Checklist

- China White 10
 - A3
- China White 11
 - C3
- China White 12
 - B3
- China White 13
 - D3
- China White 14
 - E4
- China White 15
 - E5
- China White 16
 - E7
- China White 17
 - E8
- Slate 20
 - F1
 - F3
- Slate 21
 - F2
 - F4
- Slate Thin 12
 - F3 Tiles
- Slate Thin 13
 - F4 Tiles
- Smoke 12
 - E1
- Smoke 13
 - E2
- Stone 27
 - D1
 - D4 (x2)
 - D6 (x2)
 - D8 (x2)
 - D9
 - D13
 - D14
 - D15
- Stone 27
 - A6 (x2)
 - B1
 - B4 (x2)
 - B6
- B7
- C6 (x2)
- Stone 29
 - A1
 - A4a (x2)
 - A4b (x2)
 - A11 (x2)
 - A12 (x2)
- Stone 30
 - C1
 - C4a (x2)
 - C4b (x2)
 - C11 (x2)
 - C12
 - C13
- Stone 31
 - H1
 - H2
 - H3
 - H4
 - H6 (x2)
 - H7
 - H9
 - H10
 - H11
 - H12
 - H14
 - H15 (x2)
 - H16
 - H17
 - H18 (x2)
 - H19 (x2)
- Stone 32
 - A7
 - A8
 - A9
 - A10
 - C7
 - C8
 - C9
 - C10
 - D7
 - D10
 - D11
- D12
- F5 (x2)
- White 61
 - A2
- White 62
 - C2
- White 63
 - B2
- White 64
 - D2
- White 65
 - A5 (x2)
 - B5
 - C5 (x2)
 - D5
 - H5 (x2)
 - H13 (x2)
- White 66
 - E3
- White 67
 - E6
- Clear 7
 - A5 (x2)
 - A7
 - B5
 - C5 (x2)
 - C7
 - D5
 - D7

1

A1 & A2

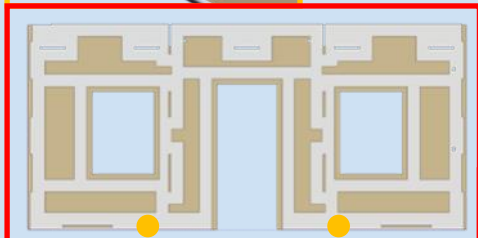
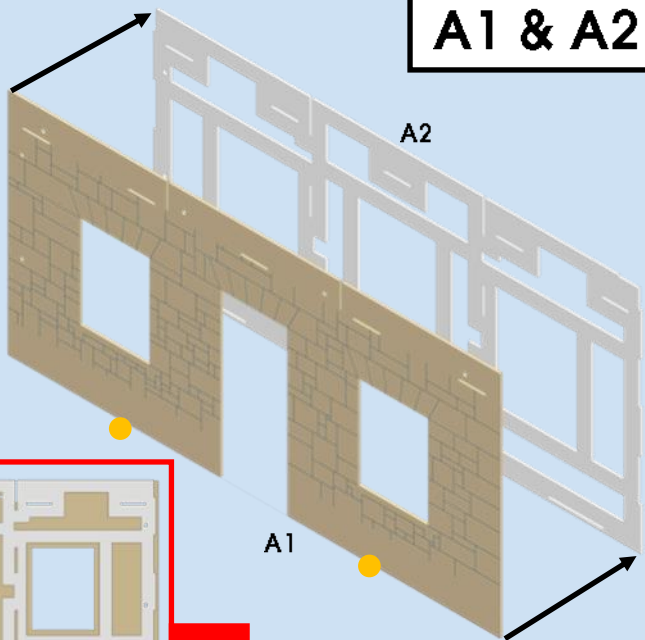
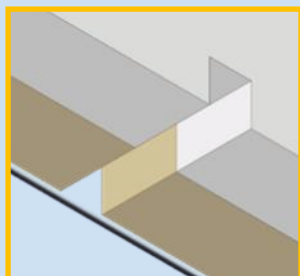

2

A3

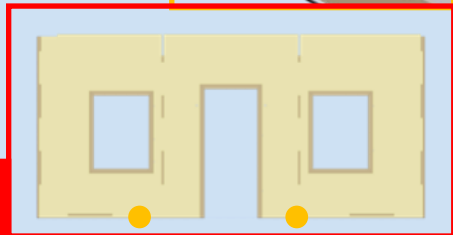
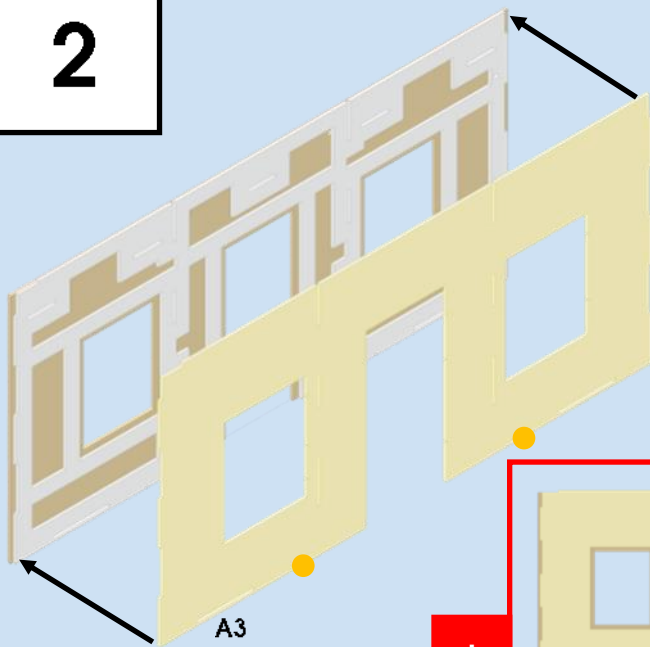

3

A4a(x2) & A5(Inc. Glazing)

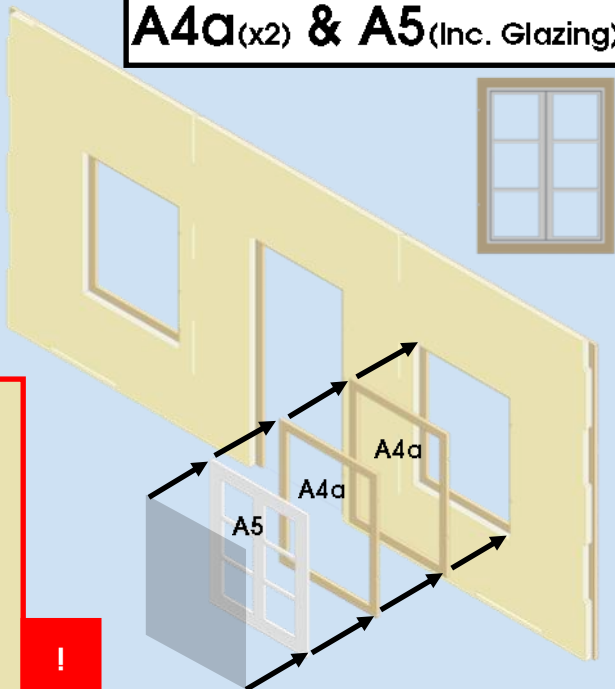

4

A4b(x2) & A5(Inc. Glazing)

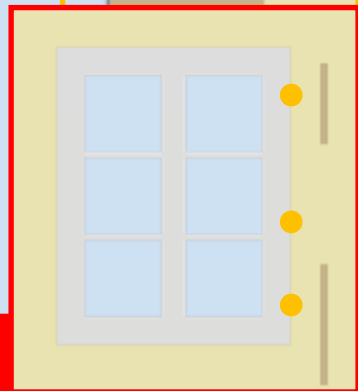
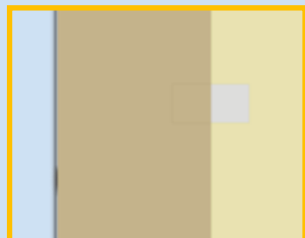
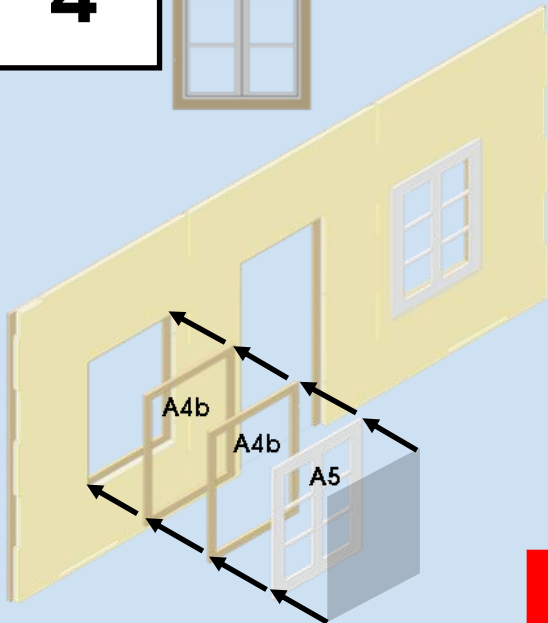

5

A6(x2) & A7 (Inc. Glazing)

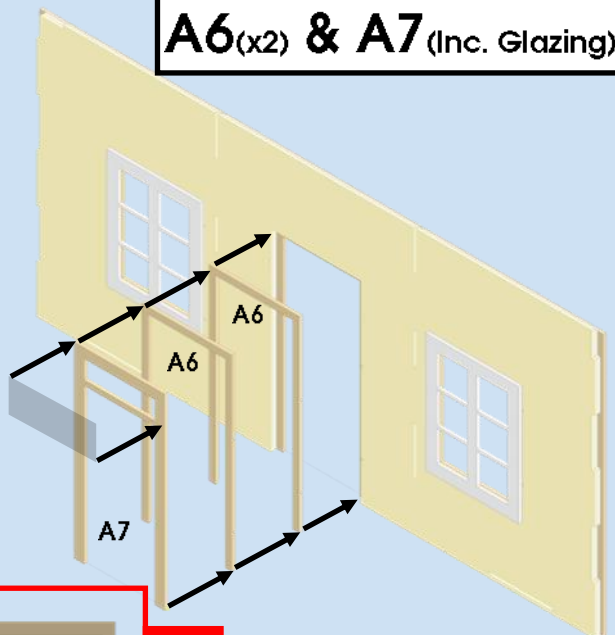
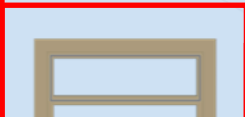
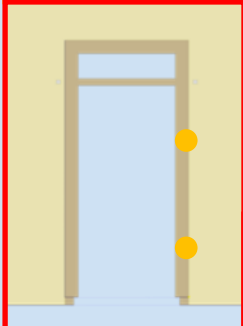

6

A11(x2)

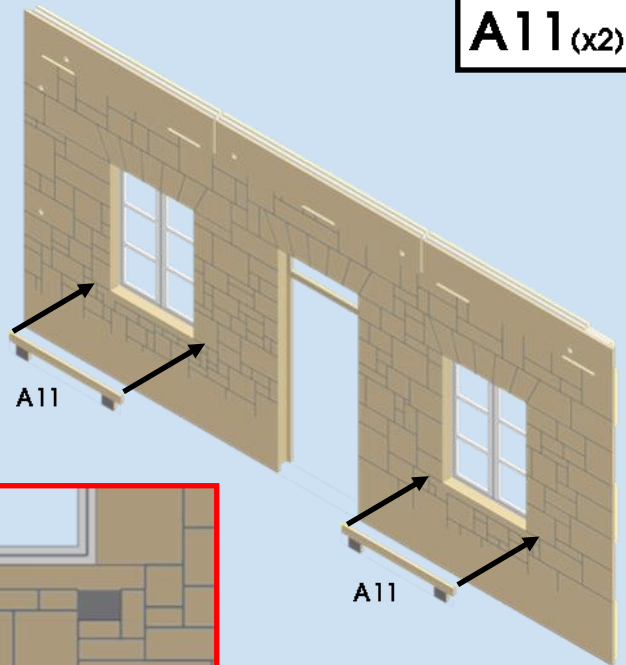
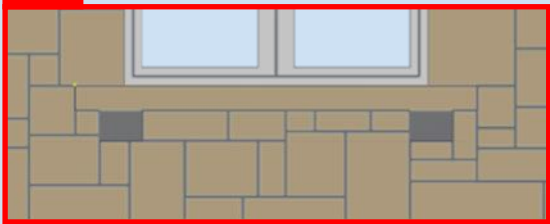

7

E1 & E2

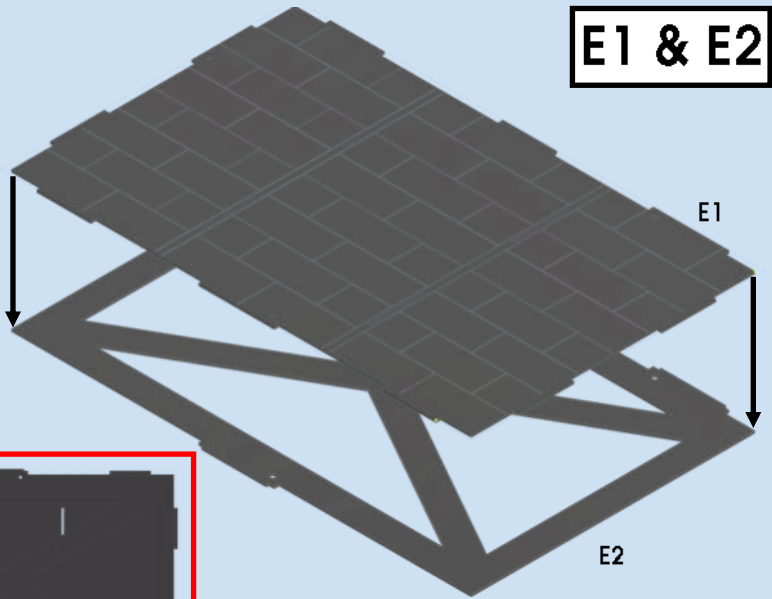

8

E3, E4 & E5

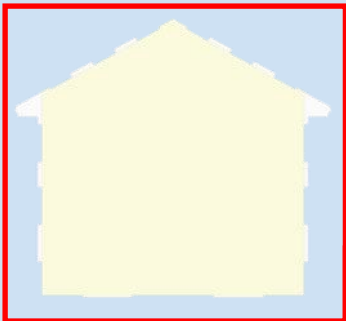
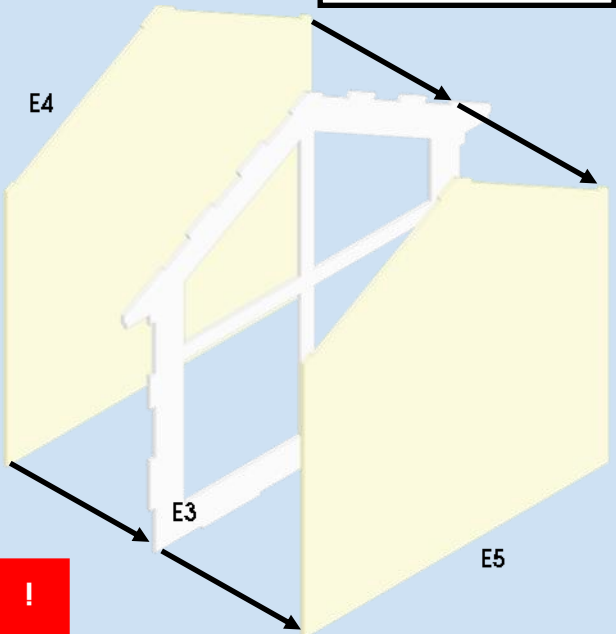

9

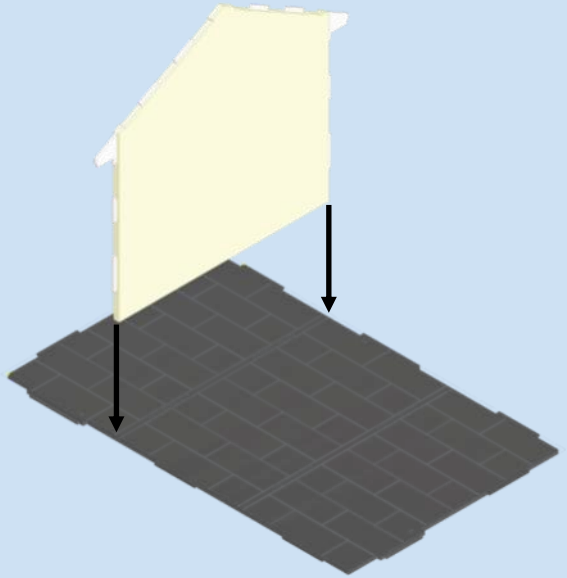
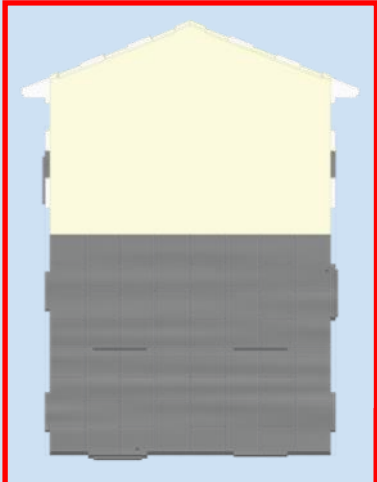

10

E6, E7 & E8

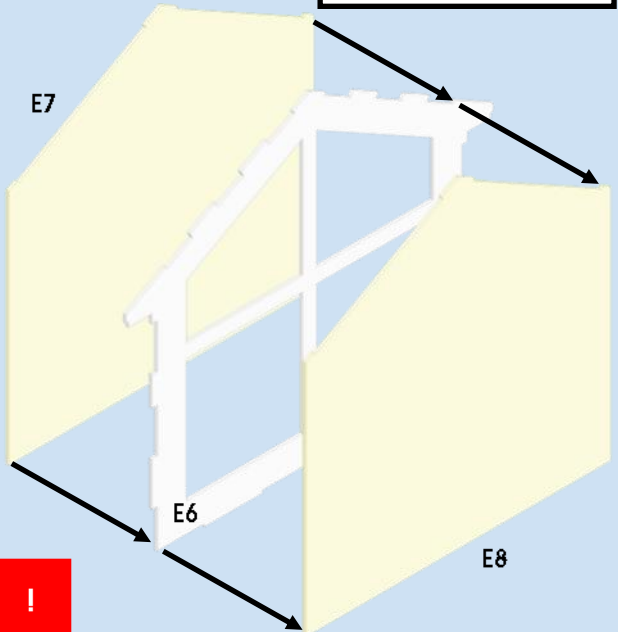

11

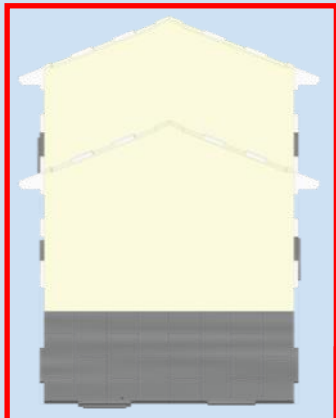
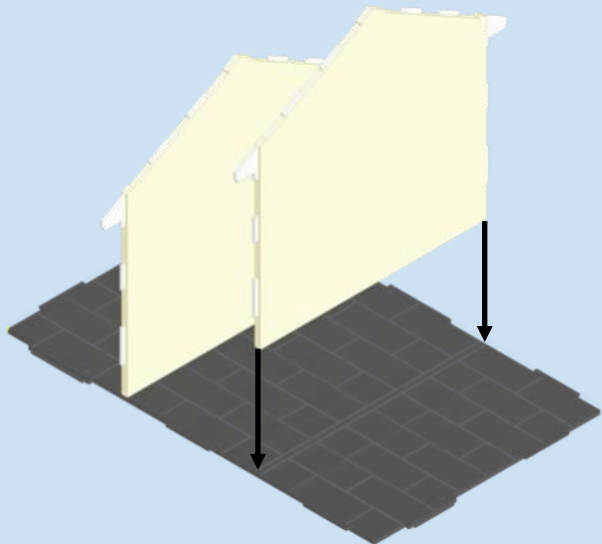

12

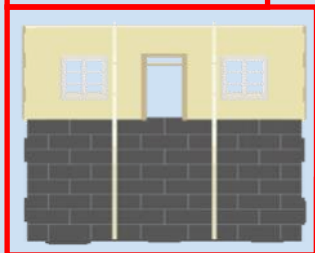
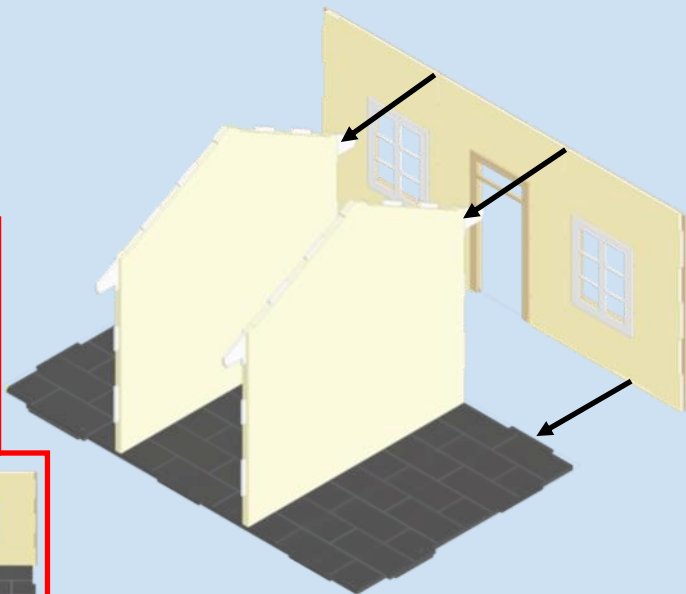

13

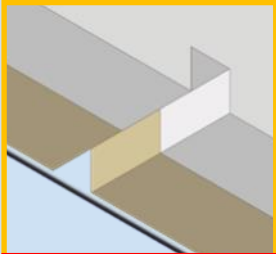

B1 & B2

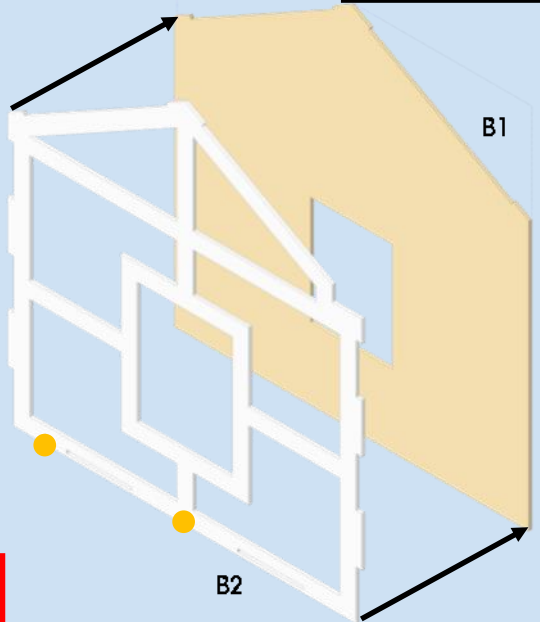

14

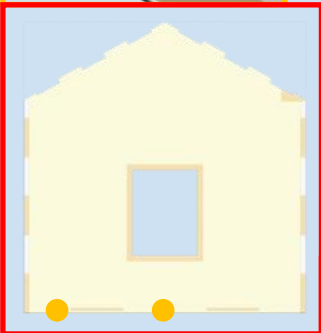

B3

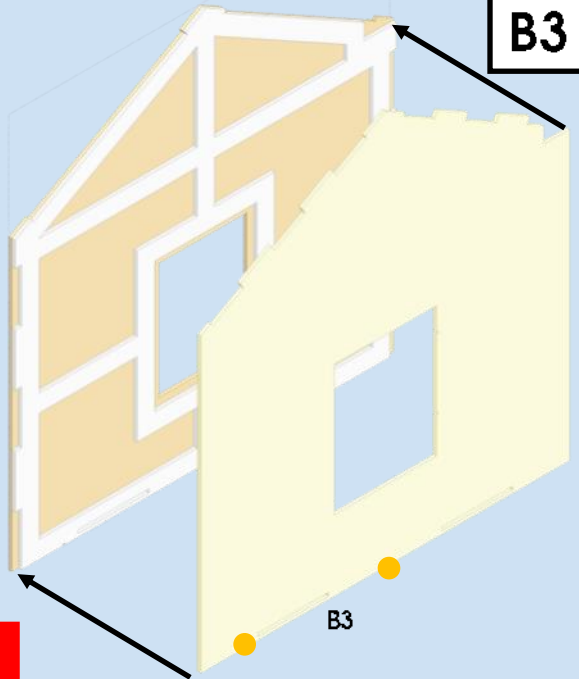

15

B4(x2) & B5(Inc. Glazing)

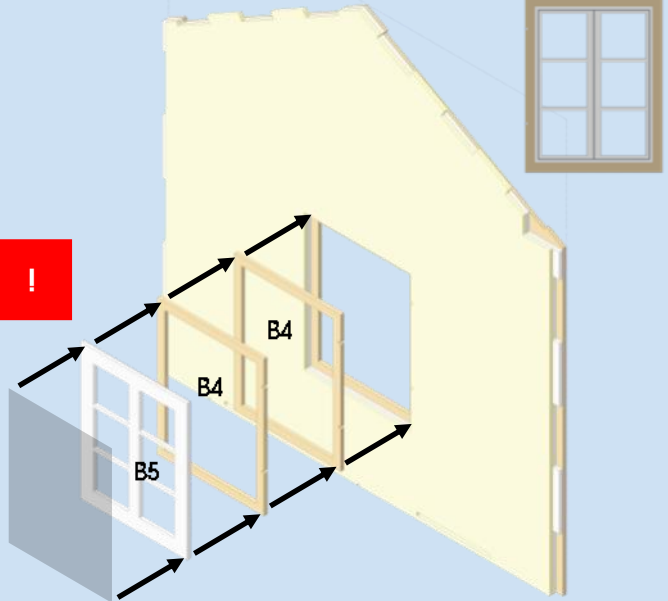
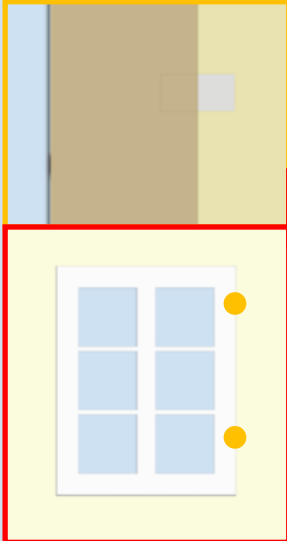

16

B6

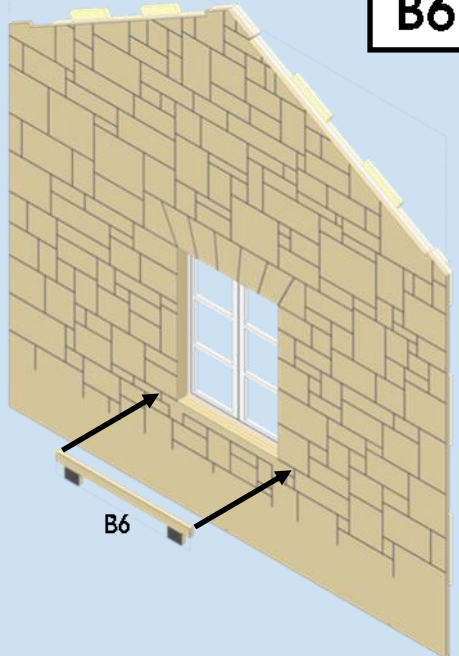
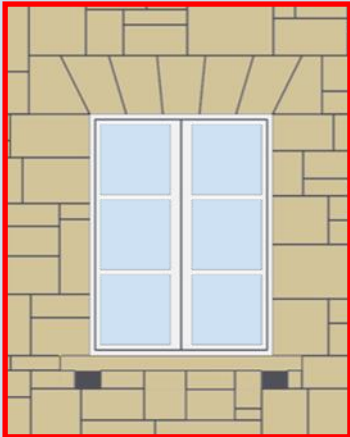

17

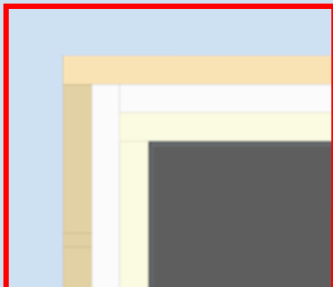
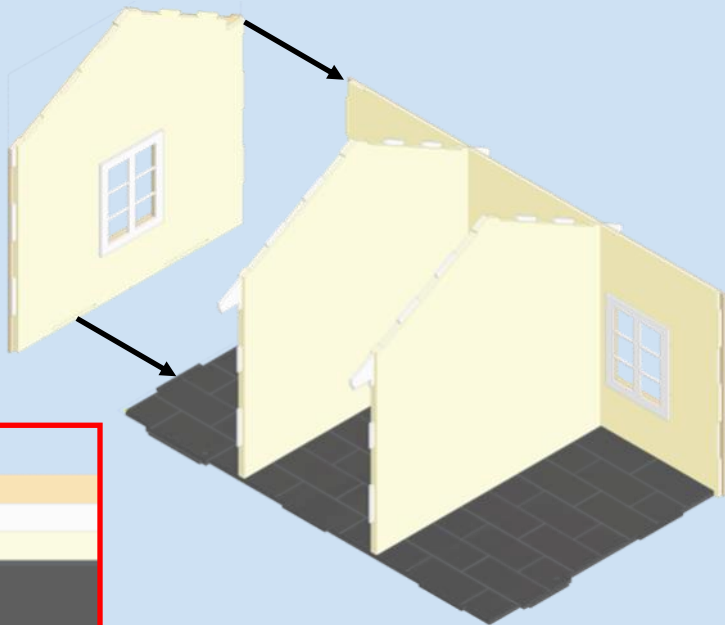

18

C1 & C2

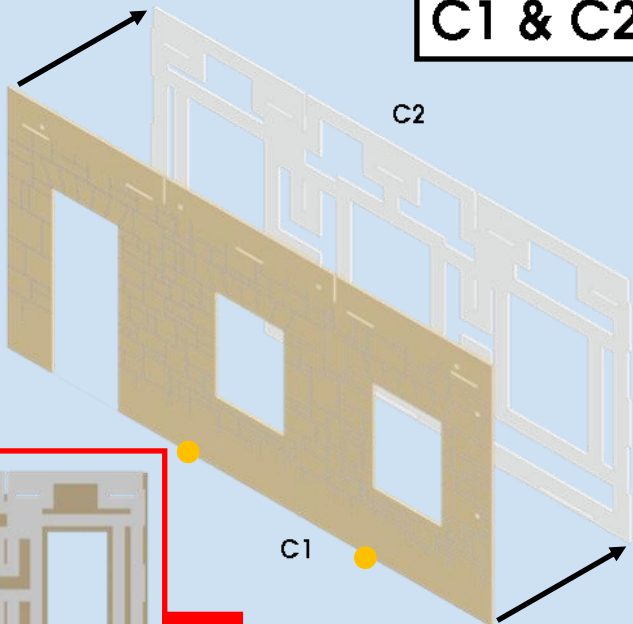
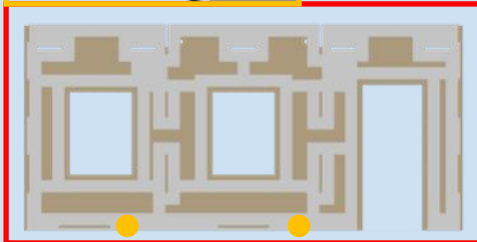
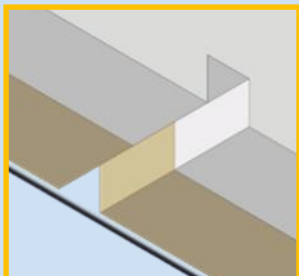

19

C3

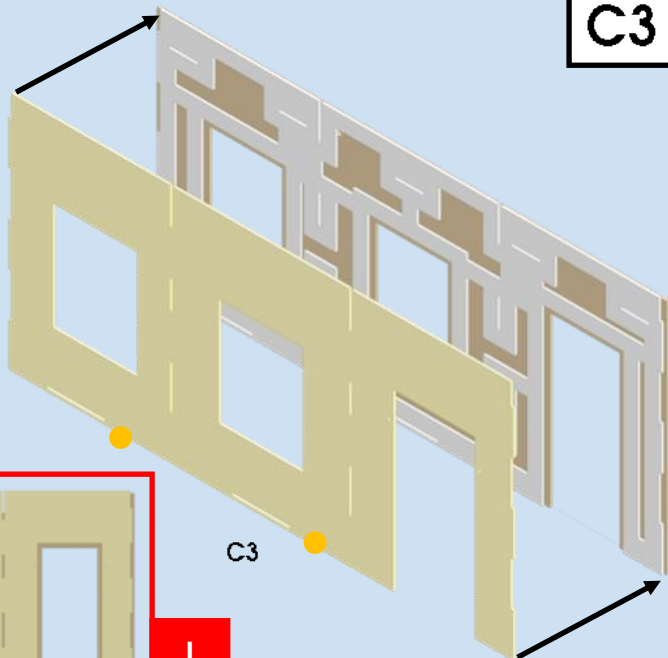

C3

20

C4a(x2) & C5 (Inc. Glazing)

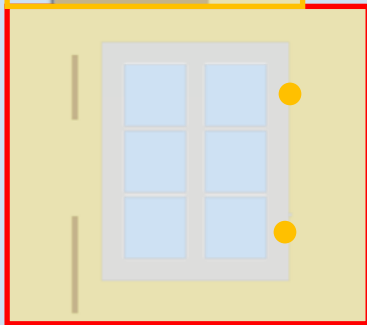
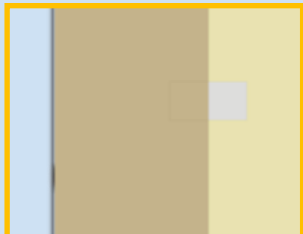
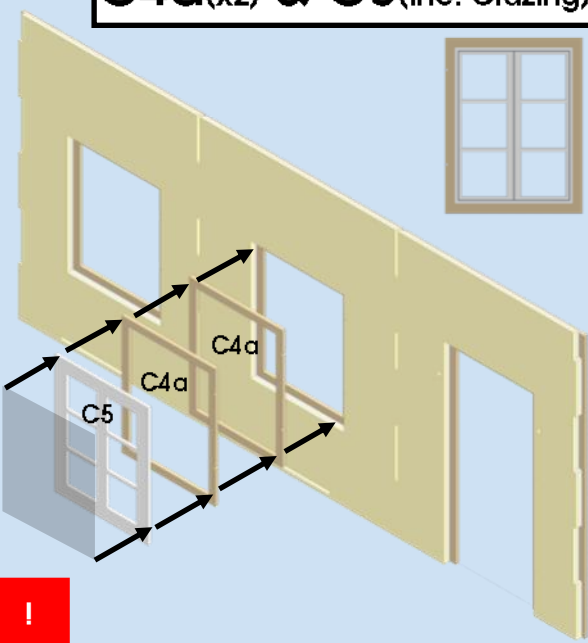

C4a

C4a

C5

21

C4b(x2) & C5 (Inc. Glazing)

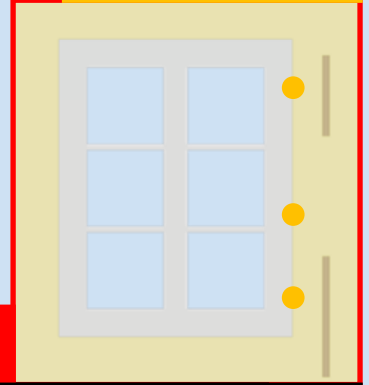
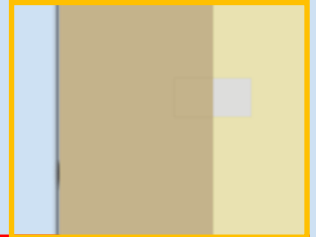
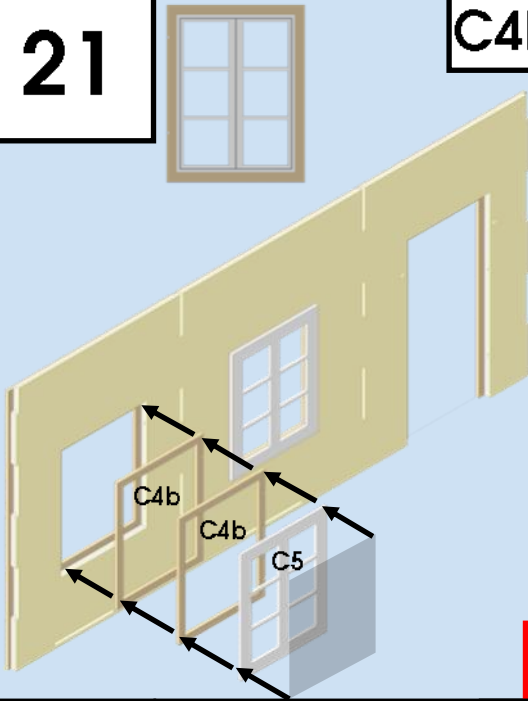

22

C6(x2) & C7 (Inc. Glazing)

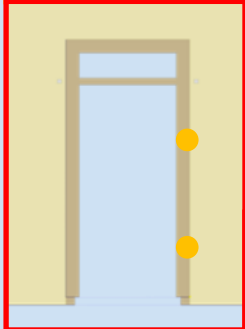
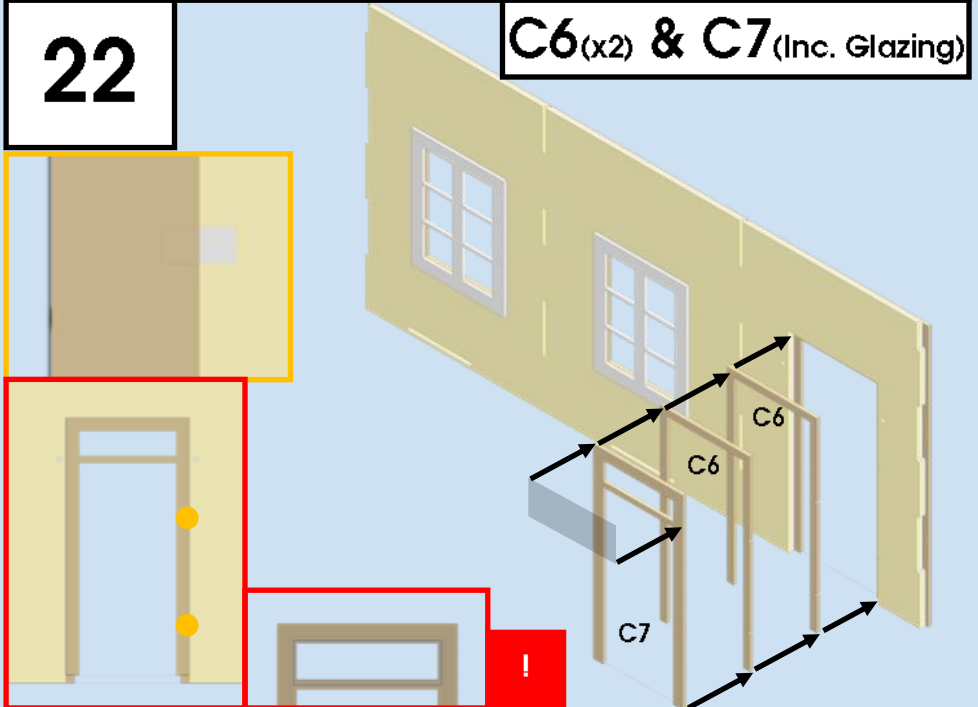

23

C11 (x2)

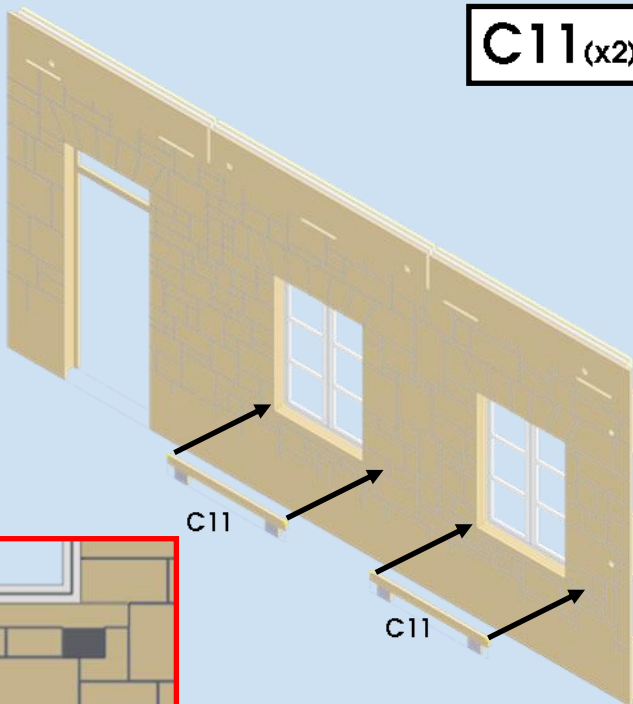

!



24

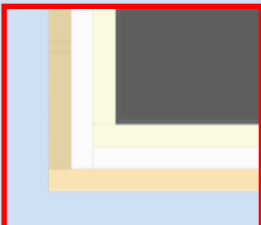
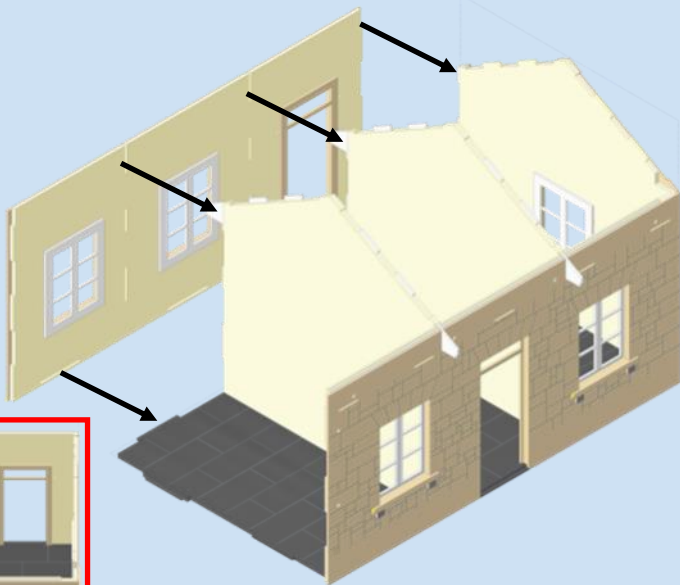

!

25



D1 & D2

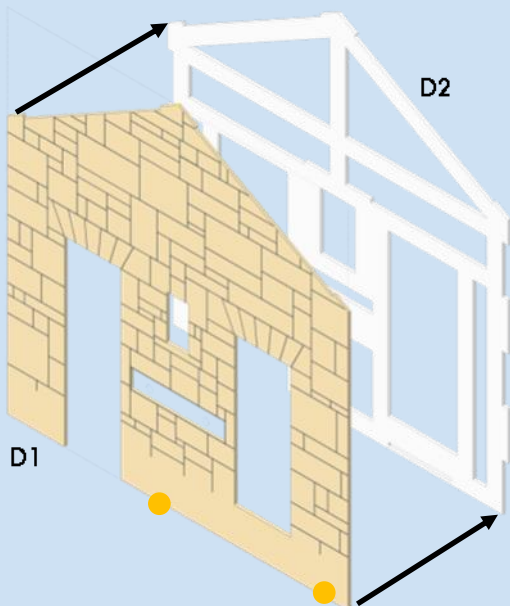

26

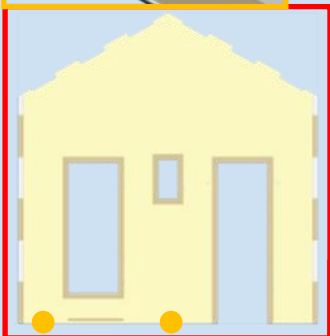

D3

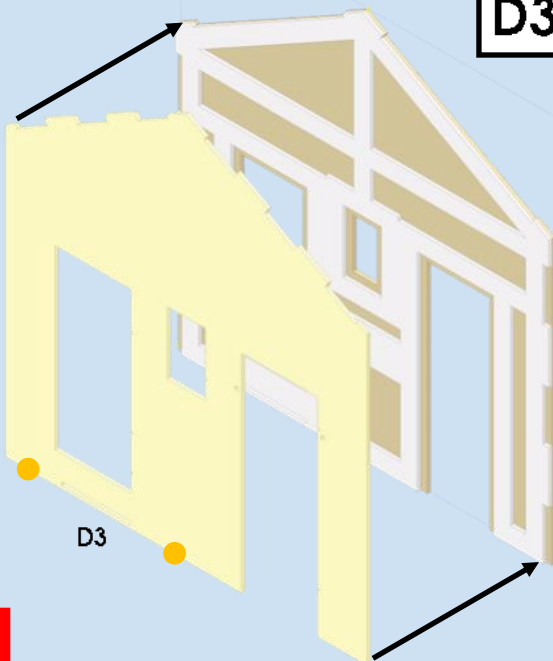

27

D4(x2) & D5(Inc. Glazing)

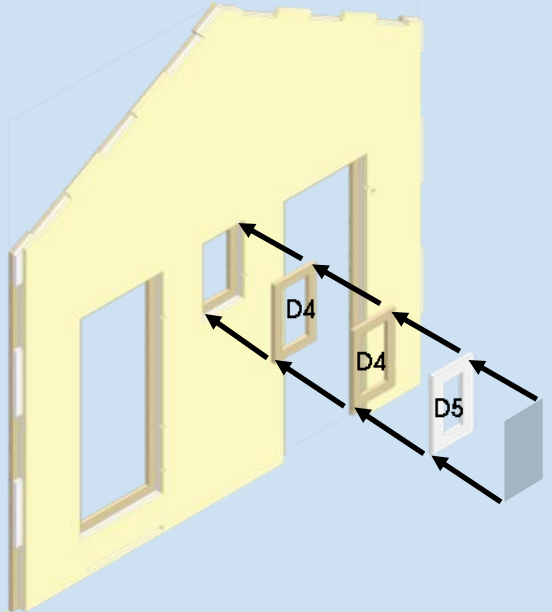
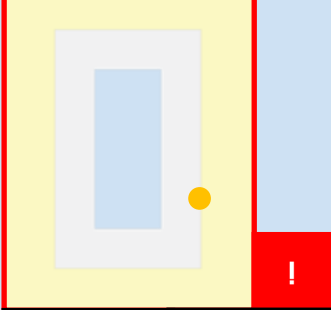
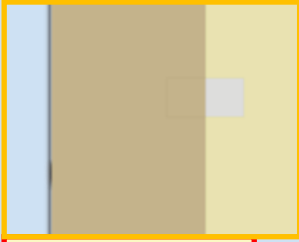

28

D6(x2) & D7(Inc. Glazing)

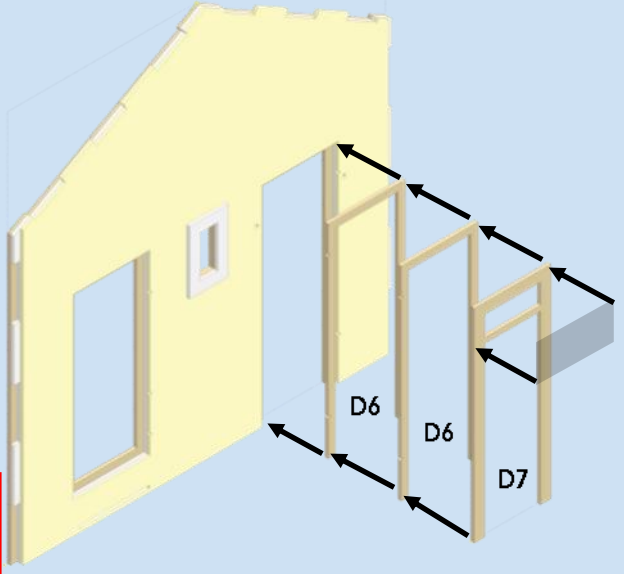
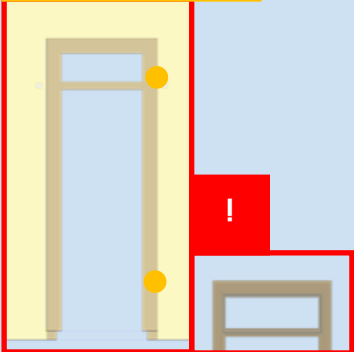
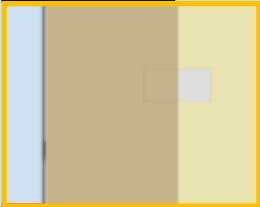

29

D8(x2) & D9

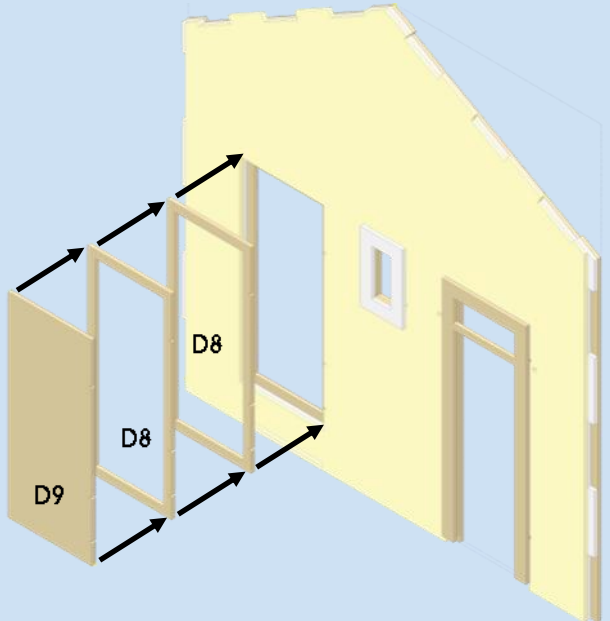
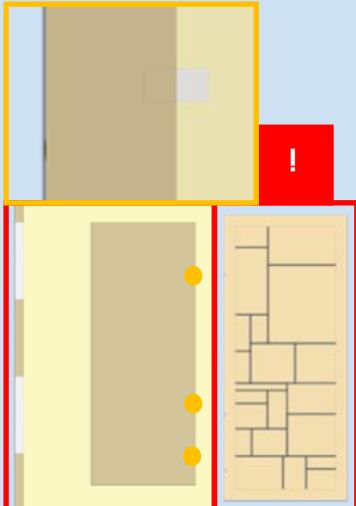

30

D13 & Fire Buckets

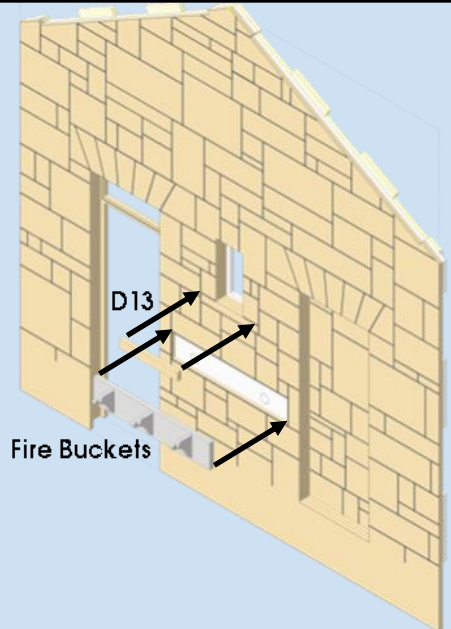
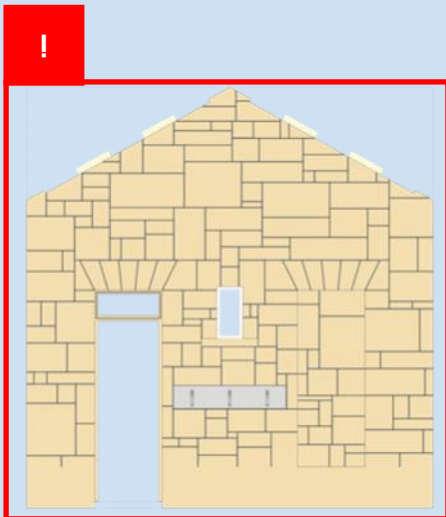

31

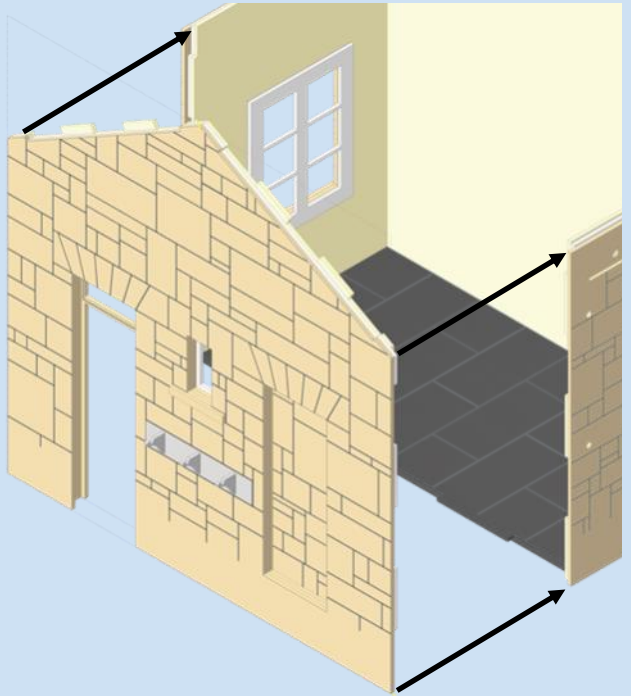
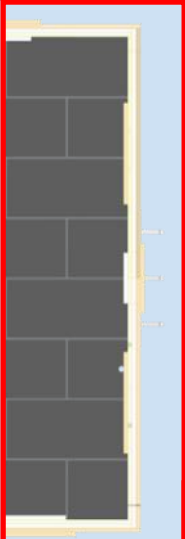

32

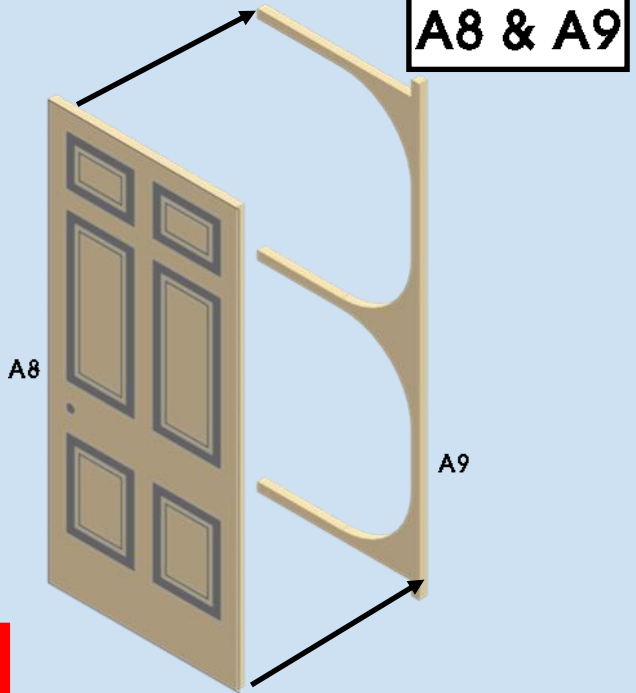
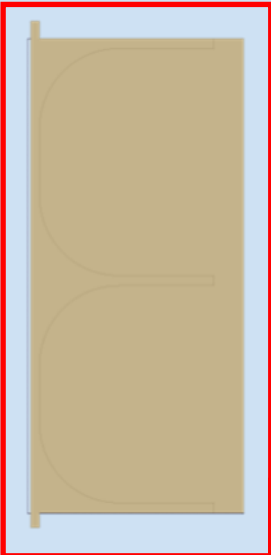

A8 & A9

A8

A9

33

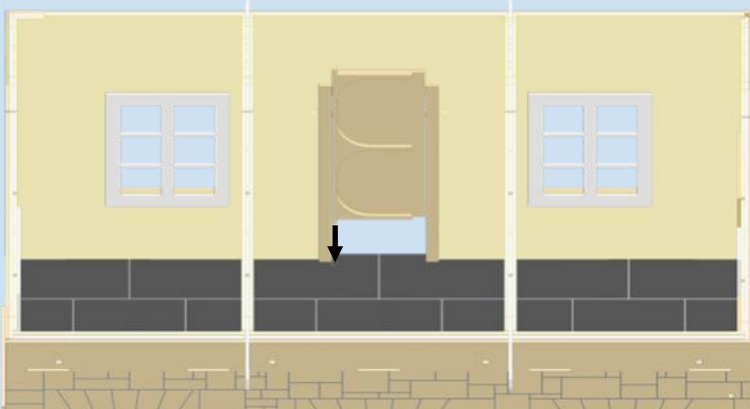
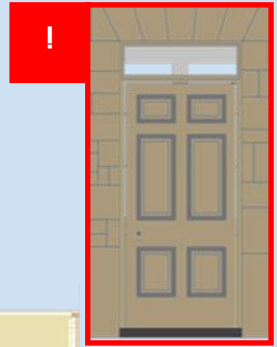

34

A10

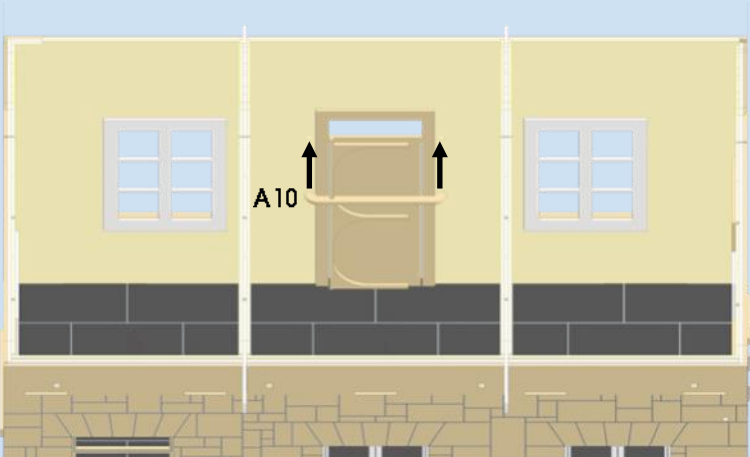
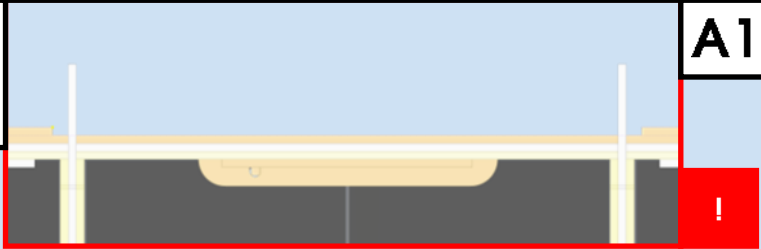

35

C8 & C9

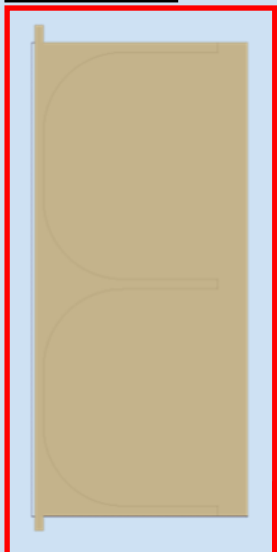

C8

C9

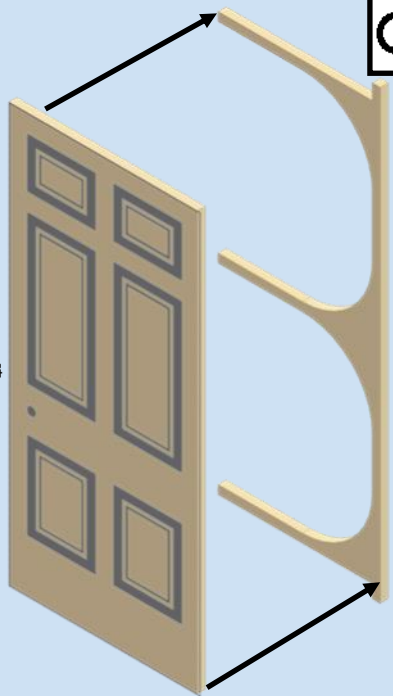

36



37

C10

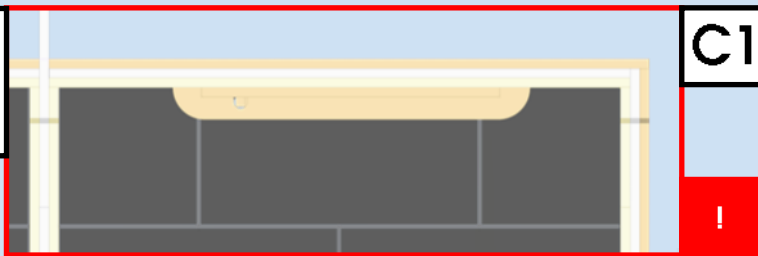

38

D10 & D11

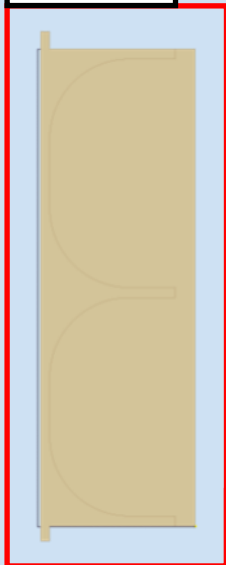

D10



D11

39

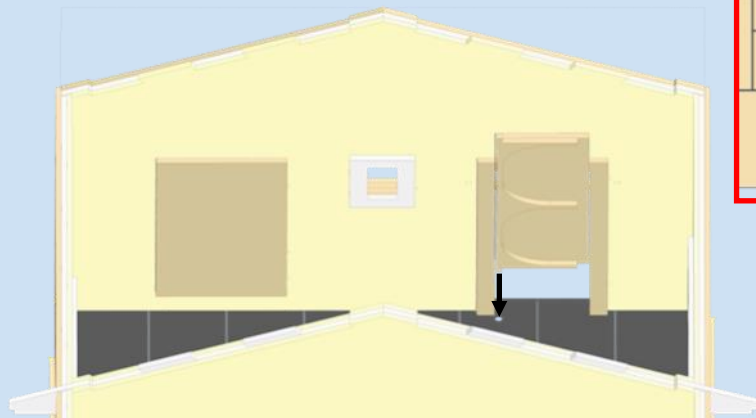

40

D12

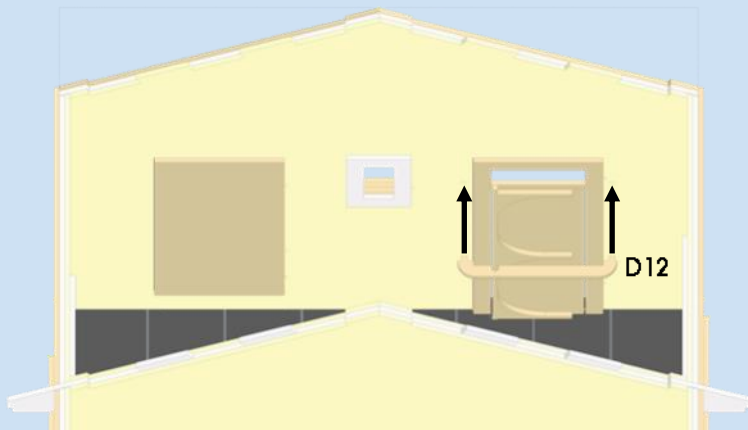

41

A12(x2)

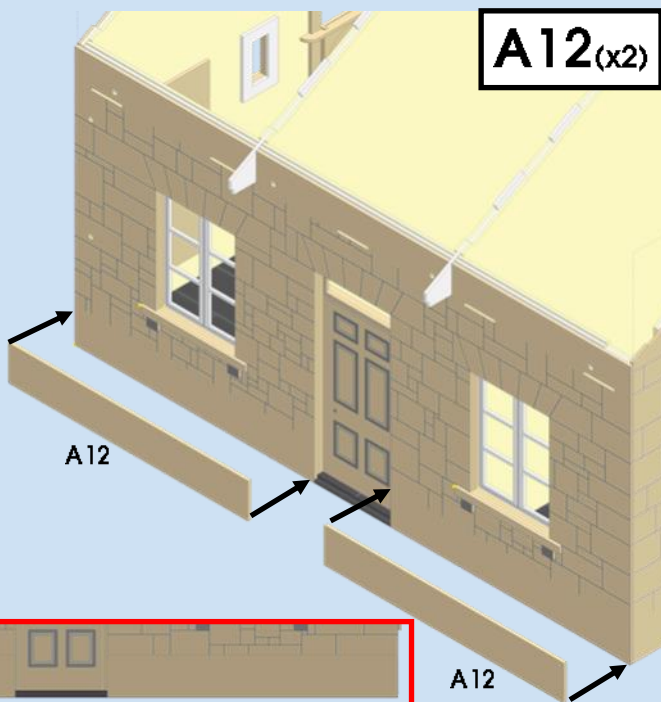

42

C12 & C13

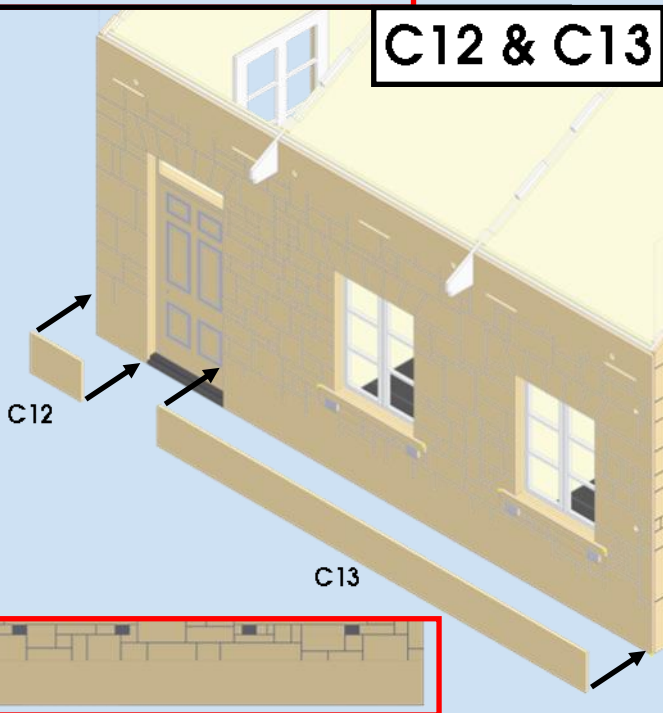

43

B7

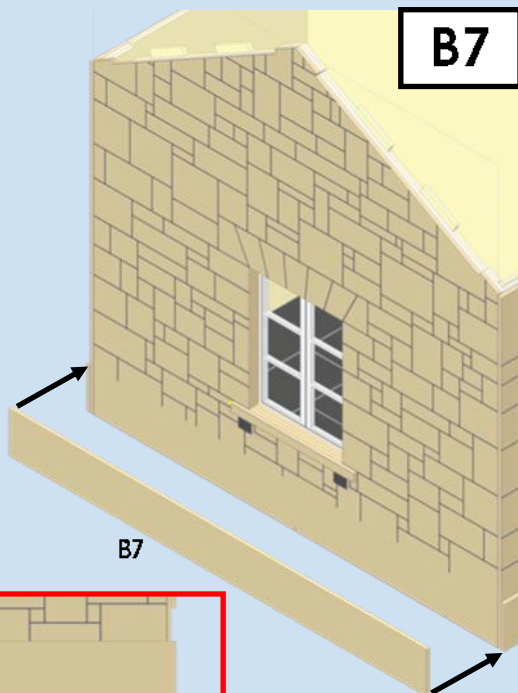

44

D14 & D15

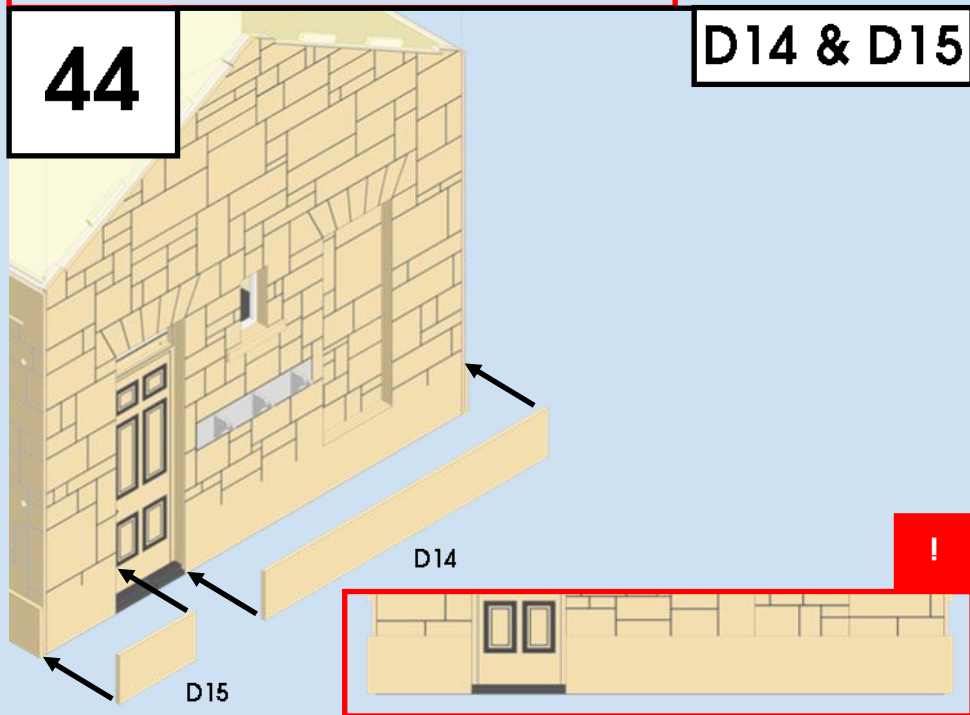

45

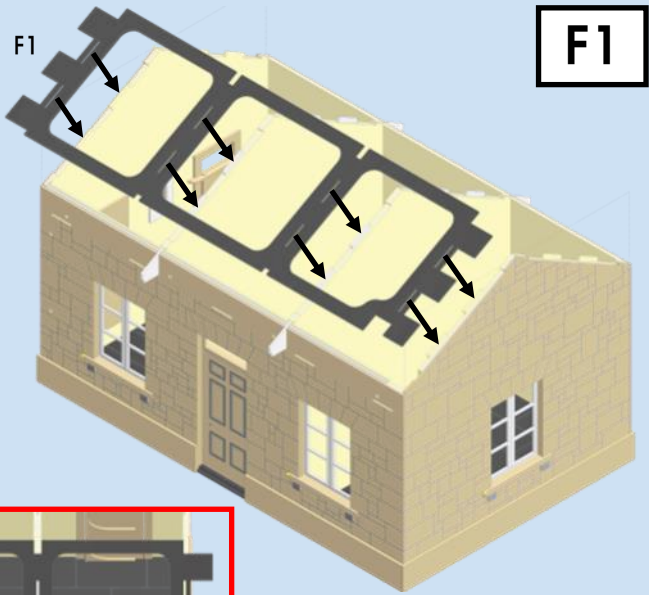

46

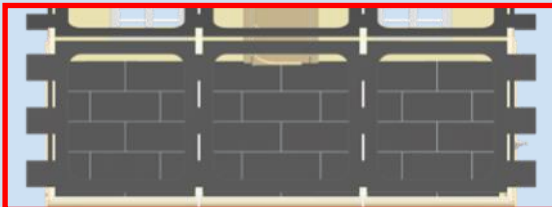
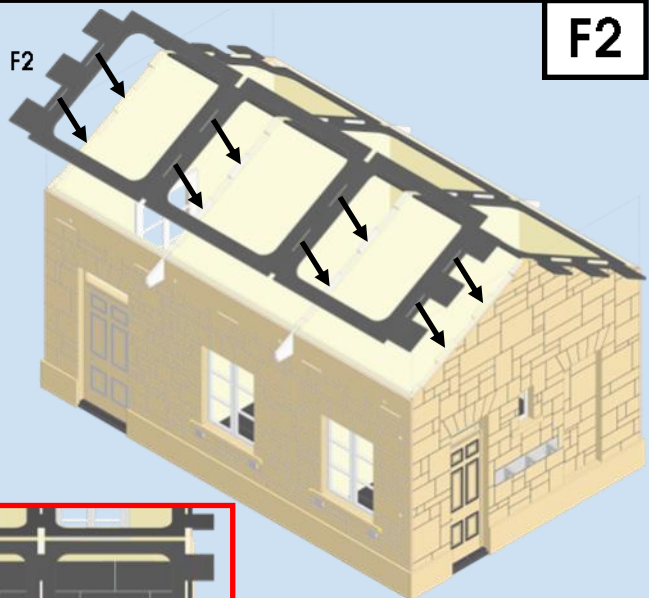

47

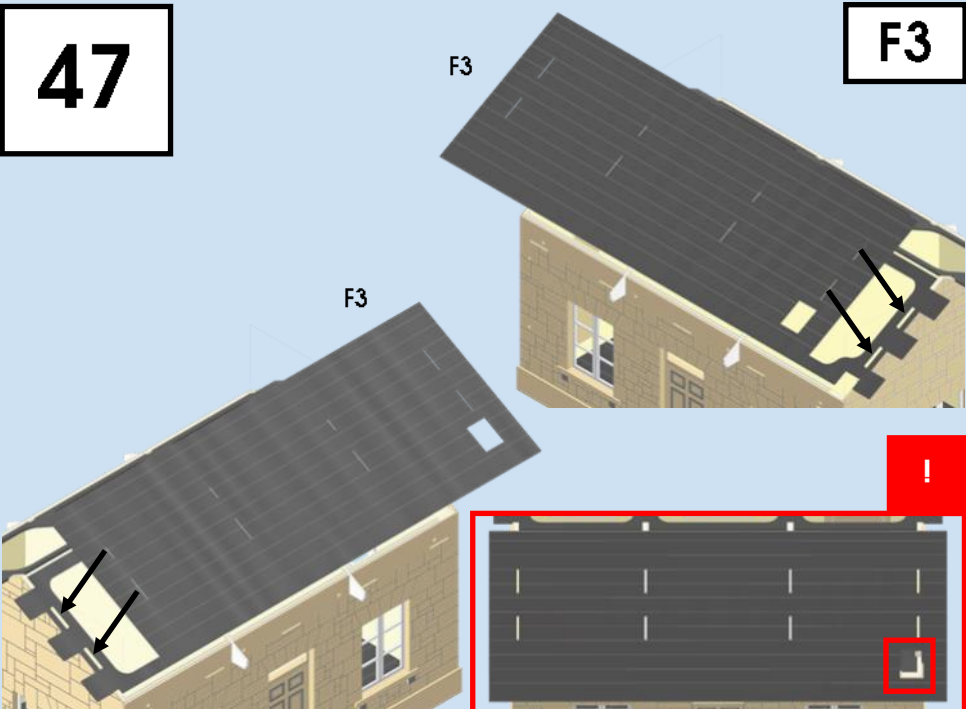

48

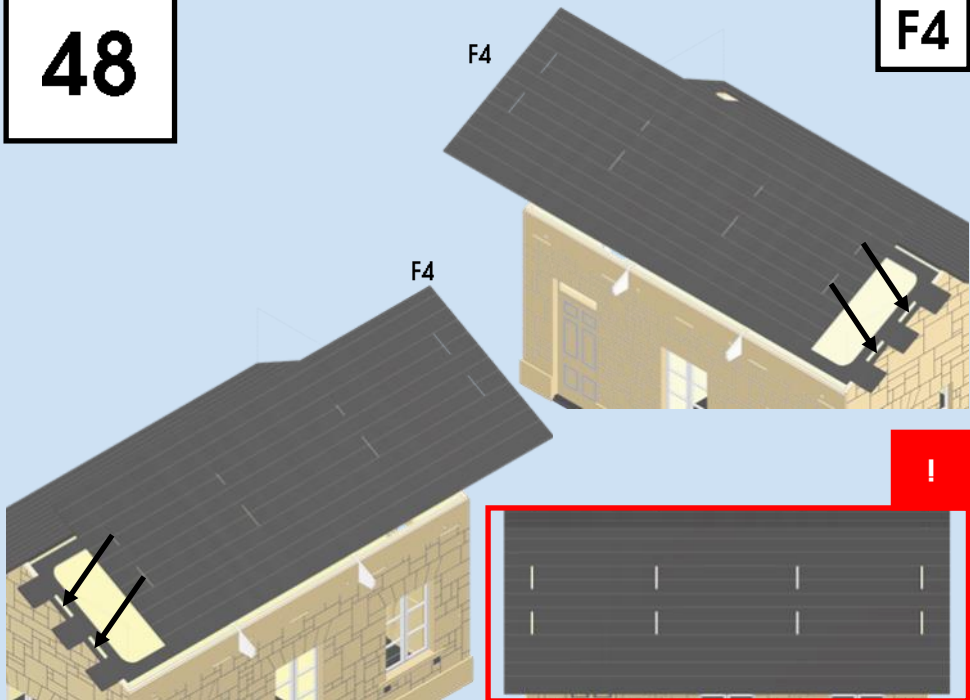

49

F7

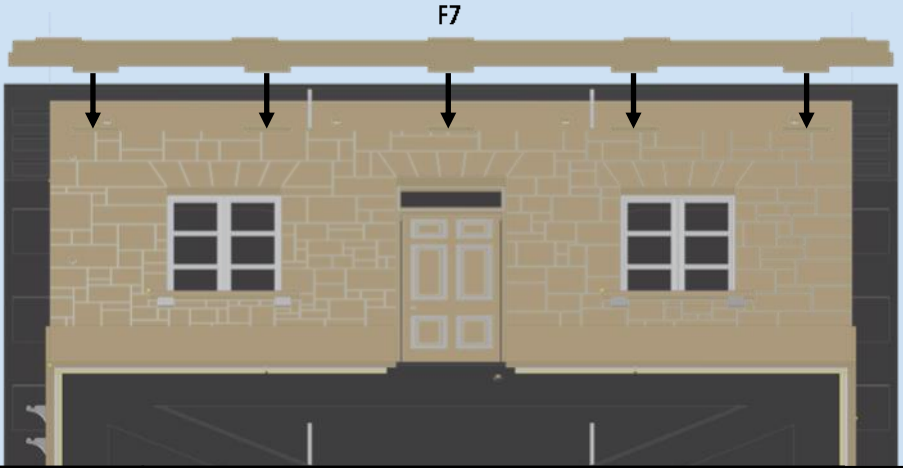

50

F6

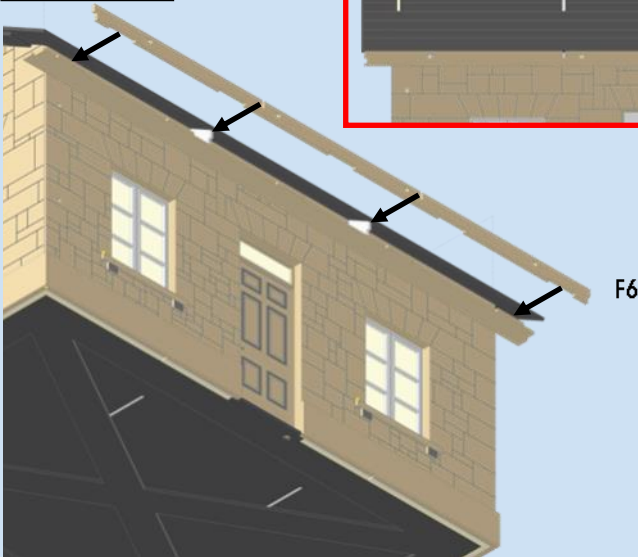

!

51

F7

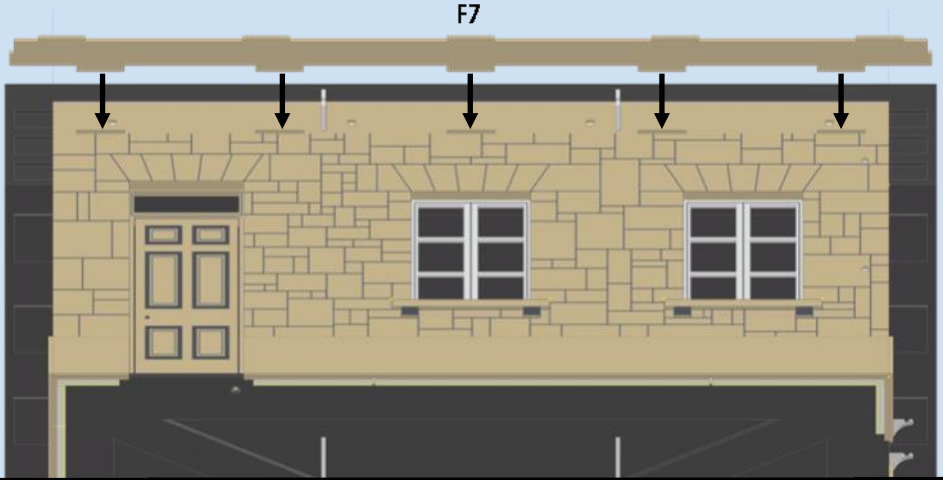

52

F6

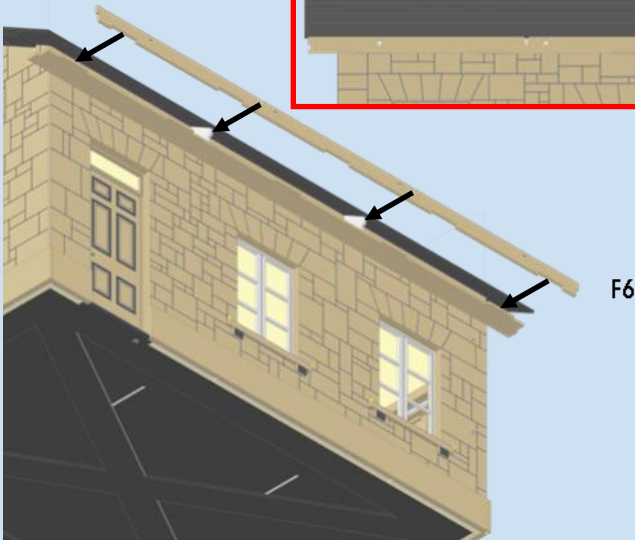

!

53

F5

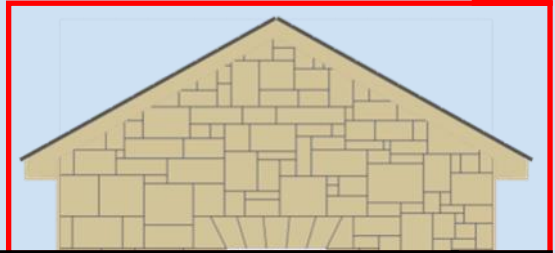
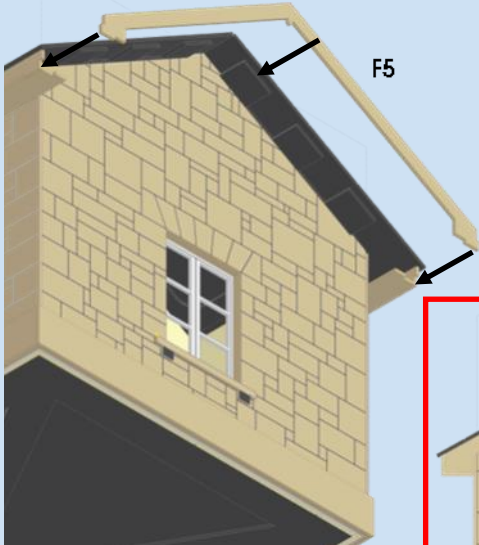

54

F5

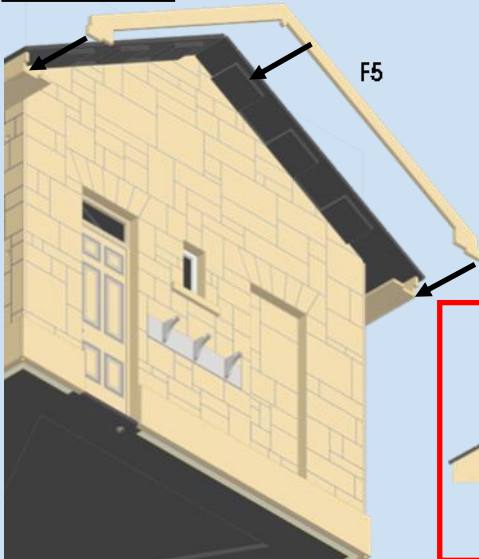

55

F3 Tile A



56

F3 Tile D

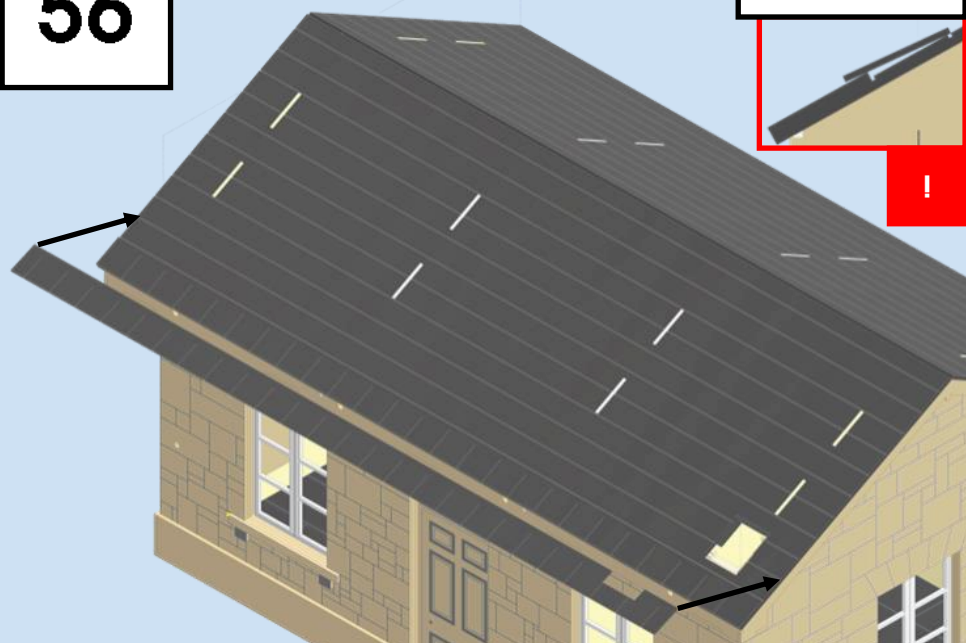

57

**Repeat with F3 Tiles
E,F,C,B,C,B,C,B & G**



58

F4 Tile A



59

F4 Tile B

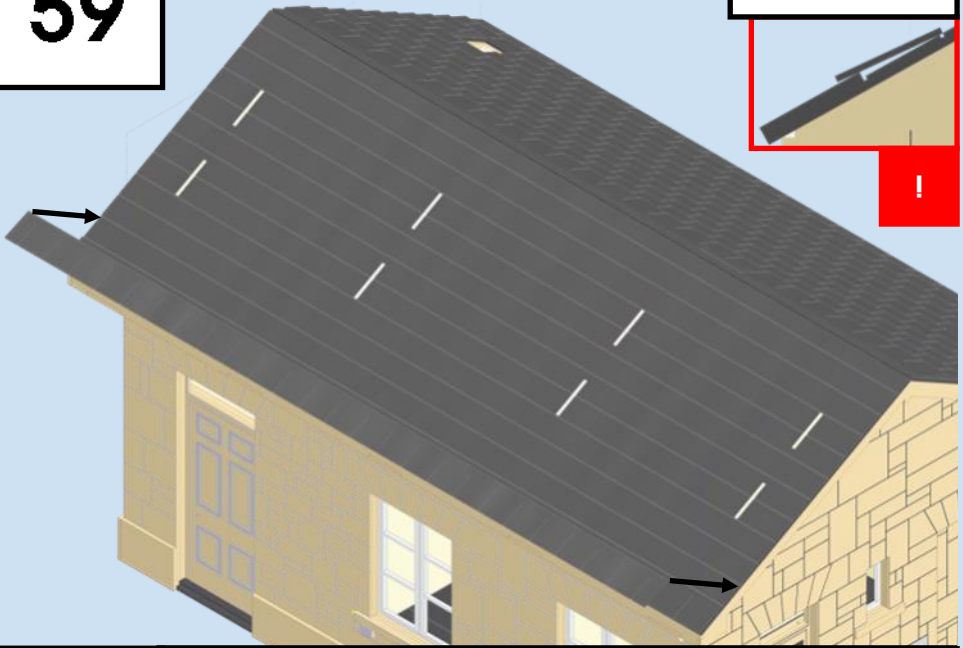

60

**Repeat with F4 Tiles
C, B, C, B, C, B, C, B, & G**

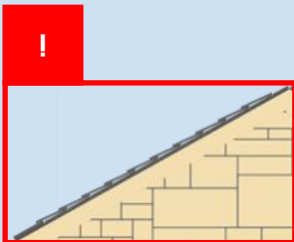

61

Tiles H

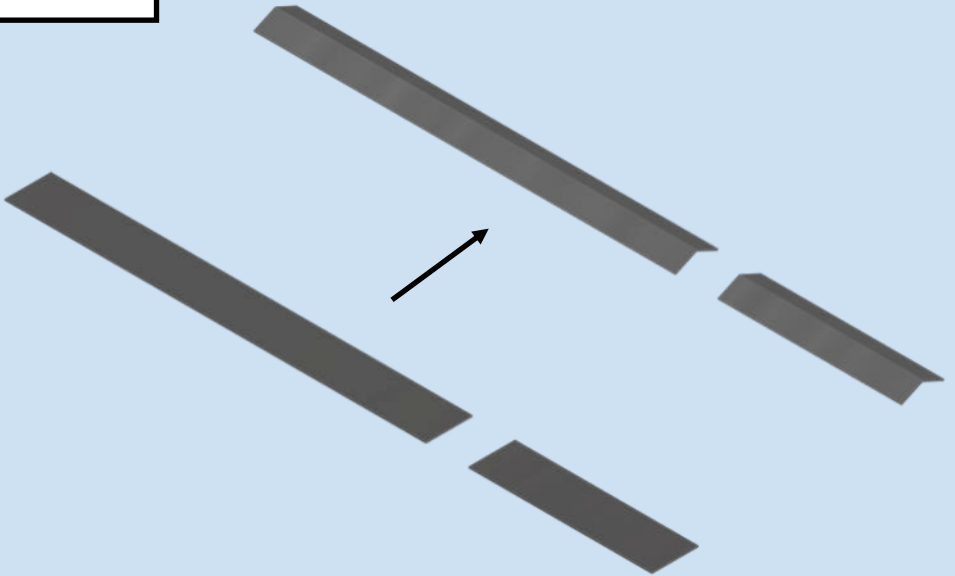

62

Tiles H

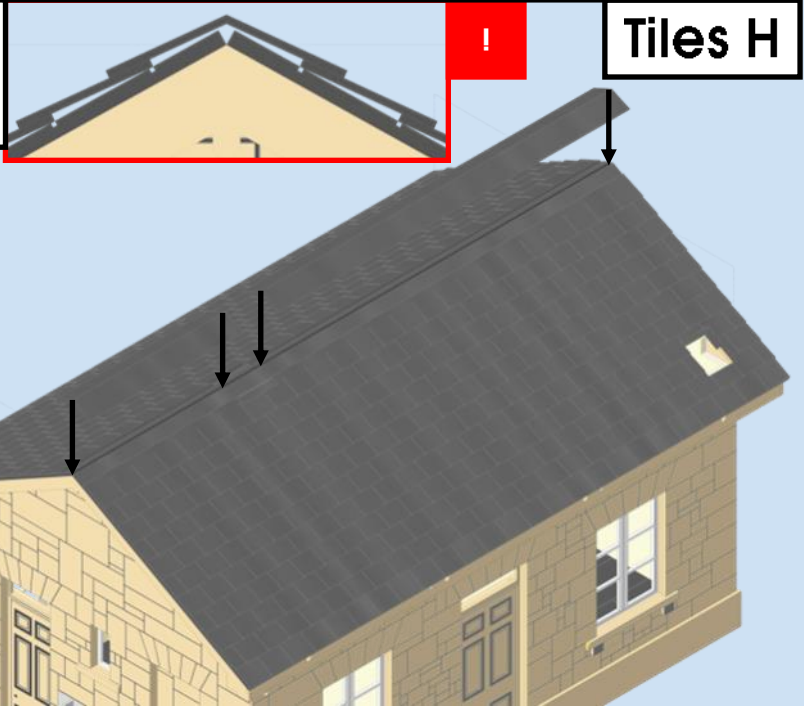

63

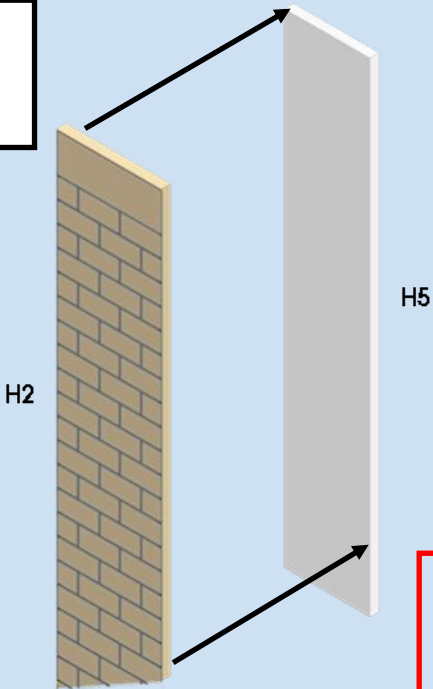

H2 & H5

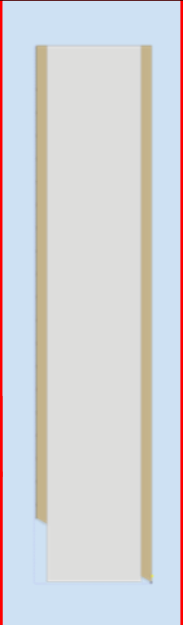

64

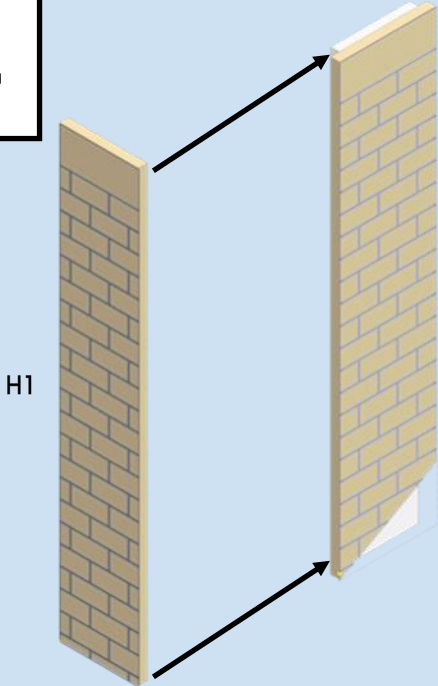

H1

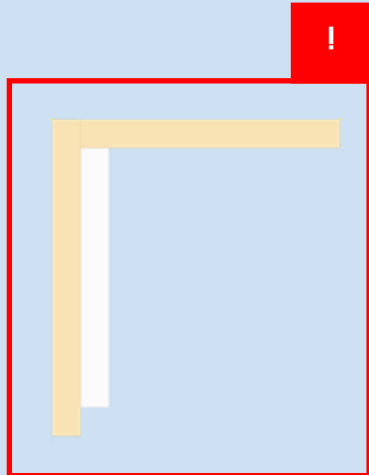

65

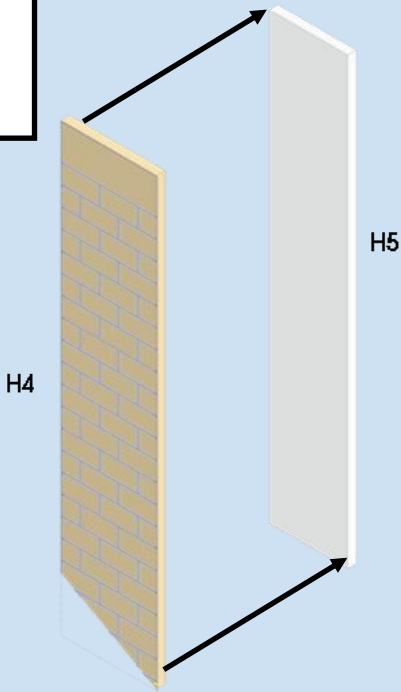

H4 & H5

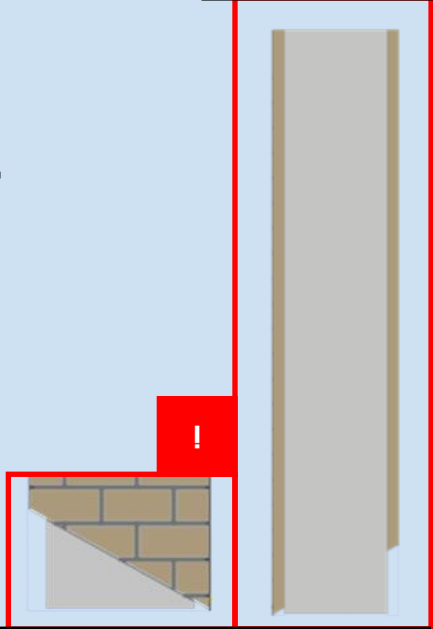

66

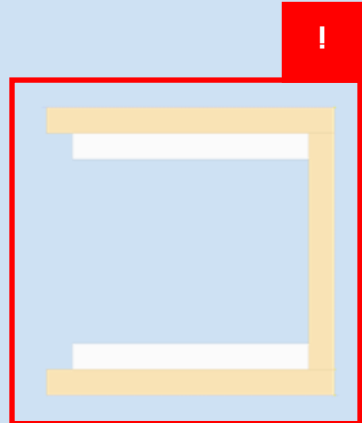
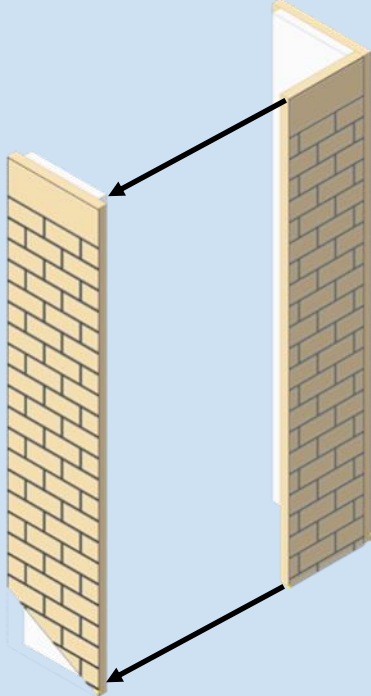

67

H3

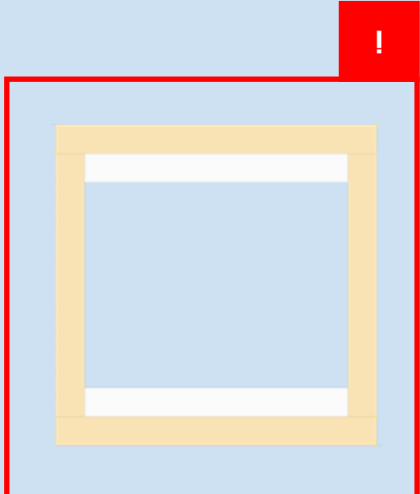
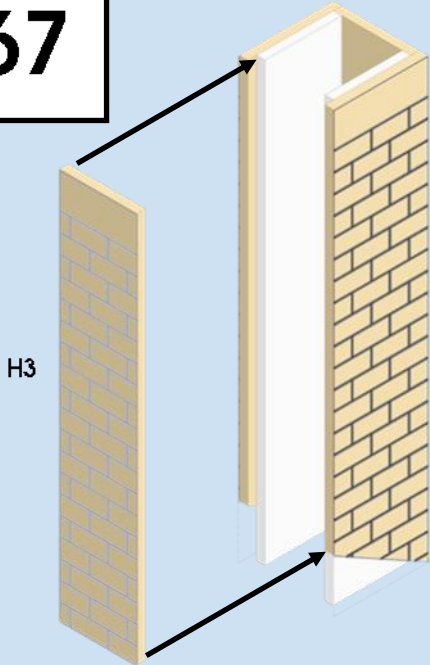

68

H6(x2) & H7

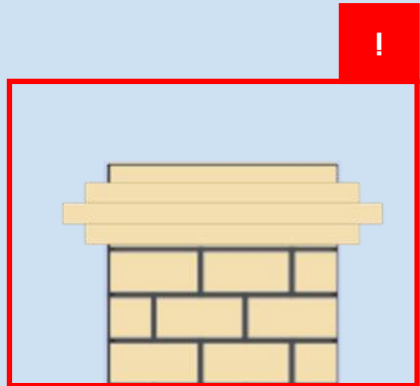
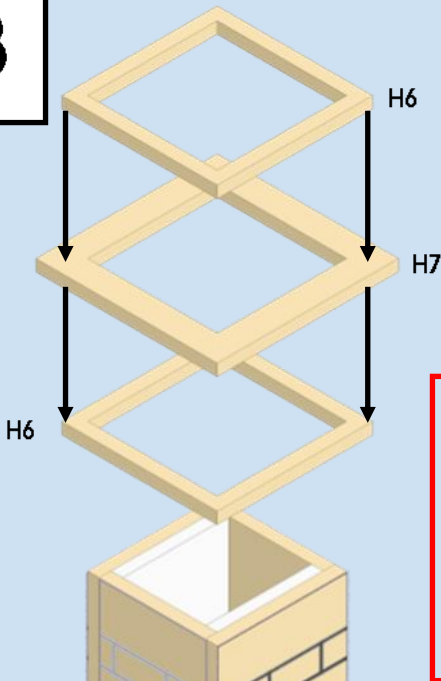

69

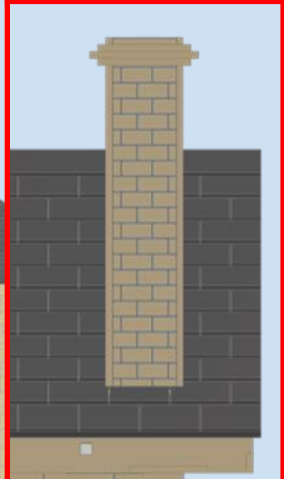
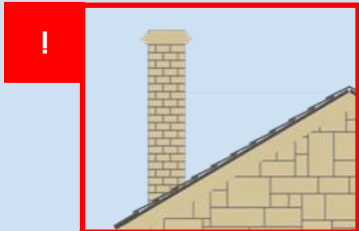

70

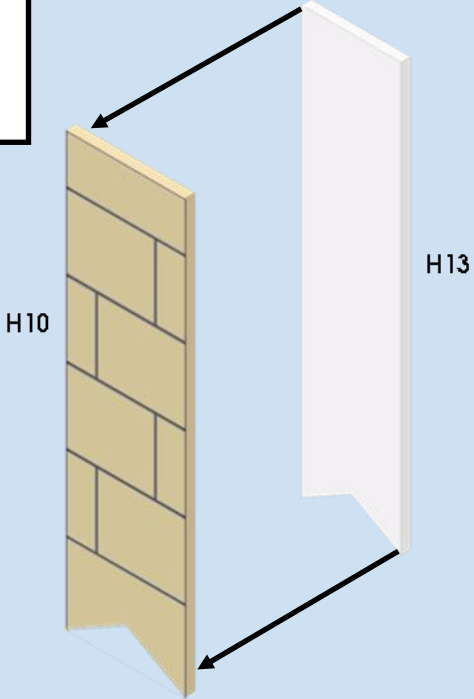

H10 & H13

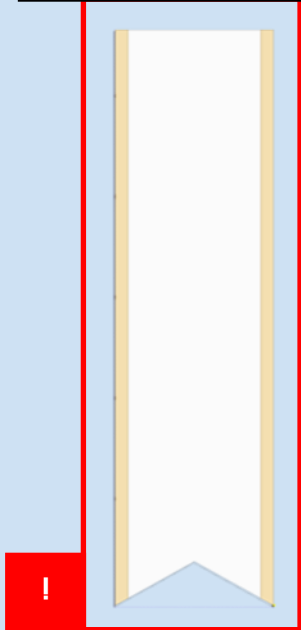

71

H9

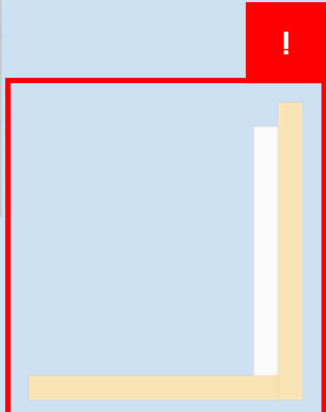
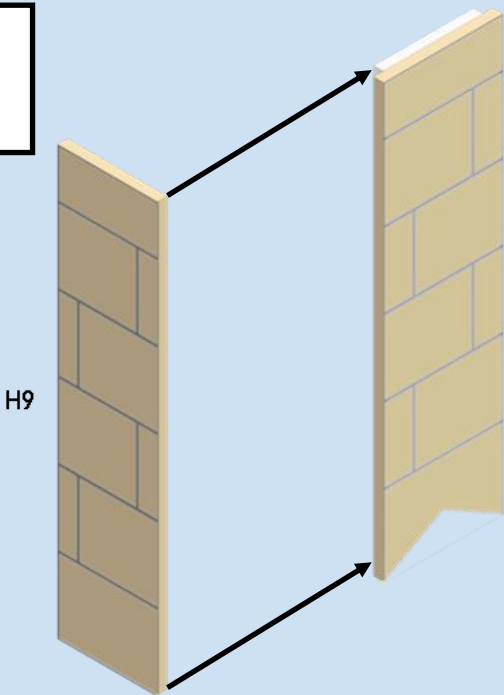

72

H12 & H13

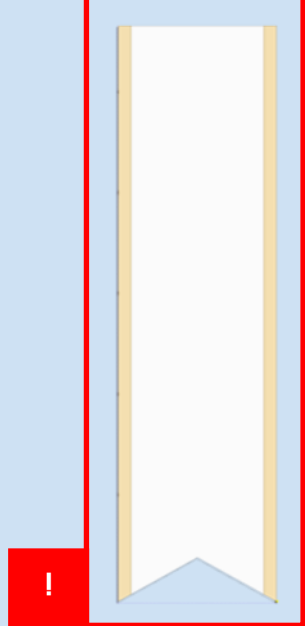
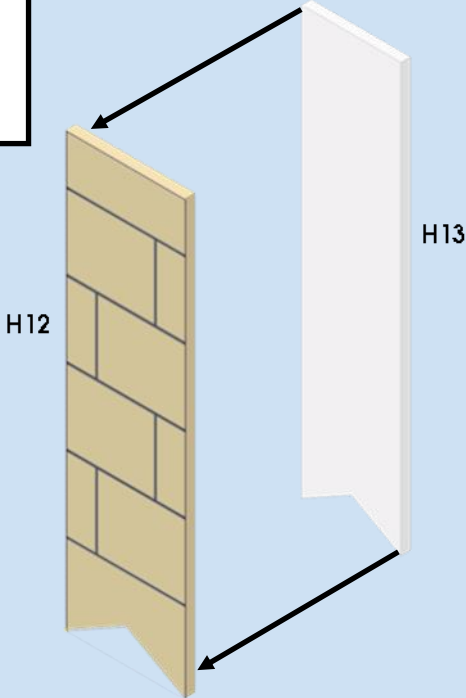

73

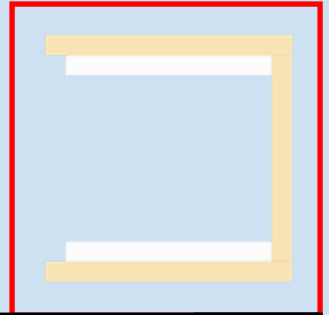
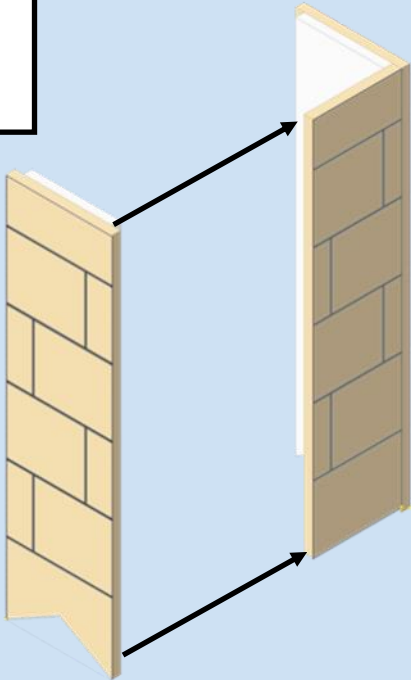

74

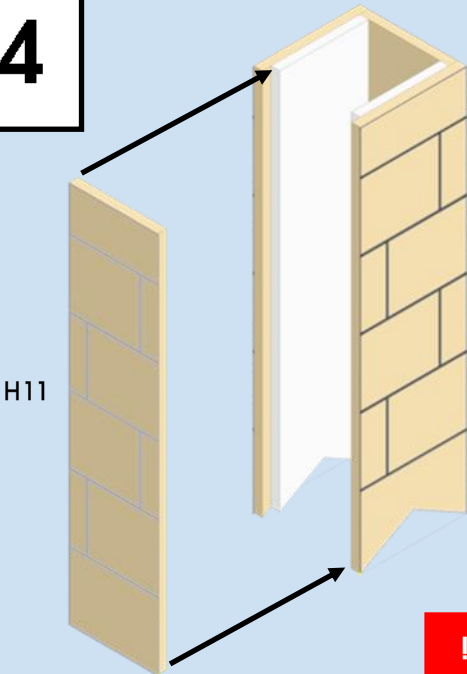

H11

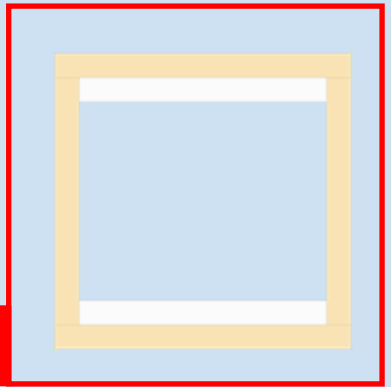

75

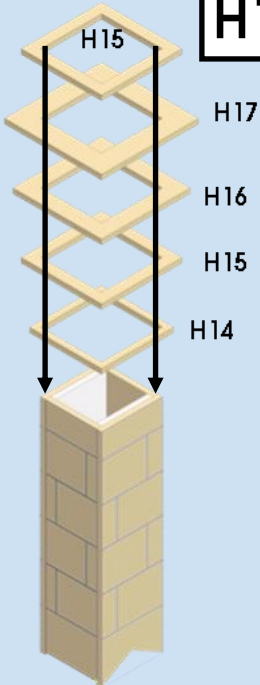

H14, H15 (x2), H16 & H17

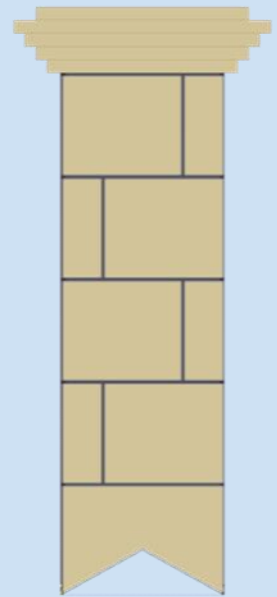

76

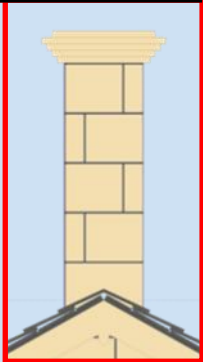

77

H18

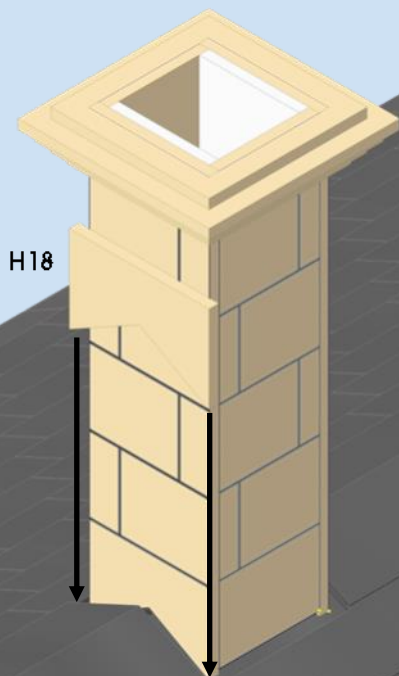

78

H18

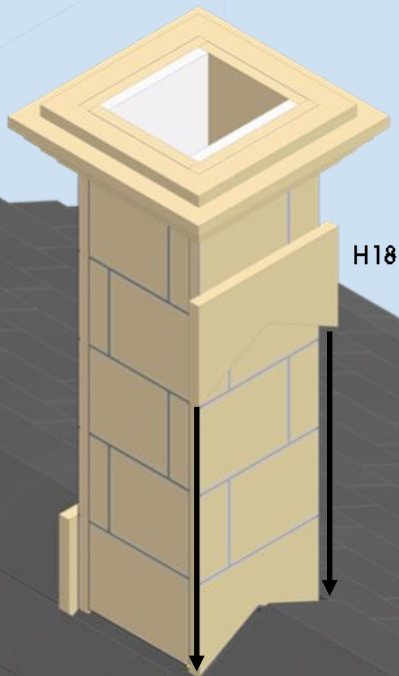

79

H19

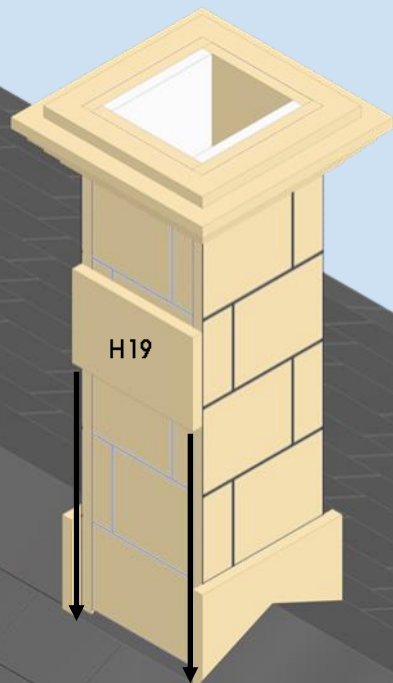

80

H19

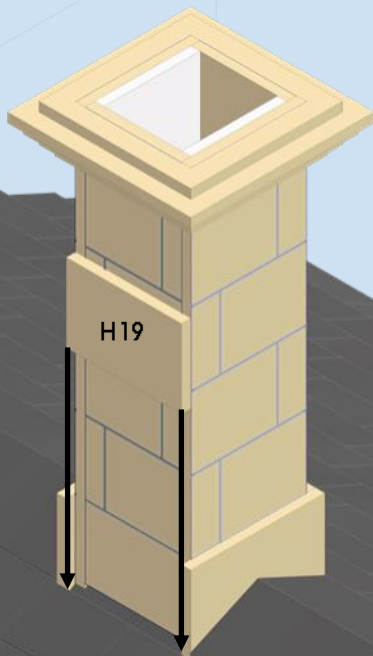

81

G1

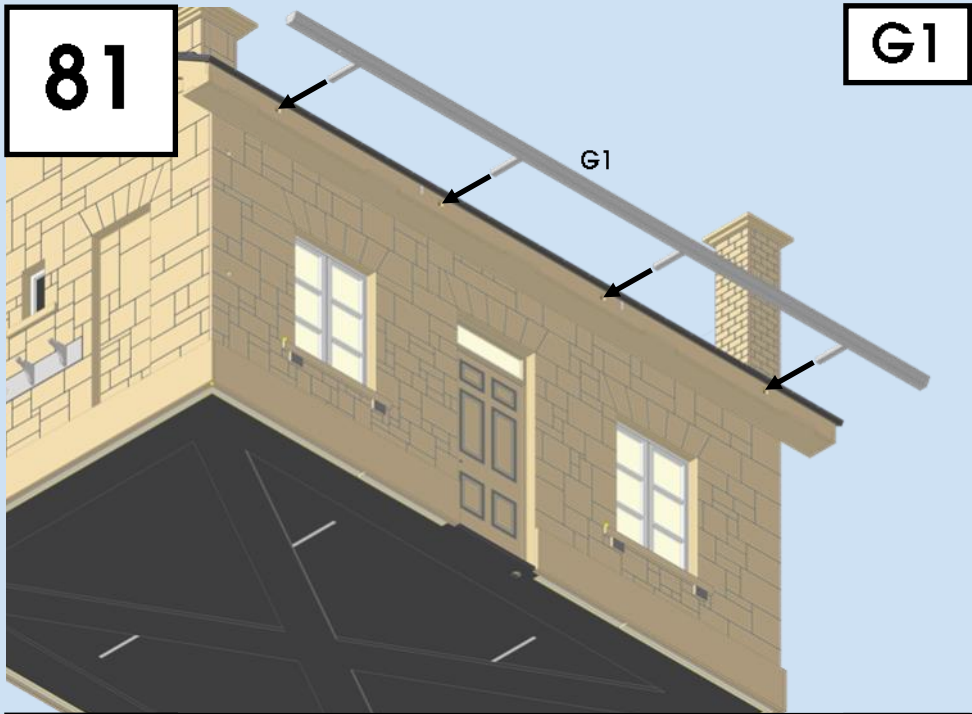

82

G2

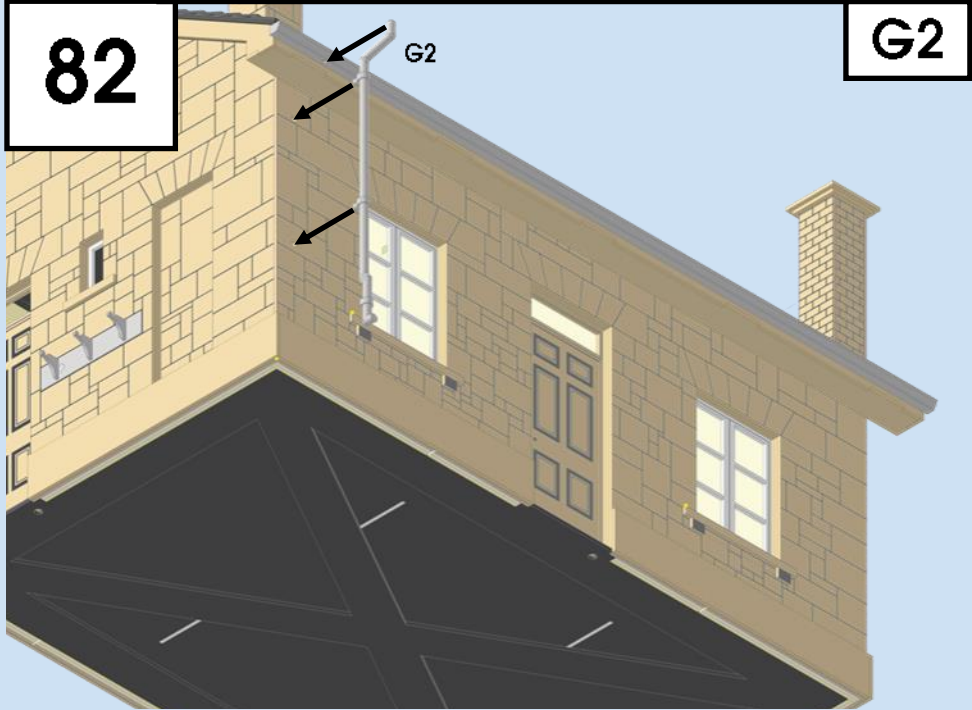

83

G3

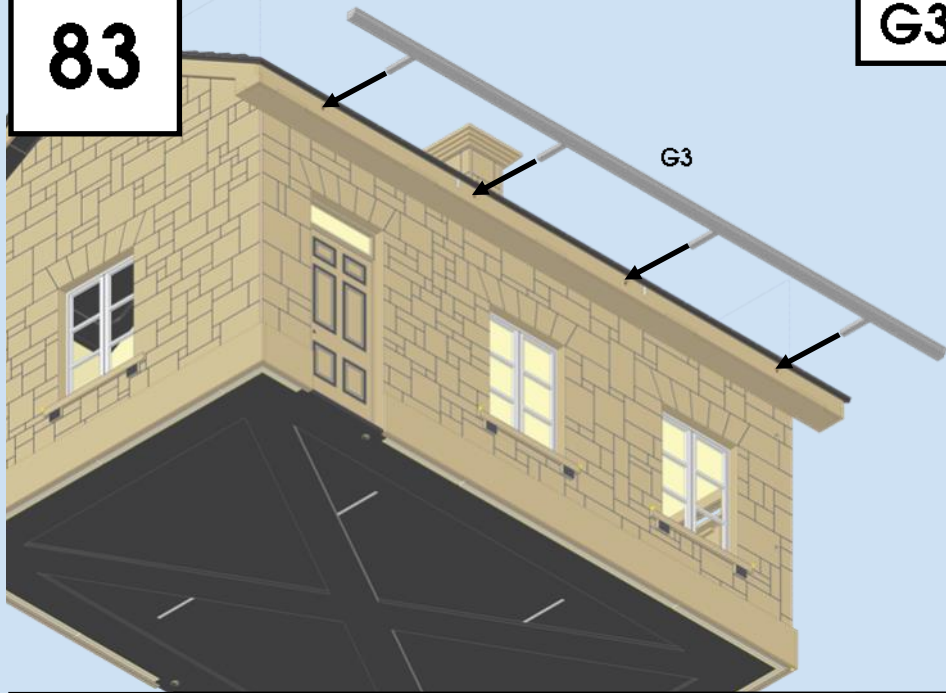

84

G2

