

# BougeRV

## 1120Wh Portable Power Station User Manual

# LiFePO<sub>4</sub>

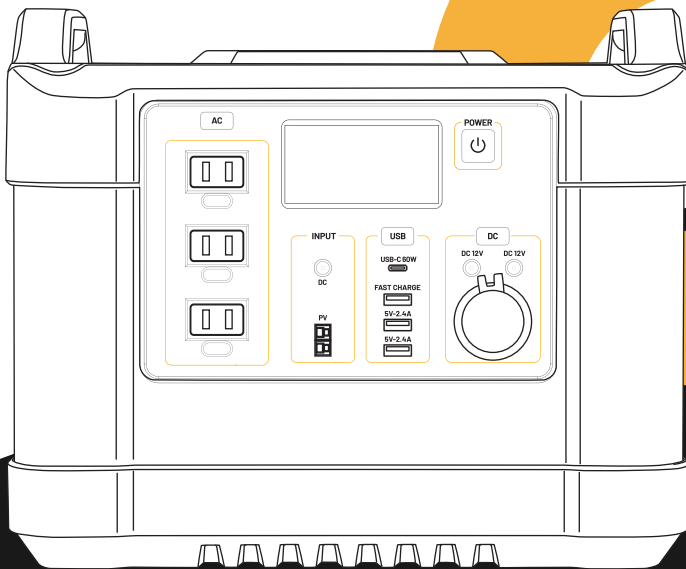



# **Warranty**

## **Limited Warranty**

BougeRV provides a one-year warranty for customers who purchase on Amazon and the BougeRV official website.

## **Warranty Period**

The warranty is measured starting on the date of purchase by the original purchaser. In order to establish the start of the warranty period, the purchaser must provide a screenshot of the order from amazon or the website.

## **Tips**

If there is any problem with the product, you can provide us with pictures and videos for identification. After the confirmation of the technicians, we will provide return and exchange services with you.

## **CUSTOMER SUPPORT**



[service@bougeRV.com](mailto:service@bougeRV.com)



1-669-232-7427  
Sun-Thu 6PM-12AM(PST)



[www.bougeRV.com](http://www.bougeRV.com)



# Exclusions

## **BougeRV's warranty does not apply to:**

- Product damage caused by the consumer not following the recommendations.
- Damage by disassembling the machine without authorization or going to a non-designated maintenance spot for maintenance.
- Products purchased neither on Amazon nor BougeRV's official website.
- This limited warranty does not apply to any battery cell or product containing a battery cell unless the battery cell has been fully charged by you within seven days after your purchase of the product and at least once every 6 months thereafter.

# Table of Contents

Product Safety Guidelines	-----	1
Specifications	-----	3
Product Description	-----	4
Operating Instructions	-----	5
Smart Display	-----	6
AC & Car & PV Solar Charging	-----	7
Faster Charging	-----	8
Error Code & Troubleshooting	-----	9
Package List	-----	11
FAQs	-----	12





# Product Safety Guidelines

## Product Use:

1. DO NOT expose the product to any liquids. Do not immerse the product in water. DO NOT leave the batteries out in the rain or near a source of moisture. Moisture in the device could cause short circuits, component failure, fires, or even an explosion.
2. Using the product in environments above 140°F (60°C) may cause fire or explosion. Using the product in environments below 32°F (0°C) will severely affect the performance of the product. Allow the product to return to a normal operating temperature before use it.
3. DO NOT use the batteries in strong electrostatic or electromagnetic environments. Otherwise, the battery of the control board may malfunction and cause a serious accident during use.
4. Avoid collision. DO NOT place heavy objects on the machine.

## Product Charging:

1. Always use BougeRV approved charging cables. BougeRV does not take any responsibility for any damages caused by using non-BougeRV charging cables.
2. When charging, please place the product on the ground with no flammable or combustible materials around.  
To prevent accidents, never leave the machine unattended during charging.
3. DO NOT charge the product immediately after a long heavy load, because the product temperature may become too high. DO NOT charge the product until it cools down to room temperature.

## **Product Storage and Transportation:**

1. If a low-battery warning appears, charge the product before storing it. Otherwise, long-term storage may cause damage to the batteries in the product. Batteries in the product will enter hibernation mode if they are depleted and stored for a long time. Recharging the product can bring the battery out of hibernation.
2. DO NOT place the product near a heat source, such as a car in direct sunlight, a fire source, or a heating stove.
3. Store the product in dry environments. Please keep the machine away from water.

## **Product Maintenance:**

1. The temperature for normal use and storage of this product is 68°F to 86°F (20°C to 30°C) Cold temperatures (below freezing) can affect the unit's battery capacity due to the chemical characteristics of the battery. Keep the power station within the environment temperature range, 32 to 105°F (0 to 40°C) to prolong battery life.
2. If the product is not used for a long time, the battery life may be reduced.
3. Discharge BougeRV G1000 to 30%, then charge to 85% every 6 months to keep the battery healthy.

## **Travel Notice:**

Do Not bring this product on flights.



# Specifications

## General Info

Weight	<b>13kg/28.7Lbs</b>
Dimensions	<b>12.6*9*11.4 in</b>
Capacity	<b>1120Wh/22.4V,50AH</b>
Certification	<b>UN38.3,FCC,PSE,ROHS,CE</b>

## Output Ports

AC (×3):	<b>Pure Sine Wave, 1200W total</b>
USB-A (×2)	<b>5V/2.4A, 12W</b>
USB-A QC3.0 (×1)	<b>5V/3A, 15W; 9V/2A, 18W</b>
USB-C (×1)	<b>5/9/12/15/20V,3A 60W Max</b>
Cigarette Port & DC5521 (×2)	<b>12V, 10A 120W Max Total</b>

## Input Ports

DC5521 Charge	<b>25V, 8A 200W Max</b>
PV Solar Charge	<b>12-30V, 8A 200W Max</b>
USB-C Charge	<b>20V, 3A 60W Max</b>

## Battery Info

Cell Chemistry	<b>LiFePO<sub>4</sub></b>
Cycle Life	<b>3500+ Cycles,80% Capacity</b>

## Environmental Operating Temperature

Operating Temperature	<b>32°F to 105°F</b>
Discharge Temperature	<b>14°F to 113°F</b>
Charge Temperature	<b>32°F to 113°F</b>
Storage Temperature	<b>68°F to 86°F</b>

# Product Description

Handle

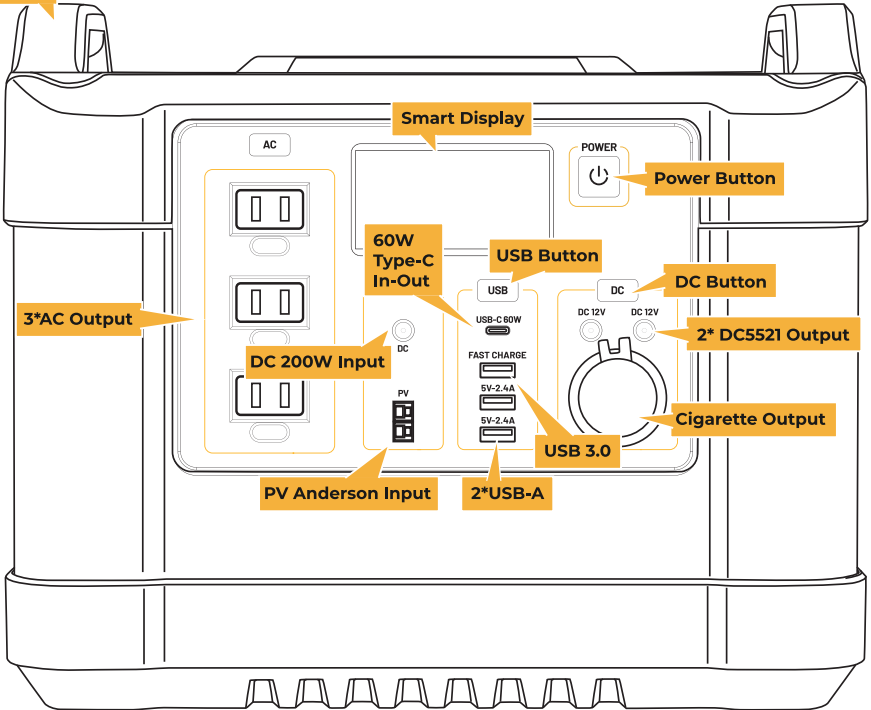

# Operating instructions



Power Button - Press 2s to turn off all output. Press 10s to reset the unit when you cannot eliminate the error code.

Press 2s to turn on/off the inverter.



When the AC output power is lower than 5W for up to 3 hours, the inverter will automatically turn off to save energy.



Press 1s to turn on/off the modules.



Circuit Frequency Change



1. Turn on the AC port firstly, and press the USB & DC button for 2s at the same time.



2. Short press the DC button to switch when you see the digit number of Circuit Frequency flashing at this time.



3. Press the USB & DC buttons simultaneously again for 2s to confirm the change (after the confirmation, the AC port will turn off automatically).

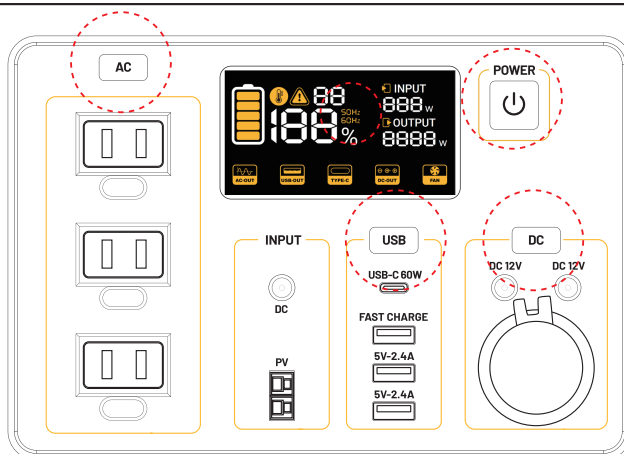

## Tips

1. Pressing one of these four buttons 0.5s could wake up the display.
2. The display will automatically turn off after detecting no output for 10s.
3. When the power station detected the input/output power, the display will be always light up. You can short press the power button to turn off/on the display.

# Smart Display

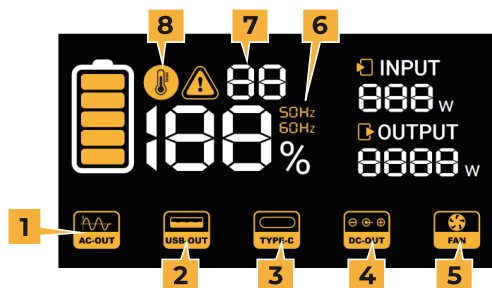

1



It lights up when the AC port starts working.

2



It lights up when the USB-A & USB 3.0 ports start working.

3



It lights up when the Type-C port starts working. The Type-C port supports both input and output.

4



It lights up when the DC & Cigarette ports start working.

5



It lights up when the power station is over 104 °F or out-power is over 110W, and the fan starts working to cool it down.

6



It lights up when the Circuit Frequency is switched manually.

7



It lights up when the power station is faulty and the corresponding error code will be displayed.

8



It lights up when the power station is over 140 °F. Please turn off the AC output port.

# AC & Car & PV Solar Charging



**PV Solar Charging**  
200W Input, 5.5H Full Charge

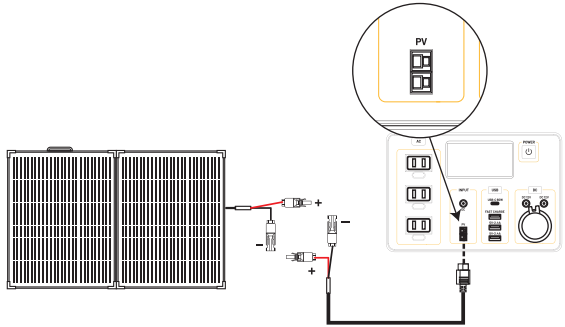

**AC Charging with adapter**  
200W Input, 5.5H Full Charge

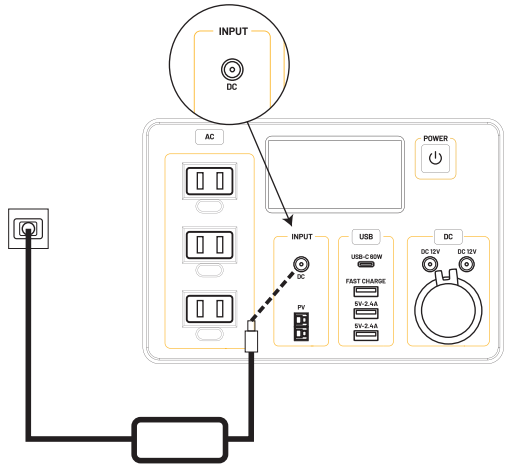

**Car Charging**  
120W Input, 9H Full Charge

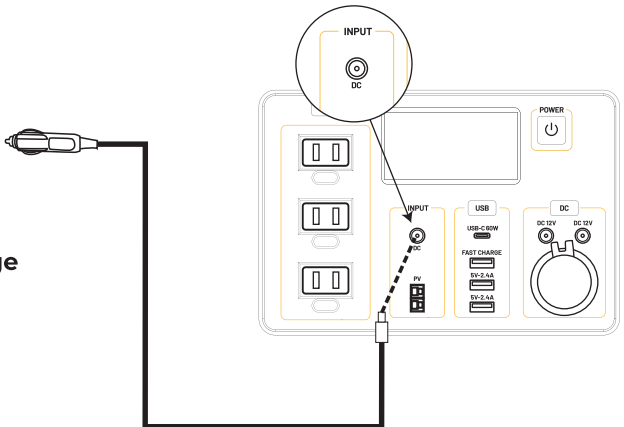

# Faster Charging

## AC Input+USB-C Input, < 5H Full Charge

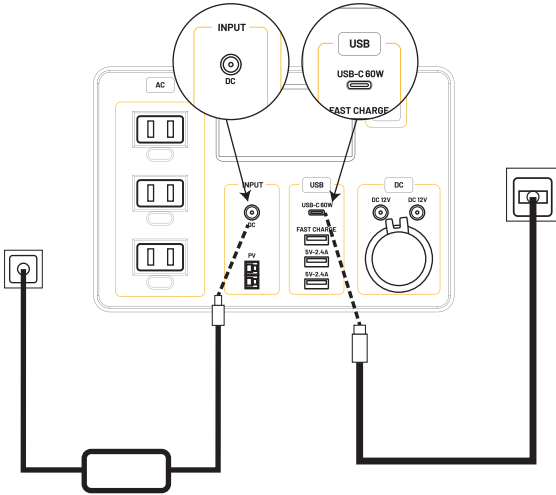

## PV Input+USB-C Input, < 5H Full Charge

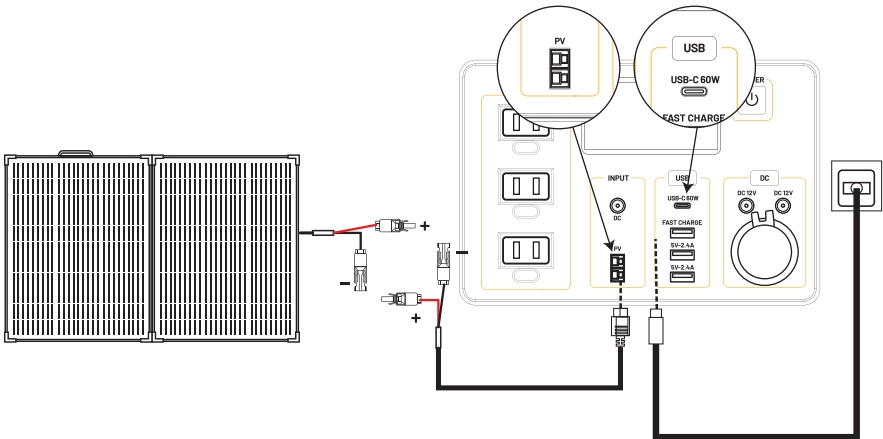

**Note:** Using USB-C charging can help you shorten the charging time. According to different charging protocols, you can get input power in the range of 0-60W.

# Error Code & Troubleshooting



<b>Error Code &amp; Troubleshooting</b>		
<b>Error Code</b>	<b>Explanation</b>	<b>Troubleshooting</b>
01: USB Short circuit protection	There is potentially a short circuit inside your device or the power station.	Please plug out the device firstly, press the USB button 2s to eliminate it.
02: QC Fast Charge Short Circuit Protection		Please plug out the device firstly, press the USB button 2s to eliminate it.
03: DC Short Circuit Protection		Please plug out the device firstly, press the DC button 2s to eliminate it.
04: AC Inverter Short Circuit Protection		Please plug out the device firstly, press the AC button 2s to eliminate it.
05: AC Inverter Overload Protection	The rated power of electrical appliances over 1200W	Do not use electrical appliances with a rated power over 1200W, including large hot water boilers, microwaves, etc. Please plug out the device firstly, press the AC button 2s to eliminate it.
06: AC Inverter High Temperature Protection	The inverter will automatically cut off the output if the temperature exceeds 80°C/176°F	Press the AC button 2s to eliminate it. It is recommended to use G1000 at an ambient temperature of 32°F to 105°F

## Error Code & Troubleshooting

Error Code	Explanation	Troubleshooting
07: Battery High Temperature Protection (Output)	The output will be cut off when the battery temperature is over 63°C/145°F	Press the AC button 2s to eliminate it. Let the G1000 stand for a period of time until the temperature drops, it can output normally
08: Battery Low Temperature Protection (Output)	The output will be cut off when the battery temperature is below -10°C/14°F	Press the AC button 2s to eliminate it. Put the G1000 in an environment above 0°C/32°F, it can output normally
09: Battery High Temperature Protection (Input)	The input will be cut off when the battery temperature is over 47°C/117°F	Automatically restart charging when the temperature is below 47°C/117°F
10: Battery Low Temperature Protection (Input)	The input will be cut off when the battery temperature is below -3°C/27°F	Automatically restart charging when the temperature is over -3°C/27°F
11: Input Over-voltage Protection	Automatically cut off the input when DC & PV input voltage over 30V	We recommend that you use the original AC adapter to charge; when PV charging, we recommend you use ≤ 200W solar panels
12: Battery High-voltage Protection	The battery voltage is over 26V, and the SYZ-G1000 cannot be charged normally.	Stop charging and contact our customer service to confirm the error code.
13: Battery Low-voltage Protection	The voltage will drop when the battery capacity is low, and the output will be cut off when the voltage is below 18V	It is recommended to charge the battery in time when the battery capacity is less than 10%; when the battery capacity is low, we recommend you not to use low-power DC appliances for a long time

**Tips: If you cannot solve the corresponding fault according to our guidelines or you find the fault is not included in the error code list, please feel free to let us know via email or a phone call.**



# Package List

Check the packaging and make sure you receive all accessories. If any of these are missing, please feel free to contact us via [service@bougeRV.com](mailto:service@bougeRV.com)

1- BougeRV SYZ-G1000\*1

2- Car Charging Cable\*1

3- AC Charger\*1

4- Solar Charging Cable\*1 ( MC4 to Anderson )

5- User Manual\*1



①



②



③

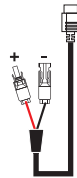

④



⑤



### **Q1: Can the SYZ-G1000 be charged while using?**

A: Yes, the SYZ-G1000 supports pass-through charging, but it will decrease the battery life, so we suggest you don't do that.

### **Q2: How long can the SYZ-G1000 power my device?**

A: You can use the formula to calculate:  $1120\text{Wh} * 0.9 / \text{operating power of your device}$ . The duration of our equipment is based on laboratory data, and the duration of specific equipment used may vary.

### **Q3: What should I do if I want to use the car cigarette port to charge the SYZ-G1000?**

A: You can use the Car Charging Cable (cigarette to DC5521) we provided to charge the SYZ-G1000, and the Max input power is 120W.

### **Q4: Where can I find any details (videos & FAQs) about the operation and use of SYZ-G1000?**

A: You can find more information about the product on our YouTube account or official website (YouTube: BougeRV, Website: bougeriv.com)

### **Q5: What matters should I pay attention to in daily use?**

A: • Please keep SYZ-G1000 fully recharged at least once a month, 0%-100%.

• Please recharge SYZ-G1000, when the capacity on the display is less than 20%.

• Ensure that the operating temperature of the SYZ-G1000 is within 0-40 degrees.

The low and high temperatures will cause a reduction in battery life.

• Please ensure that the storage environment of the SYZ-G1000 is dry and stay away from direct sunshine and flammable sources.

## **Limited Warranty**

BougeRV provides a one-year warranty for customers who purchase on Amazon and the BougeRV official website.

## **Warranty Period**

The warranty is measured starting on the date of purchase by the original purchaser. In order to establish the start of the warranty period, the purchaser must provide a screenshot of the order from amazon or the website.

## **Tips**

If there is any problem with the product, you can provide us with pictures and videos for identification. After the confirmation of the technicians, we will provide return and exchange services with you.

# BougeRV



---

[service@bougerv.com](mailto:service@bougerv.com)



1-669-232-7427  
Sun-Thu 6PM-12AM(PST)



[www.bougerv.com](http://www.bougerv.com)