

XODO®



WiFi Smart Power Strip

WP4 User Manual

Welcome

Thank you for purchasing Xodo Smart home products!

We are committed to bringing you excellence with smart technology products that make life more comfortable, convenient, and provide a more dynamic healthy lifestyle.

General Notice

Always make sure to follow safety instructions.

- Do not use products if they have become damaged.
- Follow instructions and only operate products in a safe environment.
- Do not operate electronics in wet conditions. Doing so may cause property damage, bodily harm or electrocution.
- Do not disassemble or alter the product. Doing so will void the warranty.

Table of Contents

Welcome	1
Package Contents	2
Specifications	3
Xodo Smart App	4
Configure the Power Strip Settings	10
Link Google Home	11
Link Alexa	13
Customer Service and Tech Support	15

What's included in the box

You will find the following contents included inside the product package.



WiFi Smart Power Strip



User Manual

Product Features

Your smart home power strip has the following features:

- USB Charging
- Control of each socket
- Scheduled on/off
- Timer Setting
- Remote monitoring
- Amazon Alexa Compatible
- Google Home Compatible

Specifications

Product Name: Xodo WiFi Smart Power Strip

Model: WP4

Voltage: 100V-240V AC 50Hz-60Hz

Max Current: 10A

Dual USB Port: 5V/2A

Max Power: 1100W

Output Port: 4 AC (US)

USB Port: 5V/2.1A

Support System: Android or IOS

WiFi: 802.11 b/g/n 2.4GHz

Smart Power Strip Introduction

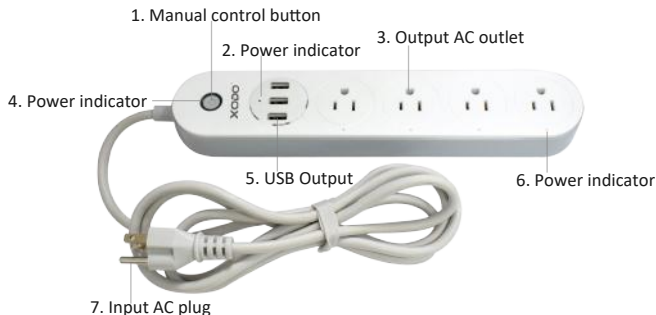

WiFi Smart Power Strip Components

Button — Press to turn on/off the Plug. Hold button to reset.

USB Output — Charging via USB

Output AC plug — Charging via charger

Input AC plug — Plug in a normal socket

Indicator Light

Blinking blue: Ready to configure

Blue light on: Power is ready

Blue light off: Power outlet is off

Download and Install the Xodo Smart APP

Download and install the APP. It can be also be found by searching "XODO Smart" by Contixo Inc. in the App Store (for IOS) or Google Play Store (for Android).



Xodo Smart

Open the APP

The welcome screen will appear and then you will be asked to login or register a profile. Register an account by entering your email address and setting up a profile or logging in with an existing account.

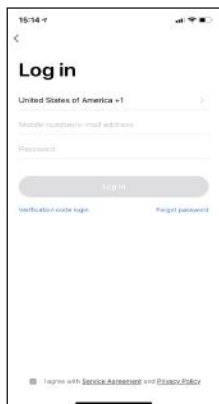

Adding Devices

You will be able to manually add a device. Select Strip to continue.

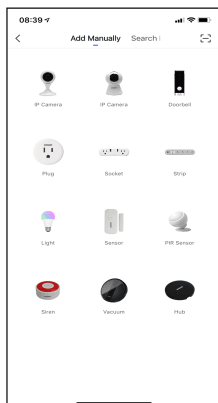
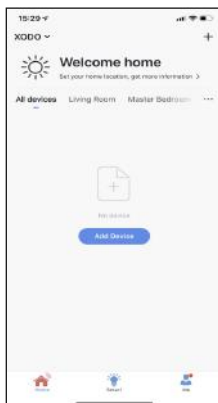

Detecting Device

When detecting devices manually, power on the device and confirm the indicator light is blinking rapidly (Hold the reset button for 10 seconds, the indicator light will blink twice per second. If the indicator flashes every two seconds, please hold the reset button for 10 seconds again.). Once you confirm the smart device is ready, press the “Confirm indicator rapidly blink” button. Continue on to the next step. Pressing the “Help” button will offer some troubleshooting guidelines to follow.



Connect to a WiFi network

Now you want to connect the smart device to a local WiFi network. If the proper network is not listed on this page, select the "Change Network" link to see a list of available networks.

Your router may broadcast both 2.4Ghz and 5.0Ghz broadband frequency. Make sure to select the 2.4Ghz Wifi.

Enter your Internet Password and connect to the network.



Connecting

The "Connecting" screen will appear. It will usually register within by approximately 30% range. The Device found will checkmark green, then Initializing device will complete. After connecting process completes it will continue on toward the next screen.



Confirmation Screen

The smart device is added once they are communicating on the same network. You can rename the smart device by clicking on the pencil icon. You can specify the location. Press the "Done" button at the bottom of screen to continue to next step.

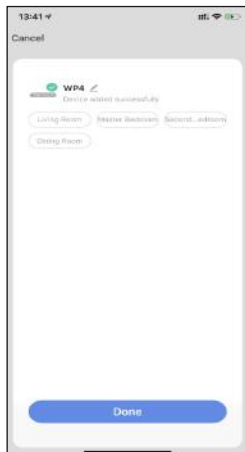

Home Screen Updated

Now that your device has been added, it will show on the home screen along with all other paired Xodo Smart Products. Now you are all set.

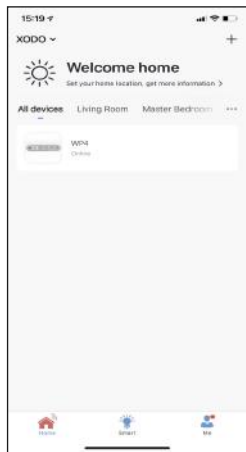

Smart Power Strip Home Screen

The home screen will show the live plug status.

1. Press the control switch on the top left to turn off/on the smart plug.
2. Press the control switch on the right to turn off/on each port.
3. Press the “Count down” button to set countdown on or off.
4. Press the “Alarm” button to set a schedule.

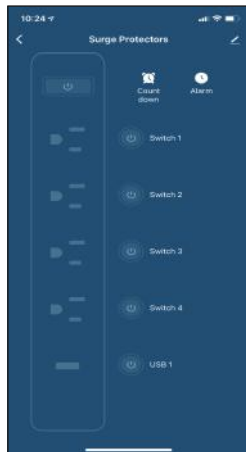

Countdown function

This will keep the sock in ON/OFF position for a specific duration of time.

1. Click "Countdown".
2. Select the switch that needs to be set.
3. First configure the hours (left)
4. Next configure minutes (right)
5. Click "OK" to save the settings.

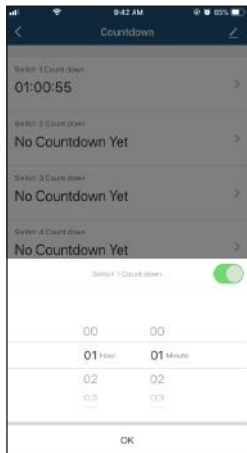

Timer function

This will keep the sock in ON/OFF position for a specific duration of time.

1. Click on "Schedule".
2. Click "Add".
3. First configure the hours (left)
4. Next configure minutes (right)
5. Click "Repeat" and choose the day of the week.
6. Select the state of the switch(ON/OFF).
7. Press HD/SD button to switch image quality.



Configure the Power Strip Settings

Different features can be adjusted from the menu button on the upper right hand button “” on the APP.

1. Device Name can be changed as desired.
2. Device information can check the information of the power strip.
3. Tap-to-Run and Automation allows to check the Smart Automation your device linked with.
4. Upported Third-Party Control provide the information about how to connect your device to Amazon Alexa, Google Assistant and DuerOS.
5. Offline Notification allows to alert you when your device is offline.
6. Add Members to be able to control the device in the Share Device setting.
7. Create Group to control other smart device at the same time.
8. FAQ & Feedback allows users to report issues and get help.
9. Add to Home Screen allows to add the power strip to the home screen of your smartphone.
10. Check Device Network allows to check the network connection status.
11. Firmware Information allows to check software or install updates to device.
12. Remove device will remove the smart strip from the Xodo Smart app and remove pairing. This is necessary if pairing with a new device.
13. Restore Factory Defaults allows to reset the Surge Protector to factory setting.

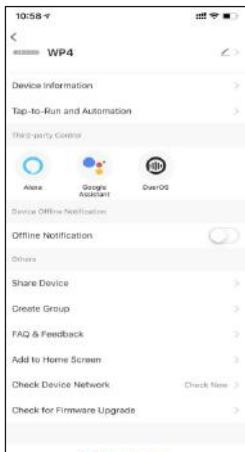

Link Xodo Smart account to Google Home Screen

1. Open Google Play Store or Apple Store and download Google Home
2. Open the Google Home app. Click on Get Started.
3. Login with a Google Account or create a new account.

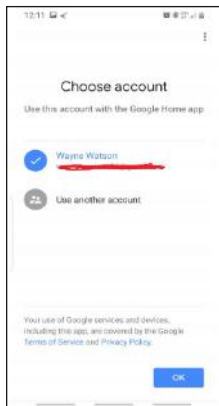
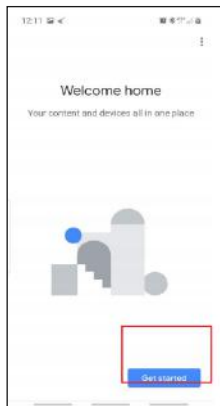
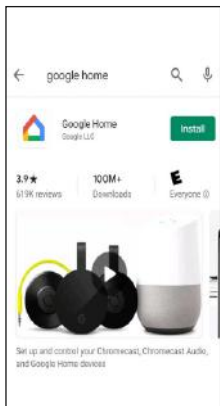

4. Use Location access to find devices on the same wifi network.
5. You will need to permission so Google Home can access device.
6. The app will search for devices to connect.

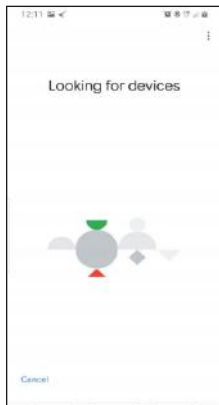
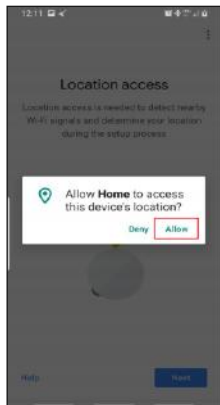
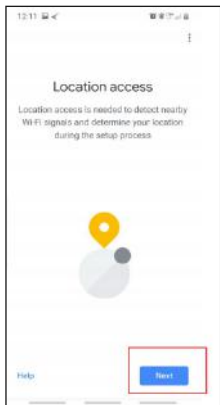

7. If no devices can be found that are already setup, select NO.
8. A youtube video is available to help instruct how to use smart devices.
9. The app will show settings to add devices, setup routines, and adjust settings.

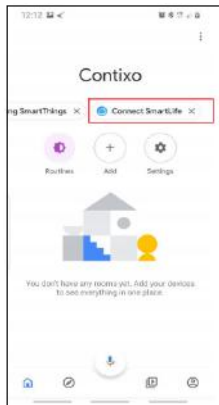
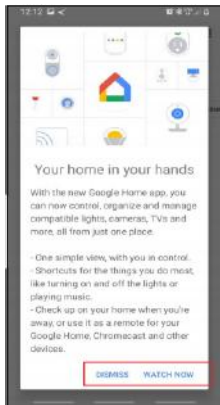

10. If the devices are already installed and setup through the Xodo app, you can select the "Works with Google" setup option to continue.
11. Configure the home settings by adding address and name to a "Home" group.

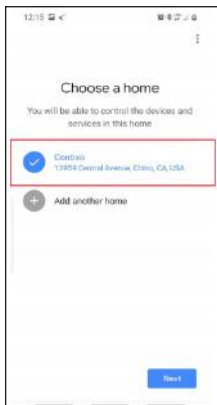
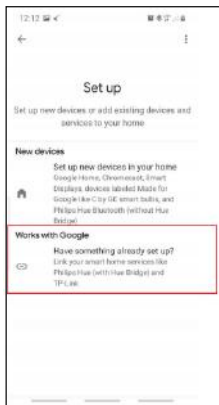

Control your smart devices through Google Home

Now you can control your smart devices through Google Home. Take bedroom light as the example, the supported voice commands are as below:

1. Ok Google, turn on/off bedroom light.
2. Ok Google, set bedroom light to 50 percent.
3. Ok Google, brighten bedroom light.
4. Ok Google, dim bedroom light.
5. Ok Google, set bedroom light to red.

Link Xodo Smart account to Alexa

1. Download the free Alexa app from the Amazon Appstore, Google Play, or the Apple App Store.
2. Open Alexa app to home screen
3. In upper left hand corner open the menu.
4. Next click on "Skills & Games"
5. In top of app you can now search for "Smart Life"
6. Smart Life App will appear.

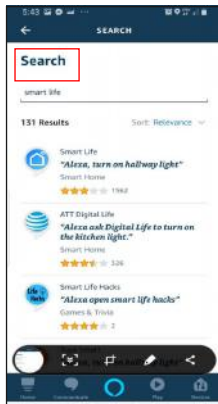
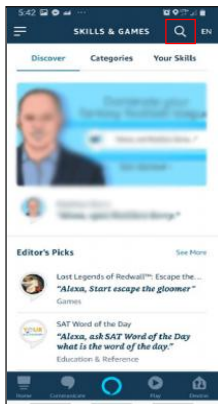
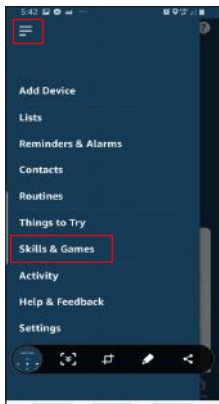

- Open the smart life app to add
- Click Settings
- Manage Smart Home Devices to verify Smart Life has been added.

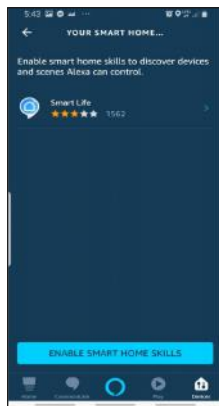
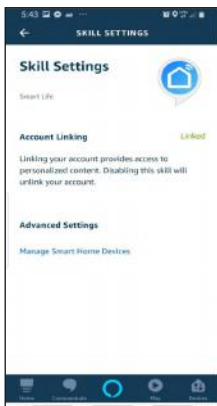
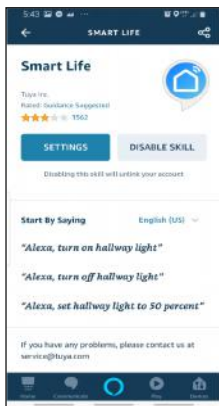

- You will be redirected to the account link page. Type in your Xodo Smart account and password, don't forget to select the country/region where your account belongs to. Then tap "Link Now" to link your Xodo Smart account. The country/region, the account, and the password must match.

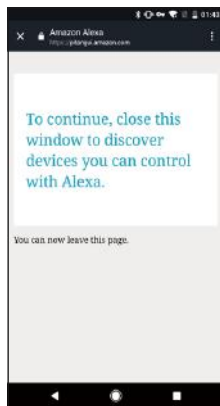

Customer Service and Tech Support

Your satisfaction is important to us. We are here to help!

Contact us at support@contixo.com

Include your order number and product description.

See our website for more products www.contixo.com

We enjoy your feedback!

Xodo is a subdivision of the Contixo Inc. group., and the respective logos are registered trademarks of Contixo Inc. and may not be used, reproduced, or altered without written Permission. All other trademarks are the property of their respective owners and used with permission.

To find the latest revision of this publication, visit our website at www.contixo.com