

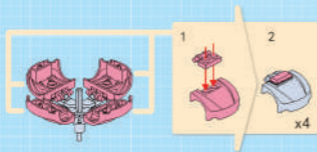

A AMAZING NEW SERIES OF FLOWER
GORGEOUS BOUQUET
655002

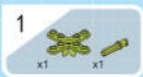

7



8

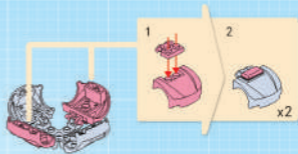
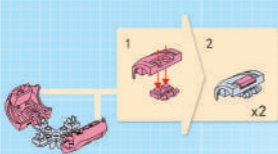

9

8

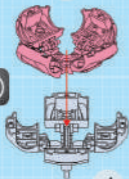

10



11



-3-

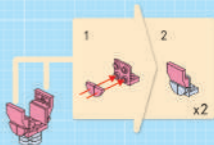

12



13

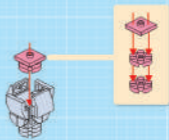

14

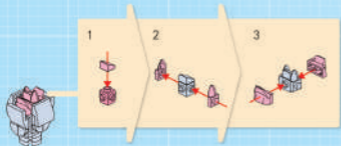
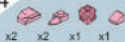

15

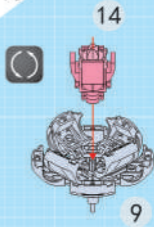

16



x2 x2



x2

17



x2 x4 x2



x2

18



x4 x2 x2



x2

19



x2 x2 x2



x2



3 1:1

20



x2 x2



x2

21



x4 x4



x2



x2

22



23



24

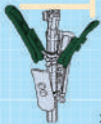

x2



x2

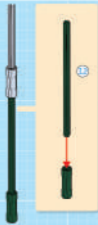

x2

25

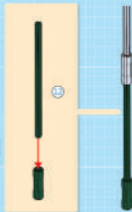

x2

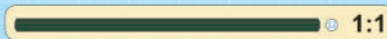

26

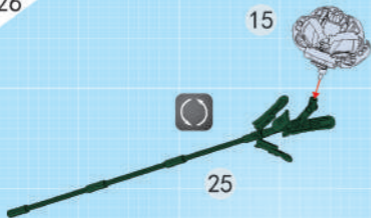

27



28



29



30

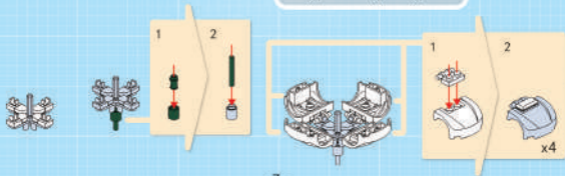

31



32



33



34

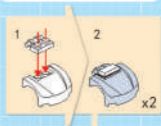
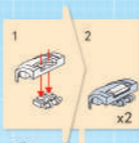

35

34



30

36



-8-

37



38



x2 x2 x2 x4

39



x1 x2

40



x2 x2 x1 x1

1



2



x2



1



2



3



41



35



40

42



25

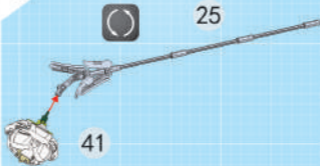

41

43



x1 x1



44



x1

x1



45



x1



46



x5

x5

x5



1

2

x5



47



x3

x3

x3

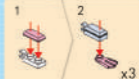

1

2

x3



48



x1

x1



49



x5

x5

x5



1

2

x5



50



x3

x3

x3



1

2

x3

51

50

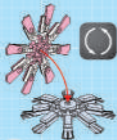

47

52



53



54

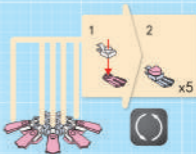

55

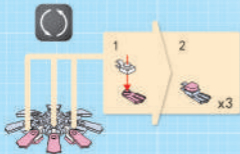

56

55



51

57



58

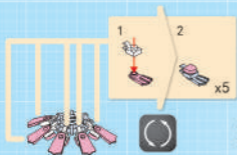

59

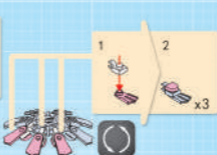

60

59



56

61

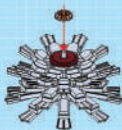

62

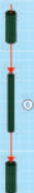

63

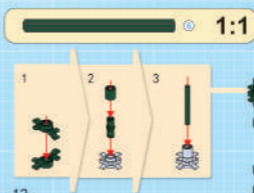

64



x1 x1

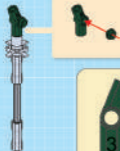

65



x2



66



x2 x2



x2

67



x2 x2

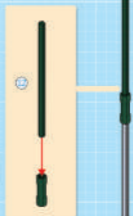

x2



15 1:1

68

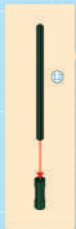

x2

69

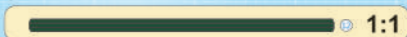
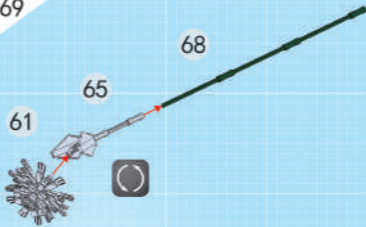

2



70



71



72



73



x5 x5 x5

74



x3 x3 x3

75



x1 x1

76



x5 x5 x5

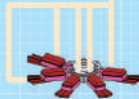
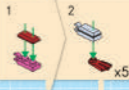
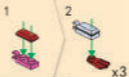
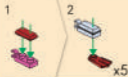

77



x3 x3 x3



78



77

74



79



x1

x1



80



x1



81



x5

x5

x5



82



x3

x3

x3



83

82



78



84



x1

x1



85



x5

x5

x5

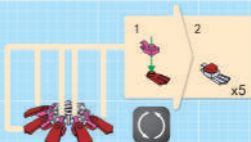

86



87

86



83

88



1



2

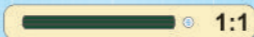

89



90



91



1



2



3



4

1:1

92



93

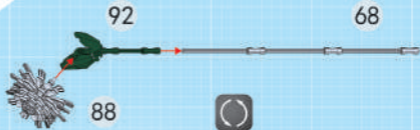

94



95



96



1



2



3



x4

97



1



2



3



x4



98

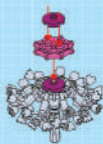

99



1



2



3



x2



100



1



2



3

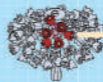

101



x3 x3 x18



102



x2 x2 x12



x3



x2



103



x1 x1



104



x3

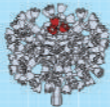

105



x2 x2 x12



x2

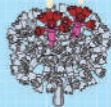

106



x2 x2 x12

107



x1 x1

108



x1 x1



x2



109



x2 x2



x2

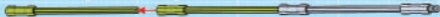

1:1

110

106



109



111

x2



x1

112

x1



x1



113

x2



x4

114

x1



x1

x1

115

x1



x1

116

x2



x1



1:1

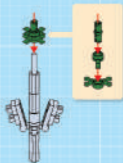

117



x1 x2 x4

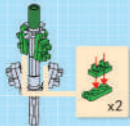

118



x2 x4 x1



119



x4 x8



x4

120



x4 x4



x4

121



x4 x4



x4

122



x12



x4

123



x12



x4

124



123

118

125



126



127



128



129



130



124



131



x2

132



x2

133



x2 x2



x2

134



x6



x2

135



x6



x2

136

135

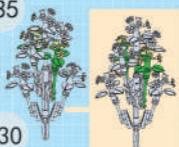

130

137



x9



x9



x3

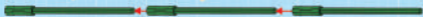

x3

138

136



137

139



140



141

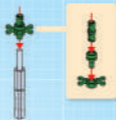

142



143



144



145



146



147



148

x3



149

148



143

150

x1

x2



151

x1

x1



152

x1

x1



153

x3



154

x3



155

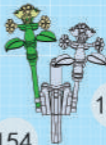

154

149

156



157



158



159



160



161



155

162



137

163



164



165



166



167



1:1



168



169



170



171



3 1:1

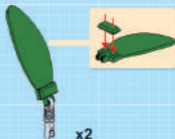

172

171

171



168

173

x1

x1

x1



174

x3

x3

x1



175

x1



176

x1

x3

x3



177

x1



178

x2



179

x2



180

x1

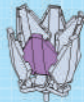

181



x1 x4



182



x2 x2



183



x2 x2



184

183



180

185

184



172

186

185



137

187



x1

x1



188



x1

x1

x1



189



x1

x1



190



x1

x1

x1



3 1:1

191



x1

x1



192



x1

x1

x1



193



x5

x4

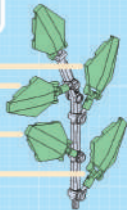

x4

194



195

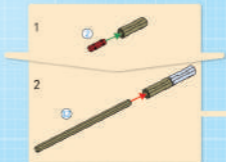

196



193



195



197



x1 x1

198



x1 x1

199



x2 x1

200



x1 x1



4 1:1



3 1:1



1:1

201



202



203



204

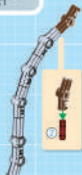

205



206



1:1

207

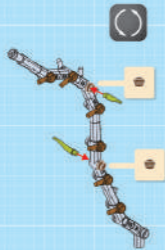

208

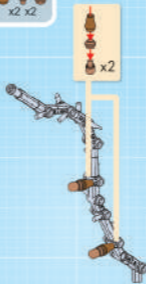

209

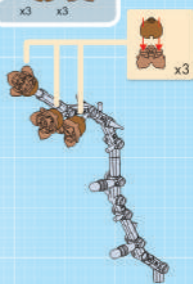

210



211



212



213



214



209

213



213

215



x2



216



217



x2 x2 x2



x2

218



x2 x2



x2

219



x4 x4

220



x4 x4



x2



x2

222



x1 x1 x1



5 1:1

223



x1 x1 x1



①



1:1



②

221



220

220

216

224

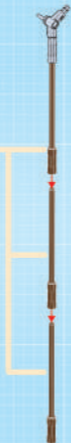

225

221



224



226



227



228



229



230



231

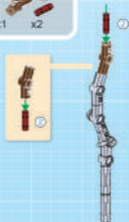

232



233



x1

x1

234



x1

x1

x2

235



x1

x1

x1

236



x1

x1



4

1:1



1:1



3

1:1



237



x2



238



x2 x4 x1



239



x3 x3 x3



x3

240



x1 x1 x1



241



x1 x1



242



x2 x2



243



x2 x2



244



243



239

245



246



247



248



249



244



248

250



251



252



253

251



252



254



x1 x1



255



x1 x1



256



x1 x1



257



x1 x1



258



x1 x1



259



x1 x1



260



x1 x1



261



262

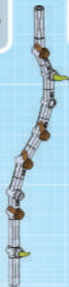

263



264



265



266



267



268



267

263

269



270



271



272



273



272



268

274



275



276



277





x8
1C3562008



x1
1C0033008



x4
1C3503008



x8
1Y_018008



x4
1B0239008



x5
1B0066008



x1
1B0052008



x2
1B0244008



x7
1B0200008



x16
1B0207008



x16
1C3185008



x8
1A1075008



x8
1A1123008



x8
1B0208008



x4
1A1076008



x11
1B2116047



x2
1G7008047



x13
1C3003047



x32
1A1026047



x13
1C3013047



x32
1C3502004



x2
1D4022004



x22
1C0092004



x29
1D4188004



x11
1C3012004



x6
1D4241004

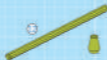

x3
1E5012036



x5
1F6130036



x2
1E501B036



x2
1C0033036



x3
1D4060036



x2
1C3360036



x2
1B020B036



x1
1B0066036



x1
1C0092036



x1
1C3373036



x1
1F6027036



x2
1B0200036



x8
1C3003036



x8
1D4091036



x19
1F6048002



x18
1F6130002



x2
1F6049002



x6
1E5048002



x9
1E5012002



x11
1C3003002



x1
1D4241002



x1
1F6004002



x2
1Y_012002



x1
1F6051002



x32
1E5005025



x2
1C3001025



x16
1A1076025



x32
1H8192025



x16
1A1123025



x123
1D4225025



x30
1C3571023



x1
1Y_017023



x2
1A1026023



x2
1C3178023



x10
1C3444035





x8
1Y. 018029



x8
1B0208029



x1
1C0033029



x4
1A1076029



x1
1D4046032



x6
1C3376032



x6
1B0208032



x3
1Y. 017032



x2
1A1082032



x1
1F6027032



x3
1A1076032



x3
1E5012038



x1
1F6004038



x4
1E5048038



x2
1F6048038



x6
1F6130038



x2
1Y. 012038



x4
1D4188038



x4
1C3001028



x16
1A1076028



x32
1H8192028



x3
1A1030028



x16
1A1123028



x1
1C3445028



x12
1C3444028



x1
1Y. 017028



x2
1A1026028



x2
1C3178028



x16
1B0207027



x3
1A1030027



x5
1C3001027



x16
1C3185027



x8
1C3444027



x20
1C3085027



x1
1D4059037



x4
1C3085037



x5
1C3376037



x1
1B0208037



x2
1D4022003



x2
1G7051003



x2
1C0043003



x2
1A1030026



x8
1A1028021



x4
1D4091021



x30
1D4225040



x4
1C3088020

MODEL BRICKS



THE BLOCK UNBLOCK

