

XODO®



Wireless Door/Window Sensor

DS2 User Manual

Welcome

Thank you for purchasing Xodo Smart home products!

We are committed to bringing you excellence. Xodo smart home technology products are convenient, make your life more comfortable and provide a more dynamic lifestyle.

Your new Wireless Door/Window Sensor is a smart home sensor that can monitor and report the activity of doors and windows.

General Notice

Always make sure to follow safety instructions.

- Do not use products if they have become damaged.
- Follow instructions and only operate products in a safe environment.
- Do not operate electronics in wet conditions. Doing so may cause property damage, bodily harm or electrocution.
- Do not disassemble or alter the product. Doing so will void the warranty.

Table of Contents

Welcome	1
Package Contents	2
Wireless Door/Window Sensor	3
Xodo Smart App	4
Configure the Wireless Door/Window Sensor Settings	7
Google Home	8
Alexa	10
Customer Service and Tech Support	12

What's included in the box

You will find the following contents included to help you get started:



Wireless Door/Window Sensor DS2 x4



3M Glue x4



User Manual

Product Features

Your DS2 Wireless Door/Window Sensor the following features:

- Monitor door / window
- Show open status
- Show closed status
- Remote monitoring
- Instant Alerts

Wireless Door/Window Sensor DS2

Battery Voltage: 12V 23A

Standby current: $\leq 10\mu\text{A}$

Alarm current: $\leq 45\text{mA}$

Wireless frequency: 433MHz

Control Range: < 250 Feet

Wireless Door/Window Sensor Introduction



Indicator Light

Red light will blink when sensor is open/closed and user will receive in app message

Installation of Wireless Door/Window Sensor



The battery cover can be removed by sliding it down (Slide the sensor and battery cover in opposite directions and the battery cover will come off so that the battery can be replaced).

The sensor can be installed using the 3M adhesive.



Download and Install the Xodo Smart APP

Download and install the APP. It can be also be found by searching "XODO Smart" by Contixo Inc. in the App Store (for IOS) or Google Play Store (for Android).



Xodo Smart

Open the APP

The welcome screen will appear and then you will be asked to login or register a profile. Register an account by entering your email address and setting up a profile or logging in with an existing account.

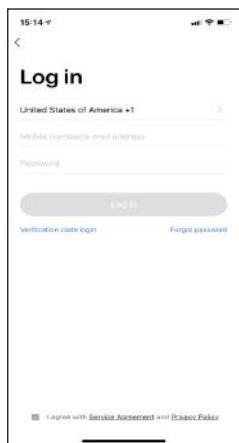

Adding Devices

Select "SA2", then click "Accessories". In the "Accessories" page, click "Quick add" and open or closed your DS2 Wireless Door/Window Sensor, the SA2 Smart Alarm Gateway will make a prompt. Click "Confirm", your DS2 Wireless Door/Window Sensor is now ready to work.

(The XODO DS2 Wireless Door/Window Sensor DS2 can only work with XODO SA2 Smart Alarm Gateway.)



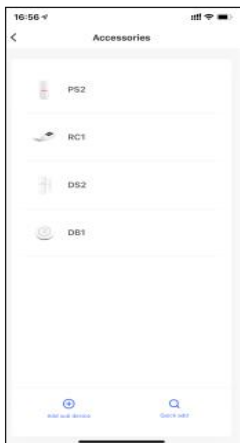



Wireless Door/Window Sensor Home Screen

The home screen will show the live Wireless Door/Window Sensor status.

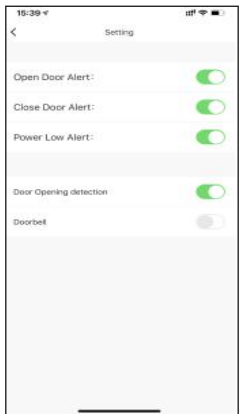
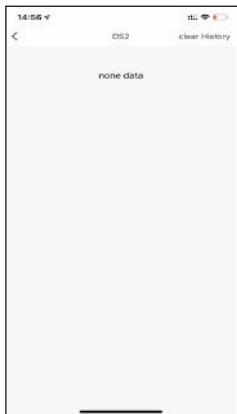
1. Press the “Click to view more” button to view the alarm history.
2. Press the “⚙️” button to set the Wireless Door/Window Sensor alarm mode.



Configure the Wireless Door/Window Sensor Settings

Different features can be adjusted from the menu button on the upper right hand button “” on the APP.

1. Device Name can be changed as desired.
2. Device information can check the information of the Door/Window Sensor.
3. Tap-to-Run and Automation allows to check the Smart Automation your device linked with.
4. Supported Third-Party Control provides the information about how to connect your device to Amazon Alexa and Google Assistant.
5. Add Members to be able to control the device in the Share Device setting.
6. FAQ & Feedback allows users to report issues and get help.
7. Add to Home Screen allows you to add the Wireless Door/Window Sensor to the home screen of your smartphone.
8. Remove device will remove the Wireless Door/Window Sensor from the Xodo Smart app and remove pairing. This is necessary if pairing with a new device.
9. Restore Factory Defaults allows to reset the Wireless Door/Window Sensor to factory setting.

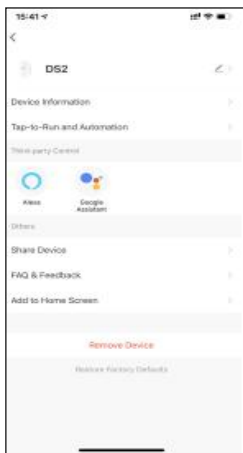

Link Xodo Smart account to Google Home Screen

1. Open Google Play Store or Apple Store and download Google Home
2. Open the Google Home app. Click on Get Started.
3. Login with a Google Account or create a new account.

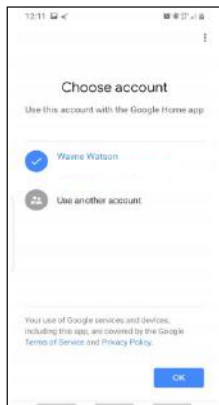
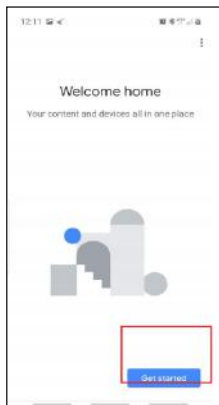
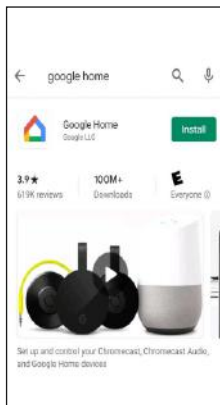

4. Use Location access to find devices on the same wifi network.
5. You will need permission so Google Home can access your device.
6. The app will search for devices to connect.

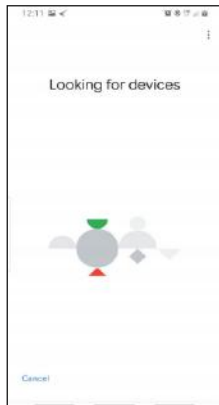
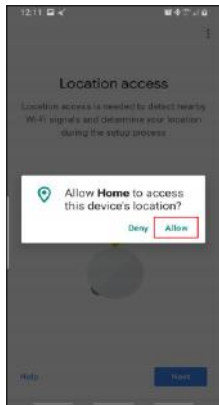
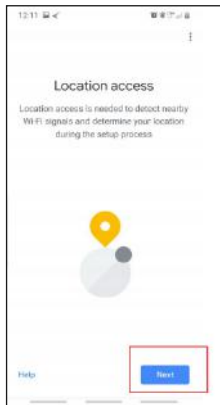

- If no devices can be found that are already setup, select NO.
- A youtube video is available to help instruct how to use smart devices.
- The app will show settings to add devices, setup routines, and adjust settings.

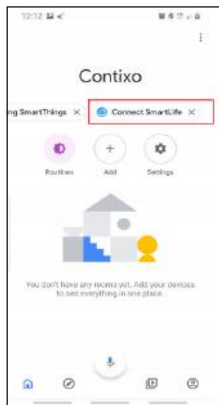
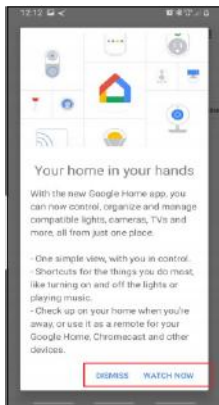

- If the devices are already installed and setup through the Xodo app, you can select the "Works with Google" setup option to continue.
- Configure the home settings by adding address and name to a "Home" group.

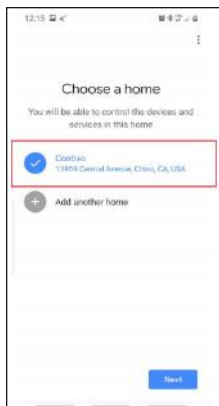
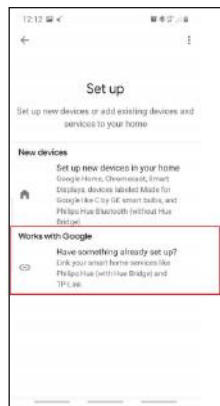

Control your smart devices through Google Home

Now you can control your smart devices through Google Home. Take XODO bulb as the example, the supported voice commands are as below:

1. Ok Google, turn on/off bedroom light.
2. Ok Google, set bedroom light to 50 percent.
3. Ok Google, brighten bedroom light.
4. Ok Google, dim bedroom light.
5. Ok Google, set bedroom light to red.

Link Xodo Smart account to Alexa

1. Download the free Alexa app from the Amazon Appstore, Google Play, or the Apple App Store.
2. Open Alexa app to home screen
3. In upper left hand corner open the menu.
4. Next click on "Skills & Games"
5. In top of app you can now search for "Smart Life"
6. Smart Life App will appear.

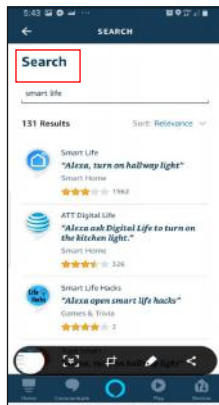
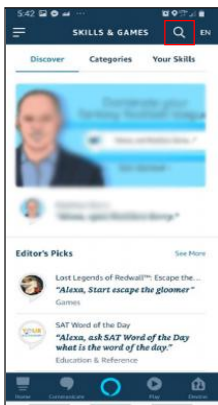
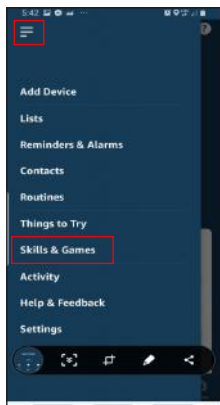

- Open the smart life app to add
- Click Settings
- Manage Smart Home Devices to verify Smart Life has been added.

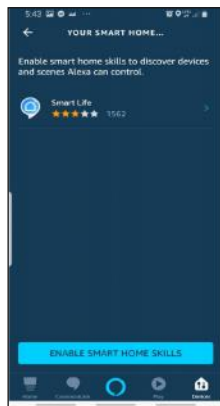
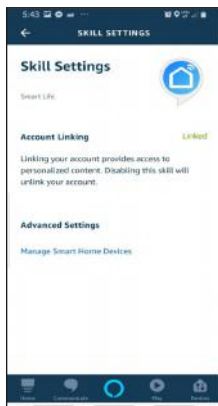
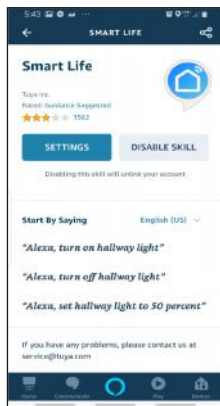

- You will be redirected to the account link page. Type in your Xodo Smart account and password, don't forget to select the country/region where your account belongs to. Then tap "Link Now" to link your Xodo Smart account. The country/region, the account, and the password must match.

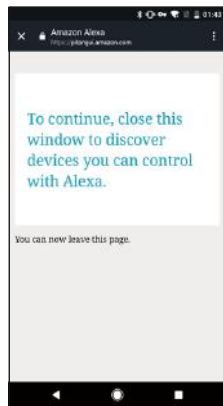
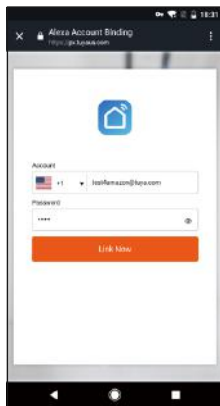

Customer Service and Tech Support

Your satisfaction is important to us. We are here to help!

Contact us at support@contixo.com

Include your order number and product description.

See our website for more products www.contixo.com

We enjoy your feedback!

Xodo is a subdivision of the Contixo Inc. group., and the respective logos are registered trademarks of Contixo Inc. and may not be used, reproduced, or altered without written Permission. All other trademarks are the property of their respective owners and used with permission.

To find the latest revision of this publication, visit our website at

www.contixo.com