

# **INFACO<sup>®</sup>**

## SAW **SC160P3**



ORIGINE  
**FRANCE<sup>®</sup>**  
GARANTIE

BVcert.615214

USER GUIDE - **EN**



<b>PW3, a multi-function handle</b>	<b>4</b>
<b>Compatible tools</b>	<b>5</b>
<b>Precautions before use</b>	<b>6</b>
<b>Personal protection equipment</b>	<b>6</b>
<b>Protection of the environment</b>	<b>6</b>
<b>General product view</b>	<b>7</b>
<b>Specifications</b>	<b>7</b>
<b>Compatible batteries</b>	<b>8</b>
<b>User guide</b>	<b>9</b>
<b>Tool gap adjustment</b>	<b>13</b>
<b>Precautions for use and safety</b>	<b>14</b>
<b>Servicing and maintenance</b>	<b>16</b>
<b>Safety instruction</b>	<b>21</b>
<b>Warranty conditions</b>	<b>22</b>
<b>Advice</b>	<b>23</b>
<b>Troubleshooting</b>	<b>24</b>
<b>Technical information</b>	<b>27</b>

# PW3, A MULTI-FUNCTION HANDLE

## Hand tools



PW3  
+ TR9



PW3  
+ SC160P3



PW3  
+ PWMP3  
+ PWP36RB



PW3  
+ THD600P3



PW3  
+ THD700P3

## Pole tools



PW3  
+ PW930P3  
+ SC160P3



PW3  
+ PW930P3  
+ TR9



PW3  
+ PW930P3  
+ THD600P3



PW3  
+ PW930P3  
+ THD700P3



PW3  
+ PS1P3 (sardlage)



PW3  
+ PB100P3 (hoeing)  
+ PB150P3 (hoeing)  
+ PB220P3 (hoeing)  
+ PN370P3 (sweeping)



PW3  
+ EP1700P3



PW3  
+ EC1700P3



PW3  
+ V5000P3EF



PW3  
+ V5000P3ET



PW3  
+ V5000P3AF

# COMPATIBLE TOOLS

REFERENCE	DESCRIPTION
THD600P3	Double hedge-trimmer, blade length 600mm.
THD700P3	Double hedge-trimmer, blade length 700mm.
TR9	Arborists chainsaw, maximum cutting capacity Ø150mm.
SC160P3	Saw head, max cutting capacity Ø100mm.
PW930P3	Carbon extension, length 930mm.
PW1830P3	Carbon extension, length 1830mm.
PWT1650P3	Carbon extension, length 1650mm.
PS1P3	Fixed tying pole 1480mm.
PB100P3	Fixed hoe pole 1430mm Cutting head Ø100mm.
PB150P3	Fixed hoe pole 1430mm Cutting head Ø150mm.
PB220P3	Fixed hoe pole 1430mm Cutting head Ø200mm.
PN370P3	Fixed sweeping pole 1430mm Brush Ø370mm.
PWMP3 + PWP36RB	De-cankering tool (mill diameter 36mm)
PWMP3 + PWP25RB	De-cankering tool (file diameter 25 mm)
EP1700P3	Desuckering tool (telescopic pole 1200mm to 1600mm).
EC1700P3	Blossom thinner (telescopic pole 1500mm to 1900mm).
V5000P3EF	Olive harvester (fixed pole 2500mm).
V5000P3ET	Olive harvester (telescopic pole 2200mm to 2800mm).
V5000P3AF	Alternative olive harvester (fixed pole 2250mm)

## PRECAUTIONS BEFORE USE



**WARNING.** Read all the safety warnings and all the instructions. Failing to heed warnings and follow instructions may lead to an electric shock, a fire and/or serious injury.

Keep all warnings and instructions for future reference. The term “tools” in the warnings refers to your battery powered electric tool (with power cord), or your tool operating on a battery (without power cord).

## PERSONAL PROTECTION EQUIPMENT

	Read the instructions for use carefully, especially the safety instructions.
	The wearing of a hard hat, eye and ear protection is MANDATORY
	Hand protection using cut-prevention work gloves.
	Foot protection using safety footwear.
	Face protection using a visor
	Body protection, using cut protection overalls.
	IMPORTANT! Extensions can be made of conductive materials. Do not use near sources of electricity or electric wires
	IMPORTANT! Do not approach any part of the body to the blade. Do not remove the cut material or hold the material to be cut while the blades are moving.

## PROTECTION OF THE ENVIRONMENT



Observe all country-specific waste disposal rules and regulations.

- > Power tools must not be disposed of with household refuse.
- > The device, accessories and packaging must be taken to a recycling centre.
- > Ask the approved INFACO dealer for up-to-date information on the eco-compatible elimination of waste.



## GENERAL PRODUCT VIEW

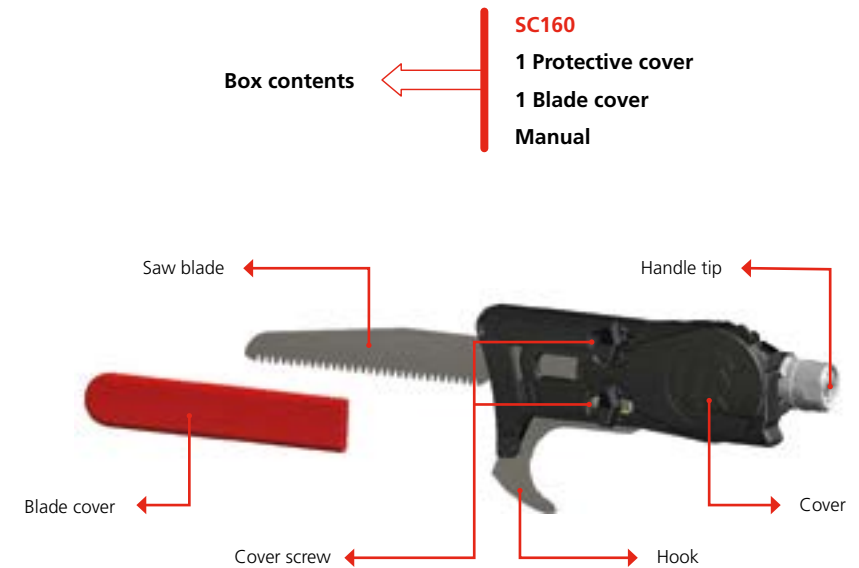

## SPECIFICATIONS

REFERENCE	SC160P3
Rated power supply	48 VDC
Max power	1300 W
Weight	3440 g
Length	570 mm
Speed	3200 cuts / min

*These specifications are given as an indication only. Under no circumstances may they be considered as contractually binding. They are subject to modification without prior notice in the interests of product development.*

*Patented equipment*

## COMPATIBLE BATTERIES



### 820Wh battery L850B

Cable compatibility  
L856CC



### 120Wh battery 831B

Cable compatibility  
825S



### 500Wh battery L810B

Cable compatibility  
PW225S



### 150Wh battery 731B

Cable compatibility  
PW225S (requires fuse  
replacement by 539F20).

## USER GUIDE

### First use

The first time you use the equipment, we strongly recommend you to ask the advice of your dealer, who is qualified to give you all the advice you need for correct use and optimum performance. *It is imperative to carefully read the tool and accessory user manuals before handling or powering up the tool.*



*Disconnect  
the power cord*



### Installation and connection



*Only use INFACO brand batteries with a 48 Volt power supply.*

Any use with batteries other than INFACO batteries may lead to damage. The warranty on the motorized handle will be void if batteries other than those manufactured by INFACO are used.



*In wet weather, it is imperative to carry the battery belt under waterproof clothing to keep the battery unit protected from the rain.*

## Mounting the handle



## Using the machine

> It is **IMPERATIVE** to fit the **blade cover**.



> Mounting the saw on the handle

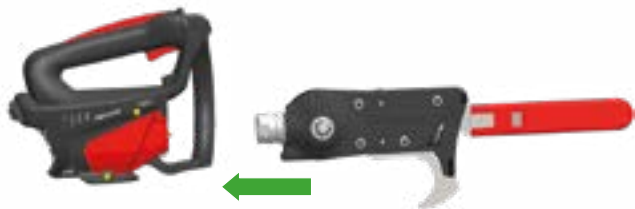

> Tighten the wing nut



> Connect the battery



> Connect the power cable



> First start-up



**1st start-up:** 2 short presses on the trigger = ON  
**Exit from standby mode:** 2 short presses on the trigger = ON  
**Normal operation:** 1 long press on the trigger = ON  
**Trigger release:** OFF

**It is mandatory to hold it with both hands**

## Assembly on a pole



Disconnect the power cord

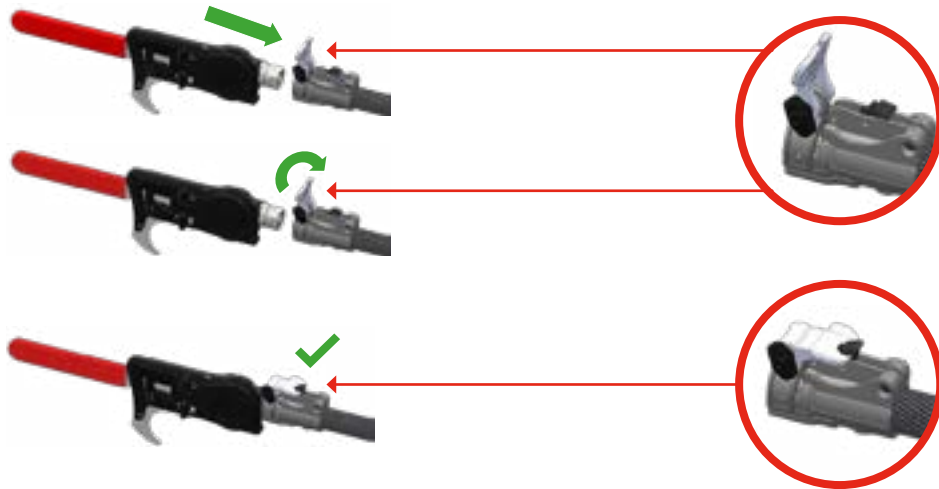

Tighten the wing nut



## TOOL GAP ADJUSTMENT



It is imperative to disconnect the machine.



No movements

GAP OK

Presence of movements

ADJUST THE GAP



# PRECAUTIONS FOR USE AND SAFETY

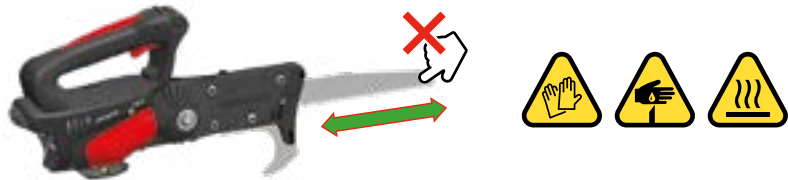

It is mandatory to hold it with both hands

## Travail en hauteur



Warning about risks when working at heights using a ladder.  
**High-risk work configuration not recommended.**

We recommend the use of the extension (option) for all work at heights. In order to prevent any risk of falls and other accidents.



## Storage and transport

When storing and transporting the chainsaw, we recommend **draining off the oil and storing the tool in a box**, as oil seepage can occur.



It is **IMPERATIVE** to fit the **blade cover** and **disconnect the power cord** for storage and transport.



For the transport, storage, servicing, maintenance of the tool, or any other operations not related to tool function operations, it is **imperative to disconnect the device**.



Disconnect before transport and storage



Disconnect before transport and storage





# SERVICING AND MAINTENANCE

<p>All servicing and maintenance operations must be carried out with the tool disconnected from all power sources:</p> <p>Adapt the servicing frequencies to your tool use.</p> <p>Occasional use, space out the frequency. Intensive use, increase the frequency.</p>		Before starting work	At the end of the day	Each time the battery is charged	Once per week	Once per month	Once per year	In the event of damage	In the event of a malfunction	When necessary		
		Complete machine	Visual inspection of its condition	×	×							
			Cleaning		×							×
			Inspection by the dealer							×	×	
Accessory assembly	Cleaning and lubrication				×							
Saw blade gap	Inspection		×									
	Adjust									×		
Saw blade	Visual inspection of its condition	×										
	Cleaning		×									
	Replacement							×		×		
Saw head	Gap check	×		×						×		
	Lubrication				×					×		
	Inspection by the dealer							×	×			
Power cord	Visual inspection of its condition					×		×	×			
Battery	Visual inspection of its condition			×	×			×	×			
Vest	Visual inspection of its condition						×	×	×			
Handle	Visual inspection of its condition	×	×									

## Changing the blade



It is imperative to disconnect the machine from the battery



New saw blade  
SCP3 SCP4 SCP4S

Only use POWERCOUP blades specific to the saw.



Blade gap

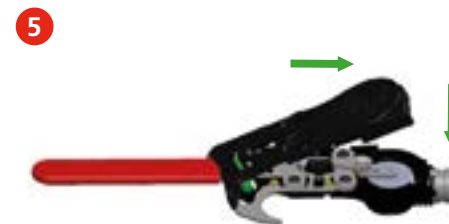
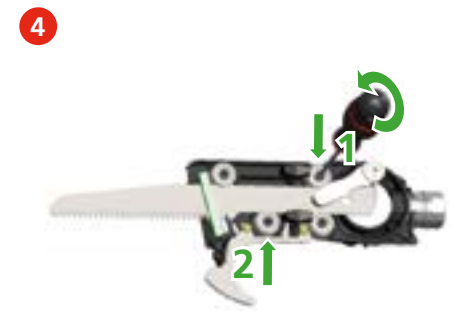
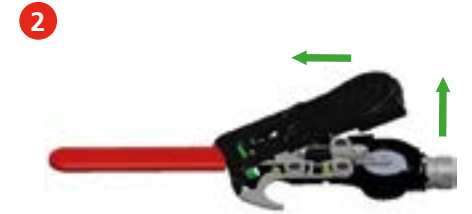
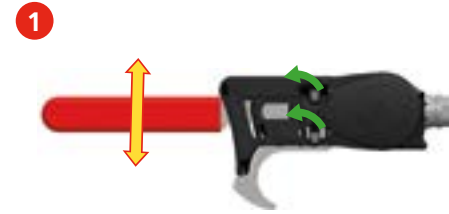
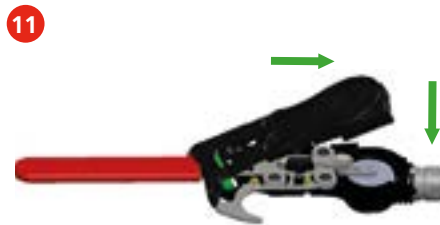

## Cleaning and lubrication



Zone to be lubricated



## SAFETY INSTRUCTION

IMPORTANT. To reduce the risk of electric discharges, injuries and fire when using electric tools, follow the fundamental safety measures indicated below. Read and follow these instructions before using the tool, and keep the safety instructions!

Outside operations related to the use of the tool, your tool and its accessories must be disconnected and stored in their relevant packaging.



It is imperative to disconnect your tool from all power sources for the following operations:

- Servicing.
- Battery charging.
- Maintenance.
- Transport.
- Storage.

When the tool is running, always remember to keep the hands away from the accessory head being used. Do not work with the tool if you are tired or feeling unwell. Wear the specific recommended personal protection equipment for each accessory. Keep the equipment out of the reach of children or visitors.



Do not use the tool if there is a risk of fire or explosions, for example in presence of flammable liquids or gases.

Never carry the charger by the cord, and do not pull on the cord to disconnect it from the socket.



Keep the cord away from heat, oil and sharp edges.

Never use the tool at night or in bad light without setting up additional lighting. When using the tool, keep both feet on the ground and keep as much balance as possible.



Caution: extensions can be made of conductive materials. Do not use near sources of electricity or electric wires.

## WARRANTY CONDITIONS

Your tool has a two year warranty for manufacturing defects or faults.

The warranty applies to the normal use of the tool and does not cover:

- **damage due to poor maintenance or lack of maintenance,**
- **damage due to incorrect use,**
- **wear parts,**
- **tools that have been taken apart by unauthorised repairers,**
- **external factors (fire, flood, lightning, etc.),**
- **impacts and their consequences,**
- **It tools used with a battery or charger other than those of the INFACO brand.**

**The warranty is only applicable when the warranty has been registered with INFACO (warranty card or online declaration on [www.infaco.com](http://www.infaco.com)).**

**If the warranty declaration was not made when the tool was purchased, the factory departure date will be used as the warranty start date.**

**The warranty covers factory labour but not necessarily dealer labour. The repair or replacement during the warranty period does not extend or renew the initial warranty.**

All failings regarding the storage and safety instructions will void the manufacturer's warranty.

The warranty cannot entitle to compensation for:

The possible immobilisation of the tool during repairs.

All work carried out by a person other than approved INFACO agents will cancel the tool warranty.

The repair or replacement during the warranty period does not extend or renew the initial warranty.

We strongly recommend INFACO tool users to contact the dealer that sold them the tool in the event of a failure.

To avoid all disputes, please note the following procedure:

- **Tool still under warranty, send it to us carriage paid and we will pay the return.**
- **Tool no longer under warranty, send it to us carriage paid and the return will be at your expense by cash on delivery. If the cost of the repair were to exceed € 80 excluding VAT, you will be supplied with a quote.**

## ADVICE

**Keep your work area tidy.** Clutter in work areas increases risks of accidents.

**Take into account the work zone.** Do not expose electric tools to rain. Do not use electric tools in a damp or wet environment. Make sure the work area is properly lit. Do not use electric tools near inflammable liquids or gases.

**Protect yourself from electric shocks.** Avoid bodily contact with surfaces connected to the earth, such as battery chargers, electric multi-plugs, etc.

**Keep away from children!** Do not allow third parties to touch the tool or cable. Keep them away from your work area.

**Store your tools in a safe location.** When not in use, tools must be stored in a dry, locked location in their original packaging and out of the reach of children.

**Wear suitable work clothing.** Do not wear loose-fitting clothing or jewellery. It could be caught up in moving parts. When working in the open air, wearing rubber gloves and non-slip sole footwear is recommended. If your hair is long, wear a hair net.

**Wear protective eye-wear.** Also wear a mask if the work being carried out generates dust.

**Protect the power cord.** Do not carry the tool using its cord and do not pull on the cord to disconnect it from the socket. Protect the cord from heat, oil and sharp edges.

**Maintain your tools carefully.** Regularly check the plug and power cord condition and, if they are damaged, have them replaced by a recognised specialist. Keep your tool dry and free of oil.

**Remove the tool keys.** Before starting the machine, make sure the keys and adjustment tools have been removed.

**Check your tool for damage.** Before reusing the tool, carefully check that the safety systems or slightly damaged parts are in perfect working order.

**Have your tool repaired by a specialist.** This tool is compliant with applicable safety rules. All repairs must be carried out by a specialist and only using original parts, failure to do so could result in serious risks to user safety.

# TRUBLESHOOTING

DISRUPTIONS	CAUSES	SOLUTIONS
Significant abnormal vibrations	Incorrect blade assembly	Remove and refit the blade following the procedure
	Blade gap too big	Adjust the blade gap by following the procedure and contact the dealer if necessary
Poor cuts	Blade wear	Replace the worn blade by following the procedure.
Noise in the extension	Extension guide damaged	Contact your dealer.
The machine will not start	Battery discharged	Recharge the battery
	No power supply	Re-connect the machine.
	Other	Contact your dealer.
Unexpected machine stoppages	Too much pressure on the branches	Do not force on the machine.
	Battery discharged	Recharge the battery.
	Branches too thick	Cut thinner branches

## DEALER PART

Part to be kept by the dealer.

Serial number > ..... Ref > .....

Name > .....

First name > .....

Company name > .....

Full address > .....

.....

City > .....

Postcode > .....

Phone number > .....

Purchase date > ..... / ..... / .....

Remarks > .....

customer signature

## TO BE RETURNED TO INFACO

To validate the warranty, **REGISTER IMMEDIATELY ONLINE ON** : [www.infaco.com](http://www.infaco.com), your warranty declaration or send this form filled out **IN BLOCK CAPITALS AS SOON AS THE TOOL IS PURCHASED.**

Name > ..... Prénom > .....

Company name > .....

Full address > .....

.....

City > ..... Postcode > .....

Phone number > .....

Email > .....

Purchase date > ..... / ..... / .....

Serial number v - Ref > .....

--	--	--	--	--	--	--	--

Remarks > .....

Orchards                       Oil production  
 Vine growing                       Parks & gardens

Dealer's stamp

Serial number

--	--	--	--	--	--	--	--

**DEALER**

To be kept by the dealer  
for the customer  
file  
customer file



--

--



**EQUIPMENT MANUFACTURED  
IN FRANCE**



Manufacturer > *INFACO S.A.S. - 81140 CAHUZAC-SUR-VÈRE (FRANCE)*

Type > *POWERCOUP PW3 SC160*

Ref > *SC160P3*

Weight with handle > *2100g*

Maximum power > *1300 W*

Battery rated voltage > *48 Volts*

These specifications are given as an indication only. Under no circumstances may they be considered as contractually binding. They are subject to modification without prior notice in the interests of product development.

## **TECHNICAL INFORMATION OR CUSTOMER SERVICE**

INFACO S.A.S.

Bois de Roziès

81140 CAHUZAC-SUR VÈRE France

**Phone:** (+33) 05 63 33 91 49 - **Fax:** (+33) 05 63 33 95 57

**Email:** [contact@infaco.fr](mailto:contact@infaco.fr)

Technical videos available on the website: [www.infaco.com](http://www.infaco.com)