



ORIGINAL INSTRUCTIONS

P8F120 / P8F210 / P8T120 / P8T210





Before you use the extension pole, please read the instructions for using your pruning shear carefully and follow all safety instructions.



The user should always take great care when the pruning shear are on the end of the extension pole to avoid all risk of causing physical injury or material damage.



For all forms of handling other than pruning operations, stop the pruning shear in the closed-blade position and disconnect the power plug.



N.B. the extension pole is made of carbon which conducts electricity. Do not use it near electrical sources or electricity wires.

The first time you use the equipment, we strongly recommend you to ask the advice of your dealer, who is qualified to give you all the advice you need for correct use and optimum performance.

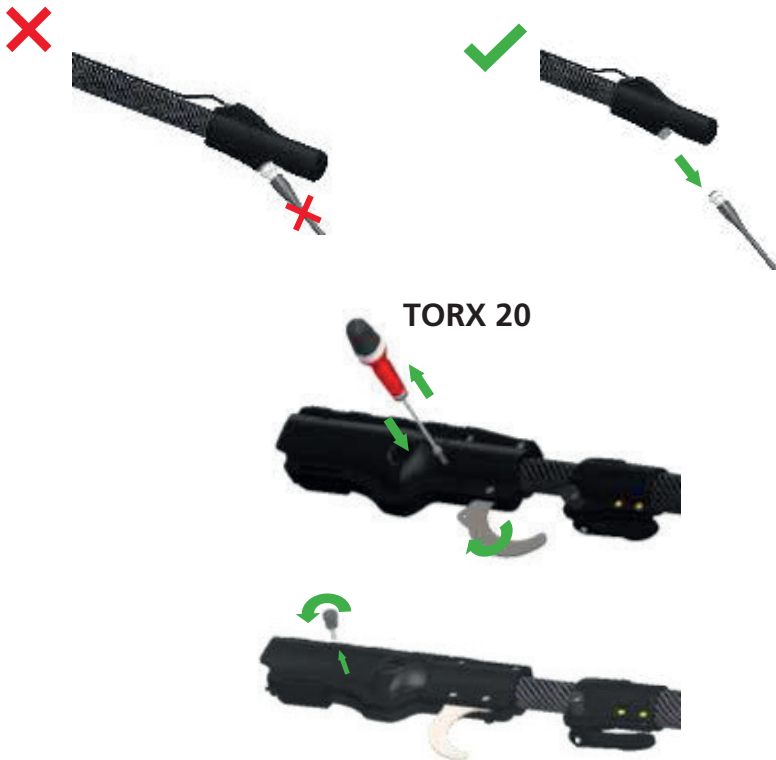



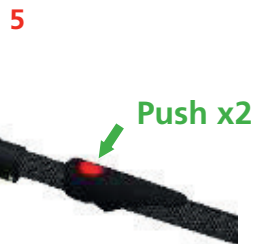
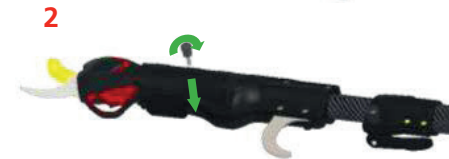

DO NOT START WITH THE SHEARS TRIGGER.



THE WIRELESS SYSTEM IS DEACTIVATED ON THE POLE.



If your cable will not enter, deploy the telescopic extension.

With telescopic extensions avoid turning the head. It could create knots in the spiral cable and stop the extension from sliding properly.

NOTPERCHEF3015_EN_01

