

# THE A.R.K - SMALL ROOM

## ASSEMBLY INSTRUCTIONS

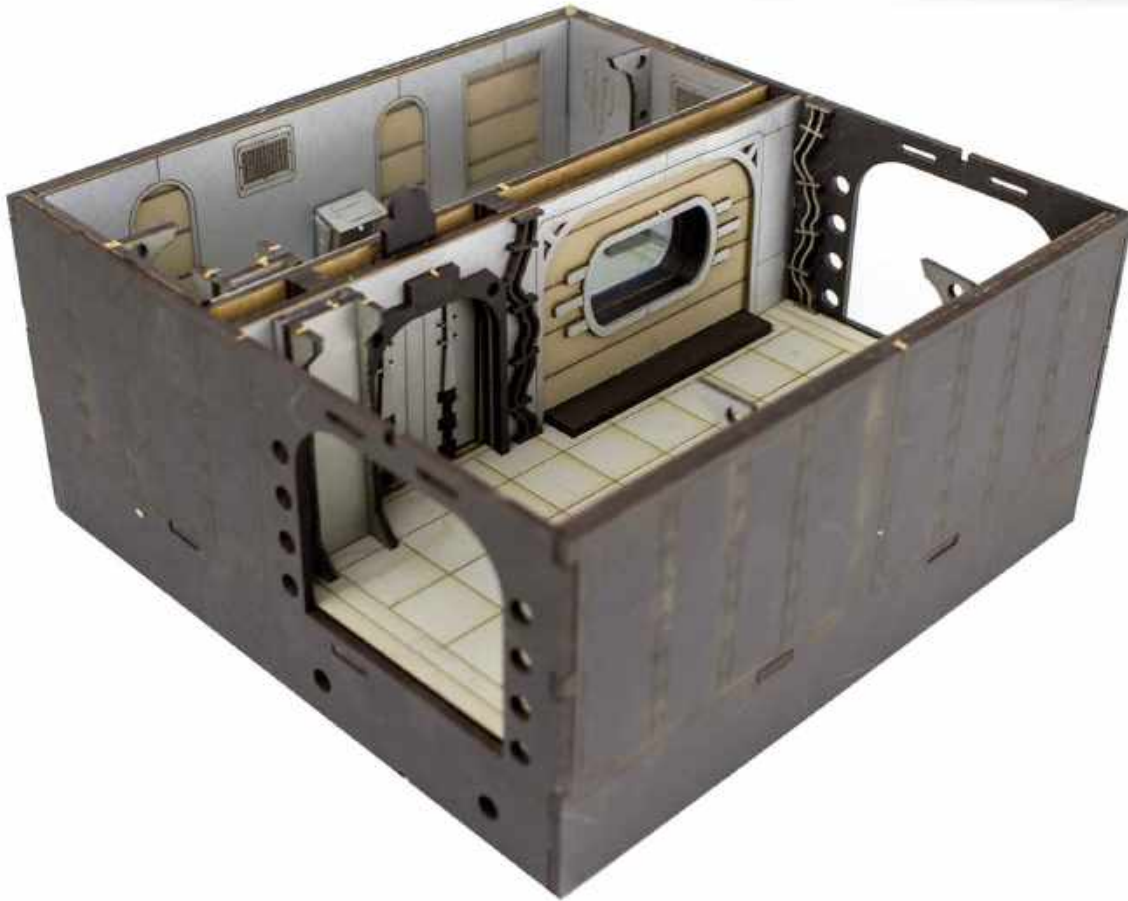

**Before starting this kit, make sure you read through all the instructions carefully.** Always remember to dry fit parts and sand as needed.

**We use two kinds of glue when assembling our kits. Super glue (cyanoacrylate) or PVA glue.**

**You can repaint or weather our kits easily! The paint we use is a great base primer and will take paint nicely.**

**If you have any issues during assembly, please contact us and we'll always help!**

**We would like to take the time to thank you for purchasing a Black Site Studios product!**

**[www.blacksitestudio.com](http://www.blacksitestudio.com)**

### WE SUGGEST HAVING THESE TOOLS ON HAND



### IMPORTANT SYMBOLS YOU'LL FIND ON YOUR JOURNEY



ATTENTION



DRY FIT



NO GLUE



GLUE



TRIM/SAND

# THE A.R.K - SMALL ROOM

PAGE 1

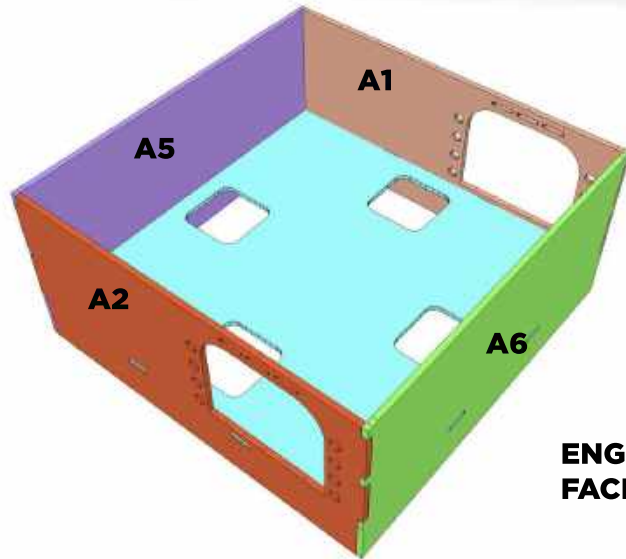

ENGRAVING  
FACES OUT.

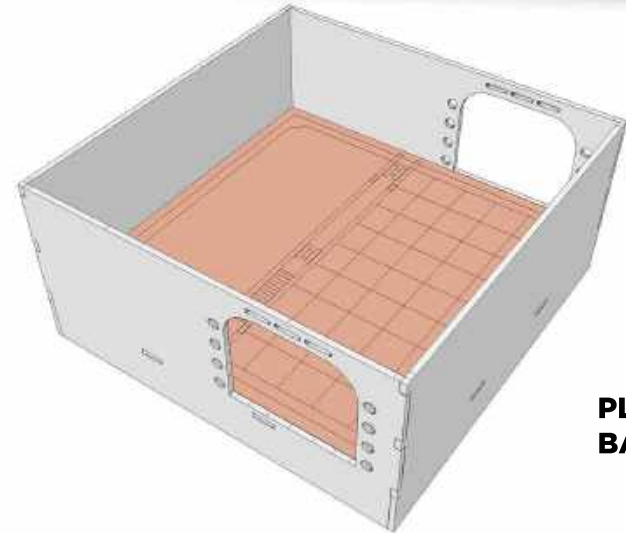

PLACE IN GREY  
BASE.

NOTE THE DIRECTION  
OF THE TABS



B4

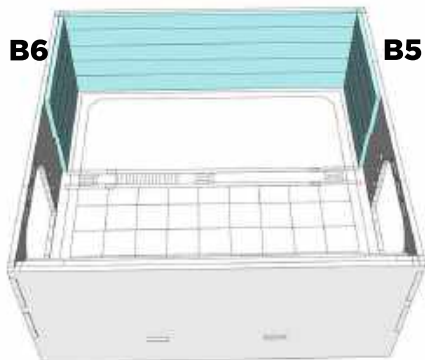

C2

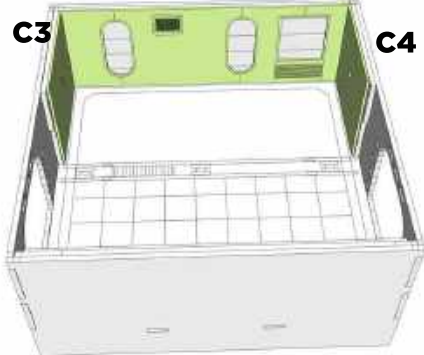

B3

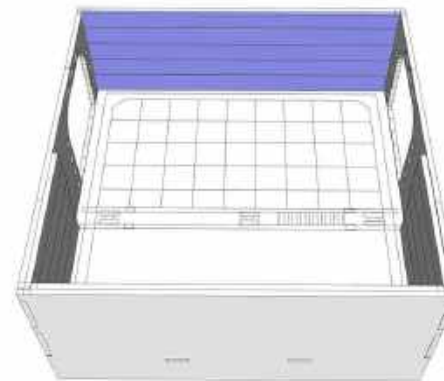

C1



# THE A.R.K - SMALL ROOM

PAGE 2

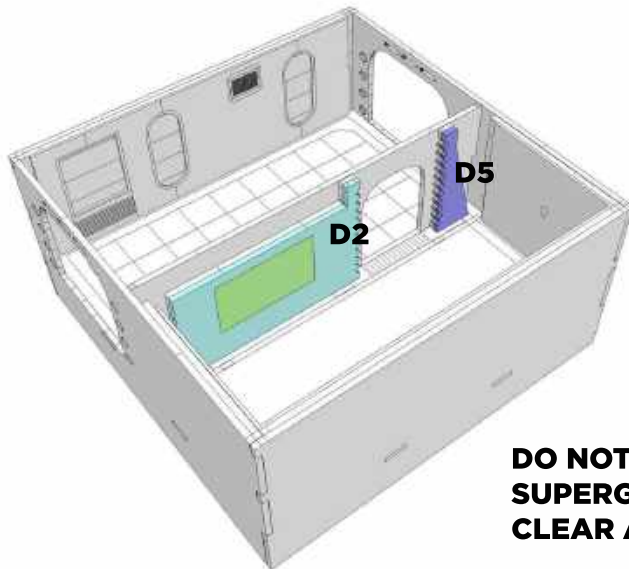
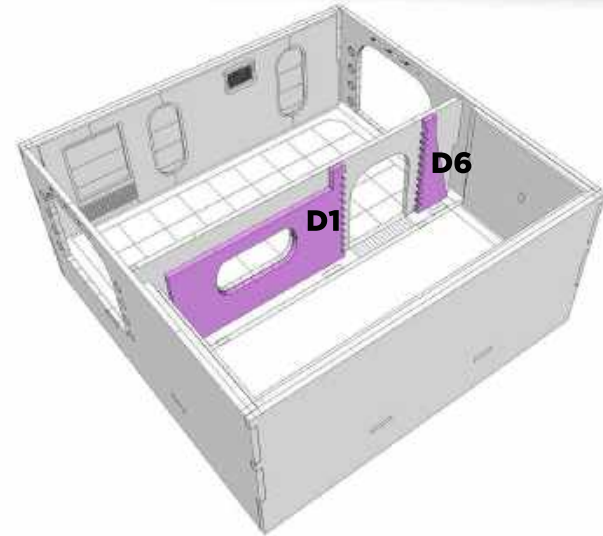
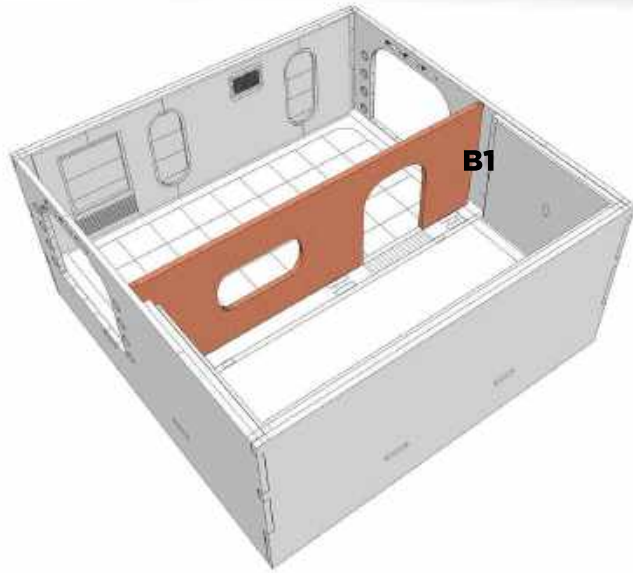

**DO NOT GET  
SUPERGLUE ON THE  
CLEAR ACRYLIC PART.**

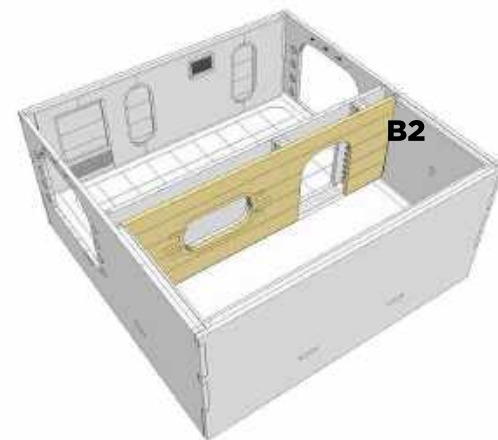
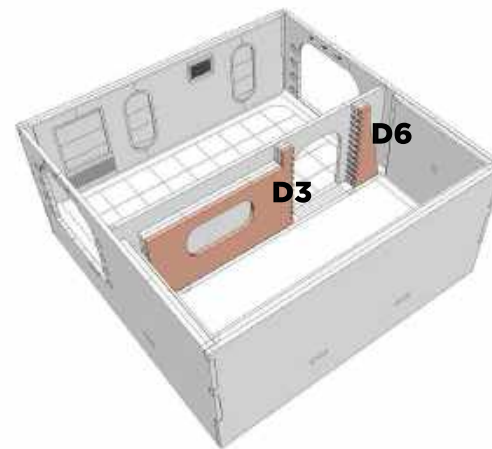



# THE A.R.K - SMALL ROOM

PAGE 3

