

BIG TURKEY VIDEO STORE

ASSEMBLY INSTRUCTIONS



Before starting this kit, make sure you read through all the instructions carefully. Always remember to dry fit parts and sand as needed.

We use two kinds of glue when assembling our kits. Super glue (cyanoacrylate) or PVA glue.

You can repaint or weather our kits easily! The paint we use is a great base primer and will take paint nicely.

If you have any issues during assembly, please contact us and we'll always help!

We would like to take the time to thank you for purchasing a Black Site Studios product!

www.blacksitestudio.com

WE SUGGEST HAVING THESE TOOLS ON HAND



IMPORTANT SYMBOLS YOU'LL FIND ON YOUR JOURNEY



ATTENTION



DRY FIT



NO GLUE



GLUE



TRIM/SAND

BIG TURKEY VIDEO STORE

PAGE 1

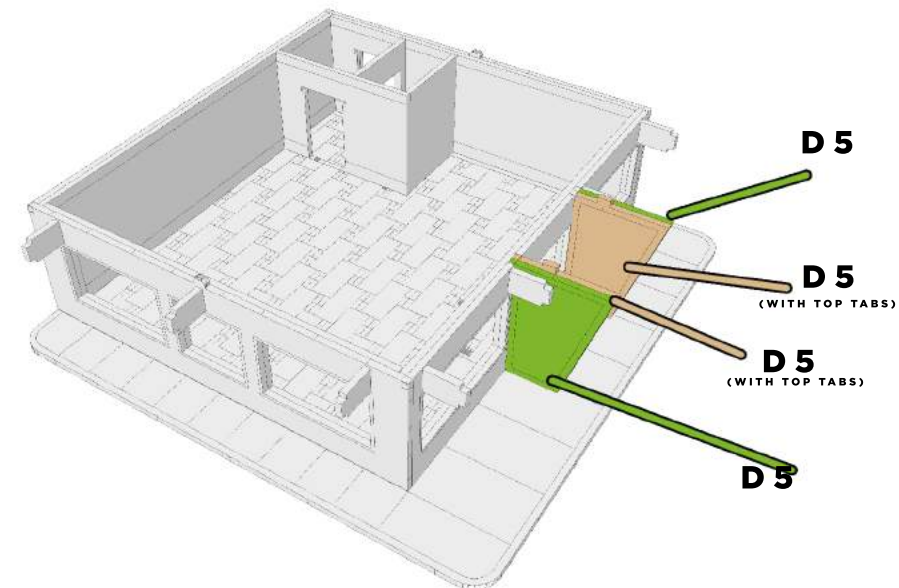
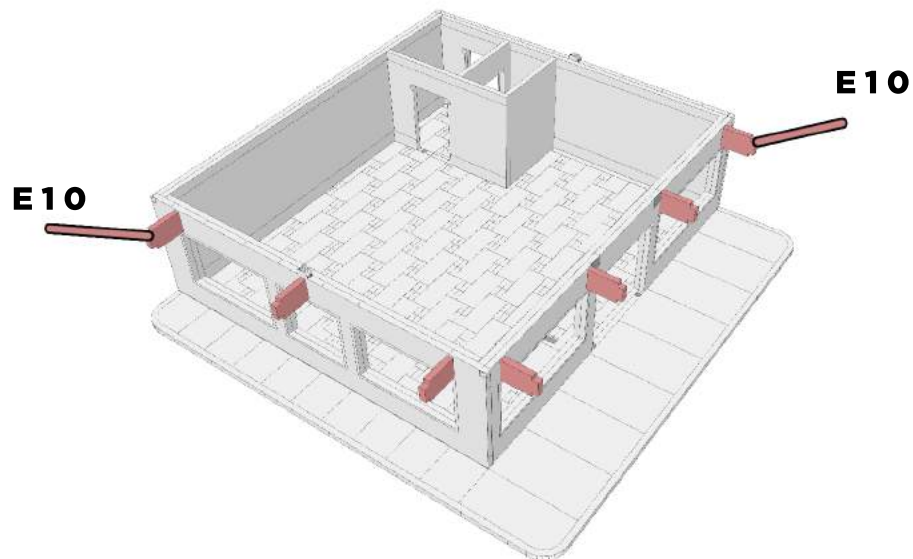
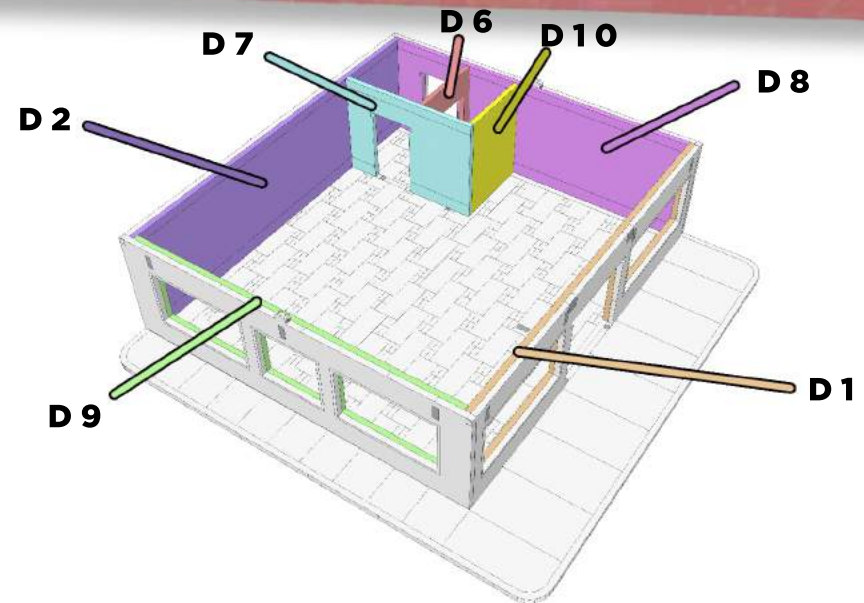
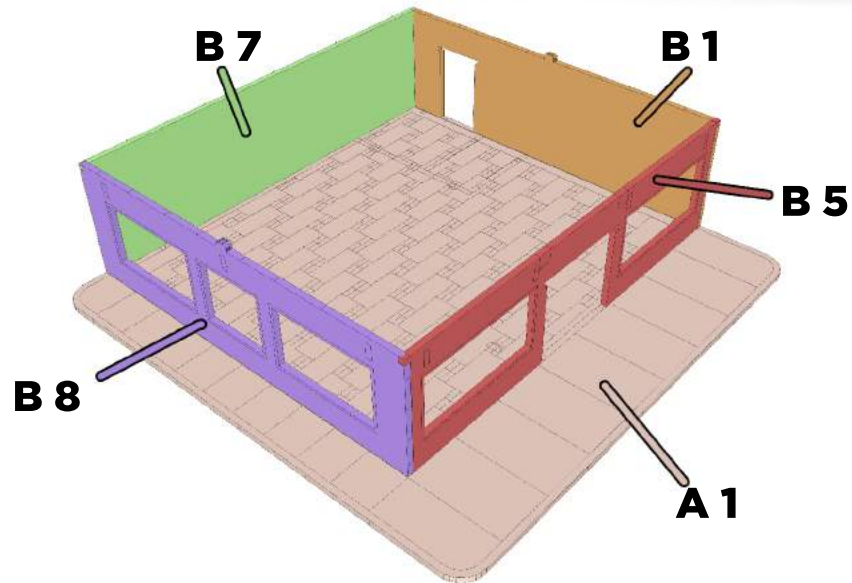

BIG TURKEY VIDEO STORE

PAGE 2

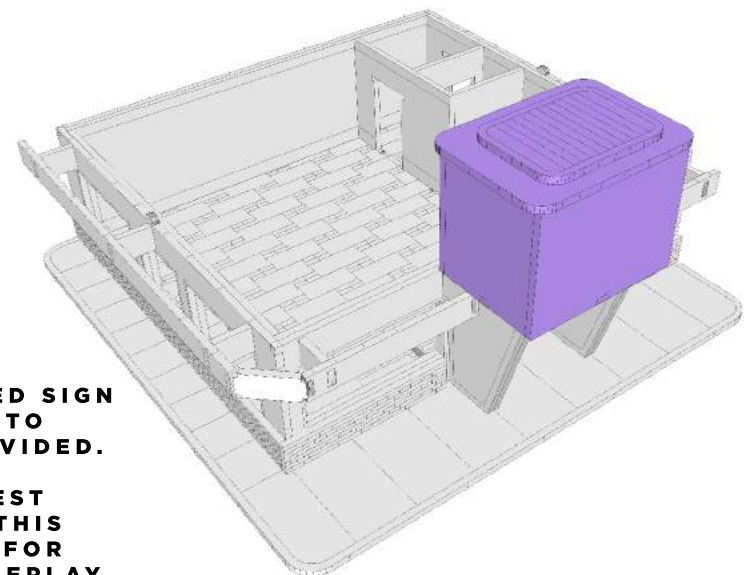
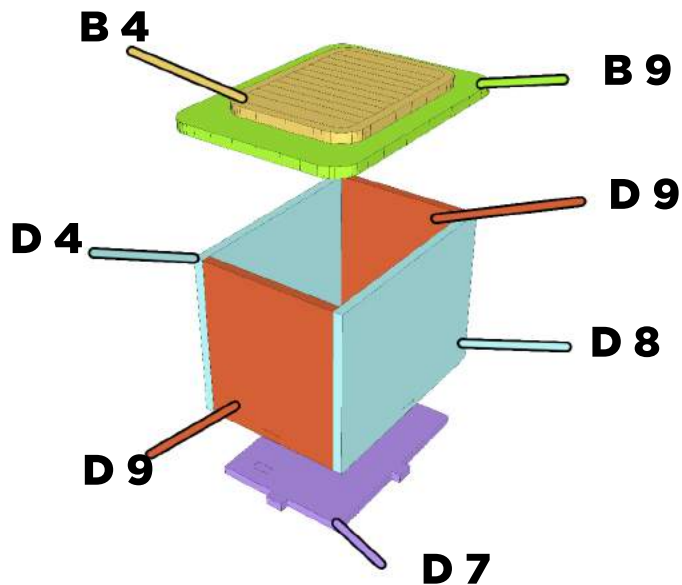
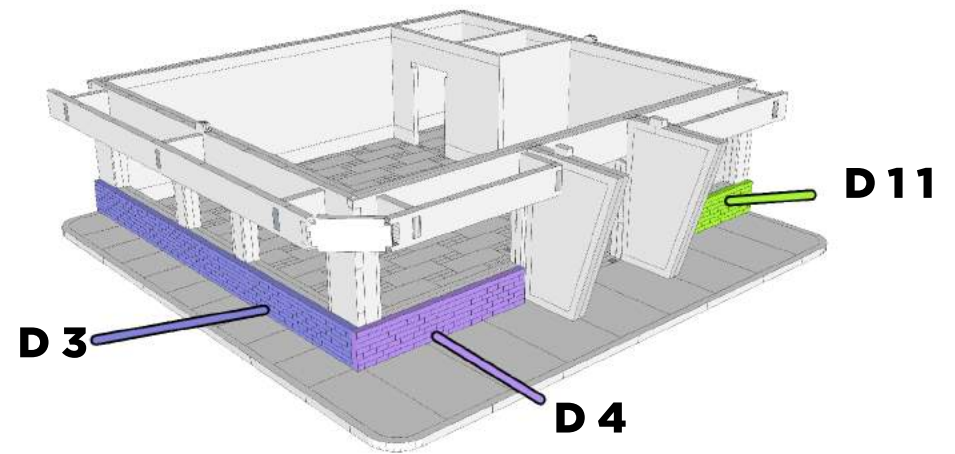
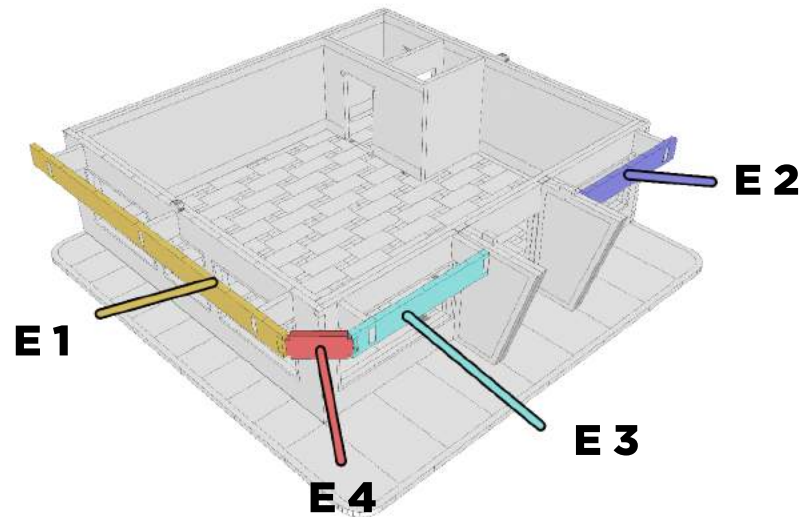

PLACE
ASSEMBLED SIGN
BLOCK ONTO
TABS PROVIDED.

WE SUGGEST
LEAVING THIS
UNGLUED FOR
EASY GAMEPLAY.

BIG TURKEY VIDEO STORE

PAGE 3

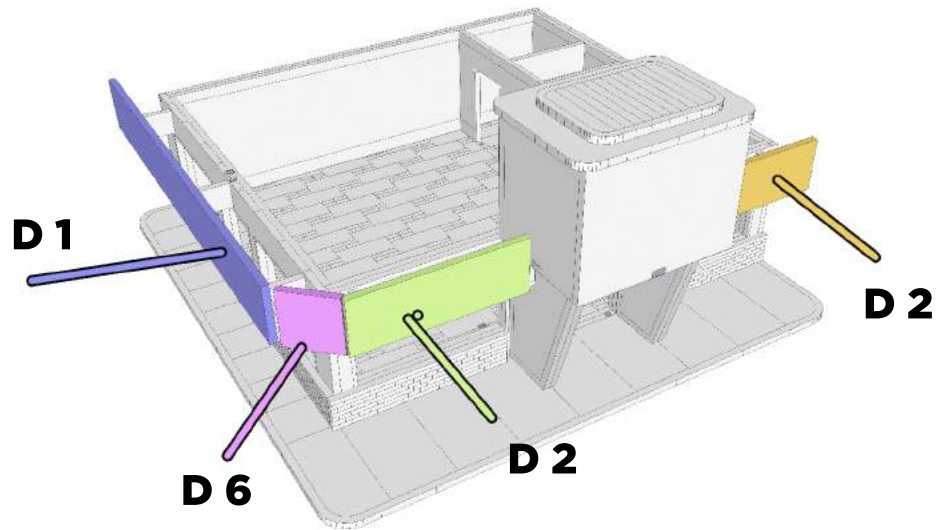

E13
THE LONGER ONE

THE DOORS
ARE DESIGNED
TO OPEN AND
CLOSE. ONLY
PLACE GLUE
ONTO TOP
HINGE AND
SLOT THE
DOOR INTO
HOLES
PROVIDED

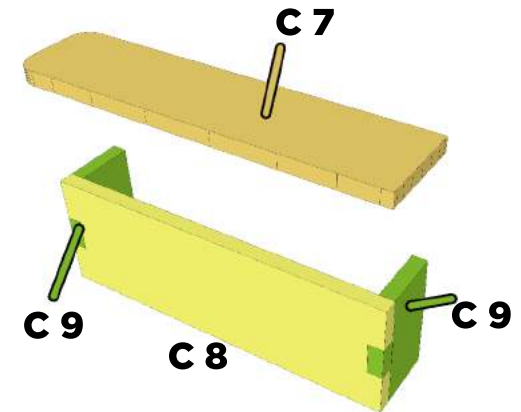
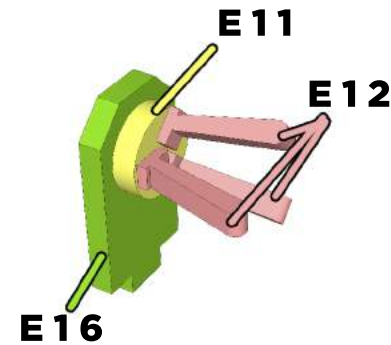
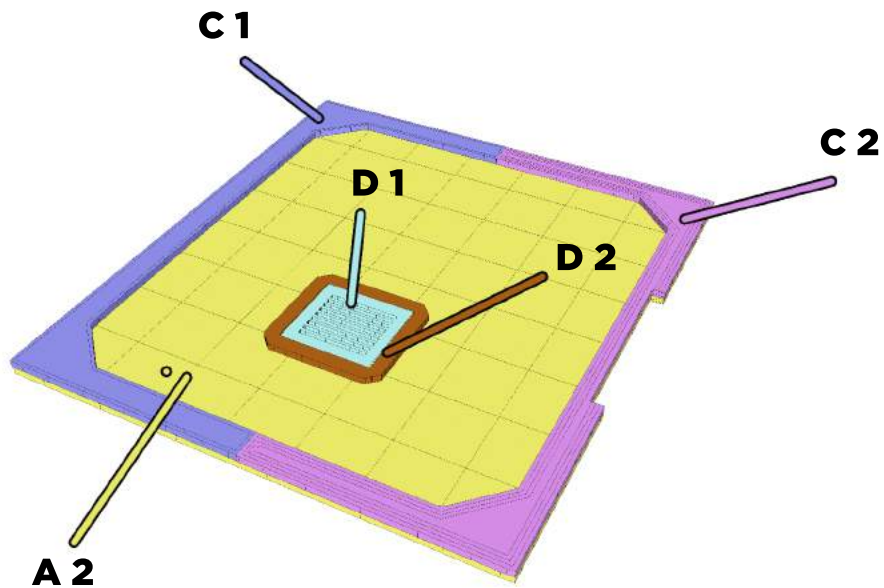
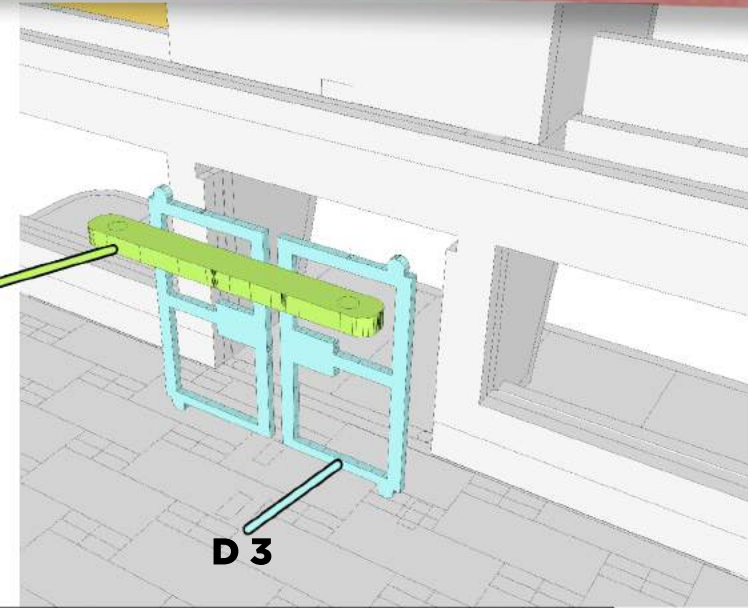

BIG TURKEY VIDEO STORE

PAGE 4

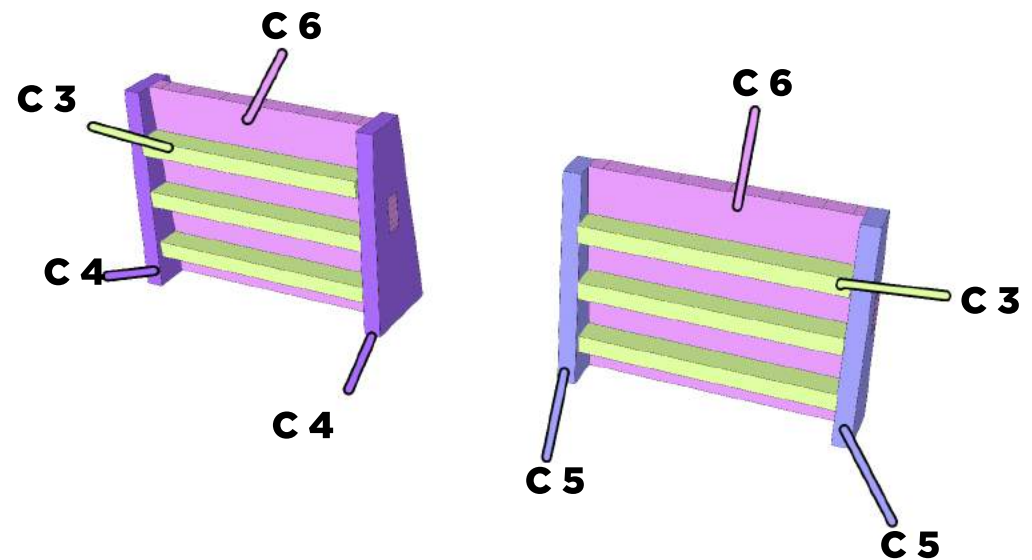
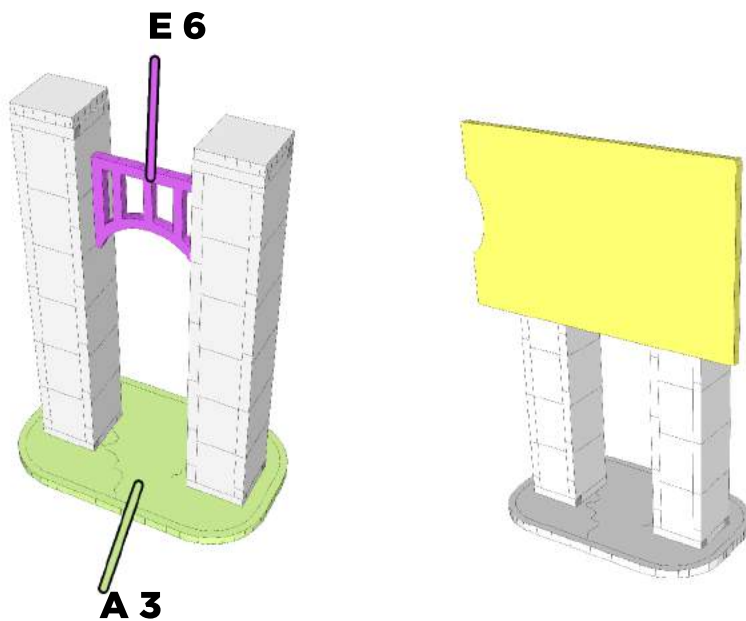
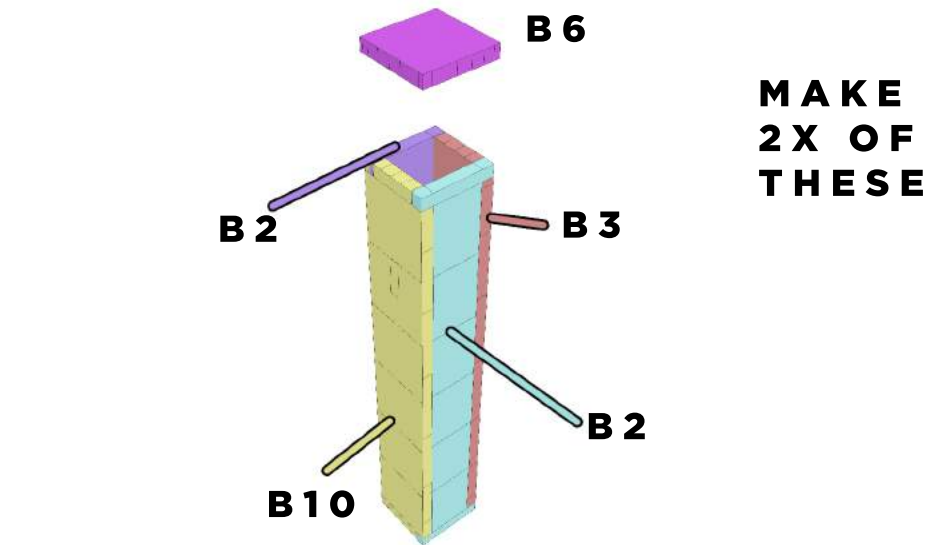
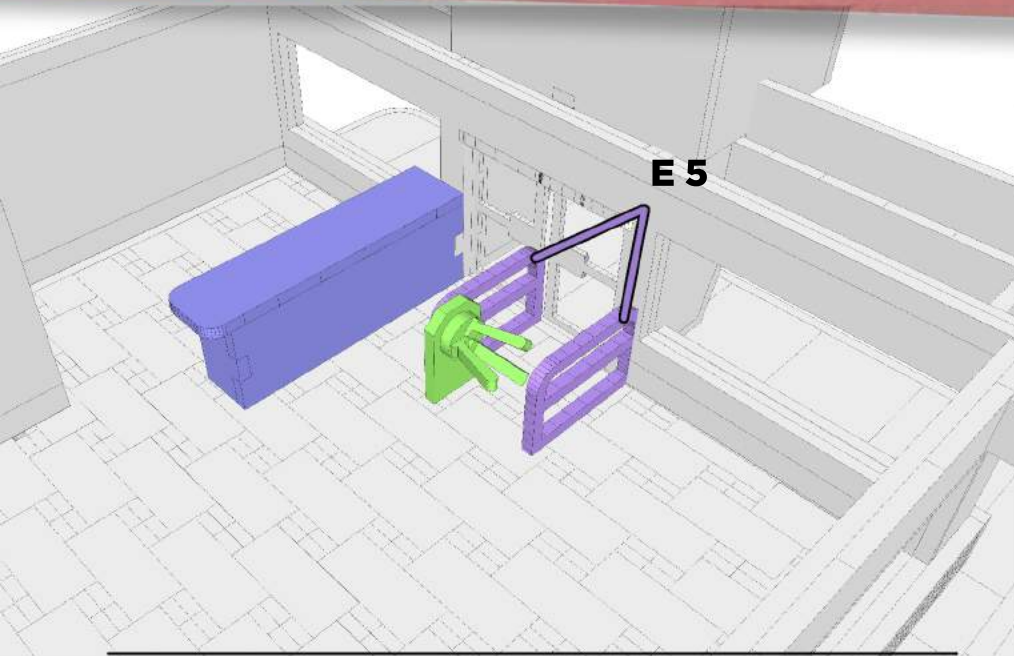

BIG TURKEY VIDEO STORE

PAGE 5



PLACE WINDOWS INTO HOLES

THIS KIT COMES WITH SOME PRINTED GRAPHICS. YOU CAN CUT THE PARTS OUT AND APPLY THEM WITH GLUE.

PLEASE REFER TO THE IMAGES ON OUR WEBSITE FOR THE BEST WAY TO PLACE THEM.

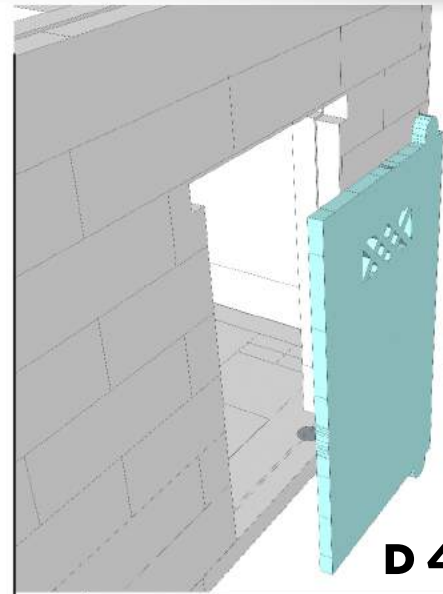

THE DOORS ARE DESIGNED TO OPEN AND CLOSE. ONLY PLACE GLUE ONTO TOP HINGE AND SLOT THE DOOR INTO HOLES PROVIDED