

DELUXE LEG STRETCH

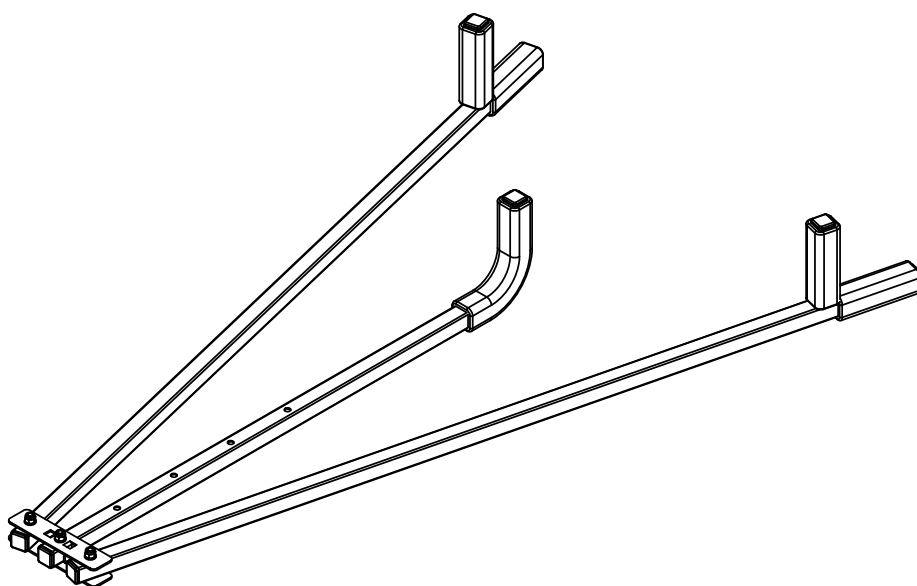

Owner's Manual

PARTS LIST & ASSEMBLY

- Hardware Package

No.	Description	Q'ty
1	M6 x 35 bolt	3
2	∅6 washer	6
3	M6 nut	3
4	Sandwich bracket	2

- Attached to the frame

5	20 tube plug	8
6	100 foam tube	4
7	170 foam tube	1

- Parts in the box

8	Leg post support 0100	2
9	Center pull arm 0200	1

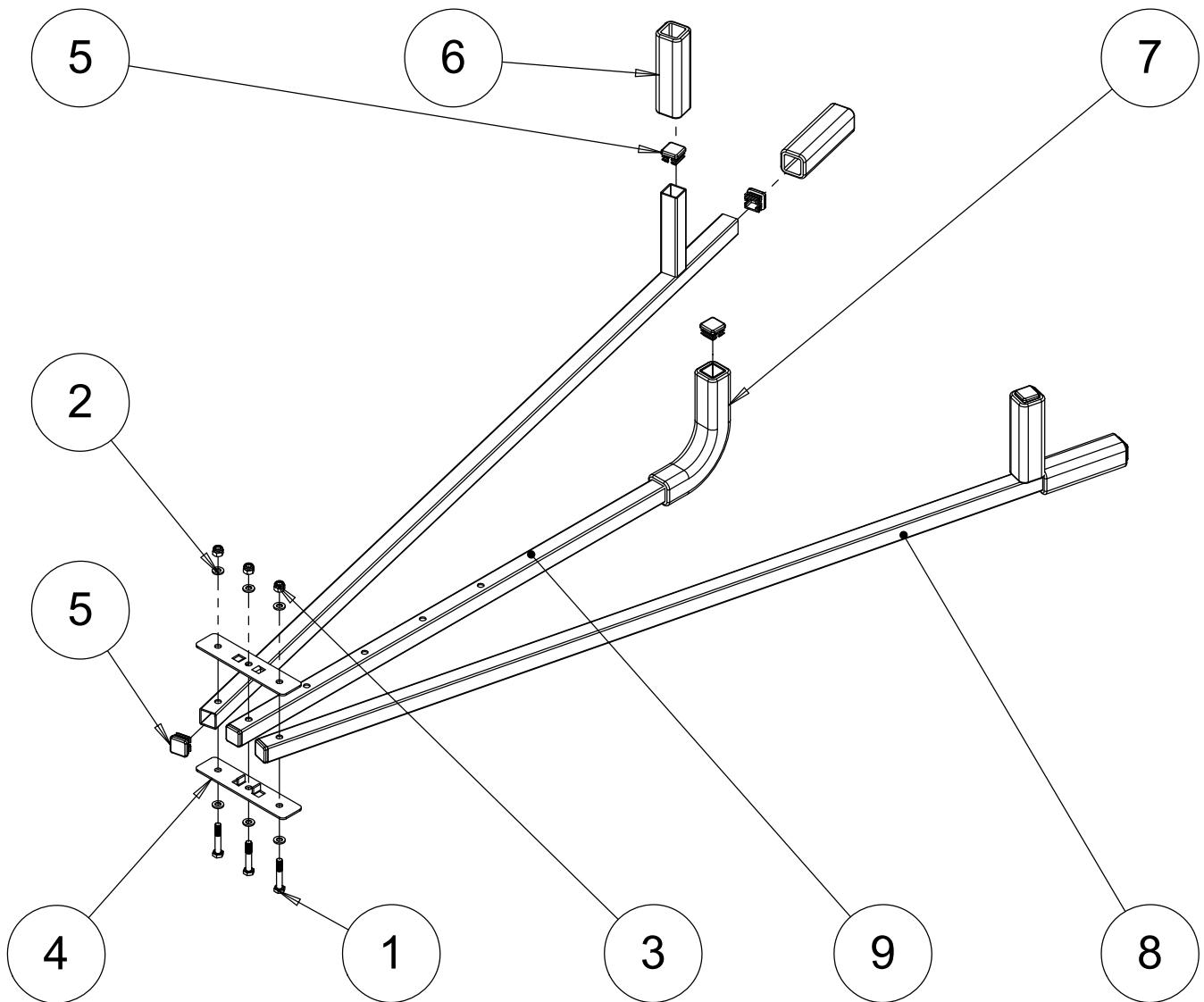

SAFETY & PRECAUTIONS

**BEFORE BEGINNING ANY EXERCISE PROGRAM, CONSULT YOUR PHYSICIAN.
RETAIN OWNER'S MANUAL FOR FUTURE REFERENCE.**

Place manual and warranty information in safe secure place in your home or office.

- Additional features on products may be added during seasonal production but may not be representative in line art diagrams at time of production. Changes as such will not affect the performance or assembly of the unit.
- This exercise equipment was designed and built for optimum safety. However, certain operator precautions apply whenever you operate a piece of exercise equipment. Please note the following safety procedures.

WARNING

1. Keep children and pets away from this equipment. Move equipment away from walkways and floors to alleviate possible tripping over the equipment.
2. Always inspect equipment prior to use to assure structural integrity. Some parts may need occasional maintenance due to wear and tear. Make certain all moving pieces and parts are secure before each training session.
3. If dizziness, nausea, chest pains or any other abnormal symptoms are experienced while using this equipment, stop the workout at once and consult a physician immediately.
4. Always use this equipment on a level surface.
5. Before using this equipment, always do stretching exercises to warm up.
6. Use this equipment only for its intended use as described in manual.