

ECOSYS MA2100cwf & ECOSYS MA2100cfx:

A classic, redefined

With the new ECOSYS MA2100cwf & ECOSYS MA2100cfx, we have transformed a hugely popular legacy device, making it the perfect fit for the new age of work. This compact and highly reliable A4 multi-function printer combines the best of Kyocera's ECOSYS technology with modern innovation to meet the needs of the most demanding workspaces, be they in the office or across remote locations.

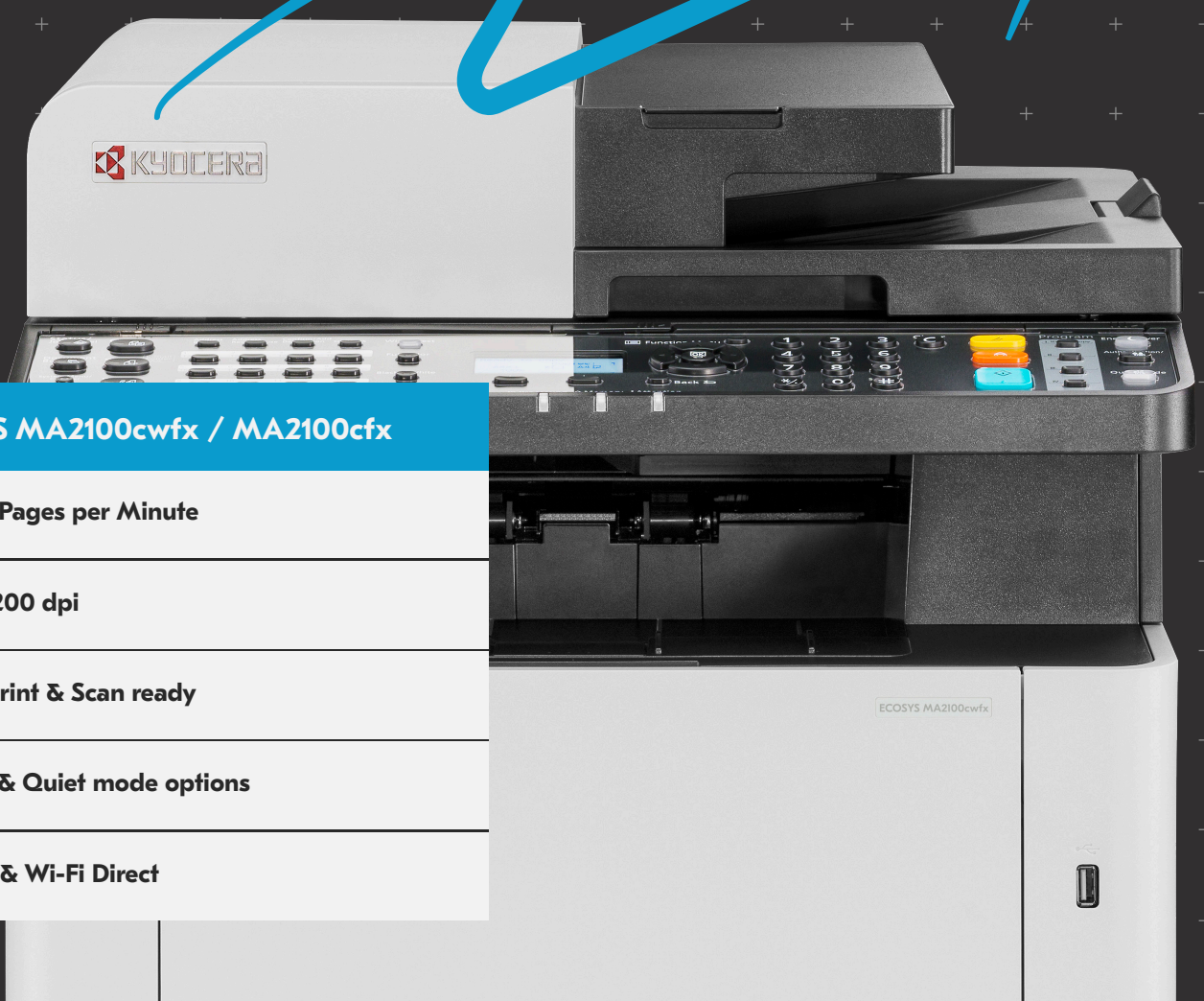

ECOSYS MA2100cwf / MA2100cfx

Up to 21 Pages per Minute

1200 x 1200 dpi

Mobile Print & Scan ready

EcoPrint & Quiet mode options

Wireless & Wi-Fi Direct

GENERAL

Technology: KYOCERA ECOSYS, Colour Laser
Control panel display: 5 lines LCD display
Engine speed: Up to 21 pages A4 per minute in colour and b/w
Resolution: 1,200 x1,200 dpi print at reduced speed, multibit technology for print quality of up to 9,600 x 600 dpi (print), 600 x 600 dpi, 256 greyscales per colour (scan/copy)
Warm-up time: Approx. 32 seconds or less
Time to first print: Approx. 11/12.5 seconds or less in b/w/colour
Time to first copy: Approx. 10/12 seconds or less in b/w/colour
CPU: 800MHZ
Memory: Standard 512 MB, max. 1,536 MB
Standard interface:
 ECOSYS MA2100cfx: USB 2.0 (Hi-Speed), USB Host Interface, Gigabit Ethernet (10BaseT/100BaseTX/1000BaseT) Slot for optional SD/SDHC-Card
 ECOSYS MA2100cwfxf: USB 2.0 (Hi-Speed), USB Host Interface, Gigabit Ethernet 10BaseT/100BaseTX/1000BaseT), Wireless LAN, Slot for optional SD/SDHC-Card
Dimensions (W x D x H): Main unit: 417 x 429 x 495 mm
Weight: Main unit: Approx. 26 kg
Power source: AC 240 V, 50 Hz
Power consumption:
Copy/Print: 345 W
Ready mode: 41 W
Sleep mode: 1 W
Noise (Sound pressure level: ISO 7779/ISO 9296):
 Copy/Print BW/colour: 48/48 dB(A) LpA
 Ready/Standby mode: 30 dB(A) LpA
 Sleep mode: Immeasurably low
Safety standards: AS/NZS 60950.1/62368.1/IEC 60825.1
 This unit is manufactured according to ISO 9001 quality standard and ISO 14001 environmental standard.

PAPER HANDLING

All paper capacities quoted are based on a paper thickness of max. 0.11 mm. Please use paper recommended by KYOCERA under normal environmental conditions.
Input capacity: 50-sheet multi-purpose tray; 60-220 g/m² A4, A5, A6, B5, B6, Letter, Legal, Custom (70 x148 mm-216 x356 mm) 250-sheet universal cassette: 60 -163 g/ m² A4, A5, A6, B5, B6, Letter, Legal, Custom (105 x148 - 216 x 356mm). Max. Input capacity with options: 550 sheets
Duplex functionality as standard: Double-sided printing: 60 -120 g/m²; A4, A5, B5, Letter, Legal
Document processor: 50-sheet, 50-160 g/m², A4, A5, A6, B5, Letter, Legal, Custom (105 x148 mm to 216 x356 mm)
 Output capacity: Max. 150 sheets face-down with paper full detection

PRINT FUNCTIONS

Controller language: PRESCRIBE IIc
Emulations: PCL 6 (PCL 5c/PCL-XL), PostScript 3 (KPD L 3), PDF Direct Print 1.7. XPS Direct Print
Operating systems: All current Windows operating systems, MAC OS X Version 10.8 or higher, Unix, Linux as well as other operating systems on request
Fonts/barcodes: 93 scalable fonts for PCL/PostScript, 8 fonts for Windows Vista, 1 bitmap font, 45 barcodes (e.g. EAN8, EAN13, EAN128) with automatic generation of checksums as well as support of two-dimensional barcodes PDF-417 under PRESCRIBE (PC and other barcodes available as an option)

COPY FUNCTIONS

Max. original size: A4/Legal
Continuous copying: 1-999
Zoom range: 25-400 % in 1% steps
Preset magnification ratios: 7 Reductions/5 Enlargements
Exposure mode: Manual: 9 steps
Image adjustments: Text + Photo, Photo, Text, Map, Printed document
Scan resolution: 600, 400, 300, 200 dpi (256 greyscales-per colour)
Features: Auto Colour Mode, Scan-once-copy-many, electronic sort, 2in1, 4in1, ID-card copy, priority print, program, continuous scan, auto cassette change, copy density control

SCAN FUNCTIONS

Functionality: Scan-to-e-mail (SMTP). Scan-to-FTP (FTP over SSL). Scan-to-SMB, Scan to USB Host, TWAIN scan (USB. network). WSD (WIA) scan (USB. network)
Scan speed: 30 ipm (300 dpi, A4, b/w), 23 ipm (300 dpi, A4, colour)
Max. scan size: A4, Legal
Scanning volume: 830 pages per month
Original recognition: Text + Photo, Photo, Text, Light Text, Text (for OCR)
Scan file formats: TIFF, PDF, PDF/A, high compression PDF, encrypted PDF, JPEG, XPS
Compression method: MMR/IPEG
Features: Integrated address book, Active directory support, encrypted data transfer, Blank sheet skip

FAX FUNCTIONS

Compatibility: ITU-T Super G3
Modem speed: Max. 33.6 kbps
Transmission speed: Less than 3 seconds
Scanning speed: 2 sec./sheet or less
Address book: 100 entries

Scanning density:

Normal: 200 x 100 dpi, Fine: 200 x 200 dpi
Superfine: 200 x 400 dpi, Ultrafine: 400 x 400 dpi
Maximum original size: A4, Legal
Compression method: BIG, MMR, MR, MH
Features: Network fax, duplex transmission and reception, polling transmission and reception, Scanning volume 830 pages per month

CONSUMABLES

Average continuous toner yield in accordance with ISO/IEC 19798
Toner-Kit TK-5444K: black toner yield 2,800 pages A4
Toner-Kit TK-5444C, TK-5444M, TK-5444Y: cyan, magenta, yellow toner yield 2,400 pages A4
Toner-Kit TK-5434K: black toner yield 1,250 pages A4
Toner-Kit TK-5434C, TK-5434M, TK-5434Y: cyan, magenta, yellow toner yield 1,250 pages A4

OPTIONS

PF-5110 Paper feeder: 250 sheets; 60-163 g/m: A4, A5, A6, B5, B6, Letter, Legal, Custom (105 x 148 mm-216 x 356 mm)
Memory upgrade: MM3-1GB: 1,024 MB, MM3-512MB: 512MB
UG-33: ThinPrint support
USB IC Card Reader + Card Authentication Kit (B): Support for various authentication keys available

WARRANTY

2-year onsite warranty as standard. KYOCERA guarantees the drum and developer for 3 years or maximum 100,000 pages (whichever occurs sooner), provided the printer is used and cleaned in accordance with the service instructions. Up to 4-year on-site warranty extension for printer and options.

Specifications and design are subject to change without notice. TASKalfa, PRESCRIBE, Kyocera Net Manager, Kyocera Net Viewer, Kyocera Device Manager, PDF Direct Print, Command Center RX, and KX Driver are trademarks of The Kyocera Companies. Mac OS and AirPrint are trademarks of Apple, Inc. Mopria is a trademark of Mopria Alliance, Inc. Windows is a trademark of Microsoft, Inc. All other trademarks are the property of their respective owners.



KYOCERA Document Solutions Australia
Ph: 13 59 62
www.kyoceradocumentsolutions.com.au



Kyocera Document Solutions does not warrant that any specifications mentioned will be error-free. Specifications are subject to change without notice. Information is correct at time of going to press. All other brand and product names may be registered trademarks or trademarks of their respective holders and are hereby acknowledged.
 ©2022 KYOCERA Document Solutions Australia & New Zealand



PO Box 1167
 North Cairns 4870
 Ph- 4080 2000
 Fax- 4080 2020
info@evolvecairns.com.au
www.evolvecairns.com.au
KYOCERA Document Solutions Partner

KYOCERA Document Solutions New Zealand
Ph: 0800 459 623
www.kyoceradocumentsolutions.co.nz