



CATLINK RFID Pet Feeder

Standard User Manual



Toll free: +1 833 440 2772 Email: support@catlink.cn

Thank you for purchasing the CATLINK RFID Pet Feeder - standard!

CATLINK is committed to developing innovative products that cater to your pet's needs and make your life easier.

The CATLINK RFID Pet Feeder - standard is designed to recognize the CATLINK RFID Collar Tag, which comes in packs of two that are included with the feeder. When your pet places its head on the front top of the feeder, the Collar Tag will be scanned, allowing your pet to access its food while keeping other animals out. This feeder is perfect for use in multi-pet households, as it only opens for authorized pets.

This user manual provides step-by-step instructions for configuring the feeder to work in your home. From installing the batteries to teaching your pet how to use the feeder, we will guide you through the entire process.

The CATLINK RFID Pet Feeder - standard is packed with many features, so be sure to keep this manual handy for future reference. If you require assistance or have any questions, please don't hesitate to reach out to us at support@catlink.cn or call us at +1 833 440 2772.

We hope you and your pets enjoy the freedom that comes with the CATLINK RFID Pet Feeder - standard.

Thank you again for choosing CATLINK.

01 Important Notice

- Before using this product, make sure to read this manual carefully. By using this product, you acknowledge that you have read and accepted the following safety precautions.
- It is important to note that we cannot be held responsible for any accidents or losses resulting from failure to comply with the guidelines outlined in this manual.
- Be aware that Shanghai Catlink Intelligent Technology Co., Ltd. retains the right to interpret and make amendments to this manual as necessary.

02 Important Safety Instructions

- ① To properly install and use the device, it is important to strictly follow this manual.
- ② Follow the official tutorial steps provided for installation and use. Do not forcibly insert or remove parts, as this may result in the device malfunctioning.
- ③ Only use the recommended adapter to power the device to prevent damage, malfunction or potential security risks.
- ④ To prevent damage to the feeder or shorten its service life, use it indoors and keep it away from sources of fire, high temperatures, high humidity, or direct sunlight.
- ⑤ Ensure the device is placed horizontally on a stable surface to avoid tipping over.
- ⑥ Keep any objects at least 20cm away from the front of the device to avoid interfering with your cat's eating experience or the device's proper operation.
- ⑧ After cleaning the bowl, gently place it back on the device once it has dried. Make sure to align it correctly.
- ⑨ If the device will not be used for an extended period, remove the battery, clean the device, pack the parts in the original order, and store in a dry place.
- ⑩ Do not immerse the feeder in water. Instead, turn it off, wipe it with a dry cloth, and allow it to dry completely before turning it back on. Avoid using gasoline, alcohol, or other chemicals, as this may cause damage.
- ⑪ Please note that the device or related functions may differ from those described in this manual as we continue to improve it. For any questions, refer to the latest e-Manual in the CATLINK APP or contact us at support@catlink.cn or +1 833 440 2772.

03 What's In the Box

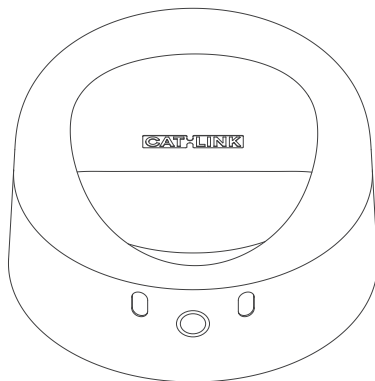

Feeder x1



Collar x2



RFID Collar Tag x2



User Manual x1

04 Product Structure

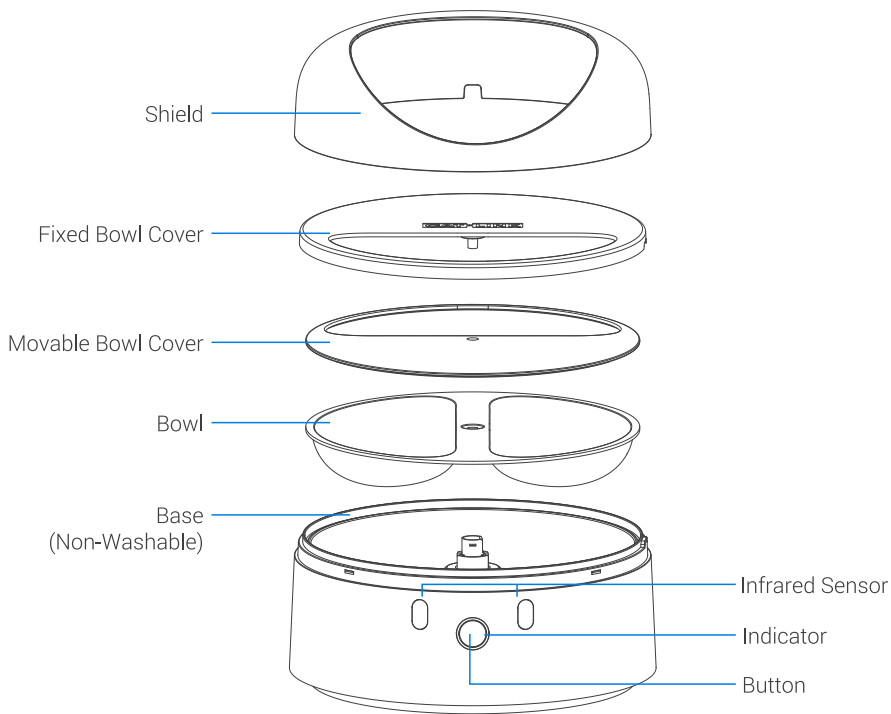

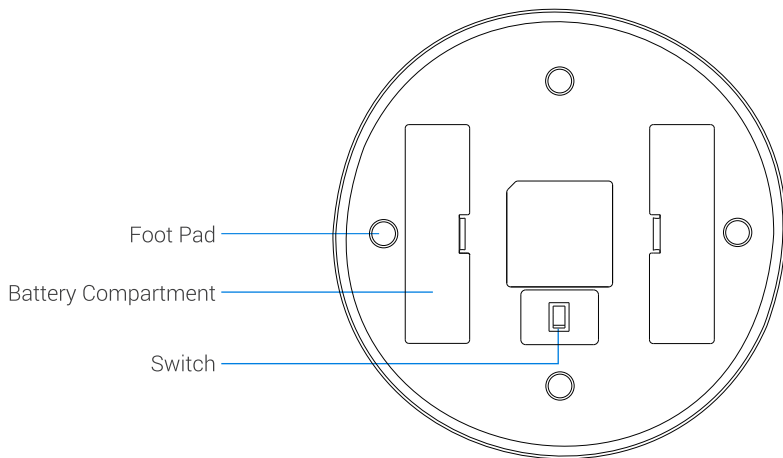

bottom

05 Setting Up Your CATLINK RFID Pet Feeder – standard

Once you have assembled the product and confirmed that the package is complete, get started by following the steps below.

① Placement

- Place the feeder on a flat and sturdy surface with no objects underneath it. Avoid soft, uneven, or unstable flooring as this can affect its performance.
- Ensure that there are no obstructions within 50cm in front of the feeder to prevent interference with the sensor.

② Power

- It is recommended to install four No.2 batteries to ensure uninterrupted operation even during unexpected power outages.
- If the indicator is solid red, indicating low battery power, please replace the batteries promptly.

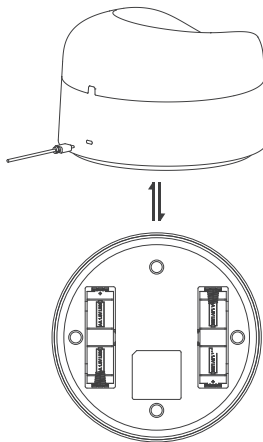

③ Add/Remove Collar Tag

- Press and hold the button for 3 seconds until the green light turns on, then release it.
- The green light will flash. Place a single collar tag above the food bowl.
- Once the blue light starts flashing, it indicates successful tag addition. If the tag already exists, the red light will flash, indicating successful tag deletion.

06 Replacing the Food

NOTE:

- The maximum capacity of the Bowl is 400mL, with two sections of 200mL each. The Bowl should be placed properly.
 - The Bowl can hold freeze-dried, wet food, and other types of cat food. We recommend placing different types of cat food in each section.
 - Be sure to pay attention to the amount of food you pour into the Bowl and DO NOT exceed the mobile Bowl Cover. It is recommended to use a spoon to spread the cat food evenly.
- ① Double-click the button to open the feeder.
 - ② Fill one section of the Bowl with food, making sure not to overfill it, as this may prevent the cover from closing properly and cause a mess.
 - ③ To close the feeder, double-click the button again.
 - ④ Repeat the process to fill the other section of the Bowl.

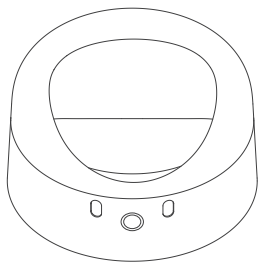

Open the feeder

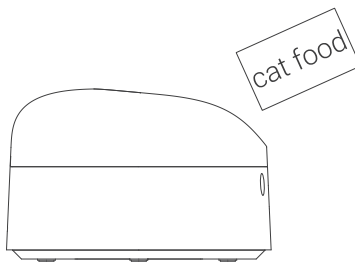

Put food in one section

07 Authorizing Pets to Use the Feeder

Once installed, the CATLINK RFID Pet Feeder - standard will prevent greedy or aggressive pets from accessing food that is not theirs, giving you control over your pets' prescribed meals, medications, and weight management. Pets often prefer to consume small meals throughout the day. To facilitate this and minimize waste, the CATLINK RFID Pet Feeder - standard was designed.

NOTE: For **single-cat** households, it is optional to not bind the collar tag for usage. In the case where the device is not bound to a tag, it can automatically open when the cat approaches the front.

Authorized pets with Collar Tag

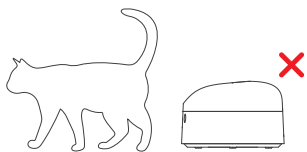
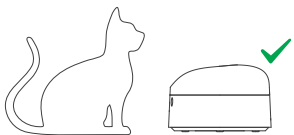

- The feeder cover will remain closed until you open it to replace the food.
- The infrared sensor at front of the device detects the arrival of your cat and activates the RFID sensor to identify the pet's tag information.
- If your pet's tag is authorized and allowed to eat, the cover will open for it.
- Once your pet has finished eating and walked away, the feeder cover will close after a short delay(20s). This helps to keep the food fresher by sealing the Bowl again.

Unauthorized pets

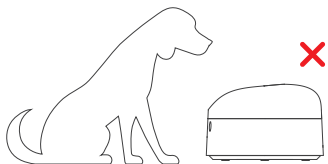

- The lid will not open if an unauthorized pet attempts to access the feeder while it is closed.

08 Teaching Your Pet to Use the Feeder

The Feeder will open/close the Bowl Cover before and after each feeding, which may cause discomfort to your cat. It is recommended to allow your pet to use the Feeder with the Bowl Cover open for a period of time, typically 3-5 days, to gradually adapt to the device. This mode will allow your pet to become familiar with the movement of the feeder's cover.

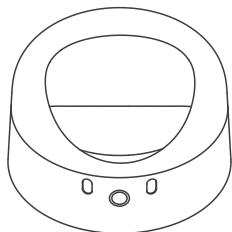

Open

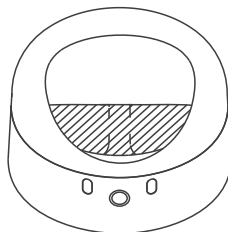

Closed

Phase I

Double-click the button to keep the food Bowl in an open state. Turn off the switch located below the device. Add cat food to the open food bowl, while leaving the other food Bowl empty for now.

Phase II

Turn on the switch to enter the normal working mode. At this point, observe your pet's eating behavior. If your pet is unable to eat normally and still needs to adapt, you can restart the phase I again.

09 Training Multiple Pets

If multiple pets have the same feeding requirements, they can share a feeder. However, if they have different dietary needs or require different amounts of food, it's best to provide each pet with its own feeder. This allows you to precisely control each pet's diet and avoid any potential feeding conflicts.

1

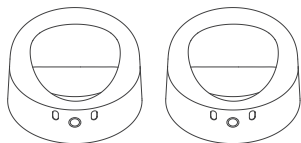

It is recommended to have a separate feeder for each pet, as this allows for precise diet management for each individual pet.

2

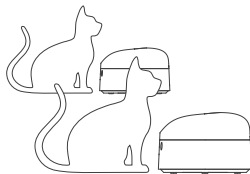

Make sure to keep the feeders separated so that each pet can recognize its own feeder.

3

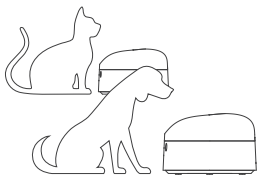

Before beginning the Training Mode, ensure that each pet is comfortable consuming food from the feeder while it is in the open position.

4

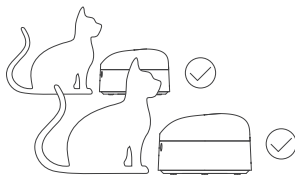

As you progress through the training stages, your pets will learn which feeder is theirs since it will only open for them.

10 Button Functions

Operation	Function	Explanation
Double-click	Open/Close	Open one section, close it; open the other one, and so on.
Press for 3 seconds	Add/Remove Collar Tag	<ol style="list-style-type: none">1. Press and hold the button for 3 seconds until the green light turns on, then release it.2. The green light will flash. Place a single collar tag above the food bowl.3. Once the blue light starts flashing, it indicates successful tag addition. If the tag already exists, the red light will flash, indicating successful tag deletion. The device supports adding up to 16 tags. If the addition is not successful, please delete any unused tags and try again.
Press for 5 seconds	Reset	Release the button after the indicator light turns blue. This will reset the device and delete all previously added tags. This process is used for removing tags in the case of loss or damage

11 Indicators

Indicator	Status	Explanation
White	Blinking	The Collar Tag has been successfully read. The cover is open. The pet is eating.
Green	Blinking	It's calibrating.
Blue	Solid then turn white	The device is successfully reset.
	Blinking	The tag is successfully added.
Red	Solid	Low battery power
	Blinking	Motor blockage: In the event of a blockage, please open the food Bowl and check for any obstructions around. If there are any, remove them. Manually open the food Bowl once to resolve the issue.
	Blinking twice	The tag is successfully removed.

12 Cleaning & Maintenance

Do not submerge the entire feeder in water or put it in the dishwasher.

- Washable parts: **Shield, Fixed Bowl Cover, Mobile Bowl Cover, Bowl**
- Unwashable part: **Base**

How to disassemble the feeder?

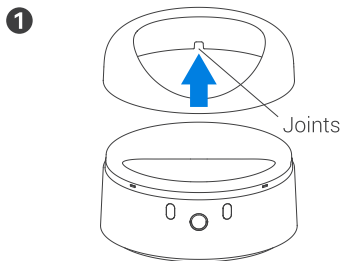

Align the joints and remove the Shield upwards.

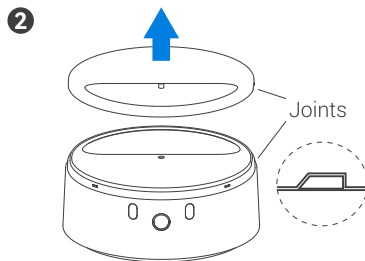

Align the joints and remove the Fixed Bowl Cover upwards.

3

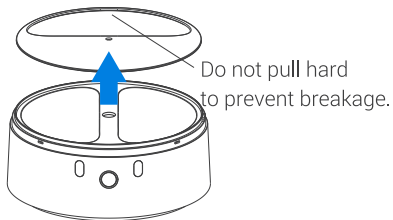

Align the joints and remove the Mobile Bowl Cover upwards.

4

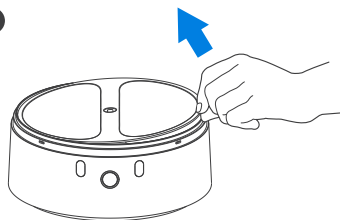

Remove the Bowl diagonally upwards.

The Bowl is washable.
The Base is unwashable.

13 Specification

Product Name	CATLINK RFID Pet Feeder - standard
Product Model	CL-FC-02
Main Material	ABS
Product Size	240*240*155mm (9.45 x 9.45 x 6.10 inches)
Rated Voltage	5V $\overline{\text{=}}$ 1A
Rated Power	5W
Applicable Scope	Cats or small dogs
Product Weight	1.1kg (2.87lbs)
Compliance Standard	GB 4706.1-2005
Manufacturer	Shanghai Catlink Intelligent Technology Co., Ltd
Address	No.800 Naxian road, Pudong New District, Shanghai, China
Website	www.catlinkus.com

14 Customer Service

We will provide customers with a one-year free warranty service.
If you have questions or need assistance, contact us!

Phone Support

+1 833 440 2772

Mon-Fri: 10AM-6PM EST

Email Support

support@catlink.cn 24/7



Toll free: +1 833 440 2772 Email: support@catlink.cn